

## REMA Tiller Handle – RFID Product Model 9602431





---

Verfasser / Sign	Datum / Date	Page
Philipp Welzel / PW	04/25/2023	2 / 6

Betreff / Subject  
9602431 - Tiller Handle RFID THD Manual

Version  
1.0

---

## 1 Content

2	Introduction.....	3
3	Connections.....	3
3.1	Operating the RFID Module.....	4
3.1.1	Layout & Buttons.....	4
3.1.2	Access Levels .....	4
3.1.3	Locking and unlocking the RFID Module .....	4
4	FCC Compliance Statement .....	6

## 2 Introduction

The Tiller Handle (THD) with RFID Access Module is the control interface for a low lift pallet truck. The device with RFID Access Module is comprised of a printed circuit assembly with RFID Chip and an RFID Membrane with Antenna. The RFID transceiver is for the 125kHz frequency range.

The RFID Module allows to switch the logic power from the Battery to the motor controller of the pallet truck if the correct RFID ID was scanned

The THD generates and communicates signals for functions like lift, lower, direction and speed via CAN Bus to the motor controller of the pallet truck.

Commissioning is prohibited until it has been determined that the machinery in which this THD is to be installed complies with the provisions of Machinery Directive 2006/42 / EU.

## 3 Connections

- The RFID Membrane is connected to X101 of the main PCB.
- The main harness from the truck is connected to X100 of the main PCB
- Mechanical connection: 3x M6, Torque: 3 N/m

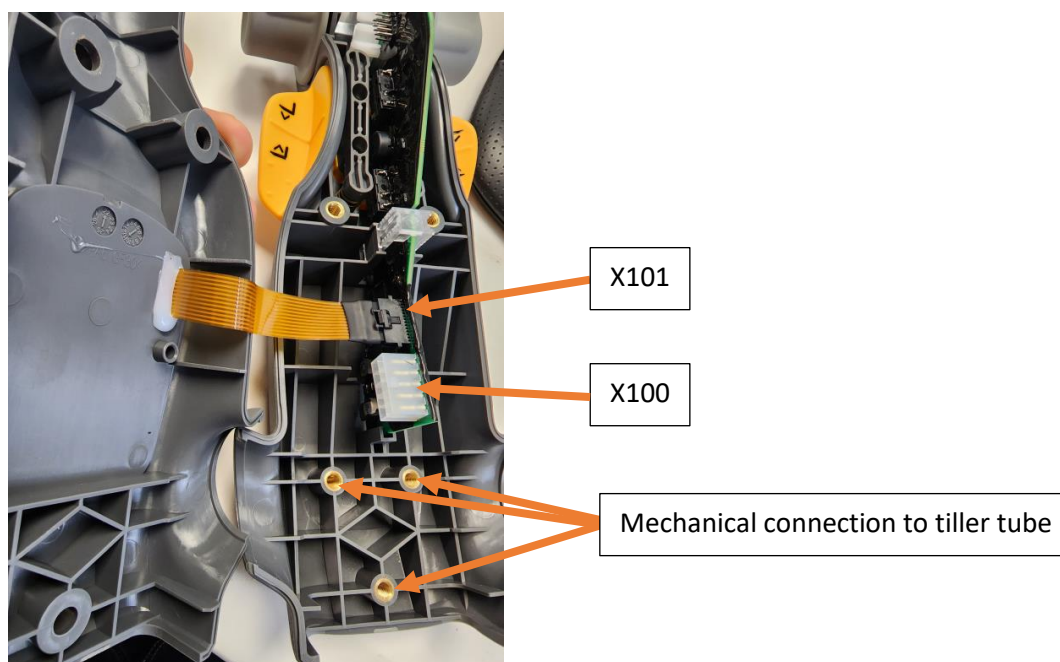

### 3.1 Operating the RFID Module

#### 3.1.1 Layout & Buttons



#### 3.1.2 Access Levels

The RFID Module has 2 access levels:

- Operator Level
  - Functions:
    - Unlock
    - Lock
- Supervisor / Service Level

#### 3.1.3 Locking and unlocking the RFID Module

To Unlock from **STATE "OFF/SLEEP"**

- You are in **STATE "OFF/SLEEP"**
- STEP 1:**
  - Press "P" to wake up the keypad → **STATE "LOCKED"**
    - You are now in **STATE "LOCKED"**
- STEP 2:**
  - Scan User Card
    - If user Card ID OK → **STATE "UNLOCKED"**
      - You are in **STATE "UNLOCKED"**
    - If user CARD ID NOK → **STATE "ERROR"**
      - Wrong User ID or reading error
      - You are in **STATE "LOCKED"**

To Lock from STATE "UNLOCKED"

- You are in STATE "UNLOCKED"
- STEP 1:**
- Press "X" → STATE "LOCKED"
  - You are in STATE "LOCKED"

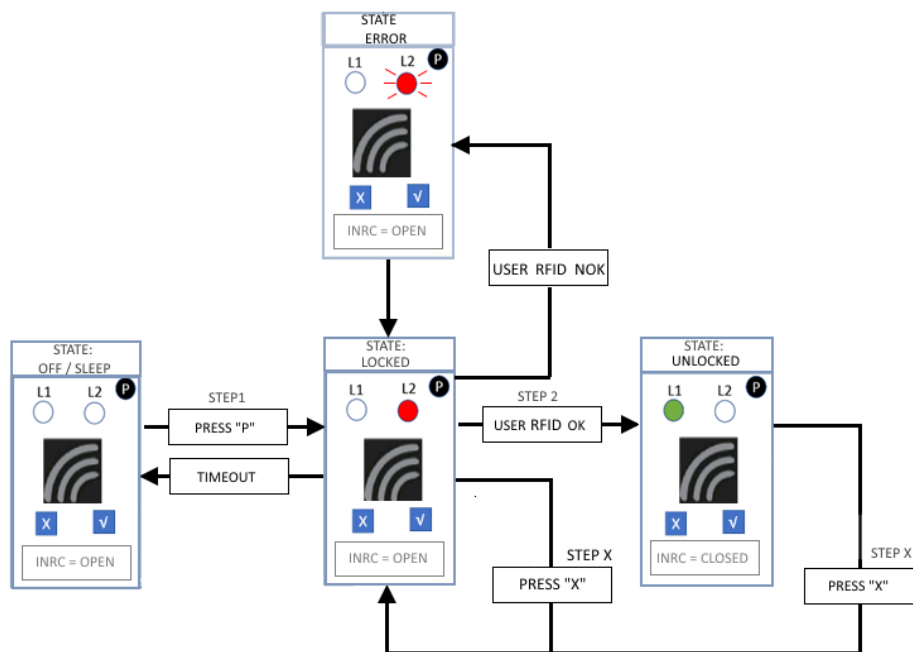



## 4 FCC Compliance Statement

This device complies with part 15 of the FCC Rules. Operation is subject to the following two conditions:

(1) this device may not cause harmful interference, and (2) this device must accept any interference received, including interference that may cause undesired operation.

**CAUTION:** The grantee is not responsible for any changes or modifications not expressly approved by the party responsible for compliance. Such modifications could void the user's authority to operate the equipment.

**NOTE:** This equipment has been tested and found to comply with the limits for a Class B digital device, pursuant to part 15 of the FCC Rules. These limits are designed to provide reasonable protection against harmful interference in a residential installation. This equipment generates, uses, and can radiate radio frequency energy, and if not installed and used in accordance with the instructions, may cause harmful interference to radio communications. However, there is no guarantee that interference will not occur in a particular installation. If this equipment does cause harmful interference to radio or television reception, which can be determined by turning the equipment off and on, the user is encouraged to try to correct the interference by one or more of the following measures:

- Reorient or relocate the receiving antenna.
- Increase the separation between the equipment and receiver.
- Connect the equipment into an outlet on a circuit different from that to which the receiver is connected.
- Consult the dealer or an experienced radio/TV technician for help.

This equipment has been tested and meets applicable limits for radio frequency (RF) exposure.