



GAN Smart Cube (ui FreePlay series) User Manual



关注 GAN 微信公众号
获取魔方知识 体验竞速之趣



Follow GANCUBE on Instagram
for more speedcubing stuff



SPECIFICATIONS

Model	GAN12 ui FreePlay	GAN mini ui FreePlay
Product size	56x56x56 mm	53x53x53 mm
Product weight	About 68.5±1g	About 63.5±1g
Battery type	3.7V lithium	
Charging time	2.5 h	
Battery life	About 15 h*	
USB adapter	≤5V2A	
Connection	Wireless	
Device requirement	IOS 9.0 Android 4.4 or above	

* Lab test data. Actual battery life subject to actual usage.

ACCESSORIES

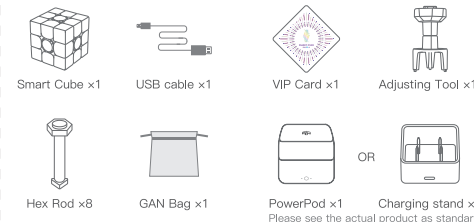

STEP 2 : TENSION ADJUSTMENT

Insert the tool into the GES nut from the 3 matching slots. Then turn clockwise to increase the tension. You will feel a click with every turn as the nut moves downward. There will be the most obvious click when the tension turn to grade 1 from grade 6.

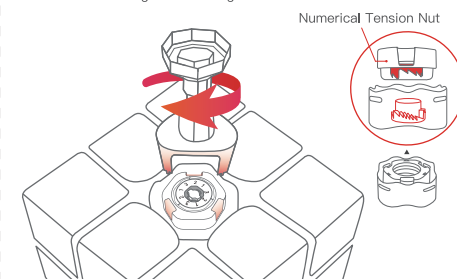

Warning: DO NOT alter the positions of center caps, this will lead to synchronization problems. DO NOT bend the core when adjusting center travel and tension, to prevent damage of the internal electrics. Resetting the cube is required after readjusting center travel and tension.

READ CAREFULLY BEFORE GETTING STARTED

- The product contains a built-in motion tracking system to record moves on each side. DO NOT swap the center caps of each side.
- DO NOT bend the core when adjusting tension, in case of damaging the internal circuit.
- To charge the cube, ensure that the LOGO side is facing upwards.

GETTING STARTED

- Charging methods**
 - Charging method of Charging stand: Put the cube into the charging stand and press it, LOGO SIDE UP ONLY. Connect the charging stand to a power source as shown.
 - Charging method of PowerPod: Put the cube into PowerPod (LOGO SIDE UP ONLY), and press the power button to start charging.
- Awaking method**
 - Turn any side of the cube to awake it. (The white light will blink when successful awakening.)
 - *Battery level will show in APP once connected.
- Download and install APP "Cube Station"**. Enable your smart phone's Bluetooth function and open the APP; Connect the cube per instructions in the APP.

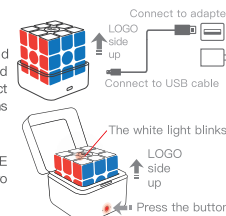

BASIC CUBE STATUS/FUNCTION

Cube Status/Function	Status/Function Instruction	Operation	Light Indicator (on the white side)
Awaken	The cube can connect to Bluetooth devices when in awaken mode.	Turn any side of the cube.	White light blinks.
Sleep	The cube can not connect to Bluetooth devices when in sleep mode.	Cube will automatically go off in situations below: 1. do not connect to any devices over 5 minutes. 2. no action over 10 minutes when connecting to the app.	White light off.
Low-battery	The cube will automatically enter sleep mode when battery is low.	Use the charger and USB cable provided for charging only.	Red light blinks.
Disconnect to APP	The cube can only connect to one device at a time. Once connected, the cube can not be detected by another device.	Rotate the white side clockwise for 5 rounds or using "disconnect" option in the APP can disconnect the cube.	White light blinks.
Bind to APP	The cube can only bind to one APP account at a time. Once binded, the cube can not be connected by any other APP accounts.	Rotate the orange side clockwise for 5 rounds or using "Unbind" option in the APP can unbind the cube.	/

SET UP STEPS

Instructions for Adjusting Tool
When used for adjusting, the tool is shown as Figure 1.

- Align the Gan logo vertically with the groove.
- Hold both ends of the tool and gently pull it out to make the connection between the two sections clamp tightly.

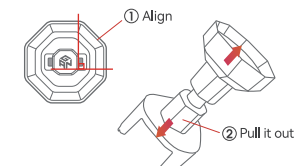
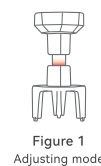

STEP 1 : CENTER TRAVEL ADJUSTMENT

Insert the tool into the numerical distancing nut. Then turn clockwise to adjust the center travel. Each turn counterclockwise decreases the center travel by one grade. You will feel a click with every turn as the nut moves. 1/2/3: 3 center travel options, the smaller the number, the tighter the cube feels.

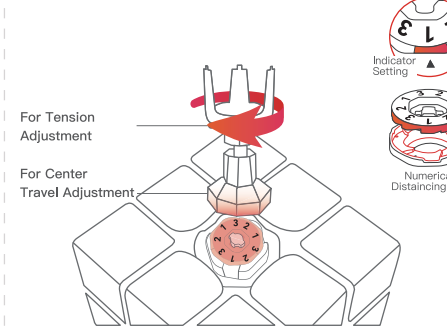

VIDEO INSTRUCTION



MUST KNOWS

- Usage restrictions**
- The smart cube contains electronic components. To prevent damage, DO NOT dismantle the core.
 - DO NOT lubricate on the yellow face and the core.
 - DO NOT crash the product. Keep away from water or high temperature (≥60°C).
 - Product contains small parts, NOT suitable for children under 36 months.
 - Strictly follow manual to avoid product damage or bodily harm.

Battery and Charging

- Use the PowerPod and USB cable provided for charging only. Ensure they are in good condition before connecting to power.
- Product shuts down automatically when battery is low. Please charge the cube appropriately to avoid loss of data.
- Fully charge the cube at least once every 3 months to prevent permanent battery damage. Keep in dry and cool conditions if not in use.

TROUBLE-SHOOTING

- Failure of detecting the cube by APP?**
 - Ensure the cube has been fully charged.
 - Ensure the cube has been awakened.
 - Ensure the cube's Bluetooth has been enabled. The red light in the white side will light up when cube's Bluetooth is off.
 - Ensure the cube has not been connected already by another device.
 - Android users please ensure location access has been authorized to the APP.
- Cube position not synchronized in the APP?**
 - Reset the cube via "Reset Cube" functions in the APP.
 - The cube will shut down when battery is low. Charge timely.
 - Gyroscope will accumulate detection bias over time. This is not malfunction. Please adjust cube position in APP from time to time to ensure synchronization.
- Failure of charging the cube?**
 - Ensure sides have not been altered from ex-factory positions and white side is facing upwards.
 - When battery is too low it takes a few minutes to reach minimum wake-up battery level.
 - Make a whole rotation and put the cube in the charging stand again.

More info & supports: support@gancube.com

STEP 3 : MAGNET ADJUSTMENT

- Standard Adjustment (NO disassembling required)**
 - Turn the outer layer 45° to expose the magnet slots on the corner pieces. Use the adjusting tool to toggle the lever to the desired setting.
- Advanced adjustment (requires disassembling the cube)**
 - start from any one of the corner pieces. Take the corner piece out. Turn the magnet rod 60° counterclockwise to unlock and pull it out from the slot.
 - insert the new rod and turn 60° clockwise to lock it. Then repeat the same operation to change the magnet rods on the other corners one by one.

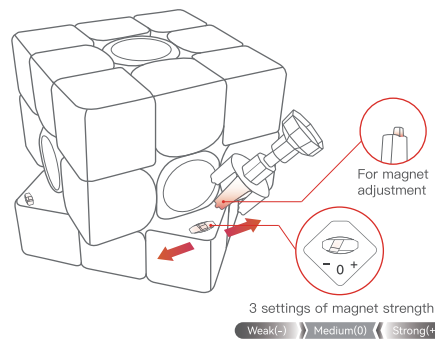

FCC Warning

This device complies with part 15 of the FCC Rules. Operation is subject to the following two conditions:

(1) This device may not cause harmful interference, and (2) this device must accept any interference received, including interference that may cause undesired operation.

Any Changes or modifications not expressly approved by the party responsible for compliance could void the user's authority to operate the equipment.

Note: This equipment has been tested and found to comply with the limits for a Class B digital device, pursuant to part 15 of the FCC Rules. These limits are designed to provide reasonable protection against harmful interference in a residential installation. This equipment generates uses and can radiate radio frequency energy and, if not installed and used in accordance with the instructions, may cause harmful interference to radio communications. However, there is no guarantee that interference will not occur in a particular installation. If this equipment does cause harmful interference to radio or television reception, which can be determined by turning the equipment off and on, the user is encouraged to try to correct the interference by one or more of the following measures:

- Reorient or relocate the receiving antenna.
- Increase the separation between the equipment and receiver.
- Connect the equipment into an outlet on a circuit different from that to which the receiver is connected.
- Consult the dealer or an experienced radio/TV technician for help.

The device has been evaluated to meet general RF exposure requirement. The device can be used inportable exposure condition without restriction.