

802未转曲

58.00 mm

88.00 mm



彩屏仓耳机说明书

产品基本参数及功能

1. 产品名称: 彩屏仓蓝牙耳机
2. 颜色: 黑色 白色 肤色
3. 耳机材质: ABS+PC
4. 蓝牙版本: Bluetooth 5.3
5. 耳机充电时间: <2h
6. 电池容量: 600mAh/60mAh
7. mic数量: 双唛降噪
8. 蓝牙通讯距离: >10m
9. 工作温度: -10°C ~ +55°C
10. 显示屏: 2.01吋 IPS触摸显示屏

功能特点:

贴耳式设计超舒适感; 搭载1217mm气传导, 浑厚立体 HIFI 无损音质自动开关机; 来电接听; 拒绝; 唤醒语音助手; 音乐播放暂停; 上下一曲; 天气获取; 遥控拍照; 消息提醒; 来电提醒; 秒表; 计时器; EQ调节; 图片下载; 音量调节; OTA升级

耳机/充电仓操作说明

1. 首次开机

撕掉屏幕保护膜, 并充电激活开机



2. 安装APP

设置中找到关于-扫码下载APP 或应用商店搜索 TB Audio安装到手机上

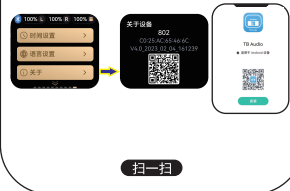

耳机/充电仓操作说明

3. 充电仓连接耳机

充电仓跟耳机默认自动连接, 蓝牙图标显示蓝色为已连接, 红色未连接, 如未自动连接请执行以下操作:

1. 左右耳机开机状态下左右同时单击4次在长按5秒恢复出厂设置
2. 充电仓开盖, 长按充电仓按键5秒选择清空配对后在点恢复出厂



4. 充电仓连接设备操作

打开APP 点击+添加产品设备搜索到该型号后点击连接



5. 耳机连接设备操作

Android设备: 充电仓在连接手机后APP会自动推送耳机配对信息, 点击配对即可
iOS设备: 需要在设置中手动找到该型号蓝牙名后点击配对(Android设备也可按此操作手动配对连接)

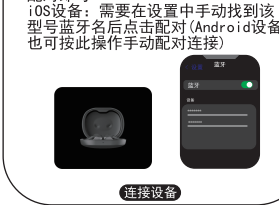

耳机功能说明

| No | 功能类型 | 操作描述 |
|----|-----------|---------------------|
| 1 | 开机 | 耳机在仓中, 电池仓开盖开机 |
| 2 | 关机 | 耳机在仓中, 电池仓合盖关机 |
| 3 | TWS互配成功 | 电池仓开盖配对 |
| 4 | TWS断开 | 任意一边放入仓, 合盖断开 |
| 5 | 播放/暂停 | 双击任意一边 |
| 6 | 上一曲 | 长按2S左耳键 |
| 7 | 下一曲 | 长按2S右耳键 |
| 8 | 拒绝电话 | 长按1S任意一边 |
| 9 | 接听/挂断电话 | 双击任意一边 |
| 10 | 语音助手 | 三击右耳 |
| 11 | 游戏模式/音乐模式 | 三击左耳 |
| 12 | 清除配对后关机 | 双击左右耳机加长按5秒多功能键清除配对 |
| 13 | 无连接自动关机 | 开机后5分钟没连接蓝牙自动关机 |

充电仓状态说明



状态栏图标说明



快捷功能图标说明



— THE END —

802未转曲英文

58.00 mm

88.00 mm



Full-color screen open ear true wireless earhook MANUAL

Basic Specs

- *Product name: Full-color screen open ear true wireless earhook
- *Color: Black/White/Skin Color
- *Material: ABS+PC
- *Bluetooth Version: 5.3
- *Charging time: <2h
- *Battery size: 600mAh for charging case 60mAh for earbuds
- *Mic: 4 AI mic
- *Bluetooth Range: >10m
- *Working temperature: -10~55C
- *Screen: 2.01-inch full color LCD

Advantages

- * An epoch-making new way of headphones wearing, not in-ear or half-in-ear any more, multi-mechanic support for stable and non-sensory wear, all-day wear without bondage, more comfortable than in-ear semi-in-ear headphones, even better than bone conduction, and sound quality much better than bone conduction earphones.
- * Multi-scene wear, running, coffee shop, business, travel, wear all day without feeling, you can hang back, you can hang ears, you can use when glasses Special software algorithm with patented mechanic design which support ur colleague or friend hear no voice from you earphone.
- * With New 12X17mm oval patent driver whichs make the sound quality premium.
- * Full-color high definition screen multiple function: Answer a call, End a call, Reject a call, wake up siri/google assistant, play music/p ause music, next track/previous track, weather report, remote camera, message reminder, timer, EQ setting, download wallpaper, volume up/down, OTA upgrade

耳机/充电仓操作说明

Operating Instructions

1. First boot

Tear off the film on the screen, charging the case to activate the earphone.



2. Install APP

Find the setting in the screen and open refer to find the QR code, scan the QR code to download the APP-TB audio, you can also search TB Audio to download the APP Operating Instructions.

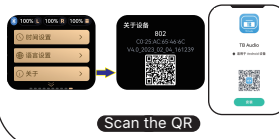

耳机/充电仓操作说明

Operating Instructions

3. Connecting the charging case

The charging case will be automatically connected to the earhook, The Bluetooth icon shows blue as connected and red as unconnected. If not automatically connected, please perform the following operations:

- *When the left and right earphones are powered on, click four times at the same time and hold for 5 seconds to reset.
- *Open the lid of the charging case, long press the button of the charging case for 5 seconds to reset



4. Connect the charging bin to the device for operation

Open the APP and click + Add product Device Search for the model and click Connect.

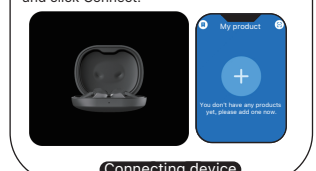

5. Connect the headset to the device

For Android device: After the charging case connect the APP, there will be an auto popup pairing information, tap pairing will finish the process, you can also find the bluetooth name in the bluetooth list and pair the earphone For iOS device, Find the bluetooth name in the bluetooth list and pair the earphone.



Headset function description

| No | Functional type | Operation description |
|----|---------------------------------------|---|
| 1 | Power on | Open the lid to power on. |
| 2 | Power Off | Close the lid to power off. |
| 3 | pairing | See the details in the manual. |
| 4 | TWS disconnect | Put either side in the charging case, close the lid for disconnect. |
| 5 | Play/pause | Double click on either side. |
| 6 | Previous song | Long press the left ear button for 2S. |
| 7 | Next song | Long press the right ear button for 2S. |
| 8 | Reject call | Press and hold 1S on either side. |
| 9 | Answering up the phone | Double click on either side. |
| 10 | Voice assistant | Triple tap on the right ear. |
| 11 | Game mode/Mute mode | Triple tap on the left ear. |
| 12 | Clear pairing and shut down | Four taps left and right earbuds by pressing the multifunction key for 5 seconds for clear the pairing. |
| 13 | Automatic shutdown without connection | After 5 minutes after the boot is not connected to the Bluetooth automatic shutdown. |

Description of charging case screen

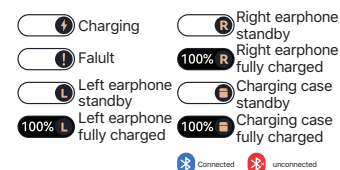

Description of ICONS



FCC Warning:

This equipment has been tested and found to comply with the limits for a Class B digital device, pursuant to part 15 of the FCC Rules. These limits are designed to provide reasonable protection against harmful interference in a residential installation. This equipment generates, uses and can radiate radio frequency energy and, if not installed and used in accordance with the instructions, may cause harmful interference to radio communications. However, there is no guarantee that interference will not occur in a particular installation. If this equipment does cause harmful interference to radio or television reception, which can be determined by turning the equipment off and on, the user is encouraged to try to correct the interference by one or more of the following measures:

- Reorient or relocate the receiving antenna.
- Increase the separation between the equipment and receiver.
- Connect the equipment into an outlet on a circuit different from that to which the receiver is connected.
- Consult the dealer or an experienced radio/TV technician for help.

Caution: Any changes or modifications to this device not explicitly approved by manufacturer could void your authority to operate this equipment.

This device complies with part 15 of the FCC Rules. Operation is subject to the following two conditions:

(1) This device may not cause harmful interference, and (2) this device must accept any interference received, including interference that may cause undesired operation.

This equipment complies with FCC radiation exposure limits set forth for an uncontrolled environment. This equipment should be installed and operated with minimum distance 0cm between the radiator and your body.