

Battery Installation:

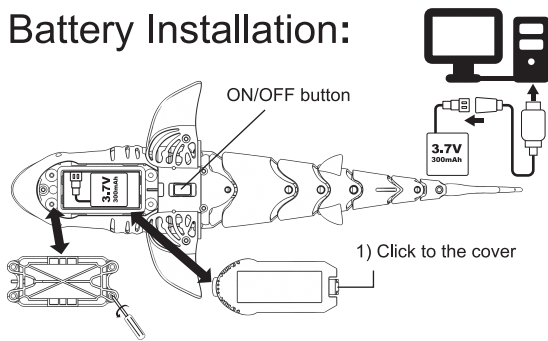

- RC Shark requires one 3.7V 300mAh rechargeable battery. (included)

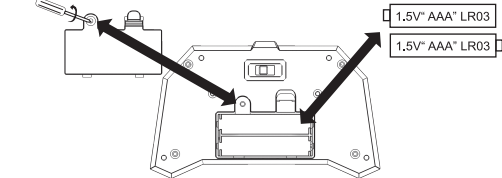

- Remote controller requires 2 x 1.5V Alkaline "AAA" LR03 batteries. (Not included)

- Open the battery compartment: loosen the screw by turning counterclockwise with a Phillips screwdriver (included).
- Insert one 3.7V 300mAh rechargeable battery into the battery compartment of Shark with correct polarity.
- Insert 2 x 1.5V "AAA" LR03 batteries into the battery compartment of the remote controller with correct polarity.
- Close the battery compartment: tighten the screw by turning clockwise with a Phillips screwdriver.

How to play

- Put the batteries into the remote controller and press the ON/OFF button. If the left and right LEDs flash simultaneously (for 0.25 seconds), it indicates that the remote controller is ready for pairing.
- Put the batteries into the RC Shark, turn the ON/OFF switch to ON, and it will automatically pair with the remote controller to establish a connection. The left and right LEDs of the remote controller are always on.
- Put the shark into the water, and you can toggle the left and right joysticks forward or backward to control the shark to move forward or backward.
- The right button above the remote control can be used to control the speed of Shark.

 **WARNING:** Never allow young children to play in or around water without adult supervision.

2.4GHZ RC
Shark must be in water to function.

Shark has variable speed modes-can be tuned for movements like real sharks!

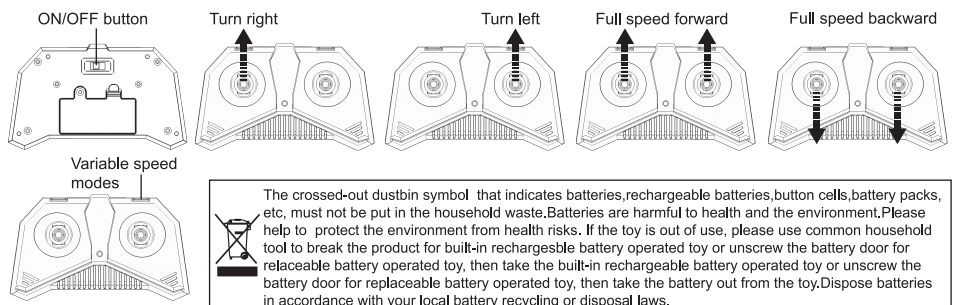

⚠ Caution:

- This product is a children's toy that will swim in the water through the 2.4GHz wireless remote control.
- This product has the function of automatic pairing. After successful pairing, it can only be controlled one-to-one.
- While pairing, put the RC Shark and remote controller as close as possible.
- The RC Shark has the function of sensing water. The motor will stop running once Shark is taken out of the water.
- The RC Shark possesses the waterproof function.
- The remote controller does not possess the waterproof function.
- *Distance of remote control: 30-40 meters in unobstructed environment.
- Operate only in calm, clear water for the RC Shark. Pools and shallow are recommended.
- After each use, wipe with a towel and allow to dry completely.
- Do not operate near concrete walls which may disturb transmission.
- Your RC Shark is designed for operation in fresh water. Avoid to operate it in salty water. Do not submerge the RC Shark in water for a long time.
- Maximum 10 players at a time.

⚠ Battery Notice

- 1) Shark uses one 3.7V rechargeable lithium battery and the remote controller uses two 1.5V AAA non-rechargeable batteries.
- 2) Ensure the batteries are removed and installed correctly with the regard to polarity (positive and negative) and voltage. Ensure the batteries are not to be short-circuited.
- 3) Non-rechargeable batteries are not to be charged.
- 4) Rechargeable batteries are only to be charged under adult supervision.
- 5) Rechargeable batteries are to be removed from the toy before being charged.
- 6) Do not mix different types of batteries. Do not mix old and new batteries.
- 7) Always use batteries as recommended or equivalent.
- 8) Always remove batteries if the battery drains or the product is to be left unused for a long time.
- 9) The supply terminals are not to be short-circuited.
- 10) Do not connect the product to excessive power supplies than recommended.
- 11) Inspect the cord, plug, housing and other parts of the charger for the toy at a regular basis. And if any damage has been found, please immediately stop using not until restored.

changes or modifications not expressly approved by the party responsible for compliance could void the user's authority to operate the equipment.

This equipment has been tested and found to comply with the limits for a Class B digital device, pursuant to Part 15 of the FCC Rules. These limits are designed to provide reasonable protection against harmful interference in a residential installation. This equipment generates, uses and can radiate radio frequency energy and, if not installed and used in accordance with the instructions, may cause harmful interference to radio communications. However, there is no guarantee that interference will not occur in a particular installation.

If this equipment does cause harmful interference to radio or television reception, which can be determined by turning the equipment off and on, the user is encouraged to try to correct the interference by one or more of the following measures:

- Reorient or relocate the receiving antenna.
- Increase the separation between the equipment and receiver.
- Connect the equipment into an outlet on a circuit different from that to which the receiver is connected.
- Consult the dealer or an experienced radio/TV technician for help.

This equipment complies with FCC radiation exposure limits set forth for an uncontrolled environment. This equipment should be installed and operated with minimum distance 20cm between the radiator and your body. This transmitter must not be co-located or operating in conjunction with any other antenna or transmitter.