

HY206 使用手册

instruction manual



非常感谢您选用本公司设计的音箱产品！为了能更好地发挥音箱使用效果、给您带来更多的乐趣，避免不必要的困扰，我们建议您认真地阅读一下使用手册。若有不明白清楚之处、请联系本公司产品在当地的经销商或致电本公司，会给您满意的答复！

Thank you for purchasing your new gaming speaker system. We recommend that you spend some time reading this manual in order that you fully understand all the operational features it offers. Read all the safety instructions carefully before use and keep this instruction manual for future reference.

一、产品简介：

Brief Introduction

本音响支持 AUX-IN 输入播放与蓝牙播放、内置 DSP 音效处理、RGB 七彩灯与投影灯光装饰。

This product supports AUX-IN and Bluetooth playing as well as earphone function.

Built-in DSP sound processing

Dual optical projectors and RGB led lighting.

二、接口功能说明：Controls on panel interface 插入图片

1. DC5V 供电 USB 插头
DC 5V USB powered
2. AUX-IN 输入Φ3.5 立体声插头
AUX -input for Φ3.5mm stereo jack
3. 耳机输出
Earphone port
4. 模式键
Mode
5. 音量旋钮
Volume

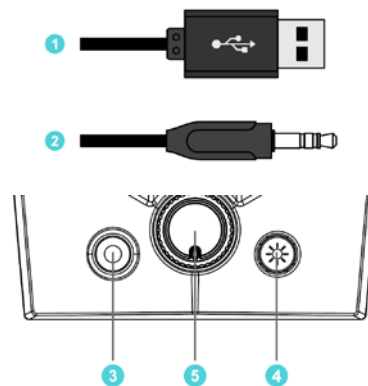

三、使用方法：Operations

1. 请把 USB 头插上 DC5V 电源开机，默认为 AUX-IN 播放模式并有提示音、Φ3.5 立体声插头插至电脑或手机等Φ3.5 音频输出设备，音量旋钮请调节至合适音量。
Plug the USB power cable into your DC5V power supply such as PC or DC5V adaptor. the unit implies a priority of AUX-in playing.
2. **蓝牙配对播放：**连按两次模式键、转换到蓝牙模式，进入配对连接状态(自动回联最后一次连接的蓝牙设备)、蓝色投影灯闪烁，打开蓝牙设备（如：手机蓝牙等蓝牙播放设备）寻找新配对设备，

可发现“HY206”蓝牙音响设备标识,如连接本机时要求输入密码提示,默认输入密码为“0000”确认后即配对完成并有提示音,连接成功后投影灯呼吸变化,蓝牙设备即可播放音乐。

Double press the “M” key to shift to Bluetooth mode , bluetooth device is under pairing and the optical projector will flash blue lightings.

Power on the mobile phone or other BT devices, and search “HY206”, press it to connect and input the Bluetooth pin “0000” if needed, a sound indicator will play after the connection is completed. and then the projection lamps will shine a breathing light.

灯光模式切换：短按模式键灯光切换,共四种灯光效果(关闭或开启灯光),默认是随音乐节拍闪烁模式。长按模式键为投影灯光亮度调节,亮度从100%→30%或30%→100%循环调节。

Press the “M” key shift to lighting mode , there are 4 different lighting modes plus light ON and light OFF for choice. the unit implies the light flashing mode followed music playing..

Keep pressing the “M” key to adjust the brightness of projection lamps (from 30-100%).

四、产品参数：Main Parameter

音频输入方式:	AUX
供电:	DC5V 1A/2A
输出功率:	2.5W+2.5W
频率响应范围:	80 Hz-20 kHz
分离度:	>40dB
信噪比:	>75dB
扬声器阻抗:	4Ω
控制方式:	旋钮+按键

Audio input: AUX, Bluetooth

Power supply: DC5V 1A/2A

Output power: 2.5W+2.5W

Frequency response: 80 Hz-20 kHz

Separation: ≥40dB

S/N ratio: ≥75dB

Impedance: 4ohm

Controls: Knob + key

五. 注意事项：Cautions

1. 必须在额定电压下使用本产品。

make sure to use it under the rated voltage DC 5V

2. 当输入音频信号过强时、音量不要开到最大以不失真欣赏音乐为佳。

Whilele a strong signal input. don't set volume to the maximum to limit distrotion.

3. 不得将本产品搁置于高温、潮湿的环境中,请置于通风干燥处。

To reduce the risk of fire or product damage, do not expose this unit to rain, moisture, dripping or splashing. keep the unit in a ventilated and dry place.

4. 维护时,请用干布擦拭本产品,不能用水、酒精、汽油、酸碱性洗涤剂清洗。如不慎有金属物件或液体洒落产品内,应立即切断电源,经专业人士检查后方可使用。

* Only use dry cloths for cleaning the units, If you spill any liquid into the unit, it can be cause serious damage. Switch it off at the mains immediately. Withdraw the USB plug and consult your dealer.

5. 本产品不可随意拆卸，如需维修，请联系本公司售后客服。

* Do not open any fixed covers as this may expose dangerous voltages.if maintance required, Please leave all maintenance work to qualified personnel or consult your dealer.

6. 使用温度范围：0°C~45°C；湿度范围：30~70%RH。

Working atmosphere: under 0°C~45°C, 30-70% humidity.

7. 长时间收听语音播放可能会导致短暂的听力受损。

Listening to loud sounds for prolonged period of time may momentarily damage your hearing.

8. 长时间注视闪烁灯光可能会导致短暂视觉暂留。

Looking at flashing lights for prolonged period of time may momentarily damage your visus.

9. 带上耳机前，请将音量先调低，然后再调到舒适的音量。

Before putting on earphones, turn the volume down and slowly increase the volume to a comfortable volume level.

FCC warning:

Any Changes or modifications not expressly approved by the party responsible for compliance could void the user's authority to operate the equipment.

Note: This equipment has been tested and found to comply with the limits for a Class B digital device, pursuant to part 15 of the FCC Rules. These limits are designed to provide reasonable protection against harmful interference in a residential installation. This equipment generates uses and can radiate radio frequency energy and, if not installed and used in accordance with the instructions, may cause harmful interference to radio communications. However, there is no guarantee that interference will not occur in a particular installation. If this equipment does cause harmful interference to radio or television reception, which can be determined by turning the equipment off and on, the user is encouraged to try to correct the interference by one or more of the following measures:

-Reorient or relocate the receiving antenna.

-Increase the separation between the equipment and receiver.

-Connect the equipment into an outlet on a circuit different from that to which the receiver is connected.

-Consult the dealer or an experienced radio/TV technician for help.

This equipment complies with FCC radiation exposure limits set forth for an uncontrolled environment. This equipment should be installed and operated with minimum distance 20cm between the radiator & your body.

This device complies with part 15 of the FCC Rules. Operation is subject to the following two conditions:
(1) This device may not cause harmful interference, and (2) this device must accept any interference received, including interference that may cause undesired operation.