



Bravo Monster

Bravo Monster Super RC Car Manual

Thank you for purchasing Bravo Monster Super RC Car. This product is based on the combination of the newly developed 2.4GHz transmitter and its corresponding receiver. Before driving the car, read this manual which contains the instructions you will need to operate, and maintain your car.

After reading this manual, store it in a safe place.

Table of contents

Import safety warning	01
Definition of symbols.....	02
Battery precaution.....	02
Storage, disposal and recycle	03
Part list	04
Product Information	04
How to drive the car	06
Install the batteries.....	06
Start the engine.....	06
Happy mode and Monster mode....	06
Steering trim.....	07
Binding instructions.....	08
Operation precaution	09
Trouble shooting	10
Regulatory Notices	11

MODEL:P-201

Important Safety Warnings

⚠ WARNING:

Before running your car, look over this entire manual and examine the car carefully. If for some reason you decide it is not what you wanted, then do not continue any further. Your toy dealer absolutely cannot accept a car for return or exchange after it has been run.

Failure to observe the following warnings may result in harm either to you or damage to Bravo Monster and its associated products (collectively the “Bravo Monster Products”) and will void the below warranty on Bravo Monster Products. Please note that additional information is provided on www.beijingdynamics.com and it is your sole responsibility to review all important information before using Bravo Monster Products. Your purchase and use of Bravo Monster Products imply that you have read and accepted the terms and conditions both stated in this document and available online at www.beijingdynamics.com

01

Definition of symbols

Throughout this manual, you’ll notice warning, cautions and helpful hints identified by icons below. Be sure to read them. The following defines the symbols used in this manual.

WARNING: CHOKING HAZARD
Small parts. Not for children under 3 yrs.



⚠ BATTERY PRECAUTION

- Do not mix used and new batteries.
- Do not mix different types of batteries: alkaline, standard(carbon-zinc) or rechargeable (nickel-metal hydride)
- Do not dispose of batteries in a fire.
- Only batteries of the same or equivalent type as recommended are to be used.
- Batteries are to be inserted with the correct polarity.
- Exhausted batteries are to be removed from the product.
- Never short circuit the battery terminals. Remove batteries during long periods of non-use.
- To prevent electric shock, do not immerse in water.

02

STORAGE, DISPOSAL AND RECYCLING:

When you are through running your car for the day, always disconnect and remove batteries from your car whenever the car is stored. If your car will be stored for a long time, then also remove the batteries from controller.

Please kindly be aware that it is the consumer’s responsibility to properly dispose and recycle Bravo Monster and accompanying components. Do not dispose of Bravo Monster with common household waste, the Bravo Monster unit is considered electronic waste and should be disposed of at your local electronic equipment collection facility. For more information, please contact your local electronic equipment waste management authority or the retailer where you bought the product. If improperly disposed, batteries may short, causing them to become hot, burst or ignite.

03

PARTS LIST

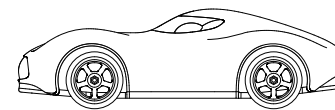

Car



Remote controller

Required equipment (not included, you need to purchase them separately to operate and maintain your car):

- Screwdriver
- 4 AAA alkaline batteries for car
- 2 AAA alkaline batteries for controller

Product Information

Product: NURBURGRING- Passion red; MONTE CARLO-Ocean blue

Radio system: 2.4GHz FHSS

MODEL:P-201

Ages: 8 years old +

Size of car: 174mmx84mmx52mm

Size of package:285mmx130mmx90mm

Run time: A large factor affecting run time is the type and condition of your batteries. With alkaline batteries car could run continuously at 80~100 minutes with happy mode, or 50~90 minutes with rechargeable batteries (nickel-metal hydride). Another major factor that affects run time is how the car is driven: HAPPY mode or MONSTER mode.

04

Car

Power switch

When slide it to “ON” the power is turned on.

LED Light

It blinks at low battery.

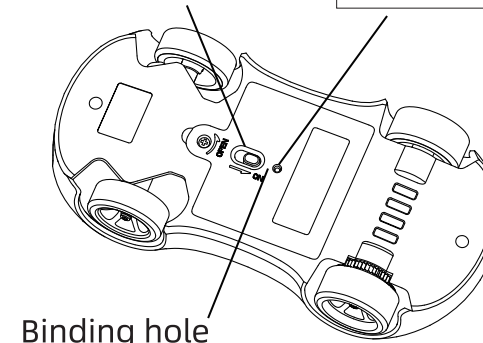

Binding hole

The controller and car must be electronically “bound” through the hole. This has been done for you at the factory. You can get more information in the page XX

Remote Controller

Throttle stick

Control the speed of the car and movement forward and backward.

Power switch

When press it, the power is turned on, press again, the power is turned off.

LED Light

It blinks at low battery.

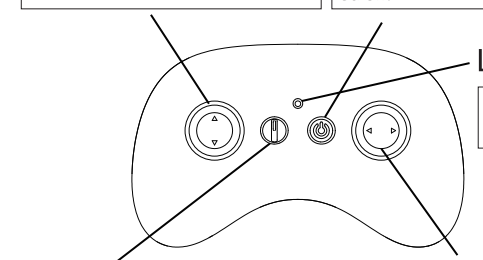

Steering trim

Adjust the steering in small increments so the car will run straight. You can get more information in the page XX

Steering stick

Turn car to left or right.

05

How to drive the car?

Install the batteries

This step should be done by adult. Use a screwdriver to remove the battery covers of car and controller, insert the batteries in the correct orientation as indicated inside the battery compartment, reinstall the battery covers. Note: You need 4 AAA alkaline batteries for your car, 2 AAA alkaline batteries for the controller. The product does not include AAA alkaline batteries.

Start the engine

Turn on the power switch of car and controller, check the status LED for a solid red light. If the status LED blinks, the batteries may be weak, discharged, replace with new or freshly charged batteries. When not using, turn off the power switch.

HAPPY mode and MONSTER mode

HAPPY mode: Turn on the power switch of controller, the LED is for a solid red light, It’s HAPPY mode now. You can drive the car with slowly or normal speed, if you are a beginner of remote control or driving the car in house,

06

HAPPY mode suits you very well. MONSTER mode: Push the “Throttle stick” to the front, at the meantime press the “power switch” on the controller, the LED is for a solid red light. It’s MONSTER mode now. you can drive your car very fast, MONSTER mode is better for skilled “driver” .

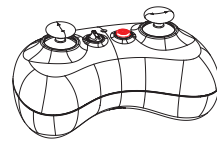

HAPPY mode

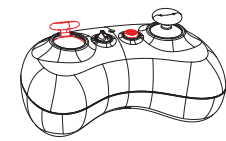

MONSTER mode

Steering trim

Look down at the car when you drive. The front wheels should be pointing straight ahead. If the wheels are tuned slightly to the left or right, slowly adjust the steering trim button on the controller until they are pointing straight ahead while the car are running.

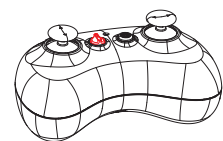

Steering trim

Binding instructions

For proper operation, the controller and car must be electronically “bound” . This has been done for you at the factory. When you ever need to re-bind or bind to additional controller or car, follow these instructions:

1. Turn on the power switch of car and controller, check the status LED for a solid red light. Make sure that only the controller you want to bind is powered on, all your other controllers must be turned off.

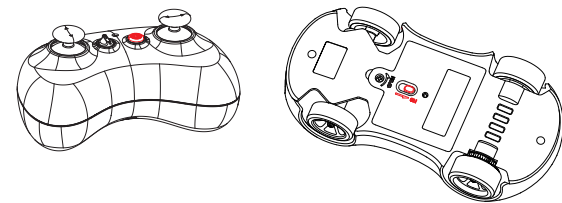

2. Remove the battery cover of car.

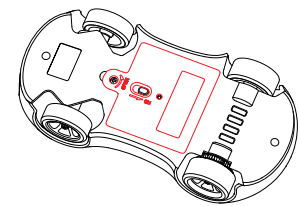

3. Use a small stick (diameter about 1~2.0 mm) to press the binding key through the hole.

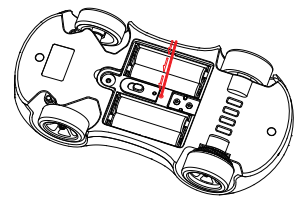

4. Press the controller’s throttle stick, the car has response. The system is bound and ready for use.

OPERATION PRECAUTION

Now it’s time to have some fun! This section contains instructions on driving and make adjustments to your car. Before you go on, here are some important precautions to keep in mind.

1. Do not continue to operate the car with low batteries or you could lose control of it. Indications of low battery power include slow operation and sluggish servos (slow to return to center), Stop immediately at the first sign of weak batteries. When the batteries become weak, the red power light will begin to blink, stop immediately and install new batteries.

2. Do not drive the car at night, on public streets, or in large crowds of people.
 3. If the car becomes stuck against an object, do not continue to run the car. Remove the obstruction before continuing.
 4. When using “Monster mode” - top. Speed running, limit your driving to paved surfaces only.
 5. Because the car is controlled by radio, it’s subject to radio interference from many sources beyond your control. Since radio interference can cause momentary losses of control, allow a safety margin of space in all directions around the car in order to prevent collisions.

Troubleshooting

Symptom	Cause	Solution
Car will not pair with the controller		
If the status LED blinks of car and controller	Car in the vehicle or controller are low on power	Replace low batteries with new alkaline batteries or freshly charged batteries nickel-metal hydride
If the car doesn't go forward, or backward		

Regulatory Notices

FCC Statement:

This device complies with Part 15 of the FCC Rules.

Operation is subject to the following two conditions:

(1) this device may not cause harmful interference, and (2) this device must accept any interference received, including interference that may cause undesired operation.

INFORMATION TO USER:

This equipment has been tested and found to comply with the limits for a Class B digital device, pursuant to Part 15 of the FCC Rules. These limits are designed to provide reasonable protection against harmful interference in a residential installation. This equipment generates, uses and can radiate radio frequency energy and, if not installed and used in accordance with the instructions, may cause harmful interference to radio communications. However, there is no guarantee that interference will not occur in a particular installation.

If this equipment does cause harmful interference to radio or television reception, which can be determined by turning the equipment off and on, the user is encouraged to try to correct the interference by one or more of the following measures:

- Reorient or relocate the receiving antenna.
- Increase the separation between the equipment and receiver.
- Connect the equipment into an outlet on a circuit different from that to which the receiver is connected.
- Consult the dealer or an experienced radio/TV technician for help..

Warning

Changes or modifications not expressly approved by the party responsible for compliance could void the user’s authority to operate the equipment.



FCC ID: 2AZV7-P201

Bravo Monster Super RC Car P-201 @2017 Beijing Dynamics. All Rights Reserved. Beijing Dynamics Technology Co., Ltd.
 Beijing Dynamics Technology Co., Ltd.
 Internet: www.beijingdynamics.com
 Email: info@beijingdynamics.com



Bravo Monster