

8+

S2 Double Jet Pump Boat

USER MANUAL



Multi-terrain driving, no fear of any obstacles.
No exposed propeller, more safer.

SAFETY PRECAUTIONS

1. This product is suitable for people aged 14 and over. People under the age of 14 need to be accompanied by an adult to use the product.
2. The battery can not be recharged until it has cooled.
3. The boat can't sail when there are people in the water.
4. This product contains small parts, please do not swallow, so as not to cause suffocation.
5. Check the product regularly for damage. If there is any damage, please stop using it until it is repaired.
6. If the ship is out of Control, please find a way to retrieve the ship while ensuring your own personal safety.

MAINTENANCE

1. If the boat is not being used, remove the battery.
2. If the transmitter will not be used for a long time, make sure to remove the battery.
3. The surface of the boat should be protected from prolonged exposure to the sun to prevent paint peeling. When the boat is finished, it should be wiped down with a dry cloth.
4. When boat is finished, the water in the cabin should be drained with a dry cloth and a desiccant should be put in to ensure that the cabin remains dry.

BOX CONTENTS

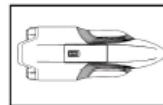

BOAT



Transmitter

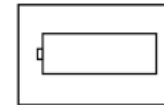

Battery

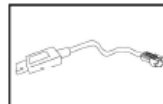

USB charger

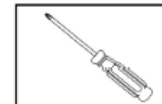

Screwdriver



User manual

PRODUCT OVERVIEW

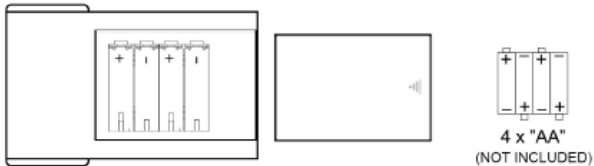
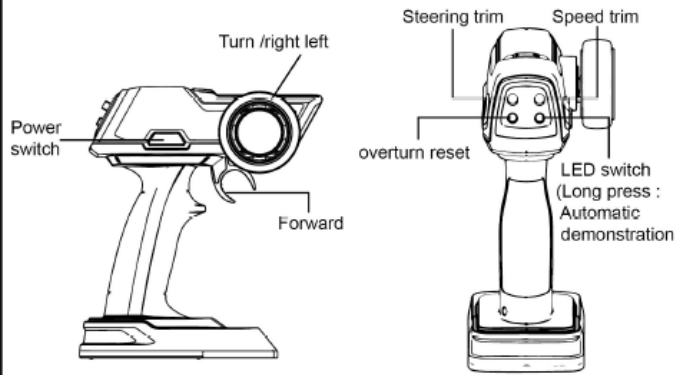
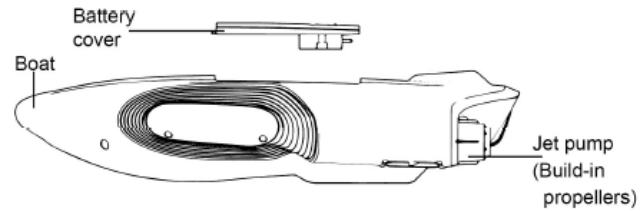

Unscrew and open the battery cover. Insert 4 AA batteries in the correct direction. Close the battery cover and lock it. If the transmitter will not be used for a long time, make sure to turn it off and remove the batteries.

BATTERY CHARGING

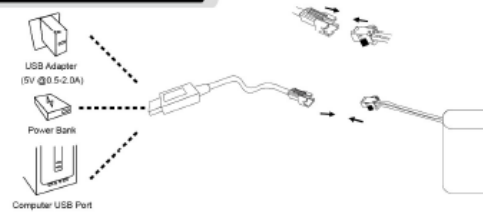

1. Plug the USB charging cable into the USB charging port of the computer, power bank or USB adapter (5V@ 0.5-2.0A)
2. Connect the battery wire to the USB charging cable.
3. Charging time: about 120-150 minutes.
4. The red indicator light on the USB charging cable will turn on when it is charging and will turn off once fully charged.

1. Install the battery with the correct polarity.
2. Don't mix old and new batteries.
3. Don't mix batteries.
4. DO NOT charge batteries that can not be charged
5. Rechargeable batteries must be charged under adult supervision.
6. The power terminal must not be short circuited.
7. DO NOT connect more power than recommended.
8. USB cable can only be used with the manufacturer to recharge the supply, USB is not the model.
9. Remove discharged batteries from toys.

BATTERY INSTALL

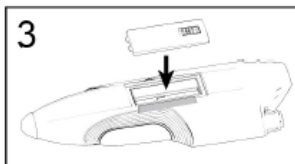
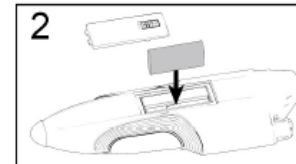
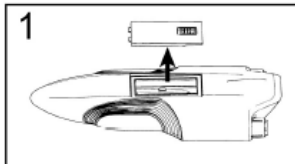

1. Open the battery cover.
2. Place the battery in the battery compartment in the correct direction.
3. Close the battery cover.

READY TO SAIL

1. After the batteries are installed, open the power switch on the boat (the lights on boat flickered).
2. Open the controller (the green light flickered).
3. The light on the boat and the green light on the controller will turn on solid once pairing has been successful.

CONTROLS

1. Forward

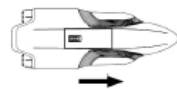

Push the throttle backward, the boat goes forward.

2. Turn left

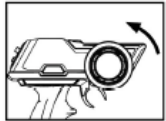

Push the steering wheel to the left when the boat is moving, the boat will turn left

3. Turn right



Push the steering wheel to the right when the boat is moving, the boat will turn right

4. Steering trim

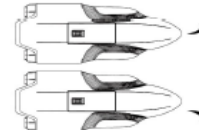
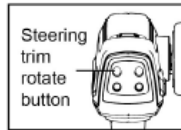

When you find that the ship cannot driving in a straight line when it moving forward, you can control it by steering trim rotate button to make the left and right.

5. Overturn reset



6. Speed Trim

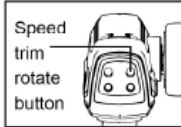

You can change the speed by the rotate button.

7. Drainage function

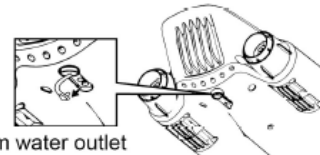

Pull out the bottom water outlet

LOW BATTERY INDICATION

When the battery is nearly run out, the lights on the boat will flash and the controller will make a "dididi" sound. Please drive the ship back to you quickly.

(When the controller sound "dididi", it means the battery will completely dead in 90 seconds.)

FCC Statement

This equipment has been tested and found to comply with the limits for a Class B digital device, pursuant to part 15 of the FCC Rules. These limits are designed to provide reasonable protection against harmful interference in a residential installation. This equipment generates, uses and can radiate radio frequency energy and, if not installed and used in accordance with the instructions, may cause harmful interference to radio communications. However, there is no guarantee that interference will not occur in a particular installation. If this equipment does cause harmful interference to radio or television reception, which can be determined by turning the equipment off and on, the user is encouraged to try to correct the interference by one or more of the following measures:

- Reorient or relocate the receiving antenna.
- Increase the separation between the equipment and receiver.
- Connect the equipment into an outlet on a circuit different from that to which the receiver is connected.
- Consult the dealer or an experienced radio/TV technician for help.

Caution: Any changes or modifications to this device not explicitly approved by manufacturer could void your authority to operate this equipment.

This device complies with part 15 of the FCC Rules. Operation is subject to the following two conditions: (1) This device may not cause harmful interference, and (2) this device must accept any interference received, including interference that may cause undesired operation.

RF Exposure Information

The device has been evaluated to meet general RF exposure requirement. The device can be used in portable exposure condition without restriction.