

M28 M46

炫彩灯光四轴

使用说明书

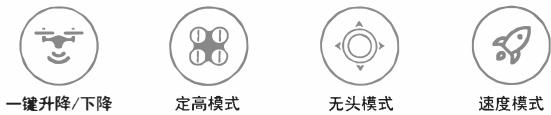

1. 请将飞行器较小零部件放置于小孩不能触及的地方，避免发生意外。
2. 本飞行器动力十足，首次飞翔时应慢慢推高遥控器左手变速操纵杆，避免飞行器急速上升而导致碰撞损坏。
3. 飞行结束后，应先关闭遥控器电源，再走近飞行器关闭飞行器电源。
4. 切勿将电池放在高温、受热的地方（如火中或电热装置附近）。
5. 注意飞行器飞行时与使用者或其他人保持2-3米的距离，避免飞行器飞行降落时撞向他人的头部、脸部或身体等。
6. 儿童操控飞行器时应由成年人在旁指导并确保飞行器控制在操纵者（或指导者）的视线范围内，方便控制。
7. 非充电电池不可充电，安装或更换电池时请注意极性：不可混用新旧或不同类型的电池。
8. 不使用时应关闭遥控器及飞行器电源，并取出遥控器内的电池。
9. 超过10天不使用电池时，请将电池放至40%-50%电量存放（即充满电后飞行至总飞行时间的一半），可延长电池的使用寿命。

1. 常用干净软布清洁此产品。
2. 避免此产品在阳光下暴晒或受热。
3. 切勿将此玩具浸在水中，否则会令电子零件受损。
4. 定期检查插头及其它配件，如发现任何损坏，请马上停止使用，直到完全修复。

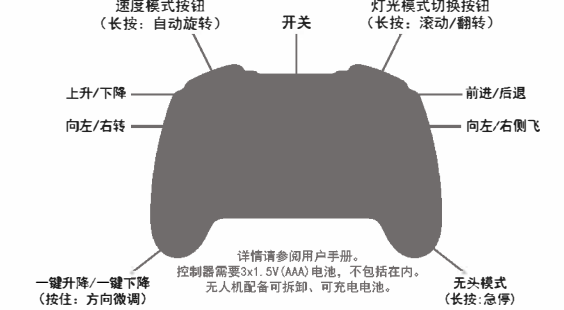
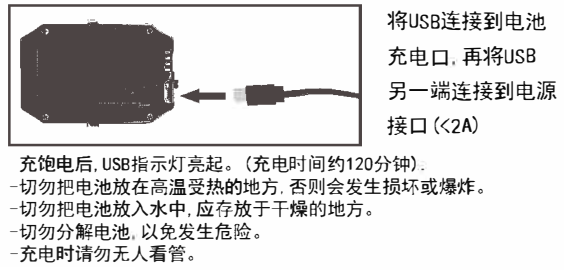
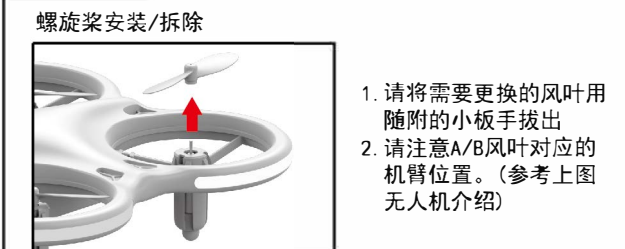
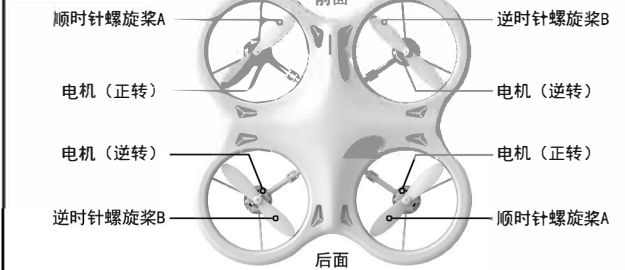

- 一、一键起飞/下降
将无人机放在平坦的平面上，按“一键起飞/下降”（如图）无人机螺旋桨开始旋转，将左摇杆向上推，无人机将向上飞行。
- 二、同按键 飞机在高空时将缓慢降落。
- 三、高度保持
无人机可保持在一定高度上操控，更加适合初学者。
- 四、灯光切换
按“灯光切换”模式切换不同灯光效果。
- 五、低电量提醒
当电池电量不足时，在飞行时无人机电灯闪烁，遥控器发出“滴滴”提醒。这时您有30秒左右的时间让无人机着陆。
- 六、360° 翻滚和旋转
注意：请在2米高度以上的宽敞的空域进行翻滚。当电池饱电时，翻滚效果最佳，低电状态下不适合操作翻滚。

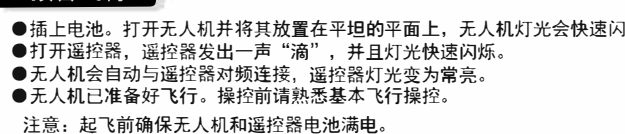

问题	原因	解决方案
连接电池后，无人机的LED指示灯持续闪烁，发射机没有响应。	遥控器和无人机没有配对。	参考第8页再次配对。
无人机没有反应。	1. 无人机或遥控器已关闭。 2. 无人机或遥控器的电池没电了。 3. 电池没有正确插入。	1. 打开遥控器和无人机，并确保电池插入正确。 2. 充电电池，使用充满电的电池。 3. 重新插入电池，确保连接正确。
电机对油门杆没有反应，无人机的LED指示灯闪烁。	无人机电池电量过低。	请给电池充电或更换电池。
机翼不转动。	机翼离电机太近。	将机翼向上拉，使其不会离电机太近。
机翼旋转，但无人机不起飞。	1. 机翼损坏。 2. 无人机电池电量过低。	1. 更换损坏的机翼。 2. 请给电池充电或更换电池。
无人机在飞行过程中会摇晃或倾斜。	机翼损坏。	机翼损坏。
微调后无人机继续旋转或左右偏航速度不一致。	1. 机翼损坏。 2. 电机损坏。	1. 更换损坏的机翼。 2. 更换损坏的电机。
无人机一直朝一个方向漂移。	陀螺仪没有正确校准。	将无人机打开后进行微调(第9页)。

M28 M46

Remote control drone

USER MANUAL

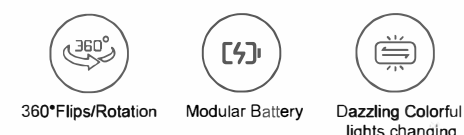

- This product is not a toy and suitable for experienced RC drone operators aged 14 years and older. It contains small parts, and should be kept out of reach of small children.
1. The flying zone must be legally approved by your local government.
 2. Keep your drone away from heat and prolonged exposure to direct sunlight to avoid damage.
 3. Avoid moisture. Humidity and water can damage your drone, which in turn may cause accidents.
 4. Please be sure that all the propellers are undamaged and are installed in the correct orientation.
 5. Please operate your drone as your skill level allows. User fatigue, impairment and improper operation can cause accidents.
 6. Do not touch propellers, motors or other moving parts while your drone is on.
 7. Please don't use this product to follow any moving vehicles.
 8. Please light the drone back to you as soon as possible when the battery is running low.

1. Please clean this product with a clean dry soft cloth.
2. Keep your drone away from heat and direct sunlight to avoid damage.
3. Keep your drone away from water and damp place to avoid damage.
4. Check your drone and battery connections at regular.

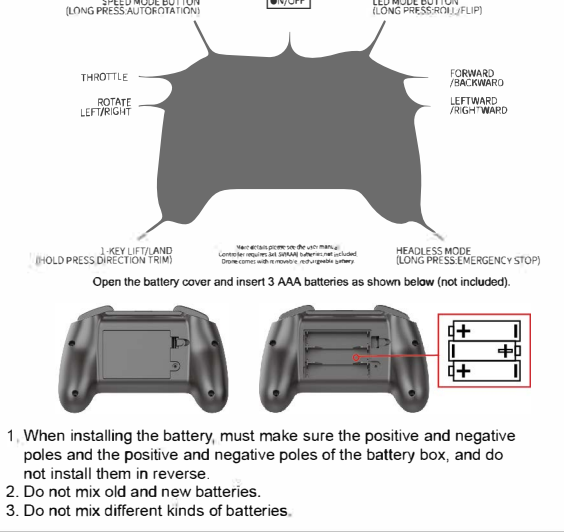
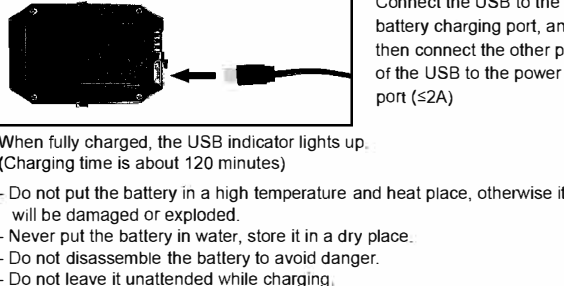
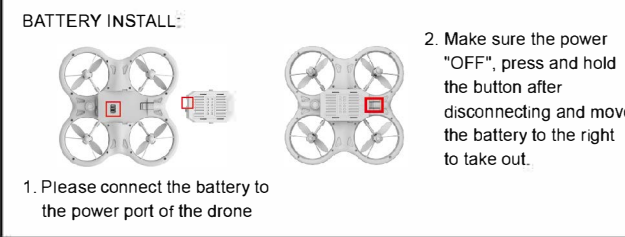
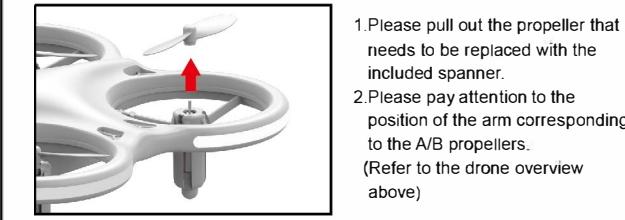
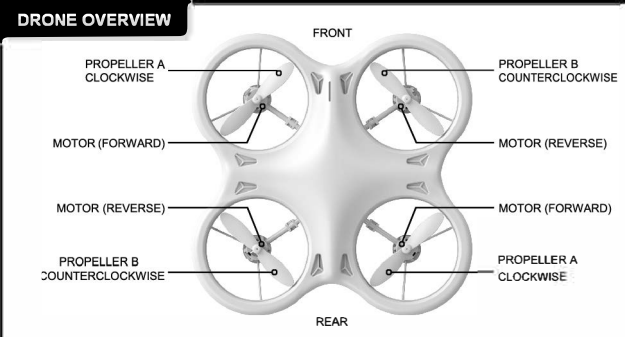
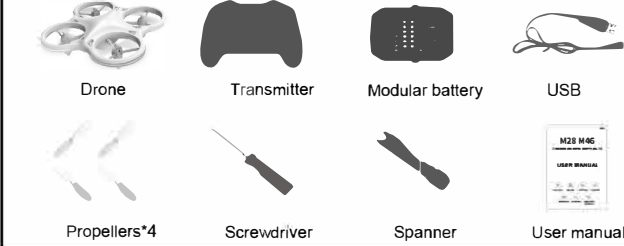

- 1-KEY LIFT/LAND
Place the drone on a flat surface, Press "1-KEY LIFT/LAND" (pictured). The propeller of the drone starts to spin. Push the left stick up and the drone will fly up.
2. With the same button, the drone will land slowly when flying.
- ALTITUDE HOLD
Push the left stick up or down to the desired height, then release the left stick to the center position. The drone will continue to fly at the current altitude, if you want to change the altitude, please repeat the above steps.
- SPEED MODE
The drone has three speed modes. Press "speed switch" (pictured). The transmitter will "di" three times to indicate in high-speed mode, two "di" are medium speed mode, one "di" is low speed mode.
- LOW BATTERY WARNING
When the battery power is low, the lights of the drone will flash during flight, and the transmitter will issue "di" reminder. At this point you only have 30 seconds so to land the drone.
- LOW BATTERY WARNING
When the battery power is low, the lights of the drone will flash during flight, and the transmitter will issue "di" reminder. At this point you only have 30 seconds so to land the drone.

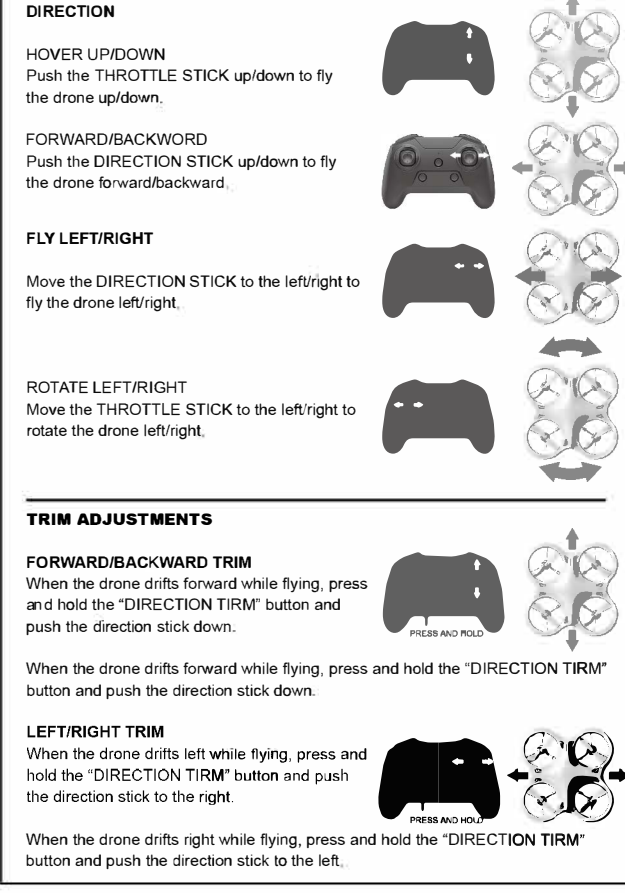
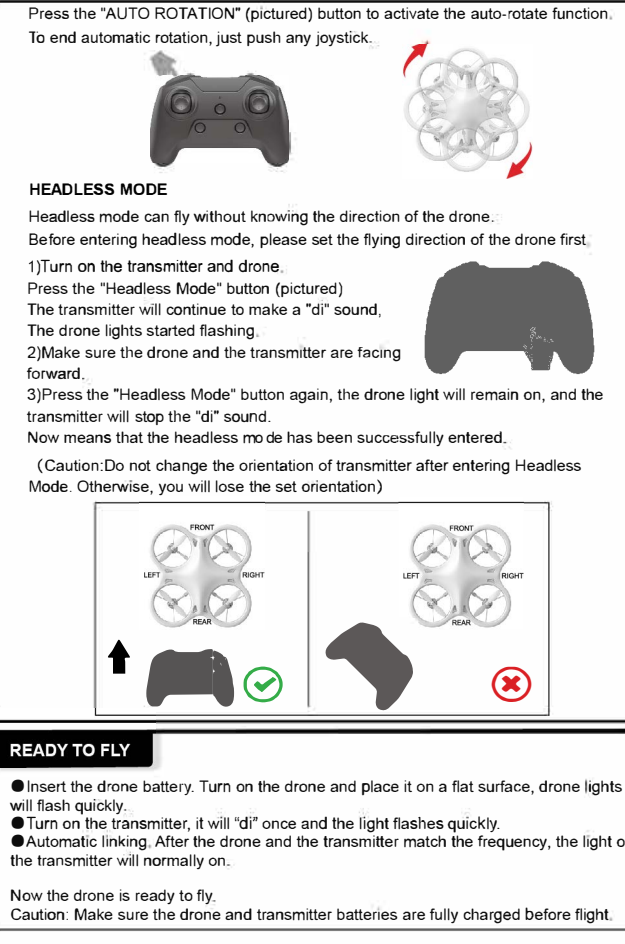

Problem	Cause	Solution
After connecting the battery, the lights of the drone continued to flash, but the transmitter did not respond.	The transmitter and drone are not paired.	Refer to pg.8 to pair again
The drone is not responding.	1. The drone/transmitter are switched off. 2. The batteries in the drone/transmitter are dead. The batteries are not inserted properly.	1. Turn on the transmitter and drone, and make sure that the battery is inserted properly. 2. Charge the batteries. Insert the battery again and ensure that connected properly.
The motor does not respond and the lights on the drone flashes.	The drone battery is too low.	Charge the battery or replace it with a fully charged battery.
The propellers do not turn.	The propeller is too close to the motor.	Pull the propeller upwards so that it is not too close to the motor.
The propellers spin but the drone does not take off.	1. The propellers are damaged. The drone battery is too low.	1. Replace the damaged propeller(s). Charge the battery or replace it with a fully charged battery.
The drone shakes or tilts sideways during flight.	The propellers are damaged.	The propellers are damaged.
The drone continues to spin after making trim adjustments or the left/right yaw speed is not consistent.	1. The propellers re damaged. The motor is damaged.	1. Replace the damaged propeller(s). Replace the damaged motor(s).
The drone keeps drifting in one direction.	The gyroscope is not calibrated properly.	Make trim adjustments to the drone after turning it on (pg.9).

FCC Warning

This device complies with part 15 of the FCC rules. Operation is subject to the following two conditions: (1) this device may not cause harmful interference, and (2) this device must accept any inte rference received, including interference that may cause undesired operation.

Changes or modifications not expressly approved by the party responsible for compliance could void the user’s authority to operate the equipment.

NOTE: This equipment has been tested and found to comply with the limits for a Class B digital device, pursuant to part 15 of the FCC Rules. These limits are designed to provide reasonable protection against harmful interference in a residential installation. This equipment generates uses and can radiate radio frequency energy and, if not installed and used in accordance with the instructions, may cause harmful interference to radio communications. However, there is no guarantee that interference will not occur in a particular installation. If this equipment does cause harmful interferenceto radio or television reception, which can be determined by turning the equipment off and on, the user is encouraged to try to correct the interference by one or more of the following measures:

- Reorient or relocate the receiving antenna.
- Increase the separation between the equipment and receiver.
- Connect the equipment into an outlet on a circuit different from that to which the receiver is connected.
- Consult the dealer or an experienced radio/TV technician for help.