

**kollegend**

# Dump truck

NO.K-203

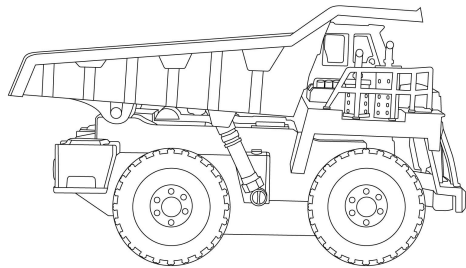

kollegend-US@outlook.com

Please read this manual before use and keep it properly for future reference and maintenance

## Operation methods

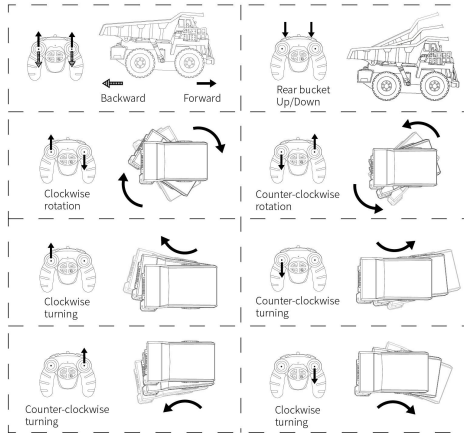

## Remote control button instructions and battery installation methods

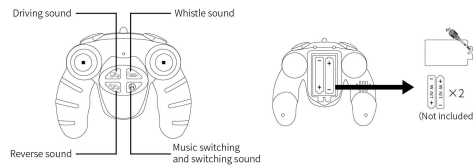

## Battery installation and charging instructions :

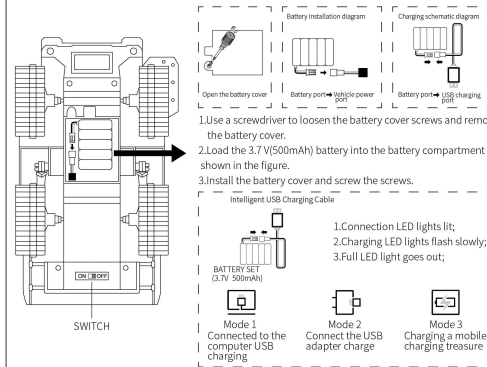

## Precautions before Battery Use

- There are certain risks in the use of batteries, which may cause enormous personal and property losses. Users shall assume all relevant liabilities on their own. Manufacturers and dealers will not control the use of batteries (charging, discharging and storage, etc.) or take responsibility for the losses incurred to people and property.
- If any battery leaks, please avoid liquid contact with skin and eyes. In the event that the liquid contacts with skin, please wash your skin immediately with soap and water. In case of liquid contact with eyes, please rinse your eyes immediately with large amounts of cold water and seek medical advice at once.
- If there is a suspicious odor, noise or smoke from the charger, remove the power supply at once.
- Please strictly comply with the following requirements, otherwise it will result in fire, electric shock or explosion.
- The product uses 3.7 V(500mAh) rechargeable battery pack and 1.5 V "AA" non-rechargeable battery.
- The battery should be taken out and loaded according to the polarity and voltage marks on the battery box for correct operation. The battery should not be short-circuited.
- Non-rechargeable batteries cannot be charged, and different types of batteries or new and old batteries cannot be mixed.
- The rechargeable battery should be charged under the supervision of an adult. Before charging, the rechargeable battery should be removed from the toy car.
- Only batteries that are the same as or equivalent to the recommended batteries can be used.
- Exhausted batteries should be removed from the product. If not used, please remove the battery.
- Power terminal must not be short-circuited. Do not connect to more than the recommended number of power supplies. Be cautious about short circuit. Avoid direct contact with electrolytic substances in batteries.
- Do not overcharge the batteries. When the batteries are fully charged, please unplug the charger.

- After charging is over, please do not recharge the batteries so as to avoid overheating.
- Do not charge the batteries near flammable materials or on the surface of flammable (Carpet, wooden floor, solid wood furniture, etc.) or conductive objects, and observe the batteries at any time.
  - Do not charge the batteries immediately while they are still hot after use.
  - The temperature of the batteries should be between 0°C and 40°C.
  - Please unplug the charger when the batteries are not being charged.
  - It is strictly forbidden to pack damaged batteries with plastics.
  - Do not insert or remove the batteries when the product is in use.
  - Do not expose the batteries to excessive physical impact.
  - It is strictly forbidden to use expanded, leaked or broken batteries or those emitting peculiar smell.
  - Children are forbidden from touching the batteries.
  - Do not put the batteries in the fire to avoid contact between the batteries and liquid. It is strictly forbidden to get the product wet in the rain or place it in a damp place. Do not place the product near the accessories of heating source.
  - Do not put the batteries in a microwave oven or a pressure tank.
  - Do not disassemble, drill, deform or cut the batteries. It is strictly forbidden to carry heavy objects on batteries or chargers or knock the batteries.
  - Do not clean the charger with solvents, industrial alcohol or other flammable solvents.
  - Be cautious about short circuit. Avoid direct contact with electrolytic substances in batteries. Electrolytic substances and electrolytic steams are harmful to the body.
  - Store the product in a greenhouse. Do not expose the product to extreme temperatures.
  - Avoid substantial changes in the temperature of the place where the product is stored.

## Use and Storage

- This product is not suitable for children under 8 years old. Please use it under the supervision of adults. All products need to pay attention to and prevent electric shock when using. Please read this instruction carefully before operating this product.
- Please don't touch the four wheels of the car to avoid breaking.
- When the power of the remote control car or the remote controller is insufficient, it will affect the remote control distance and make it difficult for the car to travel distance or climb a hill. Please don't let the remote control car fall or collide from a height, so as not to damage the car or shorten its service life. Please don't play in dangerous places such as roadside puddles and mud, so as to avoid danger.
- Please gently use a damp cloth to vehicle.
- Do not place this product in high temperature and direct sunlight.
- Do not place this product in water to avoid damage to its electronic components.
- Once the products are sold, we will not bear the safety responsibility arising from improper operation or storage.
- Do not treat the product as daily garbage. Damaged or unusable batteries should be placed in special containers for designated purposes. The product is made up of electronic components and batteries. Please treat the garbage of electrical and electronic equipment in line with special requirements. Please get familiar with the centralized treatment method for garbage in local places.
- Do not treat the product as daily garbage. Damaged or unusable batteries should be placed in special containers for designated purposes.
- The product is made up of electronic components and batteries. Please treat the garbage of electrical and electronic equipment in line with special requirements.
- Please get familiar with the centralized treatment method for garbage in local places.

## Customer service

Your shopping experience is our priority. If you meet any concern or problem about this product, please feel free to contact us at

Kollegend-US@outlook.com



Follow us to join VIP Membership.

FCC Caution:

This device complies with part 15 of the FCC Rules. Operation is subject to the following two conditions: (1) this device may not cause harmful interference, and (2) this device must accept any interference received, including interference that may cause undesired operation.

Any changes or modifications not expressly approved by the party responsible for compliance could void the user's authority to operate the equipment.

NOTE: This equipment has been tested and found to comply with the limits for a Class B digital device, pursuant to Part 15 of the FCC Rules. These limits are designed to provide reasonable protection against harmful interference in a residential installation. This equipment generates, uses and can radiate radio frequency energy and, if not installed and used in accordance with the instructions, may cause harmful interference to radio communications. However, there is no guarantee that interference will not occur in a particular installation.

If this equipment does cause harmful interference to radio or television reception, which can be determined by turning the equipment off and on, the user is encouraged to try to correct the interference by one or more of the following measures:

- Reorient or relocate the receiving antenna.
- Increase the separation between the equipment and receiver.
- Connect the equipment into an outlet on a circuit different from that to which the receiver is connected.
- Consult the dealer or an experienced radio/TV technician for help.

To maintain compliance with FCC's RF Exposure guidelines, This equipment should be installed and operated with minimum distance between 0cm the radiator your body: Use only the supplied antenna.