



Instruction Manual

For proper operation of the car, please read this manual carefully and keep it for future reference.

Product parameters

Basic Version Fx	Bluetooth speaker version Fx	Camera Version Fx	Bluetooth Camera Version Fx
Remote Transmission Frequency	2.4G	2.4G	Bluetooth Camera Version Fx
Bluetooth Frequency	2.4G		
Functions	Forward/Backward Turn Left/Right Fast/Slow speed switch	Forward/Backward Turn Left/Right Fast/Slow speed switch Photo/Video mode switch	Forward/Backward Turn Left/Right Fast/Slow speed switch Photo/Video mode switch Camera zoom in/out
Remote Control Distance	about 20m	about 20m	about 20m
operation time	about 25min	about 25min	about 25min
Recharge Time (Full Charge)	about 3-4 Hours	about 3-4 Hours	about 2-3 Hours
Charging Voltage	5V	5V	5V
Charging Time	about 90-120mins	about 90-120mins	about 90-120mins

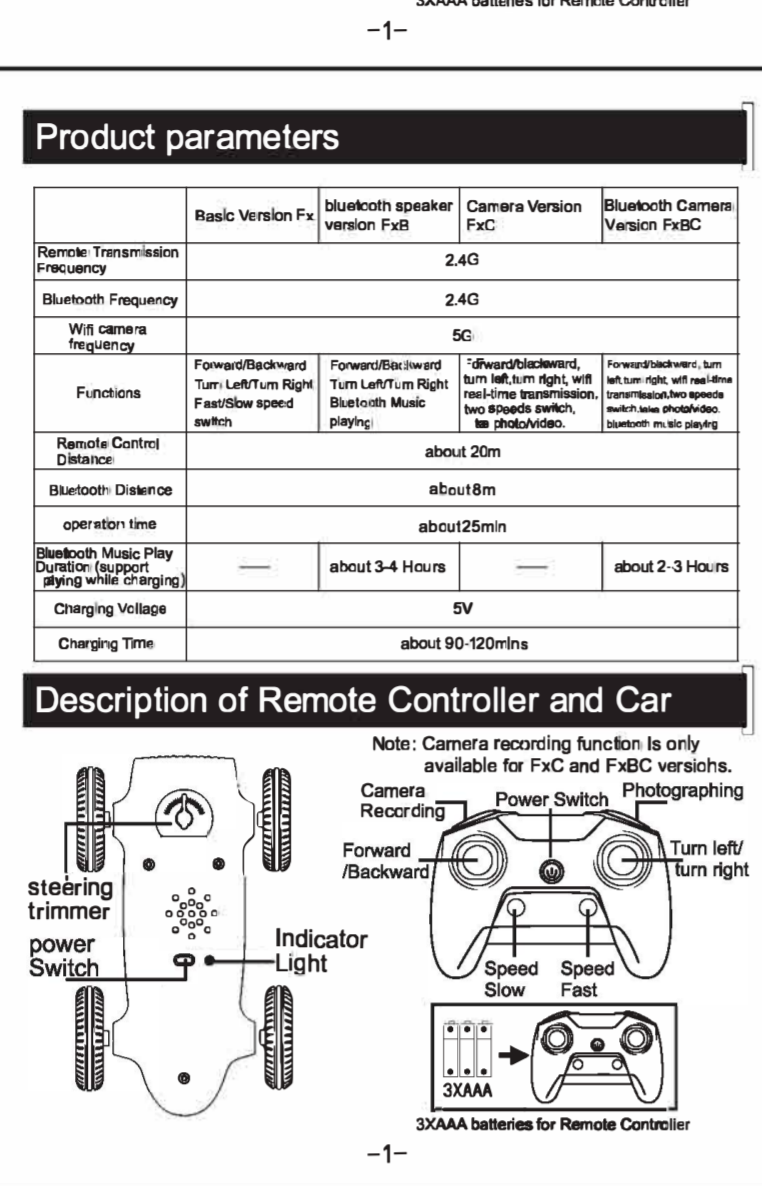

For proper operation of the car, please read this manual carefully and keep it for future reference.

Product parameters

Basic Version Fx	Bluetooth speaker version Fx	Camera Version Fx	Bluetooth Camera Version Fx
Remote Transmission Frequency	2.4G	2.4G	Bluetooth Camera Version Fx
Bluetooth Frequency	2.4G		
Functions	Forward/Backward Turn Left/Right Fast/Slow speed switch	Forward/Backward Turn Left/Right Fast/Slow speed switch Photo/Video mode switch	Forward/Backward Turn Left/Right Fast/Slow speed switch Photo/Video mode switch Camera zoom in/out
Remote Control Distance	about 20m	about 20m	about 20m
operation time	about 25min	about 25min	about 25min
Recharge Time (Full Charge)	about 3-4 Hours	about 3-4 Hours	about 2-3 Hours
Charging Voltage	5V	5V	5V
Charging Time	about 90-120mins	about 90-120mins	about 90-120mins

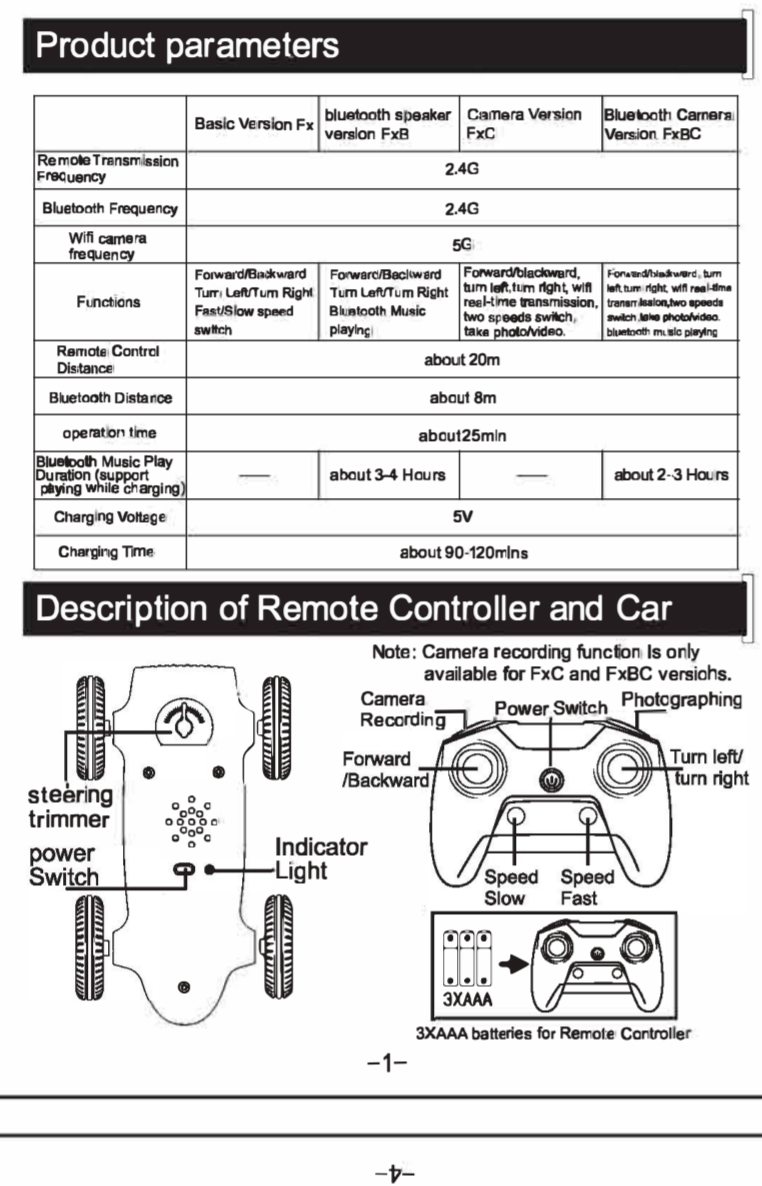

For proper operation of the car, please read this manual carefully and keep it for future reference.

Product parameters

Basic Version Fx	Bluetooth speaker version Fx	Camera Version Fx	Bluetooth Camera Version Fx
Remote Transmission Frequency	2.4G	2.4G	Bluetooth Camera Version Fx
Bluetooth Frequency	2.4G		
Functions	Forward/Backward Turn Left/Right Fast/Slow speed switch	Forward/Backward Turn Left/Right Fast/Slow speed switch Photo/Video mode switch	Forward/Backward Turn Left/Right Fast/Slow speed switch Photo/Video mode switch Camera zoom in/out
Remote Control Distance	about 20m	about 20m	about 20m
operation time	about 25min	about 25min	about 25min
Recharge Time (Full Charge)	about 3-4 Hours	about 3-4 Hours	about 2-3 Hours
Charging Voltage	5V	5V	5V
Charging Time	about 90-120mins	about 90-120mins	about 90-120mins

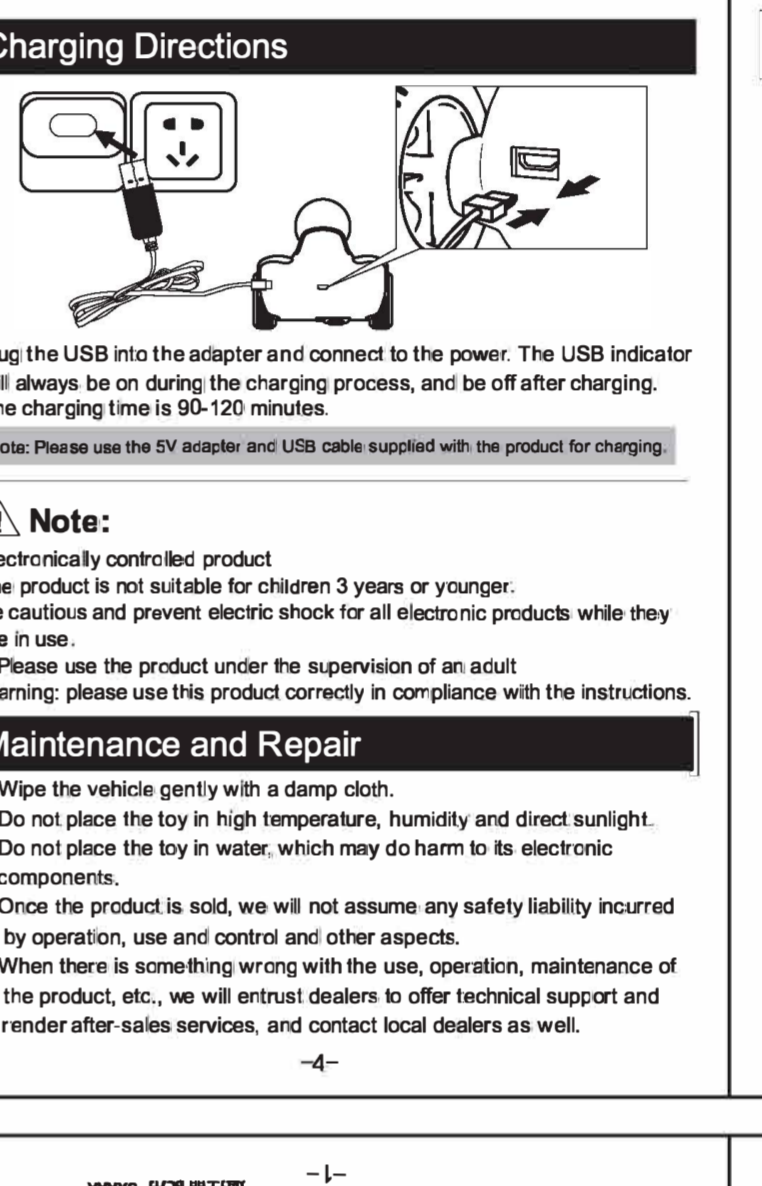
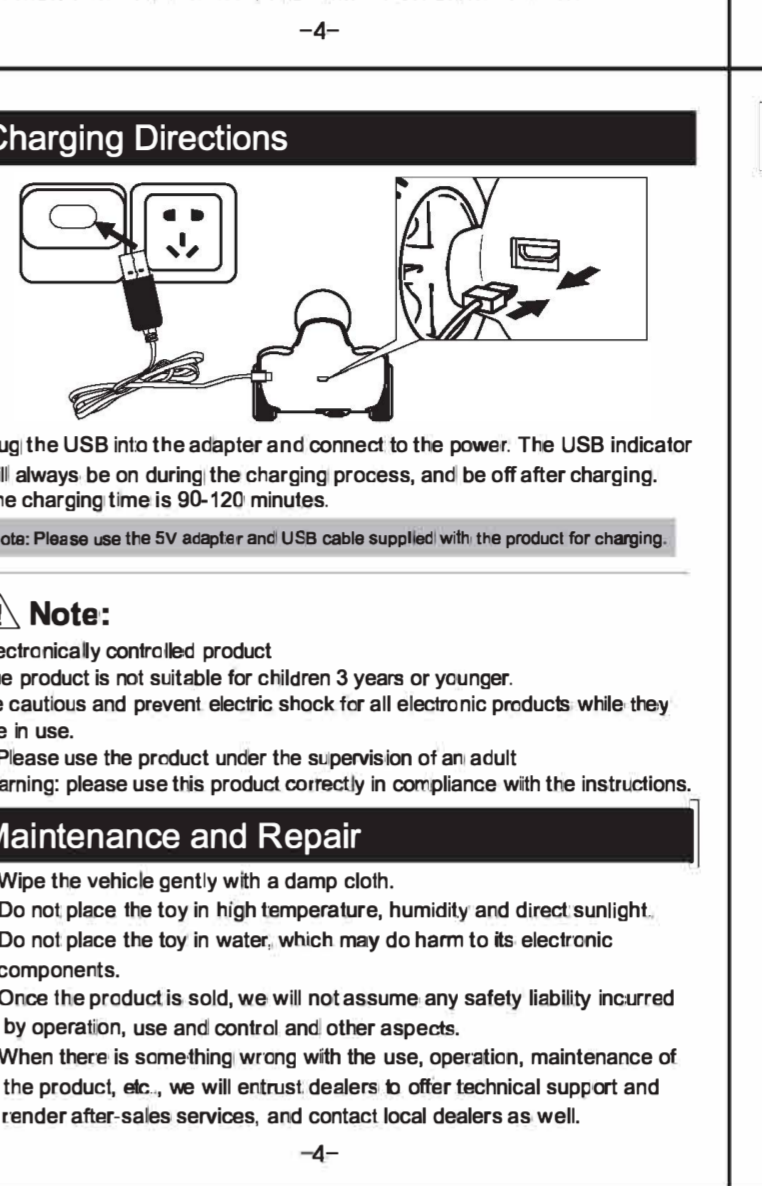
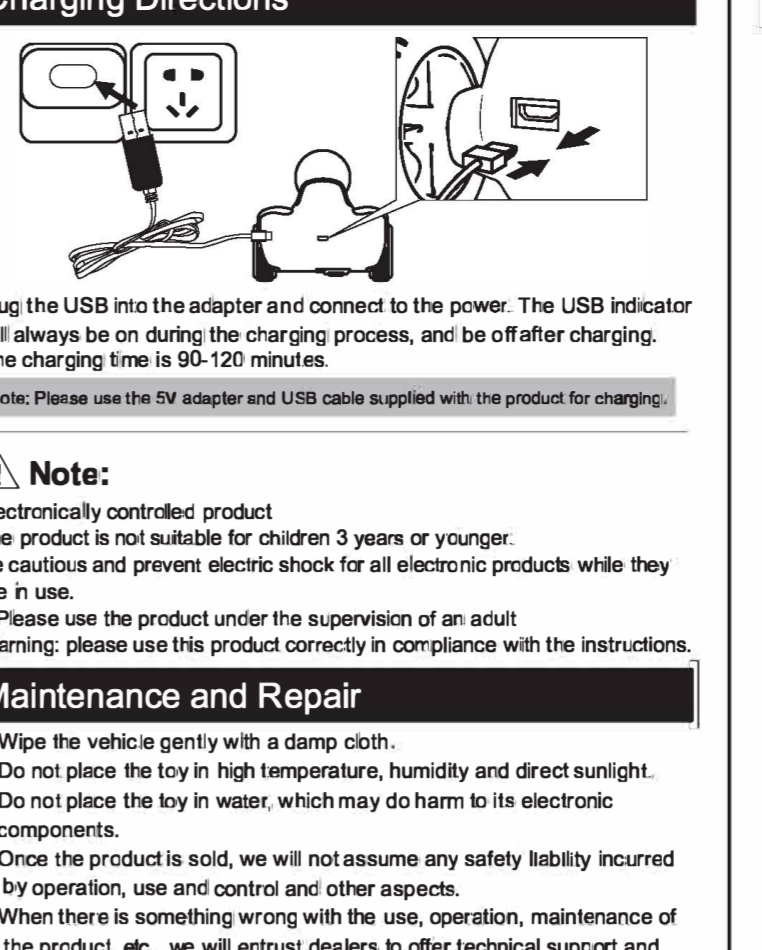
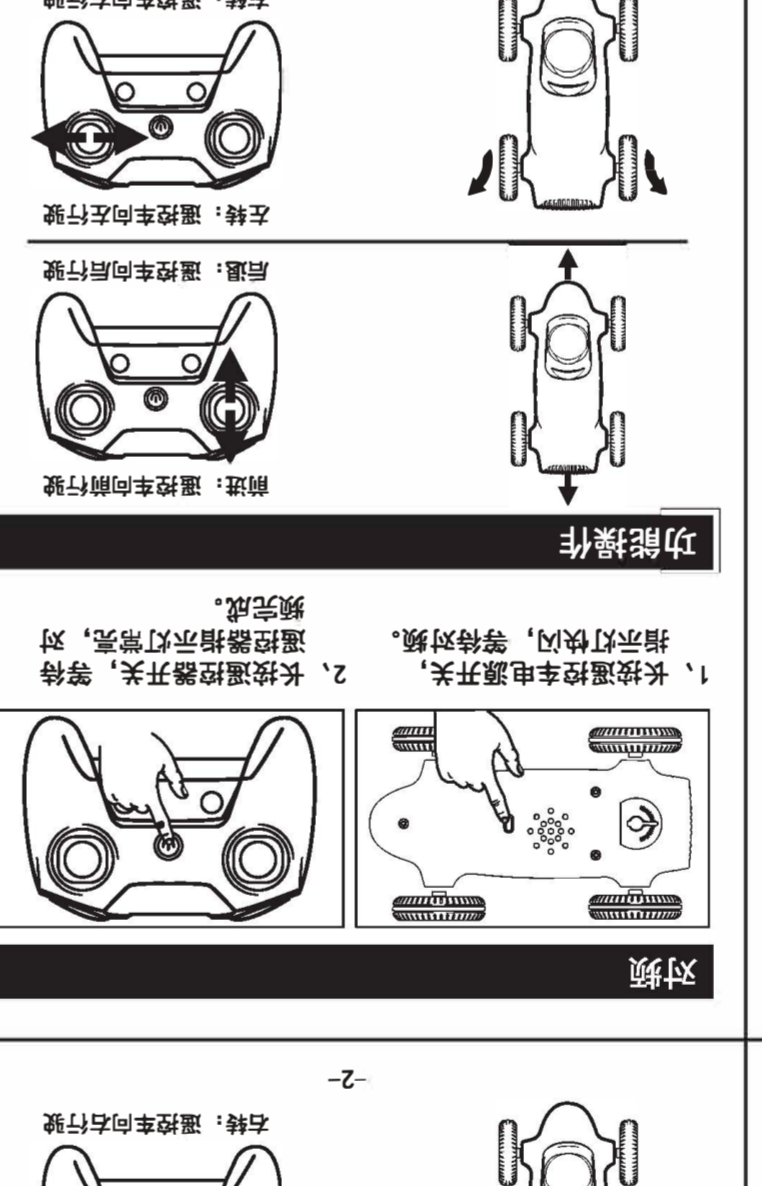
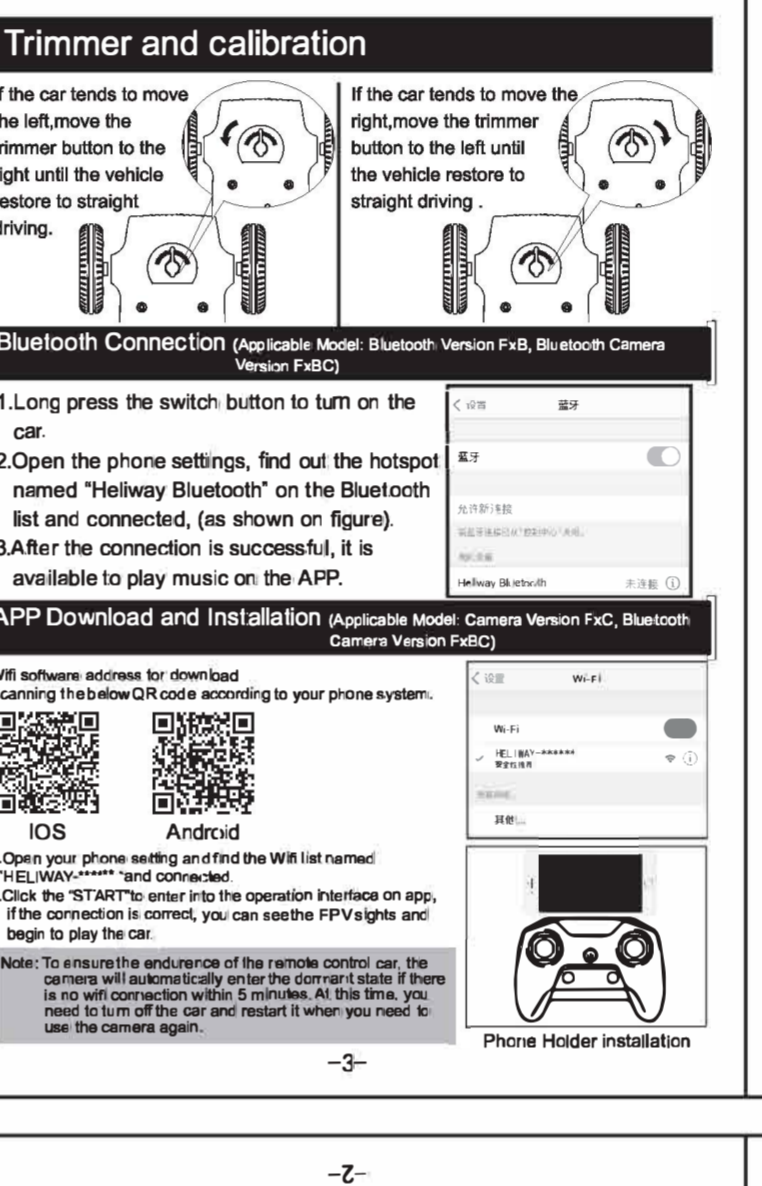
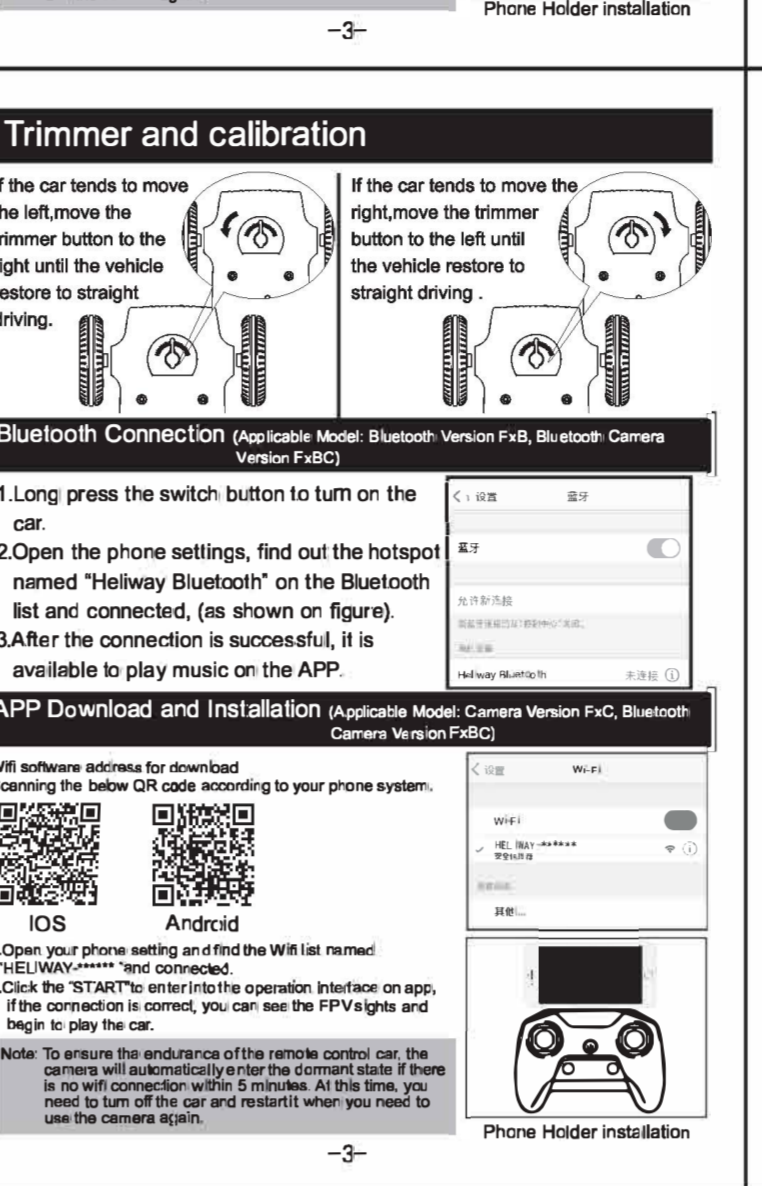
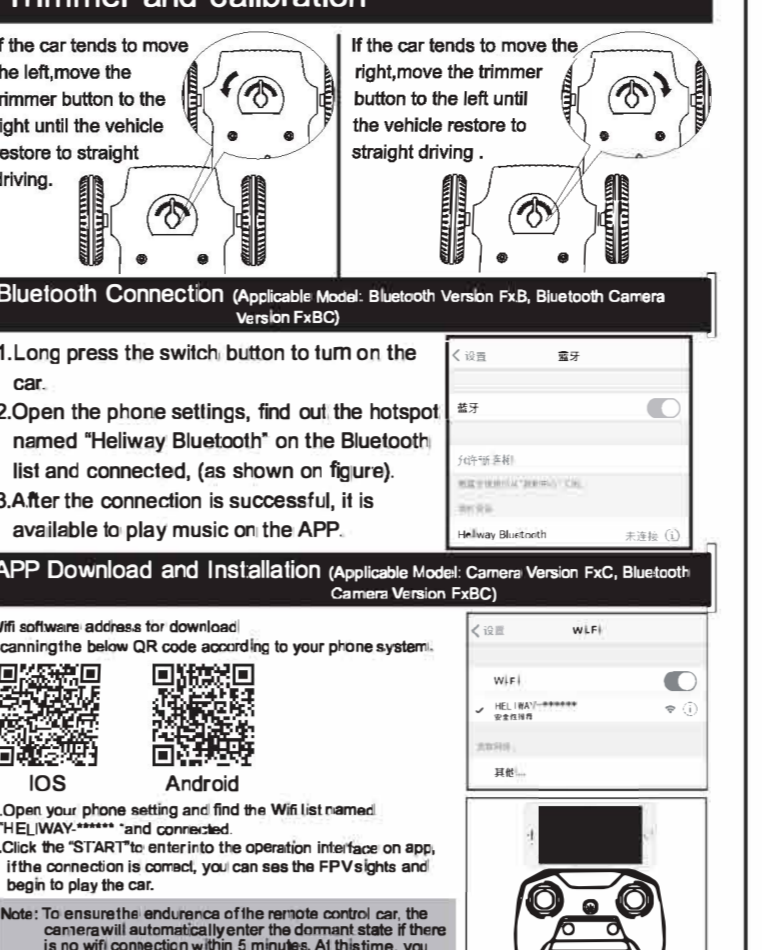
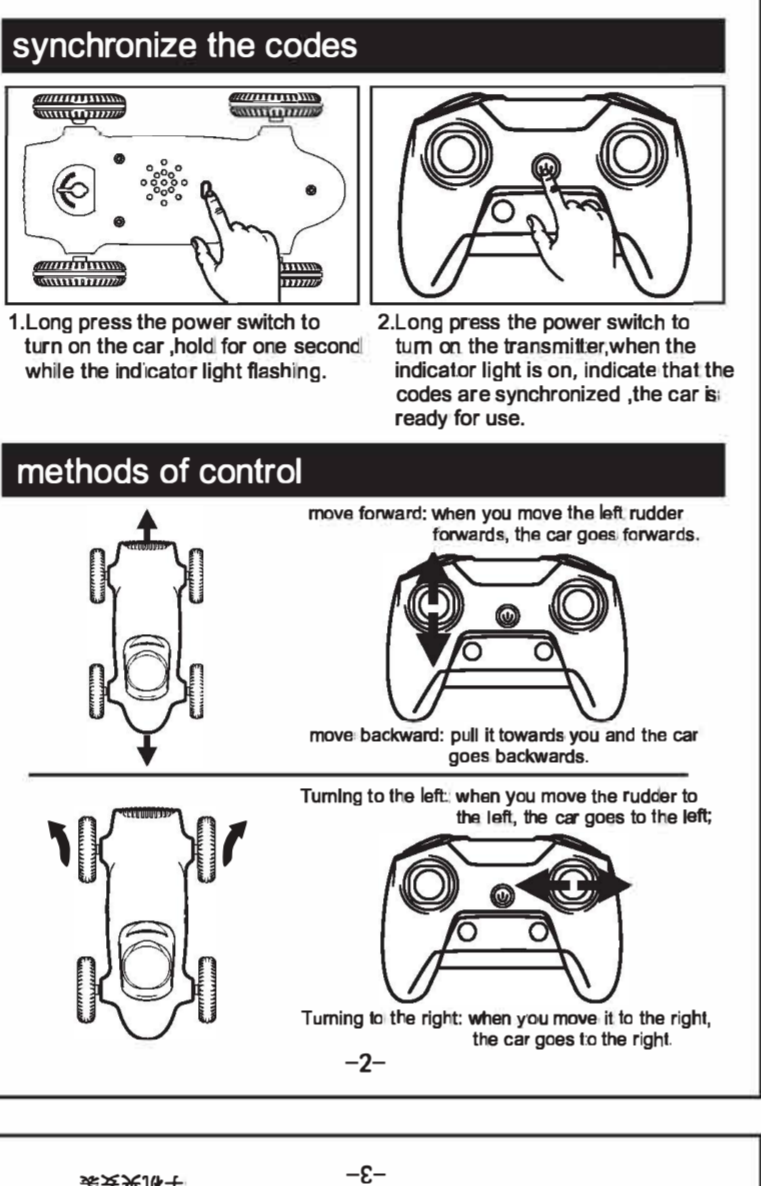
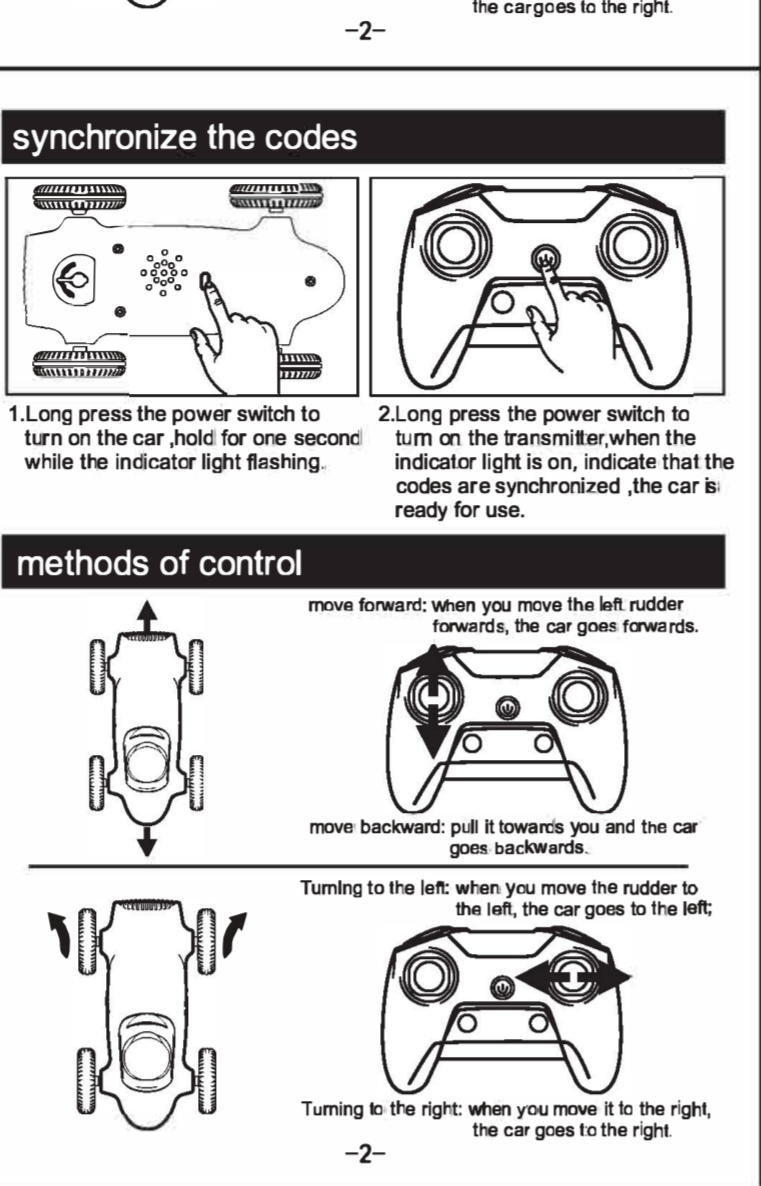
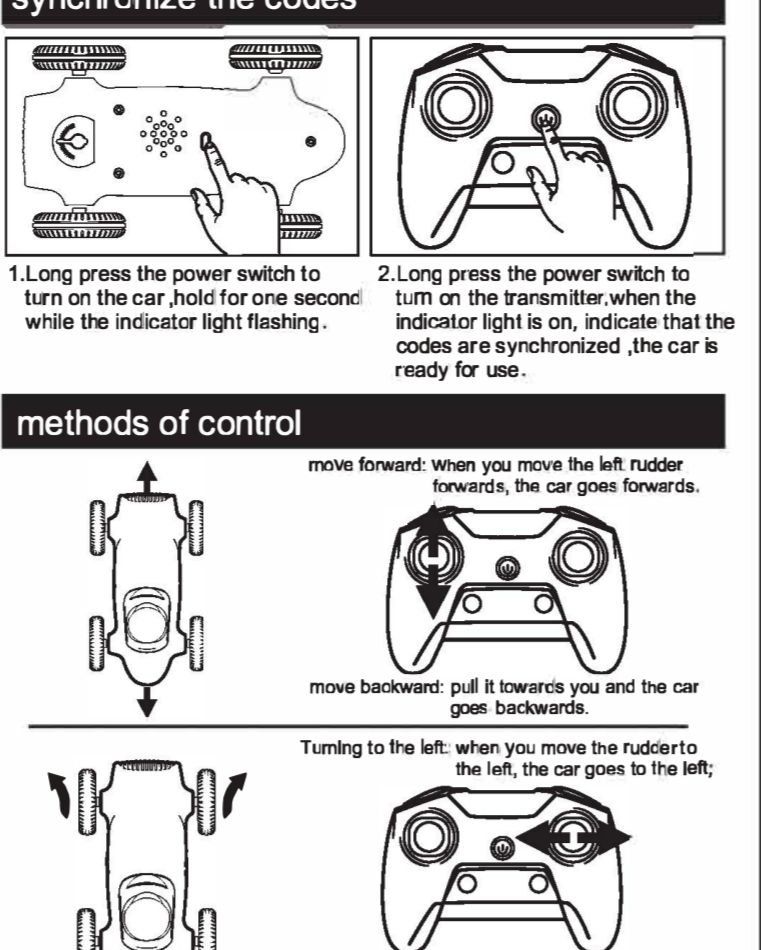

Precautions before Battery Use

- There are certain risks in the use of batteries, which may cause enormous personal and property losses. Users shall assume all relevant liabilities on their own. Manufacturers and dealers will not control the use of batteries (charging, discharging and storage, etc) or take responsibility for the losses incurred to people and property.
- If any battery leaks, please avoid liquid contact with skin and eyes. In case of liquid contact with skin, please wash your skin immediately with large amounts of cold water and seek medical advice at once.
- If there is a suspicious odor, noise or smoke from the charger, remove the power supply at once.
- Please strictly comply with the following requirements, otherwise it will result in fire, electric shock or explosion.

Chargers and charging

- Do not overcharge the batteries. When the batteries are fully charged, please unplug the charger. After charging is over, please do not recharge the batteries as to avoid overcharging.
- Do not charge the batteries near flammable materials or on the surface of flammable (paper, wooden floor, solid wood furniture, etc) or conductive objects, and observe the battery safety time.
- Do not charge the batteries immediately while they are still hot after use.
- The temperature of the batteries should be between 0°C and 40°C.
- Please unplug the charger when the batteries are not being charged.

Use and Storage

- It is strictly forbidden to pack damaged batteries with plastic.
- Do not insert or remove the batteries when the product is in use.
- Do not expose the batteries to excessive physical impact.
- It is strictly forbidden to use expanded, leaked or broken batteries or those entering liquid acid.
- Children are forbidden from touching the batteries.
- Do not put the batteries in the fire to avoid contact between the batteries and liquid. It is strictly forbidden to get the product wet in the rain or place it in a damp place.
- Do not disassemble, drill, deform or cut the batteries. It is strictly forbidden to carry heavy objects on battery or chargers or across the batteries.
- Do not clean the charger with solvents, industrial alcohol or other flammable solvents. Use the product in a greenhouse. Do not expose the product to extreme temperatures. Electrolytic substances and electronic steams are harmful to the body.
- Avoid substantial changes in the temperature of the place where the product is stored.
- Do not place the product near the sources of heating or fire.
- The batteries should be taken out when the product is not in use.

Recovery

- Do not treat the product as daily garbage. Damaged or unusable batteries should be placed in special containers for designated purposes.
- The products made of electronic components and batteries. Please treat the garbage of electronic and electronic equipment in line with special requirements.
- Please get familiar with the contracted treatment method for garbage in local places.

Precautions before Battery Use

- There are certain risks in the use of batteries, which may cause enormous personal and property losses. Users shall assume all relevant liabilities on their own. Manufacturers and dealers will not control the use of batteries (charging, discharging and storage, etc) or take responsibility for the losses incurred to people and property.
- If any battery leaks, please avoid liquid contact with skin and eyes. In case of liquid contact with skin, please wash your skin immediately with large amounts of cold water and seek medical advice at once.
- If there is a suspicious odor, noise or smoke from the charger, remove the power supply at once.
- Please strictly comply with the following requirements, otherwise it will result in fire, electric shock or explosion.

Chargers and charging

- Do not overcharge the batteries. When the batteries are fully charged, please unplug the charger. After charging is over, please do not recharge the batteries as to avoid overcharging.
- Do not charge the batteries near flammable materials or on the surface of flammable (paper, wooden floor, solid wood furniture, etc) or conductive objects, and observe the battery safety time.
- Do not charge the batteries immediately while they are still hot after use.
- The temperature of the batteries should be between 0°C and 40°C.
- Please unplug the charger when the batteries are not being charged.

Use and Storage

- It is strictly forbidden to pack damaged batteries with plastic.
- Do not insert or remove the batteries when the product is in use.
- Do not expose the batteries to excessive physical impact.
- It is strictly forbidden to use expanded, leaked or broken batteries or those entering liquid acid.
- Children are forbidden from touching the batteries.
- Do not put the batteries in the fire to avoid contact between the batteries and liquid. It is strictly forbidden to get the product wet in the rain or place it in a damp place.
- Do not disassemble, drill, deform or cut the batteries. It is strictly forbidden to carry heavy objects on battery or chargers or across the batteries.
- Do not clean the charger with solvents, industrial alcohol or other flammable solvents. Use the product in a greenhouse. Do not expose the product to extreme temperatures. Electrolytic substances and electronic steams are harmful to the body.
- Avoid substantial changes in the temperature of the place where the product is stored.
- Do not place the product near the sources of heating or fire.
- The batteries should be taken out when the product is not in use.

Recovery

- Do not treat the product as daily garbage. Damaged or unusable batteries should be placed in special containers for designated purposes.
- The products made of electronic components and batteries. Please treat the garbage of electronic and electronic equipment in line with special requirements.
- Please get familiar with the contracted treatment method for garbage in local places.

Precautions before Battery Use

- There are certain risks in the use of batteries, which may cause enormous personal and property losses. Users shall assume all relevant liabilities on their own. Manufacturers and dealers will not control the use of batteries (charging, discharging and storage, etc) or take responsibility for the losses incurred to people and property.
- If any battery leaks, please avoid liquid contact with skin and eyes. In case of liquid contact with skin, please wash your skin immediately with large amounts of cold water and seek medical advice at once.
- If there is a suspicious odor, noise or smoke from the charger, remove the power supply at once.
- Please strictly comply with the following requirements, otherwise it will result in fire, electric shock or explosion.

Chargers and charging

- Do not overcharge the batteries. When the batteries are fully charged, please unplug the charger. After charging is over, please do not recharge the batteries as to avoid overcharging.
- Do not charge the batteries near flammable materials or on the surface of flammable (paper, wooden floor, solid wood furniture, etc) or conductive objects, and observe the battery safety time.
- Do not charge the batteries immediately while they are still hot after use.
- The temperature of the batteries should be between 0°C and 40°C.
- Please unplug the charger when the batteries are not being charged.

Use and Storage

- It is strictly forbidden to pack damaged batteries with plastic.
- Do not insert or remove the batteries when the product is in use.
- Do not expose the batteries to excessive physical impact.
- It is strictly forbidden to use expanded, leaked or broken batteries or those entering liquid acid.
- Children are forbidden from touching the batteries.
- Do not put the batteries in the fire to avoid contact between the batteries and liquid. It is strictly forbidden to get the product wet in the rain or place it in a damp place.
- Do not disassemble, drill, deform or cut the batteries. It is strictly forbidden to carry heavy objects on battery or chargers or across the batteries.
- Do not clean the charger with solvents, industrial alcohol or other flammable solvents. Use the product in a greenhouse. Do not expose the product to extreme temperatures. Electrolytic substances and electronic steams are harmful to the body.
- Avoid substantial changes in the temperature of the place where the product is stored.
- Do not place the product near the sources of heating or fire.
- The batteries should be taken out when the product is not in use.

Recovery

- Do not treat the product as daily garbage. Damaged or unusable batteries should be placed in special containers for designated purposes.
- The products made of electronic components and batteries. Please treat the garbage of electronic and electronic equipment in line with special requirements.
- Please get familiar with the contracted treatment method for garbage in local places.

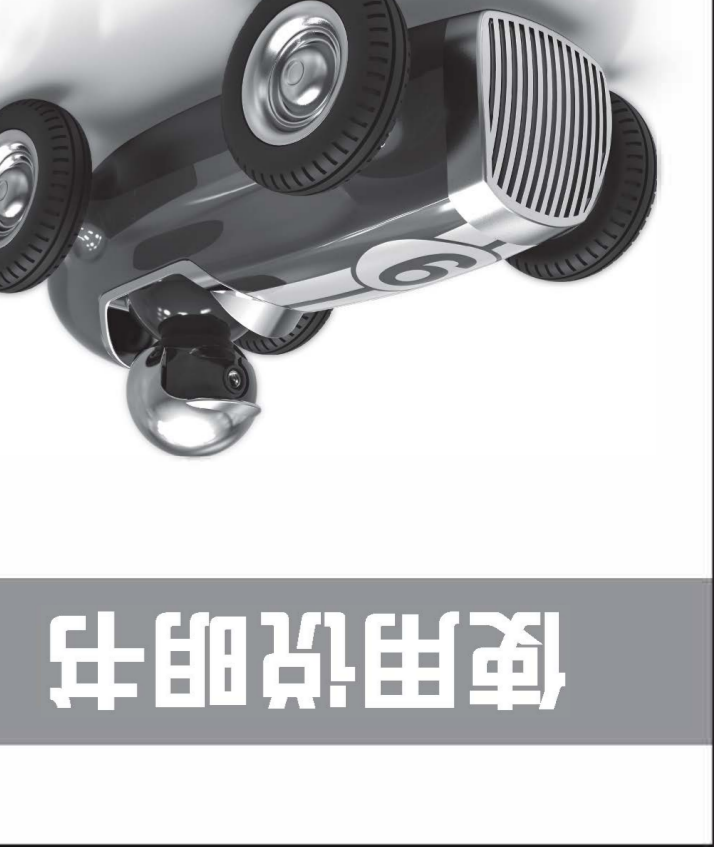

充电使用的相关注意事项

1. 使用布轻轻擦拭车子。
2. 请勿将车放在水中, 潮湿及阳光直射的地方。
3. 请勿将车放在暖气下, 可能引起电子元件损坏。
4. 另一路电源插座, 可能引起电子元件损坏。
5. 请勿将车放在暖气下, 潮湿及阳光直射的地方。
6. 请勿将车放在暖气下, 潮湿及阳光直射的地方。
7. 请勿将车放在暖气下, 潮湿及阳光直射的地方。

充电使用的相关注意事项

1. 使用布轻轻擦拭车子。
2. 请勿将车放在水中, 潮湿及阳光直射的地方。
3. 请勿将车放在暖气下, 可能引起电子元件损坏。
4. 另一路电源插座, 可能引起电子元件损坏。
5. 请勿将车放在暖气下, 潮湿及阳光直射的地方。
6. 请勿将车放在暖气下, 潮湿及阳光直射的地方。
7. 请勿将车放在暖气下, 潮湿及阳光直射的地方。

充电使用的相关注意事项

1. 使用布轻轻擦拭车子。
2. 请勿将车放在水中, 潮湿及阳光直射的地方。
3. 请勿将车放在暖气下, 可能引起电子元件损坏。
4. 另一路电源插座, 可能引起电子元件损坏。
5. 请勿将车放在暖气下, 潮湿及阳光直射的地方。
6. 请勿将车放在暖气下, 潮湿及阳光直射的地方。
7. 请勿将车放在暖气下, 潮湿及阳光直射的地方。

充电使用的相关注意事项

1. 使用布轻轻擦拭车子。
2. 请勿将车放在水中, 潮湿及阳光直射的地方。
3. 请勿将车放在暖气下, 可能引起电子元件损坏。
4. 另一路电源插座, 可能引起电子元件损坏。
5. 请勿将车放在暖气下, 潮湿及阳光直射的地方。
6. 请勿将车放在暖气下, 潮湿及阳光直射的地方。
7. 请勿将车放在暖气下, 潮湿及阳光直射的地方。

蓝牙连接

1. 长按开启遥控器电源。
2. 进入手机设置选项, 在蓝牙列表。
3. 连接成功后, 可用媒体APP。
4. 蓝牙名称为 "Helway".

蓝牙连接

1. 长按开启遥控器电源。
2. 进入手机设置选项, 在蓝牙列表。
3. 连接成功后, 可用媒体APP。
4. 蓝牙名称为 "Helway".

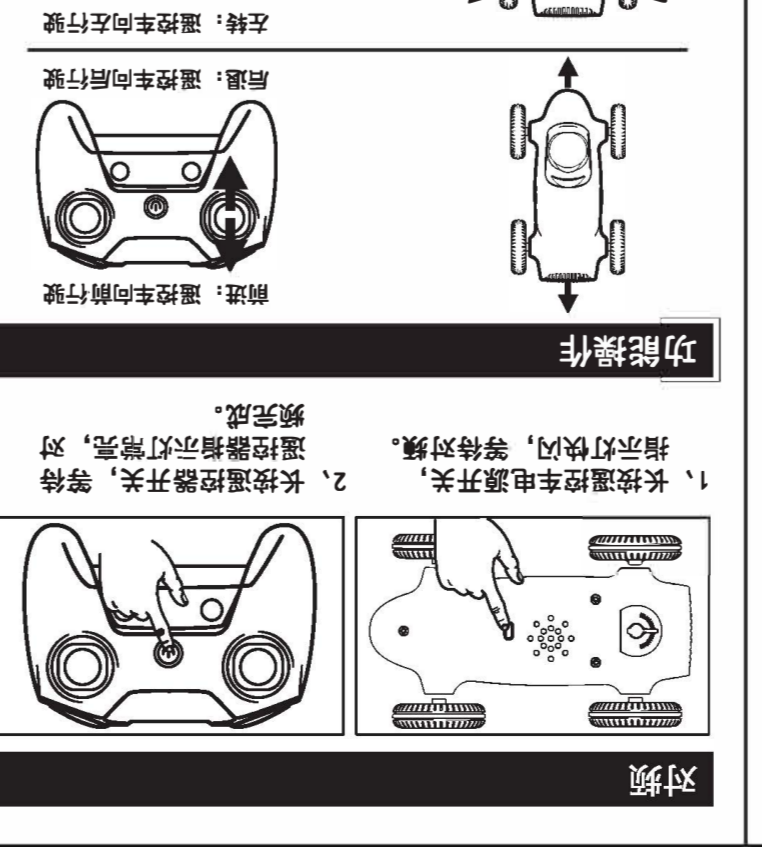
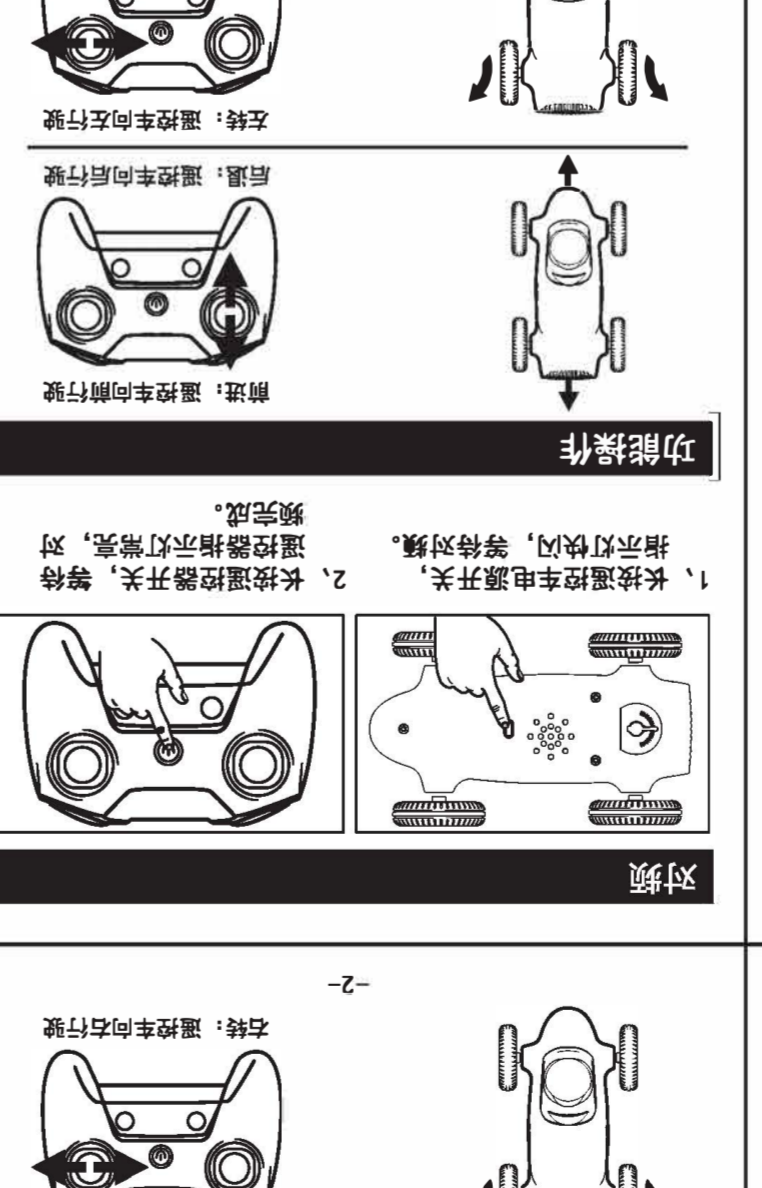

产品参数

名称	规格
遥控器	2.4G
摄像头	2.0MP
喇叭	0.5W
闪光灯	LED
车体	2.4G
摄像头	2.0MP
喇叭	0.5W
闪光灯	LED

产品参数

名称	规格
遥控器	2.4G
摄像头	2.0MP
喇叭	0.5W
闪光灯	LED
车体	2.4G
摄像头	2.0MP
喇叭	0.5W
闪光灯	LED

FCC Warning

This device complies with part 15 of the FCC rules. Operation is subject to the following two conditions: (1) this device may not cause harmful interference, and (2) this device must accept any interference received, including interference that may cause undesired operation.

Changes or modifications not expressly approved by the party responsible for compliance could void the user's authority to operate the equipment.

NOTE: This equipment has been tested and found to comply with the limits for a Class B digital device, pursuant to part 15 of the FCC Rules. These limits are designed to provide reasonable protection against harmful interference in a residential installation. This equipment generates uses and can radiate radio frequency energy and, if not installed and used in accordance with the instructions, may cause harmful interference to radio communications. However, there is no guarantee that interference will not occur in a particular installation. If this equipment does cause harmful interference to radio or television reception, which can be determined by turning the equipment off and on, the user is encouraged to try to correct the interference by one or more of the following measures:

- Reorient or relocate the receiving antenna.
- Increase the separation between the equipment and receiver.
- Connect the equipment into an outlet on a circuit different from that to which the receiver is connected.
- Consult the dealer or an experienced radio/TV technician for help.

Radiation Exposure Statement

This equipment complies with FCC radiation exposure limits set forth for an uncontrolled environment. This equipment should be installed and operated with minimum distance 20cm between the radiator and your body.