

nreal

Nreal Light 混合现实眼镜 NR-9100GGL

Nreal 计算单元 NR-9100UGL

Nreal 手柄 NR-9100CGL

Quickstart Guide

クイックガイド

퀵가이드

快速上手指南

1

Turning on the Computing Unit コンピューティングユニットの電源を入れる 컴퓨팅 유닛 켜기 开启计算单元

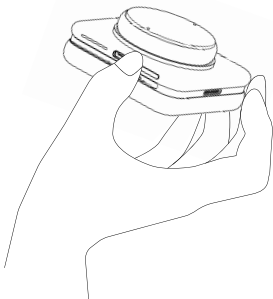

Long press the power button until the indicator light starts blinking, then wait for it to turn solid green.
(Notice: Blue indicator light means the Computing Unit is in Sleep Mode. Press the power button to wake it up.)

インジケータライトが点灯するまで電源ボタンを押し続け、インジケータライトが緑色に点灯するまで待ちます。(注: コンピューティングユニットがスリープモードになるとインジケータライトが青色に変わります。電源ボタンを押して起動します。)

지시등이 켜질 때 까지 전원 버튼을 길게 누른 후, 녹색등이 켜질 때까지 기다려 주십시오. (주의: 컴퓨팅 유닛이 휴면 상태로 들어가면 지시등이 파란색으로 변하게 됩니다, 이경우 전원 버튼을 눌러 유닛을 재기동 시킬 수 있습니다)

长按电源键直至指示灯亮起, 然后等待指示灯变为绿色常亮。(注意: 指示灯变蓝表示计算单元进入休眠模式, 按下电源键可唤醒。)

Turning on the Controller

コントローラーの電源を入れる

컨트롤러 전원 켜기

开启手柄电源

2

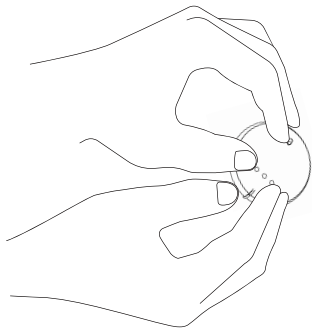

Turn on the switch on the back of the Controller. The Controller's light should turn solid green.

コントローラー背面のスイッチをオンにすると、コントローラーのインジケータライトが緑色に点灯します。

컨트롤러 아래쪽의 스위치를 켜주십시오, 컨트롤러의 지시등이 녹색으로 켜집니다.

开启手柄背面的开关，等待手柄的指示灯变为绿色常亮。

3

Picking the Best Fitting Nose Pad and Corrective Lenses Combination (if needed)

適切な鼻パッドと矯正レンズを選択します (必要な場合)

본인에게 맞는 코받침과 교정렌즈를 선택하세요
(필요한 경우에 한함)

选择合适的鼻托和矫正镜 (若需要)

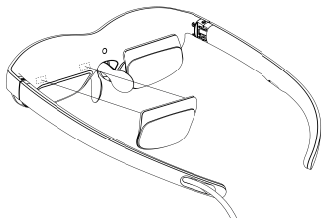
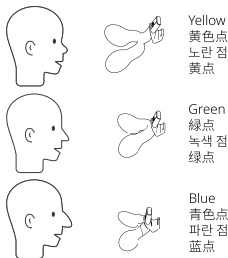

Pick a nose pad that best fits your nose shape, and magnetically attach it onto the middle of the glasses. If you need corrective lenses, you can also magnetically attach them onto the inner side of the glasses as well.

鼻の高さに合った鼻パッドを選択し、メガネの中央に挿入します。矯正レンズが必要な場合は、メガネの内側に取り付けることができます。

자신의 코높이에 맞는 코받침을 선택하여 글래스의 중앙 홈에 꽂아 주십시오. 만일 교정 렌즈가 필요한 경우 안경 내측에 자력을 이용하여 부착이 가능합니다.

选择一款适合自己鼻子高度的鼻托，插入到眼镜的中间部位。如果需要矫正镜片，则将其吸附在眼镜内侧。

Tethering the Glasses with the Computing Unit

メガネをコンピューティングユニットに接続させる
글래스와 컴퓨팅 유닛 연결
连接眼镜和计算单元

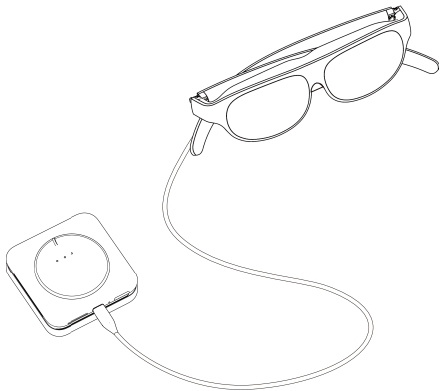

Plug the USB-C cable of the glasses into the Computing Unit.

メガネの USB-C ケーブルをコンピューティングユニットに差し込みます。

글래스의 USB-C 타입 케이블을 컴퓨팅 유닛에 꽂아주세요

将眼镜的 USB-C 连接线插入计算单元。

5

Using the Controller コントローラーの使い方 컨트롤러 사용법 如何使用手柄

Up Button: (Long press) to reset the laser pointer.

上キー : (長押し) コントローラーのライトをリセットします。

업버튼 : (길게 누름) 리모콘 레이저 방향 초기화.

上键 : (长按) 校准手柄射线方向。

Center of the Touch-pad: (Click) select / enter. Swipe gestures are also supported.

タッチパッドの中央部 : (クリック) を選択して入力します。またジェスチャーの操作もサポートします。

중앙 터치패드 : (클릭) 선택 및 진입, 제스처 동작 인식.

触摸板中心区域 : (点击) 选择和进入, 支持滑动手势操作。

Down Button: (Click) return to the previous menu. (Long press) return to the home menu.

下キー : (クリック) 前のステップに戻ります。(長押し) メインメニューに戻ります。

다운버튼 : (클릭) 상위 메뉴로 이동, (길게 누름) 메인 메뉴로 이동.

下键 : (点击) 返回上一步, (长按) 返回主菜单。

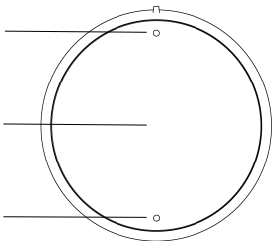

The (virtual) laser pointing outward from the Controller is used to interact with objects in AR. Please reset the laser pointer before you start.

コントローラーから出るレーザーで仮想の物体と相互作用できます。開始する前に、まずアップボタンを長押ししてレーザーの方向をリセットしてください。

리모콘에서 나오는 레이저로 가상의 물체와 상호작용이 가능합니다. 시작하기 전에 먼저 업버튼을 (길게 눌러) 레이저의 방향을 초기화 하여 주십시오.

使用从手柄前方射出的射线来和虚拟内容交互。请在开始使用时首先 (长按) 上键以校准射线方向。

Put on Your Nreal Light Glasses and Enjoy it!

眼鏡をかけて、Nreal を楽しんでください！

Nreal Light 를 착용하신 후 마음껏 즐기십시오！

戴上眼镜开始享受 Nreal 带来的体验！

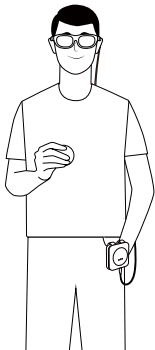

If the display is blurry, or parts of it are cropped out: Move the glasses back and forth to find the perfect vertex distance for your eyes. Try a different nose pad until you get the best fit and clearest vision.

画面がぼやけて見えたり、または画面の一部が切り取られて見える場合：メガネを前後に動かして、目の最適な頂点距離を見つけます。最適なフィット感と鮮明な視界が得るために、自分にあう鼻パッドを試してください。

디스플레이가 흐리거나 화면이 잘린 경우, 안경을 앞뒤로 움직이거나 코패드 변경하여 알맞은 높이를 찾아 주십시오.

若感觉眼镜的显示模糊或视野被部分裁切：请尝试前后移动眼镜，以找到适合您眼睛的最佳距离。或尝试使用其他高度的鼻托，直到获得最佳及最清晰的视野。

Adjusting Volume and Brightness

音量と明るさの調節方法

볼륨과 화면 밝기 조절하는 법

调整音量和亮度

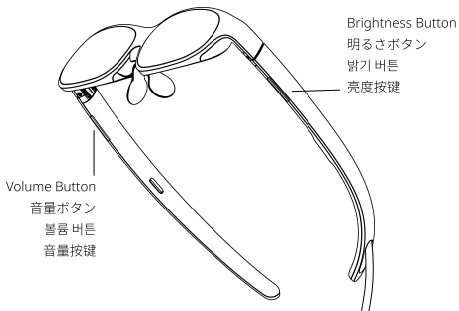

For More Information

詳細情報

상세정보

更多信息

Please visit our support page: <https://support.nreal.ai/dev-kit>
当社ウェブサイトをご確認ください: <https://support.nreal.ai/dev-kit>
당사 웹사이트를 방문하여 확인해주세요: <https://support.nreal.ai/dev-kit>
请查阅我们官网: <https://support.nreal.ai/dev-kit>

Charger Disclaimer

Please only use an original charger and USB Cable, failure to do so may result in a hazardous situation. When charging, the adapter must be near the equipment, and easily accessible.

Manufacturer of Power Adapter: Huizhou Jinhua Industrial Development Co.,Ltd.

Parameters of Power adapter: Input 100-240 Vac ~50/60Hz 0.6A ; Output 5.0Vdc 3.0A ;9.0Vdc 2.0A; 12.0Vdc 1.5A

The product should only be connected using a USB Type-C interface.

Battery Instructions and Caution

Use the specified charger(by the manufacturer) .

Do not continue to use if there is severe swelling.

Do not expose to high temperature environments.

Do not disassemble, strike, squeeze or place the battery into a fire.

Follow manufacturer's instructions If the battery's temperature exceeds 55°C or catches on fire.

Risk of explosion if battery is replaced by an incorrect type.

dispose of used batteries according to the instructions.

Extreme Temperature

45° C

RF

The device complies with RF specifications when the device is used 0 mm from your body.

CE Declaration

Declaration Of Conformity Hereby, Beijing Unicorn Technology Co.,Ltd declares that this Nreal Light Developer Kit is in compliance with the essential requirements and other relevant provisions of directive 1995/5/EC.

FCC Statement

This equipment has been tested and found to comply with the limits for a Class B digital device, pursuant to part 15 of the FCC Rules. These limits are designed to provide reasonable protection against harmful interference in a residential installation. This equipment generates, uses and can radiate radio frequency energy and, if not installed and used in accordance with the instructions, may cause harmful interference to radio communications. However, there is no guarantee that interference will not occur in a particular installation. If this equipment does cause harmful interference to radio or television reception, which can be determined by turning the equipment off and on, the user is encouraged to try to correct the interference by one or more of the following measures:

- Reorient or relocate the receiving antenna.

- Increase the separation between the equipment and receiver.

- Connect the equipment into an outlet on a circuit different from that to which the receiver is connected. Consult the dealer or an experienced radio/TV technician for help.

Caution: Any changes or modifications to this device not explicitly approved by manufacturer could void your authority to operate this equipment.

This device complies with part 15 of the FCC Rules. Operation is subject to the following two conditions:

(1) This device may not cause harmful interference, and (2) This device must accept any interference received, including interference that may cause undesired operation.

IC Warning Statements

This device complies with Industry Canada licence-exempt RSS standard(s). Operation is subject to the following two conditions:

- This device may not cause interference.

- This device must accept any interference, including interference that may cause undesired operation of the device.

The digital apparatus complies with Canadian CAN ICES-3 (B)/NMB-3(B)

Absorption Rate (SAR) Information:

This device meets the government's requirements for exposure to radio waves. The guidelines are based on standards that were developed by independent scientific organizations through periodic and thorough evaluation of scientific studies. The standards include a substantial safety margin designed to assure the safety of all persons regardless of age or health.

FCC RF Exposure Information and Statement The SAR limit of USA (FCC) is 1.6 W/KG averaged over one gram of tissue. This device was tested for typical body-worn operations with the back of the handset kept 10mm from the body. To maintain compliance with FCC RF exposure requirements, use accessories that maintain a 10mm separation distance between the user's body and the back of the handset. The use of belt clips, holsters and similar accessories should not contain metallic components in its assembly. The use of accessories that do not satisfy these requirements may not comply with FCC RF exposure requirements, and should be avoided.

Body-worn Operation

This device was tested for typical body-worn operations. To comply with RF exposure requirements, a minimum separation distance of 10 mm must be maintained between the user's body and the device, including the antenna. Third-party belt-clips, holsters, and similar accessories used by this device should not contain any metallic components. Body-worn accessories that do not meet these requirements may not comply with RF exposure requirements and should be avoided. Use only the supplied or an approved antenna.

Nreal Ltd.