

材质: 80g书纸单色印刷

142.50 mm

142.50 mm

LED Shelf Floor Lamp with Wireless Charger

Model: A-092

USTX-WSEF01-1

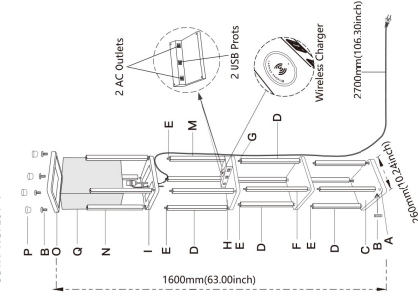

Technical Details

This shelf lamp is only suitable for light bulbs with E26 base. Use max 100watt type a lamp.

After-sales Service Guarantee

24-Month warranty is provided for this device from the date of purchase. If you have any query, please sign in to Amazon and contact us or email us via Miambert@t63.com

Note: An order ID with detail description or image is preferred when contacting our customer service if possible.

Warranty

- During the warranty period, we provides service including refund or replacement without charge to those who use the device in accordance with its intended use.
- This warranty does not cover:
 - A. Failure due to improper use, repair or remodeling.
 - B. Failure or damage because of falling.
 - C. Failure or damage caused by fire, earthquake, flood, lightning and other natural disasters.
 - D. Failure or damage when used other than its intended use.
 - E. Failure or damage caused the third-party products other than this device.

Warning
THIS INSTRUCTION BOOKLET CONTAINS IMPORTANT SAFETY INFORMATION. PLEASE READ AND KEEP FOR FUTURE REFERENCE.

A	B	C	D	E
4PCS	8PCS	1PC	10PCS	10PCS
F	G	H	I	J
1PC	2PCS	2PCS	4PCS	4PCS
K	L	M	N	O
1PC	1PC	1PC	4PCS	1PC
P	Q	R	S	T
4PCS	1PC	4PCS	1PC	4PCS

Assembly Instructions

Use the following steps to assemble your shelf lamp:

- A.Screw Cover(1) 4PCS
- B.Screw 8PCS
- C.Thick Base 1PC
- D.Charging Board 1PC
- E.Short Thread-Pipe 10PCS
- F.Shelf Board 1PC
- G.Long Thread-Pipe 2PCS
- H.Charging Board 1PC
- I.Socket Board 1PC
- J.Top Frame 1PC
- K.Butterfly Nut 1PC
- L.Pull Chain 1PC
- M.Short Pole 2PCS
- N.Medium Pole 4PCS
- O.Top Frame 1PC
- P.Socket Board 1PC
- Q.Lamp Shade 1PC
- R.Mini Pole 4PCS

- Carefully remove all parts from the box and remove all plastic coverings.
- Insert 4pcs Short Thread-Pipe (E) into the screw-holes at 4pcs Long Pole (D). Insert 2pcs Long Thread-Pipe (G) into the screw-holes at 2pcs Short Poles (M). (Note: The side of the poles with the thread-pipes should be face up when installing them. Diagram 1)
- Insert 4pcs of screws (B) into the screw-holes at Thick Base (C) and tighten them by a screwdriver. Place 4pcs Screw Cover (A) to cover the screw-holes.
- Tighten 4pcs of Long Pole (D) onto Thick Base (C).
- Place Shelf Board (F) on top of Long Pole (D) with the holes over the threads.
- Place Socket Board (H) on top of Long Pole (D) with the holes over the threads. Turn clockwise until it is secured. (Note: 4pcs of Long Pole (D) include 4pcs Long Pole (D) with 4pcs Long Thread-Pipe (G) and 2pcs Long Pole (D) with 2pcs Short Thread-Pipe (E).)
- Place Charging Board (H) on top of Long Pole (D) with the holes over the threads. (Note: Place the thicker side into the Long Pole (D) with Long Thread-Pipe (G).)
- Place 2pcs Long Pole (D) and 2pcs Short Pole (M) and turn clockwise until it is secured.
- Place the Socket Board (H) on top of the 2pcs Long Pole (D) and 2pcs Short Pole (M) with the holes over the threads. Turn clockwise until it is secured.
- Place 4pcs Mini Pole (R) into the little holes on the Socket Board (H). (Note: Diagram 2)
- Place the Top Frame (O) onto the Short Poles (M) with Screws (B) from the top by a screwdriver. And place Screw Cover (P) to cover the screw-holes.
- Insert the Lamp Shade (Q) over the Socket Board (I).

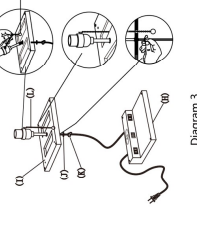
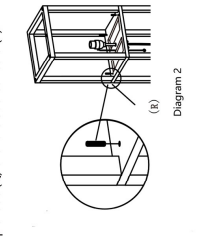
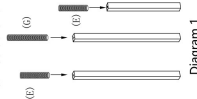

Insert socket pipe into center hole of Socket Board (H). Adjust socket direction be sure pull chain (L) goes through the hole in line. Tighten up by turning Annulus (J) and Butterfly Nut (K) clockwise.

WARNING: This device complies with Part 15 of the FCC Rules. Operation is subject to the following two conditions: (1) This device may not cause harmful interference, and (2) This device must accept any interference received, including interference that may cause undesired operation.

CAUTION: Changes or modifications not expressly approved by the party responsible for compliance could void the user's authority to operate the equipment.

NOTE: This equipment has been tested and found to comply with the limits for a Class B digital device, pursuant to Part 15 of the FCC Rules. These limits are designed to provide reasonable protection against harmful interference in a residential installation. This equipment generates, uses, and can radiate radio frequency energy and, if not installed and used in accordance with the instructions, may cause harmful interference to radio communications. However, there is no guarantee that interference will not occur in a particular installation. If this equipment does cause harmful interference to radio or television reception, which can be determined by turning the equipment off and on, the user is encouraged to try to correct the interference by one more of the following measures:

- Reorient or relocate the receiving antenna.
- Increase the distance between the equipment and receiver.
- Connect the equipment into an outlet on a circuit different from that to which the receiver is connected.
- Consult the dealer or an experienced radio/TV technician for help.

FCC Radiation Exposure Statement:

This equipment complies with FCC radiation exposure limits set forth for an uncontrolled environment. This equipment should be installed and operated with minimum distance 20cm between the radiator & your body.

Made in China

210.00 mm