

80*80mm
双面印刷

OREIN

Wi-Fi Smart Light Bulb Operation Manual

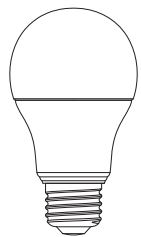

Function Introduction



APP control



Voice control



16 million color



APP Dimming & Tunable



music rhythm



Timing & countdown

- 1 -

Installation Instructions

1. After installing the bulb, power on the bulb.
2. The bulb will gradually change to a warm white light after R-G-B-W, and then enter the state of waiting to connect to the network.
3. To connect bulb to the Internet, download the Aidot APP and follow the APP guidelines.

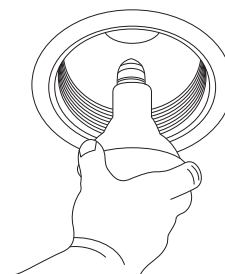

- 2 -

Quick Start Guide

1. Scan the QR code below, or search for "AiDot" in App Store or Google Play.



2. Create an account and sign in. Tap '+' to add the "Wi-Fi Light Bulb":

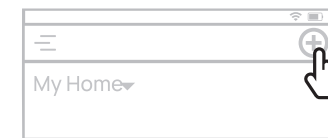

3. Follow the instructions on the App.
(Note: Please turn on Bluetooth and location.)
For more information about the usage guidelines and FAQs, Please scan the QR code below or visit the website: <https://www.aidot.com/s/000001>.



- 3 -

How to connect your device to other apps that support the Matter protocol, such as Alexa, Apple home, Google home, Smartthings?

1. Please use APP scanning function to scan the QR code or manually input the Pairing code below the QR code.
2. Note that the matter QR code on the scanning sticker must be the same as that on the device to be connected to the Internet. As shown in the diagram below.
3. For more information on how to add devices to apps that support Matter protocol, please refer to the apps guide of each manufacturer.

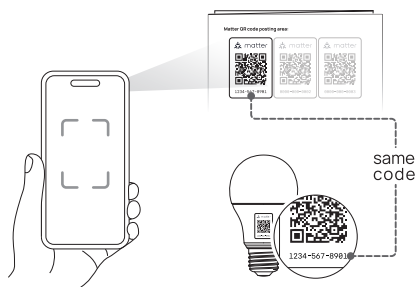

- 4 -

Matter QR code posting area:

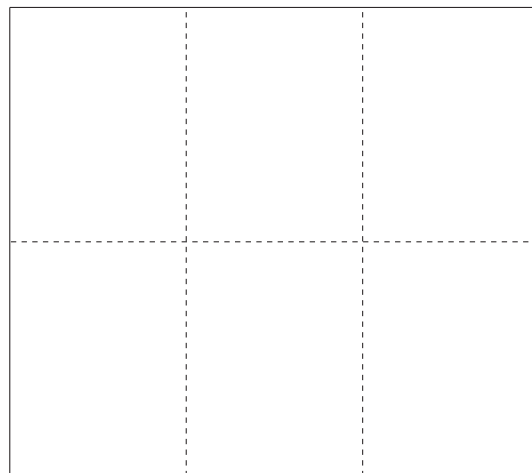

- 5 -

Warning

1. This device complies with Part 15 of the FCC Rules. Operation is subject to the following two conditions:
(1) This device may not cause harmful interference.
(2) This device must accept any interference received, including interference that may cause undesired operation.
- NOTE:** The grantee is not responsible for any changes or modifications not expressly approved by the party responsible for compliance. Such modifications or changes could void the user's authority to operate the equipment.
- NOTE:** This equipment has been tested and found to comply with the limits for a Class B digital device, pursuant to part 15 of the FCC Rules. These limits are designed to provide reasonable protection against harmful interference in a residential installation. This equipment generates uses and can radiate radio frequency energy and, if not installed and used in accordance with the instructions, may cause harmful interference to radio communications. However, there is no guarantee that interference will not occur in a particular installation. If this equipment does cause harmful interference to radio or television reception, which can be determined by turning the equipment off and on, the user is encouraged to try to correct the interference by one or more of the following measures:
- Reorient or relocate the receiving antenna.
 - Increase the separation between the equipment and receiver.
 - Connect the equipment into an outlet on a circuit different from that to which the receiver is connected.
 - Consult the dealer or an experienced radio/TV

To maintain compliance with FCC's RF Exposure guidelines, This equipment should be installed and operated with minimum 20cm distance between the radiator and your body: Use only the supplied antenna.

- 6 -

Cautions

- To avoid personal injury and/or possible product damage, the following cautions must be followed:
1. Risk of electrical shock. Disconnect power at fuse or circuit breaker before installing or servicing.
 2. To prevent early lamp failure, lamp should only be installed in operating environments ranging between: -20 C and +40 C (-4°F and +104°F).
 3. Suitable for damp locations.
 4. Not for use with dimmers.
 5. Lamp dims via wireless control and will not operate with a dimmer switch.
 6. Not for use in totally enclosed luminaires.
 7. Not for use in emergency light fixtures or exit signs.
 8. Ensure fixture can support the added weight of the lamp/bulb.

Contact Us

Syvio Technology .CO., LIMITED
Room A, 8/F Kwok Cheung Building, 635-637
Shanghai Street, Mong Kok, Hong Kong
Phone: 0086-199-2547-1900
Website: www.iorein.com
Email: Support@iorein.com
Made in China
Manufacturer: Leedarson IoT Technology Inc.
Address: No.1511, 2nd Fanghu North Rd,
Huli District, Xiamen, China

v1.0