

06\_

## Update device info on Studio

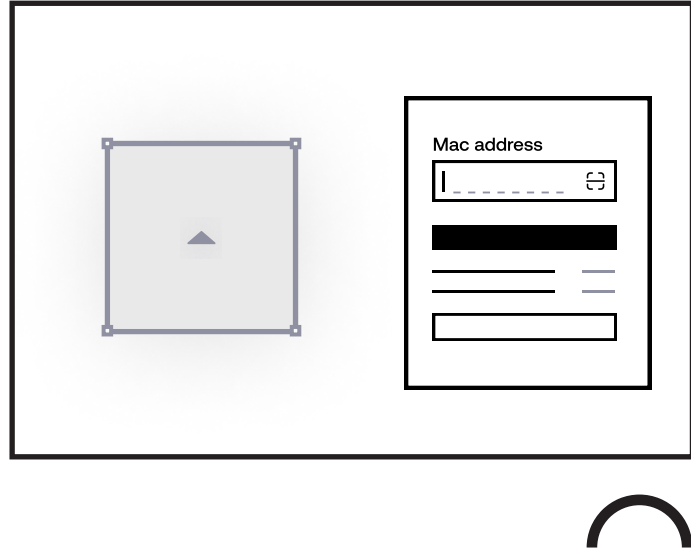

Update the virtual placeholder to accurately reflect device-specific information, such as the MAC address, serial number, installation height, orientation, mounting method, and precise location. Modify the device's custom fields as necessary.

07\_

## Device pairing and configuration

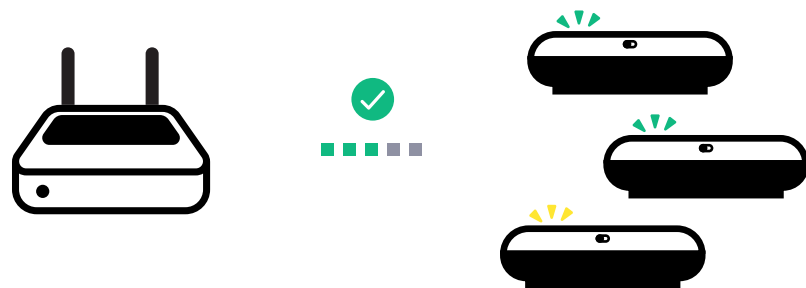

If onsite support is unavailable, Butlr offers remote pairing and configuration options. Please contact your Butlr representative for more information.

08\_

## Post-installation QA

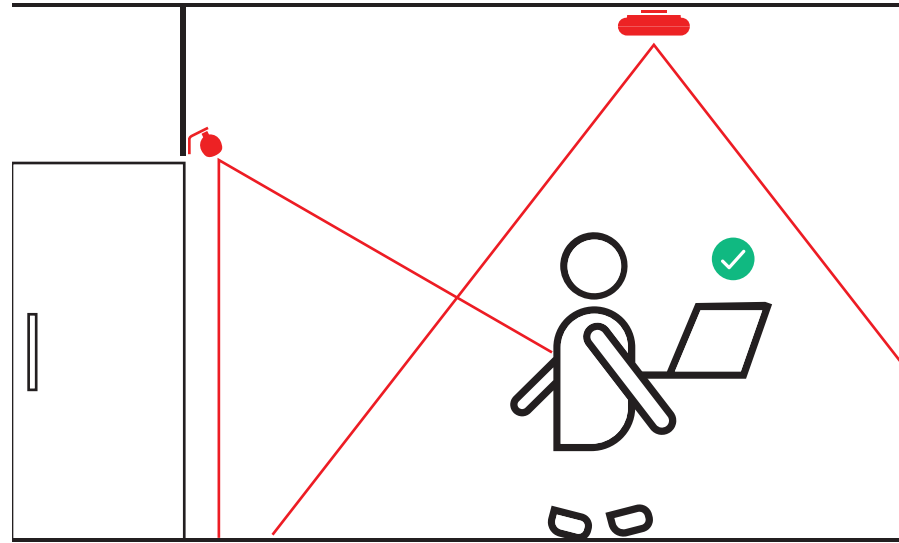

Use Studio and the materials provided by Butlr to verify the correct installation of devices and ensure data quality, optimizing sensor performance.

09\_

## Access Spatial Insights via Butlr Dashboard or by Integrating the Butlr API



Butlr enjoys collaborating with your development team. Our Product and Engineering teams will assist your engineers throughout the integration process to ensure your success from the start.

Heatic 2+

# Quick Start Guide

This Quick Start Guide provides an overview for setting up Heatic sensors and gateways. For a detailed step-by-step guide, please visit [support.butlr.io](https://support.butlr.io).

Thank you for choosing Butlr—the AI Data Platform for Anonymous People Sensing. We are excited for you to explore the future of spatial design with our innovative solutions. Whether you aim to gain insights on indoor traffic, monitor human activities, optimize desk utilization, or enhance operational efficiency, we hope your experience with Butlr is both seamless and rewarding.

For additional support, please visit our Learning Center at [support.butlr.io](https://support.butlr.io) or contact your Butlr representative. We are eager to partner with you as we transform sensors into the nerve cells of tomorrow's built environments.

Changes or modifications not expressly approved by the party responsible for compliance could void the user's authority to operate the equipment.

This equipment has been tested and found to comply with the limits for a Class A digital device, pursuant to Part 15 of the FCC Rules. These limits are designed to provide reasonable protection against harmful interference when the equipment is operated in a commercial environment. This equipment generates, uses, and can radiate radio frequency energy and, if not installed and used in accordance with the instruction manual, may cause harmful interference to radio communications. Operation of this equipment in a residential area is likely to cause harmful interference in which case the user will be required to correct the interference at his own expense.

"This device complies with part 15 of the FCC Rules. Operation is subject to the following two conditions: (1) This device may not cause harmful interference, and (2) this device must accept any interference received, including interference that may cause undesired operation."

"In order to comply with FCC/ISED RF Exposure requirements, this device must be installed to provide at least 20 cm separation from the human body at all times.

Lors de l'installation et du fonctionnement de cet équipement, la distance minimale entre le radiateur et le corps doit être de 20 cm

"This device contains licence-exempt transmitter(s)/receiver(s) that comply with Innovation, Science and Economic Development Canada's licence-exempt RSS(s). Operation is subject to the following two conditions:

1. This device may not cause interference.
2. This device must accept any interference, including interference that may cause undesired operation of the device."

"L'émetteur/récepteur exempt de licence contenu dans le présent appareil est conforme aux CNR d'Innovation, Sciences et Développement économique Canada applicables aux appareils radio exempts de licence. L'exploitation est autorisée aux deux conditions suivantes:

1. L'appareil ne doit pas produire de brouillage ;
2. L'appareil doit accepter tout brouillage radioélectrique subi, même si le brouillage est susceptible d'en compromettre le fonctionnement."

This is only required if product is within ICES-003 scope and is not exempt: \* Insert either "A" or "B", but not both, to identify the applicable Class of the device used for compliance verification.

"CAN ICES-3 (\*)/NMB-3(\*)"

Cela n'est nécessaire que si le produit entre dans le champ d'application de la norme ICES-003 et n'est pas exempté : \* Insérer "A" ou "B", mais pas les deux, pour identifier la classe applicable de l'appareil utilisé pour la vérification de la conformité.

"CAN ICES-3 (\*)/NMB-3(\*)"

[www.butlr.com](https://www.butlr.com)  
 Burlingame, California, USA  
 © 2024 Butlr Technologies Inc. All rights reserved.

01\_  
Log in to Butlr dashboard

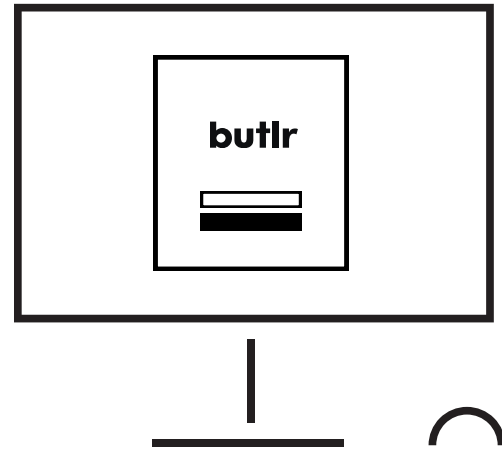

<https://app.butlr.io>

02\_  
Set up your virtual space in Studio

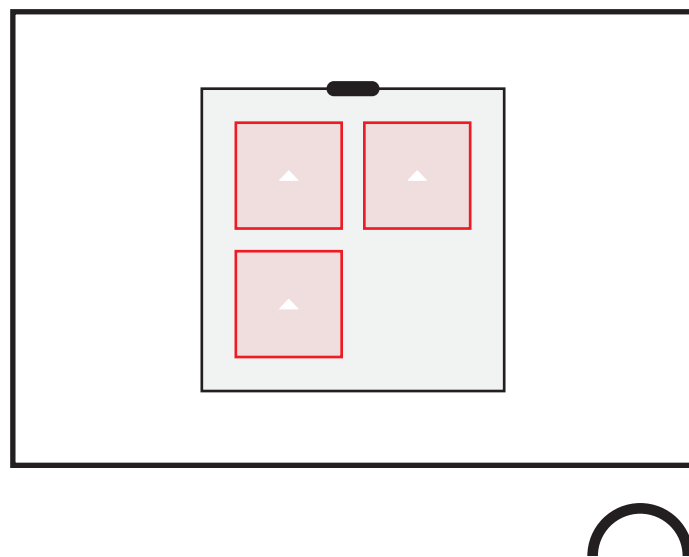

If you have multiple spaces or complex floorplans, Butlr can help with sensor placement planning. Please contact your Butlr representative for more information.

03\_  
Plug in Hive and connect to the Internet

WiFi, Ethernet or LTE

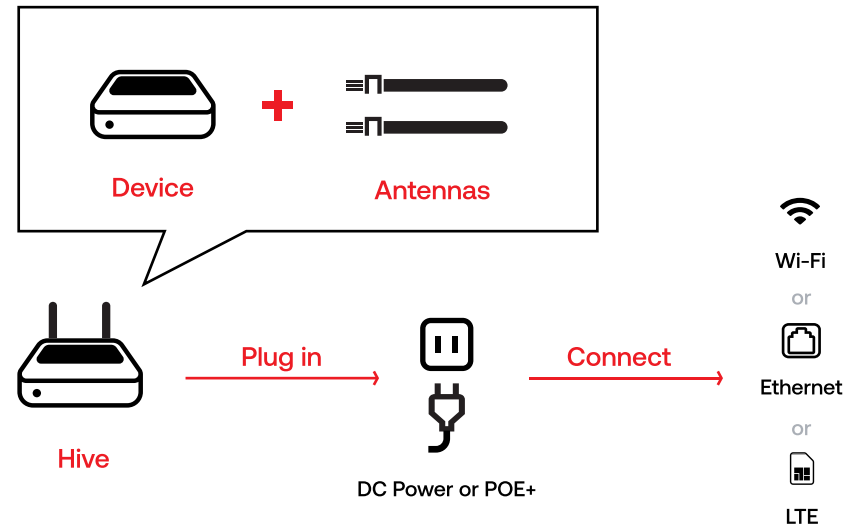

Different Hive versions may include varying numbers and types of antennas. The illustration above is for demonstration purposes only.

04\_  
Turn on Heatic Sensor(s)

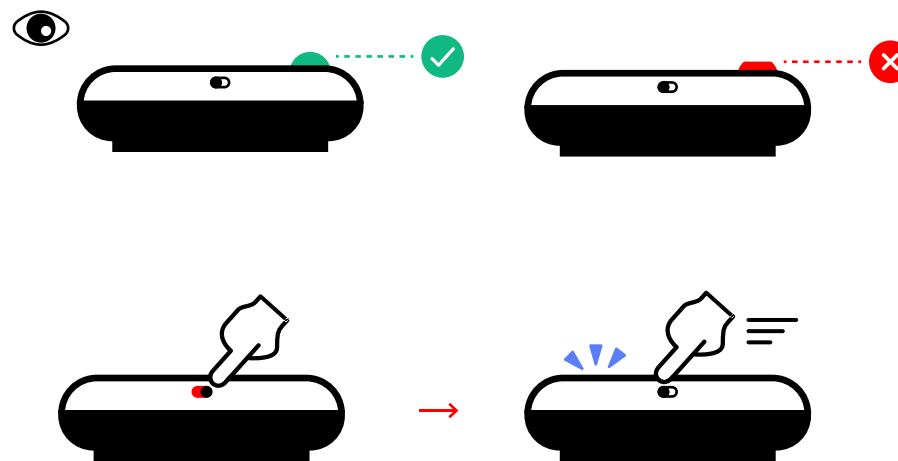

When switched on, unpaired Heatic Sensors set to the default Network ID will flash a yellow LED. If this does not occur, first ensure that the batteries are correctly installed. Next, verify that the PIR module is intact before mounting the sensor. For further assistance, contact your Butlr representative or submit a support ticket.

05\_  
Mount Heatic Sensor(s)

Traffic Mode

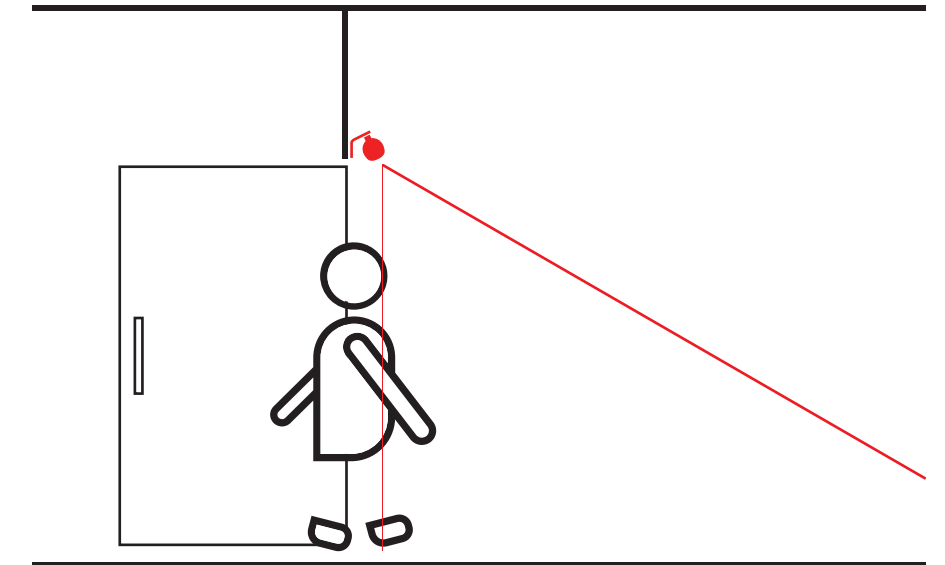

Traffic Mode provides aggregated totals of 'in' and 'out' movements based on a sensor's orientation, a user-defined door line, and the direction of entry. It is recommended to mount the sensor above entrances using either a Wall Mount or Ceiling Mount for optimal performance.

Presence Mode

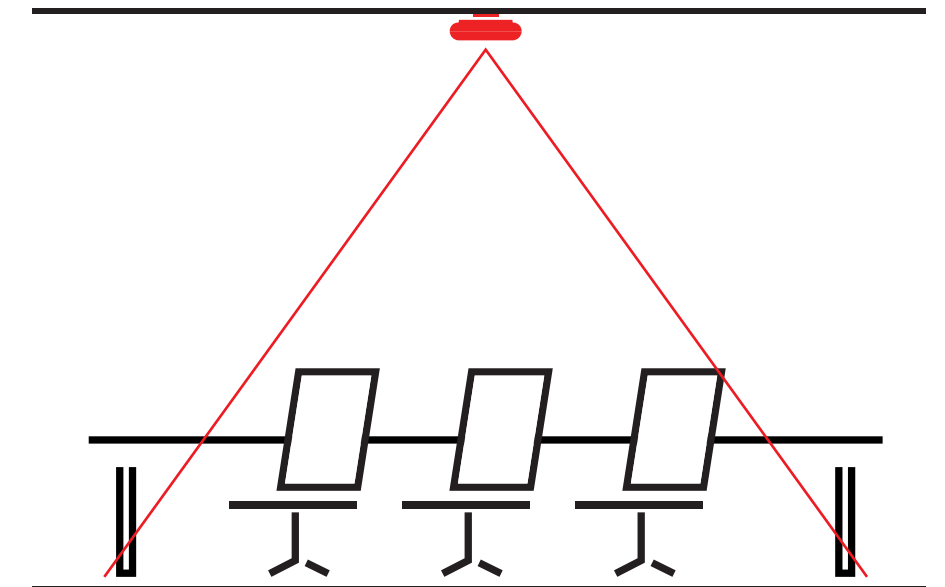

Presence Mode supplies the number and coordinates of individuals within its coverage area. For best results, it is recommended to mount the sensor in open areas and meeting rooms using a Ceiling Mount.

[Learning Center -> Mounting Guide](#)