



*intelli***ZENS** SMART PLUG ADAPTOR USER MANUAL



DEVICE PICTURE

***iz* PA xxxx**



1. Introduction:

Employment of IntelliZENS Smart Plug Adapter offers you device protection from surges and voltage fluctuations, allows you to measure power consumption patterns, monitor the appliances basic health via smart alerts and controlling options such as setting specific voltage and power consumption limits to your appliances. Following are the key features of the device you have purchased.

1.1 Protection:

IntelliZENS smart plug adapter offers a range of appliance protection features that are not supported by typical smart plugs out there in the market. This is why we call the device and solution rather than a smart plug!

- **Surge Protection** up to 5000V (5kV)
- **Over & Under Voltage Protection** by disconnecting the device from the supply when voltage fluctuates beyond normal range and reconnecting the device once voltage is stable.
- **Over & Under Operating Power Fluctuation Protection** by allowing you to set specific power consumption range based on your appliance's manufacturer recommendations. Once you set these limits, device will monitor power consumption of the appliance, detach the appliance from the supply and report to you via smart alerts if the device is connected to internet.
- **Zero Cross Voltage Switching** to ensure appliance always turns ON at the most safer load conditions. This is the same feature employed by some of your expensive and power fluctuation sensitive appliances. Adding this to the plug point itself can prevent situations such as having to replace appliance's PCB boards, which can be expensive.
- **Plug Point Fire Hazard Protection** via shutting down the plug point if the internal temperature of the plug socket exceeds certain limits. This feature helps conditions such as burnt plug sockets etc and acts as a fire hazard deterrent. In such conditions, this device will turn-off the appliance (no-load condition) and alerts the users via smart messages provided device is connected to the internet.



- **Electrical Earth Fault Detector** will generate smart alerts if your plug point's earth wiring is not optimally functional.

1.2 Measure & Monitor

IntelliZENS smart plug adapter comes with power consumption measurement circuit as well as integrated temperature and humidity monitoring sensors. This opens up a range of possibilities such as:

- **Predicting Maintenance Needs** in conditions such as air-conditioner not cooling the room efficiently to geyser turning ON more frequently. These factors unnecessarily cause excessive power consumption costing you more and attribute to increasing CO2 emissions which are high in power generation.
- **Periodic Power Consumption Reports** allowing you to predict potential electrical supply costs from the specific appliance as well as alerting you if the device is consuming excessive energy. This will allow you to take necessary actions to prevent such situations

1.3 Control

- Offers you both **OFFLINE & ONLINE control facilities** via supporting both WiFi (internet based) and Bluetooth (direct from the mobile). This will help you not only in controlling devices when there is no internet, but also semi-control appliances that are typically not in the range of WiFi
- Allows you to **set multiple schedules** for the appliance in the same day as well as supports **count down timer functionality**. Multiple schedules while offer you more flexibility in scheduling your appliances per your daily utilization patterns, count down times type additional scheduling facility can really help scheduling repetitive task such as water my plants for XX minutes every YY hours. Such features are very helpful when you have repetitive task requiring set-us such as balcony / roof gardens using drip irrigation etc.
- Ofcourse your plug also supports typical **Voice Activated Controls** such as controlling via Amazon Alex, Google Home etc as with any other smart plugs out there in the market.

Now you now know what all can you do with **👉 xxxx** you have purchased! Hope this device helps you offering you possible intelligence about your appliance and also insights on your usage patterns.



Please do provide us your feedback if you think, this device can be further improved in terms of features. Where possible, we will try to improve your experience on a continual basis via software upgrades to the device.

2. Setting Up & Registering Your Device

2.1 Where is What on the Device

Device Photos with notes.

2.2 Setting Up your Device

2.3 Download Evoluzn Smart Home App



Download from Google Play

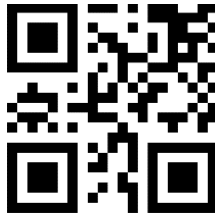

Download from IOS App Store



2.4 Create Your User Account

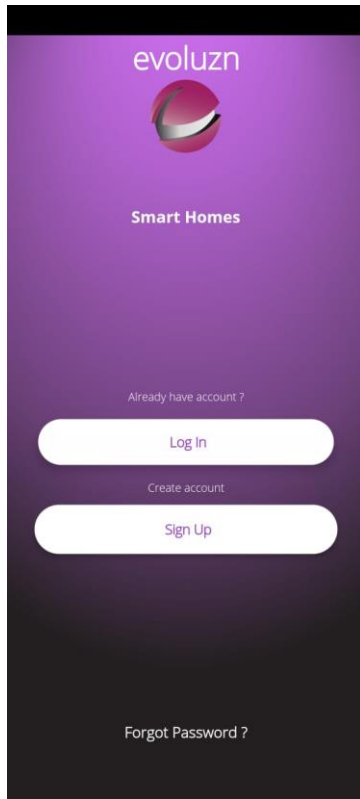

Click the Sign Up Button

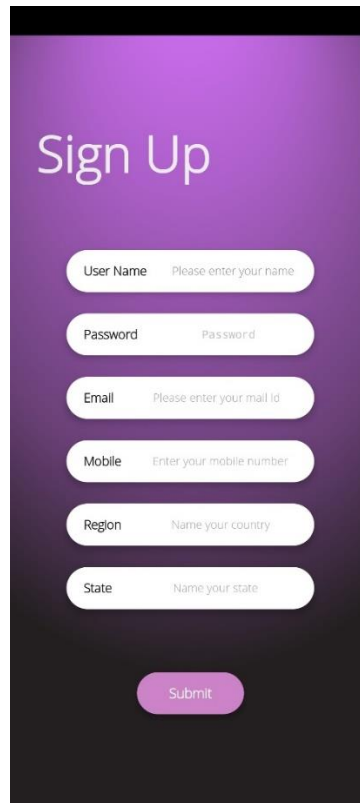

Enter your desired credentials and click Submit button



OTP Verification

Please enter your received (OTP) Below

Verify your OTP

You will receive an OTP via SMS & Email with in 1 to 2 minutes

Enter the OTP and click verify your OTP button

Once account is verified you will be redirected to Login screen

2.5 Log into Your Account

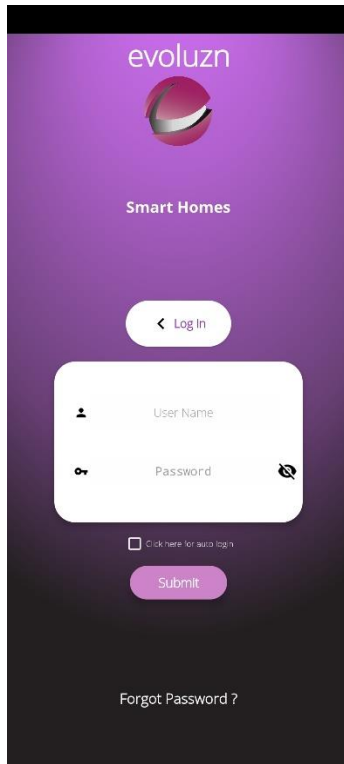

Enter your Login details

You will be Going to your home screen

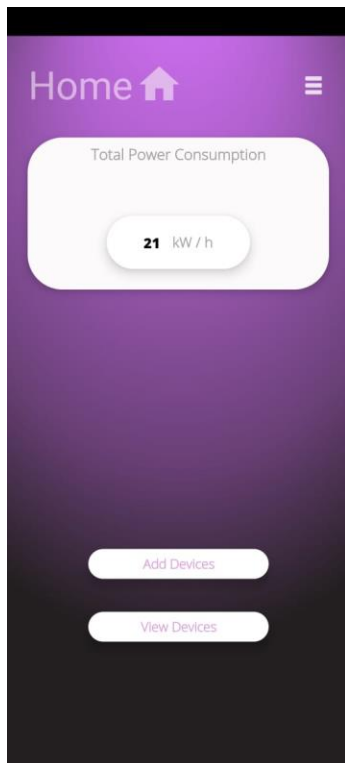



2.6 Add Device

Click on Add Device Button to add your appliance if you are setting up your device for the first time.

You will be directed to the following screen



NOTE : If you have only one device that device's identifier will show in the screen, if you have multiple devices at home app will show the full list of identifiers

2.6.1 Select the Bluetooth ID of Your Device & Connect

Select the desire device identifier and click the Connect Button



2.6.2 Verify Your Device Connection

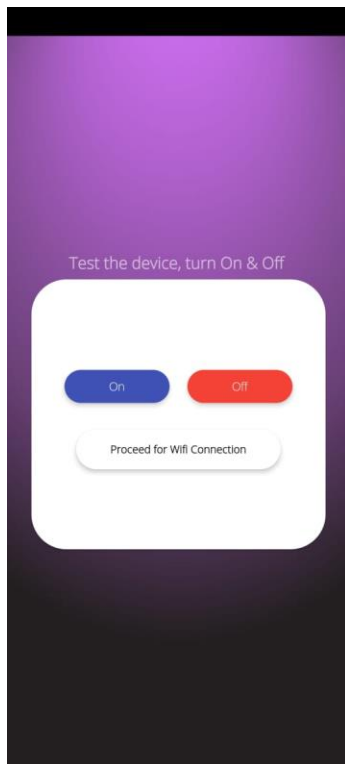

You can now verify whether your mobile is connected to the device by trying to Turn it OFF / ON.
If the device could be turned OFF and turned ON, you have successfully setup your device.



Now it is the time to connect your device to internet via WiFi by clicking the Proceed to WiFi Connection button

2.6.3 Select Your Home WiFi Network & Connect the Device

The app will show all the wifi network SSID's in the range

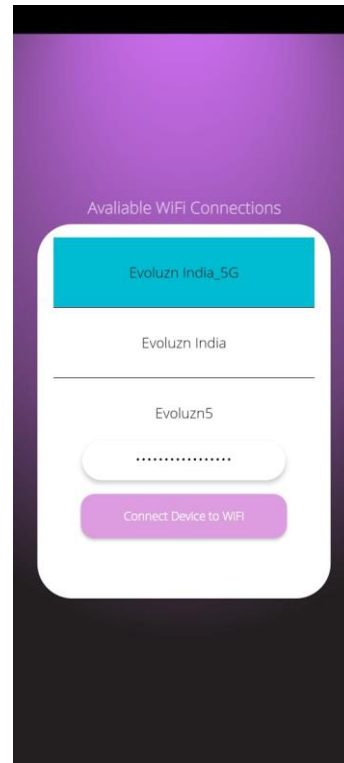

Select your desired home Wifi SSID and enter your wifi networks password in the Space shown as Please enter your Wifi password and click the Connect Device to WiFi button

2.6.4 Name Your Device

Now you can customize your device's name or leave it as it is.

It is recommended to customize your device's name (Ex: Main Hall AC) based on the appliance you are trying to connect to the IntelliZENS Smart Plug to track and control it easily and intuitively.

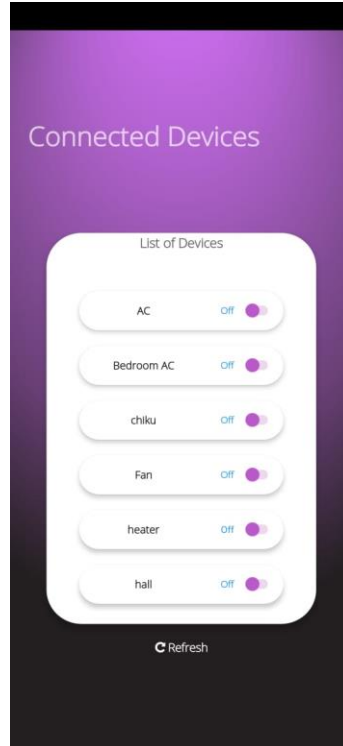
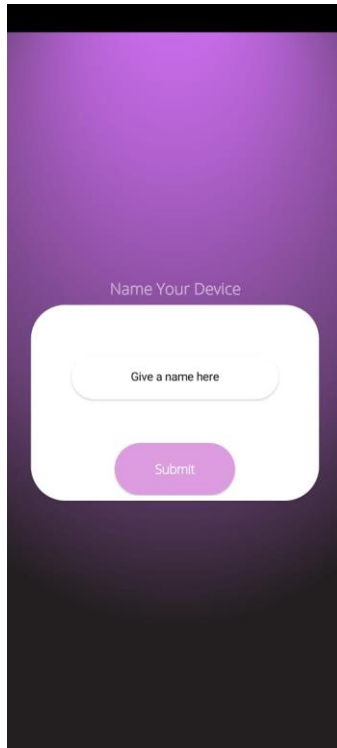

2.7 Check Added Devices on View Devices

3 Frequently Asked Questions

- 1) Do I have to connect this adapter to Air-conditioner or Geyser or water pump only?
- 2) Can I use multiple type of intelliZENS adapters in my house and control all via same APP?
- 3) Why does my LED keeps blinking?
- 4) Can I turn ON/OFF the device manually if I see no lights on the adapter?
- 5) Why is my WiFi connection not stable?
- 6) How to use the countdown timer function?
- 7) Is my User Registration data secured?
- 8) What to do if the device is defective?

4. Warranty Support

5. Device Specifications

Voice Control

Works with Alexa and Google Home

Remote Controlling

WiFi 2.4GHz 802.11 b / g/ n



Offline Controlling	Bluetooth v4.2
Max. Output Current	15A
Power Measurement	Up to 3600W Single Phase
Scheduling Support	YES
Input Voltage	85 to 265 Vac
Dimensions	48 (L) x 56 (H) x 40 (D) mm
Operational Temperature	0 deg ~ 60 deg C
Storage Temperature	-40 deg ~ 70 deg C
Operational Humidity	5% to 95% (non – condensing)

FCC Statement

This equipment has been tested and found to comply with the limits for a Class B digital device, pursuant to Part 15 of the FCC Rules. These limits are designed to provide reasonable protection against harmful interference in a residential installation. This equipment generates uses and can radiate radio frequency energy and, if not installed and used in accordance with the instructions, may cause harmful interference to radio communications. However, there is no guarantee that interference will not occur in a particular installation. If this equipment does cause harmful interference to radio or television reception, which can be determined by turning the equipment off and on, the user is encouraged to try to correct the interference by one or more of the following measures:

- Reorient or relocate the receiving antenna.
- Increase the separation between the equipment and receiver.
- Connect the equipment into an outlet on a circuit different from that to which the receiver is connected.
- Consult the dealer or an experienced radio/TV technician for help.

This device complies with part 15 of the FCC Rules. Operation is subject to the following two conditions:

(1) This device may not cause harmful interference, and (2) this device must accept any interference received, including interference that may cause undesired operation.

Changes or modifications not expressly approved by the party responsible for compliance could void the user's authority to operate the equipment.

The distance between user and device should be no less than 20cm.