

QT-916BT

Product description

Features

Bluetooth Version: 5.0

Wireless Range: 8-10m

Speaker Output: 2 x 3W

Frequency Range: 150HZ-20KHZ

Built-in Rechargeable Battery: 1200mAh

Function: BT/MIC / USB/LINE IN/TF /LED/Torch/ Phone holder

Function keys:

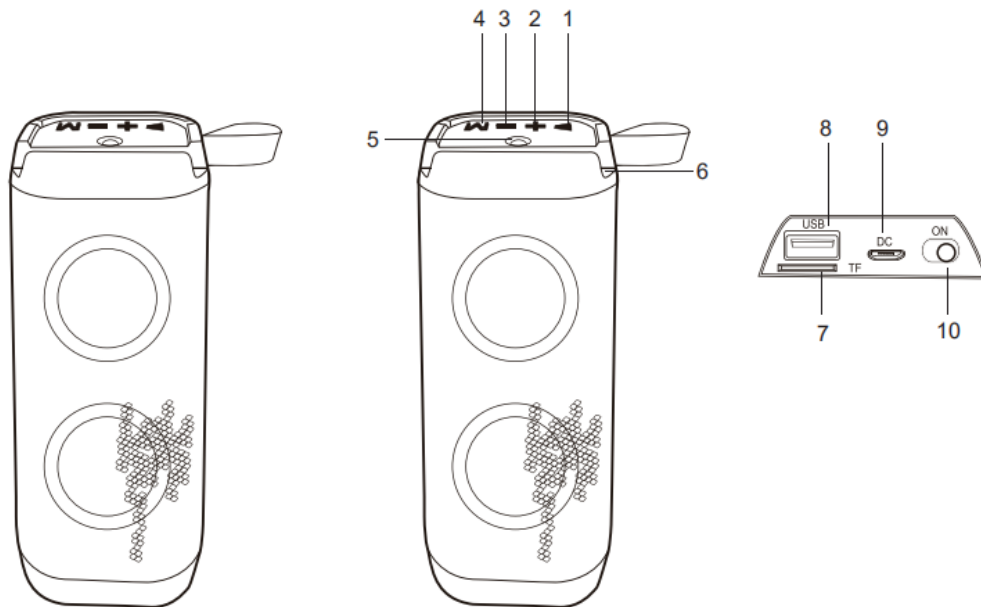

1. Pause/Play(▶)
2. Skip/Volume + Button (+)
3. Skip/Volume - Button (-)
4. Mode/ LED Torch ON/OFF Button(M)
5. LED Torch/Charging Indicator Light
6. Phone Holder
7. Micro SD Card Slot
8. USB Port
9. 5V = Charging Port
10. Power Button

Instructions for Use

Charging the Battery

The speaker is fitted with a 3.7V 1200mAh rechargeable battery (non-removable). It is recommended that the battery is fully charged before first use; this will take approx. 4 hours.

Connect the micro USB end of the USB charging cable into the 5V charging port on the back of the speaker and the other end to a compatible USB port.

Whilst charging, the charging indicator light will illuminate red. Once the battery has fully charged, the charging indicator light will switch off.

Carefully disconnect both ends of the USB charging cable and store it safely for future use.

Using the BluetoothLED Speaker

Basic Functionality

Turn on the speaker by sliding the power switch to the 'ON' position. Pause a track by pressing ►; push it again to resume the track.

Adjust the volume of the speaker using '+' and '-'. Press and hold '+' to increase the volume; decrease the volume by

pressing and holding '-' .

To switch to the next track, press '+'; play the previous track by pressing '-'.

Cycle between modes by pressing 'M' until the desired operation is selected.

Slide the power button to turn the speaker off.

Modes

The speaker must be turned on before using any of the following modes.

Using the Colour LED Light

The LED lights will automatically activate when the speaker is turned on.

Bluetooth Mode

Pairing with a Bluetooth Compatible Device

STEP 1: Once the speaker has been turned on, a tone will play to signal it is ready to be paired with a Bluetooth compatible device.

STEP 2: Search for the speaker using a Bluetooth compatible device. Select 'BT speaker' to connect and pair. Once a connection has been made, the LED lights will flash slowly and the speaker will play a tone to signal that the devices are paired.

STEP 3: To unpair or remove a Bluetooth compatible device from the speaker, turn off the Bluetooth function on the compatible device. The speaker can now be paired with a new compatible device.

Note: Once connected, sound can be controlled using either the speaker or the relevant controls on the Bluetooth compatible device.

Making Phone Calls via a Bluetooth Compatible Device

Once the Bluetooth compatible device has been paired with the speaker, phone calls can be made.

STEP 1: Using the Bluetooth compatible device, dial the number to be called and select the Bluetooth/hands-free option. The speaker and its built-in microphone will now act as a hands-free device.

STEP 2: To connect or disconnect a call using the speaker, press "▶"

STEP 3: The volume of the phone call can be controlled using either the speaker or the Bluetooth compatible device.

STEP 4: To reject an incoming phone call, press and hold "▶" for approx. 2-3 seconds.

Line-in AUX. Mode

Connect one end of the charging cable to the microcharging

port on the speaker and the AUX end to an MP3 player or other compatible audio source.

Note: Sound can now be controlled using the relevant controls on the compatible audio source; the speaker cannot be used to skip tracks during Aux. mode.

The speaker does not automatically switch to Aux. mode once the line-in Aux. cable (not included) is inserted, press 'M' until it is selected.

Micro SD Card/USB Mode

STEP 1: To use micro SD card mode, insert a micro SD card (not included) into the micro SD card slot. The speaker will automatically change to micro SD card mode.

STEP 2: To use USB mode, insert a compatible USB drive into the USB port, The speaker will automatically change to USB mode.

STEP 3: If the speaker does not automatically change to micro SD card or USB mode, press 'M' until the desired operation is selected.

Note: Once connected, sound can be controlled using the speaker.

No USB drive should be inserted whilst using micro SD card mode or vice versa, as this could interfere with playback.

The speaker will only recognise MP3 audio files; if other files are present on the Micro SD card or USB drive, this may prevent the speaker from playing.

Troubleshooting

The speaker has no power.

The speaker has run out of charge. Charge the speaker following the instructions in the section entitled 'Charging the Battery'.

The speaker has no sound.

The volume level is set too low. Check that the volume level is set at an audible level and adjust accordingly.

The speaker is not paired with a Bluetooth compatible device. Follow the instructions in the section entitled 'Bluetooth Mode'.

The speaker is not connected to a compatible audio source. Follow the instructions in the section entitled 'Aux. Mode'.

Unable to pair a Bluetooth device with the speaker.

The Bluetooth device is not compatible with the speaker. Check that the Bluetooth device is compatible with the speaker and that the Bluetooth function is switched on.

The charge of the speaker depletes quickly.

The volume level is set too high. Excessive use of the speaker at

high volumes will drain the battery quickly. Charge the speaker following the instructions in the section entitled 'Charging the Battery' and listen at a lower volume for better results.

The battery may be reaching the end of its service life and the unit will need to be disposed of.

FCC warning:

This device complies with part 15 of the FCC Rules. Operation is subject to the following two conditions: (1) This device may not cause harmful interference, and (2) this device must accept any interference received, including interference that may cause undesired operation.

Any Changes or modifications not expressly approved by the party responsible for compliance could void the user's authority to operate the equipment.

Note: This equipment has been tested and found to comply with the limits for a Class B digital device, pursuant to part 15 of the FCC Rules. These limits are designed to provide reasonable protection against harmful interference in a residential installation. This equipment generates uses and can radiate radio frequency energy and, if not installed and used in accordance with the instructions, may cause harmful interference to radio communications. However, there is no guarantee that interference will not occur in a particular installation. If this equipment does cause harmful interference to radio or television reception, which can be determined by turning the equipment off and on, the user is encouraged to try to correct the interference by one or more of the following measures:

- Reorient or relocate the receiving antenna.
- Increase the separation between the equipment and receiver.
- Connect the equipment into an outlet on a circuit different from that to which the receiver is connected.
- Consult the dealer or an experienced radio/TV technician for help.

The device has been evaluated to meet general RF exposure requirement. The device can be used in portable exposure condition without restriction.