

使用说明书

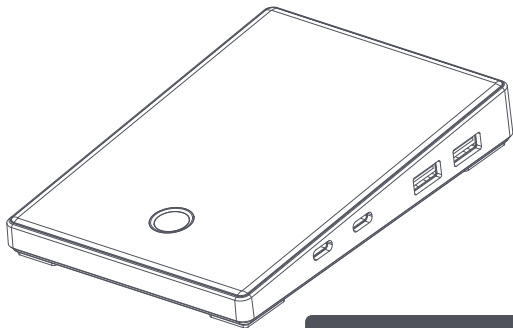

接口使用说明

*指纹识别功能需要安装驱动方可正常运行
驱动安装链接：www.lanq.com

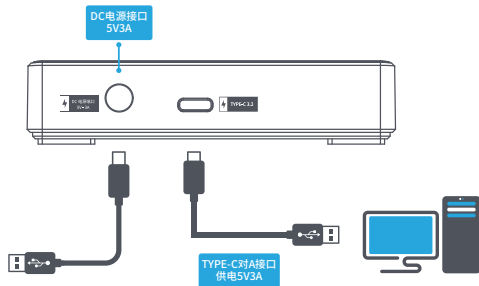

*使用赠送的USB数据线连接电脑主机提供数据传输

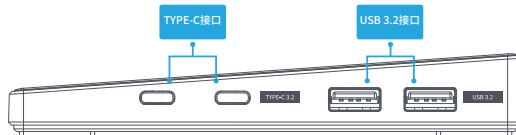

*辅助供电端口：
辅助供电端口需要外接充电器（充电器非标配）供电的情况：
1. 使用大硬盘进行数据传输
2. 给手机等设备充电



公司名称：狼群云创(深圳)电子有限公司
地址：深圳市龙岗区坂田街道南坑社区坂田街道文化街B区B316-321室之320室
网址：www.lanq.com
生产商：深圳市富邦新科技有限公司
地址：深圳市光明区马田街道合水口社区第四工业区安立邦科技园6号电梯3楼
Made in China



Guía

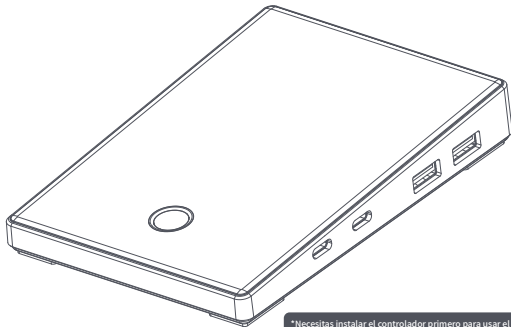

*Necesitas instalar el controlador primero para usar el escáner de huellas dactilares y la función Wi-Fi. URL de instalación del controlador: www.lanq.com

Especificación de la interfaz

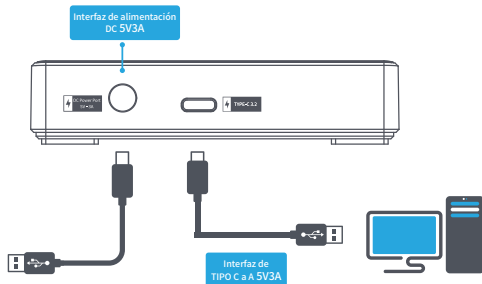

*Use el cable de datos USB de cortesía para conectar y transferir datos

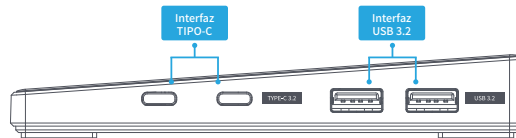
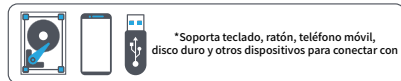

* Puerto de suministro de energía auxiliar:
Las siguientes circunstancias que darían lugar al puerto de suministro de energía auxiliar requieren un cargador externo (no un cargador estándar) para cargar:
1. Usar un disco duro grande para la transferencia de datos
2. Cargar los teléfonos móviles y otros dispositivos



Nombre de empresa: Langqun Yunchuang (Shenzhen) Electronics Co., Ltd.
Dirección: Habitación 320, Habitación B316-321, Bloque B, Calle de la Cultura Artesanal Bantian, Comunidad Nankeng, Calle Bantian, Distrito Longgang, Shenzhen
Sitio web: www.lanq.com
Fabricante: Shenzhen Fubon New Technology Co., Ltd.
Dirección: 3º piso, ascensor 6, Parque Tecnológico Anlibang, Cuarta Zona Industrial, Comunidad de Heshuikou, Calle Matian, Distrito de Guangming, Shenzhen

Made in China



LANQ Pcdocking (Standard)

Guidebook

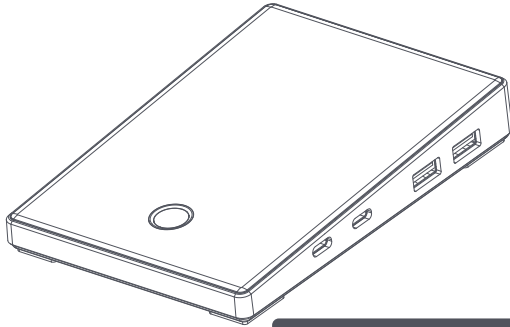

*You need to install the driver first to use Fingerprint scanner and Wi-Fi function. Driver installation URL: www.lanq.com

Interface Specification

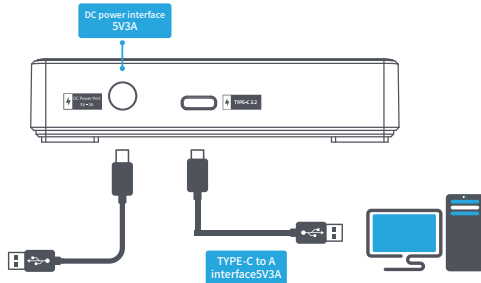

*Use the complimentary USB data cable to connect and transfer data

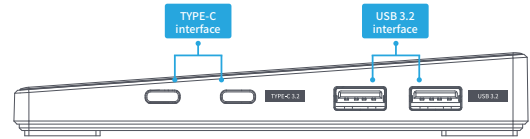

*Auxiliary power supply port:

The following circumstances that would lead to the auxiliary power supply port require an external charger (not standard charger) to charge:

1. Use a large hard drive for data transfer
2. Charge mobile phones and other devices

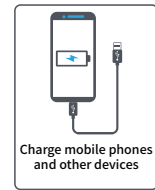
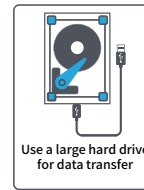

Company Name : Langqun Yunchuang (Shenzhen) Electronics Co., Ltd.

Address : Room 320, B316-321, Building B, Bantian Handmade Culture Street, Nankeng Community, Bantian Street, Longgang District, Shenzhen.CN

Website : www.lanq.com

Manufacturer: Shenzhen Fubon New Technology Co., Ltd.

Address: 3rd Floor, Elevator 6, Anlibang Technology Park, Fourth Industrial Zone, Heshuikou Community, Matian Street, Guangming District, Shenzhen

Address: 3rd Floor, Elevator 6, Anlibang Technology Park, Fourth Industrial Zone, Heshuikou Community, Matian Street, Guangming District, Shenzhen

Made in China



Manuel de référence

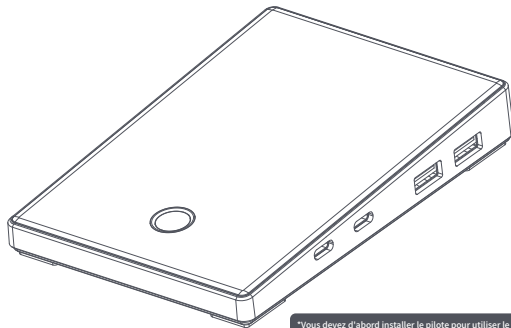

*Vous devez d'abord installer le pilote pour utiliser le scanner d'empreintes digitales et la fonction WI-FI. URL d'installation du pilote: www.lanq.com

Spécification de l'interface

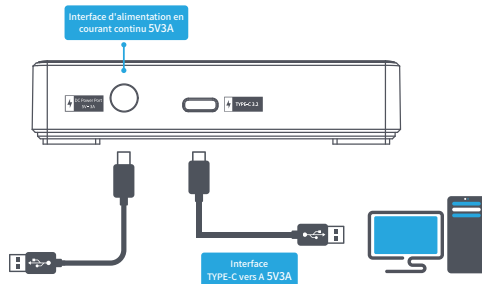

*Utilisez le câble de données USB gratuit pour connecter et transférer des données

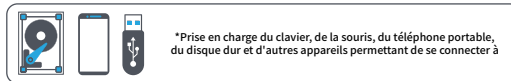

*Prise en charge du clavier, de la souris, du téléphone portable, du disque dur et d'autres appareils permettant de se connecter à

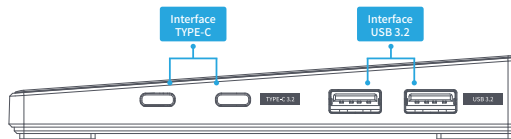

* Port d'alimentation électrique auxiliaire :

Les circonstances suivantes qui mèneraient au port d'alimentation auxiliaire nécessitent un chargeur externe (pas un chargeur standard) pour la charge :

1. Utilisez un grand disque dur pour le transfert de données
2. Chargez les téléphones mobiles et autres appareils

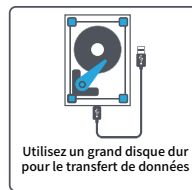

Utilisez un grand disque dur pour le transfert de données



Chargez les téléphones mobiles et autres appareils

Nom de la société : Langqun Yunchuang (Shenzhen) Electronics Co., Ltd.
Adresse : Salle 320, salle B316-321, bloc B, Rue de la culture artisanale de Bantian, Communauté de Nankeng, Rue Bantian, District de Longgang, Shenzhen
Site web : www.lanq.com
Fabricant : Shenzhen Fubon New Technology Co., Ltd.
Adresse : 3e étage, ascenseur 6, parc technologique d'Anlibang, quatrième zone industrielle, communauté de Heshuikou, Rue Matian, district de Guangming, Shenzhen

Made in China



Benutzerhandbuch

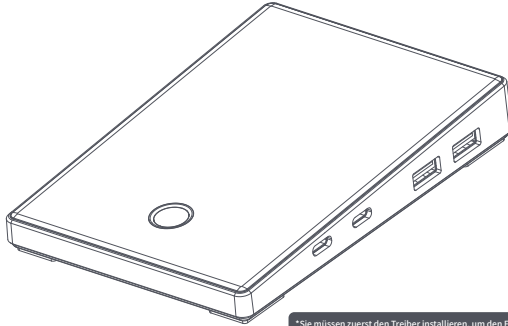

*Sie müssen zuerst den Treiber installieren, um den Fingerabdrucks Scanner und die Wi-Fi-Funktion zu nutzen. URL des Treiberinstallations: www.langq.com

Spezifikation der Schnittstelle

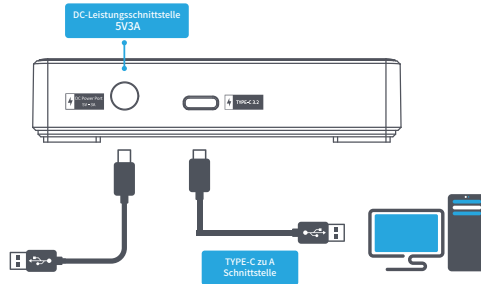

*Verwenden Sie das mitgelieferte USB-Datenkabel zum Anschließen und Übertragen von Daten



*Unterstützt Tastatur, Maus, Mobiltelefon, Festplatte und andere Geräte zur Verbindung mit

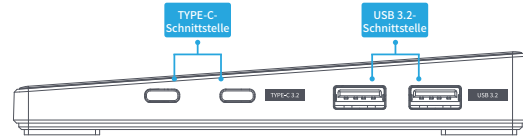

*Anschluss für Hilfsstromversorgung:
Die folgenden Umstände, die dazu führen würden, dass der Anschluss für die Hilfsstromversorgung ein externes Ladegerät (kein Standard-Ladegerät) zum Laden benötigt:

1. Verwenden Sie eine große Festplatte für die Datenübertragung
2. Laden von Mobiltelefonen und anderen Geräten



Verwenden Sie eine große Festplatte für die Datenübertragung



Laden von Mobiltelefonen und anderen Geräten

Firmenname: Langqun Yunchuang (Shenzhen) Electronics Co., Ltd.
Adresse: Raum 320, Raum B316-321, Block B, Bantian Handgemachte Kultur Straße, Nankeng Gemeinschaft, Bantian Straße, Longgang Bezirk, Shenzhen
Webseite: www.langq.com
Hersteller: Shenzhen Fubon New Technology Co., Ltd.
Adresse: 3. Stock, Aufzug 6, Anliang Technologie-Park, vierte Industriezone, Heshuikou-Gemeinde, Matian Straße, Guangming Bezirk, Shenzhen

Made in China



Manuale

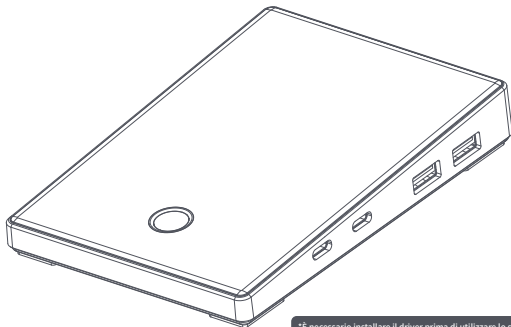

*È necessario installare il driver prima di utilizzare lo scanner di impronte digitali e la funzione Wi-Fi. URL per l'installazione del driver: www.lanq.com

Specifiche degli ingressi

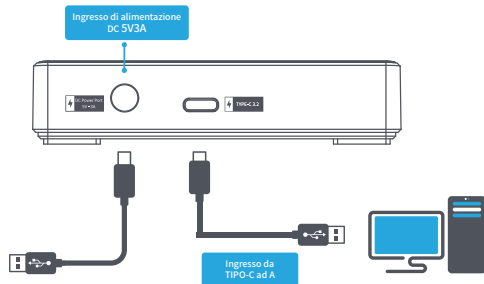

*Utilizzare il cavo dati USB in dotazione per il collegamento e il trasferimento dei dati

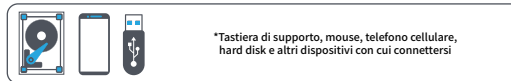

*Tastiera di supporto, mouse, telefono cellulare, hard disk e altri dispositivi con cui connettersi

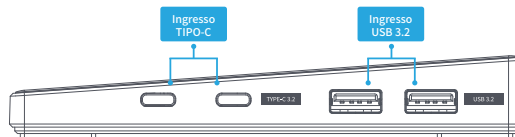

* Porta di alimentazione ausiliaria:

Le seguenti circostanze che richiederebbero la porta di alimentazione ausiliaria richiedono un caricatore esterno (non quello standard) per la ricarica:

1. Utilizzare un hard drive di grandi dimensioni per il trasferimento dei dati
2. Ricarica telefoni cellulari e altri dispositivi



Utilizzare un hard drive di grandi dimensioni per il trasferimento dei dati



Ricarica telefoni cellulari e altri dispositivi

Nome della società: Langqun Yunchuang (Shenzhen) Electronics Co., Ltd.
Indirizzo: Ufficio 320, Ufficio B316-321, Blocco B, Via Bantian Handmade Culture, Comunità di Nankeng, Via Bantian, Distretto di Longgang, Shenzhen, Shenzhen
Sito web: www.lanq.com
Produttore: Shenzhen Fubon New Technology Co., Ltd.
Indirizzo: 3° piano, Ascensore 6, Anlibang Technology Park, Quarta Divisione Industriale, Comunità Heshuikou, Via Matian, Distretto di Guangming, Shenzhen

Made in China



FCC Caution: Any changes or modifications not expressly approved by the party responsible for compliance could void the user's authority to operate this equipment.

This device complies with part 15 of the FCC Rules. Operation is subject to the following two conditions: (1) this device may not cause harmful interference, and (2) this device must accept any interference received, including interference that may cause undesired operation. This device and its antenna(s) must not be co-located or operating in conjunction with any other antenna or transmitter.

NOTE: This equipment has been tested and found to comply with the limits for a Class B digital device, pursuant to Part 15 of the FCC Rules. These limits are designed to provide reasonable protection against harmful interference in a residential installation. This equipment generates, uses and can radiate radio frequency energy and, if not installed and used in accordance with the instructions, may cause harmful interference to radio communications. However, there is no guarantee that interference will not occur in a particular installation. If this equipment does cause harmful interference to radio or television reception, which can be determined by turning the equipment off and on, the user is encouraged to try to correct the interference by one or more of the following measures:

- Reorient or relocate the receiving antenna.
- Increase the separation between the equipment and receiver.
- Connect the equipment into an outlet on a circuit different from that to which the receiver is connected.
- Consult the dealer or an experienced radio/TV technician for help.

To maintain compliance with FCC's RF Exposure guidelines, This equipment should be installed and operated with minimum distance between 20cm the radiator your body: Use only the supplied antenna.

The device is restricted to indoor use only when operating in 5150 to 5250MHz frequency range.