

Quick Start Guide

True Wireless Earbuds

Please refer to this Quick Start Guide for your first time using earbuds. About the FAQs and more detailed information, please study the user manual.

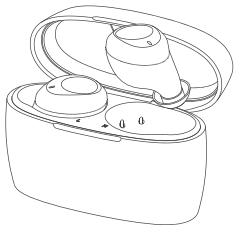

XT100

Before Use

Please take the following steps before using the earbuds for the first time:

- 1 Put the earbuds into the charging case.

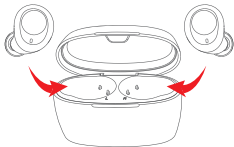

- 2 Close the lid and let the earbuds charge for about 10 minutes.



Charging

Charge the Earbuds

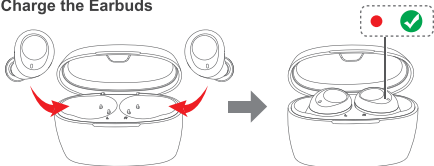

Charge the Charging Case

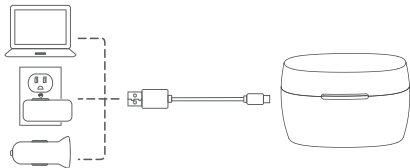

Powering ON / OFF

Power On

Take the earbuds out of the charging case.

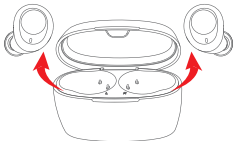

Power Off

Put the earbuds back in the charging case and close the lid.

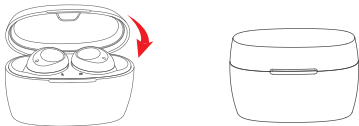

Pairing

- 1 Turn on the Bluetooth of your phone.

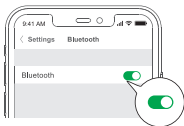



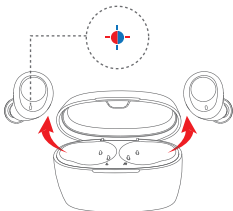



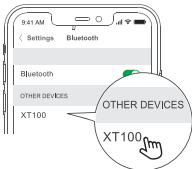







- 2 Take out the earbuds (LED indicator flashes red and blue alternately).



- 3 Choose "XT100" to connect.



Button Control

	  x1	  x3	  x2
	  x1	  x2	Voice Control  ⌚2"
	ON/OFF  ⌚5"		

x1: Single tap

x2: Double tap

x3: Triple tap

⌚2": Tap and hold for 2 seconds.

⌚5": Tap and hold for 5 seconds.

LED Indicator Guide

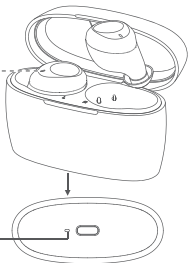
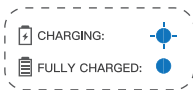
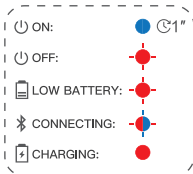

- : LED indicator stays blue.
- (red, flashing) : LED indicator **flashes red**.
- (red and blue, alternating) : LED indicator **flashes red and blue alternately**.
- (red) : LED indicator stays red.
- (blue, flashing) : LED indicator **flashes blue**.

Wearing

1



L



M



S

Choose a pair of ear tips that let you comfortable.

2



Put the earbud into your ear and rotate it to fit.

Questions & Answer

Q: Pairing fails.

- A:** 1) Put the earbuds into the charging case and being charged around 10 mins.
- 2) Take out the earbuds from the case and enter into the paring mode.
- 3) Choose “ XT100 ” on your phone to pair.

If the pairing still fails, check the following points:

- Make sure the earbuds and your Bluetooth device are next to each other and within 3 feet that are not obstacles between.
- There is no signal interference nearby (check the “Connections is not stable” hereafter for signal interference conditions).
- Clear all your Bluetooth device address on the Bluetooth list inside your mobile phone.

Q: I paired the earbuds with my mobile device before, however I failed to pair them again.

A: Turn on the Bluetooth on your phone.

Delete all your previous Bluetooth connected address inside your phone. By selecting "XT100" under the list, then connect again. If it still cannot connect, please remove the Bluetooth connected address "XT100" under the list and pair your earbuds again.

Q: Connection is not stable.

A: When Bluetooth signal is transmitted wirelessly, signals can be affected. Then, it would let the sound of the earbuds intermittent, in the following conditions:

- The distance between the earbuds and your Bluetooth device address is at the edge of the Bluetooth pairable distance.
- Transmitted signals encounter obstacles or human body blockage.

- There are high-power electronic devices nearby.
- There are other Bluetooth devices and are being turned on / off nearby.

To resume stable connection between the earbuds and your Bluetooth device, try to avoid the above conditions and pairing again. Follow the steps in the pairing fails procedures set forth above.

Q: Power runs out fast.

A: The earbuds playtime varies according to volume level and audio content. To avoid unnecessary power consumption, please put the earbuds into the charging case when not in use.



Printed in China

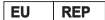

FCC ID: 2AZ5N–XT100

Xtremetec is a trademark owned by J2 International Company Limited

Copyright 2020 - All rights reserved J2 International Company Limited

Federal Communications Commission (FCC) Statement. This device complies with part 15 of the FCC Rules. Operation is subject to the following two conditions:

- (1) This device may not cause harmful interference, and
- (2) this device must accept any interference received,

including interference that may cause undesired operation. Note: This equipment has been tested and found to comply with the limits for a Class B digital device, pursuant to part 15 of the FCC Rules. These limits are designed to provide Reasonable protection against harmful interference in a residential installation. This equipment generates, uses and can radiate radio frequency energy and, if not installed and used in accordance with the instructions, may cause harmful interference to radio communications. However, there is no guarantee that interference will not occur in a particular installation. If this equipment does cause harmful interference to radio or television reception, which can be determined by turning the equipment off and on, the user is encouraged to try to correct the interference by one or more of the following measures:

- Reorient or relocate the receiving antenna.
- Increase the separation between the equipment and receiver.
- Connect the equipment into an outlet on a circuit different from that to which the receiver is connected.
- Consult the dealer or an experienced radio/TV technician for help.

Warning: Changes or modifications made to this device not expressly approved by **J2**

International Group Limited may void the FCC authorization to operate this device. Note: The manufacturer is not responsible for any radio or TV interference caused by unauthorized modifications to this equipment. Such modifications could void the user's authority to operate the equipment.

RF exposure statement:

The device complies RF exposure requirement and can installed and used without restriction