

说明书

骑马订 尺寸:62mmX80mm

INKBIRD

SMART HOME SMART LIFE

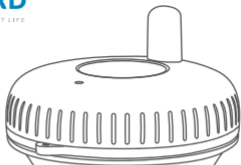

IBS-P01R

Wireless Pool Thermometer

- 01- Introduction
- 02- Parameters
- 03- Basic Operation



1. Introduction

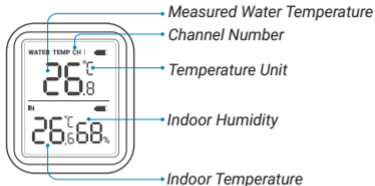

Receiver(Temperature&Humidity Monitor)

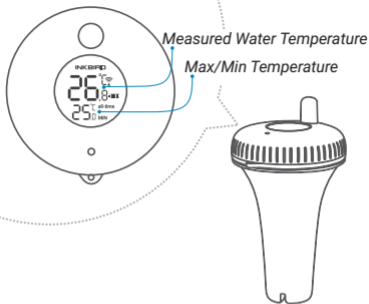

Pool Thermometer

2. Parameters

Battery: 4*AAA 1.5V Battery(not included)

Transmission Frequency: 433Mhz

Transmission Distance: up to 300 ft in open

space, if there is interference, the transmission distance will be limited.

Receiver:

Temperature Measurement Range: $-10^{\circ}\text{C}\sim 60^{\circ}\text{C}$
($14^{\circ}\text{F}\sim 140^{\circ}\text{F}$)

Temperature Measurement Accuracy: $\pm 1.0^{\circ}\text{C}$
($\pm 1.8^{\circ}\text{F}$)

Temperature Display Accuracy: 0.1°C (0.1°F)

Humidity Measurement Range: $0\sim 99\%$

Humidity Measurement Accuracy: $\pm 5\%$

Humidity Display Accuracy: 1%

Wireless pool Thermometer:

Temperature Measurement Range: $-40^{\circ}\text{C}\sim 70^{\circ}\text{C}$
($-40^{\circ}\text{F}\sim 158^{\circ}\text{F}$)

Temperature Measurement Accuracy: $\pm 1^{\circ}\text{C}$ ($\pm 1.8^{\circ}\text{F}$)

Temperature Display Accuracy: 0.1°C (0.1°F)

Temperature Sampling Period: 10 seconds

Waterproof Level: IPX7

Warranty: 1 year

3. Basic Operation

3.1 Buttons

3.1.1 Receiver

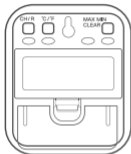

CH/R: The device support max 3 transmitters at a time, you can press the button to switch between the channels(CH1, CH2, CH3, CH8), the screen will display the measured water temperature of the

chosen one(CH1, CH2, CH3). If CH8 is selected, the measured temperature of CH1, CH2, and CH3 will be displayed for 5 seconds each alternately.

Hold the button for 5 seconds to disconnect from the pool thermometer, then reinstall the batteries of the pool thermometer, the thermometer will synchronize with the receiver automatically within 2 minutes.

Note: Please put the pool thermometer as close as to the receiver during synchronization.

MAX/MIN/CLEAR: Press the button to check the history maximum and the history minimum temperature of the pool thermometer.

Hold the button for 5 seconds to clear the history temperature data, the device will record the new maximum and minimum temperature after clearing the history data.

°C/°F: Press the button to switch the temperature unit between °C and °F in normal working state.

When the receiver displays the maximum/minimum temperature of the pool thermometer, press the button to switch the maximum&minimum temperature recording time interval between ALL-TIME and 24 hours.

3.1.2 Wireless Pool Thermometer

Twist off the lid of the thermometer as shown below, all the buttons of the pool thermometer are designed inside.

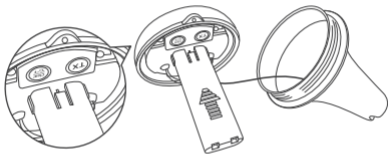

Clear/°C/°F: Press the button to clear the history temperature data, the device will record the new maximum and minimum temperature after clearing the history data.

Hold the button for 5 seconds to switch the temperature unit between °C and °F.

TX: Press the button to send temperature data

to the receiver manually, the blue light of the pool thermometer will flash once when the transmission is successful.

Hold the button for 5 seconds to reset the pool thermometer and disable the synchronization, reinstall the batteries of the pool thermometer, it will synchronize with the receiver automatically within 2 minutes.

Note: Please put the pool thermometer as close as to the receiver during synchronization.

3.2 Synchronization and Reset

3.2.1 Synchronization

- Install 2 AAA batteries in the receiver first, then install 2 AAA batteries in the pool thermometer later, the data of the pool thermometer will be synchronized on the receiver automatically within 2 minutes.

- Once the receiver is successfully synchronized with the pool thermometer, the receiver will display the measured temperature of the pool thermometer and record the registration information of it. Users will not have to repeat the synchronization steps after restarting the receiver.
- The blue light on the pool thermometer will flash once when the data of it has successfully transmitted to the receiver, and the RF signal icon will be displayed on the screen of the receiver for 5 seconds after the blue light flashes, indicates that the receiver has successfully received the data and updated the current temperature in real time.
- If the receiver can not receive the data from the pool thermometer for a long time(15 minutes or more), “-.-” will be displayed on the screen.
- If the synchronization is failed, please repeat the steps above.

3.2.2 Reset

Hold the TX button of the pool thermometer for 5 seconds to reset the synchronization between it and the receiver.

Follow the steps of 3.2.1 to re-synchronize the pool thermometer and the receiver.

3.3 Battery Installation

- Unscrew the lid of the pool thermometer as shown below.

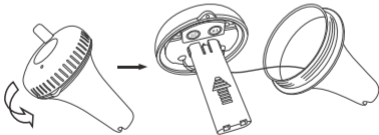

- Remove the battery cover, install 2 AAA batteries, put the cover back.

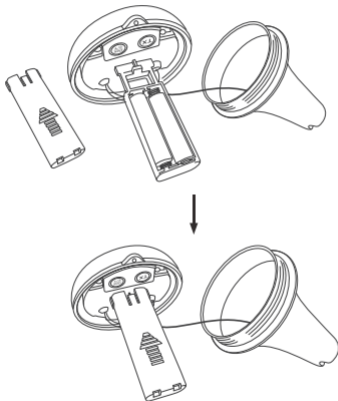

- Make sure the silicone waterproof ring is well placed, then close and tighten the lid of the pool thermometer.



FCC Requirement

changes or modifications not expressly approved by the party responsible for compliance could void the user's authority to operate the equipment.

This device complies with Part 15 of the FCC Rules. Operation is subject to the following two conditions:

- (1) this device may not cause harmful

interference, and

(2) this device must accept any interference received, including interference that may cause undesired operation.

Note: This equipment has been tested and found to comply with the limits for a Class B digital device, pursuant to Part 15 of the FCC Rules. These limits are designed to provide reasonable protection against harmful interference in a residential installation. This equipment generates, uses, and can radiate radio frequency energy, and if not installed and used in accordance with the instructions, may cause harmful interference to radio communications. However, there is no guarantee that interference will not occur in a particular installation. If this equipment does cause harmful interference to radio or television reception, which can be determined by turning the equipment off and on, the user is encouraged to try to correct the interference by

one or more of the following measures:

- Reorient or relocate the receiving antenna.
- Increase the separation between the equipment and receiver.
- Connect the equipment into an outlet on a circuit different from that to which the receiver is connected.
- Consult the dealer or an experienced radio/TV technician for help.



INKBIRD TECH.C.L

Support@inkbird.com

www.inkbird.com

+86-0755-22747857

4/F E, Bldg 713, Pengji Industrial Zone,
Liantang St, Luohu Dist., Shenzhen, China.

