



Uinees
Quick Start Guide
L2

EN CONTENTS

01 IN THE BOX

PRODUCT OVERVIEW 02

03 APP SETUP

INSTALLATION 06

17 LIGHT INDICATIONS

CAUTIONS 18

20 NEED HELP?

IN THE BOX



Camera



Quick Start Guide



Charing Cable



Extension Charging Cable



Camera Bracket



Installation Sticker



Solar Panel Bracket



Solar Panel



Screw Pack



Washer

1EN

PRODUCT OVERVIEW

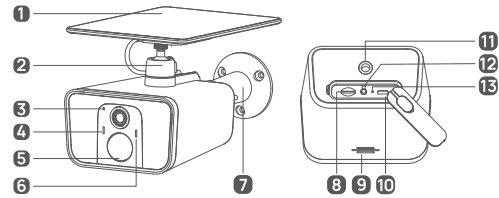

- | | |
|------------------------|---|
| 1. Solar Panel | 8. MicroSD Slot
(SD card not included) |
| 2. Solar Panel Bracket | 9. Speaker |
| 3. Microphone | 10. Type-C Charging Port |
| 4. Light Sensor | 11. 1/4 Inch Mounting Hole |
| 5. Motion Sensor | 12. Setup Button |
| 6. LED Indicator | 13. Charging LED |
| 7. Camera Bracket | |

EN 2

APP SETUP

1. Scan the QR code below to download the AiDot APP. Or search for "AiDot" in the App Store or Google Play.



2. After you register and log in to the APP, open the silicon cover on the back of the device. When the device is powered off, hold down the 3s setup button. When you hear "DU~", the device is powered on. When the device is powered on, double-click the setup button. The device will restart. You will hear "Welcome, please add the camera in the APP" and the light is flashing green. If the indicator does not respond, fully charge the device before use.

3 EN

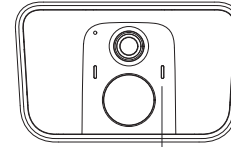

LED Indicator flashing green

■ Setup button description

Device Status	Operation	Description
Device power on	Restoring factory settings	Device power off

■ Battery charging description

Battery Status	Description
Solid Red	Charging
Flashing Red	Charge complete

EN 4

3. In the Aidot app press "+" select "L2", and follow the instructions on App to connect the camera to Wi-Fi.
4. For a better user experience, we recommend fully charging the device before installing it.
5. Place the camera in the area where you plan to install to test the video quality, and ensure that the camera can work normally after the final installation, especially the video streaming.

5 EN

INSTALLATION

■ Placement

To maximize the performance of the solar panel, we offer two installation methods. We recommend following these steps to install the camera:

A. Integrated installation

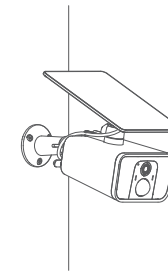
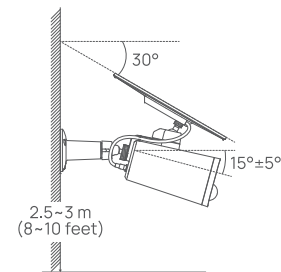

EN 6

B. Split installation

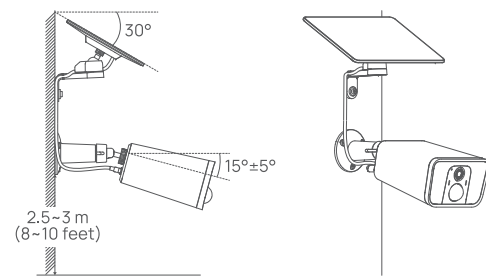

7 EN

■ Integrated installation

1. Choose a suitable installation location and apply the installation sticker. Drill a hole with a $13/64$ inch (5.16mm) drill bit, then insert the anchor into the hole. The anchor is necessary for walls that are made of hard materials such as concrete, brick or stucco.

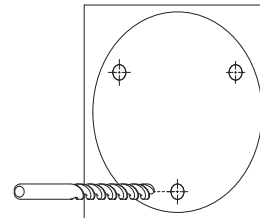

EN 8

2. Loosen the camera bracket slightly and adjust its position for screw installation. Secure the camera to the wall using the provided screws.

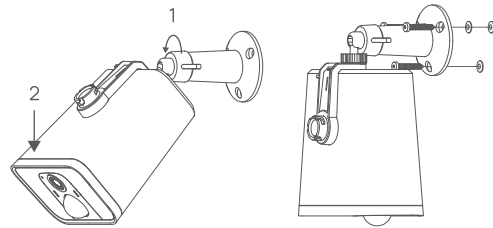

9 EN

3. Insert the knob on the solar panel into the bracket, then rotate the knob to align with the scale line to secure the solar panel.

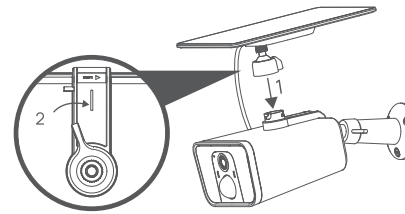

EN 10

4. Plug in the charging cable of solar panel into the camera. Adjust it to the desired position and securely fasten the camera.

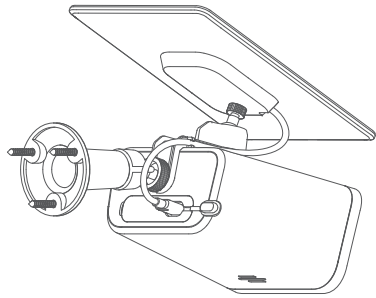

11EN

● Split installation

1. Loosen the camera bracket and remove the solar panel mounting bracket.

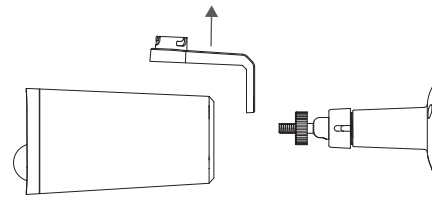

EN 12

2. Choose a suitable installation location and apply the installation sticker. Drill a hole with a 13/64 inch (5.16mm) drill bit, then insert the anchor into the hole. The anchor is necessary for walls that are made of hard materials such as concrete, brick or stucco.

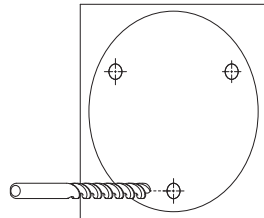

13 EN

3. Loosen the camera bracket slightly and adjust its position for screw installation. Secure the camera to the wall using the provided screws. Adjust the camera to the desired position and secure it in place.

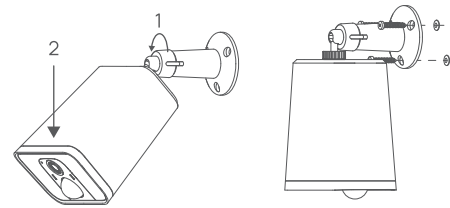

EN 14

4. The solar panel has two optional mounting locations: on the wall or on the roof. Please select the appropriate installation location. Drill a hole with a 13/64 inch (5.16mm) drill bit, then insert the anchor into the hole. Secure the solar panel using the provided screws and washers.

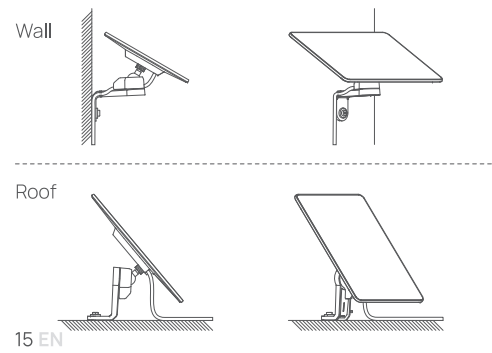

5. Please use the included extension charging cable to connect the solar panel and the camera, making sure not to move the waterproof kit.

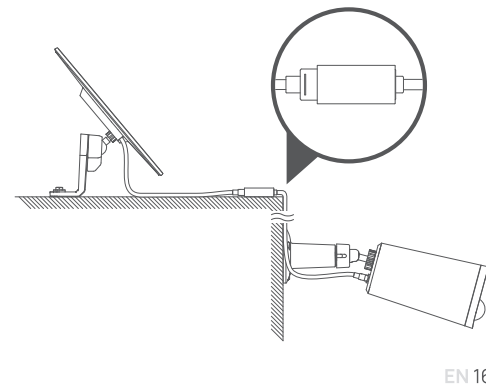

LIGHT INDICATIONS

Camera Status	Description
Solid Red	Power on/System booting/Factory resetting
Flashing Red	Wireless/Cloud connecting fail
Solid Green	Wireless connection successful
Flashing Green	System ready for Wi-Fi setup/Firmware update

17 EN

CAUTIONS

To avoid personal injury and/or possible product damage, the following cautions must be followed:

1. Please use the provided adapter instead of others in case of any damage to the product.
2. Keep out of reach of children. This product contains small magnets and other small parts, which can cause choking or injury if ingested.
3. To prevent early failure, the camera should only be installed in operating environments ranging between -20°C ~ 50°C (-4°F ~ 122°F).
4. Do not install
 - close to heat source
 - near the metal objects and mirrors that cause radio signal attenuation or shading.
5. Do not disassemble or reinstall the camera, otherwise it may cause security risks.
6. Unplug the power cord before cleaning. Do not clean the camera with any liquids, spray cleaner or wet cloth.
7. The slot and opening are used for ventilation, not allowed to be blocked or covered.
8. This product only can be connected to 2.4G WIFI.

● Note: The grantee is not responsible for any changes or modifications not expressly approved by the party responsible for compliance. Such modifications could void the user's authority to operate the equipment.

● Note: This equipment has been tested and found to comply with the limits for a Class B digital device, pursuant to part 15 of the FCC Rules. These limits are designed to provide reasonable protection against harmful interference in a residential installation. This equipment generates uses and can radiate radio frequency energy and, if not installed and used in accordance with the instructions, may cause harmful interference to radio communications. However, there is no guarantee that interference will not occur in a particular installation. If this equipment does cause harmful interference to radio or television reception, which can be determined by turning the equipment off and on, the user is encouraged to try to correct the interference by one or more of the following measures:

- Reorient or relocate the receiving antenna.
- Increase the separation between the equipment and receiver.
- Connect the equipment into an outlet on a circuit different from that to which the receiver is connected.

EN 18

- Consult the dealer or an experienced radio/TV technician for help.

■ **FCC Statement**

This device complies with Part 15 of the FCC Rules. Operation is subject to the following two conditions:

- (1) This device may not cause harmful interference.
- (2) This device must accept any interference received, including interference that may cause undesired operation.

■ **RF Exposure Statement**

This equipment complies with FCC radiation exposure limits set forth for an uncontrolled environment. This equipment should be installed and operated with a minimum distance of 20 cm between the radiator and your body.

■ **ISED Statement**

This device contains licence-exempt transmitter(s)/receiver(s) that comply with Innovation, Science and Economic Development Canada's licence-exempt RSS(s). Operation is subject to the following two conditions:

1. This device may not cause interference.
2. This device must accept any interference, including interference that may cause undesired operation of the device.

L'émetteur/récepteur exempt de licence contenu dans le présent appareil est conforme aux CNR d'Innovation, Sciences et Développement économique Canada applicables aux appareils radio exempts de licence.

L'exploitation est autorisée aux deux conditions suivantes :

1. L'appareil ne doit pas produire de brouillage;
2. L'appareil doit accepter tout brouillage radioélectrique subi, même si le brouillage est susceptible d'en compromettre le fonctionnement.

This equipment complies with ISED RSS-102 radiation exposure limits set forth for an uncontrolled environment.

This equipment should be installed and operated with a minimum distance of 20cm between the radiator and any part of your body.

Pour se conformer aux exigences de conformité CNR 102 RF exposition, une distance de séparation d'au moins 20 cm doit être maintenue entre l'antenne de cet appareil et toutes les personnes.

19 EN

NEED HELP?

Email our support team:
support@iwinees.com

Linkzone Technology Co., Limited
Room 510, 5/F, Wayson Commercial
Building, 28 Connaught Road West,
Sheung Wan, Hong Kong
Phone: 1-888-846-6470
Website: www.iwinees.com
Made in China



Help Center

EN 20

骑马钉
材质：105G铜版纸
尺寸：80*80mm
展开尺寸：160*80mm
印刷方式：单黑双面印刷、过光膜

*红字部分不印刷