

[www.solidremote.help](http://www.solidremote.help)

Self installation assistance /  
YouTube installation videos

#### Programming Instructions for Garage Door Opener

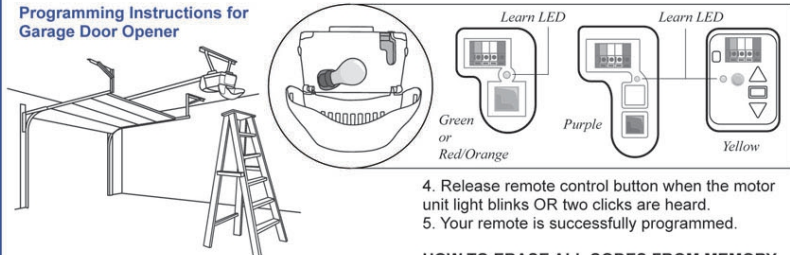

1. Locate the Smart / Learn button on your garage door opener (you will need a ladder).
2. Press and release the learn button on the motor unit. The learn indicator will glow steadily for 30s.
3. Within 30 seconds, press and hold the button you wish to use on hand-held remote.

4. Release remote control button when the motor unit light blinks OR two clicks are heard.
5. Your remote is successfully programmed.

**HOW TO ERASE ALL CODES FROM MEMORY**  
Press and hold the learn button on the motor unit for 6 seconds until the learn indicator light turns off.

**Note:** Use when programming failed due to full memory or you have accidentally programmed unwanted buttons. After erasing, you will need to program all remotes again.

#### Change Button's Working Mode on Remote

**Mode 1 - works with Purple/Red/Orange**  
**Mode 2 - works with Green/Yellow**

**Important Note:** Some learn button color may **NOT** be supported by your remote. Refer to product listing description for actual compatibility info.

**Buttons A+B** are the two buttons with hatching lines illustration on manual cover page.

1. Press and hold buttons A+B simultaneously for 3 seconds until LED blinks, then release all buttons.
2. Press and hold the button you would like to change working mode, LED will change to either **SOLID (Mode 1)** or **FLASHING (Mode 2)**.
3. Release the button (which just changed to new working mode), try program it again with opener.



**LED always flashes in step 2 above?**

Please change battery follow steps on next page.

#### Battery

The LED on your remote will turn dim and show rapid flashes when the battery is low and needs to be replaced.

To replace battery, open the case as shown below. Remove circuit board if necessary. Slide old battery out of holder, and replace it with only **3V CR2032** coin cell batteries.

Use #0 philips screwdriver to remove all 3 screws on bottom cover:



Use flat-head screwdriver blade to pry open case

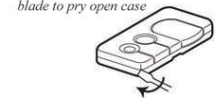

Solidremote 2020

Edition. ML-20\_09

**Press both buttons C+D to switch between above and below modes.**



[www.solidremote.help](http://www.solidremote.help)

Self installation assistance /  
YouTube installation videos

#### Programming Instructions for Garage Door Opener

##### Type A

**For Learn Code Button  
Openers (1995 - Present)**

1. Locate the "Learn Code" button and Learn Code Indicator LED. ("Learn Code" is typically located near the antenna of the opener).
2. Press and release "Learn Code" button, the LED indicator will **blink twice per second**.
3. Within 30 seconds, press and release the button you wish to use on hand-held remote, the LED indicator will **flash or glow steadily (varies by model)**.
4. Press the same remote button again, the LED indicator will **go out**.
5. Your remote is successfully programmed.

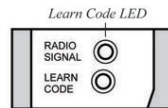

##### Type B

**For Program/Set Button  
Openers (2010 - Present)**

1. Locate the Program/Set button and Programming Indicator LEDs on your opener's powerhead (see opener owner's manual for exact location).
2. Press and hold the Program/Set button until the round LED **turns blue**.
3. Release the Program/Set button, the long LED will **blink purple**.
4. Within 30 seconds, press and release the button you wish to use on hand-held remote, the long LED will turn **steady purple**.
5. Press and release the same remote button again, both round & long LEDs will **blink blue and turn off**.
6. Your remote is successfully programmed.

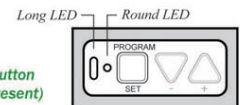

#### Frequently Asked Questions

##### Where to find learn button?

It is located on the powerhead receiver, either front, back, bottom or inside light lens (see opener owner's manual)

##### Why only one remote / only some button works?

Most likely your opener's memory is full, please **Erase All Remotes** from memory (see owner's manual). After that, only program buttons you use, since every button occupies one memory slot.

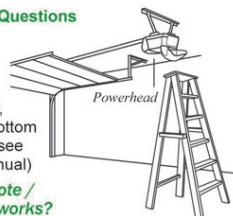

#### Battery

The LED on your remote will turn dim and show rapid flashes when the battery is low and needs to be replaced.

To replace battery, open the case as shown below. Remove circuit board if necessary. Slide old battery out of holder, and replace it with only **3V CR2032** coin cell batteries.

Use #0 philips screwdriver to remove all 3 screws on bottom cover:



1. Pull out visor clip

2. Remove screw



3. Pry open case

Solidremote 2020

Edition. MG-20\_09

**FCC STATEMENT :**

This device complies with Part 15 of the FCC Rules. Operation is subject to the following two conditions:

- (1) This device may not cause harmful interference, and
- (2) This device must accept any interference received, including interference that may cause undesired operation.

**Warning:** Changes or modifications not expressly approved by the party responsible for compliance could void the user's authority to operate the equipment.

NOTE: This equipment has been tested and found to comply with the limits for a Class B digital device, pursuant to Part 15 of the FCC Rules. These limits are designed to provide reasonable protection against harmful interference in a residential installation. This equipment generates uses and can radiate radio frequency energy and, if not installed and used in accordance with the instructions, may cause harmful interference to radio communications. However, there is no guarantee that interference will not occur in a particular installation. If this equipment does cause harmful interference to radio or television reception, which can be determined by turning the equipment off and on, the user is encouraged to try to correct the interference by one or more of the following measures:

- Reorient or relocate the receiving antenna.
- Increase the separation between the equipment and receiver.
- Connect the equipment into an outlet on a circuit different from that to which the receiver is connected.
- Consult the dealer or an experienced radio/TV technician for help.

**RF warning statement:**

The device has been evaluated to meet general RF exposure requirement. The device can be used in portable exposure condition without restriction.