

正

Zeapa®

Welcome Guide

Plug-in Wireless Doorbell

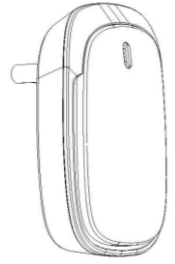

Please carefully read this Welcome Guide before using and installation

Features

- Modern and stylish design
- Piano button of emitter, brings good touch feels.
- 36 selected chimes
- 4-level adjustable sound volume.
- Super long transmission range.
- Easy to install and use
- Lower power consumption

What You Should Know Before Installation

1. The emitter supplied with this kit is already paired with receivers and set to default tune "Dingdong", also can press Chimes Button of receivers till your favorite chimes selected.
2. It is not advisable to mount the emitter onto METAL SURFACES, as the material can BLOCK RF signals between emitter and receiver.
3. We recommend to use the sticky pad provided as first option, using screws as second option.
4. Transmission range will decrease if battery in emitter is in a low volume status.
5. It is not advisable to mount the emitter outdoor directly WITHOUT any SHELTER which could accelerate aging of key electric components.

Quick Start

1. Sound Volume Adjust: Press the volume button on the receiver till the sound volume level that you prefer, then release your hands.
2. Set Chimes: 36 chimes included for your option, press chimes setting button till the one that you prefer, then release your hands.

1

Installation Methods

1. Test the doorbell working status and transmission range first before installation, battery inside emitter already.

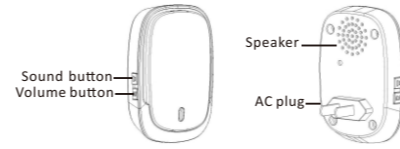

Receiver

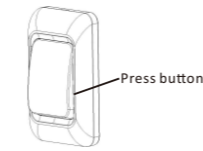

Emitter

2

2. Plug receivers into standard outlet of the room you often stay, then it will work.



AC 85V~265V



Receiver

3. Install the emitter, there are two options for choosing.

Option-1, Double-sided adhesive pad

- a. Choose a flat area that you intend to install, then use dry cloth to clean.
- b. Tear off one side film of pad and stick to emitter, then the other side and stick to the area that you intend to put on, pressing 10 secs.

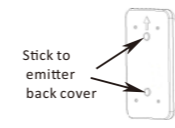

Stick to emitter back cover

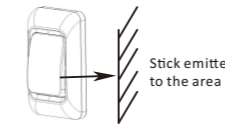

Stick emitter to the area

3

Option-2, Screws/Screws and Anchors

- Please prepare an electric drill and screwdriver before installation.
- a. Mark the hole area that you intend to install.
 - b. Drill two holes on the marked area, then insert anchors into the hole, or use screws directly on the surface, such as wood surface etc.
 - c. Use a flat screwdriver to PRY open the bracket or back cover of the emitter.

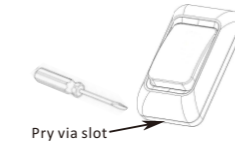

Pry via slot

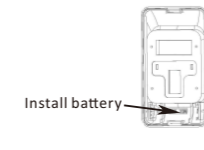

Install battery

- d. Screw up the bracket or back of the emitter.

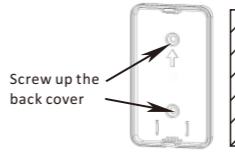

Screw up the back cover

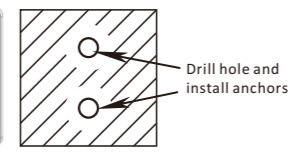

Drill hole and install anchors

4

反

Caution: Any changes or modifications to this device not explicitly approved by manufacturer could void your authority to operate this equipment.

This device complies with part 15 of the FCC Rules. Operation is subject to the following two conditions: (1) This device may not cause harmful interference, and (2) this device must accept any interference received, including interference that may cause undesired operation.

The device has been evaluated to meet general RF exposure requirement. The device can be used in portable exposure condition without restriction.

8

FCC Warning:

This device complies with part 15 of the FCC rules. Operation is subject to the following two conditions: (1) this device may not cause harmful interference, and (2) this device must accept any interference received, including interference that may cause undesired operation.

Changes or modifications not expressly approved by the party responsible for compliance could void the user's authority to operate the equipment.

NOTE: This equipment has been tested and found to comply with the limits for a Class B digital device, pursuant to part 15 of the FCC Rules. These limits are designed to provide reasonable protection against harmful interference in a residential installation. This equipment generates uses and can radiate radio frequency energy and, if not installed and used in accordance with the instructions, may cause harmful interference to radio communications. However, there is no guarantee that interference will not occur in a particular installation. If this equipment does cause harmful interference to radio or television reception, which can be determined by turning the equipment off and on, the user is encouraged to try to correct the interference by one or more of the following measures:

- Reorient or relocate the receiving antenna.
- Increase the separation between the equipment and receiver.
- Connect the equipment into an outlet on a circuit different from that to which the receiver is connected.
- Consult the dealer or an experienced radio/TV technician for help.

Important Note: Consult the dealer or an experienced radio/TV technician for help.

Radiation Exposure Statement

The device has been evaluated to meet general RF exposure requirement. The device can be used in portable exposure condition without restriction.

7

After-sales Support

Thanks for your choosing our products, we will provide 24*7hr on time service for you, if you have any query or good suggestion, welcome to contact us via below information.

Email: customer.service@wharton-pro.com

Your satisfaction is our target, hope our products and service can get your satisfaction.

Welcome to give us feedback after you receive our products within 1~4 weeks, tell us what you think of and your suggestion, we'll select the best suggestion every month, and offer some gift.

Appreciate for your support and understanding!

Best Regards
Greetings from Zeapa Store

6

Troubleshooting

1. No sound
 - Check whether emitter battery power enough or not, replace a new battery if necessary.
 - Receiver installed not properly, plug in and out for several times, or try other outlet.
 - Receiver is out of range to receive signal from emitter.
 - Check sound volume button whether it is on the lowest level.
2. Transmission range reduced cause
 - Metal structures, including UPVC door frames, can reduce the range of transmission. Avoid to mount on the area that emitter and receiver are isolated separately by metal structures.
 - Other sources give out radio wave to lessen receiver to receive signal.
 - Signal would lessen after cross Walls and ceilings; signal transmission range would reduce accordingly.
 - Weak battery would reduce transmission range as well, replace battery at interval 12 months

Specifications

No.	Item	Parameter
1	Receiver Working Voltage	AC 85-265V
2	Wattage	<0.5w
3	Transmission range (without obstacles)	500-1000ft
4	Choosing Chimes	36
5	Sound Volume	25-110dB, 4levels
6	Working Frequency	433.92MHz±280KHz
7	Working Temperature	-30℃~70℃
8	Waterproof Level (Don't drop into water)	IP44

5

Made in China

WARNING: Don't dismantle this product without support from professional electrician on site.