

SKG

NECK MASSAGER
K5-3EN

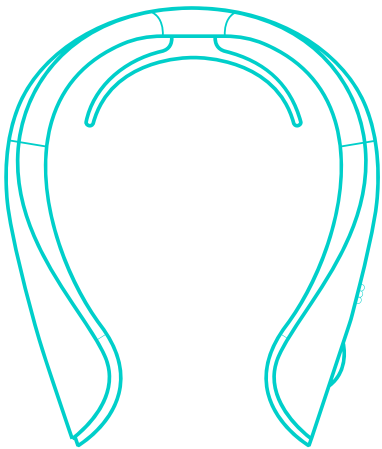

USER MANUAL

Operating instructions

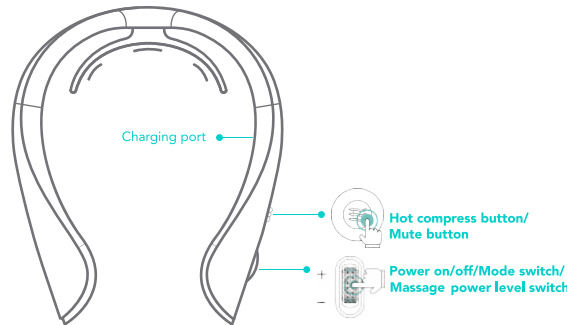

Hot compress button/Mute button
Press the Hot compress and red light hot compress button (Off, Low, Medium and High power level).
Switch power level in cycle Press and hold it for 2 seconds to disable/enable the voice

Power on/off/Mode switch/Massage power level switch
Press and hold it for 2 seconds to turn on/off the massager. Press the Mode switch button.
Scroll up to increase the massage power level;
Scroll down to reduce the massage power level

Color of indicator	Status of indicator	Description
Blue	Always on	1. Power> 25%; 2. Fully charged
Orange	Breathing	1. Charging
Orange	Flashing	1. Low power, about to shut down
Orange	Always on	1. Low power; 2. OTA upgrading

When the power of the main unit is low, the signal indicator of the power button will be on in orange (flashing), and the massager will be automatically shut down in about 3 seconds. Please connect the plug of the MicroUSB cable into the charging port of the main unit. Plug the other end into the power adapter (5V \pm) to charge the device in time; the breathing light of the power button will be on in orange when charging, and the signal indicator will turn blue (always on) when it is fully charged.

This product complies with the radio interference requirements of the European Community. ACUTION RISK OF EXPLOSION IF BATTERY IS REPLACED BY AN INCORRECT TYPE. DISPOSE OF USED BATTERIES ACCORDING TO THE INSTRUCTIONS.
Frequency band: 2400MHz~2483.5MHz
Maximum output powers20dBm

This symbol means the product must not be discarded as household waste, and should be delivered to an appropriate collection facility for recycling. Follow local rules and never dispose of the product and rechargeable batteries with normal household waste. Correct disposal of old products and rechargeable batteries helps prevent negative consequences for the environment and human health.

Control with APP

To learn more about massage techniques and smart control solutions, please download the "Future Wear" APP.
1. Use Browser to scan the QR code on the right
or search for "Future Wear" (SKG) in the mobile application market, download the APP and install it
2. Register/Login
Enter the email address and verification code to complete the registration
3. Add device
Make sure that the Bluetooth of the mobile phone is turned on and the SKG device is turned on. Click "Add Device" on the APP homepage



ISED STATEMENT:
This device contains licence-exempt transmitter(s)/receiver(s) that comply with Innovation, Science and Economic Development Canada's licence-exempt RSS(s). Operation is subject to the following two conditions:
(1) This device may not cause interference.
(2) This device must accept any interference, including interference that may cause undesired operation of the device.
L'émetteur/récepteur exempt de licence contenu dans le présent appareil est conforme aux CNR d'Innovation, Sciences et Développement économique Canada applicables aux appareils radio exempts de licence. L'exploitation est autorisée aux deux conditions suivantes :
1) L'appareil ne doit pas produire de brouillage;
2) L'appareil doit accepter tout brouillage radioélectrique subi, même si le brouillage est susceptible d'en compromettre le fonctionnement. This transmitter must not be co-located or operating in conjunction with any other antenna or transmitter. Cet émetteur ne doit pas être colocalisé ou fonctionner en conjonction avec une autre antenne ou un autre émetteur. The device has been evaluated to meet general RF exposure requirement. The device can be used in portable exposure condition without restriction.
Le matériel a été évalué pour répondre aux exigences générales d'exposition aux radiofréquences. Le dispositif peut être utilisé dans des conditions d'exposition portables illimitées.

Notes for Product Scrap

Please recycle the rechargeable battery (lithium ion battery)!

	<p>The battery in this product is a dedicated rechargeable battery, which is not intended for other products. Please do not charge the removed rechargeable battery.</p> <ul style="list-style-type: none">Do not throw it in the fire, or heat it up to high temperatureDo not pierce it with nails, impact it by gravity or decompose it for modificationDo not connect the positive and negative poles of the battery directly with metalDo not store it together with necklaces, hairpins, etc.Do not charge, use or put it in the places in high temperature such as fireside or in the blazing sunThe situations above may cause heating, fire and breakage.
	<p>Keep the removed rechargeable battery out of the reach of infants and young children in case that it is swallowed by mistake</p> <ul style="list-style-type: none">When the device is mistakenly swallowed, please consult a doctor immediatelyWhen the battery fluid leaks, do not touch the fluid by hand, and it can be processed in the following wayDo not rub your eyes with your hands when battery electrolyte enters your eyes in case of blindness. Rinse your eyes with clean water immediately and seek medical advice. When your body or clothing is contaminated by the battery electrolyte, it may cause skin irritation or injury. Please rinse with water. If you still feel discomfort, seek medical advice immediately.Only the scrapped products can be decomposed. Otherwise, the accident of fire, electric shock, injuries may be resulted in. When you need to repair the battery (not to replace the battery), please consult the dealer where you purchased this product

The lithium-ion battery in this product is a valuable resource that can be recycled and reused, which is not allowed to be replaced. Please hand it over to a professional agency that can recycle the rechargeable batteries when this product is scrapped. Before scrapping this product, remove the battery from this appliance. Before removing the battery, the appliance must be powered off. The battery should be disposed of safely, which can be taken out in the steps below:
1. With professional tools, open the upper and lower cases.
2. Remove the circuit board and the motor.
3. Take out the battery, cut the battery wire with professional pliers, and then take out the battery.

I am always the first user of each product

In company with SKG
"May you enjoy every day"

Jack.
SKG Group / CEO



Daily maintenance

Never expose it to direct sunlight

Never expose it high temperature and humidity

Keep it away from fire and smoke

Never expose it excessive dust

Power off

Wipe it gently with a soft fabric dipped in water

Put it in a dust-proof storage bag
• The product doesn't come with a storage bags

Basic parameters

Product name	SKG Neck Massager	Model	S1132HB
Device name	K5-3EN	Rated input power	5W
Battery capacity	2000mAh	Rated input voltage	5V \pm
Charging port	MicroUSB		

* The model approval code of the product is presented as "laser engraving product nameplate".
Please charge the product by appropriate power adapter with rated output 5W / 5V \pm

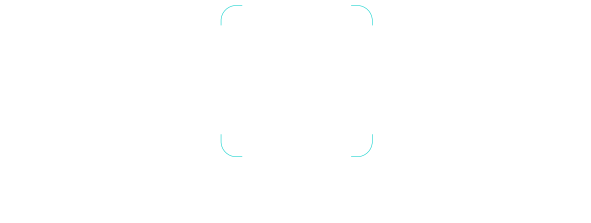

SKG Health Technologies Co.,Ltd.
Address : 23A Floor, Building 3, Zhongke R & D Park, No. 009, Gaoxin South 1st Road, High-tech Zone Community, Yuehai street, Nanshan District, Shenzhen, Guangdong, China
Website : www.skg.com
If you have any questions, please feel free to send a mail: skgelectridlc@163.com

Precautions

DANGER

Please be careful NOT to use the product together with the following medical electronic equipment to avoid mutual influence and cause injury

- Implanted medical electronic devices such as pacemakers
- Medical electronic devices for life support such as artificial heart and lungs
- Electrocardiograph and other medical electronic instruments

It's prohibited to be used in gas stations, high dust workshops, gas stations and other combustible and explosive places

Warning

- Provided that the patient simultaneously uses high-frequency surgical equipment and massage device his/her on the body, it may burn the electrode sheet of the massage device, or damage the massage device.
- In case that the user utilizes the product near shortwave or microwave therapeutic equipment (1 meter), the output of this massager may be unstable
- Avoid contacting wounds and scars with electrode sheet during massage
- During massage, be sure not to place the electrode sheet near the chest and heart, otherwise it'll increase the risk of heart fibrillation
- It's recommended that one user should use this product, other users shall clean the electrode sheet on the product before using
- When using the product, the user shall closely attach the electrode sheet to the skin to evenly contact
- The product's electrode sheet feature a heating function, when enabling the heating function, it may cause low-temperature burns if using the heating function for a long time (over 20 minutes) on the same part.
- If the user feels uncomfortable during or after use, it's recommended to stop using and seek medical advice
- Since this product contains lithium batteries, be sure not to separately dismantle, modify, immerse the product in water or throw it into the fire, otherwise it may cause product damage and explosion

- Avoid using it near the heart, above the neck, head, mouth, private parts, or parts with skin diseases, and avoid simultaneously massaging the soles of both feet
- Besides, be sure not to compress the internal organs when using it. Otherwise, it may cause accidents or physical discomfort
- Avoid using this product with other medical equipment or over 2 sets of this product, otherwise the user may feel nausea or physical discomfort
- Avoid using for purposes other than the massage recorded in the instruction manual, otherwise it may cause accidents and breakdown
- Avoid using the electrode sheet with chipped or damaged surfaces, or it may cause accidents and malfunctions
- Avoid disassembling, repairing or modifying this product without permission, otherwise it may cause malfunction or electric shock accident

In the following conditions, please consult a doctor before using this product. Otherwise, it may cause accidents or physical discomfort:

- | | |
|--|--|
| • Patients receiving the medical treatment and feeling physical discomfort | • Patients with infectious diseases |
| • Patients with heart and cranial nerve abnormalities | • Patients infected with skin perceptual disturbance or skin abnormalities |
| • Patients whose body temperature exceeds 38 degrees (stage of feverescence) | • Patients who are taking medication |
| • People whose skin is sensitive to graphene/graphite | • Patients with abnormal blood pressure |
| • Patients with perceptual disturbance caused by diabetes and other high-level peripheral circulatory disturbances | • Patients failing to express their wishes freely |

In the following conditions, please consult a doctor before using this product. Otherwise, it may cause accidents or physical discomfort:

- | | | |
|--------------------------------------|--|--|
| • Malignant tumor patient | • Pregnant women and puerpera | • Cardiac pacemaker user |
| • Patients with hemorrhagic tendency | • Patients with acute purulent inflammation | • Patients with metal implants |
| • Patient with coagulation disorders | • Patient with convulsion stage after cerebrovascular accident | • Patient with severe cognitive impairment |

- | | | |
|---|--|-------|
| • Near the human's heart | • Spastic paralysis | • Eye |
| • Patients with unconsciousness, deformity of limb bone and joint contracture | • Patient with abnormal nervous irritability | |

Note

- Please read the product manual before using
- If the user feels uncomfortable due to an abnormality in this product, please stop using it immediately. If the user feels that there exist body or skin abnormalities, please seek medical advice and follow the doctor's advice
- During the massage, if one wants to move the electrode sheet or move to other people's body, make sure to power off before moving, or it may cause strong electric shock
- Patients with a history of cerebrovascular accidents, avoid placing the electrode pair on the craniocerebral part
- Do not massage carrying an electronic device. Otherwise, the electronic device may be misoperated (e.g.: disorder in electronic watch)
- In case of abnormal operation, please cut off the power supply immediately, otherwise high temperature or short circuit or accident may occur. Contact the customer service personnel for after-sales consultation simultaneously.
- Do not plug the USB charging cable with a wet hand, otherwise it may cause an electric shock or accident
- Please keep it away from children or people without expressible conscious, otherwise it will cause accidents or physical discomfort.
- Do not use it in high humidity places such as the bathroom, or use the product while bathing, otherwise there may be a strong electric shock and damage to the product.
- Do not use it in bed, otherwise the ontology may be damaged. In addition, the electrode sheet may be moved to other parts to cause physical discomfort.
- Do not use it when driving a car, otherwise it may cause physical discomfort due to excessive stimulation, resulting in an accident.
- Do not stick the electrode sheet to the affected area for a long time, otherwise it may cause skin inflammation.
- During massage, do not allow the metal part of belts, necklaces and other items to contact the electrode sheet, otherwise it may be strongly shocked.
- When using the massage function, do not use it in the same place for a long time (more than 30 minutes), otherwise the muscle fatigue in the massage part may cause physical discomfort.
- Please wear the product correctly (bilateral symmetry at back), otherwise, it may cause accidents or physical discomfort.

- Do not pull the USB charging cable from the ontology, but hold the wire plug, otherwise it may cause electric shock or damage to the product.
- The electrode sheet has a surface heating function, which shall cause the attention of people insensitive to heat.
- It is normal to heat the surface after working for long hours.
- Please confirm that the host button is working properly before your use.
- During the first use or after the idling (power loss), please charge the product according to the instruction manual to ensure it can work normally.
- When discarding the product, please deal with it in accordance with the relevant urban environmental protection regulations, otherwise it may cause environmental pollution.
- It is recommended for people aged 16 and above.

Do not use or store the product in:
Places of direct sunlight | Places of high temperature and high humidity | Wet places
Dusty places | Near the fireworks | Places vulnerable to vibration impact
Places of strong electromagnetism

FCC STATEMENT
This device complies with Part 15 of the FCC Rules. Operation is subject to the following two conditions: (1) This device may not cause harmful interference, and (2) This device must accept any interference received, including interference that may cause undesired operation.
Warning: Changes or modifications not expressly approved by the party responsible for compliance could void the user's authority to operate that may cause undesired operation.
Note: This equipment has been tested and found to comply with the limits for a Class B digital device, pursuant to Part 15 of the FCC Rules. These limits are designed to provide reasonable protection against harmful interference in a residential installation. This equipment generates, uses, and can radiate radio frequency energy, and if not installed and used in accordance with the instructions, may cause harmful interference to radio communications. However, there is no guarantee that interference will not occur in a particular installation. If this equipment does cause harmful interference to radio or television reception, which can be determined by turning the equipment off and on, the user is encouraged to try to correct the interference by one or more of the following measures:
(1)Reorient or relocate the receiving antenna. (2) Increase the separation between the equipment and receiver. (3)Connect the equipment into an outlet on a circuit different from that to which the receiver is connected. (4)Consult the dealer or an experienced radio/TV technician for help.
This transmitter must not be co-located or operating in conjunction with any other antenna or transmitter. The device has been evaluated to meet general RF exposure requirement. The device can be used in portable exposure condition without restriction.
Made In China