

F I I I®

THE ART OF AUDIO

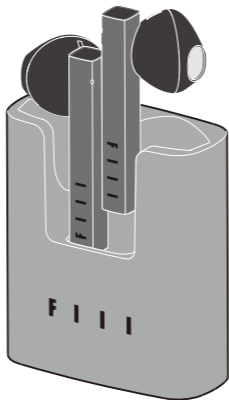

F I I I CC2

TRUE WIRELESS EARBUDS

USER MANUAL

Packaging Content

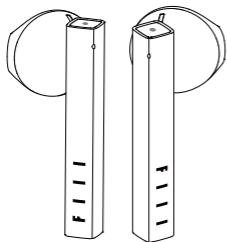

**Earbuds X2
(L/R)**

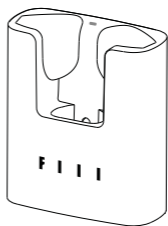

Charging Case X1

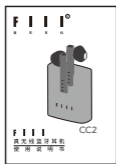

User Manual X1



**Type C Charging
Cable X1**

Main User Interfaces

● Earbud

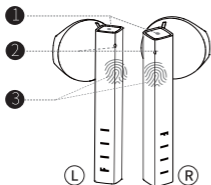

- 1 LED indicator
- 2 ENC microphone
- 3 Touch control

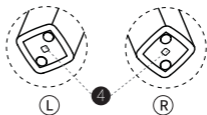

- 4 Call microphone

● Charging Case

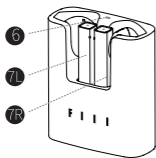

- 6 Charge indicator
- 7L Left earbud
- 7R Right earbud



- 8 Type-C connector

Get Started

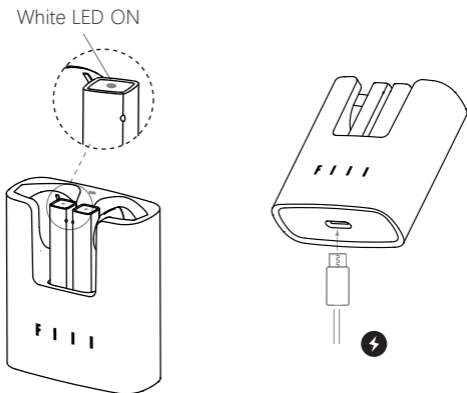

- **STEP1**
If charging case's LED does not light on after insert the earbuds. please connect USB cable to charge more than 10min.

- **STEP2**
Open the charging case then earbuds will automatically get sync and enter pairing mode without any manual operation.

Notes : Please charge the charging case via USB adapter in advance.

Bluetooth Pairing

● Bluetooth pairing

For first usage of brand new FIIL CC2, please refer to page5 "Get Started", the earbud status indicator will continue to blink blue once entered pairing mode.

For a paired FIIL CC2, please delete its pairing history in the device list or when the earbuds are turned off, press and hold any one of earbuds until the LED indicator blinks blue.

● Search Connection

Enter setup menu of audio source devices, select "search device" in "Bluetooth" then select "FIIL CC2" in the device list to connect.

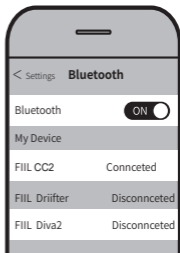
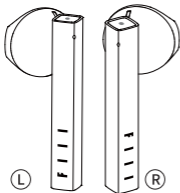

How to Control

● Easy Mode (default)

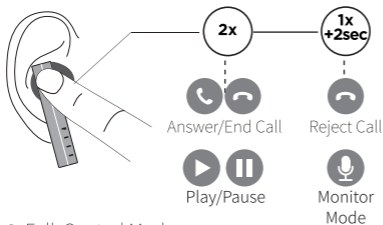

● Full Control Mode

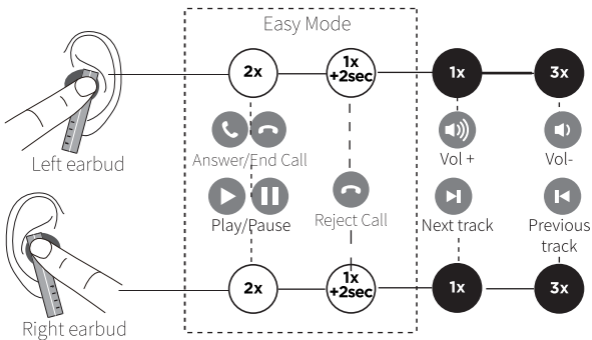

•Notes: full control mode can be activated in the fill + APP

How to charge

● Charge earbud

- When earbud reminds “recharge headset” or the LED indicator blinks **White**, that means battery is low and earbud should be charged.
- Place the earbuds into charging case and close, then earbud will be charged.

*Notes: Earbud will power off during charging.

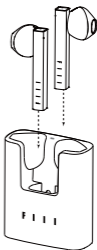

● Charging Case indicator

- When the LED indicator is on, it means the earbuds are being charged .
- When the LED indicator is off, it means earbuds are fully charged .

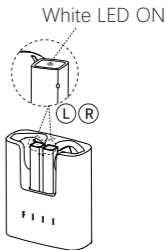

Product Parameters

Item	Specifications
Earbud weight	~4g/each
Charging case weight	~33g
User Mode	Bluetooth True Wireless
Bluetooth	V5.0, supported protocols: HSP , HFP , A2DP , AVRCP BT range: up to 30m. Pairing code: 0000. iOS and Android devices are supported.
Audio specification	Supported Code: AAC (for iOS) /SBC; Speaker specifications: ϕ 6.1mm, frequency range: 15Hz-22kHz
Power and battery	Rechargeable lithium-polymer battery; music time: up to 6 Hrs (medium level) on a single charge; Bluetooth standby time: up to 6 days ; charging time: ~ 40 minutes. Charging case: add 3 more charge cycle (18Hrs+)
Operating environment	Operating temperature: 0°C~50°C; storage temperature: -30°C to 70°C; IEC60529-IPX5 Certified(earbuds)
Voice reminder	English
Certification	

FCC Statement

This equipment has been tested and found to comply with the limits for a Class B digital device, pursuant to Part 15 of the FCC Rules. These limits are designed to provide reasonable protection against harmful interference in a residential installation. This equipment generates uses and can radiate radio frequency energy and, if not installed and used in accordance with the instructions, may cause harmful interference to radio communications. However, there is no guarantee that interference will not occur in a particular installation. If this equipment does cause harmful interference to radio or television reception, which can be determined by turning the equipment off and on, the user is encouraged to try to correct the interference by one or more of the following measures:

- Reorient or relocate the receiving antenna.
- Increase the separation between the equipment and receiver.
- Connect the equipment into an outlet on a circuit different from that to which the receiver is connected.
- Consult the dealer or an experienced radio/TV technician for help.

This device complies with part 15 of the FCC Rules. Operation is subject to the following two conditions:
(1) This device may not cause harmful interference, and (2) this device must accept any interference received, including interference that may cause undesired operation.

Changes or modifications not expressly approved by the party responsible for compliance could void the user's authority to operate the equipment.

FCC ID: 2AYVH-F030