

## Access to regulatory information Rev 3 (March 26)

- 1: Start the unit
- 2: Once the inspection view is displayed, visit the main menu

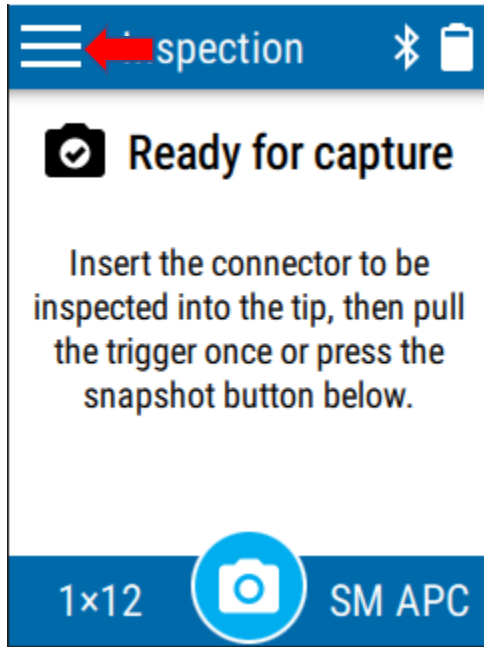

- 3: Open the Settings GUI

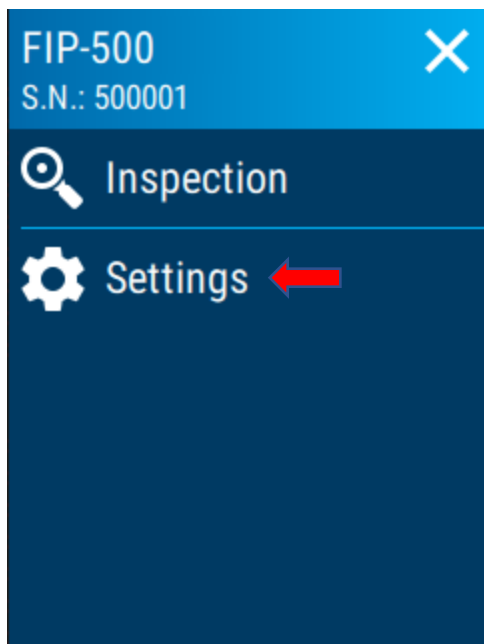

4: Scroll to the bottom of the GUI to open the regulatory GUI

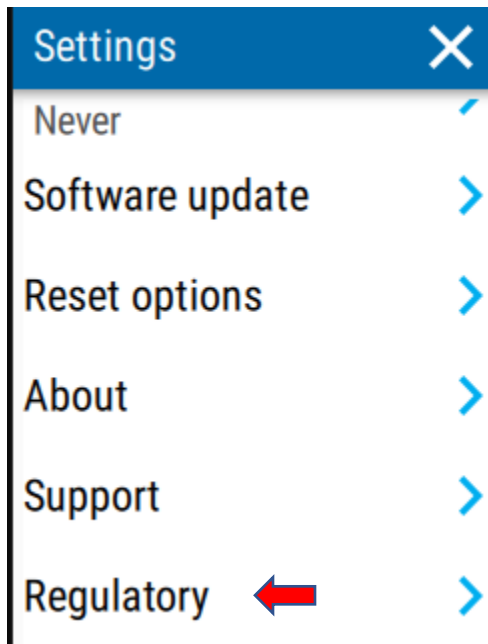

5: Regulatory information displayed

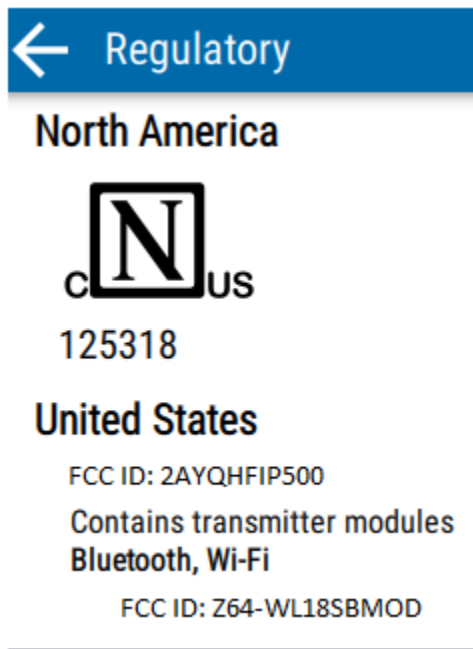

← Regulatory

## Canada

IC: 26882-FIP500

Contains transmitter modules  
Bluetooth, Wi-Fi

ID: 4511-WL18SDMOD

← Regulatory



[EXFO.com/recycle](http://EXFO.com/recycle)

## China

Bluetooth, Wi-Fi

CMIIT ID: xxxxxxxx

RFID

ID: xxxxxxxx

