

A6N MAX

— OTT —

Quick Start Guide

Product Checklist

Open the box carefully. The following accessories should be inside:

- | | |
|---------------------|---------------------|
| ■ A6N MAX OTT Box | ■ Quick Start Guide |
| ■ IR Remote Control | ■ Batteries |
| ■ Power Adapter | ■ HDTV CABLE |
| ■ IR External Cable | |

Important:

Please contact your local distributor immediately if upon opening the package you find any damage and/or loss of any part of the accessories.

This manual is for reference only and may differ from actual product appearance.

Please follow device when they differ.

■ Panel Description

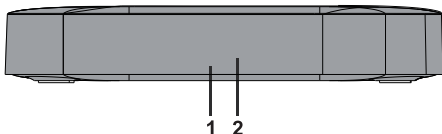

1. When the box is in stand-by mode, it will turn into red light.
2. A hidden sensor senses infrared signal from the remote control.

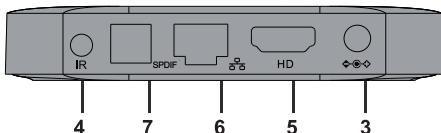

3. DC IN jack. This is used to connect the AC adapter.
4. IR extend port
5. HDTV port. Connect it to your HDTV.
6. Network port.
7. S/PDIF port. Connects to an External Audio Amplifier with S/PDIF / Optical Digital Audio.

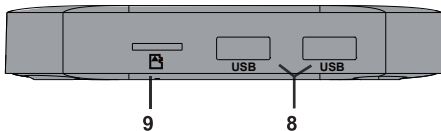

8. USB 2.0 Port. Port for external storage media such as hard drive or USB flash drive. On this connection you can also update software and program lists.
The user storage device needs to be formatted with FAT32!
9. TF CARD port

Important:

*This manual is for reference only and may differ from actual product appearance.
Please follow device when they differ.*

■ Installation sketch map

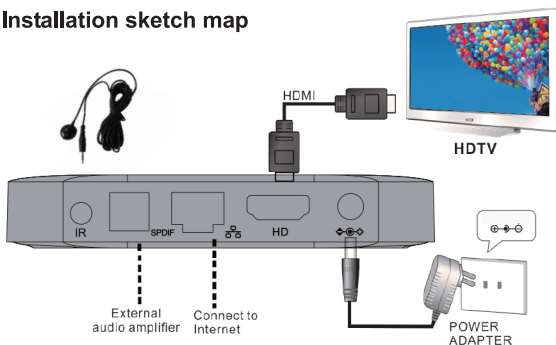

The power adapter should be connected last.

Ensure that your TV is set to the correct input channel depending on your connection type e.g. AV1, AV2, Component, HDMI etc.

Use the TV remote control to select the TV input channel connected to the box. Refer to your TV user guide or technical helpline if unable to select the input channel.



■ Remote Control Description

- POWER** - Switch on or switch off receiver
- MUTE** - Switch on or switch off receiver's sound.
- FIND** - Search channel, program or application.
- OPT** - A shortcut to run optional APP
- IPTV** - A shortcut to run IPTV APP.
- V.MODE** - A shortcut to change resolution.
- 0-9** - Numerical key.
- EPG** - Display Electronic program Guide information.
- INFO** - Display detailed information of channel, program or application.
- ▲/▼** - Page up/down.
- MOUSE** - Enable or disable mouse function.
- HOME** - Back to the portal of receiver.
- Volume** - Adjust receiver's volume.
- ◀/▶** - Move to the left screen or right screen.
- ◀/▶** - Moving the highlight to left/right.
- ▲/▼** - Moving the highlight to up/down.
- OK** - Confirm the selection.
- MENU** - The entry of application's functions.
- BACK** - Back to the previous menu.
- COLORIZED KEYS** - Entries of application's key functions.

21. **GROUP** - A shortcut to channel list
22. **FAV♥** - A shortcut to favorite channel list
23. **RECALL** - A shortcut to historical channel list
24. **F1-** Entries of application's complement functions.
25. **RECORD●** - Record program to local storage such as USB stick.
26. **PLAY▶** - Start to play media.
27. **PAUSE||** - Pause the playing of media.
28. **STOP■** - Exit the playing of media.

Using the Remote Control

1. To use the remote control, point it towards the front of the Media Player.
2. The remote control has a range of up to 7 meters from the Media Player at an angle of up to 60 degrees.
3. The remote control will not operate if its path to the sensor on the front panel of the Media Player is blocked.

■ First Time installation

Note: When you switch the box on for the first time, the easy installation starts automatically with the language selection.

Language Selection

- Use button ▲/▼ to scroll up and down to select the desired language and confirm with **OK**.
- Press **>>** button to go to Network Setting.

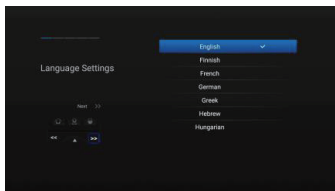

Network Setting

- If you are using the network cable to connect the LAN, You can set up the ethernet settings through the LAN Networking Settings menu.
- When you have the option DHCP on, it will automatically detect the correct IP address. DHCP OFF is used when you want to use a certain IP address. In this case, you need to enter correct addresses in each field. In the end, select the save option to confirm your settings.

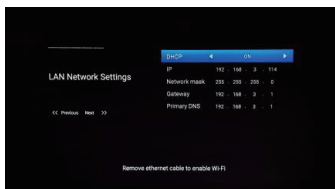

- Remove the ethernet cable, it will enter the WiFi Networking Settings menu.
- It is used when box connect to network via a wireless connection. In the WiFi Networking Settings menu, a screen appears showing the search results for available WLANs, select the appropriate WLAN from the list, if it's a secure network and it's the first time you've used it, you will need to enter your wifi network password to be able to connect.
- Press >> button to go to Time Setting.

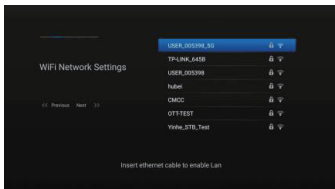

Time Setting

- You can set the time Auto Update by Internet. Set the Auto update to OFF be used when you want to set time manually. In this case, you need to enter correct time in date and time field with 0-9 button.
- Select the desired time mode.
- Select the correct GMT Offset according to your time zone.
- Press >> button to go to Resolution Setting.

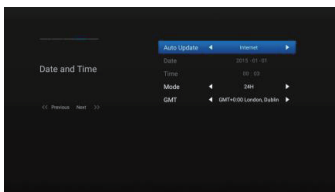

Resolution Setting

- Here you need select the desired resolution depending on your HD TV Set and confirm with OK.

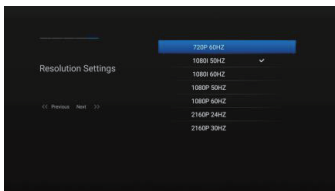

■ Setup Environment and Requirements

System Requirements

- One Television set with video and audio
- Well and safe internet environment.

Setup Environments

- Setup the system following the procedures described in this manual.
- Place the box far away from any heat source.
- Do not put the box in dirty or humid place.



Unplug the unit when installing the system, and keep your hands dry.

■ Hardware Setup Procedures

Preparation for Installation

- Unpack the box and check out the supplied accessories.
- Prepare the television box and power supply jack.
- Place the box beside the TV set.



Caution:

- a) Before making any physical connection to other equipment, unplug the unit. Also ensure that AC power is disconnected from the other equipment.
- b) The connections of all video/audio cables supplied are colour coded with the jacks of related equipment. When connecting make sure that the colours are matched.
- c) Proper physical connections is important, so be sure to insert the plug completely.

■ Troubleshooting

Blank screen

- The internet is bad, please try again when the internet is good.
- Poor connections or loose connections, please check the connection of the video.

Remote control failure

- Low battery, please change batteries.
- The remote control is operating out of its range.

Video without Audio

- Audio cable connection problem, please check the audio connection and re-connect the cable.
- Box or TV was muted; please cancel the mute of the Box or TV.
- Set TV volume and Box volume to mid level.
- Source problem, please wait or view another program.

Audio without Video

- Video cable connections problem, please check the video cable connection and re-connect it.
- Video source problem, please wait or view another program.

Picture jamming or in mosaic

- Low data rate, please wait or view another program.
- Video source problem, please wait or view another program.

NOTICE

- Specifications are subject to change without further notice.
- The manufacturer does not assume any responsibility regarding any errors or mistakes in printing.
- Please note that a new software may change the features of the receiver.
- The manufacturer holds the rights of changes without any further notice.

FCC WARNING

This device complies with part 15 of the FCC Rules. Operation is subject to the following two conditions: (1) this device may not cause harmful interference, and (2) this device must accept any interference received, including interference that may cause undesired operation.

Any changes or modifications not expressly approved by the party responsible for compliance could void the user's authority to operate the equipment.

NOTE: This equipment has been tested and found to comply with the limits for a Class B digital device, pursuant to Part 15 of the FCC Rules. These limits are designed to provide reasonable protection against harmful interference in a residential installation. This equipment generates, uses and can radiate radio frequency energy and, if not installed and used in accordance with the instructions, may cause harmful interference to radio communications. However, there is no guarantee that interference will not occur in a particular installation. If this equipment does cause harmful interference to radio or television reception, which can be determined by turning the equipment off and on, the user is encouraged to try to correct the interference by one or more of the following measures:

- Reorient or relocate the receiving antenna.
- Increase the separation between the equipment and receiver.
- Connect the equipment into an outlet on a circuit different from that to which the receiver is connected.
- Consult the dealer or an experienced radio/TV technician for help.

To maintain compliance with FCC's RF Exposure guidelines, This equipment should be installed and operated with minimum distance between 20cm the radiator your body: Use only the supplied antenna.

The use of the 5150 – 5250 MHz band is restricted to indoor use only. This restriction will be applied in all member states.