

Smart Garage



WARNING

TO PREVENT SERIOUS INJURY FROM YOUR MOVING GARAGE DOOR OR GATES:

- DO NOT let children use Smart Garage Door Opener product and app without adult supervision.
- ONLY operate your Smart Garage Door Opener device when you are in clear view of your garage or gate, and you have verified that there are no objects are obstructing the operation of the door.
- ALWAYS wait for garage door or gate to be completely closed.

WHAT'S IN THE BOX

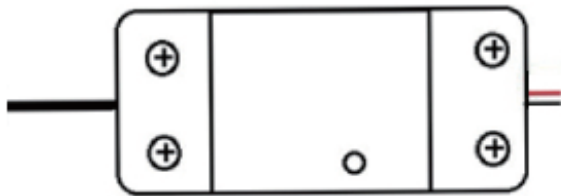

Smart Garage Controller

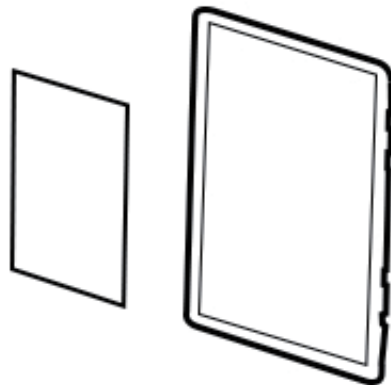

Magic Tape



Sensor Mounting Bracket

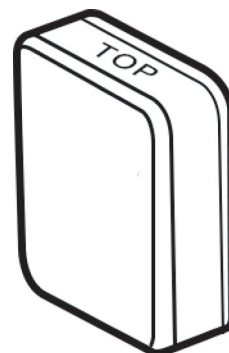

Wireless Door Sensor

COMPATIBILITY CHECK

Verify the Smart Garage Door Controller works with your garage door

1. Look for your garage door opener on the included "Garage Door Compatibility Guide".
 - Garage door openers with **yellow / purple** learn buttons will likely **NOT** work.
2. Manually ensure your garage door opener is compatible with the Smart Garage Door Controller.
 - Follow the wires from the wall mounted garage controller to your garage door opener.
 - Where the wall mounted garage door controller wires connect to the opener, use a needle nose plier or paperclip to touch the two garage door opener terminals together.

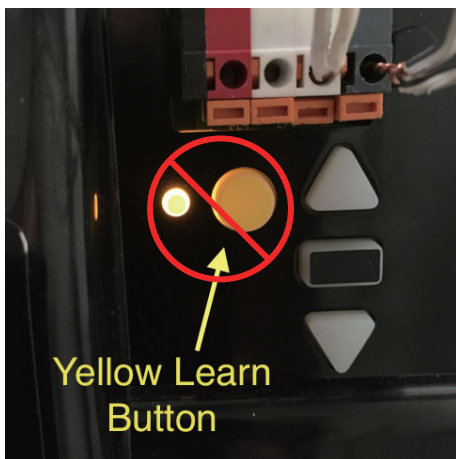

- If the garage door opens or closes, the Smart Garage Door Controller is compatible with your garage door opener; these will be the terminals the Smart Garage Door Controller will plug into.

INSTALLATION

Installation Overview

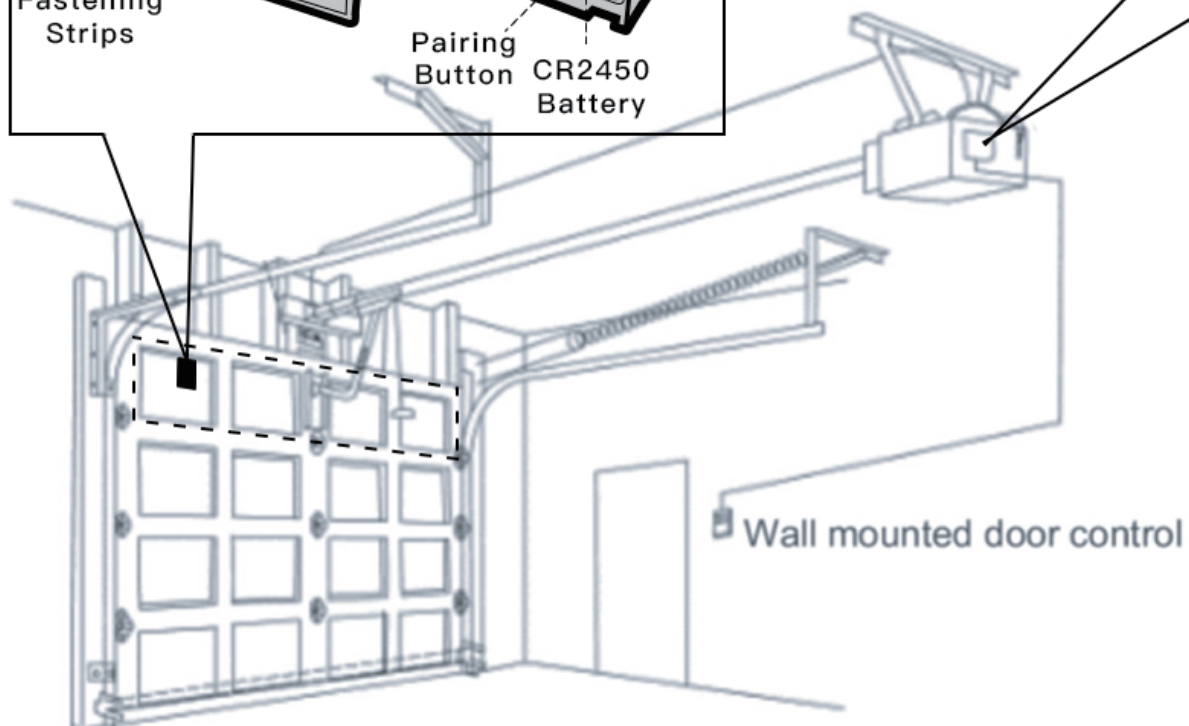
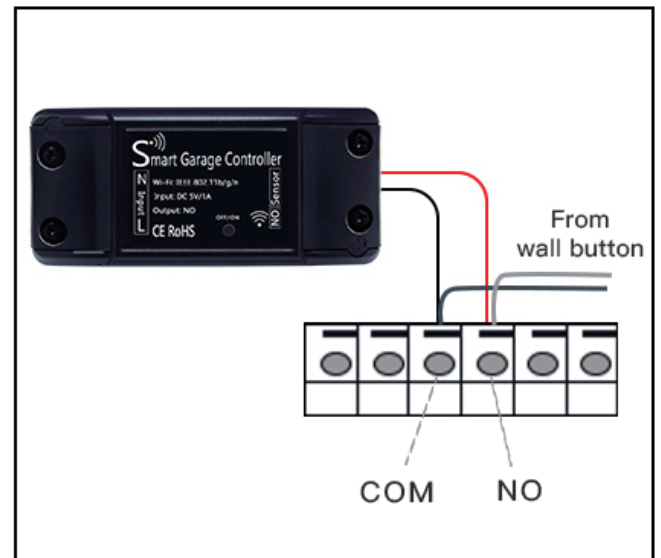
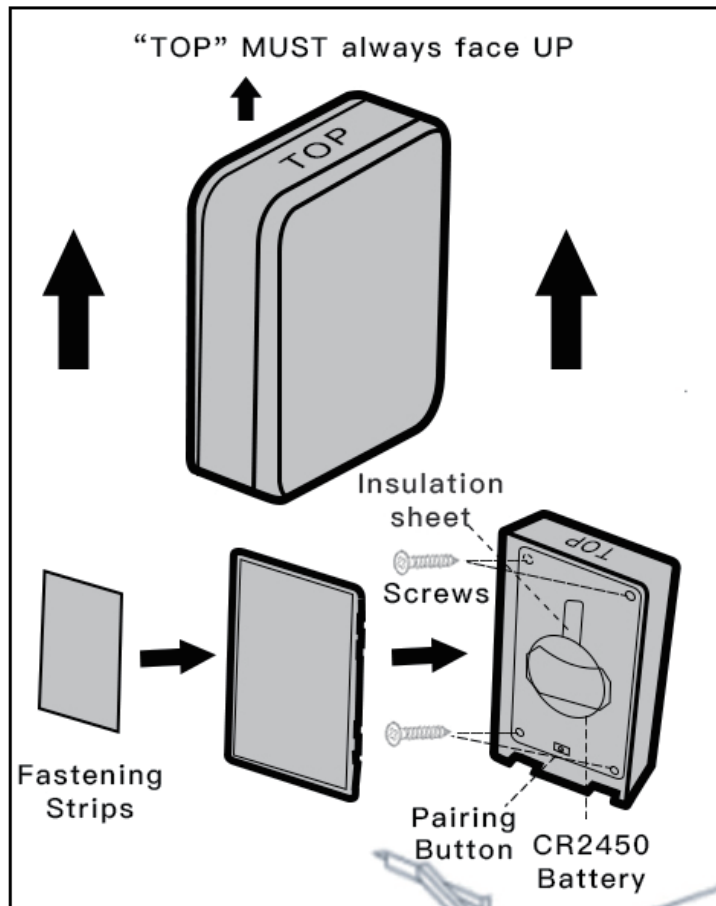

INSTALLATION

1. Check your Wi-Fi

- Check the Wi-Fi signal in the garage, where the **Smart Garage Controller** will be mounted 4 to 5 feet away from the garage door opener.
- If your Wi-Fi is 5GHz, please set it to be 2.4GHz.

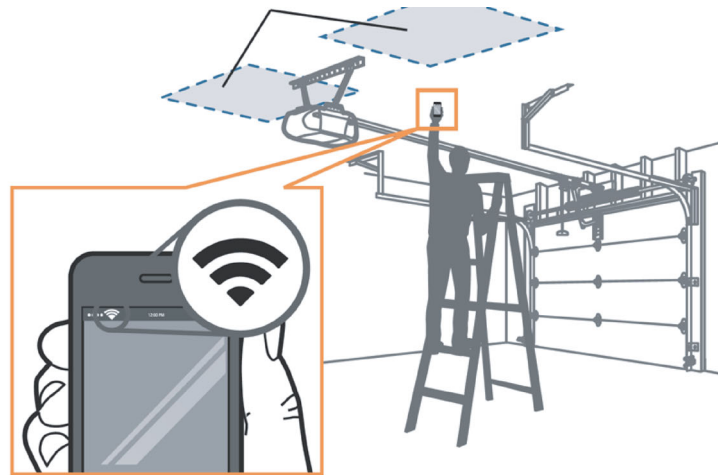

2. Download the APP

- Install “**Tuya Smart**” or “**Smart Life**” app on your mobile phone from Apple app store or Google Play store.



3. Power up your device

- Find a convenient location and power the **Smart Garage Controller** by plugging it in. The blue LED will start blinking.

INSTALLATION

4. Add device in the APP

- Launch the app and Tap the icon "+" on the right top add a device.
- Select "**Electrician**", then select "**Garage Door Opener**".
- Connect to your Wi-Fi network, enter password, then select "**Next**".
- Tap "**is fast blinking (0.5s/time)**", it will auto-connect with device.

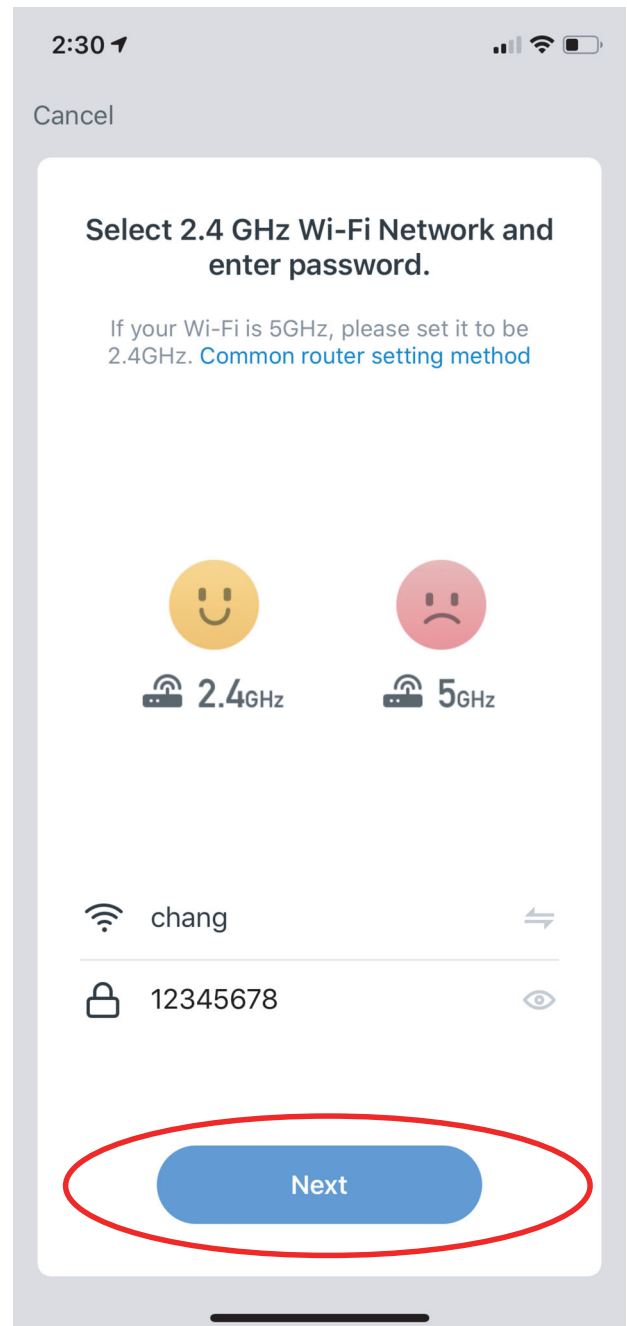
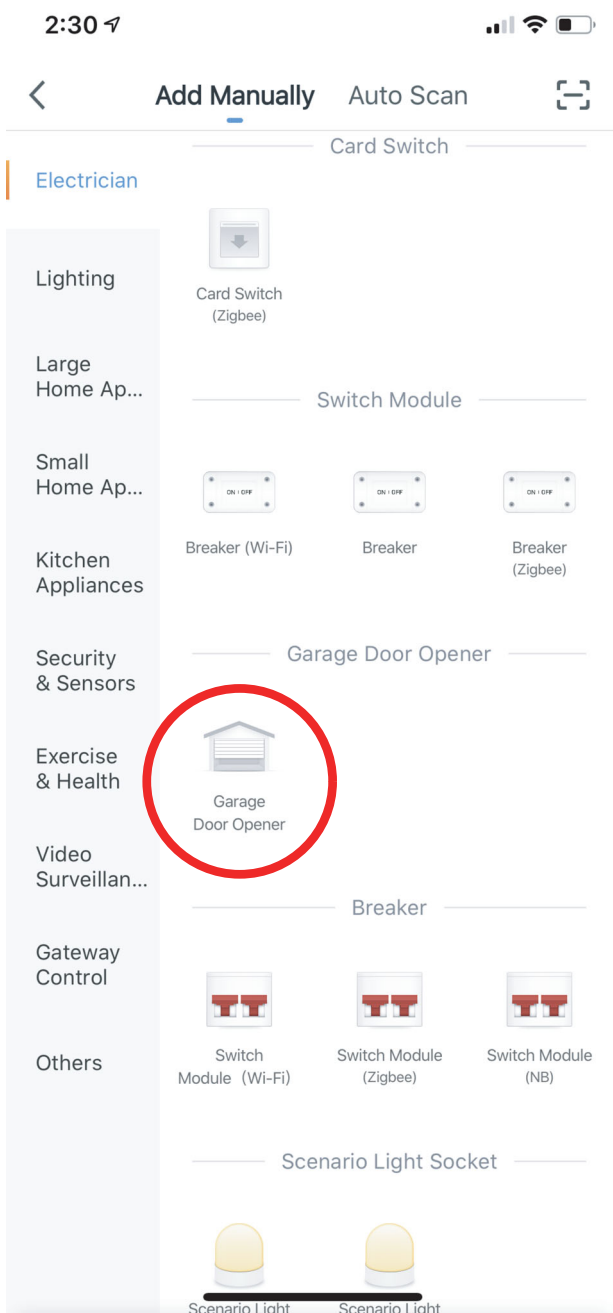

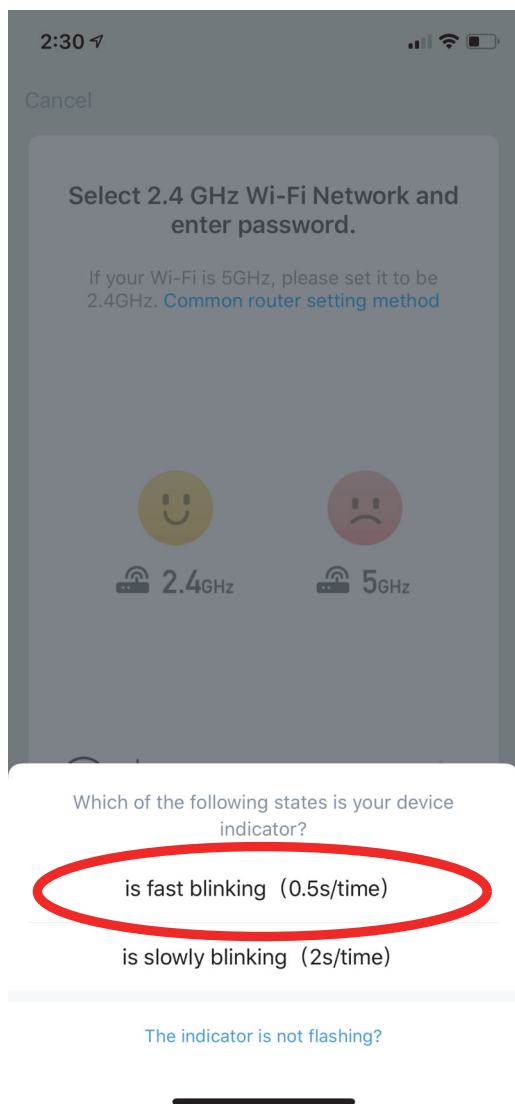

Note:(AP Mode Connection)

If connection failed under normal connection, and it maybe is a network problem. You can now be connected with the following steps: **"AP MODE "**

- **Press the "on/off" button for 8 seconds and make sure your devices light is flashing slowly.**
- Tap the icon "+" on the right top, Select **"Eletrician"**, then select **"Garage Door Opener"**. Connect to your Wi-Fi network, enter password, then select **"Next"**.
- Tap **"is slowly blinking (2s/time)"**, then tap Go to Connect
- Now, you will see the mobile phone WIFI. There will be a connection option: **"Smartlife-XXX"**, select it. In the tap that your wifi is already connected to, it will state, **"Smartlife-XXX"** on it and return to "Smart life" The APP Screen, and you will see the connection percentage.
- Waiting until the connection is successful.

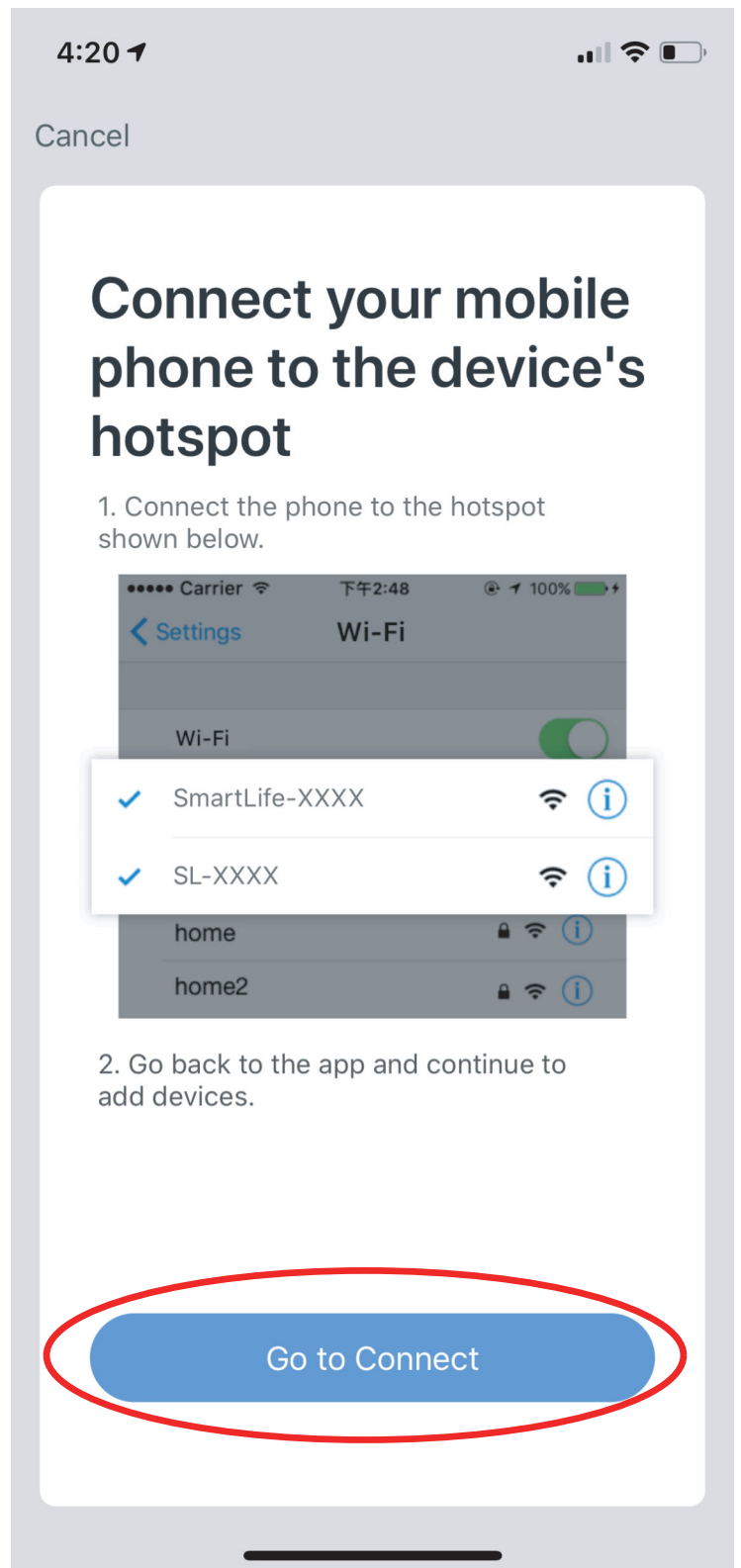
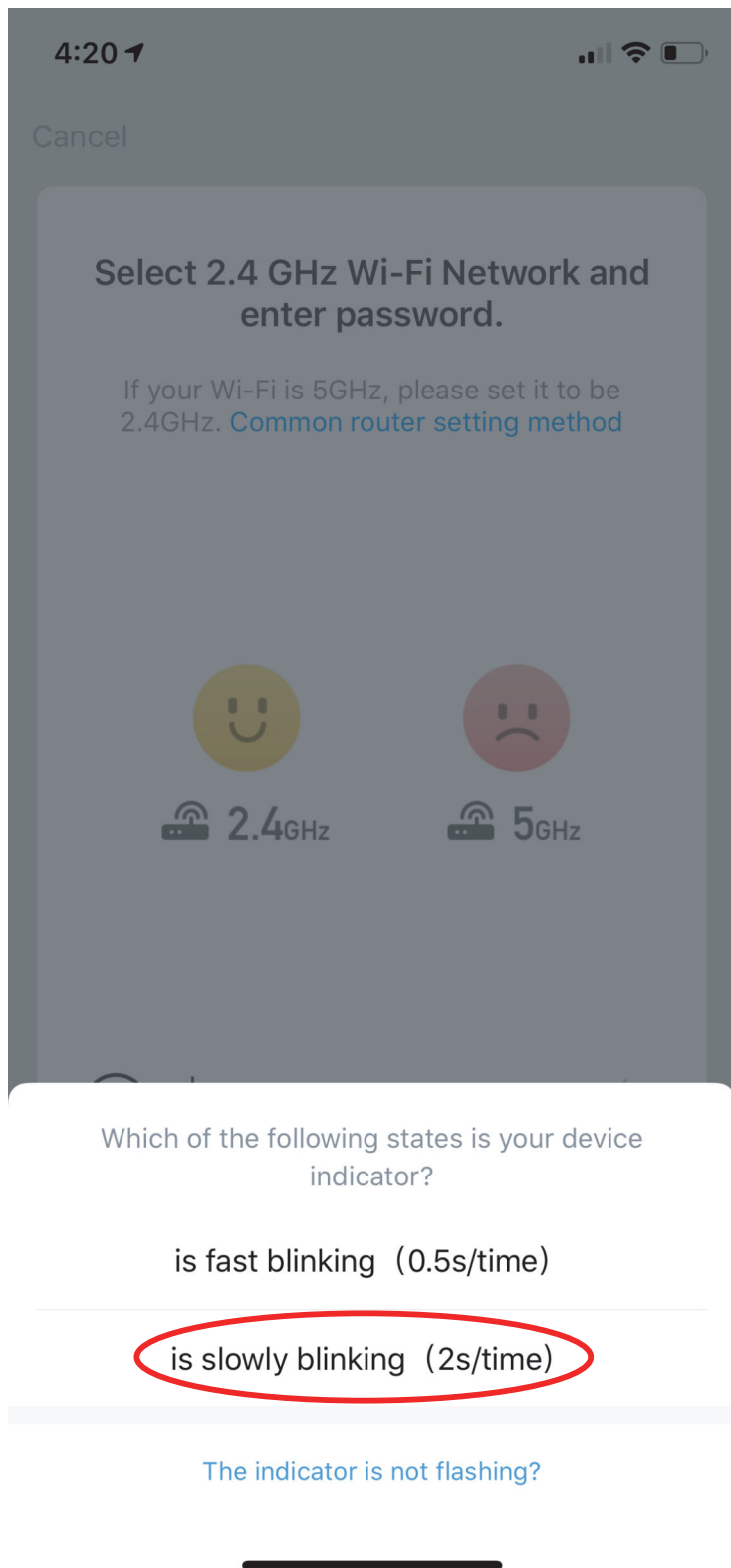

4:21

4G

Cancel

Adding device...

Ensure that the Wi-Fi signal is good.



4%



Scan
devices.



Register
on Cloud.



Initialize
the device.

4:21

4G

Cancel

Added.



Garage door

Device added successfully

客厅

主卧

次卧

餐厅

厨房

书房

Done

INSTALLATION

5. STEP 1 : Connect Controller to Opener

- Locate the 2 exposed wires coming out of the **Controller**
- Insert the 2 exposed wires into the terminals on the back of your **Garage Door Opener**

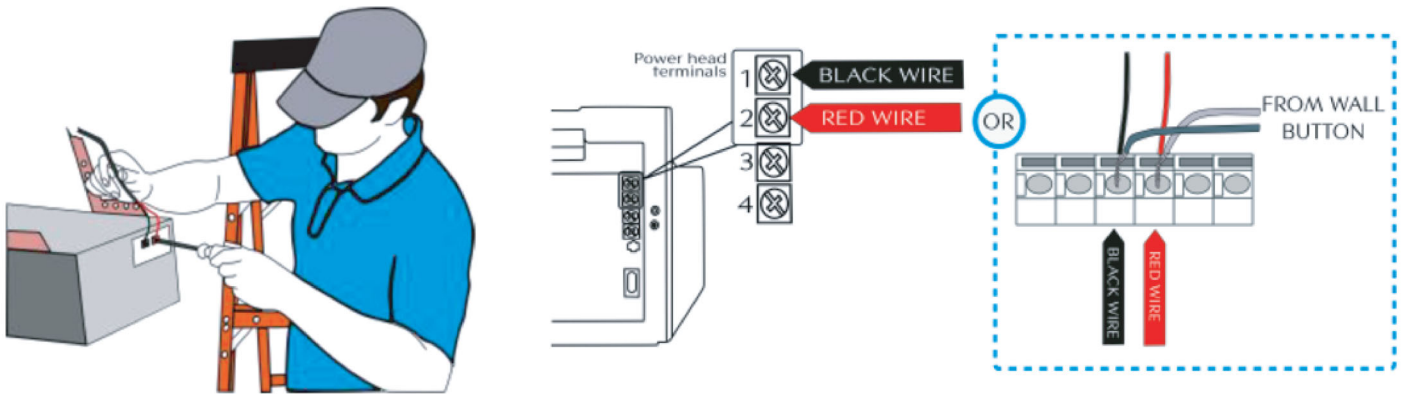

6. STEP 2 : Install the Door Sensor

- Remove the pull tab from the sensor to activate the battery.
- Install the door sensor to a clean and dry location on the top panel of the garage door using the fastening strips, or provided hardware.

➤ **Note:**

If using screws, only install to solid wood or insulated doors. DO NOT drill through door.

After installation, the wireless sensor does not respond and the APP does not notify. Please follow the steps below:

1) Please single click 5 times on the on / off button of the controller, the red and blue lights flash alternately

2) Open the wireless sensor and click on the button inside

Quick Guide of Using Siri to Control Smart Devices

1. Log in the **"Smart life"** app, select **"Smart"** at the bottom
2. Tap **" + "**, select **"launch Tap To Run"**, select **"Run the device"**

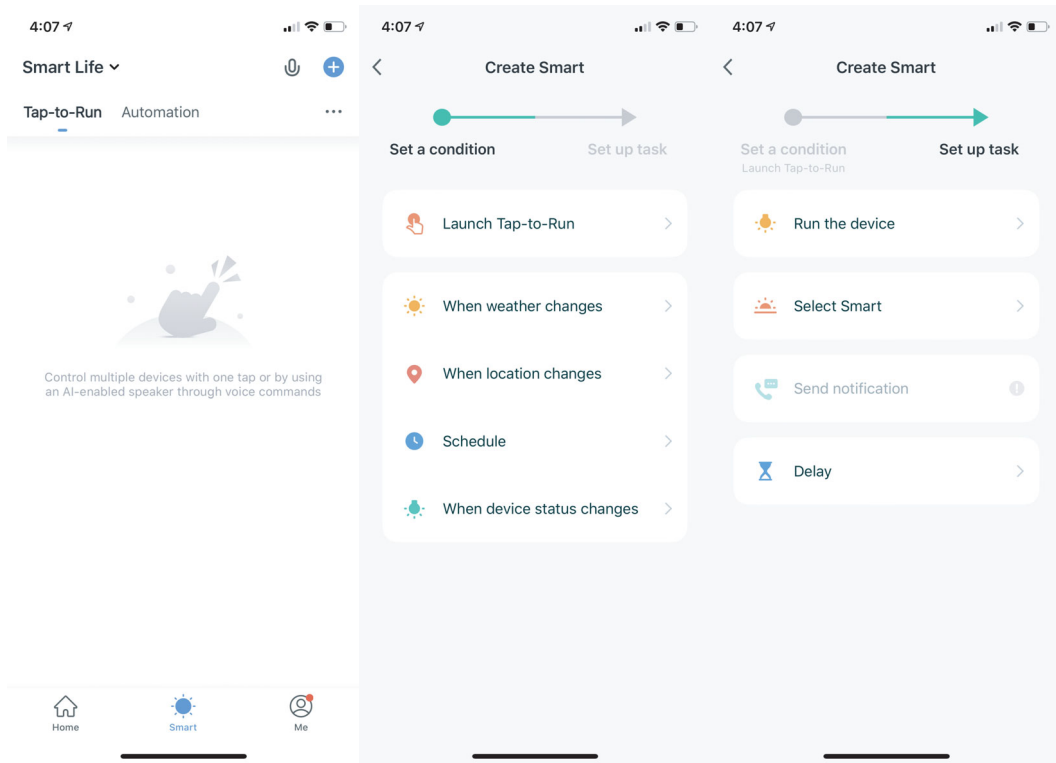

3. Select **"Garage door"**, tap **"switch"**, then select **"ON"**, click **"Save"**, and click **"Save"** again.

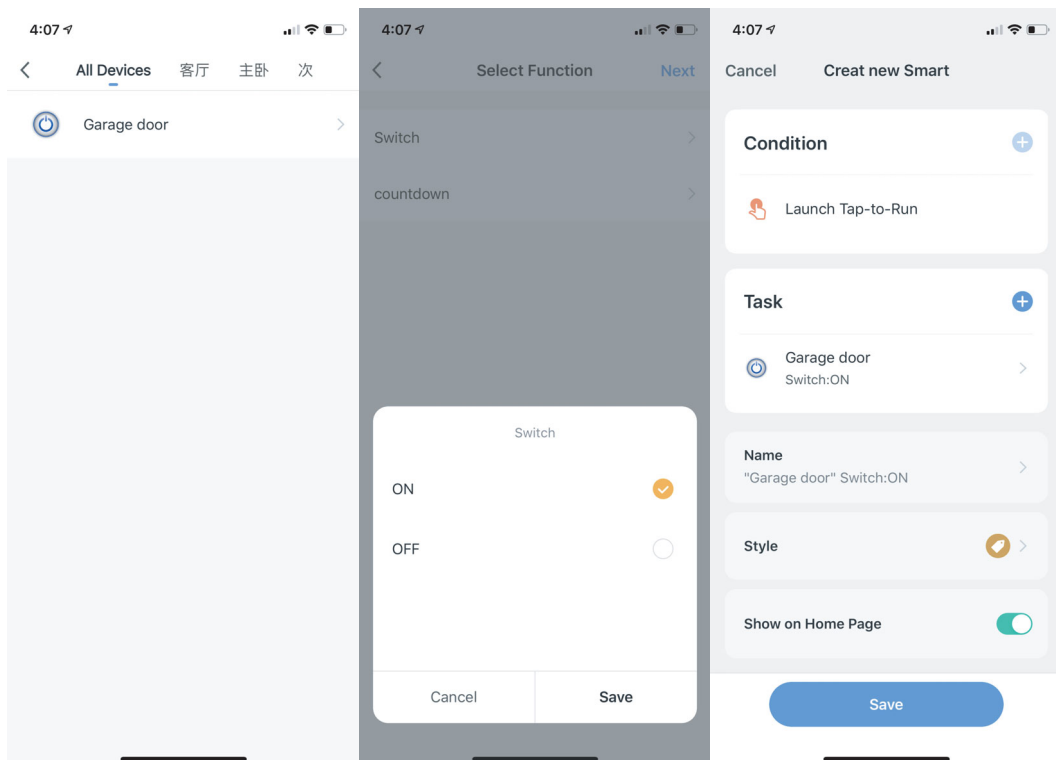

4. Back to the **"Smart"** page, tap the **"Add to Siri"** icon at the right bottom. Select the tab **"Garage door" switch: ON**.
5. Select **Add to Siri**. Now you can say the magic word **"Open the garage door"**.

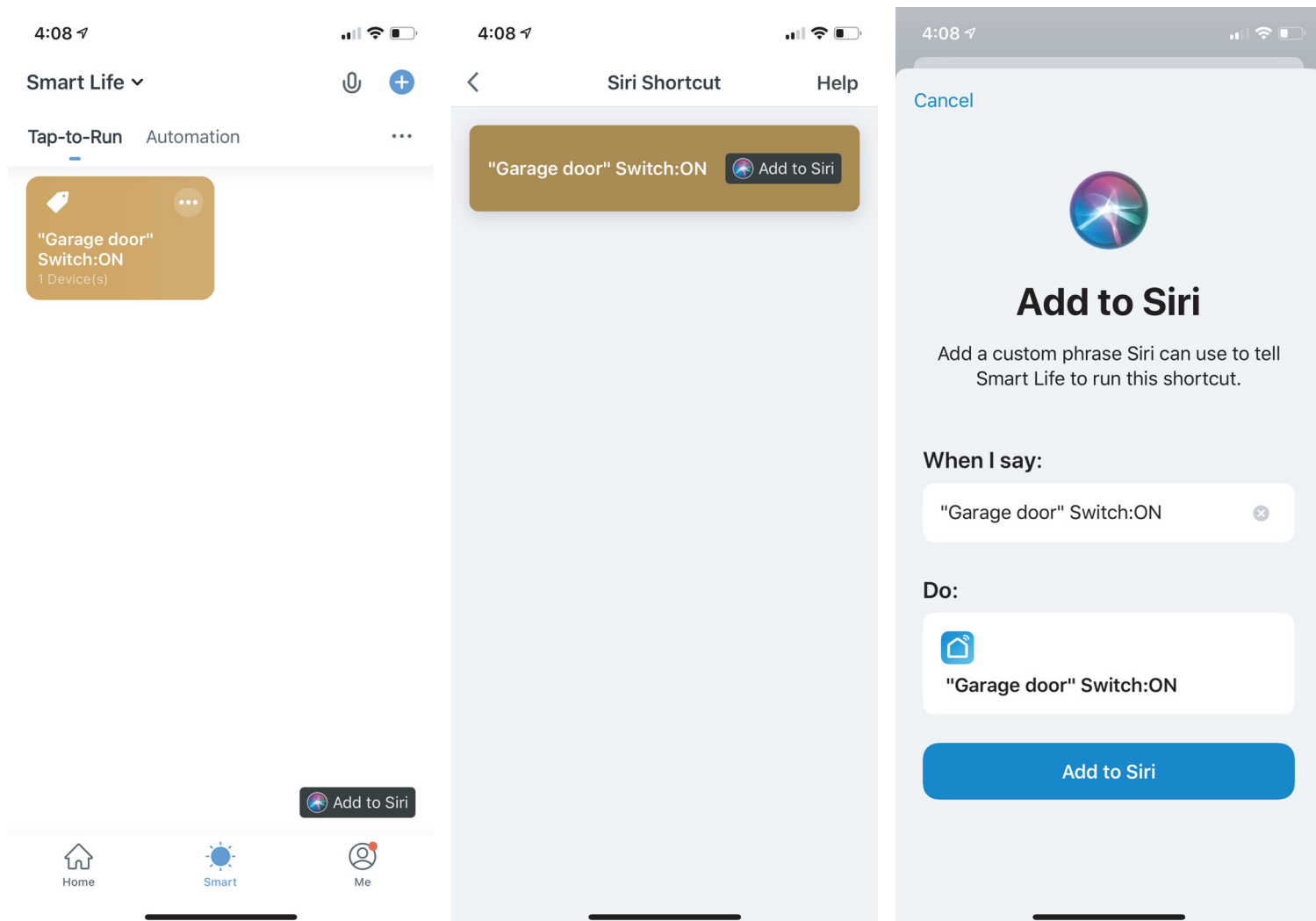

Quick guide to link Smart Life account to Google Home

Before link Smart Life to Google Home:

1. Launch "**Google Home**" app ,tap on the menu on upper left corner. Go to "**Set up device**". Then select "**Works with Google**"

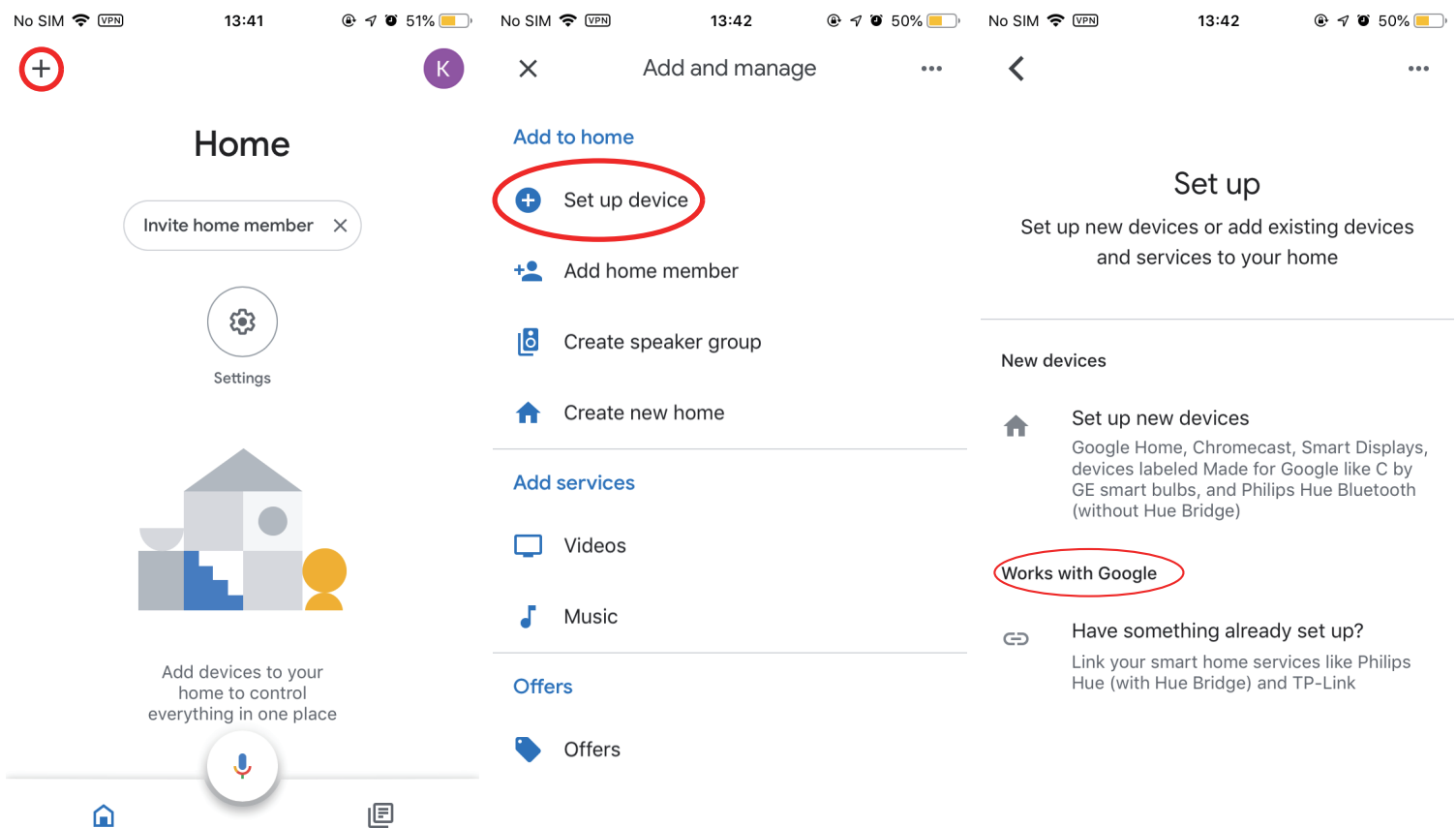

2. Enter "**Tuya Smart**" or "**Smart Life**" in the search field and search.

3. Tap "**Tuya Smart**" or "**Smart Life**", Enter your account information and Tap on "**Link now**" to link your account to your Google home account .

4.If your account is a phone number,you should select your country,If your account in an email address,please select a random country/region code.

5. Select "**Authorize**" that you are authorizing Google to access your devices.

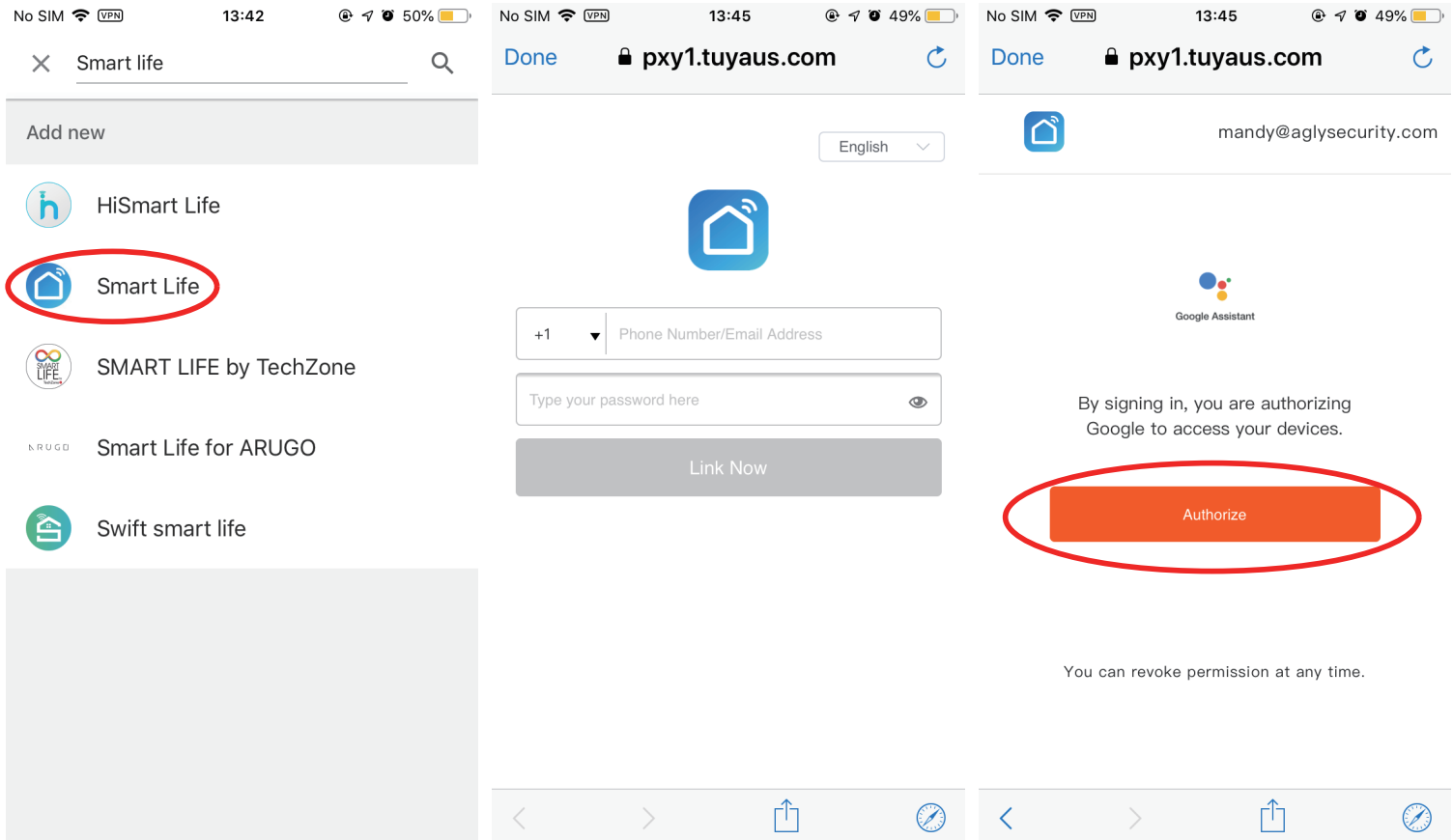

Voice commands:

"Hey Google, open my {device name}".

"Can I have your security code?"

"{One two x x}"

"Hey Google, close my {device name }"

"Hey Google, is my{device name}opened / closed"



Quick guide to link Smart Life account to Amazon alexa

Before link Smart Life to Amazon alexa:

1. Launch "**Amazon alexa**" app ,tap on the menu on upper left corner.
Go to "**Skills & Games**".
2. Enter "**Tuya Smart**" or "**Smart Life**" in the search field and search.

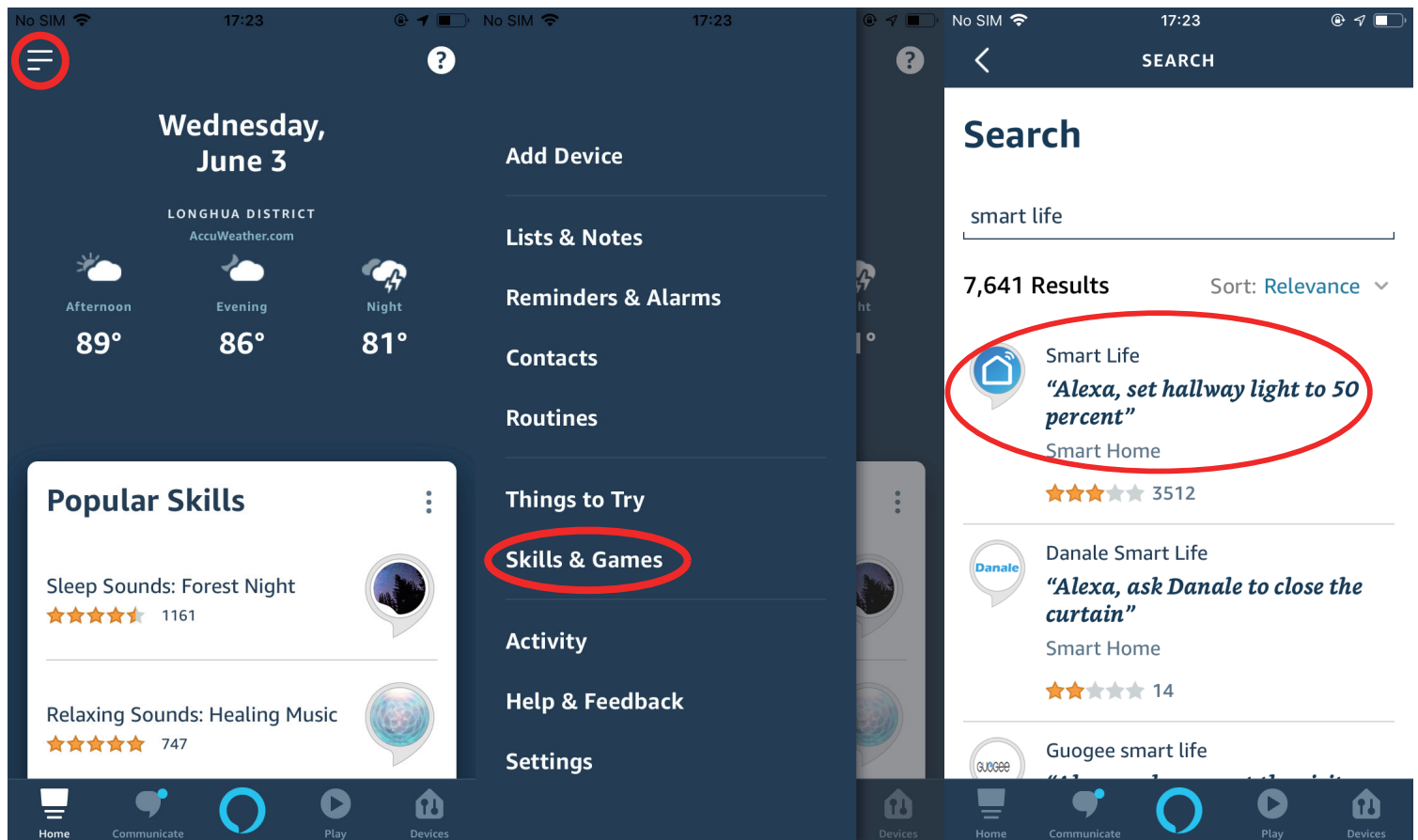

3. Tap **"Tuya Smart"** or **"Smart Life"**, Enter your account information and tap on **"ENABLE TO USE"** to link your account to your Amazon account.

4. If your account is a phone number, you should select your country, If your account is an email address, please select a random country/region code.

Voice commands:

"Alexa, Open {device name}"

"Can I have your security code?"

"{One two x x}"

"Alexa, Close {device name}"

"Alexa, is my {device name} opened / closed?"

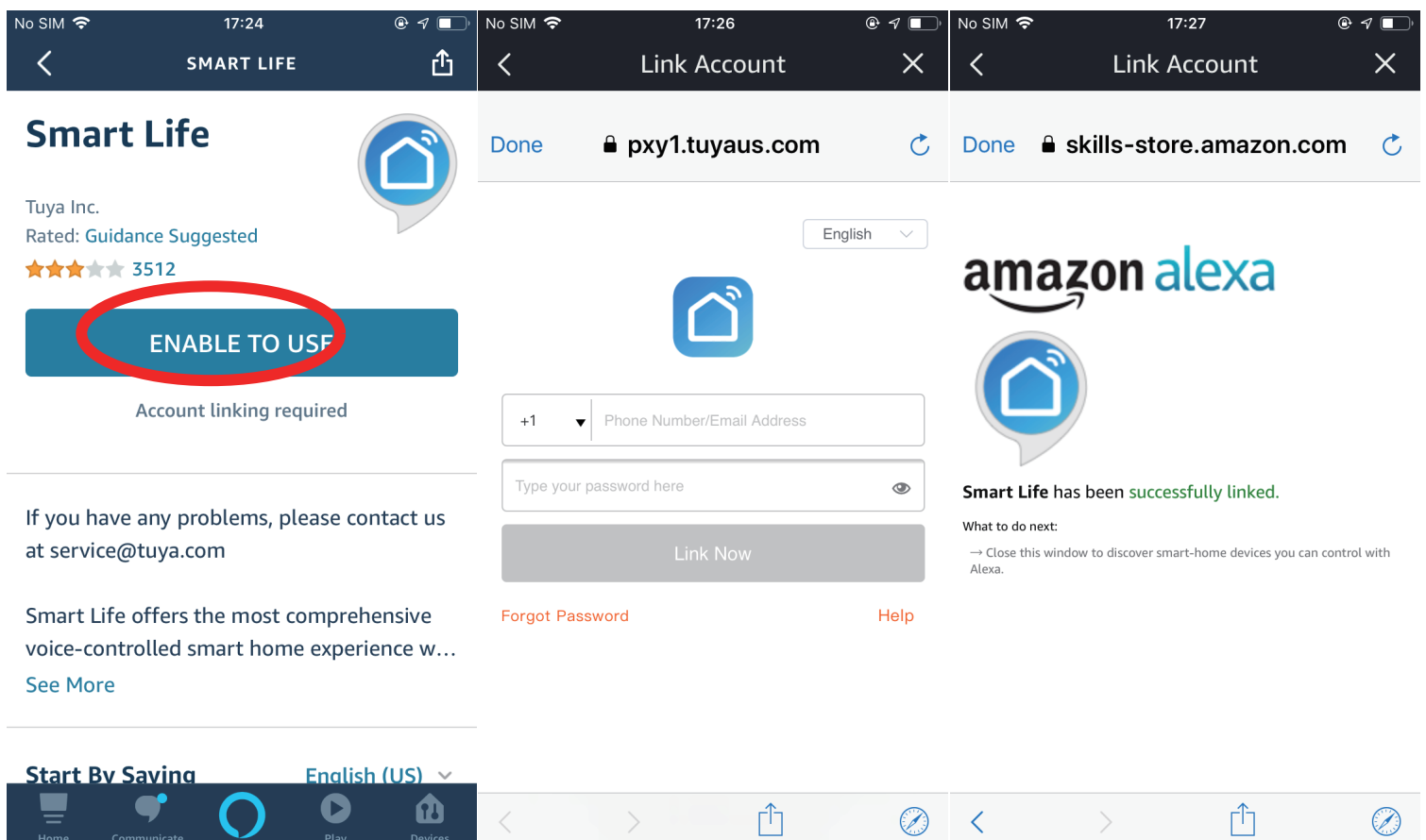

More Setting:Create a code to open by voice,then enter ALL DEVICES to select garage door.Setting the voice command,which you can perform a serious of actions.

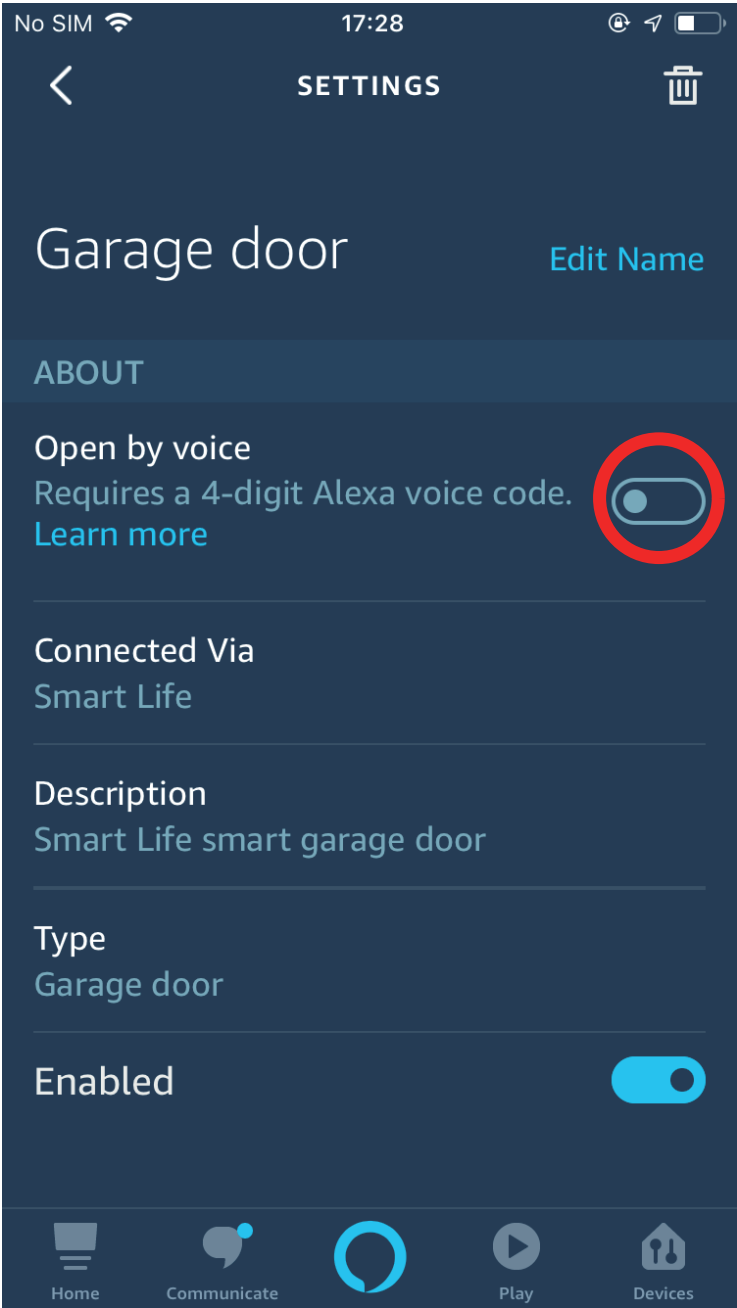
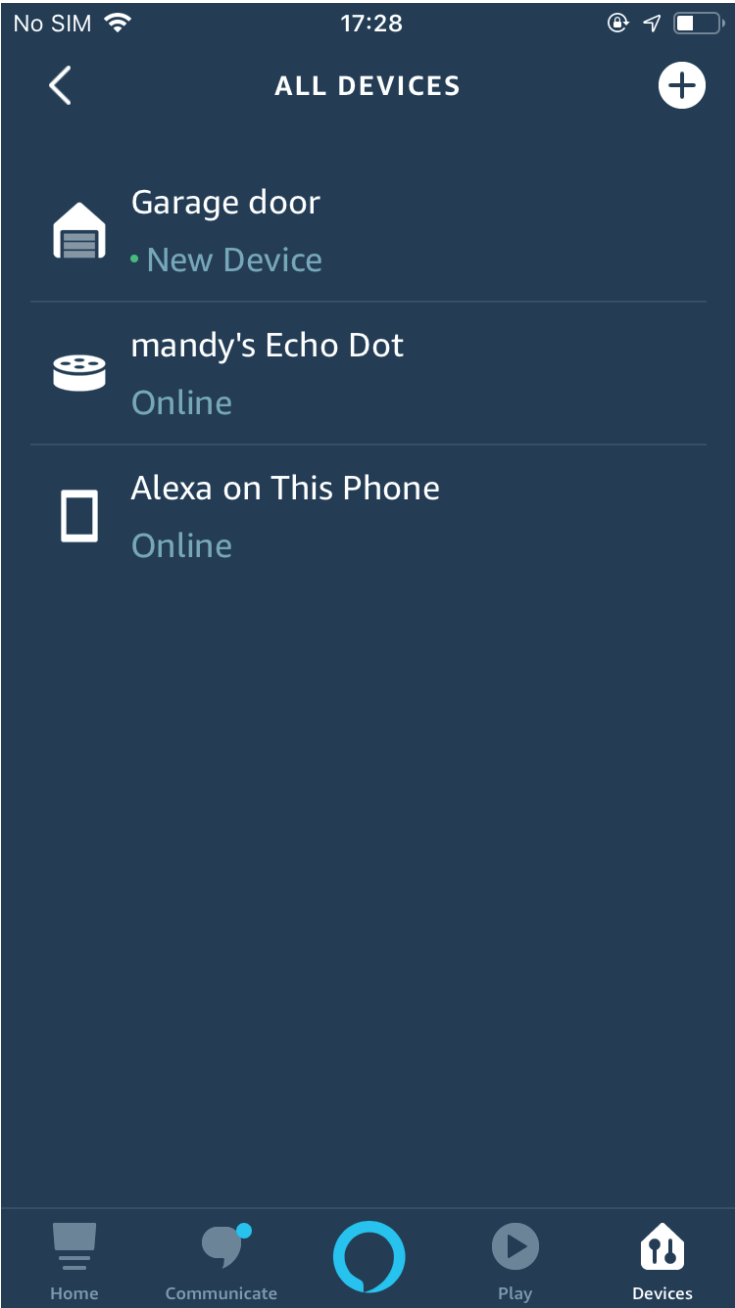

FCC Warning:

This equipment has been tested and found to comply with the limits for a Class B digital device, pursuant

to part 15 of the FCC Rules. These limits are designed to provide reasonable protection against harmful interference in a residential installation. This equipment generates, uses and can radiate radio frequency energy and, if not installed and used in accordance with the instructions, may cause harmful interference to radio communications. However, there is no guarantee that interference will not occur in a particular installation. If this equipment does cause harmful interference to radio or television reception, which can be determined by turning the equipment off and on, the user is encouraged to try to correct the interference by one or more of the following measures:

- Reorient or relocate the receiving antenna.
- Increase the separation between the equipment and receiver.
- Connect the equipment into an outlet on a circuit different from that to which the receiver is connected.
- Consult the dealer or an experienced radio/TV technician for help.

Caution: Any changes or modifications to this device not explicitly approved by manufacturer could void your authority to operate this equipment.

This device complies with part 15 of the FCC Rules. Operation is subject to the following two conditions:

(1) This device may not cause harmful interference, and (2) this device must accept any interference received, including interference that may cause undesired operation.

This equipment complies with FCC radiation exposure limits set forth for an uncontrolled environment. This equipment should be installed and operated with minimum distance 20cm between the radiator and your body.