

User Manual

Smart Temperature Humidity Sensor
With Bluetooth Gateway

TABLE OF CONTENTS

1. What's in the Box.....	1
2. Product Overview.....	2
3. LED Indicator Status Guides.....	3
4. Installing Your Device.....	4
5. Preparation Before Connecting.....	5
6. Connection.....	7
7. Create Your Scene.....	14
8. Troubleshooting.....	20

What is in the Box



Smart Sensor x 1



Bluetooth gateway x 1



Waterproof Label x 1



CR2450 Batteries
(pre-installed) x 2



Ejector Pin x 1



User Manual x 1



Lanyard x 1

Product Overview

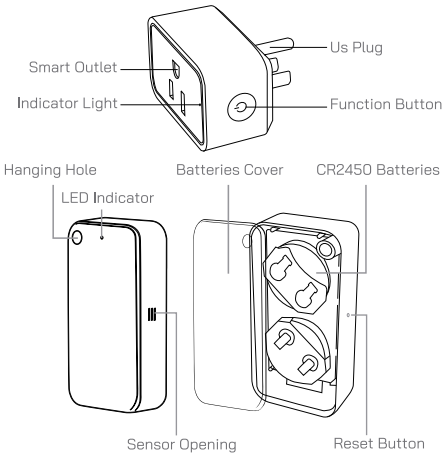

LED Indicator Status Guides

For Bluetooth Gateway Only

Blue light is always on	Wi-Fi connection is normal
light is always off	Wi-Fi connection failed
Blue light flashes slowly	Wi-Fi pairing mode
Purple light is always on	Smart Outlet Switch on
Red light is always on	Smart Outlet Switch off

Installing Your Device

- (1) Plug the gateway into the socket;
- (2) Pull out the battery insulation sheet;

Bluetooth Gateway

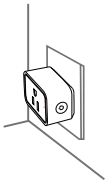

Smart Temperature humidity Sensor

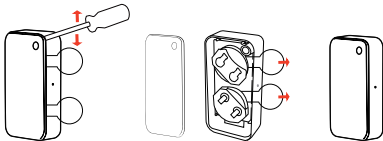

Preparation Before Connecting

2.4 Ghz WiFi

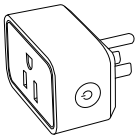

5 Ghz WiFi

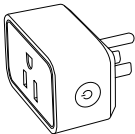

Downloading the “Smart life” App



Turn on the Bluetooth and Connect your mobile to the Wi-Fi.



Connection

1

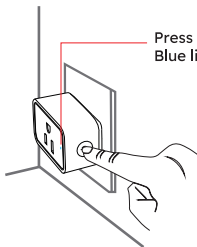

Press for 10s.
Blue light flashes quickly

2

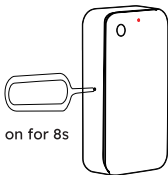

Red light flashes quickly

Hold on for 8s

Tap to add a device, then tap add

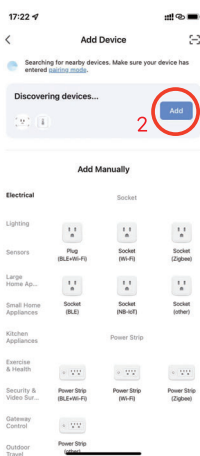
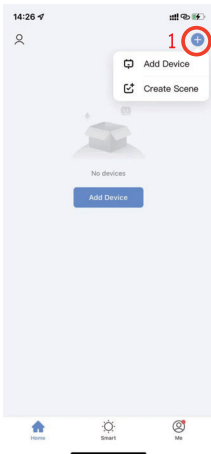

Enter Wi-Fi name and password, then tap Next.

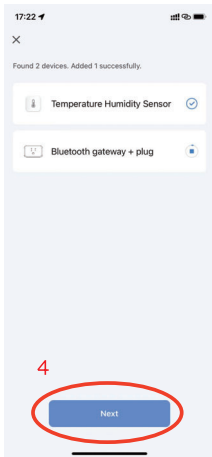
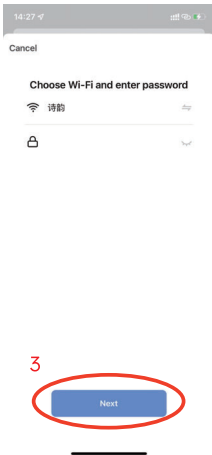

1 Tap Done

17:23



5 Done

Added.



Temperature Humidity Sensor

Device added successfully



Bluetooth gateway + plug

Device added successfully

2 Tap Finish

17:24



Add sub-device

Confirm

Please select the sub-device to add.

Select all



Temperature Humidity Sensor



add 1 devices successfully



6

Finish

Tap Gateway and Add device

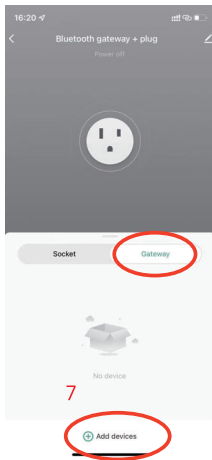

Tap Associate Bluetooth device

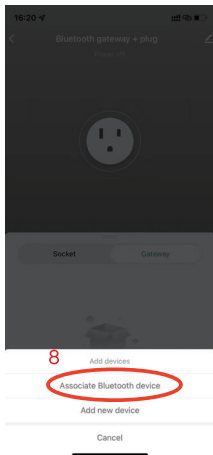

Select Temperature Humidity Sensor

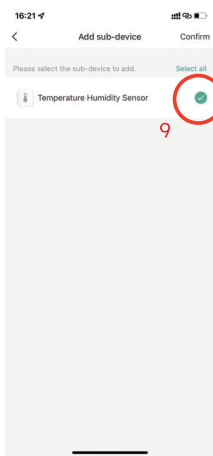

Select join

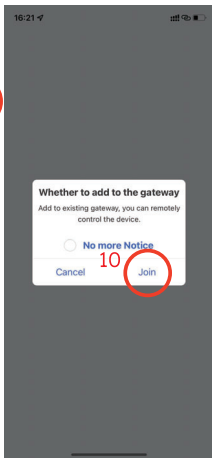

Tap Finish

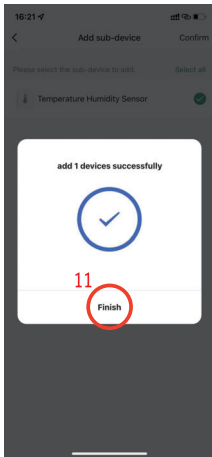

Create Your Scene

Tap Create Scene

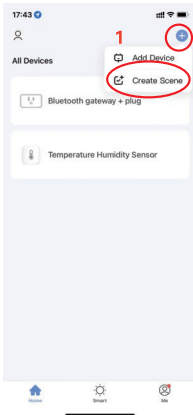

Tap when device status changes

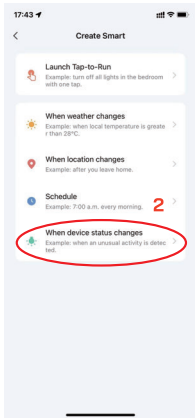

Choose Temperature Humidity Sensor

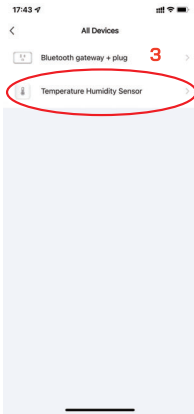

Humidity setting (If the humidity is lower than a certain value, then the humidifier is turned on)

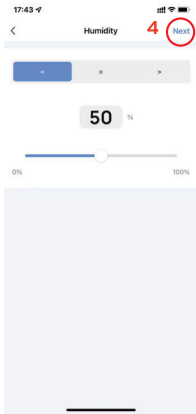

Select Add Task

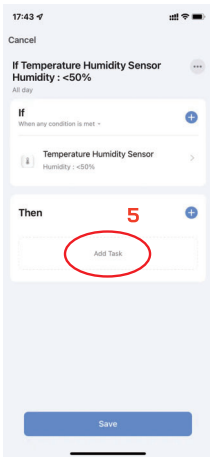

Then tap Run the device

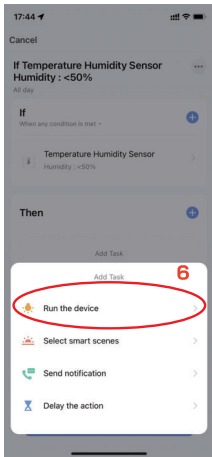

Select Bluetooth gateway+plug

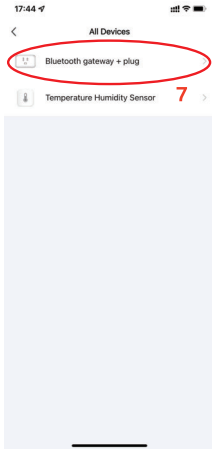

Tap Switch1

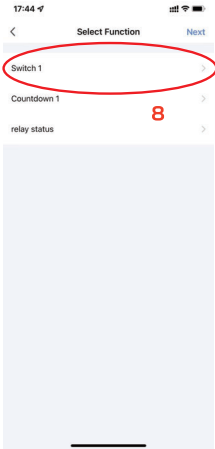

Select on and Save

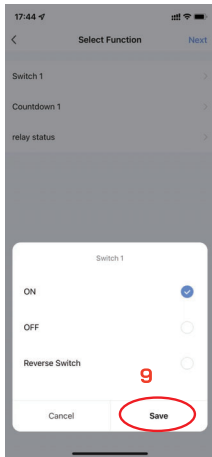

Tap Save

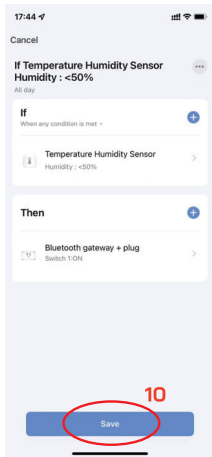

Tap Yes and Save

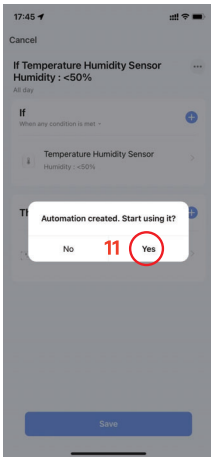

Troubleshooting

1.The gateway could not be connected to the Wi-Fi network or the connection is unstable?

- a.Product supports only 2.4 GHz (not 5 GHz) network.
- b.Check the name of the network and the password. Please try to avoid special characters.
- c.The device should be placed within the coverage of the router signal. Please keep the distance between the gateway and the router in 30 meters . (100ft)
- d.Reduce barriers like metal door or multiple / heavy walls; gateway and the router in 30 meters (100ft)

2.The sensors do not work?

- a.Pull out the insulation sheet before using.
- b.Check the battery capacity.
- c.Check if the sensor installed correctly.

3.The app alarm is delayed or no alarm?

- a.Shorten the distance and reduce the barriers between the sensor and gateway.
- b Disarm the gateway via app after the water leak occurs.

FCC Statement

This device complies with part 15 of the FCC rules. Operation is subject to the following two conditions: (1) this device may not cause harmful interference, and (2) this device must accept any interference received, including interference that may cause undesired operation.

Changes or modifications not expressly approved by the party responsible for compliance could void the user's authority to operate the equipment.

NOTE: This equipment has been tested and found to comply with the limits for a Class B digital device, pursuant to part 15 of the FCC Rules. These limits are designed to provide reasonable protection against harmful interference in a residential installation. This equipment generates uses and can radiate radio frequency energy and, if not installed and used in accordance with the instructions, may cause harmful interference to radio communications. However, there is no guarantee that interference will not occur in a particular installation. If this equipment does cause harmful interference to radio or television reception, which can be determined by turning the equipment off and on, the user is encouraged to try to correct the interference by one or more of the following measures:

- Reorient or relocate the receiving antenna.
- Increase the separation between the equipment and receiver.
- Connect the equipment into an outlet on a circuit different from that to which the receiver is connected.
- Consult the dealer or an experienced radio/TV technician for help.

The device has been evaluated to meet general RF exposure requirement. The device can be used in portable exposure condition without restriction.