

# User Manual

(433mhz door sensor )

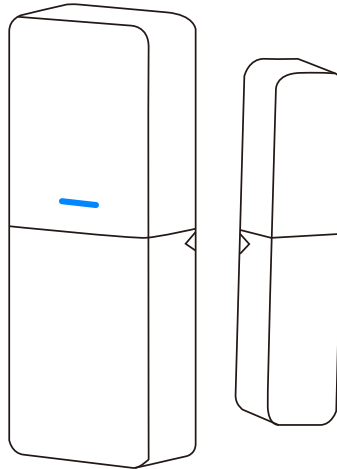

# 1. Specifications

RF	433MHz
Working voltage	DC12V
Battery model	2*23A
Workingt current	0.18a
Stand-by current	3ua
Wireless transmission distance	≤ 80m
Installation gap	<10mm
Working temperature	- 10℃~40℃
Material	ABS
Dimension	Transmitter: 765.5*25*14.5mm Magnet:52*11.6*13mm

## Product Introduction

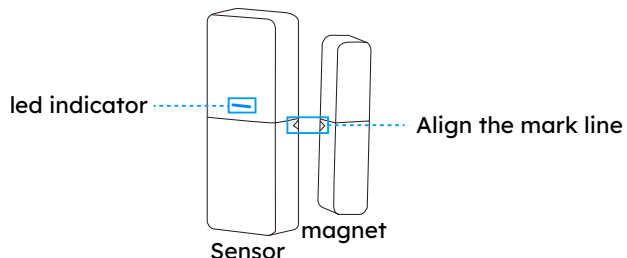

① The device weight is less than 1 kg .

## 2 . Install batteries

2-1 . Remove the cover of the sensor .

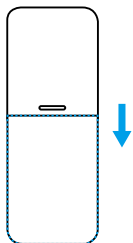

2-2 . Insert batteries into the battery compartment based on identifiers of positive and negative poles .

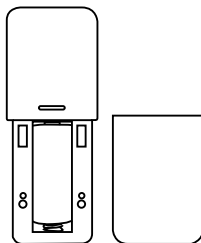

2-3 . Close the cover .

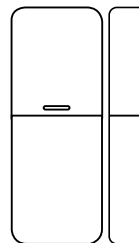

## 3.Install the device

3-1 Take out the insulation sheet, Paste 3m adhesive to the sensor and Tear off the protective film of the 3M adhesive.

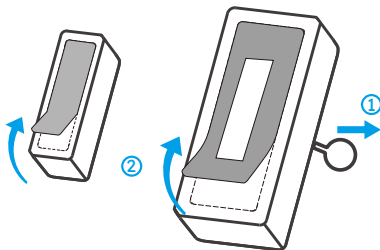

3-2 . Try to align the mark line on the magnet with that on the transmitter during installation .

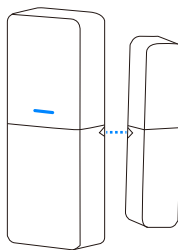

3-3 . Install them in the opening and closing area separately.

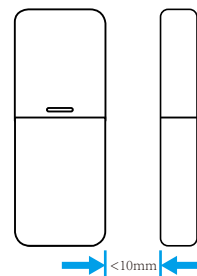

## 4. Application

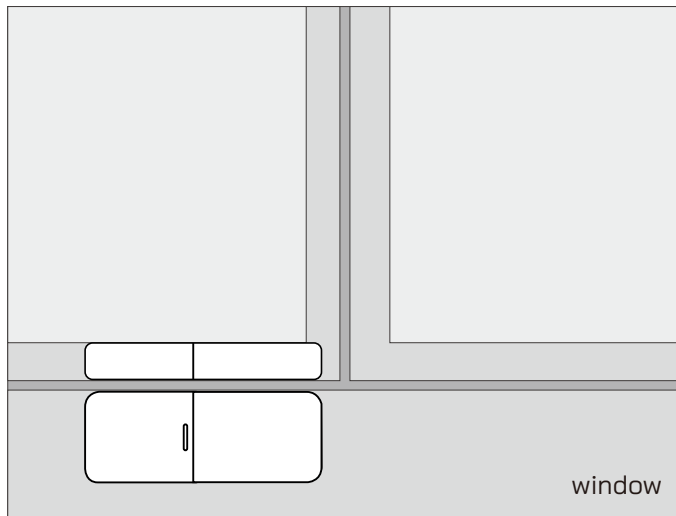
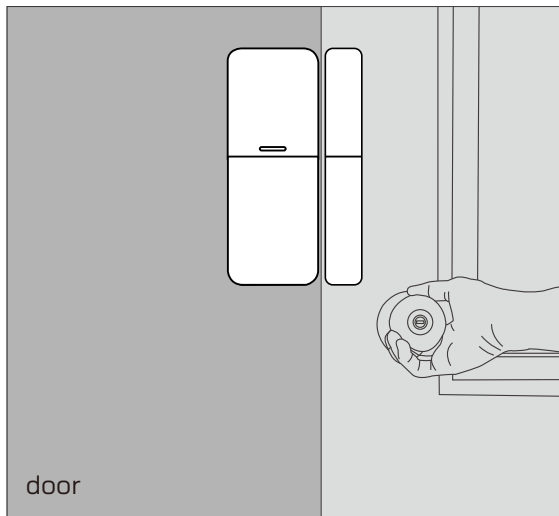

Note:

- Do not install outside the door/window.
- Do not install in the unstable position or in the place exposed to rain or moisture .
- Do not install near wiring or magnetic object .

## **FCC Statement**

This equipment has been tested and found to comply with the limits for a Class B digital device, pursuant to part 15 of the FCC Rules. These limits are designed to provide reasonable protection against harmful interference in a residential installation. This equipment generates, uses and can radiate radio frequency energy and, if not installed and used in accordance with the instructions, may cause harmful interference to radio communications. However, there is no guarantee that interference will not occur in a particular installation. If this equipment does cause harmful interference to radio or television reception, which can be determined by turning the equipment off and on, the user is encouraged to try to correct the interference by one or more of the following measures:

- Reorient or relocate the receiving antenna.
- Increase the separation between the equipment and receiver.
- Connect the equipment into an outlet on a circuit different from that to which the receiver is connected.
- Consult the dealer or an experienced radio/TV technician for help.

Caution: Any changes or modifications to this device not explicitly approved by manufacturer could void your authority to operate this equipment.

This device complies with part 15 of the FCC Rules. Operation is subject to the following two conditions: (1) This device may not cause harmful interference, and (2) this device must accept any interference received, including interference that may cause undesired operation.

### **RF Exposure Information**

The device has been evaluated to meet general RF exposure requirement. The device can be used in portable exposure condition without restriction.