

KR2201WR 智能通断器说明书

➤ 注意事项

- 请仔细阅读本说明书。
- 本产品只能在室内使用。
- 本产品不防水，请勿将本产品暴露于滴水或溅水等任何危险的环境。
- 本产品只能由成人安装。
- 请勿安装在任何热源附近。
- 请勿将本产品与调光器一起使用。
- 请勿在完全封闭的灯具中使用本产品。只能在开放式灯具中使用本产品。
- 如果本产品重量比需要更换设备的重量重，则有可能会降低照明设备和灯座的机械稳定性，并可能损害触点与灯的固定位。
- 电击危险：请在干燥环境中使用。
- 请勿湿手安装本产品！

接线示意图

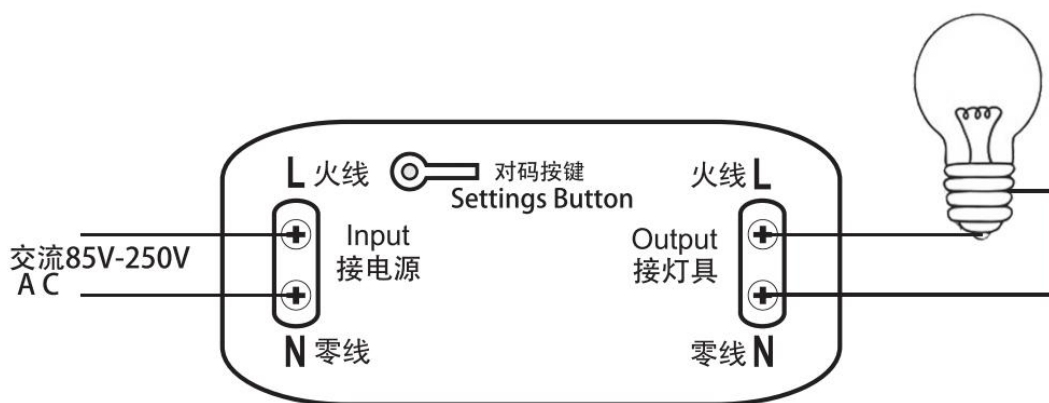

***请勿带电接线**

一、无线遥控功能操作说明（RF 功能）

*红色指示灯表示“智能通断器”进入配对遥控器的状态。

手动开关模式说明

无需遥控器，按一下对码按键“智能通断器”打开，再按一下对码按键“智能通断器”关闭。

自锁模式对码说明

（遥控器一个按键，按一下打开，再按一下关闭。该模式适用于 1 个遥控器按键控制 1 个“智能通断器”）

设置方法：按下“智能通断器”上的对码按键 2 次，红色指示灯闪烁后点亮；按下遥控器上需要配对的按键，当红色指示灯闪烁后熄灭，自锁模式设置成功。

互锁模式对码说明

（设置一个按键只能打开，另外一个按键只能关闭。需要至少两个按键以上的遥控器。该模式适用于一个遥控器控制多个“智能通断器”。）

设置方法：按下“智能通断器”上对码按键 3 次，红色指示灯闪烁后点亮；按下遥控器需要设置为打开功能的按键（例如按键 A）红色指示灯闪烁后，继续按遥控器上需要设置为关闭功能的按键（例如按键 B）红色指示灯闪烁，互锁模式设置成功。

点动模式对码说明

（同一个按键，按住打开，松开关闭。）

设置方法：按下“智能通断器”上的对码按键 4 次，红色指示灯闪烁后点亮；按下遥控器上需要配对的按键，当红色指示灯闪烁后熄灭，自锁模式设置成功。

复位设置

按下“智能通断器”的学习按钮 8 次后，“智能通断器”清除其存储器中的所有遥控器数据。当“智能通断器”的 LED 连续闪烁 8 次后，表示复位已完成。如已设置成上电通电状态也会被复位成上电断电状态。

二、设备与 WiFi 连接的操作方法

*绿色指示灯表示“智能通断器”正在进入 WiFi 配对的状态。

1. 使用准备

1) 将“智能通断器”通电，同时确保手机已连接到 2.4GHz 频段的 Wi-Fi 网络；开启手机蓝牙和手机定位。

2) 确保设备、手机、路由器三者靠近

3) 下载并打开 App：

在应用商店搜索“智能生活”或扫描以下的二维码下载安装 App；

如第一次下载使用，请点击“创建新帐户”按钮进行注册；

如已有账号，则点击“使用已有帐户登陆”按钮。



2. 重置“智能通断器”：

长按“智能通断器”上的对码按键 6 秒以上直到绿色指示灯快速的闪烁

3. 打开“智能生活”APP，点击右上角的“+”进入设备添加页面，然后选择“自动发现”

(进行此操作之前请打开手机的蓝牙功能)开始搜索附近待添加的设备,发现待添加设备后,设备的图标与名称会出现在 APP 页面中或者弹出提示页面,然后请按 APP 提示操作添加设备)

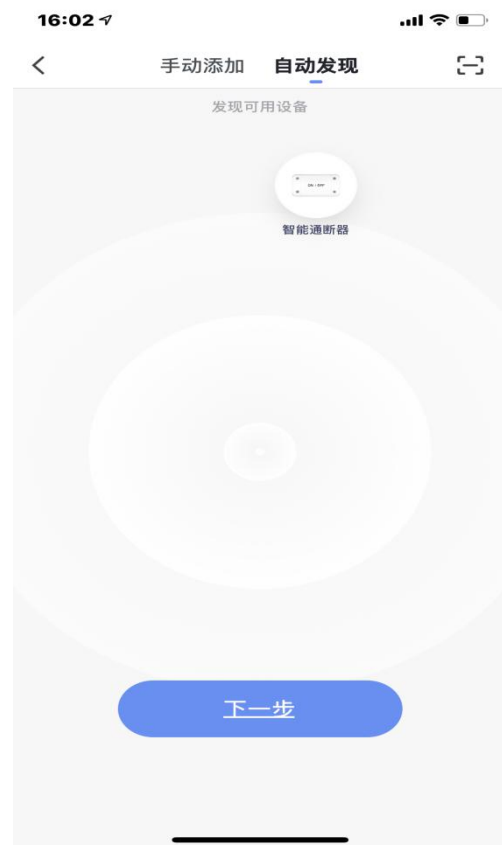
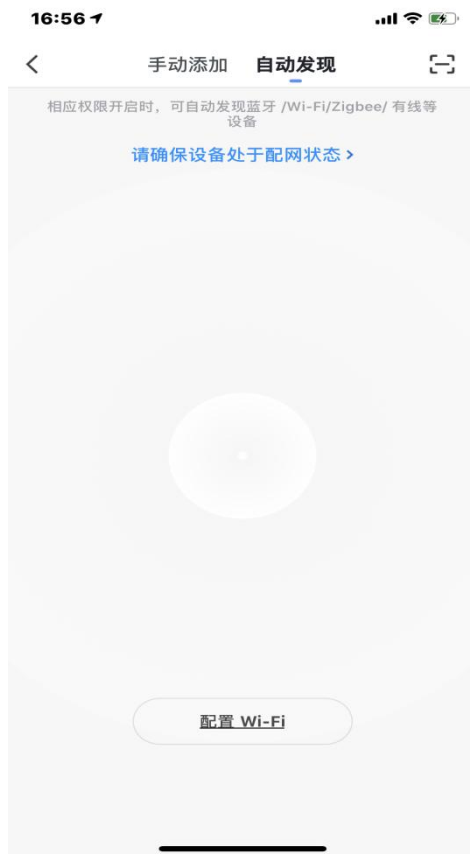

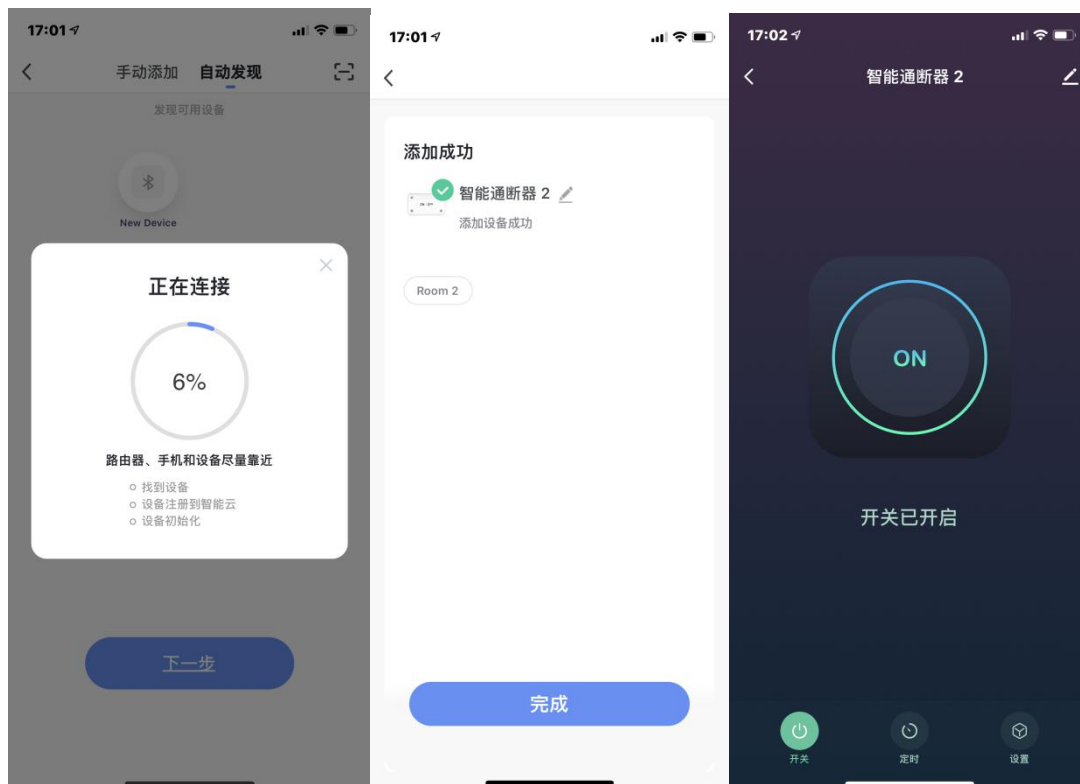
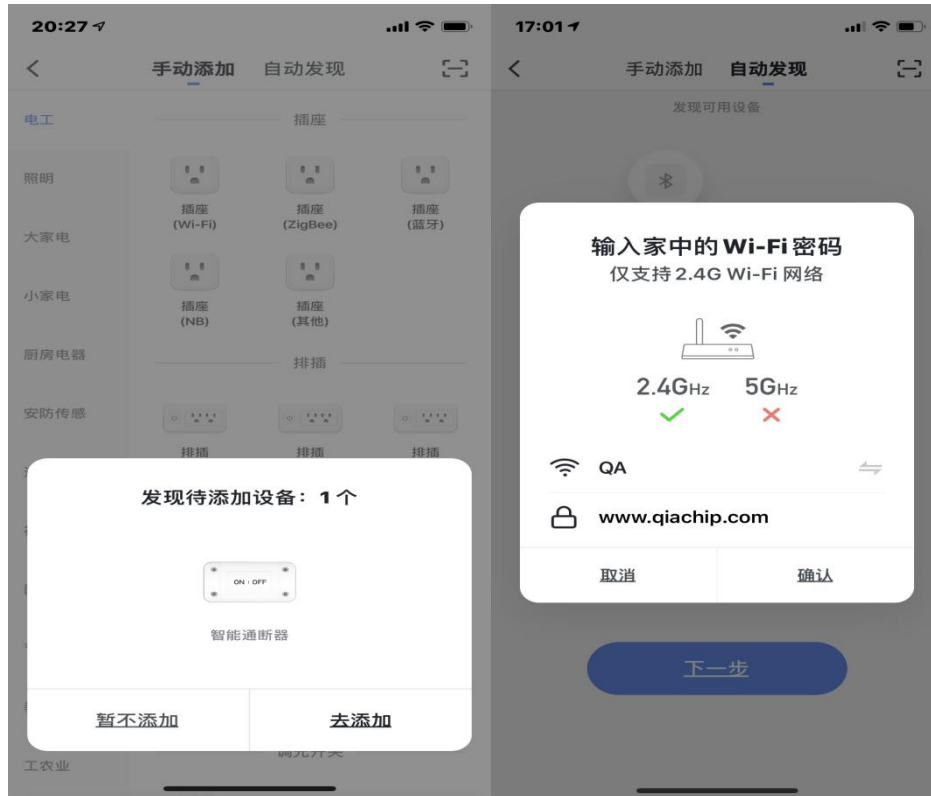

配网成功后可以在 APP 首页界面看到新添加的设备,此时“智能断路器”绿色指示灯常亮

➤ 过天猫精灵智能语音设备控制“智能通断器”

在这之前你需要做好以下准备工作：

- “智能生活”app可以正常的控制“智能通断器”。
- 拥有一个正常可以使用的天猫精灵智能音箱。
- 手机安装“天猫精灵”app并已经绑定天猫精灵智能音箱。

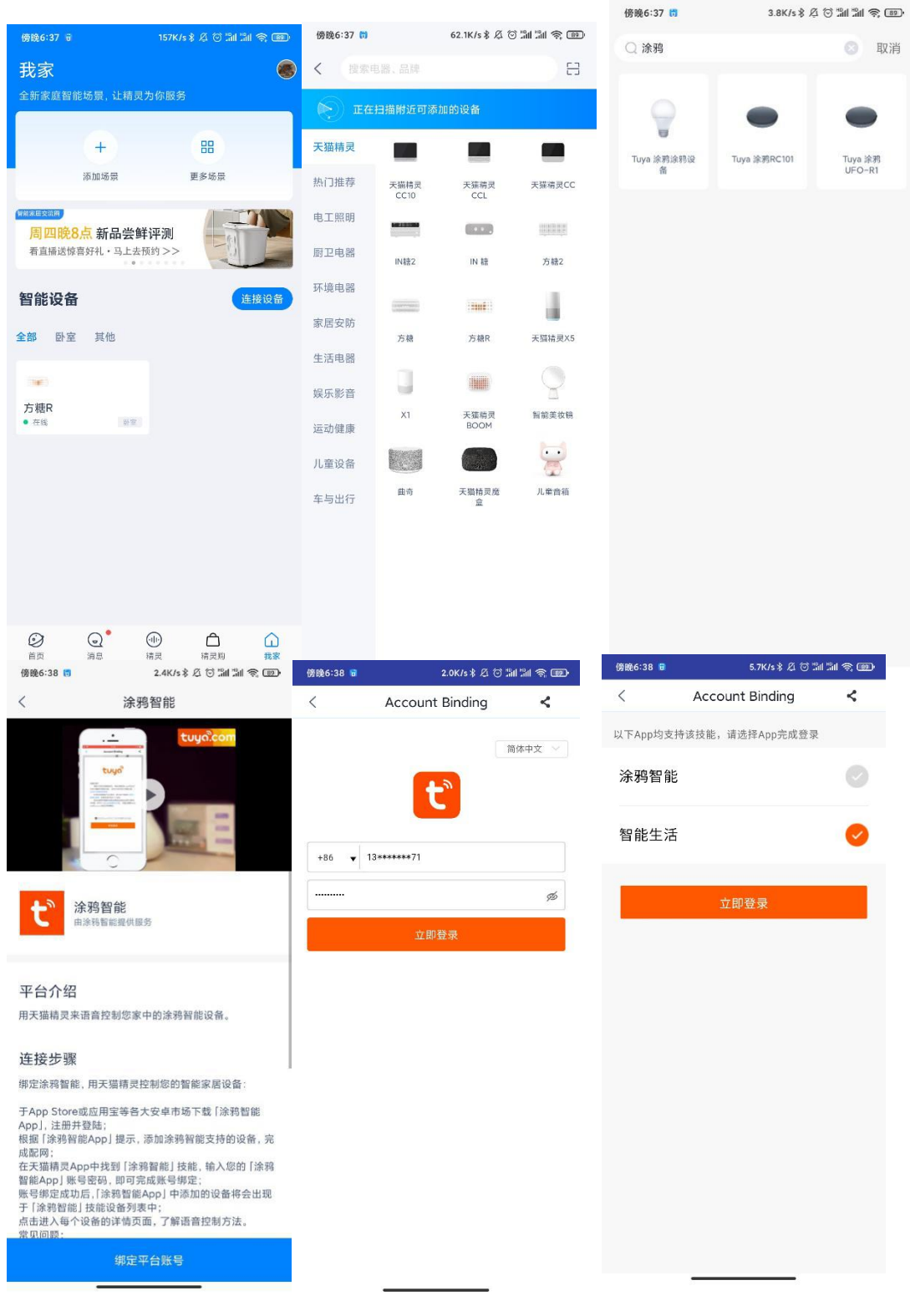

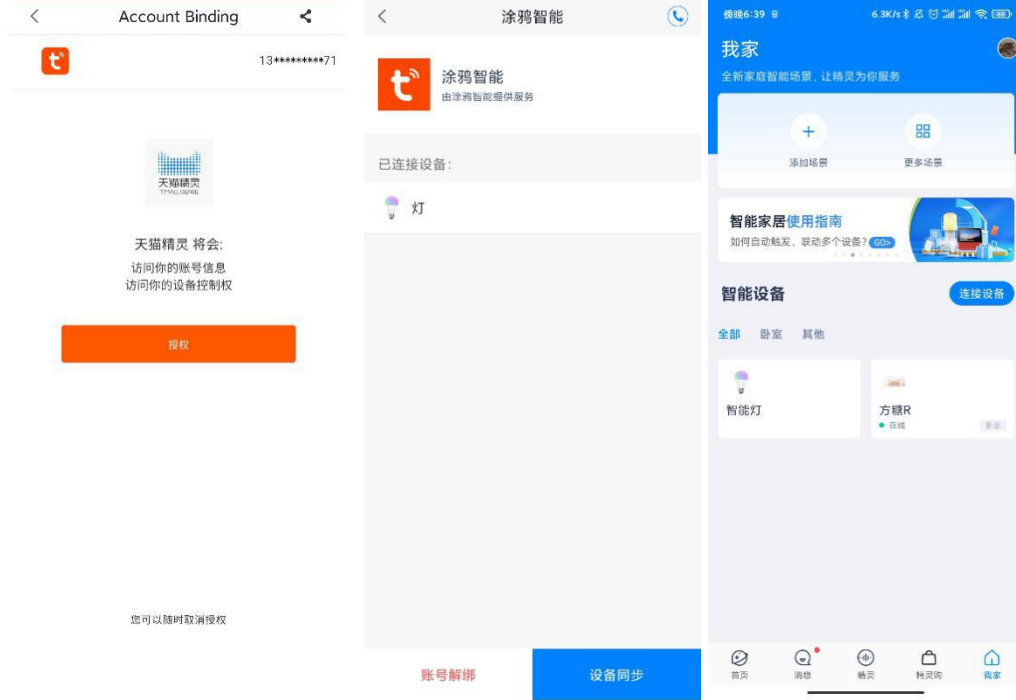

三、产品参数

输入电压：交流 AC 90V-250V 50/60Hz

最大负载电流：10A

最大负载功率：阻性负载 2200W (AC220V)

感性负载 500W (AC220V)

容性负载 200W (AC220V)

白炽灯 2200W

节能灯 300W

LED 灯 300W

遥控 (RF) 工作频率：433MHz

遥控 (RF) 距离：空旷地区大于 25 米

User Manual

➤ Safety Warning

- This device is for indoor use only.
- This device should not be exposed to dripping or splashing water or any danger Sources.
- This device should only be installed by adults.
- Do not install near any heat sources.
- Do not use this device with dimmers.
- Do not use this device in totally enclosed luminaires. Use this device in open luminaires only.
- If this device is much heavier than the one to be replaced , the increased weight may reduce the mechanical stability of certain luminaires and lampholders and may impair contact making and lamp retention.
- RISK OF ELECTRIC SHOCK: USE IN DRY
- LOCATIONS ONLY. Do not install this device with wet hands.

Wiring Diagram

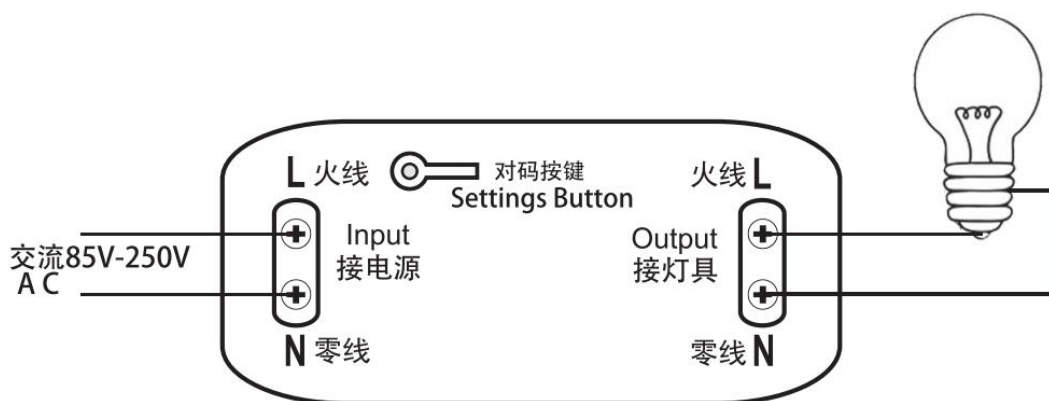

***Please don't install with electricity**

*** Note: RF working modes need to be implemented with QIACHIP brand remote control (transmitter) and controller (receiver / wireless remote control switch). There is no guarantee that remote controls from other brands will work properly.**

Operation

Note: The red indicator light indicates that the "smart switch" has entered the state of pairing the remote control.

Manual switch mode description

Without the remote control, pressing the setting button "smart switch" will turn it on, and pressing the setting button "smart switch" will turn it off.

Latch Mode Setting Description (Press the remote control to turn it on, then press it to turn it off. This mode is suitable for 1 remote control button to control 1 "smart switch")

Setting method: Press the setting button on the "smart switch" twice, the red indicator light flashes and then lights up; press the button that needs to be paired on the remote control, when the red indicator light flashes, it goes out, and the latch mode setting is successful.

Toggle mode setting Description (The same button, press and hold to open, release to close.)

Click the Settings button on the receiver once, wait for the LED to light up, and enter the setting state; then click the button (such as button A) on the remote control once, when the indicator light on the receiver flashes and goes out, the toggle mode setting is successful.

Jog mode setting Description (The same key, press and hold to open, release to close.)

Setting method: Press the code matching button on the "smart switch" 4 times, the red indicator light flashes and lights up; press the button that needs to be paired on the remote control, when the red indicator light flashes, it goes out, and the self-locking mode is set successfully.

Reset:

After pressing the receiver's learning button 8 times, the receiver clears all remote control data in its memory. When the receiver's LED flashes, the reset function is complete.

NOTE

- 1) Do not wire with power on, turn off the power to wire, and power on after checking and confirming that it is correct.
- 2) When the remote control voltage is low, please replace the battery in time (when the remote control battery voltage is low, the remote control distance will generally become shorter).
- 3) When using wireless electronic products, pay attention to avoiding metal masks, large electronic devices, electromagnetic fields and other strong sources of interference, so as to avoid the short distance between the remote control and the receiver or the failure of normal operation.
- 4) Do not use this electronic product abnormally. Abnormal use will reduce the performance and life of the product. In severe cases, it will damage the product and bring hidden dangers to your safety.

一、 How to connect the device to Wi-Fi ?

***The indicator light(Led) shows green that the device is matching the WIFI function**

First of all :

1. Power on the smart switch and make sure that the phone is connected to the Wi-Fi network in the 2.4GHz frequency band; turn on the phone' s Bluetooth.
2. Make sure that the device, mobile phone, and router are close to each other.
3. Download and open the App:

Search for "Smart Life" in the App Store or scan the QR code below to download and install the App;

For the first download and use, please click the "Create New Account" button to register;

If you already have an account, click the "Log in with an existing account" button.



4. Reset the smart switch: Press and hold the button on the smart switch for more than 6 seconds until the LED indicator on it flashes quickly.
 5. Open the "Smart Life" APP, click the "+" in the upper right corner to enter the device addition page, and then select "Auto Scan" (please turn on the Bluetooth function of the phone before performing this operation) to start searching for nearby devices to be added. After discovering the device to be added , The icon and name of the device will appear on the APP page or a prompt page will pop up, then please follow the APP prompts to add the device
-

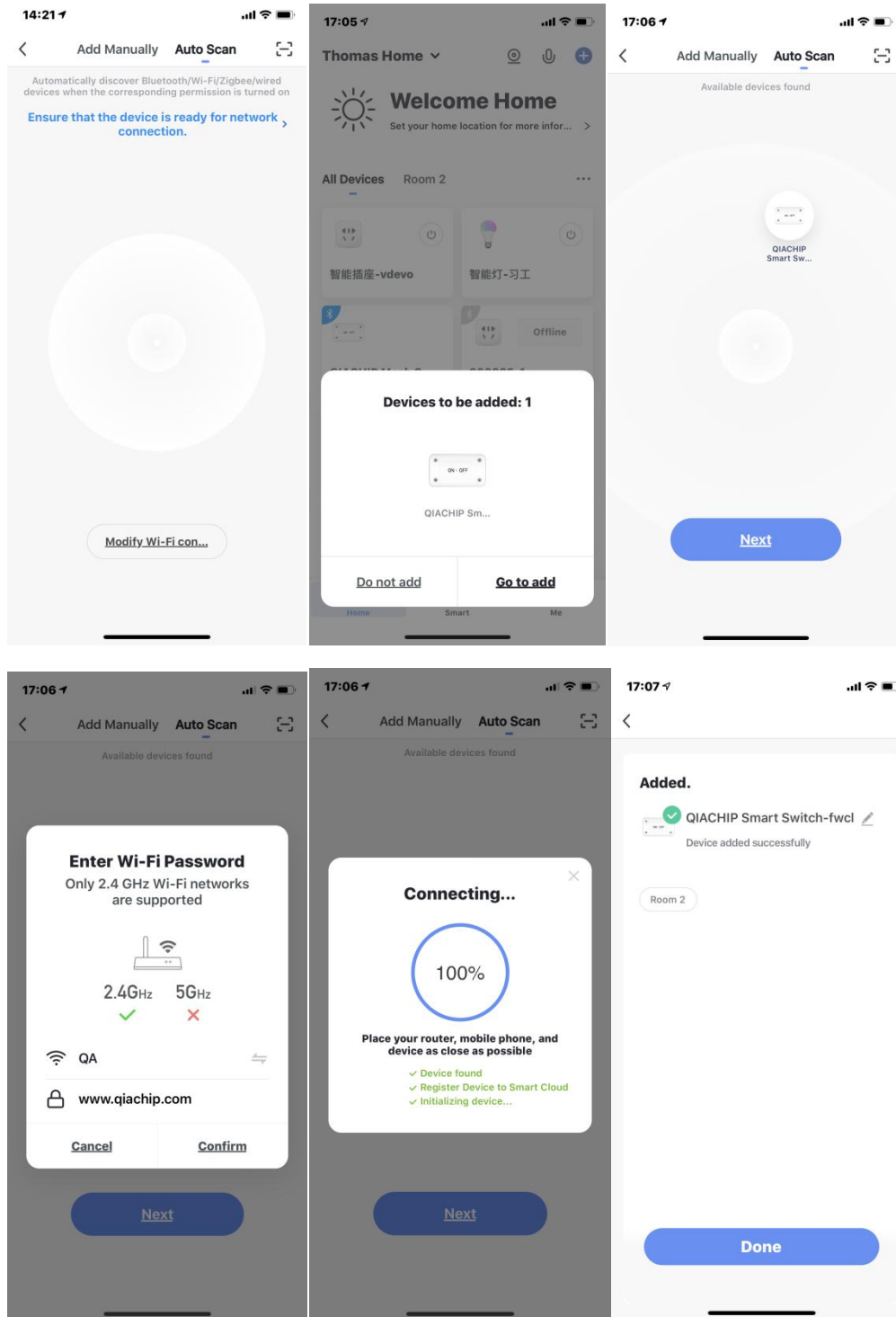

After the smart switch is successfully connected to Wi-Fi, LED is always on, you can see the newly added device on the home page of the Smart Life APP.

How to connect to third-party applications such as Alexa and Google Assistant?

When using a third-party smart speaker to connect, you first need to download the third-party APP and register an account, such as Amazon Alexa; then add the device in the "Smart Life APP", open the device control page, click the upper right corner (see the picture below), and

then Jump to the device information page, where you can change the name of the device, and you can see the details of the third-party controlled APP supported by the device, select the APP you need to connect, such as Alexa, click the icon to enter the binding interface, and then press The page prompts the operation. (see the figure below)

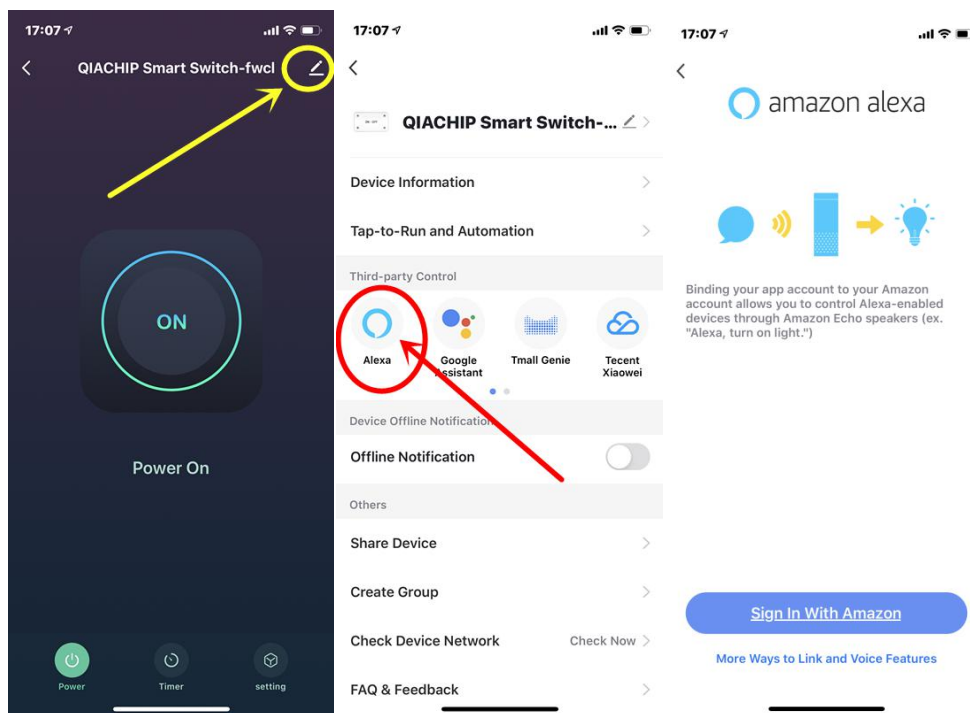

二、 Product Specifications

Input Voltage: AC 90V-250V 50/60Hz

Max Current: 10A

Max Load Power:Resistive load: 2200W (AC220V)

Incandescent lamp: 2200W (AC220V)

Inductive load: 500W (AC220V)

Capacitive load: 200W (AC220V)

Energy-saving lamp: 300W (AC220V)

RF working frequency: 433MHz

RF Remote control distance: open area greater than 25 meters



*Scan the QR code to view
the electronic manual

Warning:

This device complies with Part 15 of the FCC Rules. Operation is subject to the following two conditions: (1) this device may not cause harmful interference, and (2) this device must accept any interference received, including interference that may cause undesired operation.

changes or modifications not expressly approved by the party responsible for compliance could void the user's authority to operate the equipment.

NOTE: This equipment has been tested and found to comply with the limits for a Class B digital device, pursuant to Part 15 of the FCC Rules. These limits are designed to provide reasonable protection against harmful interference in a residential installation. This equipment generates, uses and can radiate radio frequency energy and, if not installed and used in accordance with the instructions, may cause harmful interference to radio communications. However, there is no guarantee that interference will not occur in a particular installation. If this equipment does cause harmful interference to radio or television reception, which can be determined by turning the equipment off and on, the user is encouraged to try to correct the interference by one or more of the following measures:

- Reorient or relocate the receiving antenna.
- Increase the separation between the equipment and receiver.
- Connect the equipment into an outlet on a circuit different from that to which the receiver is connected.
- Consult the dealer or an experienced radio/TV technician for help.

NOTE: This device and its antenna(s) must not be co-located or operation in conjunction with any other antenna or transmitter

RF Exposure Statement

To maintain compliance with FCC's RF Exposure guidelines, This equipment should be installed and operated with minimum distance of 20cm the radiator your body. This device and its antenna(s) must not be co-located or operation in conjunction with any other antenna or transmitter