

Print Version: S0-P8-01-09-EN

ATOTO
Different • Better • Reliable



Multi-Functional On-Dash Navigator

Updated information (the latest instruction manual, system updates, new functions, etc.) is available from <https://www.myatoto.com>



———— All rights including copyright reserved ————

ATOTO

Manufacturer: Shenzhen Aotule Electronics & Technology Co., Ltd

<https://www.myatoto.com> support@myatoto.com

3B-1204, Tianyungu, Bantian St, Longgang District, Shenzhen, China 518000



Precaution

[EN]As an environmentally responsible company, we try to reduce paper consumption as much as we can. Scan this QR code to access our online platform, where you can not only download all of our manuals in different languages, but also consult them more quickly by going to different sections with a finger tap.

[JP]環境に配慮した企業として、紙の消費量を可能な限り削減するよう努めています。このQRコードをスキャンして、オンラインプラットフォームにアクセスします。このプラットフォームでは、すべてのマニュアルをさまざまな言語でダウンロードできるだけでなく、指でタップしてさまざまなセクションに移動することで、より迅速に参照できます。

[DE]Als umweltbewusstes Unternehmen versuchen wir, den Papierverbrauch so weit wie möglich zu reduzieren. Scannen Sie diesen QR-Code, um auf unsere Online-Plattform zuzugreifen, auf der Sie nicht nur alle unsere Handbücher in verschiedenen Sprachen herunterladen, sondern auch schneller konsultieren können, indem Sie mit einem Fingertipp zu verschiedenen Abschnitten wechseln.

[FR]En tant qu'entreprise respectueuse de l'environnement, nous essayons de réduire au maximum la consommation de papier. Scannez ce code QR pour accéder à notre plateforme en ligne, où vous pouvez non seulement télécharger tous nos manuels dans différentes langues, mais aussi les consulter plus rapidement en accédant à différentes sections d'un simple toucher du doigt.

[IT]In qualità di azienda responsabile per l'ambiente, cerchiamo di ridurre il più possibile il consumo di carta. Scansiona questo codice QR per accedere alla nostra piattaforma online, dove puoi non solo scaricare tutti i nostri manuali in diverse lingue, ma anche consultarli più rapidamente andando alle diverse sezioni con un tocco di dito.

[ES]Como empresa responsable con el medio ambiente, intentamos reducir el consumo de papel tanto como podemos. Escanee este código QR para acceder a nuestra plataforma en línea, donde no solo podrá descargar todos nuestros manuales en diferentes idiomas, sino también consultarlos más rápidamente yendo a diferentes secciones con un toque de dedo.

[RU]Чески ответственная компания мы стараемся максималь но сократить потребление бумаги. Отсканируйте этот QR-код, чтобы получить доступ к нашей онлайн-платформе, где вы можете не только загрузить все наши руководства на разных языках, но и быстрее обращаться к ним, переходя в разные разделы одним касанием.



Precaution

- This manual is applicable to all ATOTO P8 models. Some functions mentioned in this manual are only available on selected ATOTO P8 models. Newly released P8 models may have extra functions that are not mentioned. The screenshot images provided in this manual may be different from what's displayed on the current system. ATOTO may release new system updates, which may include changes made or newly added functions that are not mentioned here.
- The information in this manual may be insufficient. If you have any questions or problems concerning your unit that are not covered in this manual, consult your ATOTO dealer.

IN NO EVENT SHALL ATOTO BE LIABLE FOR ANY INCIDENTAL, INDIRECT OR CONSEQUENTIAL DAMAGES OR OTHER DAMAGES INCLUDING, BUT NOT LIMITED TO, LOSS OF PROFITS, LOSS OF REVENUE, LOSS OF DATA, LOSS OF USE OF THE PRODUCT OR ANY ASSOCIATED EQUIPMENT, DOWNTIME, AND THE PURCHASER'S TIME RELATED TO OR ARISING OUT OF THE USE OF THIS PRODUCT, ITS HARDWARE AND/OR ITS SOFTWARE.

Table of Contents

1. Basic Information	01
2. Installation	04
2.1 Mounting Methods	04
2.2 Power Supply	06
2.3 Cable Connection	07
3. Packing List	08
4. Home Page	10
5. Menu	11
6. Operation	12
6.1 Bluetooth	12
6.2 USB Music	17
6.3 CarPlay Connection	18
6.4 Android Auto Connection	19
6.5 Subscribe to Phone Mirroring Function ..	21
6.6 Camera Input and Recording	21
6.7 Audio Output	25
6.8 Gallery	26
6.9 Settings	27
7. OTA Update	31
8. Ways to Obtain Help	31
9. Specifications	32
10. Troubleshooting	36

01 Basic Information

1. Basic Information

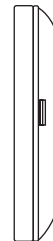
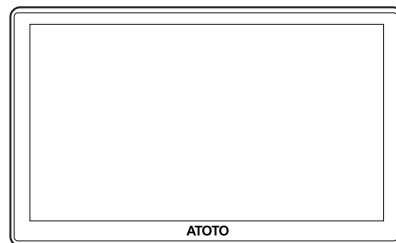

Pic. 1

01 Basic Information

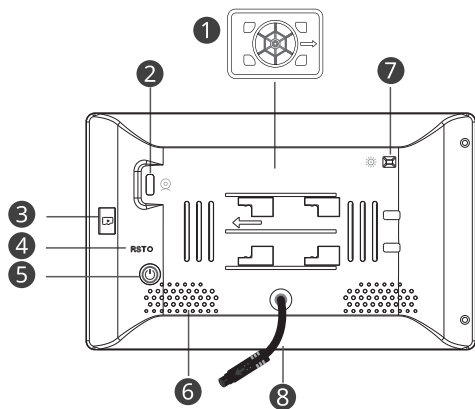

Pic. 2

- ① Holder Adapter
- ② USB-C Port for Camera
- ③ SD Card Slot
- ④ Reset Button
- ⑤ Power Switch (press to switch on; press and hold for 8 seconds to switch off)
- ⑥ Built-in Speaker
- ⑦ Built-in Light Sensor
- ⑧ Power Cable Plug

01 Basic Information

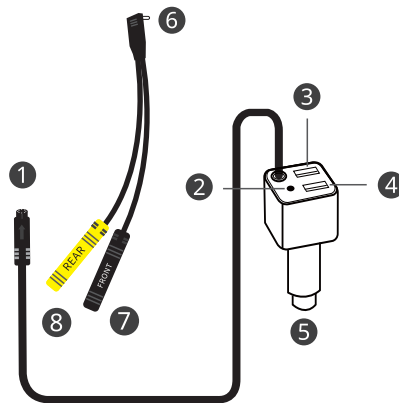

Pic. 3

- ① Power Cable Jack
- ② Auxiliary Output
- ③ USB Port for Phone Quick Charge
- ④ USB Port for Wired Android Auto and Media Playback
- ⑤ Power Plug
- ⑥ USB-C Plug for Camera
- ⑦ Front Camera Input
- ⑧ Rear Camera Input

02

Installation

2. Installation

2.1 Mounting Methods

2.1.1 With Sticking Holder

Step 1:

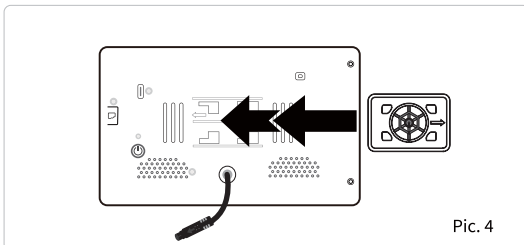

Step 2:

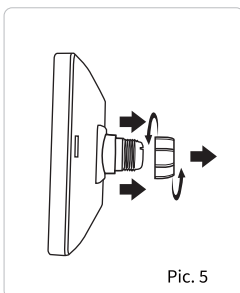

Step 3:

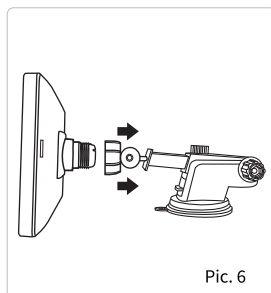

Step 4:

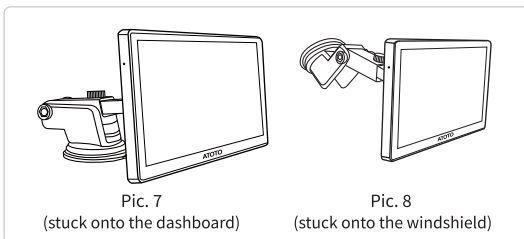

02

Installation

2.1.2 With 3rd Party Holders

(compatible ball diameter: 17mm)

1

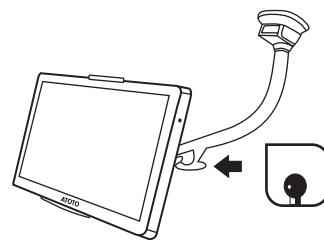

2

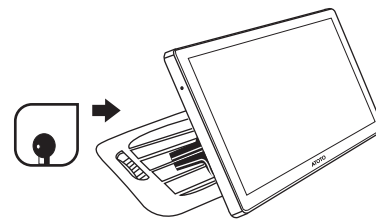

These are only a few examples of compatible holders on the market.

02 Installation

2.2 Power Supply

2.2.1 The Cigarette Lighter

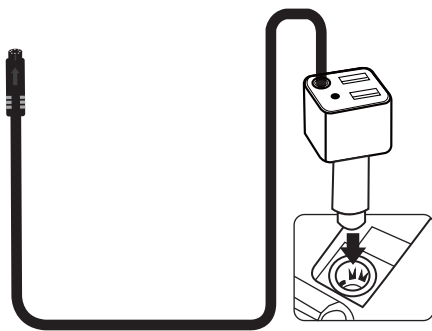

Pic.11

2.2.2 AC-P8AC12 Power Connector(to be released)

Connect the wires to the vehicle's Constant/Battery Power (+), Accessory/Ignition (+) and Chassis Ground (-) wires respectively to power P8 up.

02 Installation

2.3 Cable Connection

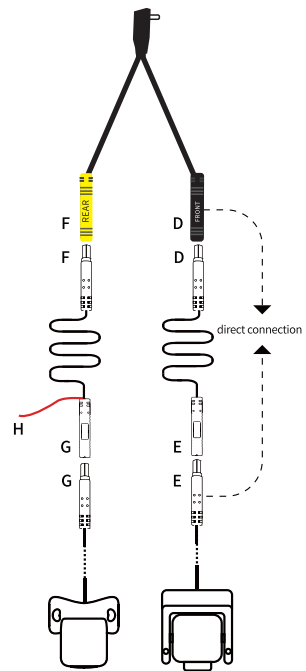

AC-RCR01W Rear Camera AC-FCR01W Front Camera

Pic.12

D	Front Camera Jack
D	Front Camera Extension Cable Plug
E	Front Camera Extension Cable Jack
E	Front Camera Plug
F	Rear Camera Jack
F	Rear Camera Extension Cable Plug
G	Rear Camera Extension Cable Jack
G	Rear Camera Plug
H	Backup Light Wire (+)

03 Packing List

3. Packing List

(optional accessories are marked with *)

1	1×P8 On-Dash Navigator
2	1×Power Cable
3	1×Sticking Holder
4	1×Holder Adapter
5	1×ATOTO AC-FCR01W Front View Camera* (see below)
6	1×Extension Cable for AC-FCR01W*(see below)
7	1×ATOTO AC-RCR01W Rear View Camera* (see below)
8	1×Extension Cable for AC-RCR01W*(see below)
9	1×ATOTO AC-44F6 Wireless Remote* (see below)
10	1×ATOTO AC-P8AC12 Power Connector (to be released)

IMPORTANT: P8 series are ONLY compatible with ATOTO AC-FCR01W and AC-RCR01W cameras. NOT COMPATIBLE with cameras of other brands or original vehicles.

03 Packing List

ATOTO AC-FCR01W Front View Camera

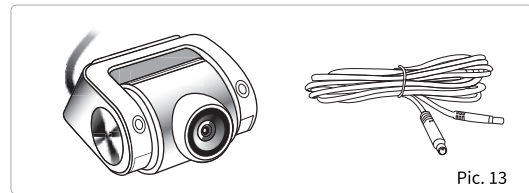

Pic. 13

ATOTO AC-RCR01W Rear View Camera

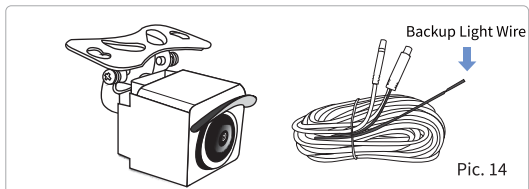

Pic. 14

ATOTO AC-44F6 Wireless Remote

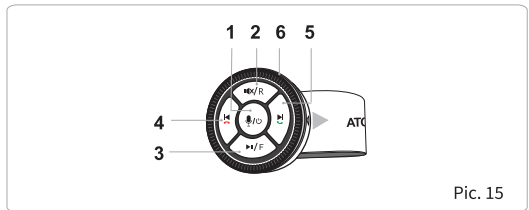

Pic. 15

1. Press to wake up phone voice assistant/press and hold for 5s to turn P8 off (This button cannot be used to turn on P8. Use the button on the back on P8 to turn it on.)
2. Press to mute/press and hold to access rear view (if P8 is already in rear view, press and hold to exit camera view)
3. Press to pause track/press and hold to access front view (if P8 is already in front view, press and hold to exit camera view)
4. Press to skip track backwards/hang up
5. Press to skip track forward/answer the phone
6. Turn clockwise/counterclockwise to increase/decrease volume

ATOTO AC-P817KIT

This kit includes AC-FCR01W, AC-RCR01W, AC-44F6

04 Home Page

4. Home Page



Pic.16

- 1 **CarPlay or Android Auto**
- 2 **DVR Cameras**
- 3 **Bluetooth Handsfree**
- 4 **Bluetooth Music**
- 5 **Home Page/Menu**
- 6 **Time and Date**
- 7 **Brightness Bar**
Drag up and down to manually adjust the screen brightness.
- 8 **Automatic Brightness Adjustment**
Tap the icon to switch on and off Automatic Brightness Adjustment. When switched on (orange), the built-in brightness sensor automatically adjusts the brightness of the screen according to surrounding lighting.
- 9 **Volume Bar**
Drag left and right to manually adjust the volume.
- 10 **Audio Output Options**
Tap the switch next to "Audio Output" to toggle between audio output from the internal speaker or into another device (the head unit). See 6.6 Audio Output for details.
- 11 **Status Bar**
 - 1 Bluetooth connection status
 - 2 Phone battery
 - 3 Bluetooth signal strength
 - 4 USB device status
 - 5 SD card slot status
 - 6 Volume
- 12 **Currently Playing**
- 13 **Bluetooth or USB Music**
- 14 **Bluetooth Settings**



Pic. 17

05 Menu

5. Menu

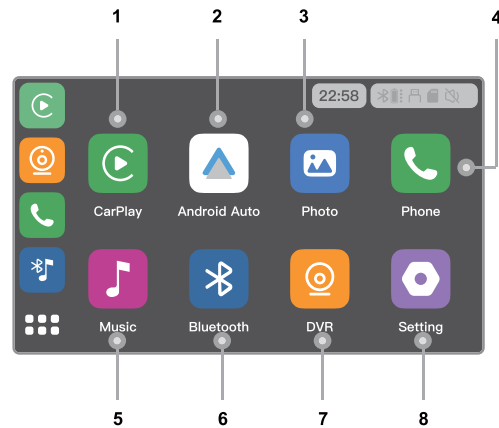

Pic. 18

- 1 **CarPlay**
- 2 **Android Auto**
- 3 **Gallery (USB pictures)**
- 4 **Bluetooth Handsfree**
- 5 **Bluetooth or USB Music**
- 6 **Bluetooth Connection**
- 7 **DVR Cameras**
- 8 **Settings**

6. Operation

6.1 Bluetooth

6.1.1 Bluetooth Connection

Step 1: Tap 3, 4, 13 or 14 in Pic.16 or 4, 5 or 6 in Pic.18 to enter Bluetooth Settings. See Pic. 19 and 20.

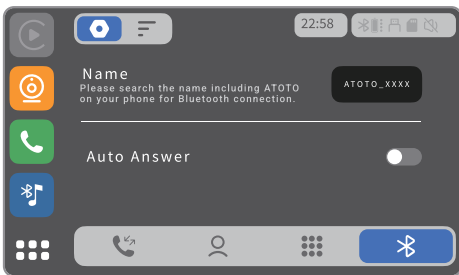

Pic. 19

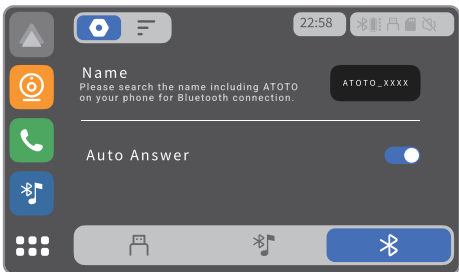

Pic. 20

Step 2: On either page, P8’s Bluetooth name is displayed as ATOTO-XXXX. If “Auto Answer” is switched on, incoming calls will be automatically answered if no operation is performed within 5 seconds. However, if CarPlay or Android Auto is being used, this feature is not available.

Step 3: Turn on Bluetooth on your phone, and look for P8’s name in the Available Bluetooth Devices list.



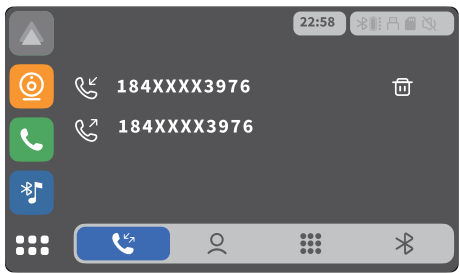

Step 4: Tap P8’s name to pair. After pairing for the first time, your phone and P8 will automatically pair afterwards.

6.1.2 Bluetooth Handsfree

6.1.2.1 Call History



Pic. 21

Tap  to view your call history made on P8. Incoming calls are marked with , and outgoing calls are marked with . Tap  in each entry to delete it. (Note: this operation will not be copied to your phone.)

06 Operation

6.1.2.2 Contacts



Pic. 22

In the Contacts list, all the contacts in your phone are listed.

Tap in each entry to mark it as favorite. View the Favorites list by tapping on the top.

Tap in each entry to delete it. (Note: these two operations will not be copied to your phone.)

Tap to refresh the list.

6.1.2.3 Dialing Pad

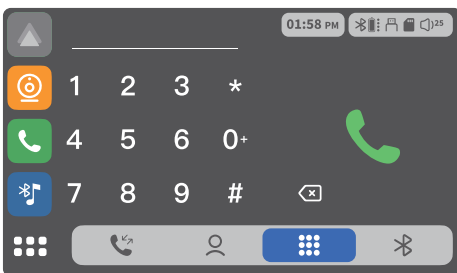

Pic. 23

Tap to enter the Dialing Pad.

Note: tap to enter "0". Tap and hold it to enter "+".

06 Operation

6.1.2.4 Three Ways to Output Audio for Bluetooth Handsfree

(1). Output Audio from the phone.

Tap the icon to use the phone's speaker during Bluetooth Handsfree. (see Pic.24)

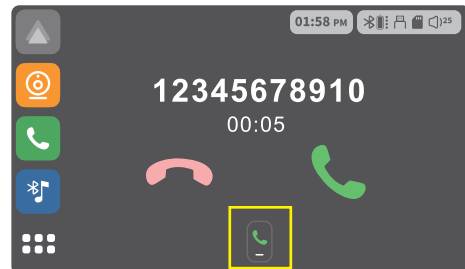

Pic. 24

(2). Output Audio from P8.

Turn off Audio Output (See Pic.25) >Settings (See Pic.26) >Audio>Handsfree Output (See Pic.27)>Tap icon Then you will hear sounds coming out of P8 during Bluetooth Handsfree.

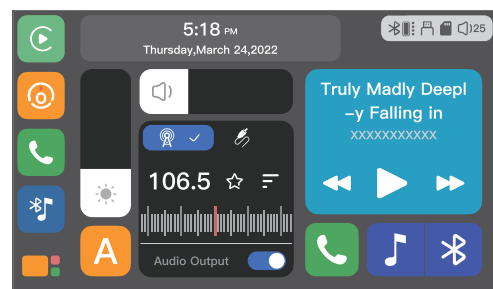

Pic. 25

06 Operation

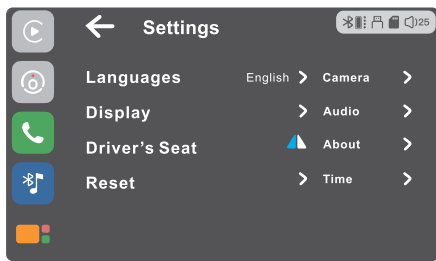

Pic.26

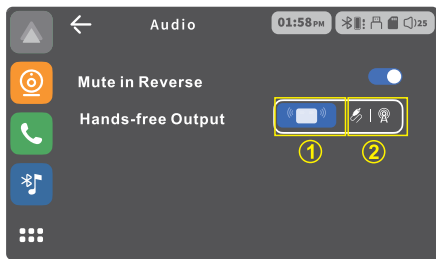

Pic.27

(3). Output Audio from another device (the head unit)
 Turn on Audio Output> Select P8's FM out /AUX out mode
 (See Pic.28)> Connect to your head unit through FM/AUX.
 (Note: Your head unit should also be in the AUX/FM mode.)
 See 6.7 Audio Output for details.
 Then you will hear sounds coming out of the head unit
 during Bluetooth Handsfree.

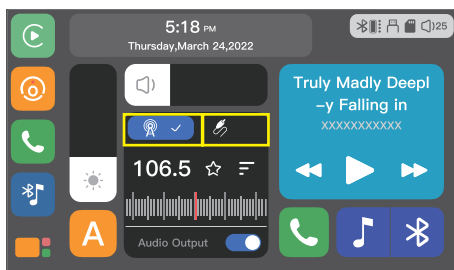

Pic.28

06 Operation

6.1.3 Bluetooth Music

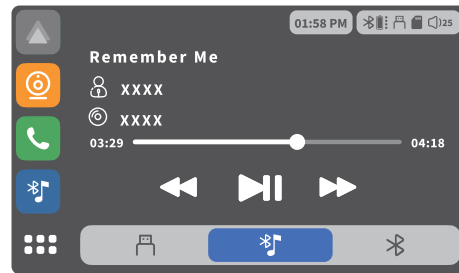

Pic.29

Tap 4 or 13 in Pic.16 or 5 in Pic.18 to enter Bluetooth Music.

On the Bluetooth Music page, the currently playing music is displayed. The singer's name and the album title are displayed below the title of the song.

6.2 USB Music

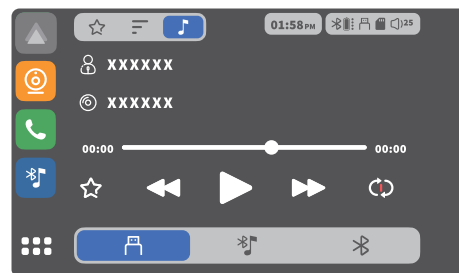





Pic.30

06 Operation

Once a USB storage device containing audio files (check Specifications for supported formats) is plugged into the USB storage device port, P8 automatically starts playing the audio files. (Note: Only the USB-A port for external storage devices on the power plug can be used for media playback.)

Tap  above the USB symbol to mark a song as favorite and it turns red.

Tap it again to unmark the song. View all favorites by tapping  on the top.

Tap  to toggle between different playing modes. There are 3 modes available: "playing in order" (default) , "repeat"  and "shuffle" .

Tap  above the singer's name to view the list of all available audio files on the USB storage device.

6.3 CarPlay Connection

6.3.1 Wireless

Step 1: Turn on Wi-Fi and Bluetooth on iPhone.

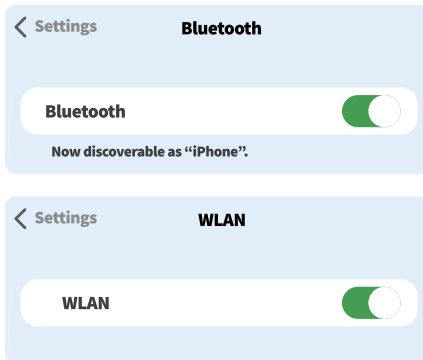

Pic.31

06 Operation

Step 2: Tap P8 ("ATOTO-xxxx") in the Bluetooth list and tap "Pair", "Allow" and "Use CarPlay" on respective pop-ups.

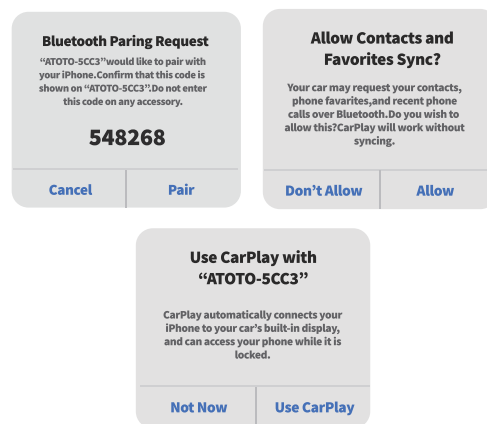

Pic.32

Step 3: Wireless CarPlay is launched. Automatic connection and launch after the first time.

Note: Wired CarPlay is not supported on P8.

6.4 Android Auto Connection

6.4.1 Wired

Once you connect your Android phone and P8 with the factory USB cable (plug the cable into the USB port dedicated to wired Android Auto connection. See Pic. 33), Android Auto is automatically launched.

6.4.2 Wireless

Step 1: Turn on Wi-Fi and Bluetooth on Android phone.

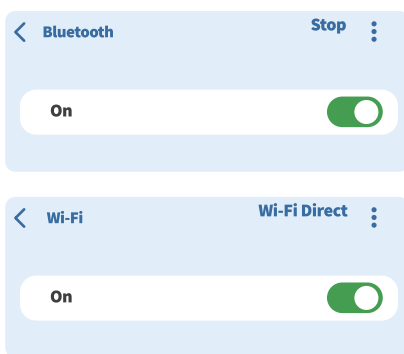

Pic.33

Step 2: Tap P8 ("ATOTO-xxxx") in the Bluetooth list. The pop-up windows vary by phone models. Tap the affirmative option on each window.

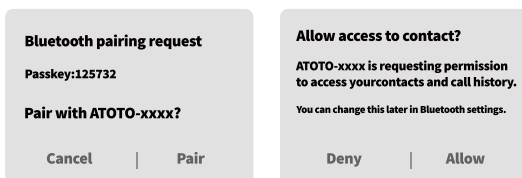

Pic.34

Step 3: Wireless Android Auto is launched. Automatic connection and launch after the first time.

6.5 Subscribe to Phone Mirroring Function

ATOTO has been continuously developing new features on P8, one of which is the Phone Mirroring function. With this function on P8, you can cast what's displayed on your phone to P8's bigger screen simultaneously. The Phone Mirroring function is currently under development. Therefore if you want to use this function as soon as possible, **please scan the QR code below to subscribe in advance.** We will notify you by email as soon as the function is developed.



6.6 Camera Input and Recording

Note: Please connect Front Camera or Rear Camera to P8 when tapping  in Home Page and see picture like this. (See Pic. 35)

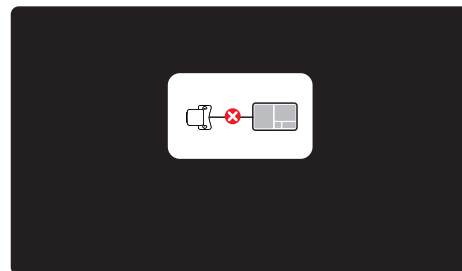

Pic.35

06 Operation

Tap  in Home Page or Menu to enter the Camera Input and Recording page.

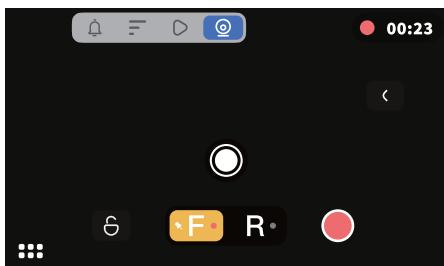

Pic.36

Tap “F” and “R” to toggle between the front camera view and the rear camera view. If there is an SD card (max. size 128G) in the SD card slot, the cameras automatically start recording. The time mark on the upper right corner of the screen indicates the length of the recording. It automatically restarts from 00:00 once the loop time has been reached. See Settings->Camera->DVR Adjust for loop time setting.

Tap  to take a picture with both the front and the rear camera.

Tap  to stop recording. Tap it again to resume recording.

Tap  to lock the current videos (front and rear).

Tap  on the top of the screen to enter the list of recorded videos and the list of pictures taken.

Tap  to unfold additional options. See Pic. 36.

06 Operation

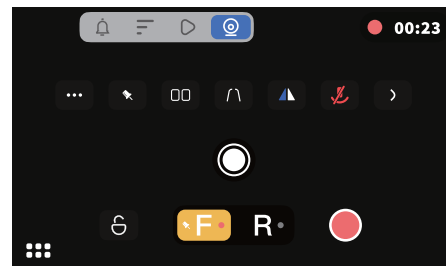

Pic.37

Tap  to enter DVR Adjust. See Settings->Camera->DVR Adjust for details.

Tap  to set the current camera view as default. (The default setting is the front camera view.)

Tap  to enter split screen view.(Pic. 37)





Pic.38

Tap  to exit split screen view.

Tap  to enter Guidelines Adjustment.

See Settings->Camera->Guidelines Adjustment for details.

Tap  to toggle between the original image and the horizontal mirror image.

Tap  to mute audio in recordings.

06 Operation

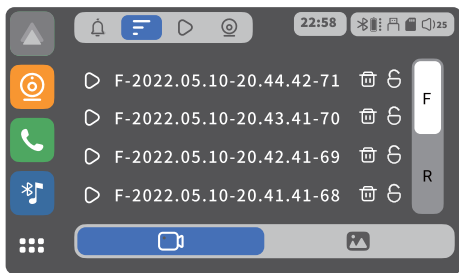

Pic.39

Tap or to toggle between the two lists. Note that you can tap “F” and “R” to toggle between the list of front camera recordings/pictures and the list of rear camera recordings/pictures.

Tap to the right of each video or picture to delete it.

Tap to the right of the trash bin symbol to lock it. Emergency videos and pictures that are triggered by the gravity sensor can be viewed by tapping on the top of the screen. (See 6.9.2 Camera for details.)

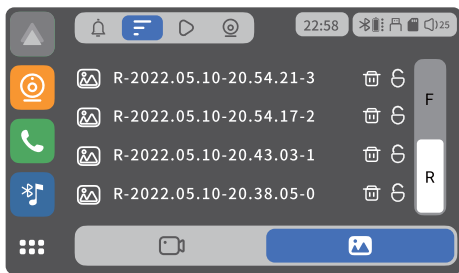

Pic.40

Tap on the top of the screen, and the latest front/rear camera recording (depending on which view or list you were in) or picture will start playing.

06 Operation

6.7 Audio Output

6.7.1 Auxiliary Output



Pic.41

For this function to work,

- the Audio Output option in Home Page (Pic.16) must be switched on;
- the Aux Output mode must be selected (Pic. 42);
- the head unit is set to aux mode.

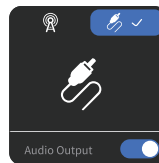

Pic.42

With a 3.5mm jack cable, you can connect the auxiliary audio output port on P8 to the auxiliary audio input on the head unit.

6.7.2 FM Transmission Output



Pic.43



Pic.44

For this function to work,

- the Audio Output option in Home Page (Pic.16) must be switched on;
- the FM Output mode must be selected;
- the FM radio on the head unit must be turned on.

Step 1: Set the FM frequency to a specific point, e.g., 88.8 Hz on P8. You can drag the frequency bar to do so, or tap the bar and make fine adjustments.

Step 2: Set the FM radio on your head unit to the same frequency. The audio output automatically starts.

Tap  next to the frequency number to mark it as a favorite.

Tap  to view all favorite frequencies.

6.7.3 Dual Bluetooth Connection

Certain phone models support dual Bluetooth connection, which means that the phone's Bluetooth can be connected with P8 and the head unit at the same time. This allows for the scenario where CarPlay/Android Auto is being used on P8 (for navigation, etc.), while Bluetooth audio streaming simultaneously happens between the phone and the head unit.

However, we recommend Android phone users to avoid dual Bluetooth connection when using P8 by unpairing the phone and the head unit for optimal audio experience.

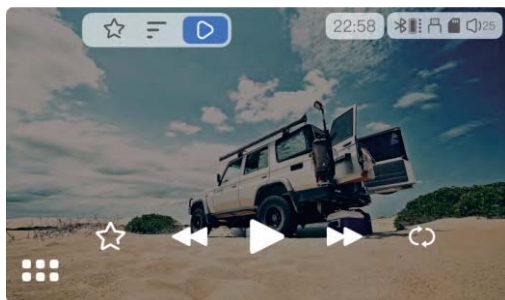

6.8 Gallery



Pic.45

If a USB storage device containing pictures (supported format: PNG and JPEG) is plugged in, then tap the Gallery icon, and P8 will automatically start playing the pictures back in order (Pic. 45).

Tap  (play in order) or  (shuffle) to switch playback modes.

Tap  on the lower left to mark and unmark the current picture as a favorite, and tap  in the top to view all favorite pictures.

Tap  in the top to view all pictures.

6.9 Settings

6.9.1 Languages

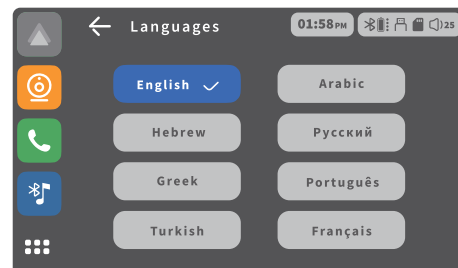

Pic.46

Tap a specific language to set it as the system language.

6.9.2 Camera



Pic.47

06 Operation

6.9.2.1 Rear-View Guidelines

You can turn Rear-View Guidelines on and off.

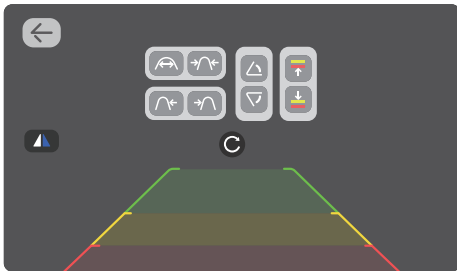

Pic.48

6.9.2.2 Guidelines Adjustment

If Rear-View Guidelines are on, you can also adjust the position and angle of the guidelines (Pic.48).

Tap  to toggle between the original image and the horizontal mirror image.

6.9.2.3 DVR Settings

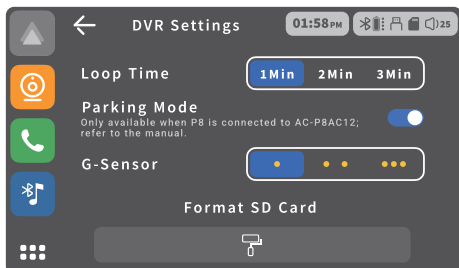

Pic.49

You can set the loop time for DVR as 1 minute, 2 minutes or 3 minutes. Parking Mode is a safety function under development. Once it is completed, you will be able to obtain it by upgrading the system software. There is a built-in gravity sensor that automatically locks videos once it senses that there has been an unusual change of gravity.

06 Operation

The sensitivity of the gravity sensor can be set on this page. Choose from the 3 levels according to the condition of the road that you are driving on. For example, if the road is rocky and bumpy, choose a lower level of sensitivity, and vice versa.

Tap the button under “Format SD Card” to format the SD card inserted into the slot.

(WARNING: Once the SD card is formatted, all the files previously stored in it will be wiped out.)

6.9.3 Display



Pic.50

Tap “Wallpaper” to view the available wallpapers. Tap any one of them to set it as the new wallpaper.

6.9.4 Audio



Pic.51-1

06 Operation

- (1). If "Mute in Reverse" is switched on, audio will be muted when the vehicle is in reverse, and vice versa.
- (2). With "Hands-free Output", the "Audio Output" mode in a hands-free call can be switched between through the internal speaker (default) or through FM out/AUX out. (see Pic. 51-1)

Note: If FM out/AUX out is selected (see Pic. 51-1), make sure that the "Audio Output" switch (see Pic. 51-2) on Home Page is turned on. Otherwise, the handsfree output still goes to P8's speaker.

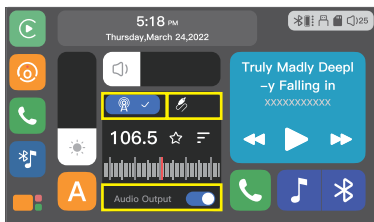

Pic.51-2

6.9.5 Driver's Seat

Tap the "Driver's Seat" tab to switch between driver's seat on the left (USA, Canada, Italy, etc.) and on the right (UK, Japan, Australia, etc.).

6.9.6 About

Tap the "About" tab to view the operating system version number and the Bluetooth version number. Tap "Updates and Help" to update your P8. (Pic. 52)

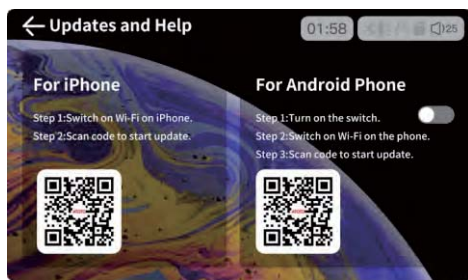

Pic.52

06 Operation

6.9.7 Reset

Tap the "Reset" tab to reset the system.

6.9.8 Time

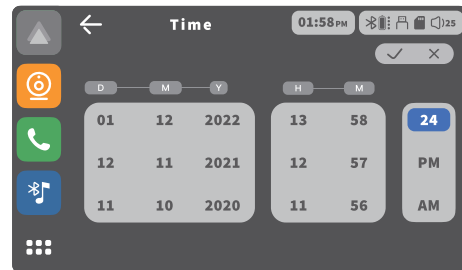

Pic.53

Tap the "Time" tab to switch between the 24-hour clock and the 12-hour clock and set the time for P8.

7.OTA Update

See 6.9.6 About.

8.Ways to Obtain Help

If you have any questions in the installation and use of P8, or need help when encountering difficulties, you can get help in the following ways:

- (1). Visit ATOTO's official website www.myatoto.com for more information, customer support, Q & A, a large community of other ATOTO customers, and much more.
- (2). Contact the ATOTO dealers or ATOTO online sellers from whom you purchased your P8.
- (3). Send an Email to support@myatoto.com. The ATOTO customer support team will reply within 48 business hours, and most Emails will be replied within 24 business hours.

9.Specifications

Part	Specifications	
OS & SOC Chipset	Linux 4.9; Model: SGS8826; ARM Cortex-A53 Dual Core with Max 1.2Ghz	
System Language	Arabic, Dutch, English, French, German, Greek, Hebrew, Hungarian, Indonesian, Italian, Japanese, Korean, Polish, Portuguese, Russian, Spanish, Thai, Turkish, Ukrainian, Vietnamese	
Internal Memory /Storage	2GB Memory + 2GB Storage	
Display & Touchscreen	Screen Size (inch): 7 inch (diagonal); Display Resolution: HD 1024*600	
	Display System: QLED (quantum film LED-backlit LCD) with DBF & AG (anti -glare) technology; Lighting Brightness:600 cd/m2	
	Touch Panel: Multi-touch Capacitive Touch-screen	
Wireless Technology	FM Transmitter	76-108Mhz Adjustable; Step Frequency: 0.1Mhz Channel output: Stereo
	Bluetooth	Bluetooth 5.0 with HFP (1.6), HSP, A2DP (1.2), AVRCP (1.4), PBAP; A2DP Codec:SBC

Part	Specifications	
Wireless Technology	Wi-Fi	IEEE 802.11a/n/ac; Support 5Ghz Band
	Wireless Remote Control	Built-in 433MHZ AC-44F6 Remote receiver; AC-44F6 Wireless Remote is not included on selected models
Media Playback	Audio: MP3, WMA, AAC, FLAC, WAV, M4A; Image: JPEG;PNG; Videos are not supported;	
System Power Supply	Cigarette Lighter Socket Adapter Input Voltage: 12v - 24v; Input Current: ≥5A USB1 supports Quick Charge (DCP, QC2.0, QC3.0, MTK, PE1.1, PE2.0, FCP, SCP, AFC, SFCP); Output Voltage: 3V to 12V (adaptive); Power Output: Max 24W (4V@3.6A, 5V @3.4A, 9V@2.5A, 12V@2A); Intelligent over-current, over-voltage, under-voltage, short-circuit protection. USB2 supports wired Android Auto connection	

09 Specifications

Part	Specifications	
System Power Supply	AC-P8AC12 Hard Wire Kit (to be released)	Get power support from the Vehicle Fuse Box. Input Voltage: 12v - 24v; Current: ≥5A; Memory Current: 5mA; The AC-P8AC12 is not included, sold separately
Camera & Image Sensor (Optional)	Front DVR Camera (AC-FCR01W)	Angle of view: 150-degree. Image Sensor: 1920x1080 1/2.7" CMOS, f=1.8mm, F/NO 2.0. With Anti-Glare, Night-vision and WDR (Wide Dynamic Range) features. AC-RCR01W Camera is only available on selected models, and sold separately
	Rear DVR Camera (AC-RCR01W)	Angle of view: 150-degree. Image Sensor: 1920x1080 1/2.7" CMOS, f=2.0mm, F/NO 3.2. With Anti-Glare, Night-vision, WDR (Wide Dynamic Range) and IP67 Waterproof features. AC-RCR01W Camera is only available on selected models, and sold separately

09 Specifications

Part	Specifications
Audio Output	1. Built-in Speaker 2.5w; 2. FM Transmitter to car stereo; 3. Aux Jack to car stereo's AUX source
SD Slot	Supports up to 128GB C10 MicroSD card. File System: NTFS, FAT32. Note: Only for storing recorded videos and pictures, not for multimedia playback
General	Rated Current Consumption: 2.5A; Rated Power Consumption: 12.5 Watts Operation Temperature Range: -20°C - +60°C

Problem	Possible Cause	Solution
Vehicle battery drained	The cigarette lighter still provides power supply even after the engine is turned off.	Turn off P8 after using it by pressing and holding the switch on the back for 8 seconds or by pressing and holding the power button on AC-44F6 wireless remote for 5 seconds.
Automatic brightness not working	The light sensor in the back is blocked.	Remove the blockage or change the mounting location.
No audio output	The audio output route is set to be FM out or aux out, but the radio or aux mode on the head unit is not turned on.	Turn on the radio or aux mode on the head unit.

10 Troubleshooting

Problem	Possible Cause	Solution
Unstable FM output	The FM frequency chosen is occupied by a local radio station.	Switch to another FM frequency.
Ground noise too loud when using FM output	Ground noise is innate to FM transmission.	Turn the volume down on P8 and turn up the volume on the phone and on the head unit.
The other person's voice coming out of P8's speaker instead of the car speakers during a call even Hands-free Output is set to be FM out/aux out	The Audio Output switch is off on Home Page.	Turn on the Audio Output switch on Home Page.
Want to use P8 to get handsfree calls but there's no sound from P8.	The phone's Bluetooth is connected to the head unit instead of P8, and the Audio Output on Home Page is on but the head unit is not at the AUX/ FM mode.	<ol style="list-style-type: none"> 1. Turn off the Audio Output switch on Home Page. 2. Go to Settings>Audio> Choose P8 as Handsfree Output. 3. Unpair Bluetooth between the phone and the head unit, then clear the pairing record to prevent the phone's Bluetooth from reconnecting to the head unit automatically.

10 Troubleshooting

Problem	Possible Cause	Solution
Wireless CarPlay Connection Issue (Note: wired CarPlay is not supported on P8.)	Bluetooth and Wi-Fi on the iPhone are not both connected to P8.	Connect both Bluetooth and Wi-Fi on the iPhone to P8.
	CarPlay is restricted on the iPhone.	Go to Settings> Screen Time> Content & Privacy Restrictions. Tap "Allows Apps" and enable CarPlay. Or go to Settings> General> Restrictions. Enter the passcode and enable CarPlay. Use either method depending on your iPhone model.
	Siri is not enabled on your iPhone.	Go to Settings> Siri & Search and turn on the switches.
Wireless Android Auto Connection Issue	Bluetooth and Wi-Fi on the phone are not both connected to P8.	Connect both Bluetooth and Wi-Fi on the phone to P8.
	The "Wireless projection" option is not turned on.	Go to Developer Settings to make the option visible (refer to Google's official website for details) and turn it on.

10 Troubleshooting

Problem	Possible Cause	Solution
Wired Android Auto Connection Issue	The USB cable is not plugged into the port for Android Auto.	Plug the USB cable into the port for Android Auto.
	The USB cable is not the original cable that came with the phone.	Use the original USB cable that came with the phone.
Cameras not recording	No SD card is in the slot.	Insert an SD card with maximum capacity under 128 GB.
USB storage device not recognized	Two USB storage devices are plugged in (one into the USB -C port and the other into the USB-A port). Only the one that was plugged in first is recognized.	Unplug the USB device that is not in use.
	The USB storage device has a maximum capacity over 512 GB.	Use a USB storage device with a maximum capacity under 512 GB.
SD card not working	The SD card is not correctly formatted or the SD card has a maximum capacity over 128 GB.	Use an SD card with a maximum capacity under 128 GB and format it in P8.
Prompts pop-up saying SD card is full	The SD card is full of event videos or the G-sensor sensitivity is set too high.	Export the event videos to an external storage device and clear the SD card's storage or adjust the G-sensor sensitivity to a proper level.

IC Caution:

RSS-Gen Issue 5 "&" RSS-Gen numéro 5

- English:

This device contains licence-exempt transmitter(s)/receiver(s) that comply with Innovation, Science and Economic Development Canada's licence-exempt RSS(s). Operation is subject to the following two conditions:

(1) This device may not cause interference.

(2) This device must accept any interference, including interference that may cause undesired operation of the device. Any changes or modifications not expressly approved by the party responsible for compliance

could void the user's authority to operate the equipment. RF exposure statement:

The equipment complies with IC Radiation exposure limit set forth for uncontrolled

environment. This equipment should be installed and operated with minimum distance 20cm between the radiator and your body.

- French:

Cet appareil contient des émetteurs / récepteurs

exemptés de licence conformes aux RSS

(RSS) d'Innovation, Sciences et Développement

économique Canada. Le fonctionnement est

soumis aux deux conditions suivantes:

(1) Cet appareil ne doit pas causer d'interférences.

(2) Cet appareil doit accepter toutes les interférences, y compris celles susceptibles de

provoquer un fonctionnement indésirable de l'appareil.

Tout changement ou modification non expressément

approuvé par la partie responsable de la

conformité pourrait annuler l'autorité de l'utilisateur à

utiliser l'équipement. Déclaration d'exposition RF:

L'équipement est conforme à la limite d'exposition aux

radiations de la IC établie pour un

environnement non contrôlé. Cet équipement doit être

installé et utilisé avec une distance

minimale de 20 cm entre le radiateur et votre corps.

5.2G:For indoor use only

***FCC Statement**

This equipment has been tested and found to comply with the limits for a Class B digital device, pursuant to part 15 of the FCC rules. These limits are designed to provide reasonable protection against harmful interference in a residential installation. This equipment generates, uses and can radiate radio frequency energy and, if not installed and used in accordance with the instructions, may cause harmful interference to radio communications.

However, there is no guarantee that interference will not occur in a particular installation. If this equipment does cause harmful interference to radio or television reception, which can be determined by turning the equipment off and on, the user is encouraged to try to correct the interference by one or more of the following measures: -Reorient or relocate the receiving antenna. -Increase the separation between the equipment and receiver. -Connect the equipment into an outlet on a circuit different from that to which the receiver is connected. -Consult the dealer or an experienced radio/TV technician for help. To assure continued compliance, any changes or modifications not expressly approved by the party. Responsible for compliance could void the user's authority to operate this equipment. (Example- use only shielded interface cables when connecting to computer or peripheral devices).

This equipment complies with Part 15 of the FCC Rules. Operation is subject to the following two conditions:

(1) This device may not cause harmful interference, and

(2) This device must accept any interference received, including interference that may cause undesired operation.

FCC Radiation Exposure Statement:

The equipment complies with FCC Radiation exposure limits set forth for uncontrolled environment. This equipment should be installed and operated with minimum distance 20cm between the radiator and your body