

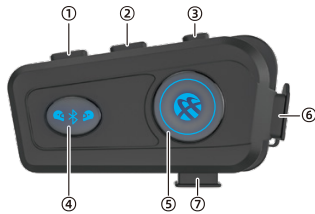

## Manual Instruction For Helmet Bluetooth Headset

Model A128

### KEY INTRODUCTION



- Volume up
- Volume down
- Switch
- Last number redial
- Multi-function key
- Charging interface
- Headphone connector

### OPERATING INSTRUCTIONS

**Power on:** In the power-off state, press and hold the ③ button for 3 seconds to power on, and the prompt will sounds "power on".

**Power off:** In the power-on state, press and hold the ③ button for 5 seconds to shut down, and the prompt will sounds "power off".

**Clear pairing information:** In the power-on state, press and hold the ⑤ key for 8 seconds to clear the pairing information and enter the pairing mode, and the red and blue lights flash alternately.

**Pairing:** After the headset is turned on, please turn on the Bluetooth of the mobile phone and search for "A128" to pair. If the phone has been connected to this headset before, when the headset is turned on and enters the pairing mode, it will automatically connect back to the phone. After the connection is successful, the blue light will flash once every 5 seconds.

**Manually enter the pairing mode:** In the connected state, press and hold the ⑤ key for 3 seconds to enter the pairing mode, and the red and blue lights flash alternately.

**Switch between Chinese and English modes:** Press and hold the ① and ② buttons at the same time for 2 seconds until you hear the prompt sound.

**Volume up / down:** Click the ① button to volume up, click the ② button to volume down.

**Play / Pause:** Click ⑤ button to play, click ⑤ button again to pause.

**Previous song:** When playing music, press and hold the ① button for 1 second to switch to the previous song.

**Next song:** When playing music, press and hold the ② button for 1 second to switch to the next song.

**Voice Assistant:** Click the ③ button to wake up the mobile phone voice assistant.

**Answer the call:** In the incoming call state, click the ⑤ button to answer the call.

**Hang up the call:** In the call state, click the ⑤ button to hang up the call.

**Rejecting call:** In the incoming call state, press and hold the ⑤ button for 3 seconds to reject the incoming call.

**Switching to answer during a call:** When a third party calls during a call, click the ④ button to switch to answer.

**Switching to reject during a call:** In the call state, when a third party calls, press and hold the ④ button for 1.5 seconds to reject the call.

**Last number redial:** When there is no call status, click the ④ button to redial the last number.

**Cancel the outgoing call:** After the outgoing call, click ⑤ button to cancel the outgoing call.

**Automatically answer incoming call:** press the ① and ② buttons at the same time to turn on/off this

function, and automatically answer the incoming calls without any operation for 5 seconds after turning on.













**Battery Volume Indicators:**

- (1) When the battery is fully charged, the blue light will flash once every 5 seconds after connecting to the mobile phone.
- (2) When the battery is low, there will be a "Battery low, please charge" prompt sound every 1 minute.
- (3) When the battery is charging, the red light is always on.
- (4) After the battery is fully charged, the red light goes out.

### SPECIFICATIONS

Model: A128	Bluetooth transmission distance:≤12M
Bluetooth version: V5.3	Voice Assistant: Support
Battery capacity: 1000 mAh	Charging interface: Type-C interface
Call time: 50 Hours (70% volume)	Charging input: DC 5V 1A
Music Time: 70 Hours (70% volume)	Smart microphone: Support
Charging time: 2 Hours	Net weight (main engine): About 44 g

### PARTS LIST

 Main engine	 Headphone cable	 Thin wire hard tube microphone	 Thin wire microphone
 Thin wire microphone	 Clip type buckle	 Host sticker	 USB charging cable
 2 pairs of earphone speaker stickers	 2 microphone sponge covers	 2 square stickers	 User Manual

### EQUIPMENT INSTALLATION

#### 1. Host installation:

1) Clean the area on the left side of the outside of the helmet. Wipe the shell of the helmet with a damp towel over this area. Wait for it to dry completely.

2.1) Stick-on buckle installation, tear off the double-sided adhesive isolation layer of the buckle, and stick the stick-on buckle to the installation position on the left edge of the helmet.

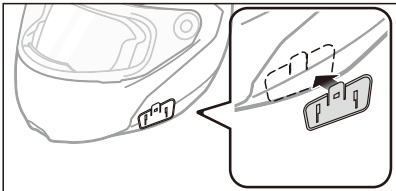

2.2) Clip-type buckle installation, find the installation position on the left edge of the helmet and clamp it, and then push it to a suitable position on the left side of the helmet.

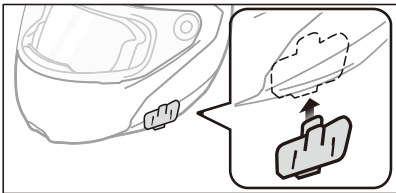

3) Align the main unit with the card slot of the buckle base and push it from top to bottom, and the installation is successful when you hear the sound of the buckle.

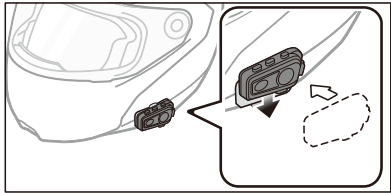

4) Plug the headphone cable into the headphone jack of the host.

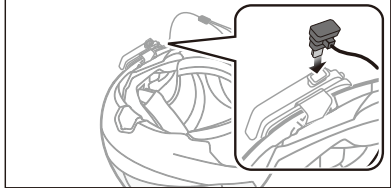

#### 2. Install the headphone speaker:

Note: There are 2 speakers for the headphone cable accessory, the one with the shorter cable is the left speaker, please install it on the left side inside the helmet. The longer wire is the right horn, please install it on the right side inside the helmet.

5) Peel off the isolation layer of the double-sided tape attached to the earphone speaker, and then paste it into the earphone hole reserved on the helmet.

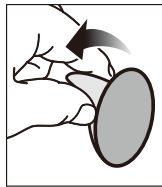

6) Paste the headphone speaker on the headphone speaker sticker.

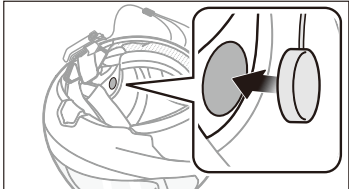

#### 3. Install the microphone:

7) Peel off the isolation layer with double-sided tape on the bottom, and stick it on the inner surface of the helmet.

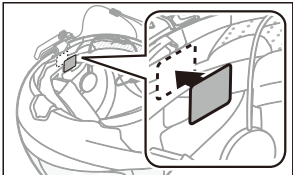

8) Paste the microphone on the square sticker.

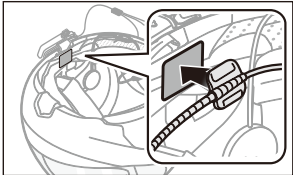

9) Adjust the head of the microphone to ensure that the sound hole of the microphone is near your mouth.

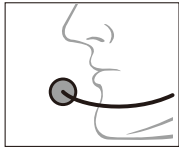

10) Align the interface between the main unit and the microphone cable, and then insert the microphone plug into the socket of the microphone cable.

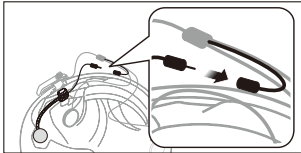

Note: After installing the microphone, make sure to re-align the inner padding of the helmet.

### USE ENVIRONMENT

- (1). The normal ambient temperature of the earphones is -40°C to +60°C, please do not exceed the temperature range;
- (2). Do not expose the earphones to open flames to prevent explosion hazards;
- (3). Do not touch the earphones with sharp objects to prevent damage to the earphones;
- (4). Please do not disassemble the earphone without permission;
- (5). If the headset is not used for a long time, please keep the storage environment of the headset dry, and the device needs to be charged regularly for long-term storage;

### WARRANTY CARD

Please keep your shopping receipt and warranty card, tearing it up is invalid !

Model: \_\_\_\_\_ Phone number: \_\_\_\_\_

Name: \_\_\_\_\_ Address: \_\_\_\_\_

Fault description :

Please paste a copy of the receipt on the back of the warranty card to prove the date of purchase.  
If you find any problems with the product during use, please contact us for after-sales service.  
Please fill in the product problem clearly on the warranty card so that we can handle it for you in time.

### FCC Statement

This device complies with part 15 of the FCC Rules. Operation is subject to the following two conditions: (1) This device may not cause harmful interference, and (2) this device must accept any interference received, including interference that may cause undesired operation.

Any changes or modifications not expressly approved by the party responsible for compliance could void the user's authority to operate the equipment.

NOTE: This equipment has been tested and found to comply with the limits for a Class B digital device, pursuant to Part 15 of the FCC Rules. These limits are designed to provide reasonable protection against harmful interference in a residential installation. This equipment generates, uses and can radiate radio frequency energy and, if not installed and used in accordance with the instructions, may cause harmful interference to radio communications. However, there is no guarantee that interference will not occur in a particular installation.

If this equipment does cause harmful interference to radio or television reception, which can be determined by turning the equipment off and on, the user is encouraged to try to correct the interference by one or more of the following measures:

- Reorient or relocate the receiving antenna.
- Increase the separation between the equipment and receiver.
- Connect the equipment into an outlet on a circuit different from that to which the receiver is connected.
- Consult the dealer or an experienced radio/TV technician for help.

The device has been evaluated to meet general RF exposure requirement. The device can be used in portable exposure condition without restriction.



## 头盔蓝牙耳机 说明书

型号 A128

### 按键介绍

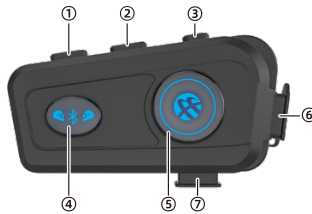

- ① 音量加键  
② 音量减键  
③ 开关机键  
④ 重拨键  
⑤ 多功能键  
⑥ 充电接口  
⑦ 耳机接口

### 操作说明

**开机：**关机状态下，长按③键3秒开机，提示音“开机”。  
**关机：**开机状态下，长按③键5秒关机，提示音“关机”。  
**清除配对信息：**开机状态下，长按③键8秒清除配对信息，然后进入配对模式。红蓝灯交替闪烁。  
**配对：**开机后，打开手机蓝牙并搜索“A128”进行配对即可。如果是已连接过的手机，开机进入配对模式后会自动回连已连接过的手机。连接成功后，蓝灯每5秒闪烁1次。  
**手动进入配对模式：**已连接状态下，长按③键3秒进入配对模式，红蓝交替闪烁。  
**中英文切换：**同时长按①键和②键2秒，听到提示音松手即可。  
**音量加/减：**单击①键增加音量，单击②键减小音量。  
**播放/暂停：**单击⑤键播放，再次单击⑤键暂停。  
**上一曲：**播放时，长按①键1秒左右切换上一曲。  
**下一曲：**播放时，长按②键1秒左右切换下一曲。  
**语音助手：**单击③键唤醒手机语音助手。  
**接听电话：**来电状态下，单击⑤键接听来电。  
**挂断通话：**通话状态下，单击⑤键挂断通话。  
**拒接来电：**来电状态下，长按⑤键3秒拒绝来电。  
**通话中切换接听：**通话状态下，第三方来电时，单击④键切换接听。  
**通话中切换拒接：**通话状态下，第三方来电时，长按④键1.5秒拒接来电。  
**末码重拨：**没有通话状态下，单击④键末号重拨。  
**取消去电：**去电后，单击⑤键取消去电。  
**自动接听来电：**同时按一下①键和②键开启/关闭此功能，开启后无操作5秒自动接听来电。

#### 电池电量指示功能

- 1) 电池电量充足时，连接手机后，蓝灯每5秒闪1次。
- 2) 电池电量不足时，每1分钟有“电量低”提示音。
- 3) 电池正在充电时，红灯常亮。
- 4) 电池充电完成后，红灯灭。

### 产品参数

型号: A128	蓝牙传输距离: ≤12米
蓝牙版本: V5.3	语音助手: 支持
电池容量: 1000 mAh	充电接口: Type-C接口
播放时长: 50小时 (70%音量)	充电输入: DC 5V 1A
通话时长: 70小时 (70%音量)	智能麦克风: 支持
充电时长: 约2小时	主机净重: 约44克

### 配件清单

主机	耳机线	硬麦	软麦
贴式卡扣	夹式卡扣	主机贴纸	USB充电线
耳机喇叭贴2副	咪棉2个	方贴2个	说明书

注意：要根据您的头盔形状去选择“贴式卡扣”或“夹式卡扣”进行安装！

### 设备安装

#### 一、主机安装：

- 1) 清洁头盔外部左侧的区域，在该区域上用湿毛巾擦拭头盔外壳，等待彻底干燥。

2.1) 贴式卡扣安装，撕下卡扣双面胶隔离层纸，把贴式卡扣贴在头盔左侧边缘安装位置

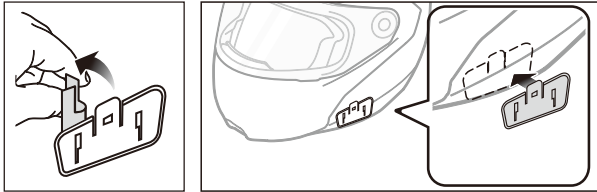

2.2) 夹式卡扣安装，找准头盔左侧边缘安装位置夹住，然后用力推到头盔左侧合适的位置。

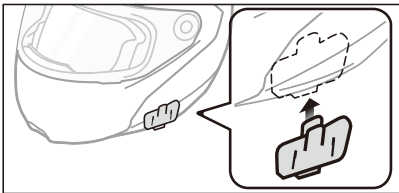

- 3) 把主机对准底座卡槽从上往下推，听到卡扣响声即安装成功。

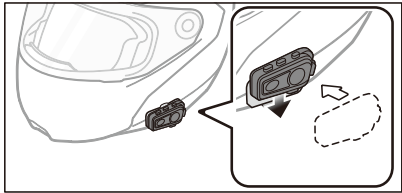

- 4) 耳机线插入主机的耳机接口。

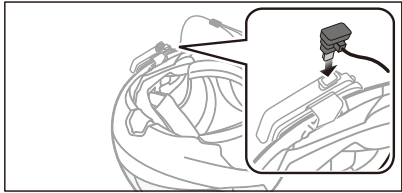

#### 二、安装耳机喇叭：

- 注意：耳机线配件有2个喇叭，线较短的是左喇叭，请装在头盔内部左侧。线较长的是右喇叭，请安装在头盔内部右侧。

- 5) 剥下耳机喇叭贴双面胶的隔离层，然后粘贴到头盔预留的耳机孔内。

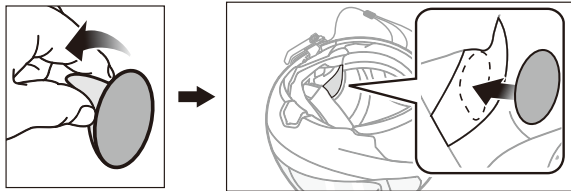

- 6) 将耳机喇叭粘贴到耳机喇叭贴上即可。

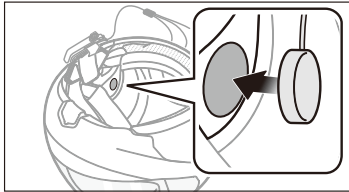

#### 三、安装麦克风：

- 7) 剥下方贴双面胶的隔离层，然后将其粘贴在头盔的内表面上。

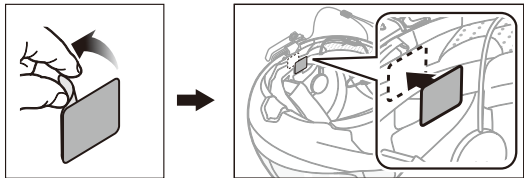

- 8) 将麦克风粘贴在方贴上即可。

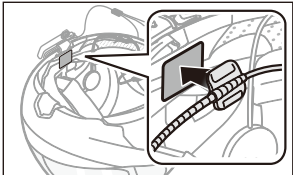

- 9) 调整麦克风的头部，确保麦克风

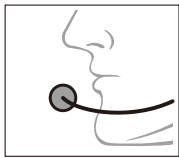

- 10) 对准主机和麦克风连接线上的接口，然后将麦克风插头插入麦克风连接线的插口里。

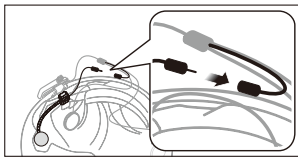

注意：安装完麦克风后，请确保重新规整头盔内部填充物。

### 使用环境

- 1) 耳机正常使用环境温度在-40℃到+60℃，请勿超过温度使用范围；
- 2) 请勿将耳机暴露在明火中，以防爆炸危险；
- 3) 请勿将耳机接触尖锐物品，以防损坏耳机；
- 4) 请勿私自拆卸耳机；
- 5) 如长时间不使用耳机，请保持耳机存放环境的干燥，长时间存放需要定时给设备充电；

### 保修卡

请保存好您的购物收据、保修卡，撕毁无效！

型号: \_\_\_\_\_ 手机号码: \_\_\_\_\_

姓名: \_\_\_\_\_ 地址: \_\_\_\_\_

故障描述: \_\_\_\_\_

请在保修卡后面贴上收据的复印件，以证明购买日期。  
您在使用过程中，如发现产品有故障，请联系我们的售后服务。  
请在保修卡填写清楚产品的故障、问题等等，以便我们及时为您处理。

