



**CAPTURE YOUR IMAGINATION**

# **INSTRUCTION**

# **MANUAL**

***Thank you for purchasing the Zila! Before using the camera, please take the time to read and understand this instruction manual to familiarise yourself with the functionalities and capabilities of the camera. For ease of reference, please print this instruction manual or save it to a computer or other such device.***

#### Note

The information contained in this instruction manual is the property of Z INTERNATIONAL LIMITED (Hong Kong).

Reproducing, altering, transferring, or distributing part or all of the contents in this instruction manual without the prior written permission of Z INTERNATIONAL LIMITED (Hong Kong) is strictly forbidden.

The accuracy and reliability of this instruction manual is not warranted, whether expressly or by implication.

Z INTERNATIONAL LIMITED (Hong Kong) reserves the right to amend this instruction manual at any time without any prior notice.

In case of any discrepancy, inconsistency, conflict, or ambiguity between the English version and any other language version of this instruction manual, the English version will always prevail.

## **Table of Contents**

Identifying the Different Parts of the Camera .....	1
Attaching the Wrist Strap .....	4
Inserting Memory Cards .....	5
Removing Memory Cards .....	7
Charging the Camera .....	8
Checking the Battery Level .....	9
Turning the Camera On and Off .....	10
Choosing a Different Language .....	11
Changing the Date and Time .....	12
Taking Photos .....	13
Zooming In and Out .....	14
Using the Fun Filters .....	15
Viewing Photos .....	16
Deleting Photos .....	17
Recording Videos .....	18
Playing Back Videos .....	19
Deleting Videos .....	20
Formatting .....	21
Toggling the Sound Effects .....	22
Transferring Files from the Camera .....	23
Troubleshooting .....	24
Warnings and Precautions .....	25
Specifications .....	29

# Identifying the Different Parts of the Camera

## **Front**

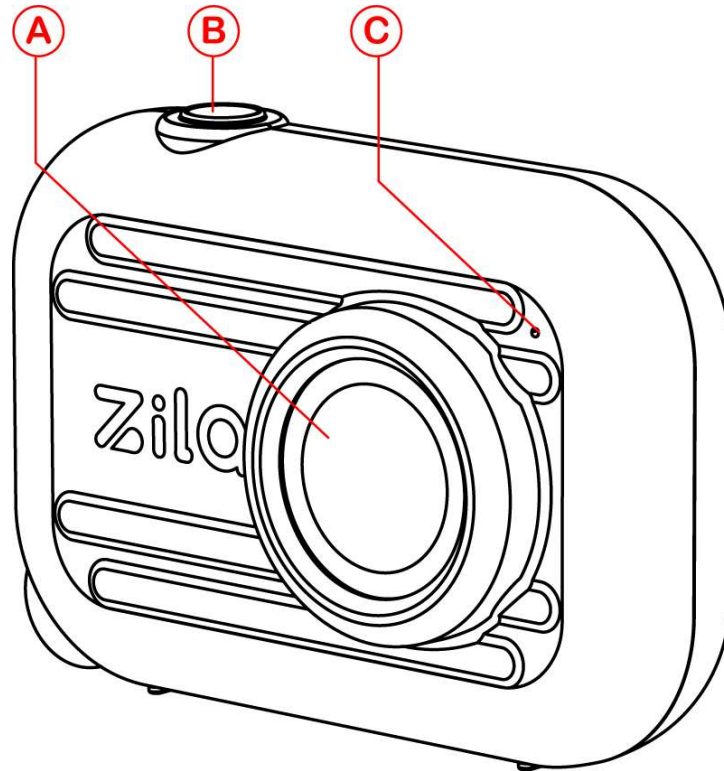

Ⓐ Lens

Ⓑ Shutter Button (Photo Mode)

Record Button (Video Mode)

Play/Pause Button (Video Playback)

Enter Button (Settings Menu, Delete Menu)

Ⓒ Microphone

## Back

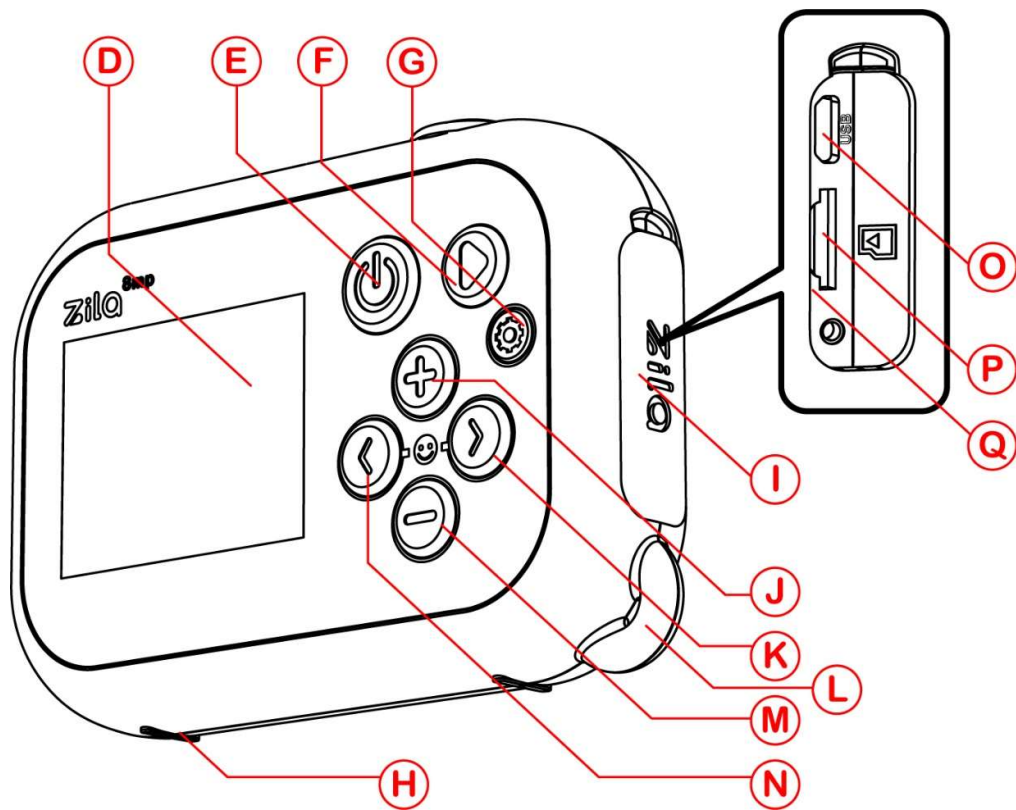

- Ⓓ LCD Screen
- Protective Film
- Ⓔ Power Button
- Exit Button (Fun Filters Mode)
- Ⓕ Playback Button
- Stop Button (Video Playback)
- Exit Button (Playback Mode)
- Ⓖ Settings Button
- Delete Button (Playback Mode)
- Exit Button (Settings Menu, Delete Menu)
- Ⓗ CE Label
- Ⓘ Silicone Cover

- Ⓜ Up Button (Settings Menu, Delete Menu)  
Zoom In Button (Photo Mode, Video Mode, Fun Filters Mode)
- Ⓝ Right Button (Settings Menu, Delete Menu)  
Fun Filters Selector Button (Photo Mode)
- Ⓛ Wrist Strap Eyelet
- Ⓜ Down Button (Settings Menu, Delete Menu)  
Zoom Out Button (Photo Mode, Video Mode, Fun-Filters Mode)
- Ⓝ Left Button (Settings Menu, Delete Menu)  
Fun Filters Selector Button (Photo Mode)
- Ⓞ Micro-B USB Port
- Ⓟ Memory Card Slot
- Ⓠ Reset Button

## **Attaching the Wrist Strap**

Attach the included wrist strap to the camera's wrist strap eyelet as described below.

1. Thread the small, thin loop of the strap all the way through the eyelet.
2. Pass the rest of the strap through the small, thin loop.
3. Pull the strap until it is securely fastened to the eyelet.

*\* Wearing the strap on your wrist can help prevent the camera from accidentally being dropped.*

*\* As the camera floats, wear the strap on your wrist and hold the camera securely while it is underwater (see page 25).*

## Inserting Memory Cards

Insert a memory card (not included) into the camera as described below.

*\* Only microSD and microSDHC cards can be used with the camera; microSDXC cards (microSD cards with a storage capacity greater than 32GB) are not supported. "Card Error" will show on the LCD screen if a microSDXC card is inserted into the camera.*

*\* Use only brand name memory cards.*

*\* Keep memory cards out of the reach of small children.*

*\* For all steps below, make sure the camera is dry and use dry hands.*

1. To remove the silicone cover, put your fingernail in the notch next to the silicone cover, then pry the silicone cover off.

*\* Do not use excessive force when removing the silicone cover or pull on it when it is removed.*

2. Hold the memory card in the orientation shown by the debossed memory card icon next to the memory card slot, then slide the memory card into the slot until it clicks into place at the back of the slot.

*\* Do not insert the memory card at an angle or with excessive force.*

*\* Format all memory cards (see page 21) before first use or after using them in a computer or other such device.*

3. Close the silicone cover by pressing it firmly back in place into its recess until its outer surface becomes flush with the camera body, making sure both protrusions on the back of the silicone cover are inserted into both the memory card slot and the Micro-B USB port, to prevent dust or water from entering and damaging the camera.



By default, the camera saves all photos and videos to the internal memory. If a memory card is inserted into the camera, photos and videos are saved to the memory card instead.

## **Removing Memory Cards**

To remove a memory card inserted into the camera, remove the silicone cover (see step 1 on page 5), then press the centre of the memory card in and release it slowly. The memory card can then be removed by hand.

*\* The memory card can be removed whether the camera is on or off.*

*\* Make sure the camera is dry and use dry hands.*

*\* When done, remember to close the silicone cover (see step 3 on page 5) to prevent dust or water from entering and damaging the camera.*

## **Charging the Camera**

The camera contains an integrated rechargeable battery. The camera is fully charged at shipment. As the camera gradually loses its charge when not in use, charge it before use. The camera charges the battery internally.

*\* For this section, make sure the camera is dry and use dry hands.*

Plug the USB-A end of the included USB cable into any USB-A charging port, such as on a computer, power bank, or wall charger. Then remove the silicone cover (see step 1 on page 5) and connect the other end of the cable to the camera's Micro-B USB port.

*\* Make sure the cable's connectors are in the correct orientation before they are inserted and the connectors are inserted fully.*

When the camera is connected as above, the LCD screen shows the following icon on a white background:



When the camera is charging, a blinking red charging icon appears on the bottom left hand corner of the LCD screen. When charging is complete, this icon is replaced by a non-blinking green battery icon.

*\* Charging times vary depending on ambient temperature.*

*\* When charging is complete, carefully disconnect the cable from the camera and the camera automatically turns off. Then close the silicone cover (see step 3 on page 5) to prevent dust or water from entering and damaging the camera.*

## **Checking the Battery Level**

After turning the camera on (see page 10), check the battery level on the bottom left hand corner of the LCD screen.

The 5 different battery levels are shown as follows:



In order from right to left:

100% – 80%

80% – 60%

60% – 40%

40% – 20%

20% – 0% (charge the camera)

## **Turning the Camera On and Off**

To turn the camera on, press and hold down the power button until the LCD screen lights up and, if the camera's sound effects are on, the power-on sound plays, then release the power button.

*\* If the camera does not turn on, try charging it (see page 8). If that does not work, troubleshoot the camera (see page 24).*

To turn the camera off, press and hold down the power button until the LCD screen shuts off and, if the camera's sound effects are on, the power-off sound plays, then release the power button.

*\* The camera automatically turns off when not in use for 2 minutes.*

## **Choosing a Different Language**

1. With the camera on (see page 10), press the settings button to enter the settings menu.
2. Select "Language" by pressing the up button or the down button, then press the right button or the shutter button to enter the language submenu.

*\* To return to the settings menu without making any changes, press the left button.*

3. Select the desired language by pressing the up button or the down button, then press the shutter button to confirm the selection and the camera automatically returns to the settings menu.

To exit the settings menu, press the settings button.

## **Changing the Date and Time**

1. With the camera on (see page 10), press the settings button to enter the settings menu.
2. Select "Date and Time" by pressing the up button or the down button, then press the right button or the shutter button to enter the date and time submenu.

*\* To return to the settings menu without making any changes, press the shutter button.*

3. Press the left button or the right button to select the year, month, day, hour, minute, or seconds, then press the up button or the down button to change the selected date or time value.
4. Press the shutter button to set the date and time and the camera automatically returns to the settings menu.

To exit the settings menu, press the settings button.

## **Taking Photos**

*\* Before proceeding, make sure the silicone cover is closed (see step 3 on page 5) to prevent dust or water from entering and damaging the camera.*

1. Turn the camera on (see page 10).
2. Hold the camera steady with both hands, using your left hand to cradle the bottom of the camera and your right hand to grip the side of the camera where the silicone cover is.
3. Brace your elbows against your torso or lean against a table, wall, tree, or other structure.

*\* Shaking or unsteady hands can blur your shots.*

*\* Keep your fingers and other objects away from the lens so as not to leave any marks on it, such as fingerprints; obstruct your shots; or render your shots out of focus.*

4. Frame your shot.

*\* The LCD screen might be difficult to see clearly in direct sunlight.*

5. Press the shutter button.

*\* Make sure to hold the camera still for 1 or 2 seconds after pressing the shutter button in order to allow the camera to process your shot.*

In photo mode, the number of shots remaining is shown on the top right hand corner of the LCD screen.



## **Zooming In and Out**

When framing your shot, zoom in by pressing the up button.

Zoom out by pressing the down button.

*\* Press and hold down the up button or the down button to zoom in or out quickly.*

When zooming in or out, the zoom magnification, which is up to 4 times in 21 steps, is shown on the bottom right hand corner of the LCD screen.

*\* The zoom function can be used in both photo mode and video mode.*

## **Using the Fun Filters**

21 fun filters, including a black and white filter, are available in photo mode.

Cycle through the fun filters and select a fun filter by pressing the left button or the right button.

To return to normal photo mode, press the power button.

*\* The fun filters are not available in video mode.*

## Viewing Photos

Photos can be viewed on the LCD screen in playback mode.

*\* The LCD screen might be difficult to see clearly in direct sunlight.*

To view photos in playback mode, press the playback button.

*\* In playback mode, photos are identified by the following icon on the top left hand corner of the LCD screen:*



Cycle through multiple photos by pressing the left button or the right button. Press the right button to view photos in chronological order. Press the left button to view photos in reverse order.

To exit playback mode, press the playback button.

## **Deleting Photos**

*\* Deleted photos cannot be recovered. Before proceeding, copy important photos to a computer or other such device.*

1. Press the playback button to go to playback mode, select the photo for deletion by pressing the left button or the right button, then press the settings button to enter the delete menu.

*\* To exit the delete menu, press the settings button again.*

2. Make sure "This Image" is selected, then press the right button or the shutter button to bring up the confirmation dialog box.

*\* To return to the delete menu, press the left button or select "No" and press the shutter button.*

3. Press the up button or the down button to select "Yes", then press the shutter button to confirm and the camera automatically returns to playback mode.

To delete all files (both photos and videos), follow steps 1 to 3 above, except make sure "All" is selected in step 2.

## **Recording Videos**

*\* Before proceeding, make sure the silicone cover is closed (see step 3 on page 5) to prevent dust or water from entering and damaging the camera.*

1. Turn the camera on (see page 10).
2. Press and hold down the shutter button for around 3 seconds to go to video mode. Video recording starts automatically, as shown by the blinking red dot on the top of the LCD screen.

*\* Release the shutter button as soon as video recording starts.*

*\* The LCD screen might be difficult to see clearly in direct sunlight.*

3. To stop recording, press the shutter button and the camera automatically returns to photo mode.

*\* Recording stops and saves automatically when the battery is too low or when the internal memory or, if a memory card is inserted into the camera (see page 5), the memory card is full.*

*\* Sound is recorded via the built-in microphone. Do not cover the microphone hole during recording. The microphone might pick up sounds made by pressing the camera buttons during recording.*

In video mode, the recording duration is shown on the top right hand corner of the LCD screen.

## **Playing Back Videos**

Videos can be played back on the LCD screen in playback mode.

*\* The LCD screen might be difficult to see clearly in direct sunlight.*

To playback a video, press the playback button to go to playback mode, select the video for playback by pressing the left button or the right button, then press the shutter button to start video playback.

*\* In playback mode, videos are identified by the following icon on the top left hand corner of the LCD screen:*



During video playback, press the shutter button again to pause playback and again to resume playback.

During video playback, press the left button or the right button to adjust the playback speed forwards or backwards respectively. The playback speed, which can be adjusted to 2, 4, or 8 times normal speed, is shown on the bottom left hand corner of the LCD screen during video playback.

To stop and exit video playback, press the playback button.

To exit playback mode, press the playback button again.

## Deleting Videos

*\* Deleted videos cannot be recovered. Before proceeding, copy important videos to a computer or other such device.*

1. Press the playback button to go to playback mode, select the video for deletion by pressing the left button or the right button, then press the settings button to enter the delete menu.

*\* To exit the delete menu, press the settings button again.*

2. Make sure "This Video" is selected, then press the right button or the shutter button to bring up the confirmation dialog box.

*\* To return to the delete menu, press the left button or select "No" and press the shutter button.*

3. Press the up button or the down button to select "Yes", then press the shutter button to confirm and the camera automatically returns to playback mode.

To delete all files (both photos and videos), follow steps 1 to 3 above, except make sure "All" is selected in step 2.

## **Formatting**

Format the internal memory as described below.

*\* Make sure no memory card is inserted into the camera.*

1. With the camera on (see page 10), press the settings button to enter the settings menu.
2. Select "Format" by pressing the up button or the down button, then press the right button or the shutter button to bring up the confirmation dialog box.

*\* To return to the settings menu without formatting, press the left button or select "No" and press the shutter button.*

3. Press the up button or the down button to select "Yes", then press the shutter button to confirm and the camera automatically returns to the settings menu.

To exit the settings menu, press the settings button.

To format a memory card inserted it into the camera, follow steps 1 to 3 above.

*\* Formatting permanently deletes all data (including photos and videos) in the internal memory or on the memory card. Before formatting, copy any data you wish to keep to a computer or other such device.*



## **Toggling the Sound Effects**

By default, the camera's sound effects (including the shutter sound, power-on and power-off sounds, and all button sounds) are on.

Turn them off as described below.

1. With the camera on (see page 10), press the settings button to enter the settings menu.
2. Select "Sound Effect" by pressing the up button or the down button, then press the right button or the shutter button to enter the sound effect submenu.

*\* To return to the settings menu without making any changes, press the left button or keep "On" selected and press the shutter button.*

3. Press the up button or the down button to select "Off", then press the shutter button to confirm and the camera automatically returns to the settings menu.

To exit the settings menu, press the settings button.

To turn the sound effects back on, follow steps 1 to 3 above, except select "On" in step 3.

## **Transferring Files from the Camera**

Copy files (photos, videos, or both) to a computer as described below.

*\* For all steps below, make sure the camera is dry and use dry hands.*

1. Use the included USB cable to connect the camera to a computer (see the second and third paragraphs on page 8).

*\* The camera can be connected whether the camera is on or off. If the camera is off, it automatically turns on once it is connected.*

*\* Connect the camera directly to the computer, not via a peripheral, such as a USB hub.*

2. The internal memory and, if a memory card is inserted into the camera (see page 5), the memory card is listed on the computer as removable drives named "Zila Data" and "Zila Card" respectively. Files can be found in folders on one drive or both drives, depending on where they were saved (see page 6). Select the desired files, then copy the selected files to the desired location on the computer.

*\* Do not disconnect the cable or remove the memory card, if any, until copying is complete.*

*\* When copying is complete, carefully disconnect the cable from the camera and the camera automatically turns off. Then close the silicone cover (see step 3 on page 5) to prevent dust or water from entering and damaging the camera.*

## **Troubleshooting**

If, for whatever reason, the camera hangs or freezes, try removing any memory cards from the camera (see page 7). If that does not work, or if the camera does not have any memory cards in it, try resetting the camera.

To reset the camera, remove the silicone cover (see step 1 on page 5) and locate the small hole next to the memory card slot. Then use a toothpick to press the reset button inside the small hole gently. The camera should now be powered off, reset to its original settings, and function as expected.

*\* A reset does not affect the files (photos, videos, or both) saved in the camera (internal memory, memory card, or both).*

*\* When done, remember to close the silicone cover (see step 3 on page 5) to prevent dust or water from entering and damaging the camera.*

If the camera still does not work, and for any warranty claims, see the below list of authorised Zila distributors, then contact the distributor in your country or region.

Hong Kong Distributor:

Z INTERNATIONAL LIMITED  
[www.zilacam.com](http://www.zilacam.com)

European Union Distributor:

NESPART SRL  
Chaussée de Lasne 59  
1330 Rixensart  
Belgium  
[info@nespart.com](mailto:info@nespart.com)

## **Warnings and Precautions**

Before using the camera, this instruction manual should be read in its entirety and its instructions should be followed carefully. In particular, all warnings and precautions in this section and any other warnings and precautions in the rest of this instruction manual should be heeded. Failure to heed these warnings and precautions will void the warranty.

### ***Water Resistance***

- The camera is IP67 certified. The 6 rating denotes that the camera has the highest level of protection against any ingress of solid particles, such as dust. In other words, the camera is dustproof and thus can be taken to, for example, the sandy part of the beach. The 7 rating, on the other hand, indicates that the camera can withstand submersion in static water to a depth of up to 1 metre for 30 minutes. So, while the camera is water resistant and thus can be used in the water at the beach, the pool, or the like, as movement of the camera underwater adds dynamic pressure to the camera body, do not jump or dive into the water with the camera, do not swim with the camera, do not take the camera to more than 0.5 metres underwater, and do not throw or thrust the camera into the water. In general, do not subject the camera to high water pressure conditions.
- Do not subject the camera to undue shock or vibration by dropping or hitting it, or else the camera's water resistance might be compromised.
- As the camera's water resistance was tested in fresh water only, its 7 rating is not guaranteed in salt, chlorinated, or soapy water.
- Do not immerse the camera in any liquid other than water, such as alcohol.
- The camera is water resistant at around room temperature, but it is not impermeable to water vapour. High heat or humidity in places like saunas, steam rooms, and hot tubs might damage the camera.

- Do not take a shower with the camera or take the camera to a bath with any water jets, such as a jacuzzi.
- Make sure the silicone cover is closed (see step 3 on page 5) before submerging the camera or otherwise bringing the camera in contact with any water to prevent water from entering and damaging the camera.
- Do not remove the silicone cover when the camera is underwater, for obvious reasons, or in areas exposed to high humidity, water spray, high winds, dust, dirt, or sand.
- Abrupt changes in temperature and humidity can result in visible condensation inside the lens or LCD screen, which might lead to the camera malfunctioning. To avoid this, place the camera in a closed bag when moving from one environment to another in order to slow any changes in temperature and humidity experienced by the camera. Take the camera out of the bag only when the temperature and humidity inside the bag is the same as that outside the bag.

*\* If visible condensation has already formed, try leaving the camera overnight in a sealed bag or container of uncooked rice. The rice will absorb the excess moisture. Alternatively, leave the camera in a dehumidifying dry cabinet until the visible condensation disappears.*

- Do not press any buttons on the back of the camera (press only the shutter button) while the camera is underwater, as pressing the buttons on the back of the camera might allow water to enter and damage the camera.

### **Camera Care**

- Always clean the camera within 1 hour of using it underwater or anywhere where it is in contact with water that is not fresh water, such as in the rain. To do this, run the camera under a tap of room temperature water. Before doing so, make sure the camera is off (see

page 10) and the silicone cover is closed (see step 3 on page 5). Use your fingers to rub away any dirt or other residues, such as sunscreen. Then wipe the camera with a soft, dry, and clean cloth and leave the camera to dry in an area that is well ventilated.

- Do not remove the silicone cover, charge the camera, or use the camera's Micro-B USB port until the camera is completely dry.
- From time to time, use a microfibre cloth to remove any dust and fingerprints on the camera, especially on the lens, which can be easily scratched.
- Do not use alcohol, thinner, or other volatile chemicals to clean the camera, or else the camera, particularly its finish, might be damaged.

### ***Storage***

- Store the camera in a cool, dry, and clean place.
- Do not store the camera in an area exposed to, among other things, high or fluctuating heat or humidity; cold temperatures; dust, dirt, or sand; chemicals; flammable objects; severe vibration; or strong magnetic fields.

### ***Others***

- Do not ever attempt to modify or take apart the camera or the included USB cable. If the camera breaks open as a result of an accident, do not touch any of the camera's internal parts, as they pose a fire and electric shock risk.
- Do not attempt to copy the camera's software; transfer to another party any copy of it, whether in whole or in part; or modify it in any way whatsoever.
- Do not apply force to the camera body, especially the lens and the LCD screen, which can be easily damaged.

- Do not place the camera on an unstable surface, as the camera might fall and cause injury.
- Do not aim the camera directly at extremely bright light sources, such as the sun, or else the camera's sensor might be damaged.
- Do not insert objects into the microphone hole, or else the camera's water resistance might be compromised and the microphone might be damaged.
- Do not remove or damage in any way the CE label on the bottom of the camera.

## **Specifications**

<b>Model</b>	ZL_Cam
<b>Dimensions</b>	101.5 mm x 71.4 mm x 32.8 mm (W x H x D)
<b>Weight</b>	105.6 g
<b>Sensor</b>	CMOS 1/4 in
<b>Pixels</b>	8.0 MP
<b>Zoom</b>	4.0 X (digital zoom)
<b>Aperture</b>	f/2.8
<b>Focal Length</b>	6.0 mm
<b>Focus Range</b>	30 cm (approximate)
<b>Focus Mode</b>	Auto
<b>White Balance</b>	Auto
<b>ISO Sensitivity</b>	ISO 100 – ISO 400
<b>LCD Screen</b>	2.0 in
<b>File Format</b>	JPG (photos), AVI (videos)
<b>Storage</b>	Internal memory (1 GB), microSD/SDHC memory cards
<b>Power Source</b>	600 mAh integrated rechargeable Li-ion battery (3.7 V)
<b>Accessories</b>	Wrist strap, USB-A to Micro-B USB cable