

Thank you for purchasing this OXS product.

To receive more complete service, please follow us at www.oxsaudio.com

OXS

OXS G1 V1.0

User Manual

BENUTZERHANDBUCH · MANUAL DE USUARIO
РУКОВОДСТВО ПОЛЬЗОВАТЕЛЯ · 使用手册
使用手冊 · ユーザーマニュアル · 사용설명서 · دليل التعليمات

制造商: 深圳雷戈创新科技有限公司
地址: 深圳市龙岗区园山街道荷坳社区龙岗大道8288号大运软件小镇17栋105
製造商: 深圳雷戈創新科技有限公司
地址: 深圳市龍崗區園山街道荷坳社區龍崗大道8288號大運軟體小鎮17棟105

Manufacturer : ShenZhen Rango Innovation Technology Co., Ltd
Address : Room 105, Building 17th, Dayun Software Town,
No. 8288 Longgang Avenue, Longgang District, Shenzhen, China 518115

Gaming Soundbar

Thank you for purchasing this OXS product.
To receive more complete service, please follow us at www.oxsaudio.com

ABOUT THIS MANUAL

The user manual has two parts: this simple paper USER MANUAL and a detailed FULL MANUAL you can download.

① USER MANUAL

See this manual for product installation, components and connections.

② FULL MANUAL

You can access the FULL MANUAL or download it in document format from OXS's website. (<http://www.oxsaudio.com/support>)

Design and specifications are subject to change without prior notice.

CONTENTS

WHAT'S INSIDE

- Device Layout
- Remote
- Toggle Control

HOW TO USE

CONNECTING TO AN AUDIO SOURCE

- Connecting via HDMI eARC/ARC
- Connecting via HDMI IN
- Connecting via the USB-C cable
- Connecting via the analog cable
- Connecting via Bluetooth
- Setting the speaker as the default device

ENABLING DOLBY ATMOS

ENG - 03

ENG - 04

ENG - 06

ENG - 07

ENG - 08

ENG - 09

ENG - 09

ENG - 10

ENG - 11

ENG - 12

ENG - 13

ENG - 14

ENG - 15

WHAT'S INSIDE

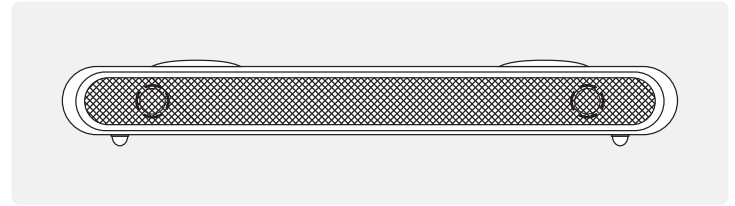

OXS Thunder Soundbar×1

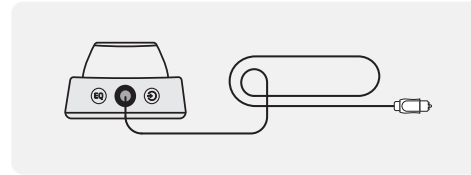

Toggle Controller×1

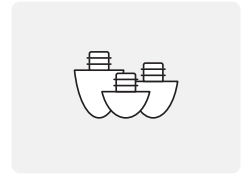

Detachable feet for soundbar angle adjustment

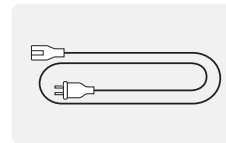

Power Cable×1

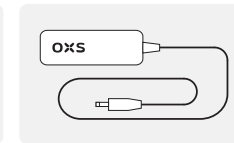

Power Adapter×1

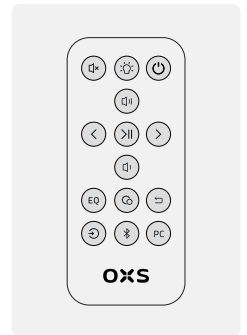

Remote Control

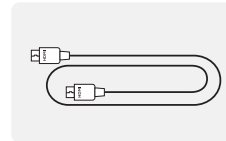



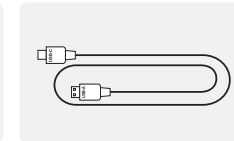



HDMI Cable×1

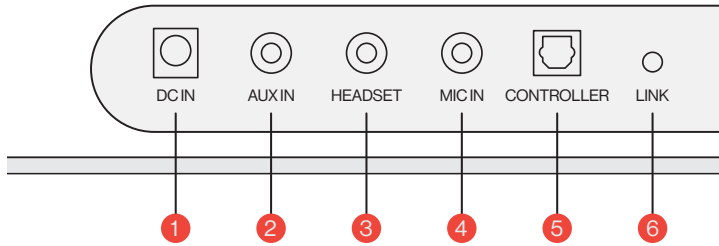
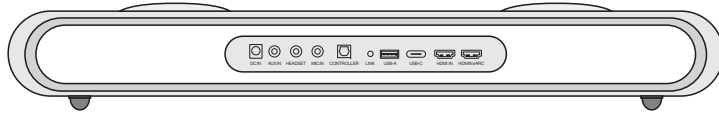

USB A to C Cable×1





DEVICE LAYOUT

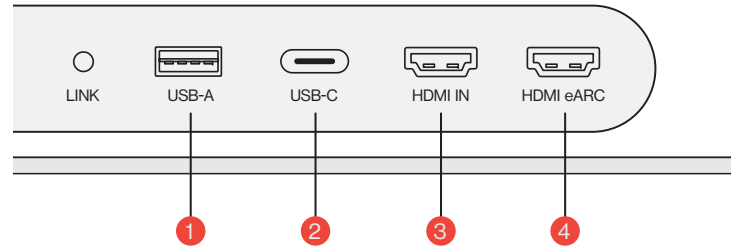
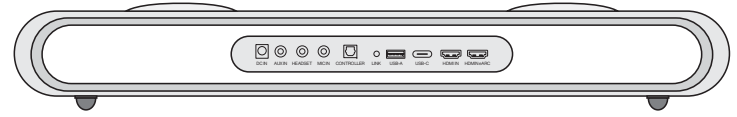

1	Power Supply		Power up the soundbar using the supplied power adapter
2	AUX IN		AUX audio input
3	HEADSET JACK		Plug in the headset or earphone wire to connect it to the soundbar
4	MIC IN JACK		Connect an external microphone to the soundbar via a 3.5 mm stereo cable
5	CONTROLLER		Plug in the toggle controller wire to connect it to the soundbar
6	LINK		Press to pair with the OXS Satellite Neck Speaker (purchase separately)

ENG-04



1	USB-A		Plug in the dongle to connect the OXS Satellite Neck Speaker (purchase separately)
2	USB-C		Plug in a USB (C-Type) cable to connect the soundbar to the PC
3	HDMI IN		Plug in an HDMI cable to connect the soundbar to the gaming monitor or PC
4	HDMI eARC		Plug in an HDMI cable to connect the soundbar to the gaming console

ENG-05

REMOTE

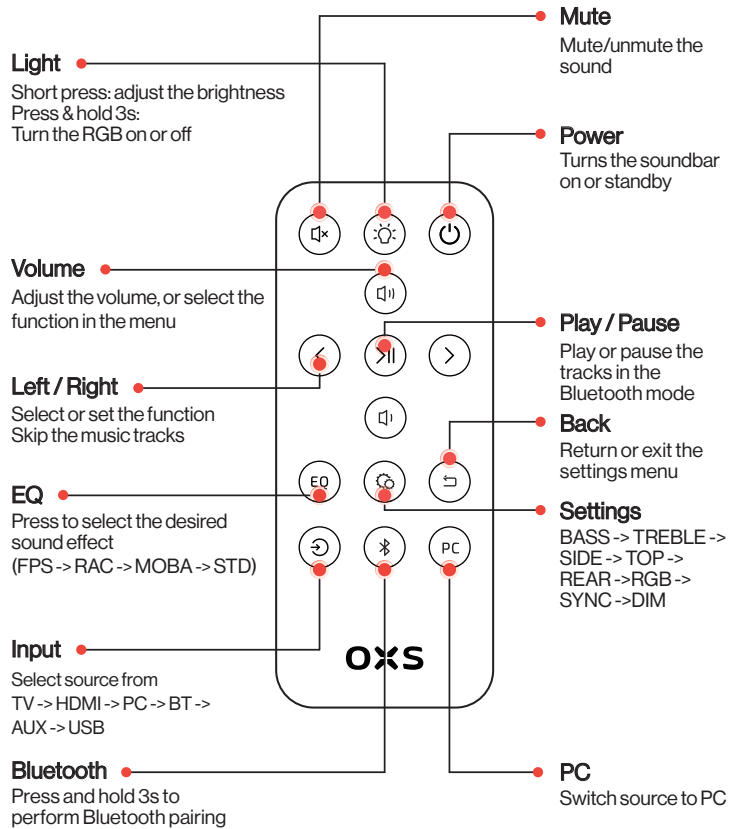

TOGGLE CONTROL

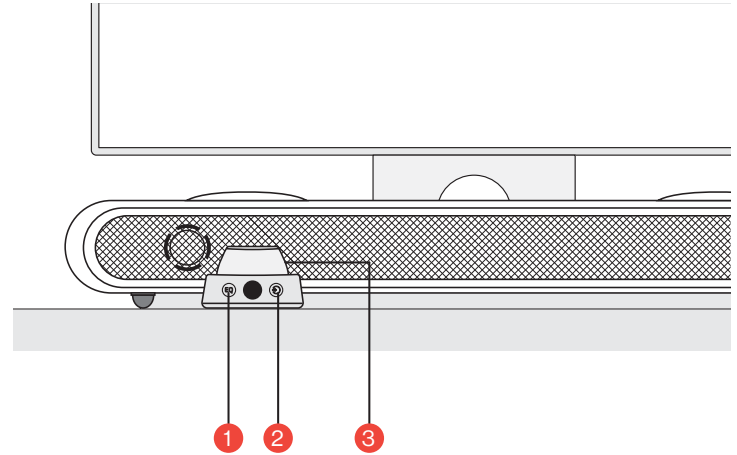

1	EQ		Press to select the desired sound effect (FPS->RAC->MOBA->STD)
2	Input		Select source from TV->HDMI->PC->BT->AUX->USB
3	Main Button		Press & hold 3s Turn the soundbar on or standby
			Press once Mute the soundbar
			Rotate to adjust the volume

HOW TO USE

Setting it up

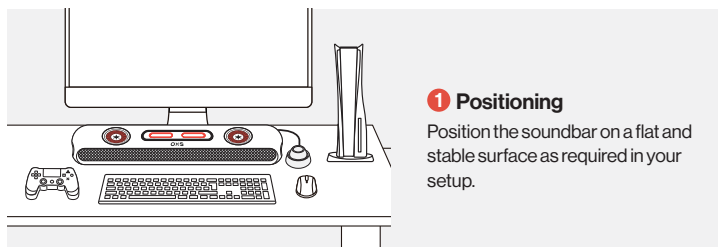

2 Adjusting height

The extra pair of detachable feet lets you change the soundbar height to ensure that sound is delivered with the least amount of obstruction.

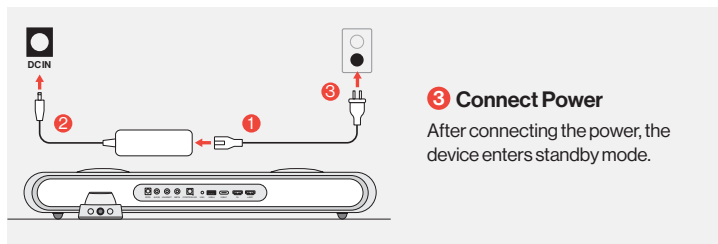
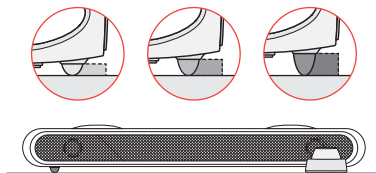

4 Power on

Power on the soundbar by press and hold the button.

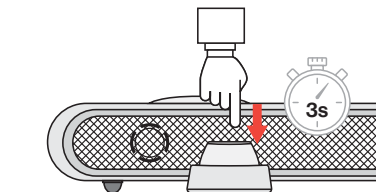

CONNECTING TO AN AUDIO SOURCE

Connecting via HDMI eARC/ARC

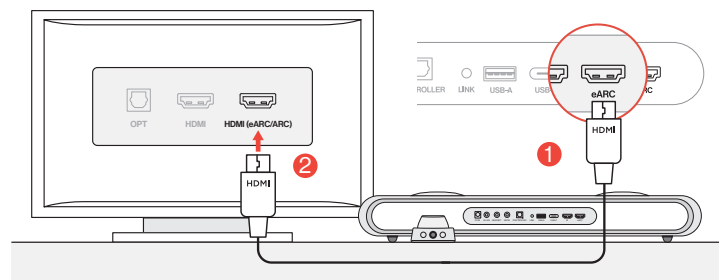

- 1 Connect the soundbar to any of the HDMI(eARC/ARC) ports on your TV using the included HDMI cable.

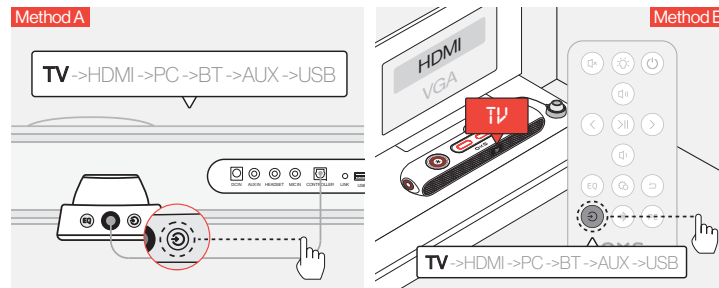

- 2 Switch the audio input to TV.

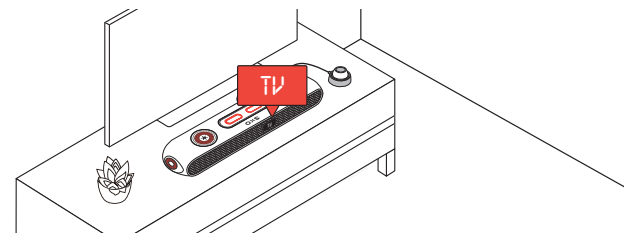

Connecting via HDMI IN

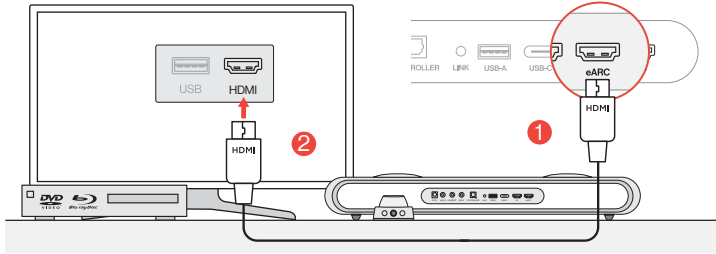

- 1 Connect any of the HDMI ports on your TV or monitor to the soundbar's HDMI OUT port.

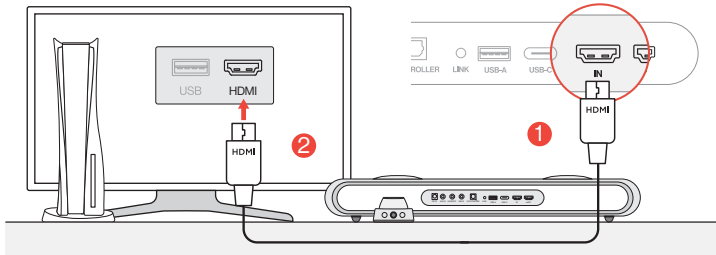

- 2 Connect any of the HDMI ports on your PC or gaming console to the soundbar's HDMI IN port.

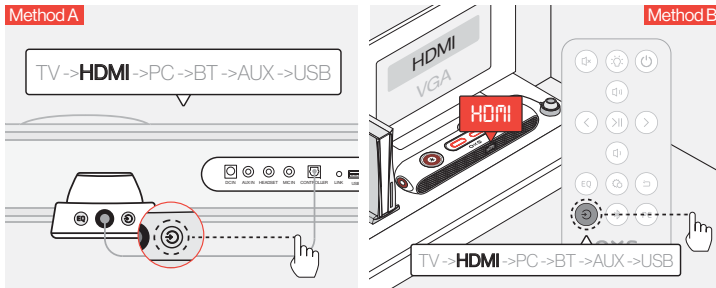

- 3 Switch the audio input to HDMI.

Connecting via the USB-C cable

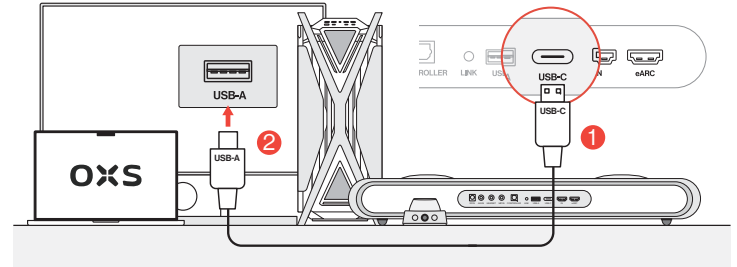

- 1 Connect the soundbar to any of the USB-A ports on your PC using the included USB-C to USB-A cable.

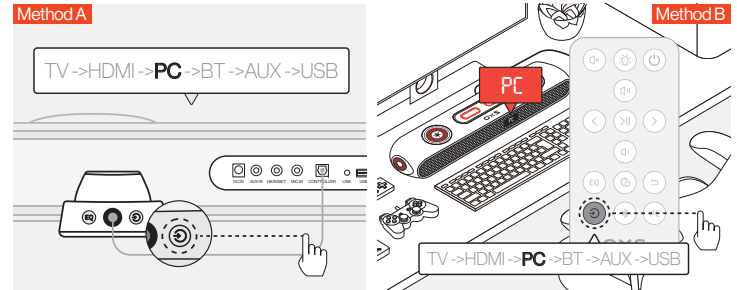

- 2 Switch the audio input to the PC.

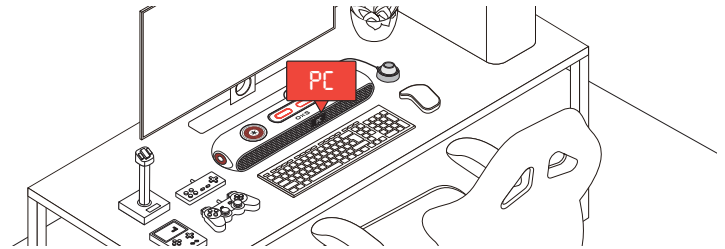

Connecting via the analog cable

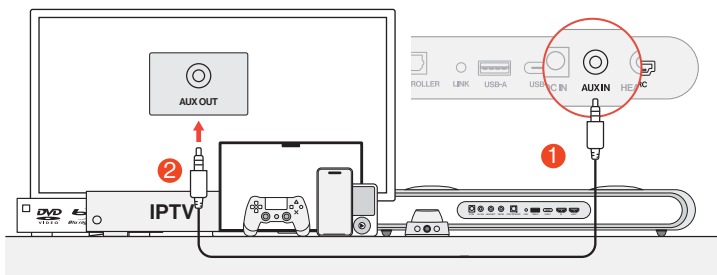

- 1 Connect the device and the soundbar using an AUX cable.

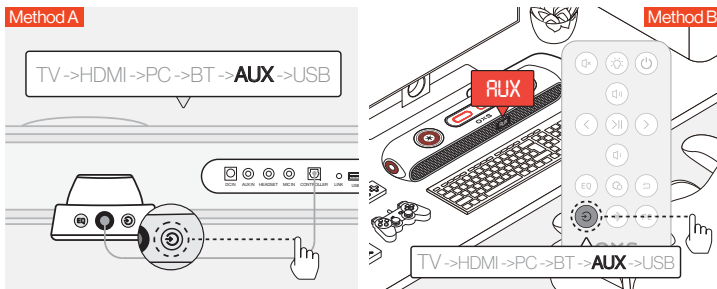

- 2 Switch the audio input to AUX.

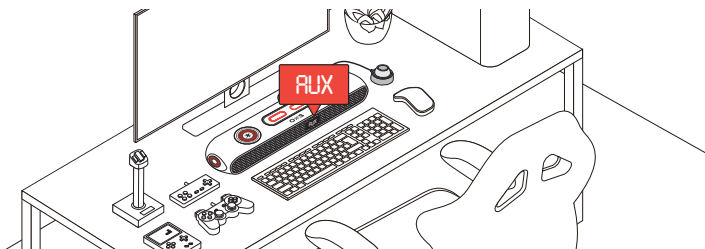

Connecting via Bluetooth

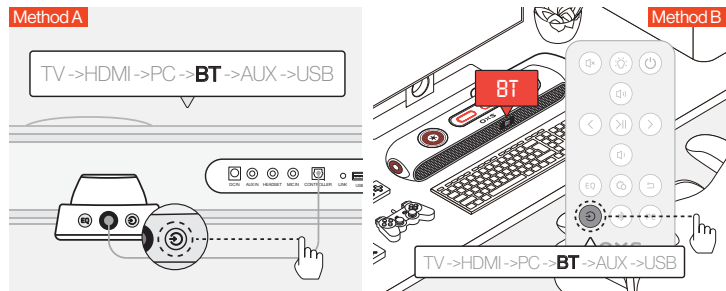

- 1 Switch the audio input to Bluetooth.

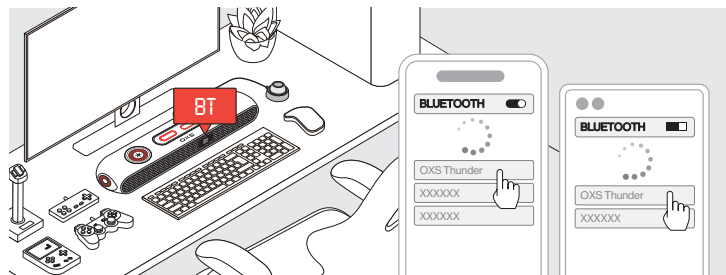

- 2 Select "OXs Thunder" on the device screen.

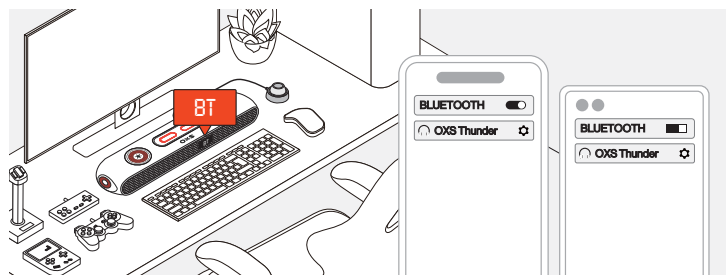

- 3 Once the connection is successful, the "BT" indicator on the soundbar will remain steady.

SETTING THE SPEAKER AS THE DEFAULT DEVICE

If you are using the soundbar for the first time, you may be required to set up the device as your system's default playback device.

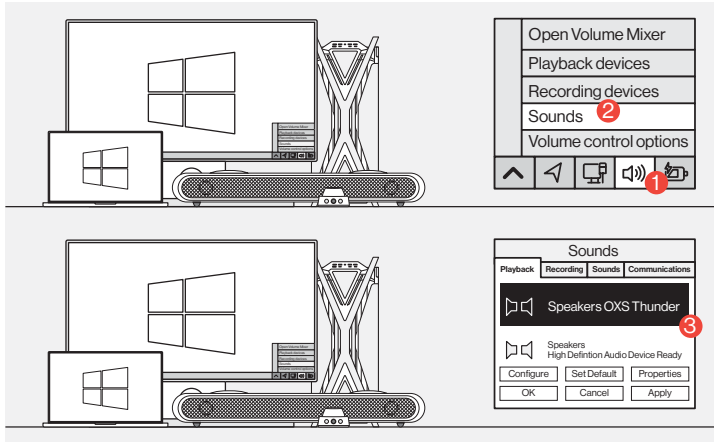

1 For Windows PC users

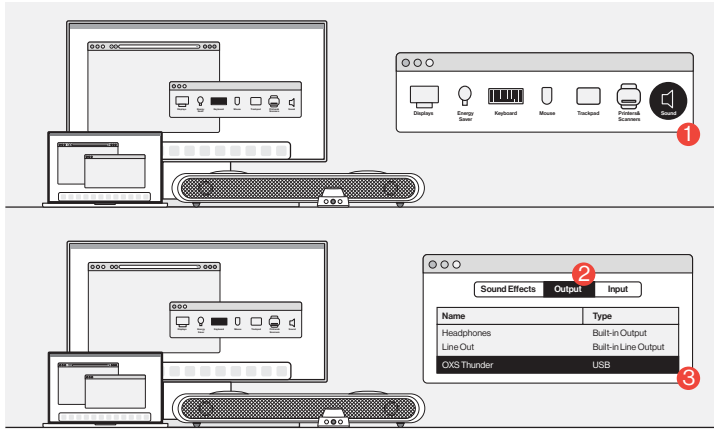

2 For MAC users

ENABLING DOLBY ATMOS

Please be noted, Dolby Atmos is only available via HDMI output. If you are using the soundbar for the first time, you may need to enable Dolby Atmos on your gaming console or PC. For more instructions, please go to below sites:

• <https://games.dolby.com/atmos/documentation/#Platforms>

INHALTSVERZEICHNIS

LIEFERUMFANG

- Gerätelayout DE - 02
- Fernbedienung DE - 03
- Controller DE - 05
- Controllerr DE - 06

GEBRAUCHSANWEISUNG

DE - 07

AN AUDIOQUELLE ANSCHLIEßEN

DE - 08

- Über HDMI eARC/ARC anschließen DE - 08
- Anschluss über HDMI IN DE - 09
- Anschluss über das USB-C-Kabel DE - 10
- Anschluss über das analoge Kabel DE - 11
- Anschluss über Bluetooth DE - 12
- Den Lautsprecher als Standardgerät einstellen DE - 13

AKTIVIEREN VON DOLBY ATMOS

DE - 14

LIEFERUMFANG

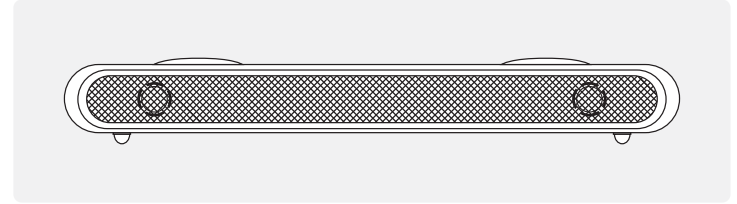

OXS Thunder Soundbar×1

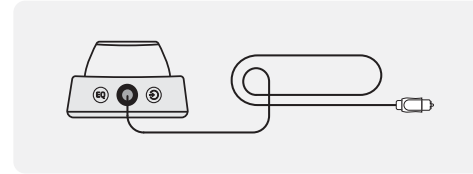

Controller×1

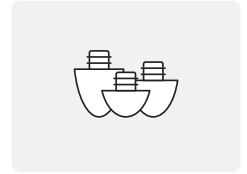

Abnehmbare Fußmatte zur Winkelverstellung der Soundbar

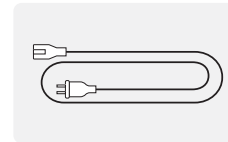

Stromkabel×1

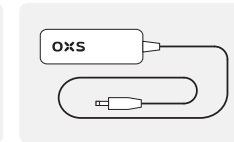

Netzadapter×1

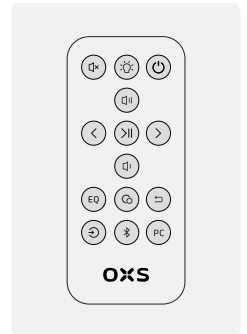

Fernbedienung

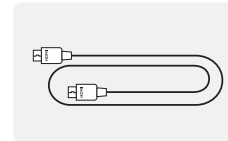



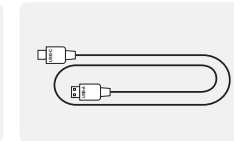



HDMI-Kabel×1

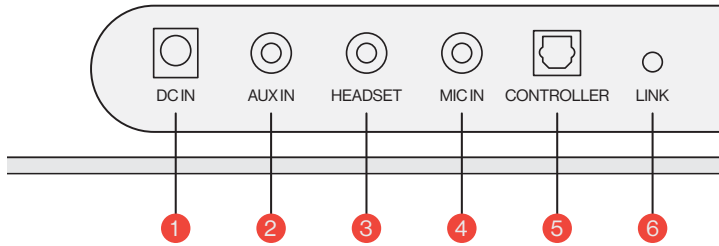
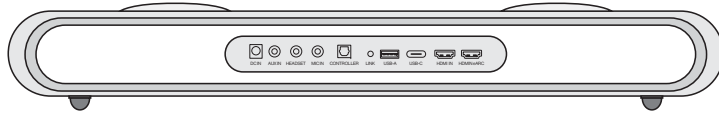





USB-A zu USB-C-Kabel×1

GERÄTELAYOUT

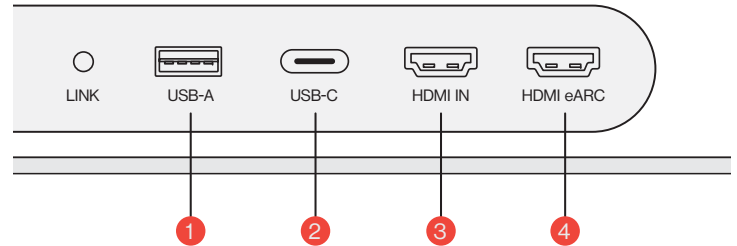
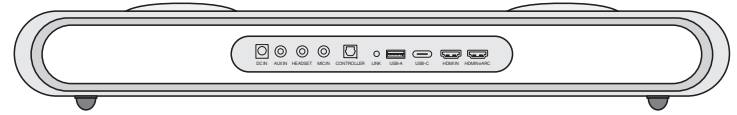

1	Netzteil		Schalten Sie die Soundbar mit dem mitgelieferten Netzadapter ein, um die Soundbar mit Strom zu versorgen
2	AUX IN		AUX-Audioeingang
3	KOPFHÖRER-ANSCHLUSS		Das Headset oder den Kopfhörer an die Soundbar anschließen
4	MIC-ANSCHLUSS		Ein externen Mikrophon mit einem 3,5-mm-Stereokabel an die Soundbar anschließen
5	CONTROLLER		Den Controller mit einem Kabel anschließen, um die Soundbar zu steuern
6	LINK		Drücken, um mit dem OXS Satellite Nackenlautsprecher (separat erhältlich) zu koppeln



1	USB-A		Plug in the dongle to connect the OXS Satellite Neck Speaker (purchase separately)
2	USB-C		Plug in a USB (C-Type) cable to connect the soundbar to the PC
3	HDMI IN		Plug in an HDMI cable to connect the soundbar to the gaming monitor or PC
4	HDMI eARC		Plug in an HDMI cable to connect the soundbar to the gaming console

FERNBEDIENUNG

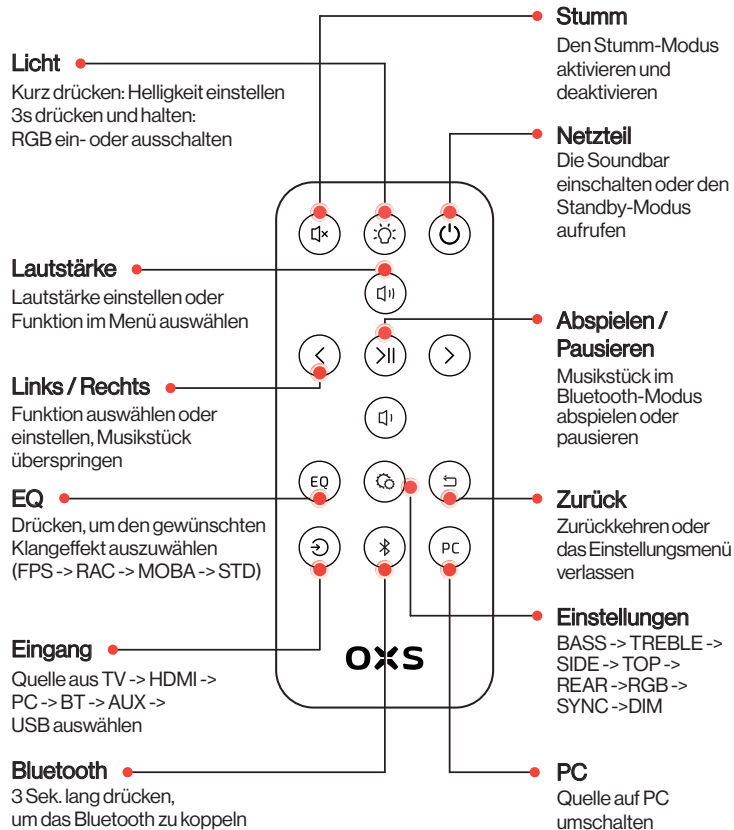

CONTROLLER

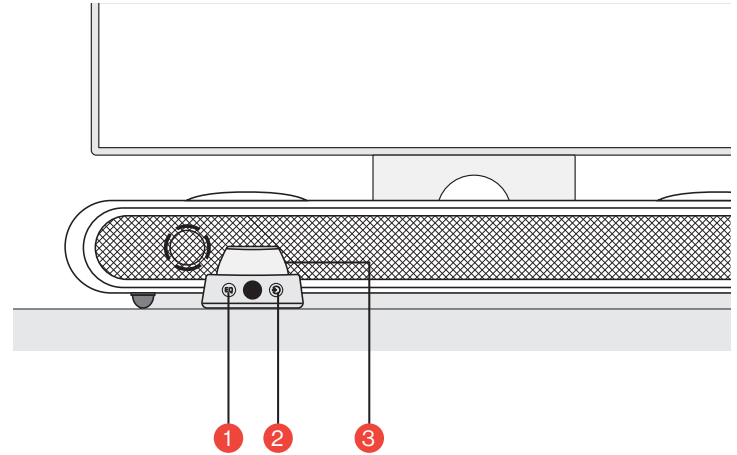

1	EQ		Drücken, um den gewünschten Klingeffekt auszuwählen (FPS -> RAC -> MOBA -> STD)
2	Eingang		Quelle aus TV -> HDMI -> PC -> BT -> AUX -> USB auswählen
3	Haupttaste		3 Sek. lang gedrückt halten Die Soundbar einzuschalten oder den Standby-Modus aufzurufen
			Kurz drücken Die Soundbar stumm zu schalten
			Drehen, um die Lautstärke einzustellen

GEBRAUCHSANWEISUNG

Einstellungen



2 Höhenanpassung

Das zusätzliche Paar abnehmbarer Fußmatte ermöglicht es Ihnen, die Höhe der Soundbar anzupassen, um sicherzustellen, dass der Klang mit möglichst geringer Behinderung übertragen wird. Nach Richtung der Fußmatte können Sie die Soundbar entweder flach oder in einem erhöhten Winkel positionieren.

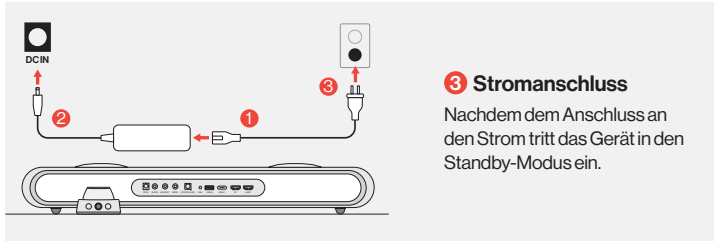
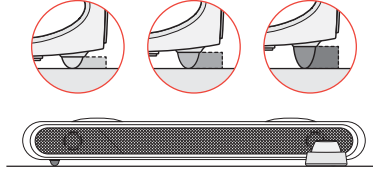

4 Einschalten

Schalten Sie die Soundbar ein, indem Sie die Taste gedrückt halten.

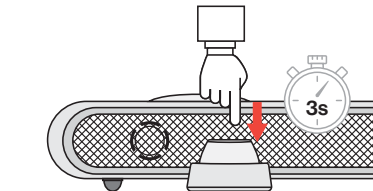

AN AUDIOQUELLE ANSCHLIEßEN

Über HDMI eARC/ARC anschließen

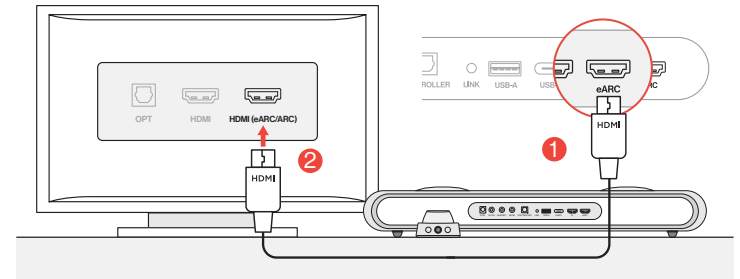

1 Die Soundbar mit dem mitgelieferten HDMI-Kabel an einen der HDMI (eARC/ARC)-Anschlüsse anschließen.

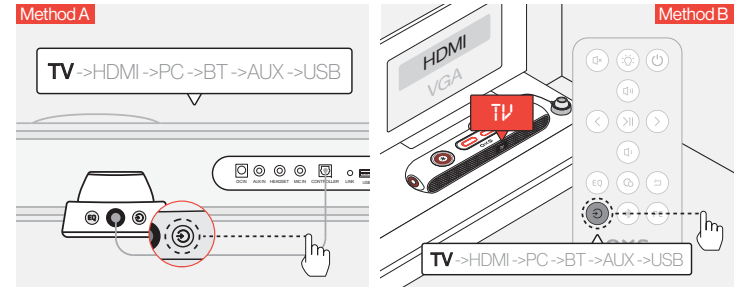

2 Den Audioeingang auf "TV" (Fernseher) umschalten.

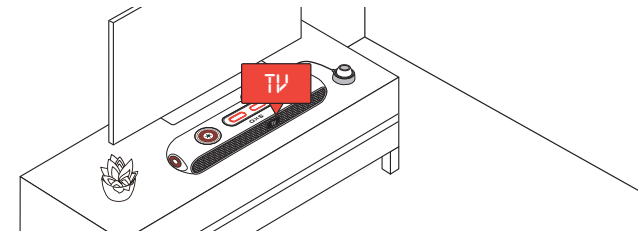

Anschluss über HDMI IN

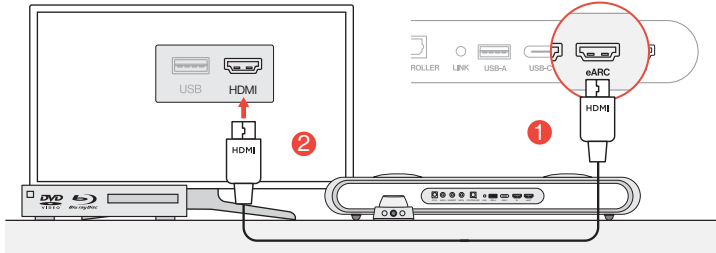

- 1 Einen der HDMI-Anschlüsse des Fernsehers oder Monitors an den HDMI OUT-Anschluss der Soundbar anschließen.

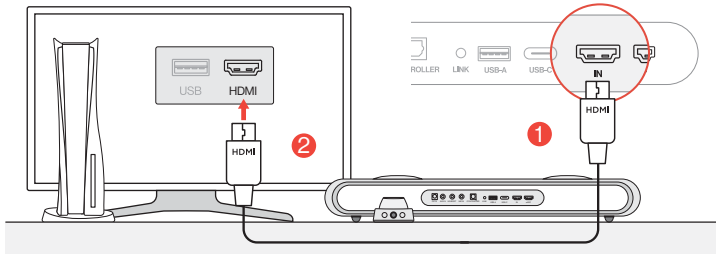

- 2 Einen der HDMI-Anschlüsse des PCs oder der Spielekonsole an den HDMI IN-Anschluss der Soundbar anschließen.

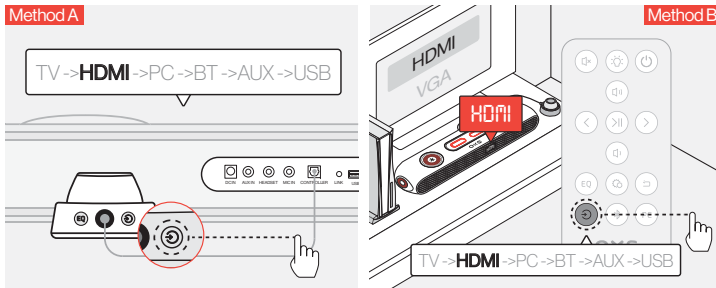

- 3 Den Audioeingang auf HDMI umschalten.

Anschluss über das USB-C-Kabel

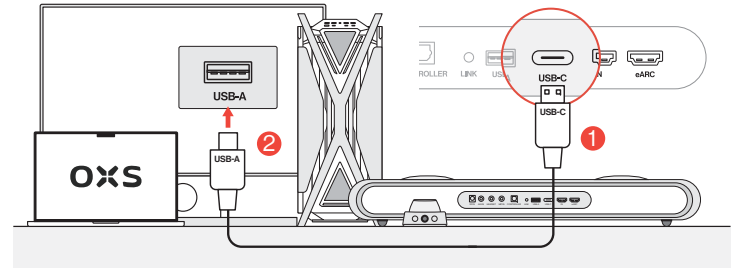

- 1 Die Soundbar mit dem mitgelieferten USB-A zu USB-C-Kabel an einen der USB-A-Anschlüsse Ihres PCs anschließen.

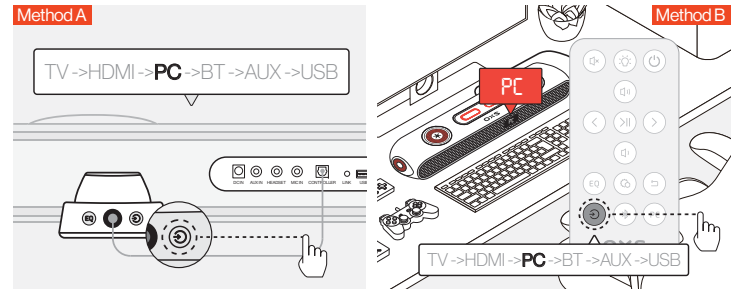

- 2 Den Audioeingang auf PC umschalten.

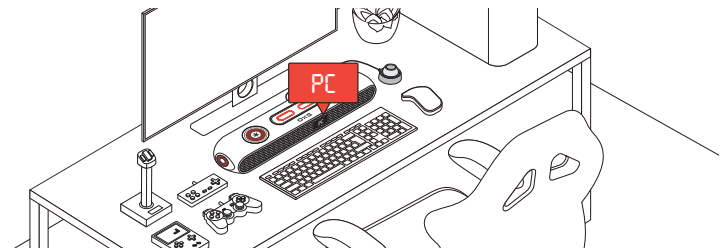

Anschluss über das analoge Kabel

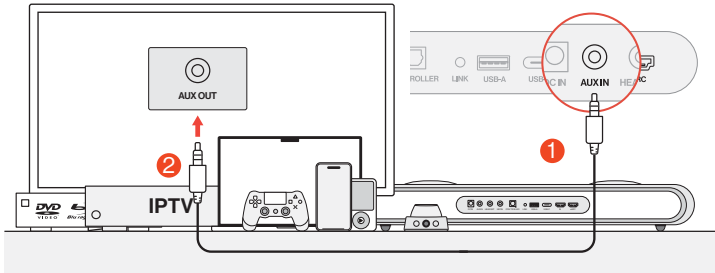

- 1 Das Gerät mit einem AUX-Kabel an die Soundbar anschließen.

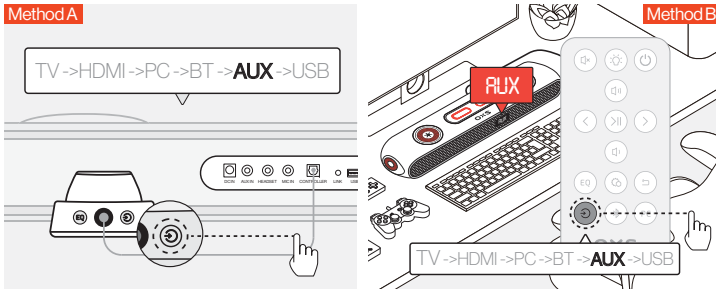

- 2 Den Audioeingang auf AUX umschalten.

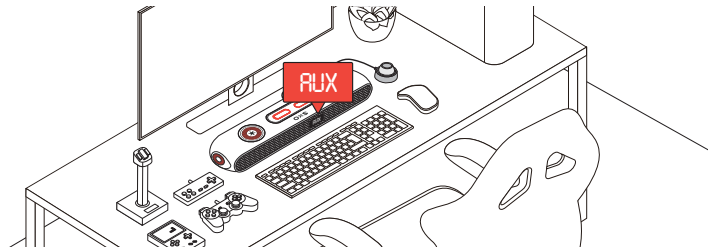

Anschluss über Bluetooth

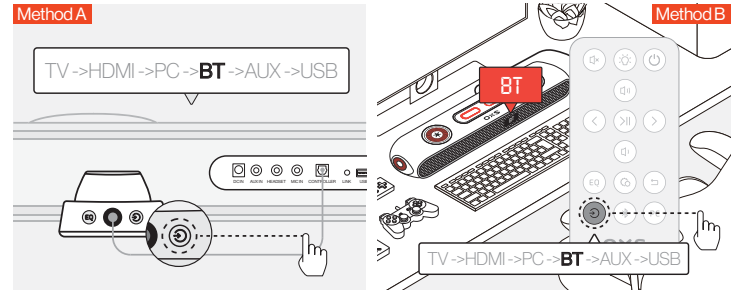

- 1 Den Audioeingang auf Bluetooth umschalten.

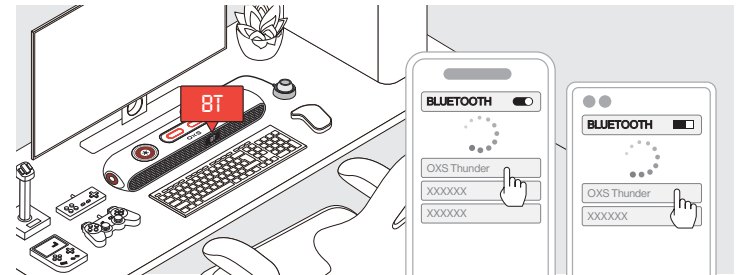

- 2 "OXs Thunder" auf dem Bildschirm des Geräts auswählen.

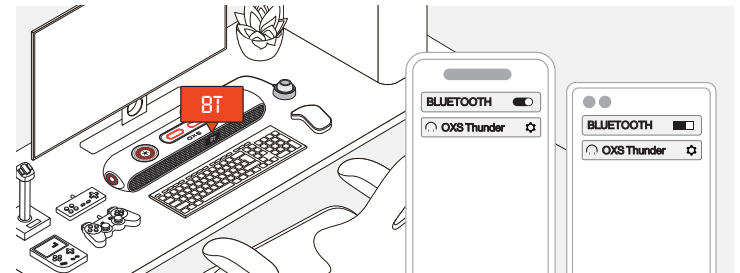

- 3 Nach dem erfolgreichen Anschluss bleibt die Anzeige „BT“ an der Soundbar stabil.

DEN LAUTSPRECHER ALS STANDARDGERÄT EINSTELLEN

Beim ersten Gebrauch der Soundbar ist die Einstellung des Geräts als Standard-Abspielgerät des Systems notwendig.

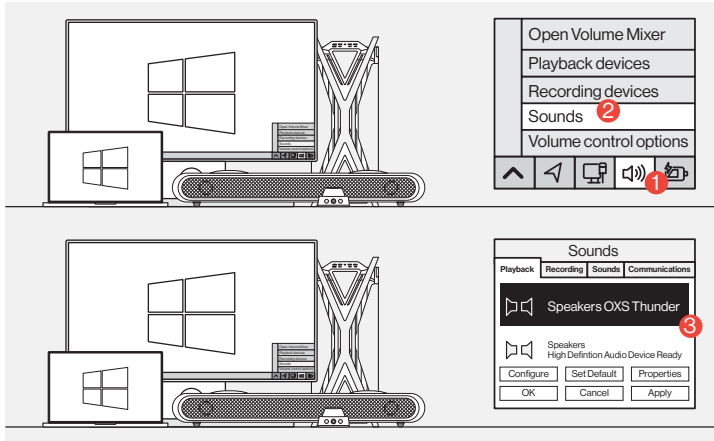

1 Für Windows-PC-Benutzer

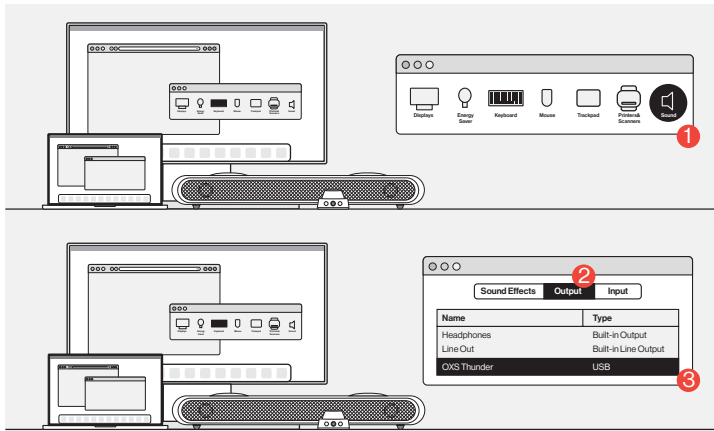

2 Für Mac-Benutzer

AKTIVIEREN VON DOLBY ATMOS

Bitte beachten Sie, dass Dolby Atmos nur über die HDMI-Ausgabe verfügbar ist. Wenn Sie die Soundbar zum ersten Mal verwenden, müssen Sie Dolby Atmos möglicherweise auf Ihrer Spielekonsole oder Ihrem PC aktivieren. Weitere Anweisungen finden Sie auf den folgenden Websites:

• <https://games.dolby.com/atmos/documentation/#Platforms>

CONTENIDO

CONTENIDO DEL EMBALAJE

• Disposición del Dispositivo

• Remoto

• Controlador

CONECTARSE A UNA FUENTE DE AUDIO

CÓMO USAR

• Conexión a través de HDMI eARC/ARC

• Conexión a través de HDMI IN

• Conexión a través del cable USB-C

• Conexión a través del cable analógico

• Conexión a través de Bluetooth

• Configurar el altavoz como dispositivo predeterminado

ACTIVAR DOLBY ATMOS

ESP - 02

ESP - 03

ESP - 05

ESP - 06

ESP - 07

ESP - 08

ESP - 08

ESP - 09

ESP - 10

ESP - 11

ESP - 12

ESP - 13

ESP - 14

CONTENIDO DEL EMBALAJE

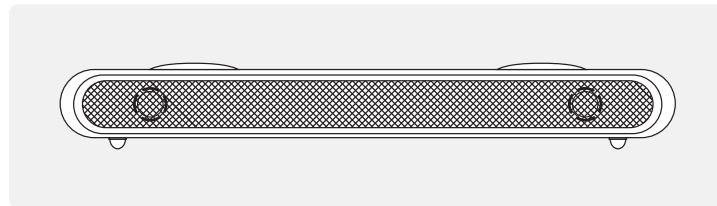

Barra de sonido OXS Thunder×1

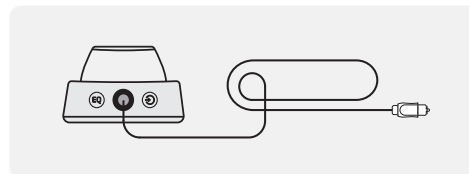

Controlador de alternancia×1



Patas desmontables para ajuste del ángulo de la barra de sonido

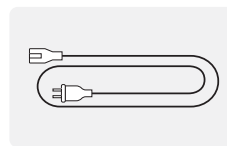

Cable de corriente×1

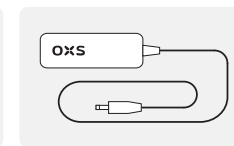

Adaptador de corriente×1

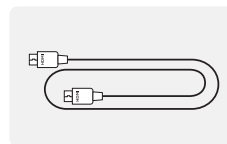

Cable HDMI×1

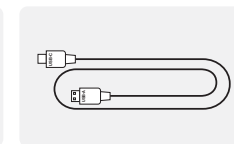

Cable USB A a C×1

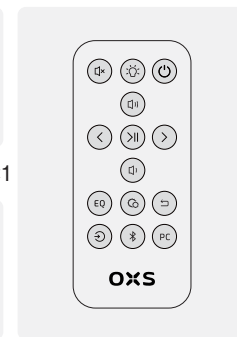

Control remoto

DISPOSICIÓN DEL DISPOSITIVO

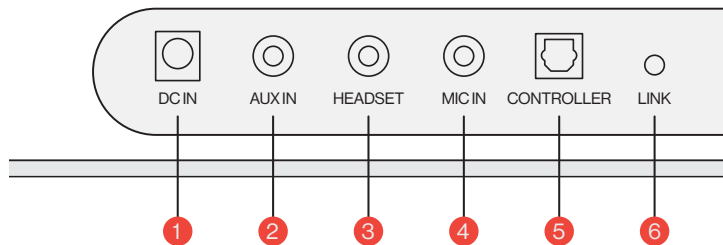
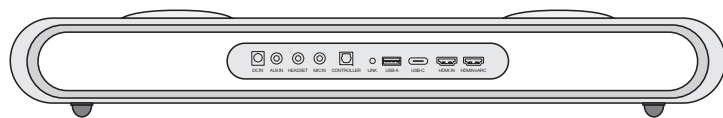

1	Fuente de alimentación		Encienda la barra de sonido usando el adaptador de corriente suministrado
2	AUX IN		Entrada de audio AUX
3	TOMA DE AURICULARES		Enchufe los auriculares a la barra de sonido para conectarse
4	TOMA DE MICRÓFONO		Conecte un micrófono externo a la barra de sonido mediante un cable estéreo de 3,5 mm
5	CONTROLADOR		Conecte el controlador de alternancia para controlar la barra de sonido
6	ENLACE		Presione para emparejar con el altavoz de cuello satelital OXS (se compra por separado)

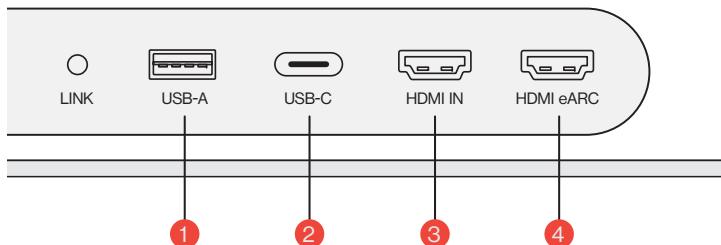
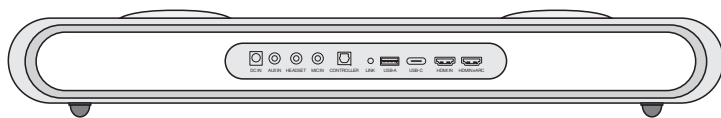

1	USB-A		Conecte el dongle para conectar el altavoz de cuello satelital OXS (se compra por separado)
2	USB-C		Conecte un cable USB (tipo C) para conectar la barra de sonido a la PC
3	HDMI IN		Conecte un cable HDMI para conectar la barra de sonido al monitor de juegos o a la PC
4	HDMI eARC		Conecte un cable HDMI para conectar la barra de sonido a la consola de juegos

REMOTO

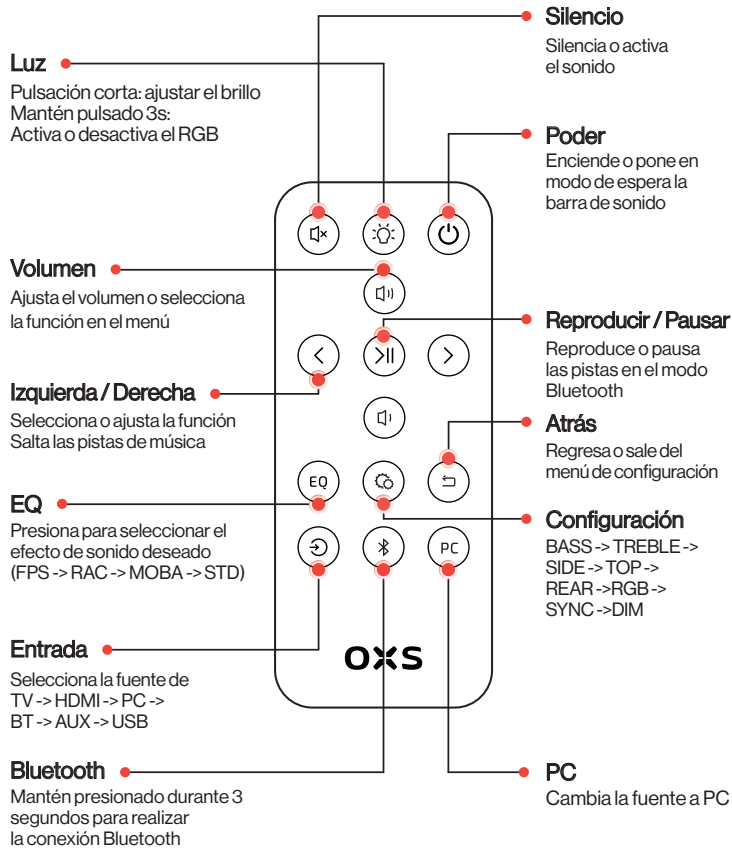

CONTROLADOR

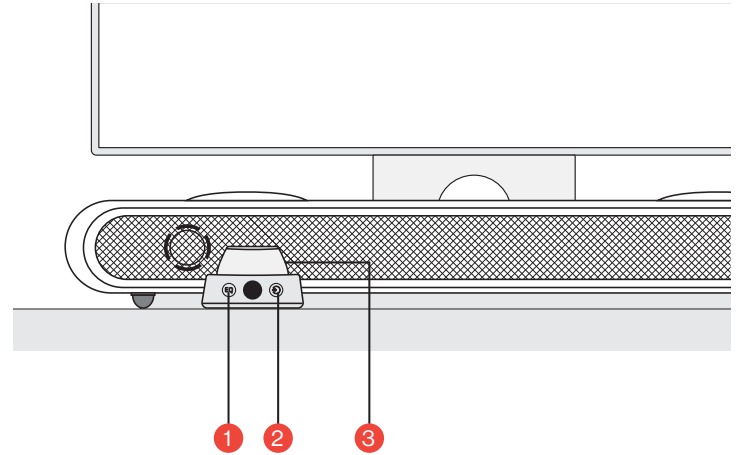

1	EQ		Presiona para seleccionar el efecto de sonido deseado (FPS -> RAC -> MOBA -> STD)
2	Entrada		Selecciona la fuente de TV -> HDMI -> PC -> BT -> AUX -> USB
3	Botón principal		Presionar y mantener durante 3 segundos Encender o poner en espera la barra de sonido
			Presionar una vez Silenciar la barra de sonido
			Gire para ajustar el volumen

CÓMO USAR

Configuración



2 Ajuste de altura

El par adicional de patas desmontables te permite cambiar la altura de la barra de sonido para asegurar que el sonido se entregue con la menor cantidad de obstrucciones. Dependiendo de la orientación de las patas, puedes configurar la barra de sonido en un ángulo plano o elevado.

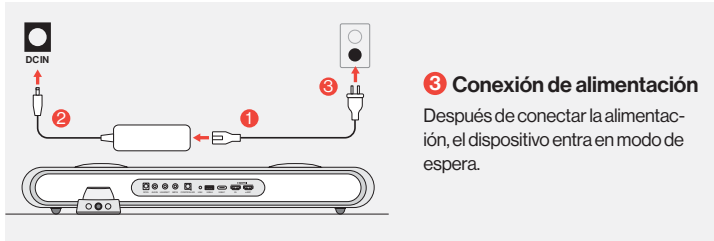
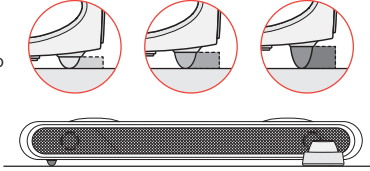

4 Encendido

Encienda la barra de sonido manteniendo presionado el botón.

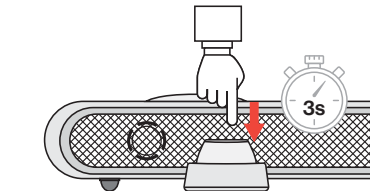

CONECTARSE A UNA FUENTE DE AUDIO

Conexión a través de HDMI eARC/ARC

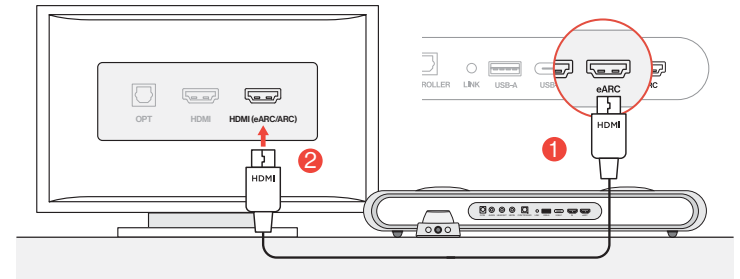

- 1 Conecta la barra de sonido a cualquiera de los puertos HDMI (eARC/ARC) de tu televisor utilizando el cable HDMI incluido.

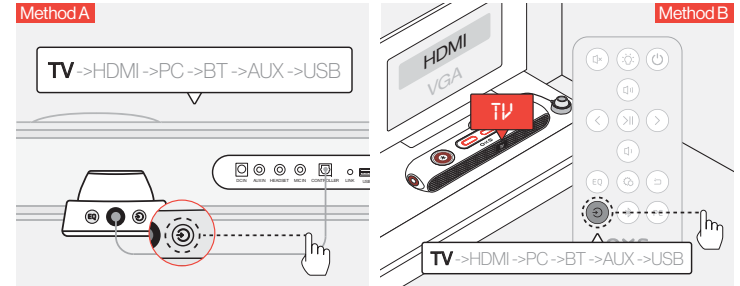

- 2 Cambia la entrada de audio a "TV".

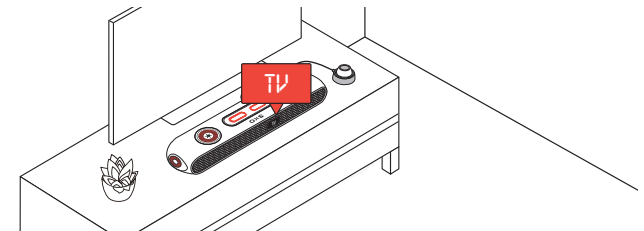

Conexión a través de HDMI IN

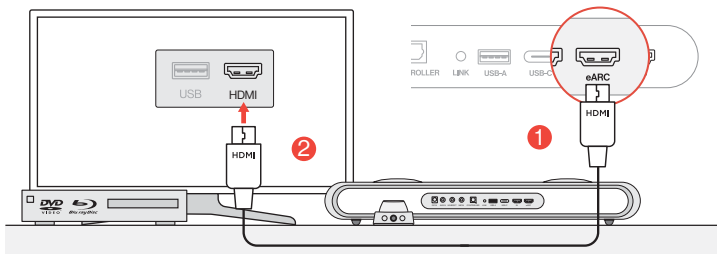

- 1 Conecta cualquiera de los puertos HDMI de tu televisor o monitor al puerto HDMI OUT de la barra de sonido.

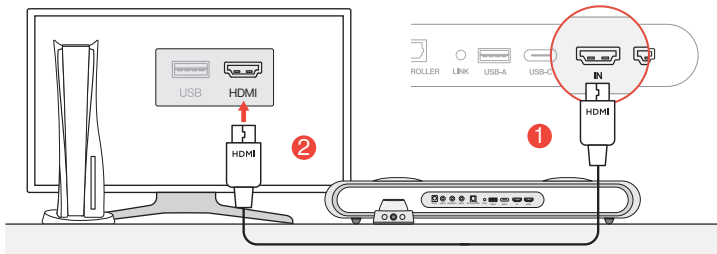

- 2 Conecta cualquiera de los puertos HDMI de tu PC o consola de juegos al puerto HDMI IN de la barra de sonido.

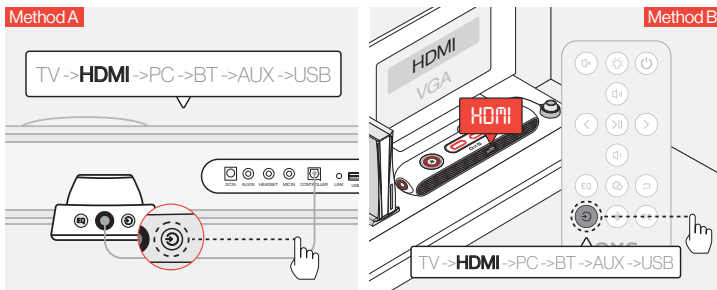

- 3 Cambia la entrada de audio a HDMI.

Conexión a través del cable USB-C

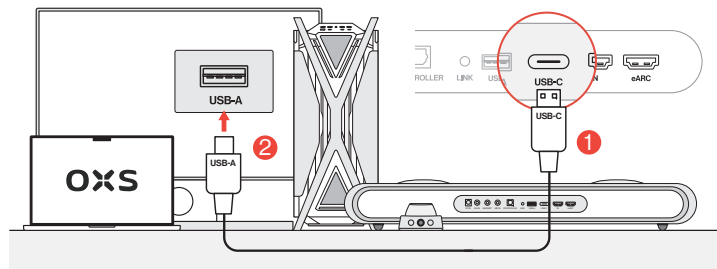

- 1 Conecta la barra de sonido a cualquiera de los puertos USB-A de tu PC utilizando el cable USB-C a USB-A incluido.

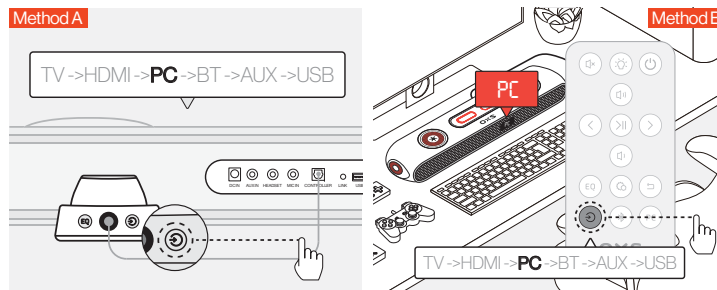

- 2 Cambia la entrada de audio al PC.

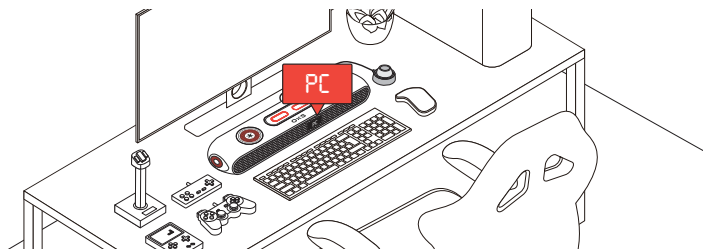

Conexión a través del cable analógico

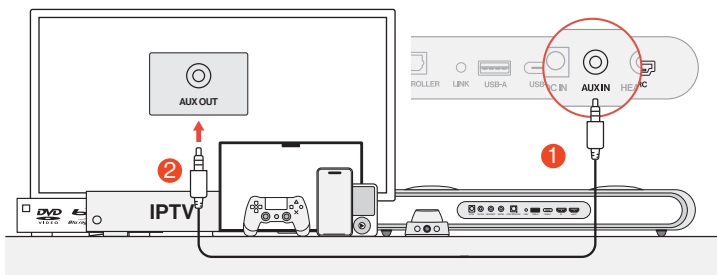

- 1 Conecta el dispositivo y la barra de sonido utilizando un cable AUX.

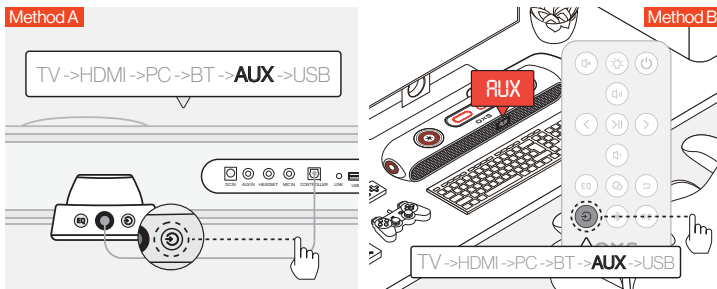

- 2 Cambia la entrada de audio a AUX.

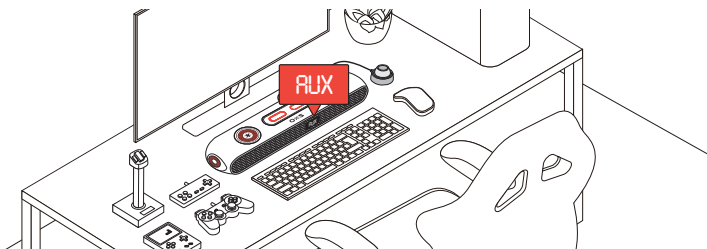

Conexión a través de Bluetooth

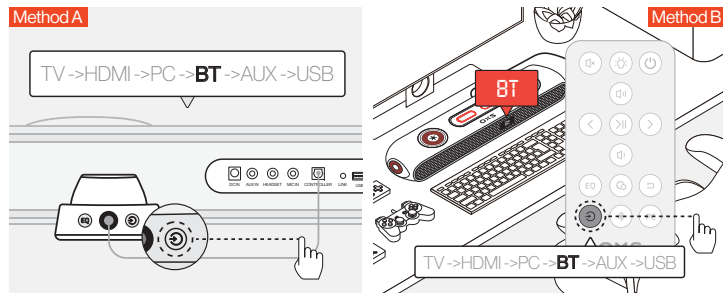

- 1 Cambia la entrada de audio a Bluetooth.

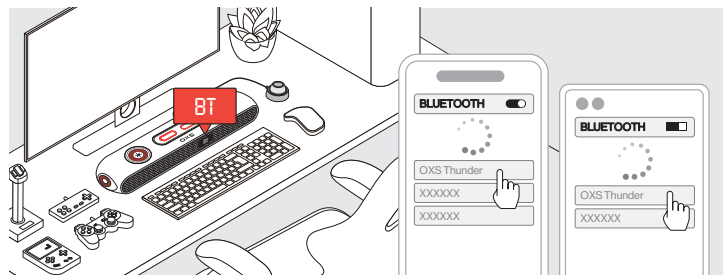

- 2 Selecciona "OXS Thunder" en la pantalla del dispositivo.

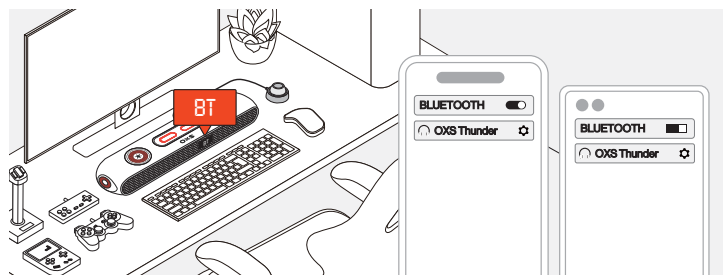

- 3 Una vez que la conexión se establezca correctamente, el indicador "BT" en la barra de sonido se mantendrá estable.

CONFIGURAR EL ALTAVOZ COMO DISPOSITIVO PREDETERMINADO

Si estás utilizando la barra de sonido por primera vez, es posible que debas configurar el dispositivo como dispositivo de reproducción predeterminado de tu sistema.

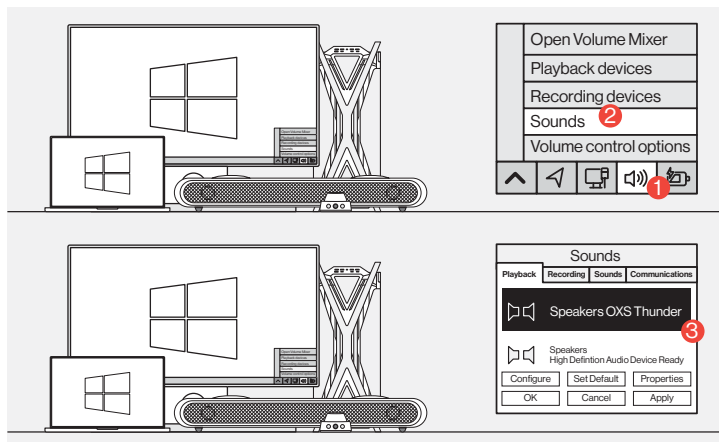

1 Para usuarios de PC con Windows

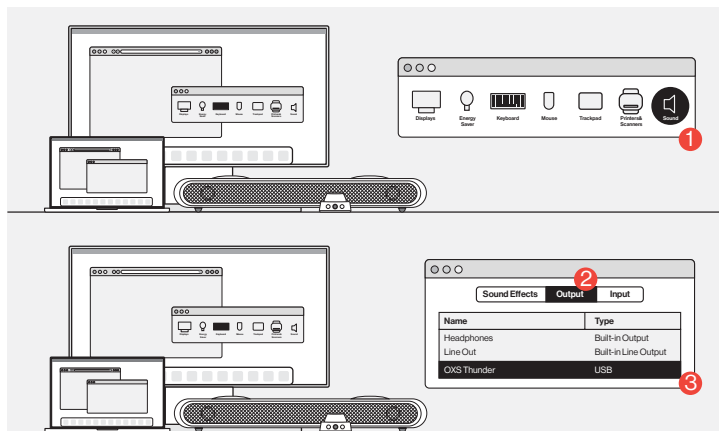

2 Para usuarios de Mac

ACTIVAR DOLBY ATMOS

Tenga en cuenta que Dolby Atmos solo está disponible a través de la salida HDMI. Si está utilizando la barra de sonido por primera vez, es posible que deba habilitar Dolby Atmos en su consola de juegos o PC. Para obtener más instrucciones, visite los siguientes sitios web:

• <https://games.dolby.com/atmos/documentation/#Platforms>

СОДЕРЖАНИЕ

ЧТО ВНУТРИ

- Схема устройства
- Дистанционное
- управляющее устройство

КАК ИСПОЛЬЗОВАТЬ

ПОДКЛЮЧЕНИЕ К ИСТОЧНИКУ АУДИОСИГНАЛА

- Подключение через HDMI eARC/ARC
- Подключение через HDMI IN
- Подключение через кабель USB-C
- Подключение через аналоговый кабель
- Подключение через Bluetooth
- Настройка динамика как устройства по умолчанию

ВКЛЮЧЕНИЕ DOLBY ATMOS

RU - 02

RU - 03

RU - 05

RU - 06

RU - 07

RU - 08

RU - 08

RU - 09

RU - 10

RU - 11

RU - 12

RU - 13

RU - 14

ЧТО ВНУТРИ

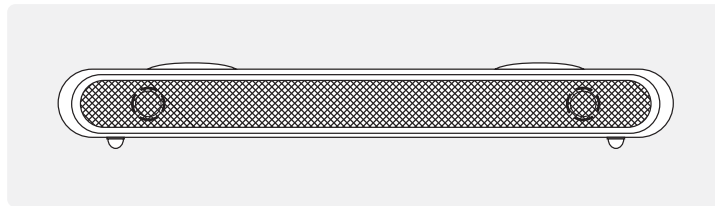

Звуковая панель OXS Thunder×1

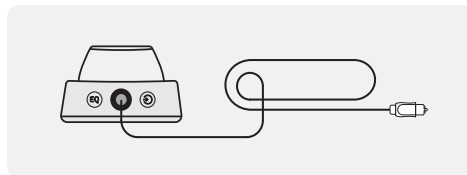

Контроллер переключения×1



Съемные ножки для регулировки угла звуковой панели

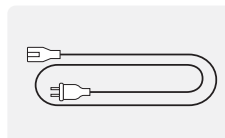

Силовой кабель×1

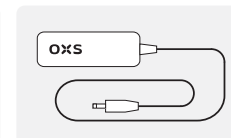

Адаптер питания×1

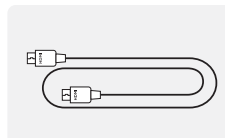

Кабель HDMI×1

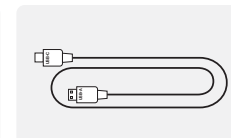

Кабель USB A к C×1

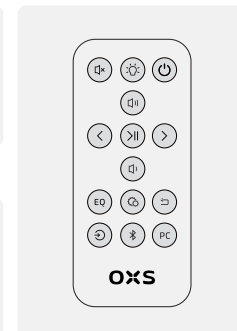

Пульт дистанционного управления

СХЕМА УСТРОЙСТВА

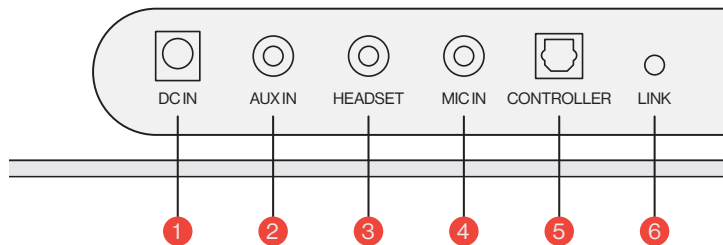
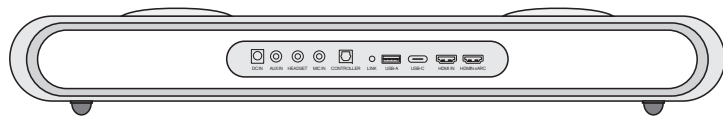

1	Питание		Включите звуковую панель, используя прилагаемый адаптер питания
2	AUX IN		Аудиовход AUX
3	РАЗЪЕМ ДЛЯ НАУШНИКОВ		Подключите кабель наушников, чтобы подключить их к звуковой панели
4	РАЗЪЕМ ДЛЯ МИКРОФОНА		Подключите внешний микрофон к звуковой панели с помощью стереокабеля 3,5 мм
5	КОНТРОЛЛЕР		Нажмите, чтобы связать спутниковый гарнитур OXS (приобретается отдельно)
6	ССЫЛКА		Presione para emparejar con el altavoz de cuello satelital OXS (se compra por separado)

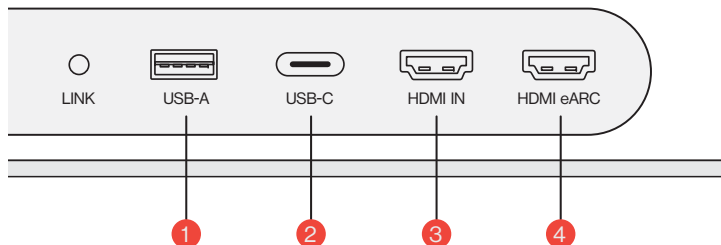
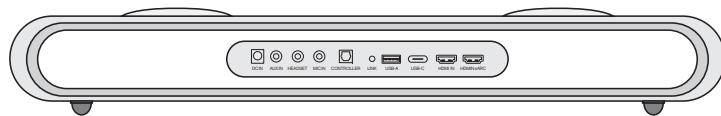

1	USB-A		Подключите докнг, чтобы подключить спутниковый гарнитур OXS (приобретается отдельно)
2	USB-C		Подключите кабель USB (тип C) чтобы подключить звуковую панель к компьютеру
3	HDMI IN		Подключите кабель HDMI, чтобы соединить звуковую панель с игровым монитором или компьютером
4	HDMI eARC		Подключите кабель HDMI, чтобы соединить звуковую панель с игровой консолью

ДИСТАНЦИОННОЕ

Свет

Короткое нажатие: регулировка яркости
Нажмите и удерживайте 3 с: включение или выключение RGB

Громкость

Регулирует громкость или выбирает функцию в меню

Влево / Вправо

Выбирает или устанавливает функцию. Пропускает музыкальные треки

EQ

Нажмите, чтобы выбрать желаемый звуковой эффект (FPS -> RAC -> MOBA -> STD)

Вход

Выбирает источник с TV -> HDMI -> PC -> BT -> AUX -> USB

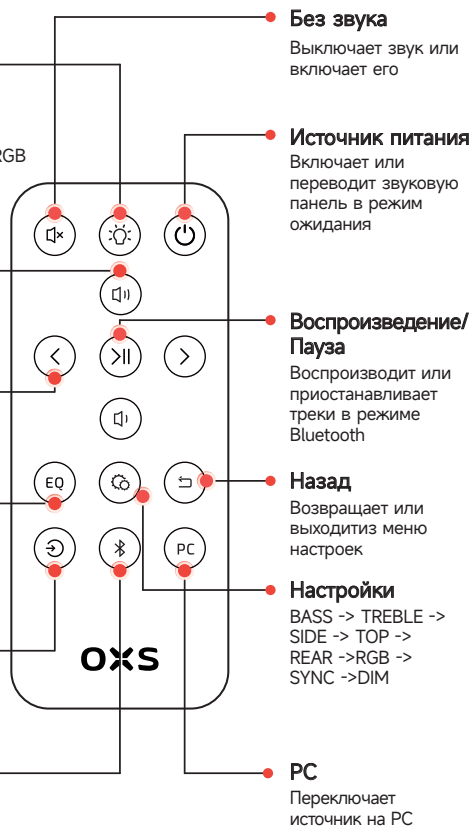

Bluetooth

Нажмите и удерживайте 3 секунды для установки соединения Bluetooth

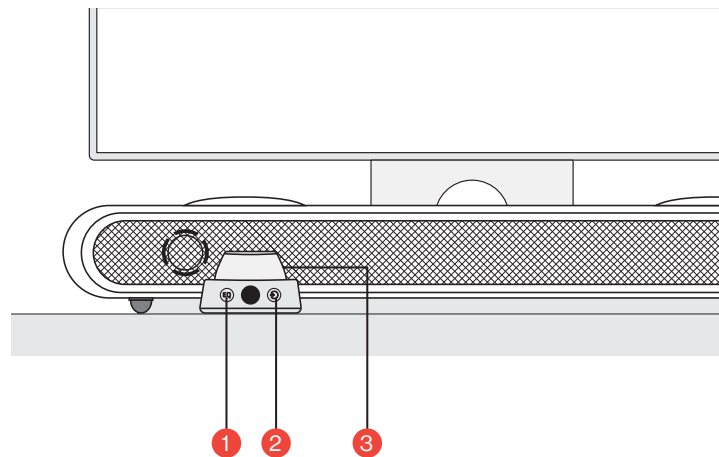

УПРАВЛЯЮЩЕЕ УСТРОЙСТВО



1	EQ (эквалайзер) 	Нажмите, чтобы выбрать желаемый звуковой эффект (FPS -> RAC -> MOBA -> STD)
2	Input (вход) 	Выбирает источник с TV -> HDMI -> PC -> BT -> AUX -> USB
3	Главная кнопка 	Удерживать нажатой кнопку в течение 3 секунд Включить или перевести звуковую панель в режим ожидания
		Однократное нажатие Отключить звук на звуковой панели
		Повернуть, чтобы настроить объем

КАК ИСПОЛЬЗОВАТЬ

Настройка

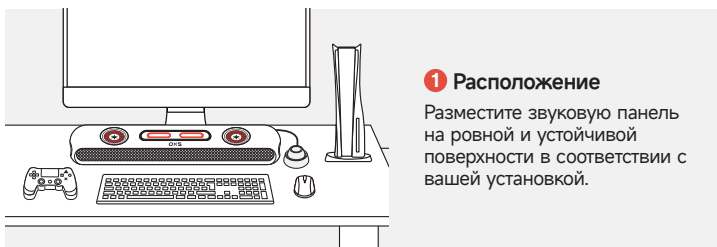

2 Регулировка высоты

Дополнительная пара съемных ножек позволяет вам изменить высоту звуковой панели, чтобы звук доставлялся с минимальными помехами. В зависимости от ориентации ножек, вы можете установить звуковую панель в плоском или поднятом углу.

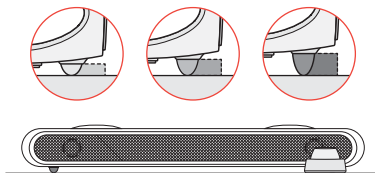

4 Включение питания

Включите звуковую панель, удерживая кнопку нажатой.

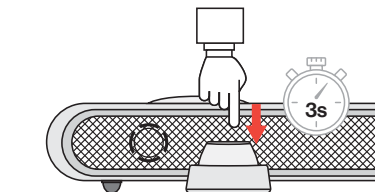

RU-07

ПОДКЛЮЧЕНИЕ К ИСТОЧНИКУ АУДИОСИГНАЛА

Подключение через HDMI eARC/ARC

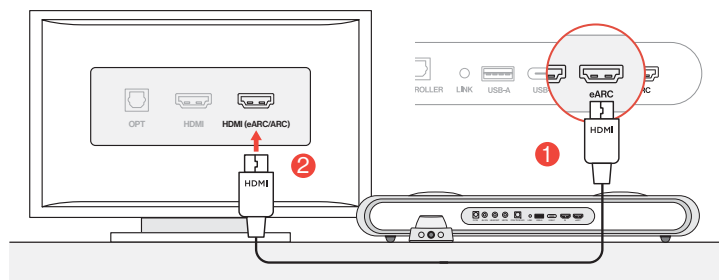

- 1 Подключите звуковую панель к любому из портов HDMI (eARC/ARC) на вашем телевизоре, используя прилагаемый HDMI-кабель.

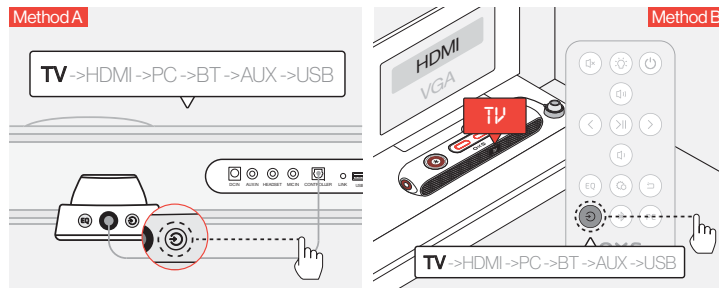

- 2 Переключите аудиовход на "TV" (ТВ).

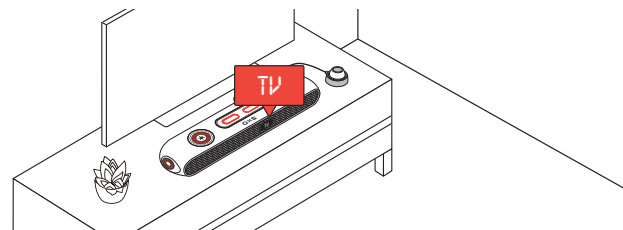

RU-08

Подключение через HDMI IN

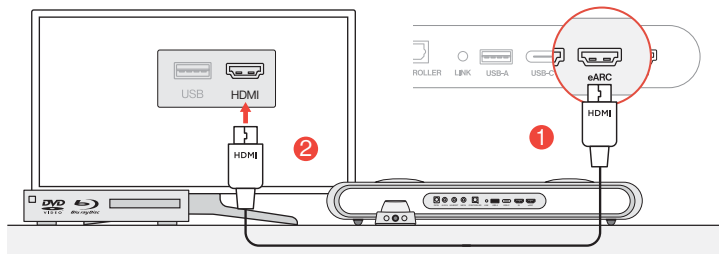

- 1 Подключите любой из HDMI-портов вашего телевизора или монитора к порту HDMI OUT звуковой панели.

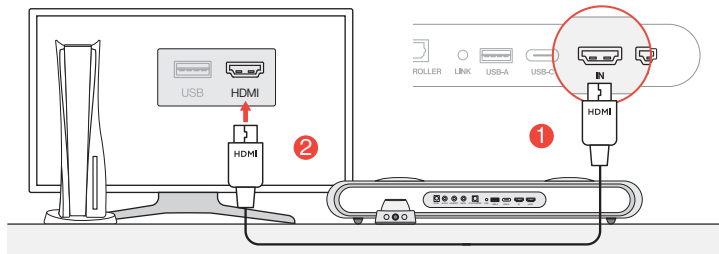

- 2 Подключите любой из HDMI-портов вашего компьютера или игровой приставки к порту HDMI IN звуковой панели.

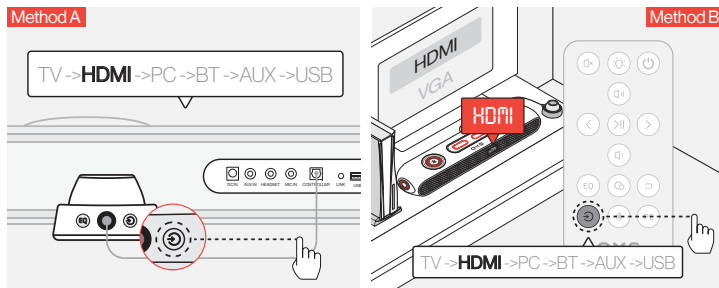

- 3 Переключите аудиовход на HDMI.

Подключение через кабель USB-C

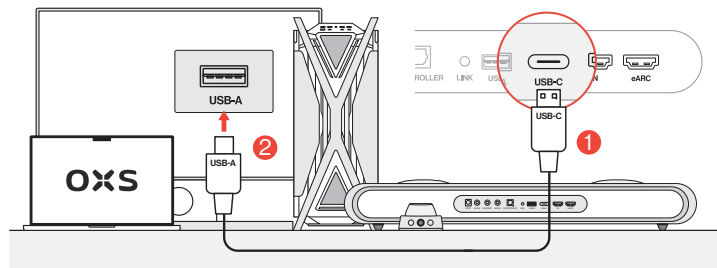

- 1 Подключите звуковую панель к любому из USB-A портов вашего компьютера с помощью прилагаемого кабеля USB-C to USB-A.

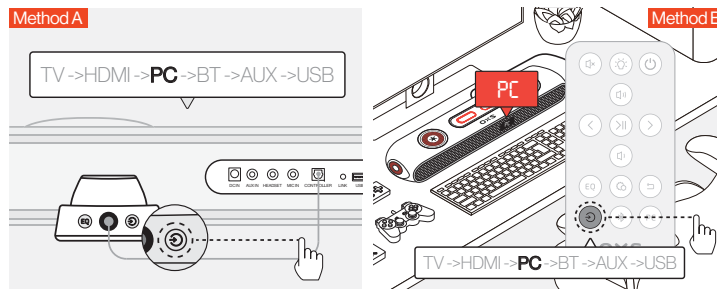

- 2 Переключите аудиовход на компьютер.

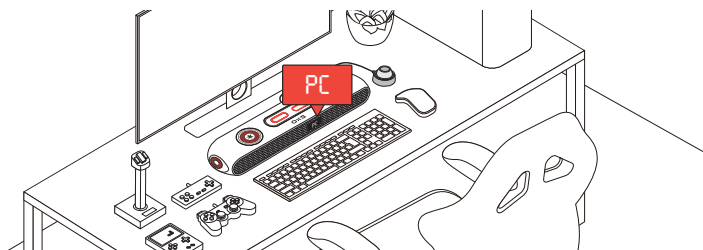

Подключение через аналоговый кабель

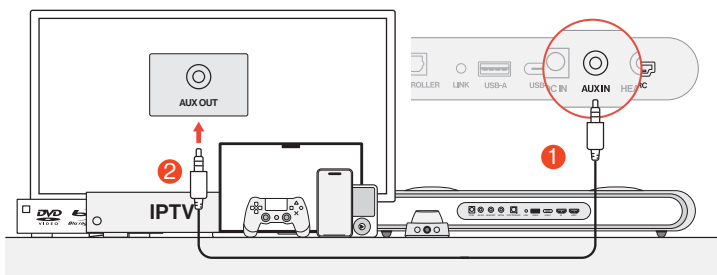

- 1 Подключите устройство и звуковую панель с помощью аудио-кабеля AUX.

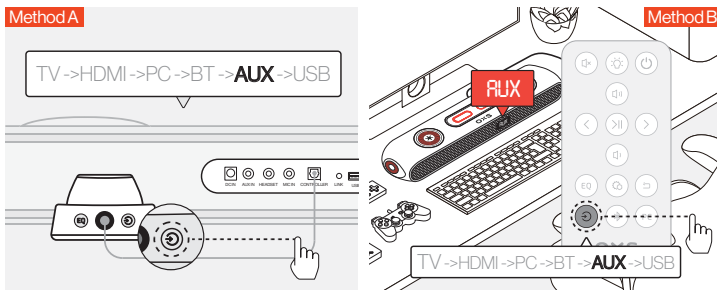

- 2 Переключите аудиовход на AUX.

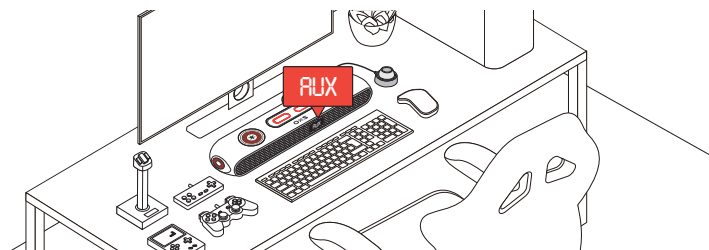

Подключение через Bluetooth

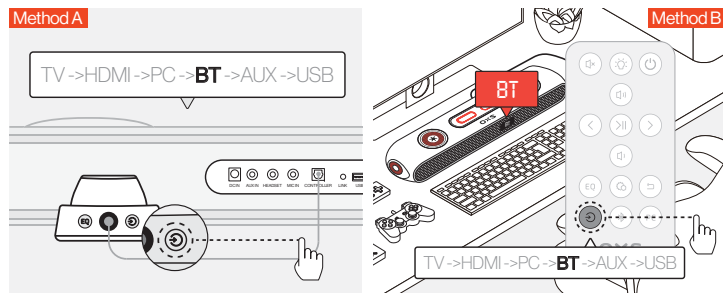

- 1 Переключите аудиовход на Bluetooth.

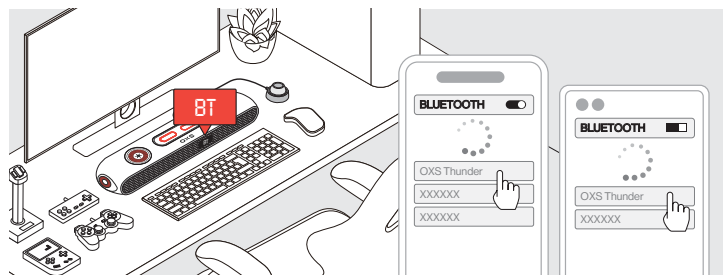

- 2 Выберите "OXS Thunder" на экране устройства.

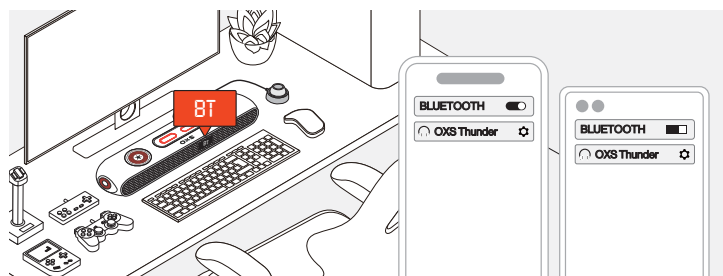

- 3 После успешного подключения индикатор "BT" на звуковой панели будет гореть постоянно.

НАСТРОЙКА ДИНАМИКА КАК УСТРОЙСТВА ПО УМОЛЧАНИЮ

Если вы используете звуковую панель впервые, вам может потребоваться настроить устройство как основное устройство воспроизведения для вашей системы.

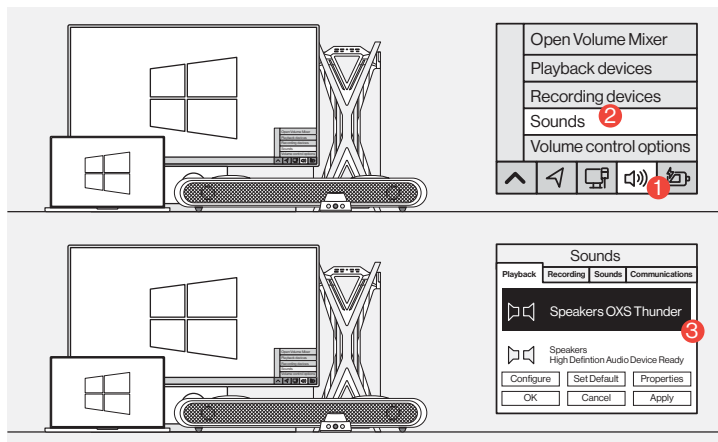

1 Для пользователей ПК с Windows

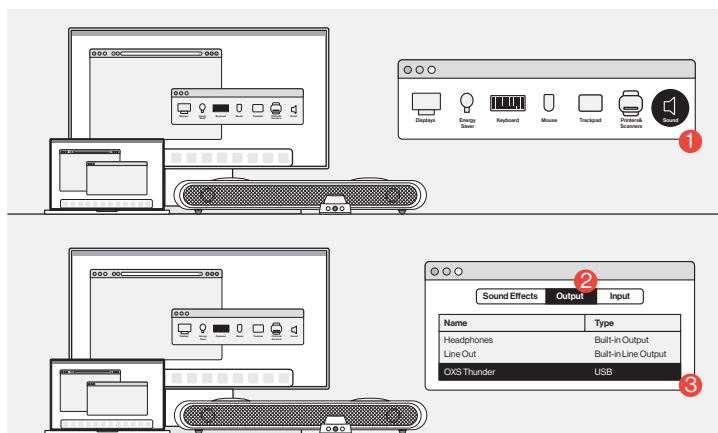

2 Для пользователей Mac

ВКЛЮЧЕНИЕ DOLBY ATMOS

Обратите внимание, что Dolby Atmos доступен только через выход HDMI. Если вы используете звуковую панель впервые, вам может потребоваться включить Dolby Atmos на вашей игровой приставке или ПК. Дополнительные инструкции можно найти на следующих веб-сайтах:

• <https://games.dolby.com/atmos/documentation/#Platforms>

目录

包装内含

- 设备布局 zhCN - 02
- 遥控 zhCN - 03
- 线控 zhCN - 05
- 线控 zhCN - 06

操作指南

连接音频源

- 通过HDMI eARC/ARC连接 zhCN - 08
- 通过HDMI IN连接 zhCN - 08
- 通过USB-C电缆连接 zhCN - 09
- 通过模拟电缆连接 zhCN - 10
- 通过蓝牙连接 zhCN - 11
- 通过蓝牙连接 zhCN - 12
- 将音箱设置为默认设备 zhCN - 13
- 将音箱设置为默认设备 zhCN - 13

启用杜比全景声

zhCN - 14

包装内含

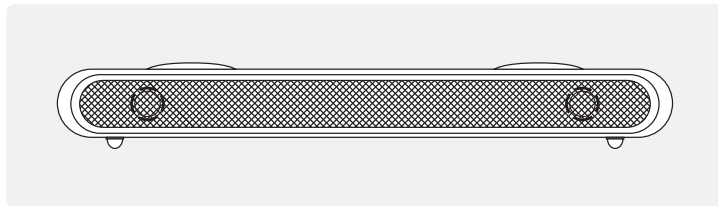

OXS Thunder 游戏音箱×1

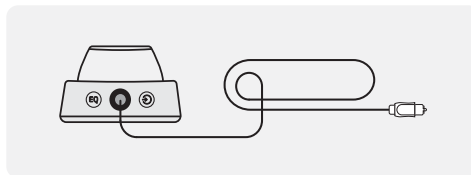

有线控制器×1



可拆卸的脚垫
用于调整音箱角度

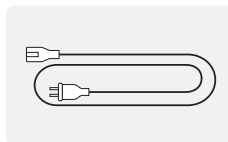

电源电缆×1

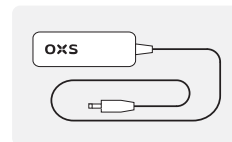

电源适配器×1

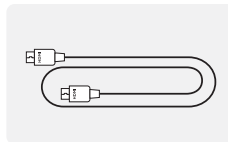

HDMI 线×1

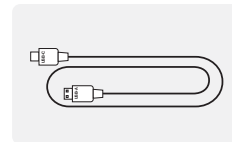

USB A 转 C 线×1



遥控器

设备布局

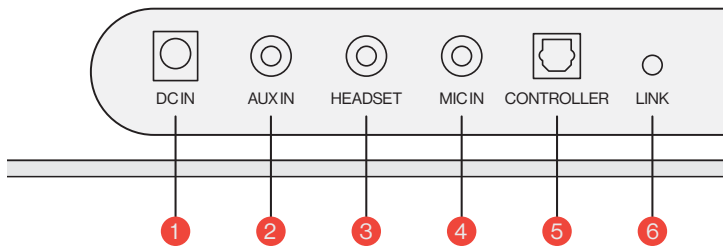
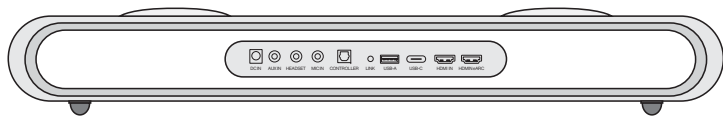

1	电源		使用提供的电源适配器为音响供电
2	AUX 输入		AUX 音频输入
3	耳机插孔		将耳机插入音箱进行连接
4	麦克风插孔		通过3.5毫米立体声电缆将外部麦克风连接到音箱
5	有线控制器		插入有线控制器以控制音箱
6	连接		按下以与OXS卫星颈部扬声器配对 (单独购买)

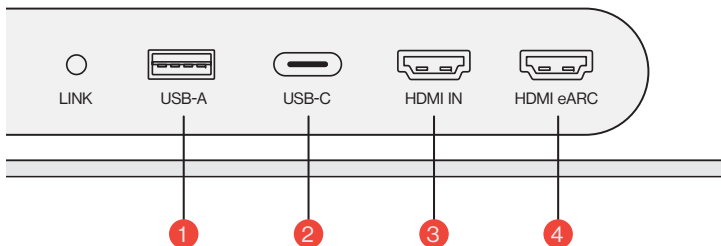
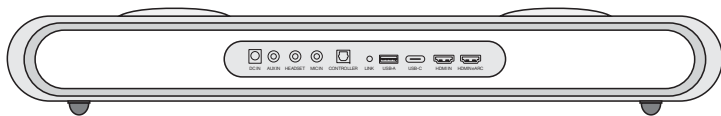



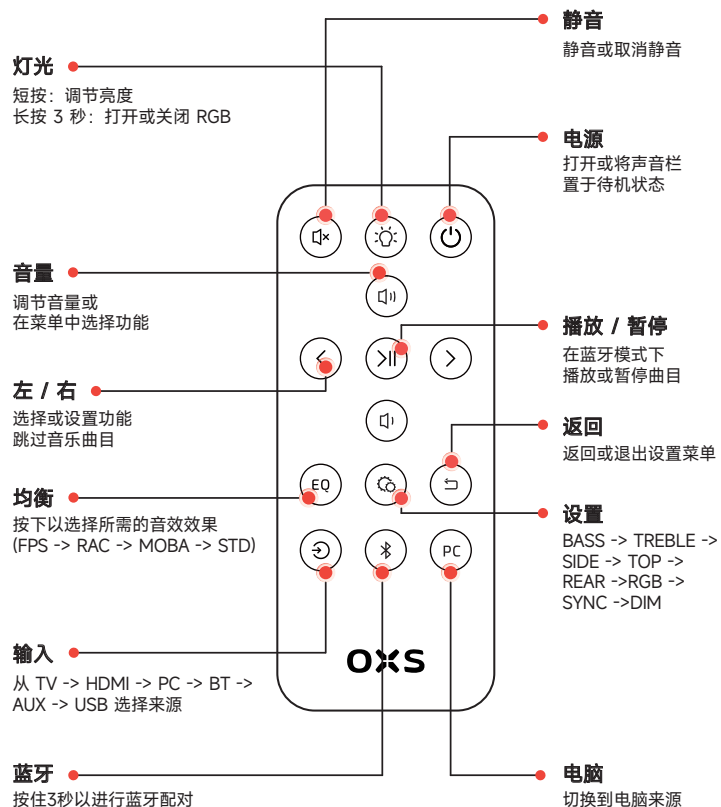

1	USB-A		插入适配器将OXS卫星颈部扬声器连接 (单独购买)
2	USB-C		插入USB (C型) 线将音箱连接到电脑
3	HDMI 输入		插入HDMI线将音箱连接到显示器或电脑
4	HDMI eARC		插入HDMI线将音箱连接到游戏主机

遥控

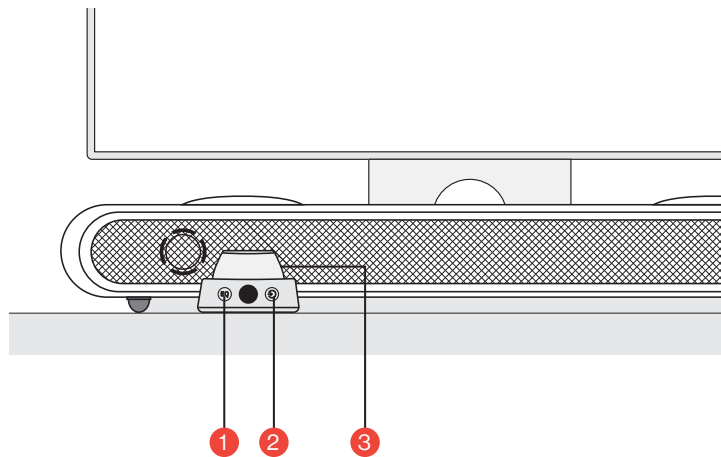

线控



1	EQ (均衡器) 	按下以选择所需的音效效果 (FPS -> RAC -> MOBA -> STD)
2	输入 	从 TV -> HDMI -> PC -> BT -> AUX -> USB 选择来源
3	主按钮 	长按3秒钟 开启或将音箱置于待机状态
		短按 将音箱静音
		旋转调节音量

操作指南

设置



2 调整高度

额外的可拆卸脚架可以让您调整音箱的高度，以确保声音传递时最少受到阻碍。根据脚架的方向，您可以将音响栏设置为平放或提高角度。

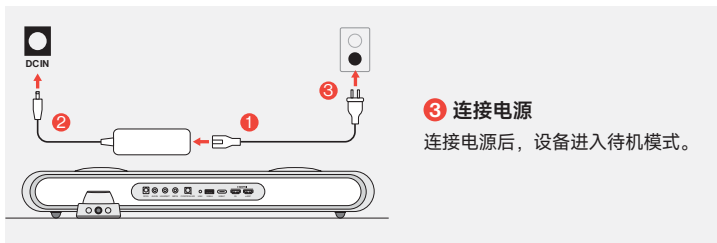
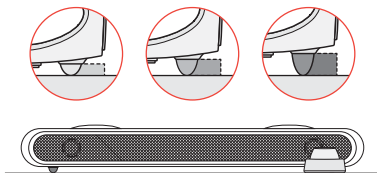

4 开机

通过长按按钮开启音箱。

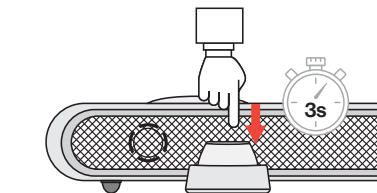

连接音频源

通过HDMI eARC/ARC连接

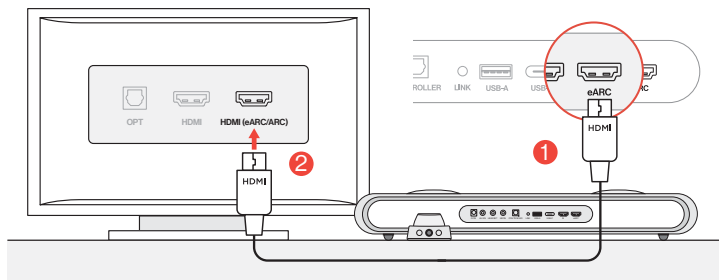

1 使用附带的HDMI线将音箱连接到电视上的任意一个HDMI (eARC/ARC)端口。

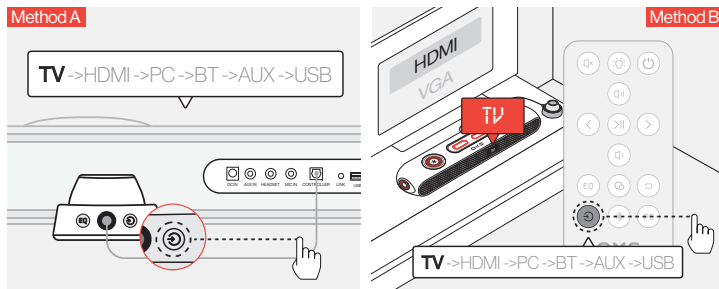

2 将音频输入切换到"TV" (电视)。

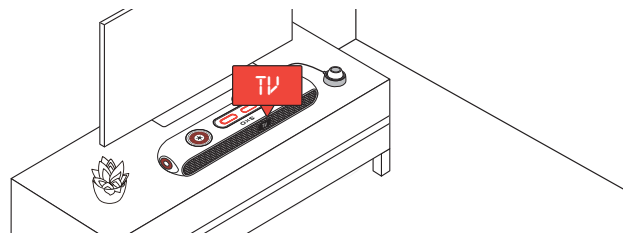

通过HDMI IN连接

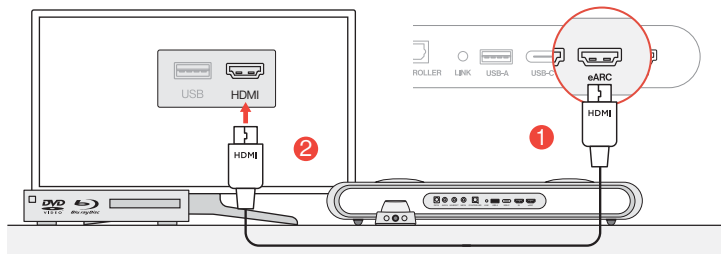

① 将电视或显示器上的任意HDMI端口连接到音箱的HDMI OUT端口。

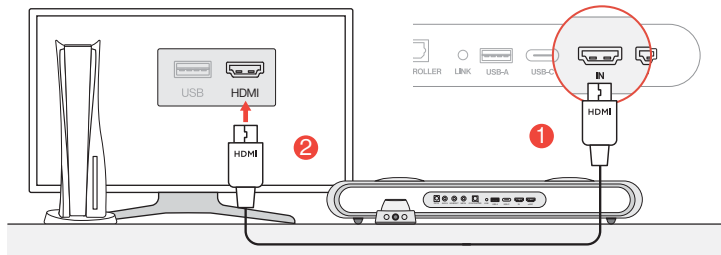

② 将个人电脑或游戏主机上的任意HDMI端口连接到音箱的HDMI IN端口。

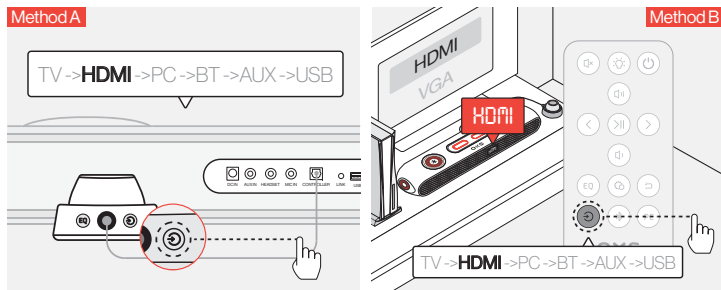

③ 将音频输入切换到HDMI。

通过USB-C电缆连接

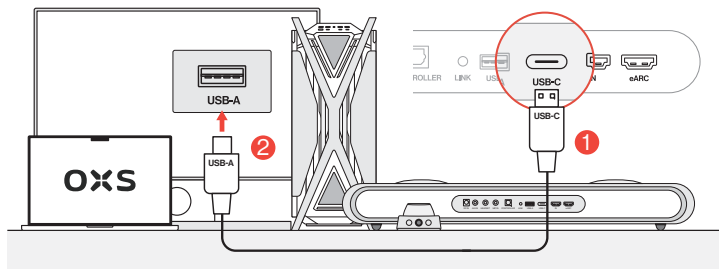

① 使用附带的USB-C至USB-A电缆，将音箱连接到您的个人电脑上的任意USB-A端口。

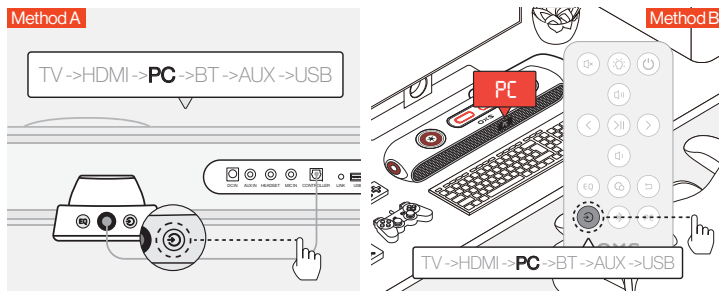

② 将音频输入切换到个人电脑。

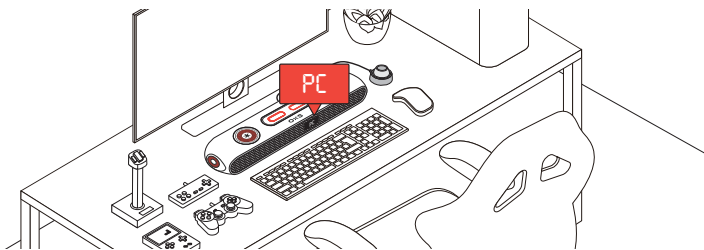

通过模拟电缆连接

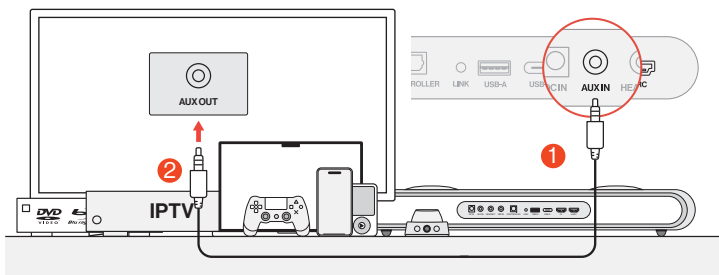

- 1 使用AUX电缆将设备和音箱连接起来。

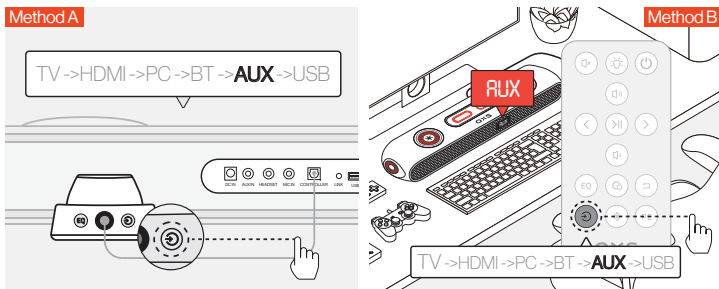

- 2 将音频输入切换到AUX。

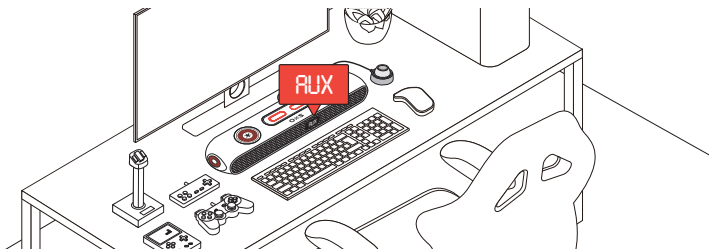

通过蓝牙连接

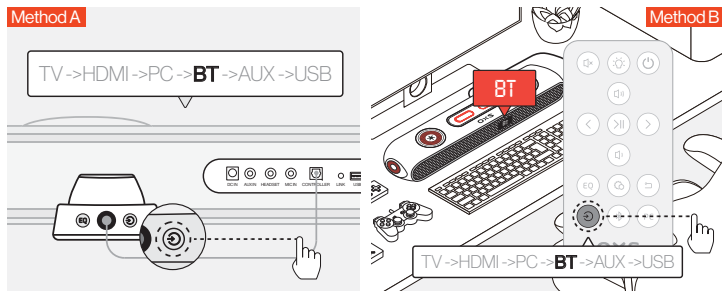

- 1 将音频输入切换到蓝牙。

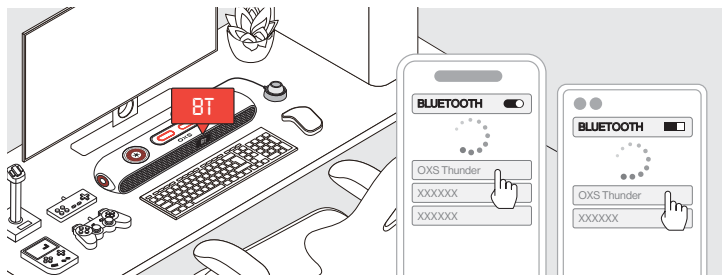

- 2 在设备屏幕上选择“OXS Thunder”。

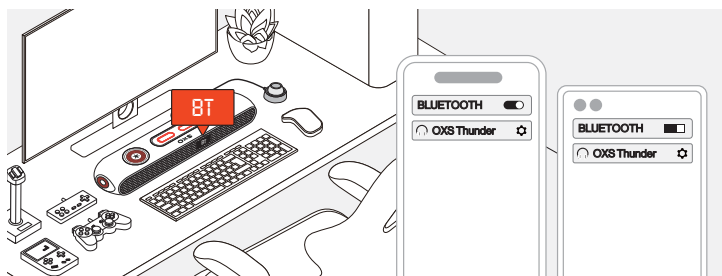

- 3 成功连接后，音箱上的“BT”指示灯将保持稳定。

将音箱设置为默认设备

如果您是第一次使用该音箱，可能需要将其设置为系统的默认播放设备。

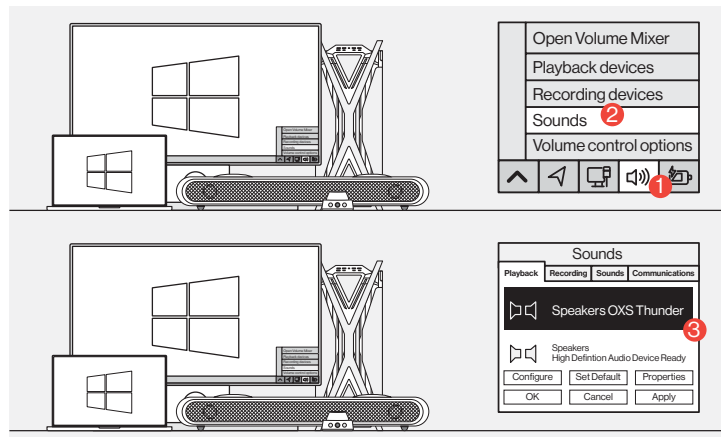

① 对于Windows PC用户

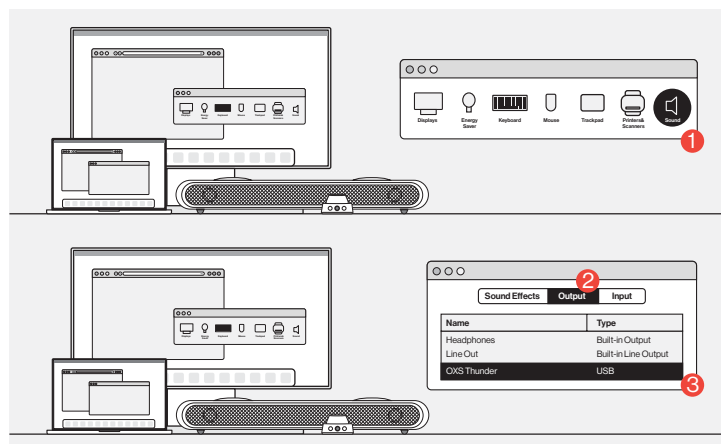

② 对于MAC用户

启用杜比全景声

请注意，杜比全景声只能通过HDMI输出使用。如果您是第一次使用该音箱，可能需要在游戏机或电脑上启用杜比全景声。更多相关说明，请访问以下网站：

• <https://games.dolby.com/atmos/documentation/#Platforms>

目錄

包裝內含

- 設備佈局
- 遙控
- 線控

操作指南

連接音頻源

- 通過HDMI eARC/ARC連接
- 通過HDMI IN連接
- 通過USB-C電纜連接
- 通過模擬電纜連接
- 通過藍牙連接
- 將音箱設置為預設裝置

啟用杜比全景聲

twCN - 02

twCN - 03

twCN - 05

twCN - 06

twCN - 07

twCN - 08

twCN - 08

twCN - 09

twCN - 10

twCN - 11

twCN - 12

twCN - 13

twCN - 14

包裝內含

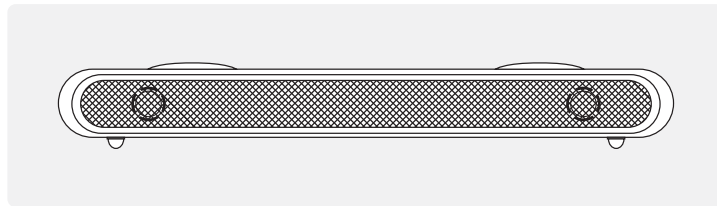

OXS Thunder 遊戲音箱×1

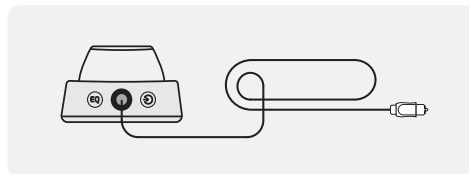

有線控制器×1



可拆卸的腳墊
用於調整音箱角度

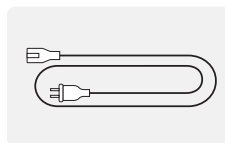

電源電纜×1

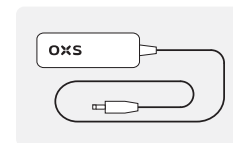

電源適配器×1

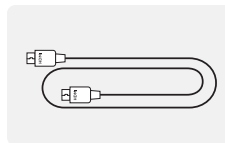

HDMI 線×1

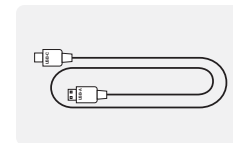

USB A 轉 C 線×1

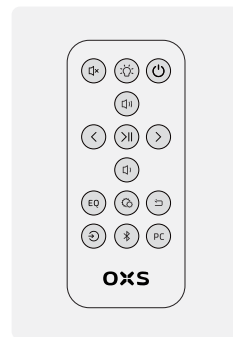



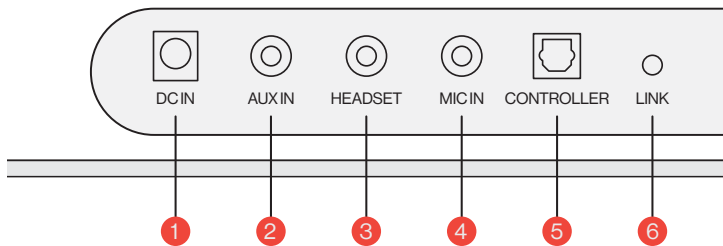
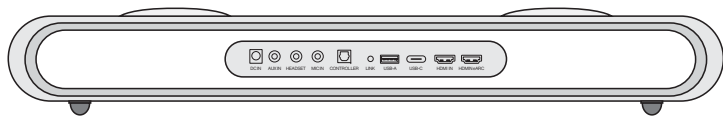

遙控器

設備佈局

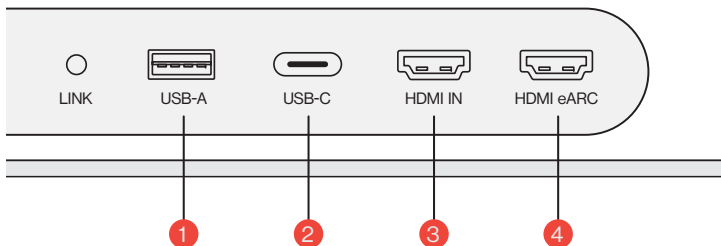
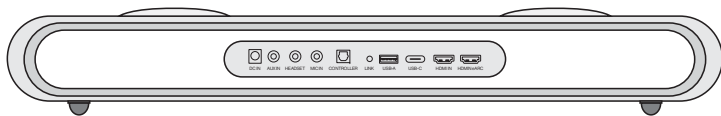

1	電源		使用提供的電源適配器為音箱供電
2	AUX 輸入		AUX 音頻輸入
3	耳機插孔		將耳機插入音箱進行連接
4	麥克風插孔		通過3.5毫米立體聲電纜將外部麥克風連接到音箱
5	有線控制器		插入有線控制器以控制音箱
6	連接		按下以與OXS衛星頸部揚聲器配對 (單獨購買)



1	USB-A		插入適配器將OXS衛星頸部揚聲器連接 (單獨購買)
2	USB-C		插入USB (C型) 線將音箱連接到電腦
3	HDMI 輸入		插入HDMI線將音箱連接到遊戲監視器或電腦
4	HDMI eARC		插入HDMI線將音響連接到遊戲主機

遙控

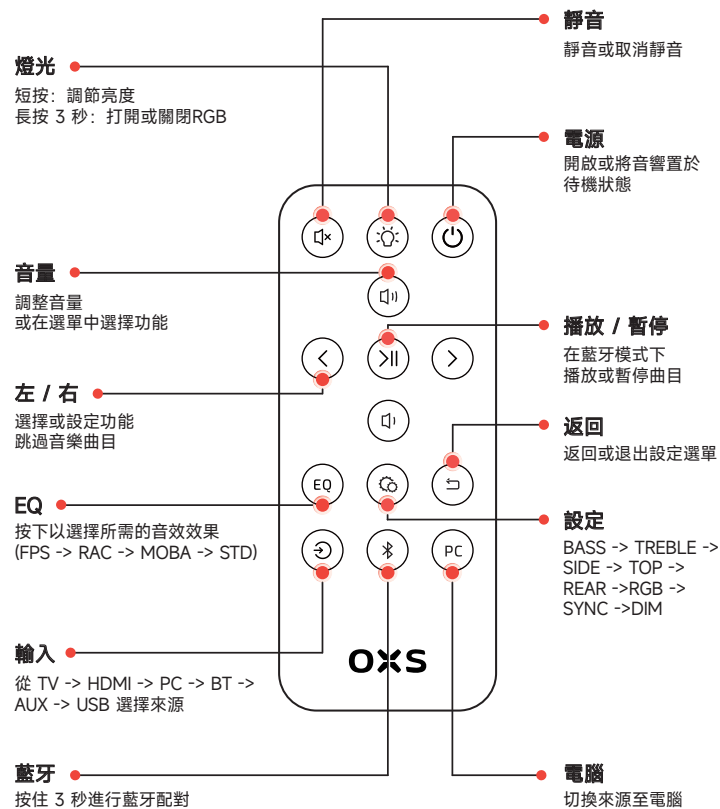

線控

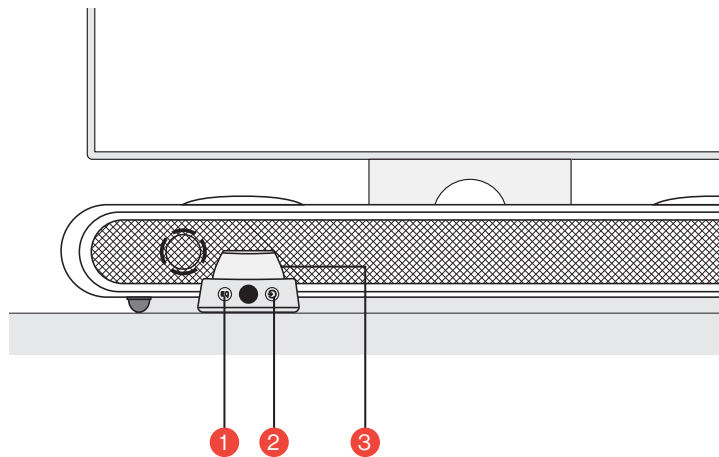

1	EQ (均衡器) EQ	按下以選擇所需的音效效果 (FPS -> RAC -> MOBA -> STD)
2	輸入	從 TV -> HDMI -> PC -> BT -> AUX -> USB 選擇來源
3	主按鈕	長按3秒鐘 開啟或將音響置於待機狀態
		短按 將音響靜音
		旋轉調節音量

操作指南

設置



2 調整高度

額外的可拆卸腳架可讓您調整音箱的高度，以確保聲音傳遞時的阻礙最少。根據腳架的方向，您可以將音箱設置為平放或提高角度。

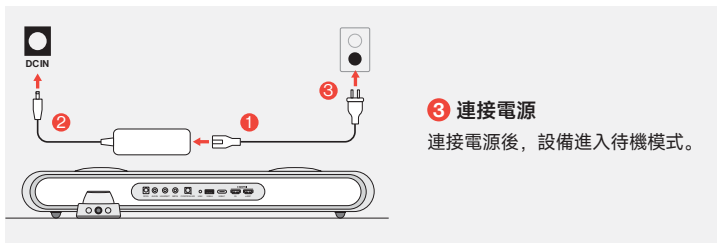
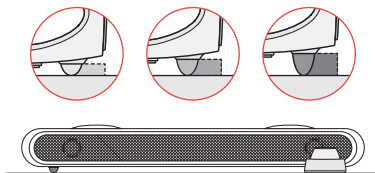

4 開機

通過長按按鈕開啟音箱。

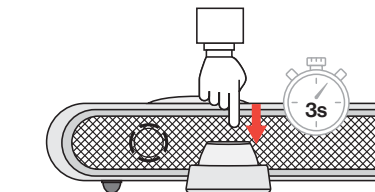

連接音頻源

通過HDMI eARC/ARC連接

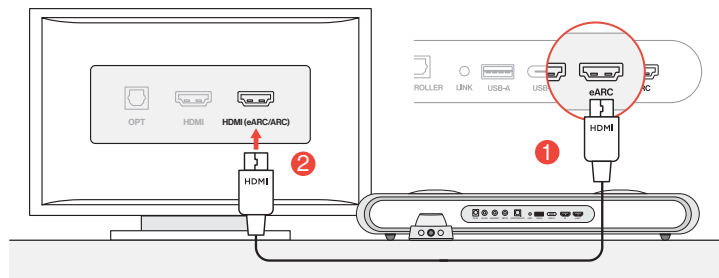

1 使用附帶的HDMI線將音響連接到電視上的任意一個HDMI (eARC/ARC)端口。

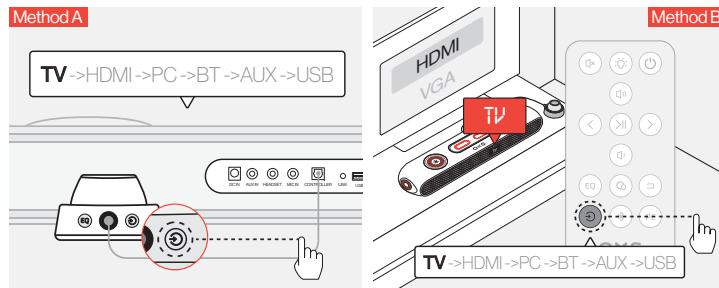

2 將音頻輸入切換到"TV" (電視)。

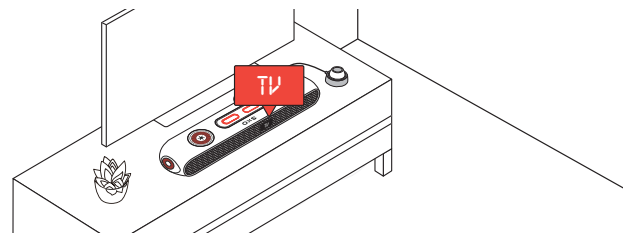

透過HDMI IN連接

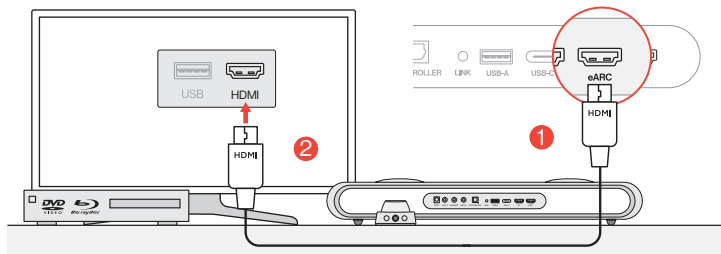

- ① 將電視或顯示器上的任一HDMI端口連接到音響的HDMI OUT端口。

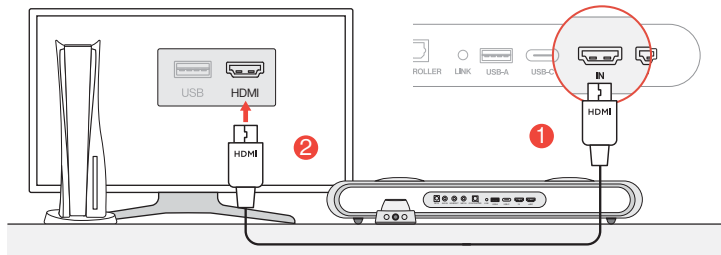

- ② 將個人電腦或遊戲主機上的任一HDMI端口連接到音響的HDMI IN端口。

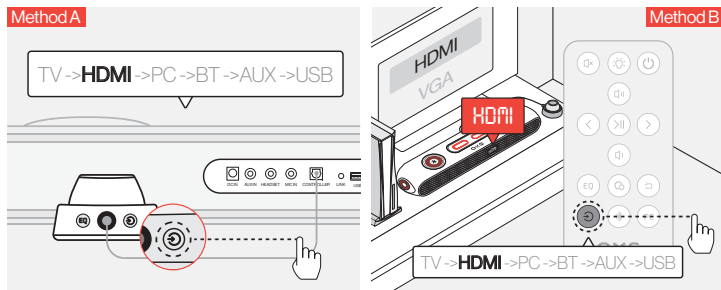

- ③ 將音頻輸入切換到HDMI。

透過USB-C電纜連接

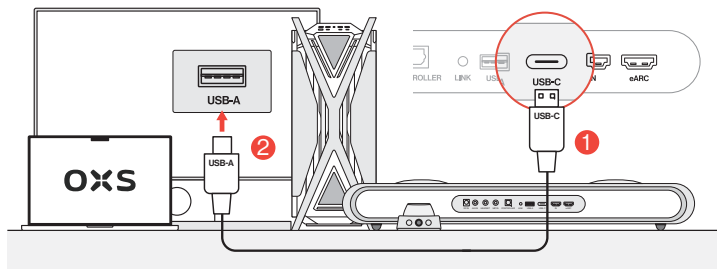

- ① 使用附帶的USB-C至USB-A電纜，將音響連接到您的個人電腦上的任一USB-A端口。

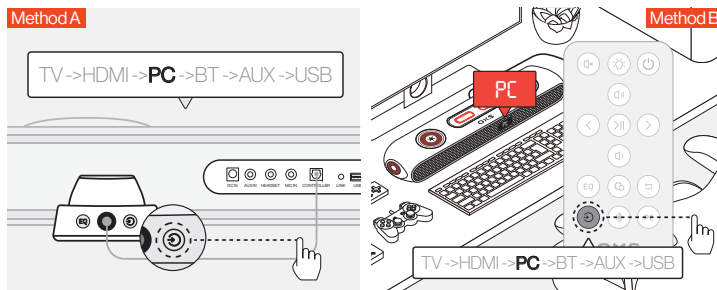

- ② 將音頻輸入切換到個人電腦。

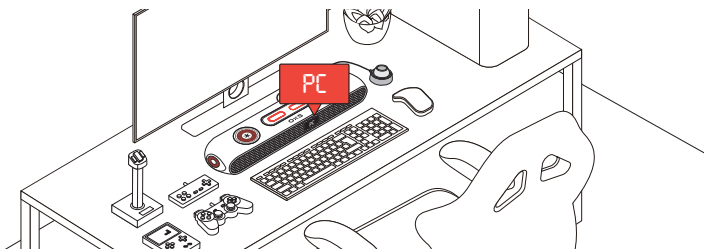

透過模擬電纜連接

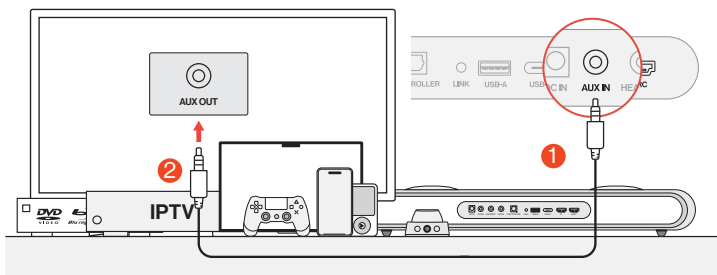

- 1 使用AUX電纜將設備和音箱連接起來。

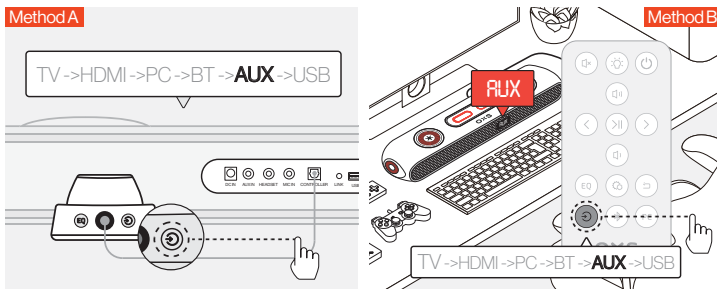

- 2 將音頻輸入切換到AUX。

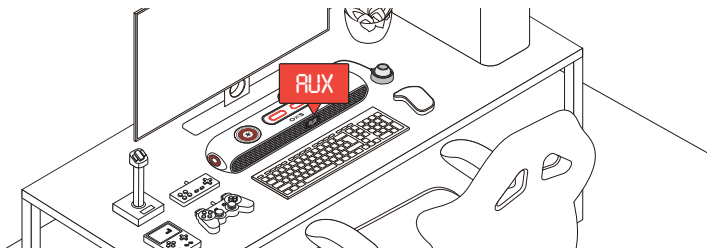

通過藍牙連接

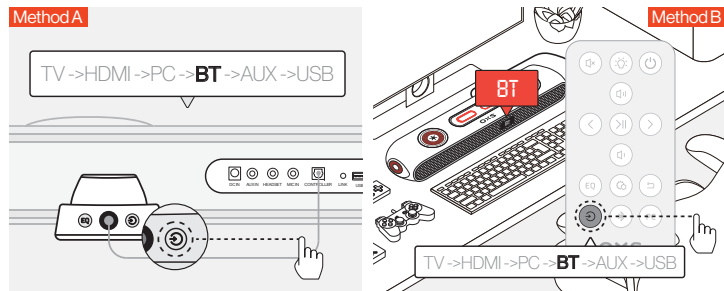

- 1 將音頻輸入切換到藍牙。

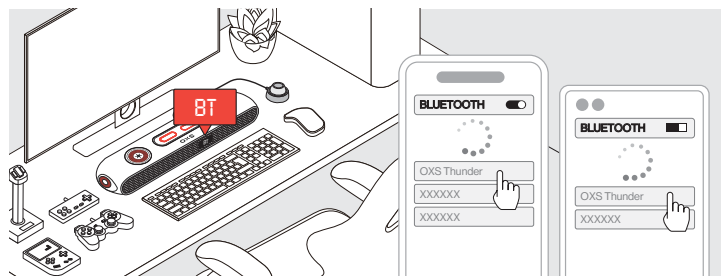

- 2 在設備螢幕上選擇「OXS Thunder」。

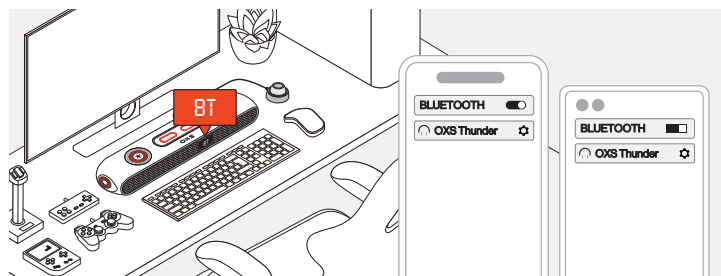

- 3 連接成功後，音箱上的「BT」指示燈將保持穩定。

將音箱設置為預設裝置

如果您是第一次使用該音箱，可能需要將其設置為系統的默認播放設備。

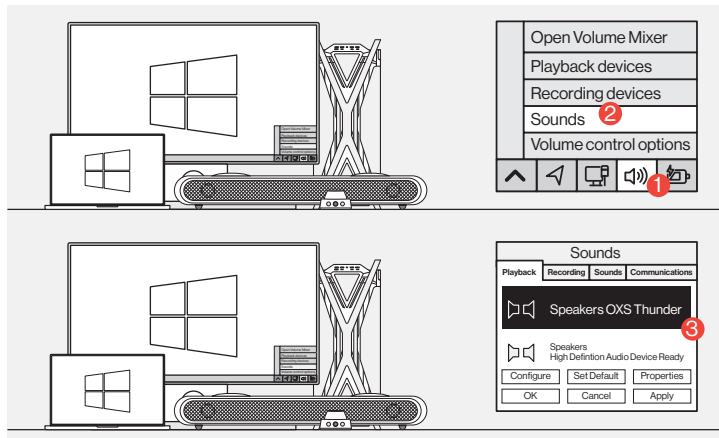

1 對於Windows PC用戶

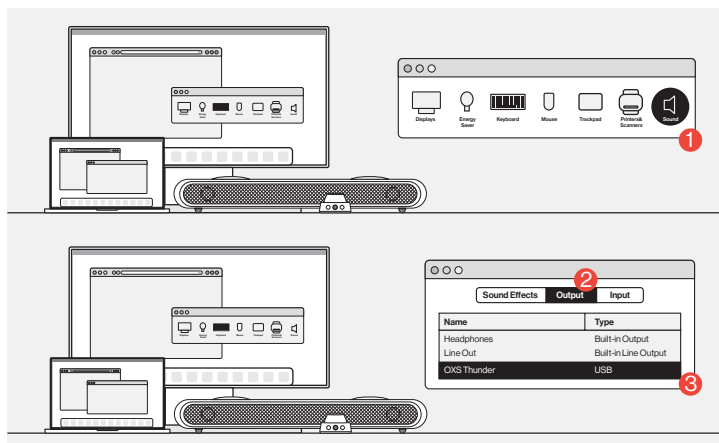

2 對於Mac用戶

啟用杜比全景聲

請注意，杜比全景聲只能通過HDMI輸出使用。如果您是第一次使用該音箱，可能需要在遊戲機或電腦上啟用杜比全景聲。更多相關說明，請訪問以下網站：

• <https://games.dolby.com/atmos/documentation/#Platforms>

目録

セット内容	JP-02
・各部のなまえとはたらき	JP-03
・リモコン	JP-05
・トグルコントローラー	JP-06
操作方法	JP-07
オーディオ入力に接続	JP-08
・HDMI eARC/ARCで接続	JP-08
・HDMI INで接続する	JP-09
・USB-Cケーブルで接続する	JP-10
・アナログケーブルで接続する	JP-11
・Bluetoothで接続する	JP-12
・スピーカーをデフォルトデバイスに設定する	JP-13
DOLBY ATMOSを有効にする	JP-14

セット内容

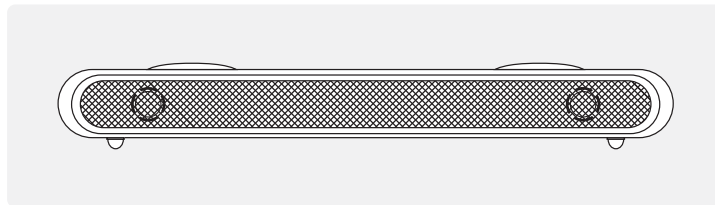

OXS Thunder サウンドバー×1

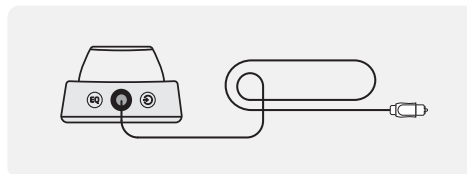

トグルコントローラー×1



サウンドバーの角度調整用の取り外し可能スタンド

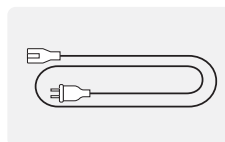

電源ケーブル×1

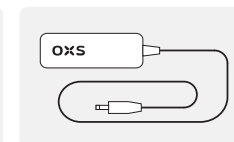

電源アダプター×1

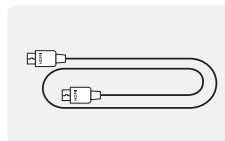

HDMIケーブル×1

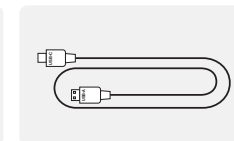







USB A to Cケーブル×1

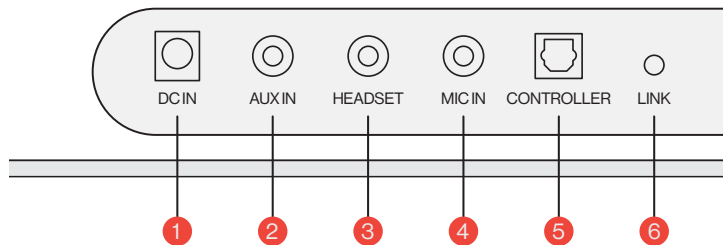
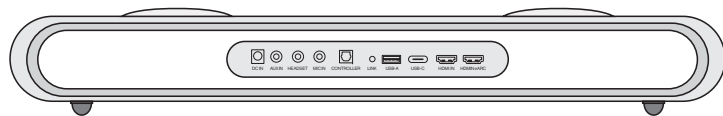





リモコン

各部のなまえとはたらき

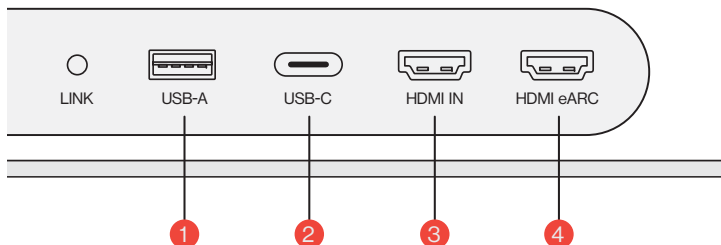
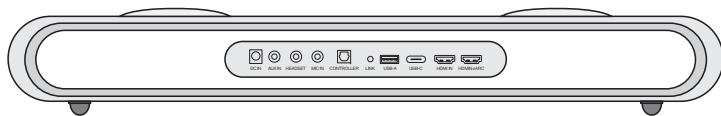

1	電源入力		付属の電源アダプターで本機に電源を入力する
2	AUX入力		AUXオーディオを入力する
3	ヘッドホンジャック		ヘッドホンやイヤホンを差し込んで本機に接続する
4	マイクジャック		3.5mmステレオケーブルで外付けマイクを本機に接続する
5	コントローラー		トグルコントローラーを差し込んで本機に接続する
6	ペアリング		ここを押してOXSサテライトネックスピーカー（別売）とペアリングする



1	USB-A		アダプターを差し込んでOXSサテライトネックスピーカー（別売）を接続する
2	USB-C		USB-Cケーブルを使ってサウンドバーをパソコンに接続する
3	HDMI入力		HDMIケーブルでサウンドバーをゲームモニターやパソコンに接続する
4	HDMI eARC		HDMIケーブルでサウンドバーをコンソールに接続する

リモコン

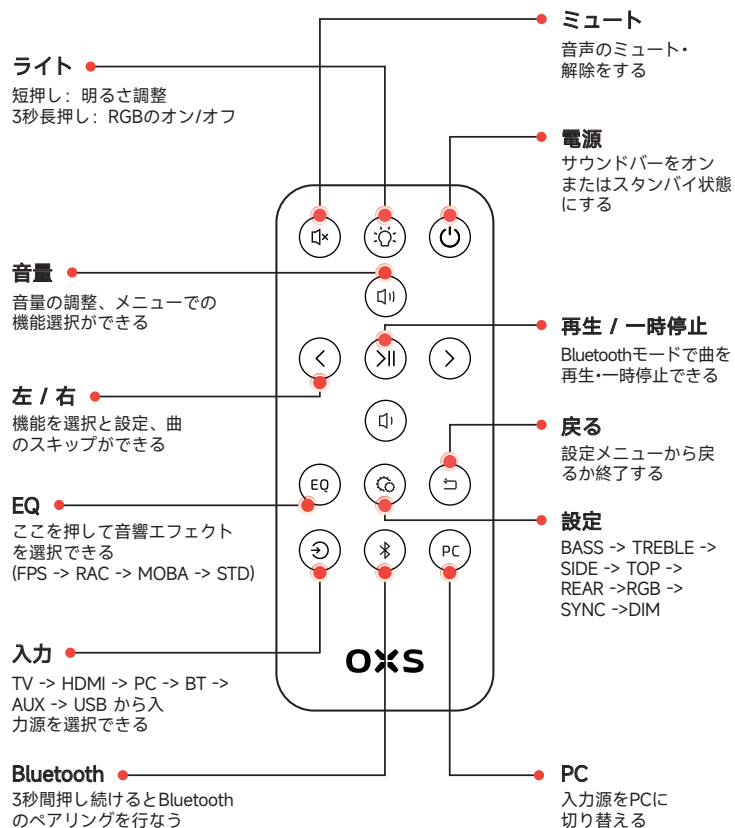

トグルコントローラー

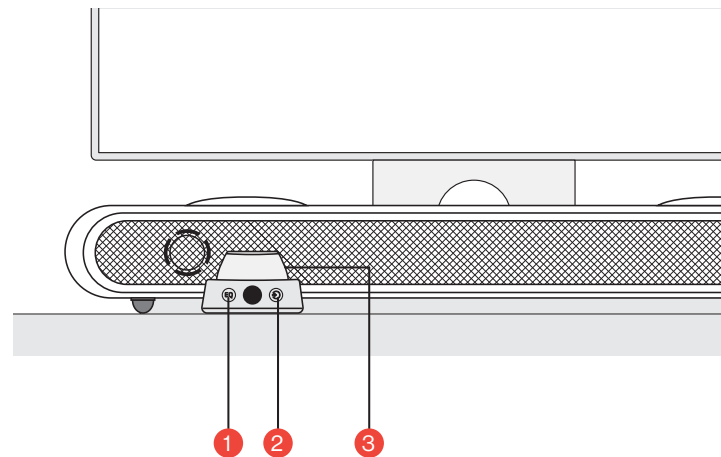

1	EQ		ここを押して音響エフェクトを選択できる (FPS -> RAC -> MOBA -> STD)
2	入力		TV -> HDMI -> PC -> BT -> AUX -> USB から入力源を選択できる
3	メインボタン		3秒間押し続けると サウンドバーをオンまたはスタンバイ状態にする
			1回押し 音声をミュートにする
			回転して音量を調整します

操作方法

設定

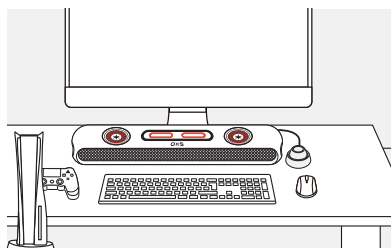

1 設置

必要に応じてサウンドバーを平らで安定した表面に設置する。

2 高さ調整

音声転送への障害を最小限に抑えるために、取り外し可能なスタンドを使ってサウンドバーの高さを調整できる。スタンドを変えることでサウンドバーの設置角度を調整できる。

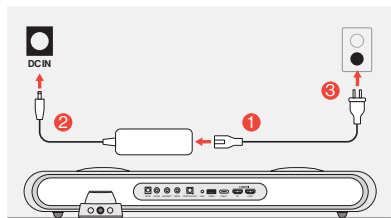
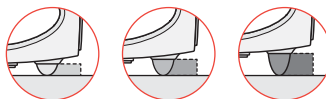

3 電源に接続

電源に接続すると、本機はスタンバイモードになる。

4 パワーオン

このボタンを短押しして本機をオンにする。

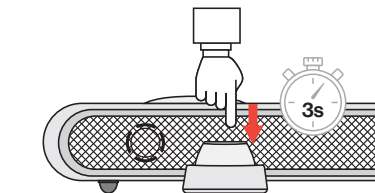

オーディオ入力に接続

HDMI eARC/ARCで接続

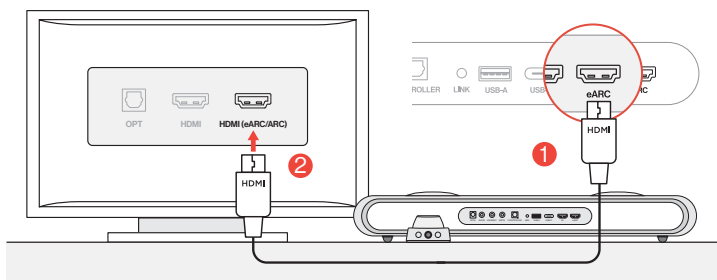

1 同梱のHDMIケーブルを使ってサウンドバーをテレビの任意のHDMI (eARC/ARC) ポートに接続する。

Method A

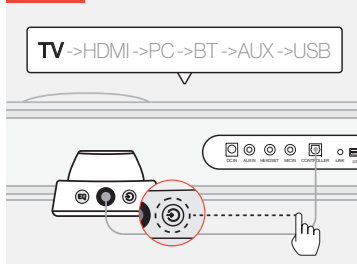

Method B

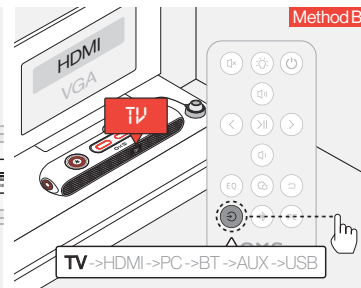

2 オーディオ入力を「TV」に切り替える。

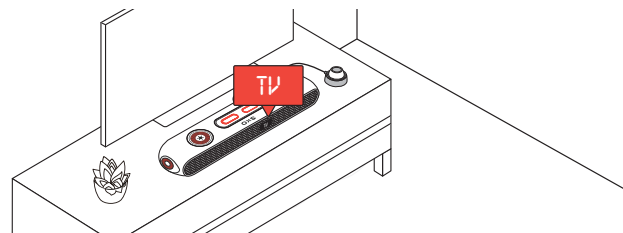

HDMI INで接続する

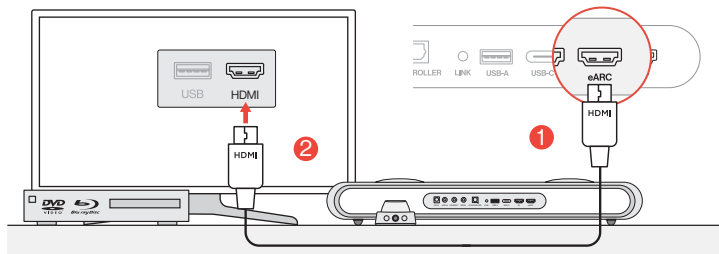

- 1 テレビまたはモニターのHDMIポートのいずれかを、サウンドバーのHDMI OUTポートに接続する。

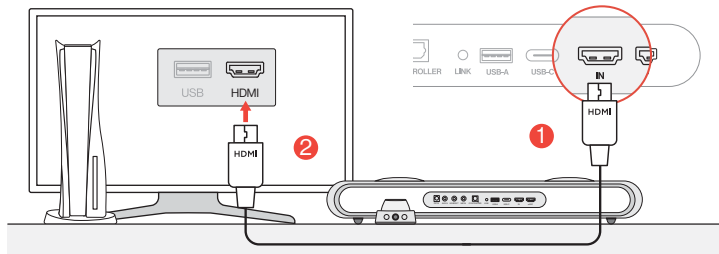

- 2 パソコンまたはゲームコンソールのHDMIポートのいずれかを、サウンドバーのHDMI INポートに接続する。

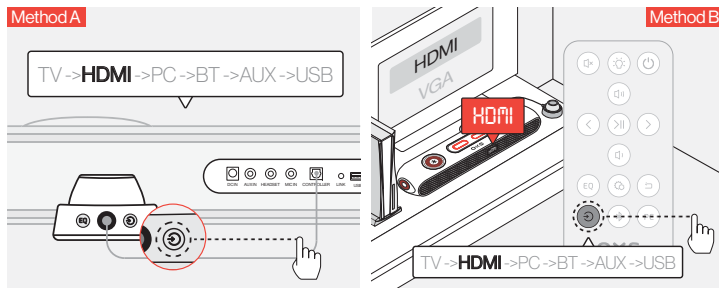

- 3 オーディオ入力をHDMIに切り替える。

USB-Cケーブルで接続する

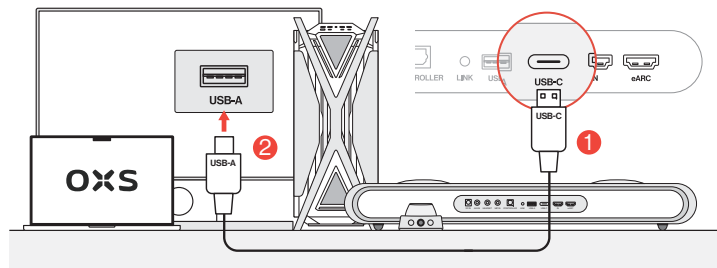

- 1 付属のUSB-C to Aケーブルを使ってサウンドバーをパソコンの任意のUSB-Aポートに接続する。

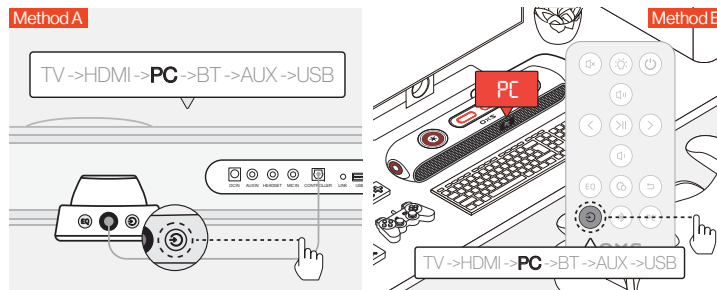

- 2 オーディオ入力をパソコンに切り替える。

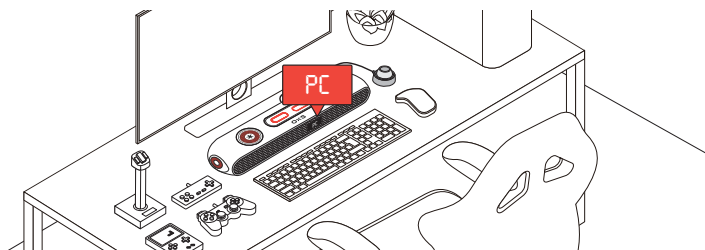

アナログケーブルで接続する

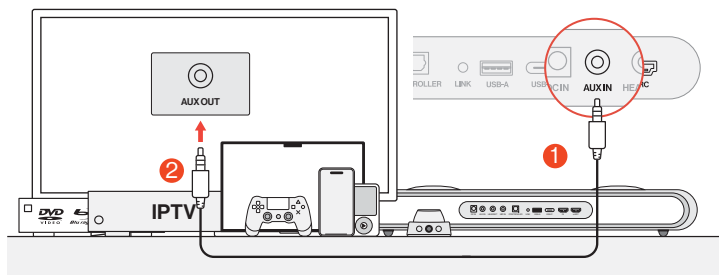

- ① デバイスとサウンドバーをAUXケーブルで接続する。

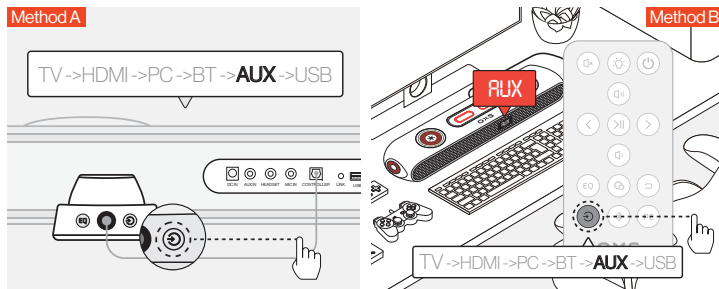

- ② オーディオ入力をAUXに切り替える。

Bluetoothで接続する

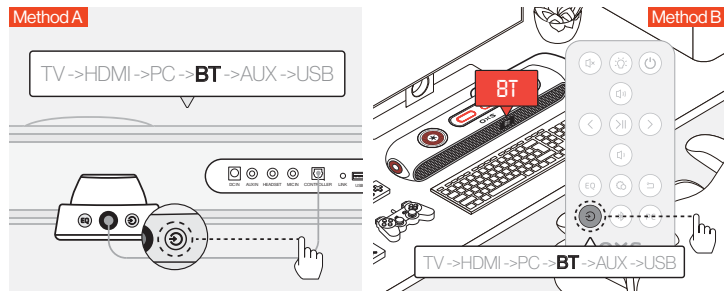

- ① オーディオ入力をBluetoothに切り替える。

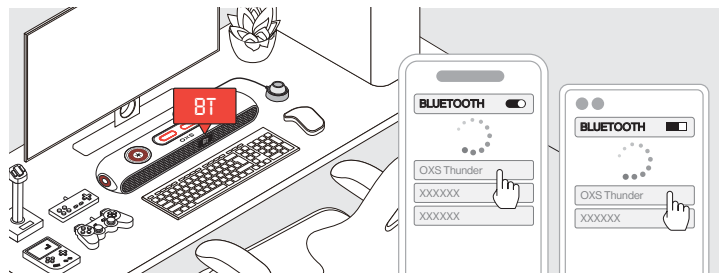

- ② デバイスリストで「OXS Thunder」を選択する。

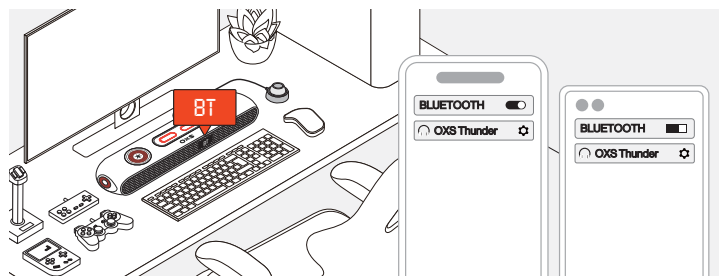

- ③ 接続が成功したら、サウンドバーの「BT」インジケータが安定した状態になる。

でスピーカーをデフォルトデバイスに設定する

サウンドバーを初めてご利用になる場合、本機をシステムのデフォルト再生デバイスとして設定する必要があります。

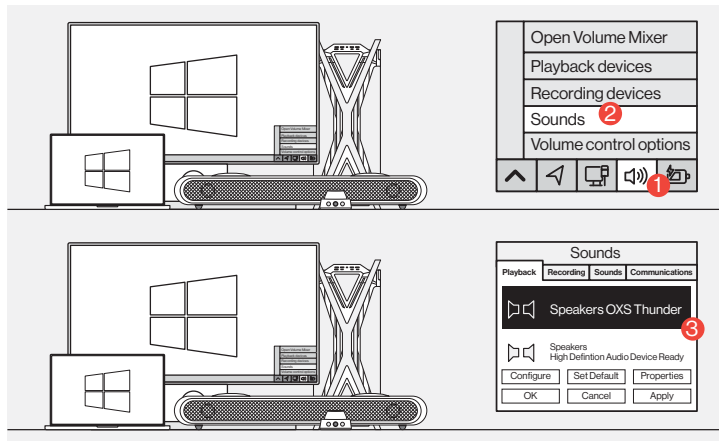

① Windows PCユーザー向け

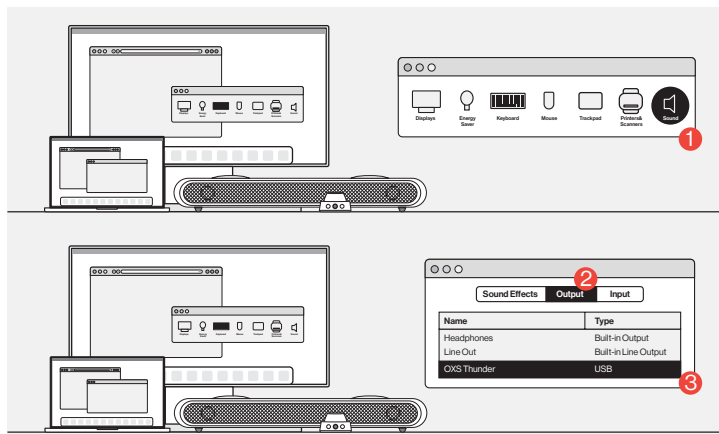

② Macユーザー向け

DOLBY ATMOS を有効にする

Dolby Atmos は HDMI 出力でのみ利用可能です。音響バーを初めて使用する場合、ゲームコンソールやPCで Dolby Atmos を有効にする必要があります。詳しい手順については、以下のサイトをご覧ください:

• <https://games.dolby.com/atmos/documentation/#Platforms>

목차

패킹 리스트

- 디바이스 레이아웃
- 원격
- 컨트롤러

사용 방법

음원에 연결해 주십시오

- HDMI eARC/ARC 연결
- HDMI IN을 통한 연결
- USB-C 케이블을 통한 연결
- 아날로그 케이블로 연결
- 블루투스로 연결하기
- 스피커를 기본 장치로 설정하기

DOLBY ATMOS 활성화

KR-02

KR-03

KR-05

KR-06

KR-07

KR-08

KR-08

KR-09

KR-10

KR-11

KR-12

KR-13

KR-14

패킹 리스트

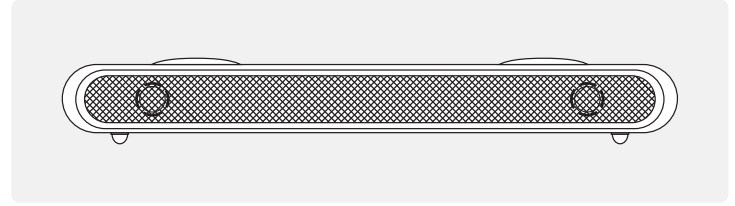

OXS Thunder 게임 스피커×1

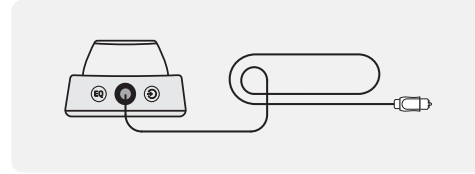

유선 컨트롤러×1

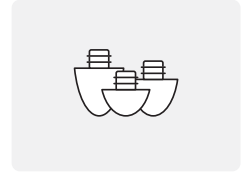

스피커 각도 조절을 위한 분리 가능한 발판

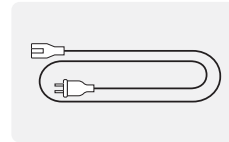

전원 케이블×1

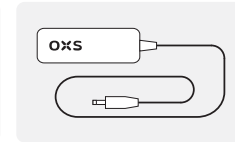

전원 어댑터×1

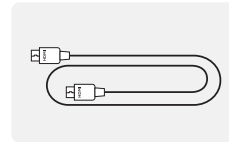

HDMI 케이블×1

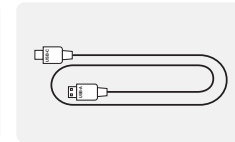

USB A에서 C로 변환하는 케이블×1

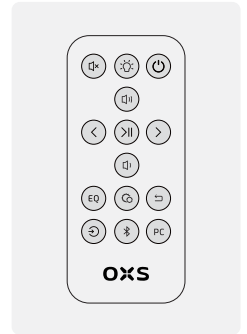

원격

디바이스 레이아웃

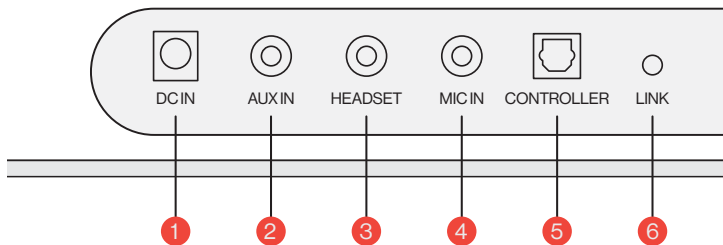
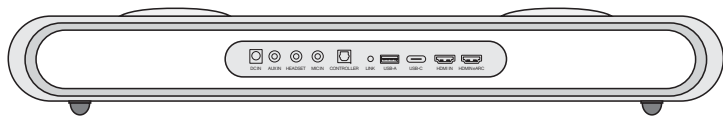

1	전원 공급		공급된 전원 어댑터를 사용하여 사운드바를 켭니다
2	AUX 입력		AUX 오디오 입력입니다
3	헤드셋 잭		헤드셋이나 이어폰을 연결하기 위해 사운드바 잭에 꽂습니다
4	마이크 잭		외부 마이크를 3.5mm 스테레오 케이블을 통해 사운드바에 연결합니다
5	컨트롤러		사운드바에 연결하기 위해 토글 컨트롤러를 꽂습니다
6	링크		OXS 위성 넥 스피커와 페어링하기 위해 누릅니다 (별도 구매)

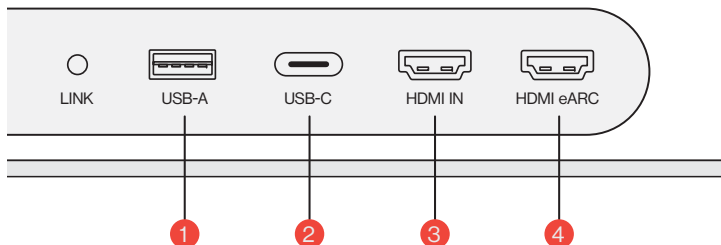
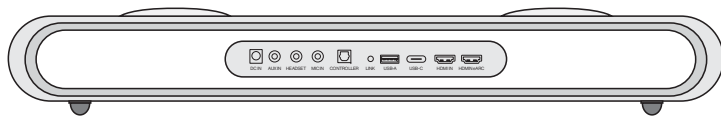

1	USB-A		동글을 꽂아 OXS 위성 넥 스피커와 연결합니다 (별도 구매)
2	USB-C		USB (C 타입) 케이블을 꽂아 사운드바를 컴퓨터에 연결합니다
3	HDMI 입력 (HDMI IN)		HDMI 케이블을 꽂아 사운드바를 게이밍 모니터나 컴퓨터에 연결합니다
4	HDMI eARC		HDMI 케이블을 꽂아 사운드바를 게이밍 콘솔에 연결합니다