

CHE-636

User Manual

For a better sound quality experience, suggest using iOS 8.0/Android 4.3 or above operating system.

J

Product Picture

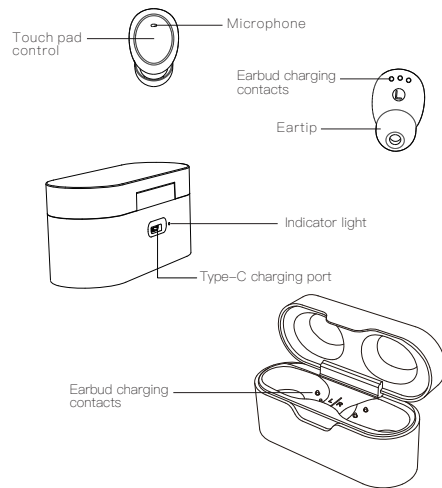

►1

Pairing

When using it for the first time (or not using it for a long time), please make sure to charge the earbuds and charging box before use.

- Open the charging case and take out the earbuds, the earbuds will turn on automatically and enter into the pairing mode.
- Turn on the Bluetooth of your phone and search for the Bluetooth name "Comfy Lite " to pair.

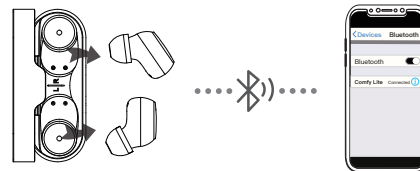

Tips:

1. When the red & blue lights of the master earbud flash alternatively, and the slave earbud indicator flash slowly, the earbuds are ready to pair with your Bluetooth device.
2. When the earbuds indicators will blue indicators flash slowly, they have connected with cellphone.
3. When you use the earbuds again, just take out two earbuds from the charging case simultaneously and they will be automatically connected with Bluetooth device. (the last connected device)
4. Left and right earbuds can be used separately.

►2

Functional operation

▶/ Play/Pause	👆 Single-click
◀ Previous Song	👆 Double-click (left earbud)
▶ Next Song	👆 Double-click (right earbud)
🔊 Volume +	👆 Press 3s (right earbud)
🔊 Volume -	👆 Press 3s (left earbud)
☎ Answer Call/Hang up	👆 Single-click
☎ Reject Call	👆 Press 2s
🗣 Voice Assistant	👆 Triple-click(right earbud)
🎮 Game Mode	👆 Triple-click(left earbud)
🔋 Power On	👆 ① Take earbuds out of charging case 👆 ② Press 3s
🔋 Power Off	👆 ① Take earbuds in the charging case 👆 ② Disconnected in 3 minutes 👆 ③ Click on the four times

Warm Tips:

1. When adjusting the earbud volume, please press the operation area of the earbud without releasing until it reaches the desired volume.
2. Please use the earbud with a reasonable volume and time, otherwise, listening to high volume music for a long time will damage your hearing
3. In the Mono mode, earbuds can't adjust the volume. You can adjust it by phone.

►3

Charging

① Charging for the charging case

Use the charging cable in the packing box, and connect it to charge with the power adapter.

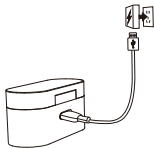

- When charging, the indicator light flashes green light.
- When fully charged, the green indicator lights keep lighting, please disconnect charging devices from the charging case.

② Charging for earbuds

Make sure the charging case is fully charged. Then put the earbuds into charging case, and they will enter into charging mode when the red indicator flashes.

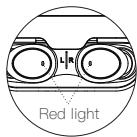

- When charging, the indicator light keep red light.
- When fully charged, the indicator goes out, the charging case will power off automatically.

▶4

How to reset

If the earbuds cannot connect to the mobile device, or the left and right earbuds cannot connect normally, please use the reset method below to solve the problem.

1. Clear the earbuds pairing record: Touch the left and right earbud touch area 5 times when they are not connected.
2. It can be reset by pressing the ear for 5 seconds while charging in the charging box.

Specification

Bluetooth version: V5.3

Support profile: A2DP/AVRCP/HFP/HSP

Transmission distance: 10M

Frequency range: 2402MHz~2480MHz

Driver: Φ6MM*2 Hi-Fi Speaker

Voltage: 3.7V

Standby time: About 70H

Talking time: About 4H

Playing time: About 5H(Volume at 60%)

Earbud battery: 40mAh

Earbud charging time: About 1.5H

Support system: IOS/Android/Windows

Certification: CE/FCC/ROHS

▶5

Attention

1. Do not remove or refit earbuds for any reason, otherwise it will lead to headset damaged and burn. These are not covered by warranty.
2. Do not touch the earbuds in corrosive liquid, otherwise it will cause serious damage. The manufacturer will not guarantee the damage caused under this situation.
3. Do not put the equipment under too high or too low temperature (Below 0°C or above 45°C).
4. Please avoid approaching the eyes of children or animals when using equipment lights.
5. Do not use equipment in the thunderstorm weather. Thunderstorms may cause abnormal equipment operation and increase the risk of electric shock.
6. Due to the limit of the environment & connection distance for the bluetooth products, do not use our earbuds in large electromagnetic interference and radiation environment.
7. While driving, try to avoid using earbud to listen to music, make or receive calls, so as not to distract from danger.

Warning!

This product contains a built-in lithium battery. Please do not expose this product to strong sunlight, roasting or throwing it into the fire, as they may explode.

▶6

Product Name: Wireless Earbuds

Model NO: CHE-636

Input: 5V/1A

Trade Mark: cherro

Manufacturer: TRA COMPANY LTD.

Address: Osaka-shi, Chuo-ku, Kitahama-higashi 6-6 Aqua

Tower 7F/8F 540-0031 JAPAN

NOTE:

This equipment has been tested and found to comply with the limits for a Class B digital device, pursuant to part 15 of the FCC Rules. These limits are designed to provide reasonable protection against harmful interference in a residential installation. This equipment generates uses and can radiate radio frequency energy and, if not installed and used in accordance with the instructions, may cause harmful interference to radio communications. However, there is no guarantee that interference will not occur in a particular installation. If this equipment does cause harmful interference to radio or television reception, which can be determined by turning the equipment off and on, the user is encouraged to try to correct the interference by one or more of the following measures:

- Reorient or relocate the receiving antenna.
- Increase the separation between the equipment and receiver.
- Connect the equipment into an outlet on a circuit different from that to which the receiver is connected.
- Consult the dealer or an experienced radio/TV technician for help

Changes or modifications not expressly approved by the party responsible for compliance could void the user's authority to operate the equipment.

This device complies with Part 15 of the FCC Rules. Operation is subject to the following two conditions:

This device may not cause harmful interference, and (2) this device must accept any interference received, including interference that may cause undesired operation.

210-172571
FCC ID: 2AYJ7CHE-636



▶7