

Milesight

# QUICK START GUIDE

EM320-TH



SMART IOT SENSOR  
FEATURING LoRaWAN®

## 1. Packing List



1 × EM320-TH Sensor



1 × Quick Start Guide



1 × Warranty Card

### Standard Version Only



2 × Wall Mounting Kits



1 × Fixing Screw

## 2. Hardware Introduction

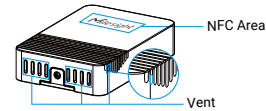

## 3. Power Button

EM320-TH equips with power button and indicator inside to switch on/off the device for emergency use. Usually users can use NFC to complete all steps.

Function	Action	LED
Turn On	Press and hold the button for more than 3 seconds.	Off → On
Turn Off	Press and hold the button for more than 3 seconds.	On → Off
Reset	Press and hold the button for more than 10 seconds.	Blinks quickly
Check On/ Off Status	Quickly press the power button.	Light On: Device is on.
		Light Off: Device is off.

Milesight



Quick Start Guide



Cloud App

All software files can be downloaded from  
<https://www.milesight-iot.com/documents-download/>

## Better Inside, More in Sight

Milesight IoT Co., Ltd. | [www.milesight-iot.com](http://www.milesight-iot.com)  
Building C09, Software Park Phase III, Xiamen 361024, Fujian, China

#### 4. Configuration Guide

1. Download "Milesight ToolBox" App on an NFC-supported smartphone.



Android



iOS

2. Open "Milesight ToolBox" App and attach the smartphone with NFC area to read/write the device until App shows a successful prompt. It's suggested to configure a device password for security. (Default password: 123456)

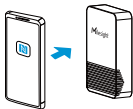

Besides, it can be configured by dedicated NFC reader provided by Milesight IoT.

#### 5. Installation

**Standard Version:**

1. Remove the backplate on the back of the device, screw the wall plugs into the wall and fix the backplate with screws on it, then install back the device. Note that the vent of device should not face upwards when installing.

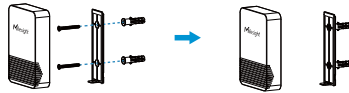

2. Fix the bottom of the device to the cover with a fixing screw.

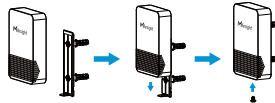

**Magnetic Version:**

Attach the device to a magnetic surface such as the metal surface of the refrigerator, freezer, freight container, etc. The back of the device is equipped with anti-slip pad to secure firm and sturdy installation. Note that the vent should not face upwards.



#### 6. Installation

Any Changes or modifications not expressly approved by the party responsible for compliance could void the user's authority to operate the equipment. This device complies with part 15 of the FCC Rules. Operation is subject to the following two conditions:

- (1) This device may not cause harmful interference, and
- (2) This device must accept any interference received, including interference that may cause undesired operation.

**Note:** This equipment has been tested and found to comply with the limits for a Class B digital device, pursuant to part 15 of the FCC Rules. These limits are designed to provide reasonable protection against harmful interference in a residential installation. This equipment generates, uses and can radiate radio frequency energy and, if not installed and used in accordance with the instructions, may cause harmful interference to radio communications. However, there is no guarantee that interference will not occur in a particular installation. If this equipment does cause harmful interference to radio or television reception, which can be determined by turning the equipment off and on, the user is encouraged to try to correct the interference by one or more of the following measures:

- Reorient or relocate the receiving antenna.
- Increase the separation between the equipment and receiver.
- Connect the equipment into an outlet on a circuit different from that to which the receiver is connected.
- Consult the dealer or an experienced radio/TV technician for help.

**FCC Radiation Exposure Statement:**

This equipment complies with FCC radiation exposure limits set forth for an uncontrolled environment. This equipment should be installed and operated with minimum distance 20cm between the radiator& your body. This transmitter must not be co-located or operating in conjunction with any other antenna or transmitter.