

Reolink Argus 3 Pro

Quick Start Guide

Contents

What's in the Box	2
Camera Introduction	3
Set up the Camera	4
Charge the Battery	6
Install the Camera	7
Safety Instructions of Battery Usage	11
Troubleshooting	12
Specifications	13
Notification of Compliance	13

What's in the Box



Camera



Stand Bracket



Security Bracket



Loop Strap



Reset Needle



Micro USB Cable

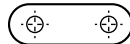

Mounting Template



Pack of Screws



Surveillance Sign



Quick Start Guide

NOTE:

* Quantity of accessories varies with different camera models that you purchase.

Camera Introduction

Battery Status LED

Micro USB Power Port

Speaker

Spotlight

Status LED

Lens

Daylight Sensor

Built-in Mic

PIR Motion Sensor

Reset Button

* Press for more than five seconds to reset the device to factory settings.

Power Switch

Micro SD Card Slot

NOTE: Always keep the rubber plug closed firmly.

Different states of the status LED:

- **Red Light:** WiFi connection failed
- **Blue Light:** WiFi connection succeeded

Blinking: Standby status
On: Working status

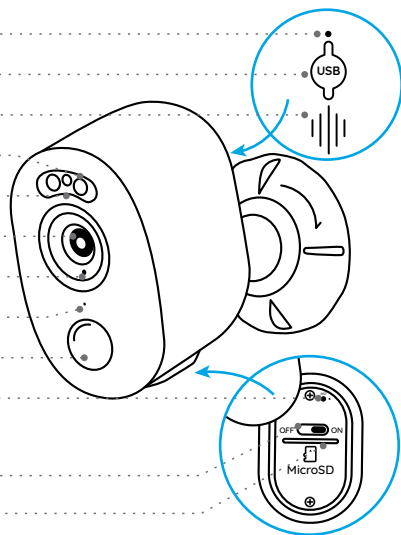

Set up the Camera

Set up the Camera using a Smartphone

Step 1 Scan to download the Reolink App from the App Store or Google Play store.



Step 2 Turn on the power switch to power on the camera.

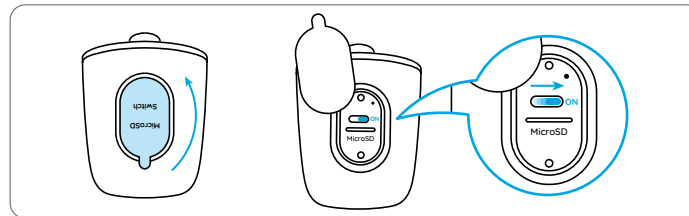

Step 3 Launch the Reolink App, and click the “+” button in the top right corner to add the camera. Scan the QR code on the device and follow the onscreen instructions to finish initial setup.

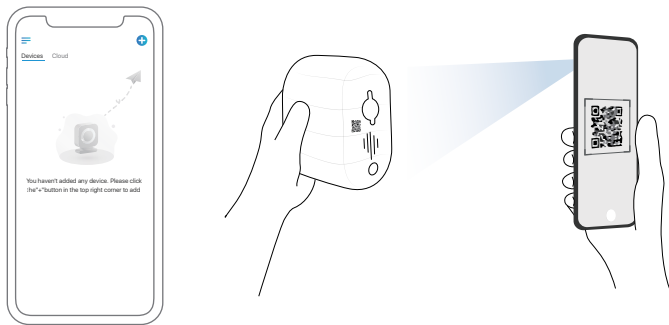

Set up the Camera on PC (Optional)

Step 1 Download and install the Reolink Client: Go to <https://reolink.com> > Support > App & Client.

Step 2 Launch the Reolink Client, click the “+” button, input the UID code of the camera to add it and follow the onscreen instructions to finish initial setup.

Charge the Battery

It's recommended to fully charge the battery before mounting the camera outdoors.

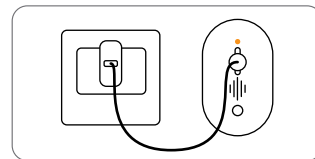

Charge the battery with a power adapter.

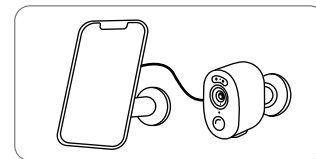

Charge the battery with the Reolink Solar Panel (Not included if you only purchase the camera).

Charging indicator:

- Orange LED: Charging
- Green LED: Fully charged

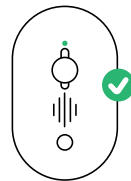

For better weatherproof performance, always keep the USB charging port covered with the rubber plug after charging the battery.

Install the Camera

Notes on Camera Installation Position

- Install the camera 2-3 meters (7-10ft) above the ground to maximize the detection range of the PIR motion sensor.
- For effective motion detection, please install the camera angularly.

NOTE: If a moving object approaches the PIR sensor vertically, the camera may fail to detect motion.

Mount the Camera

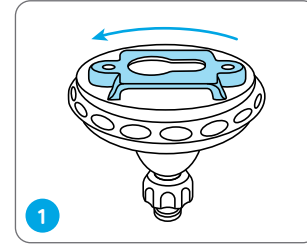

Rotate to separate the base from the bracket.

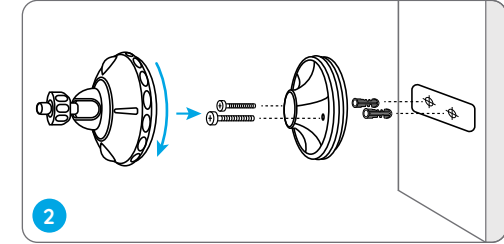

Drill holes in accordance with the mounting template and screw the base of the bracket to the wall. Next, attach the other part of the bracket to the base.

NOTE: Use the drywall anchors included in the package if needed.

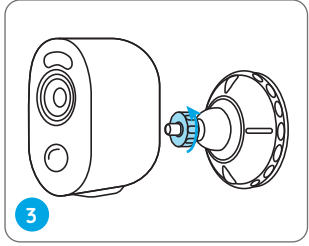

Screw the camera to the bracket.

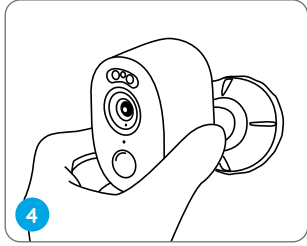

Adjust the camera angle to get the best field of view.

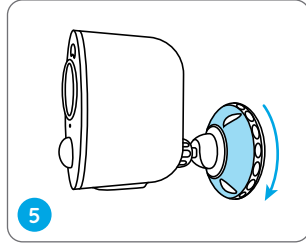

Secure the camera by turning the part on the bracket identified in the chart clockwise.

NOTE:

To adjust the camera angle later, please loosen the bracket by turning the upper part anticlockwise.

Install the Camera with Loop Strap

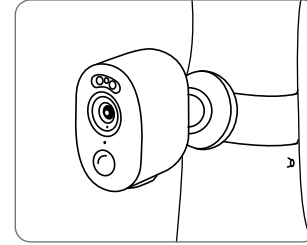
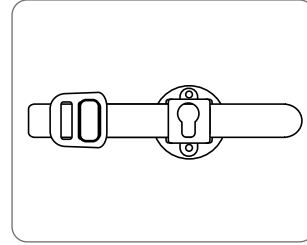

Thread the loop strap through the slots and fasten the strap. It is the most recommended installation method if you plan to mount the camera to the tree.

Place the Camera on a Surface

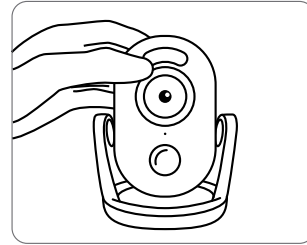

If you plan to use the camera indoors and put it on a flat surface, you may place the camera into the stand bracket and adjust the camera angle by slightly rotating the camera back and forth.

Safety Instructions of Battery Usage

Reolink Argus 3/Argus 3 Pro is not designed for running 24/7 at full capacity or around-the-clock live streaming. It's designed to record motion events and to live view remotely only when you need it. Learn useful tips on how to extend the battery life in this post:

<https://support.reolink.com/hc/en-us/articles/360006991893>

1. The battery is built-in, so do not remove it from the camera.
2. Charge the rechargeable battery with a standard and high-quality DC 5V/9V battery charger or Reolink solar panel. Do not charge the battery with solar panels from any other brands.
3. Charge the battery when temperatures are between 0°C and 45°C and always use the battery when temperatures are between -20°C and 60°C.
4. Keep the USB charging port dry, clean and free of any debris and cover the USB charging port with the rubber plug when the battery is fully charged.
5. Do not charge, use or store the battery near any ignition sources, such as fire or heaters.
6. Do not use the battery if it gives off an odor, generates heat, becomes discolored or deformed, or appears abnormal in any ways. If the battery is being used or charged, remove the battery from the device or the charger immediately, and stop using it.
7. Always follow the local waste and recycle laws when you get rid of the used battery.

Troubleshooting

Camera Is Not Powering on

If your camera is not turning on, please apply the following solutions:

- Make sure the power switch is turned on.
- Charge the battery with a DC 5V/2A power adapter. When the green light is on, the battery is fully charged.

If these won't work, please contact Reolink Support <https://support.reolink.com>

Failed to Scan QR Code on the Phone

If you cannot scan the QR code on your phone, please try the following solutions:

- Remove the protective film from the camera lens.
- Wipe the camera lens with a dry paper/towel/tissue.

- Vary the distance between your camera and the mobile phone so that the camera can focus better.
- Try to scan the QR code under sufficient lighting.

If these won't work, please contact Reolink Support <https://support.reolink.com>

Failed to Connect to WiFi During Initial Setup Process

If the camera fails to connect to WiFi, please try the following solutions:

- Ensure that you have entered the correct WiFi password.
- Put the camera closer to your router to ensure a strong WiFi signal.
- Change the encryption method of the WiFi network to WPA2-PSK/WPA-PSK (safer encryption) on your router interface.
- Change your WiFi SSID or password and make sure that SSID is within 31 characters and password is within 64 characters.

- Set your password using only the characters available on the keyboard.

If these won't work, please contact Reolink Support <https://support.reolink.com>

Specifications

Video

Field of View: 120° diagonal
Night Vision: Up to 10m (33 ft)

PIR Detection & Alerts

PIR Detection Distance:
Adjustable up to 10m (33ft)
PIR Detection Angle: 100° horizontal
Audio Alert: Customized voice-recordable alerts
Other Alerts:
Instant email alerts and push notifications

General

Operating Temperature:
-10°C to 55°C (14°F to 131°F)
Weather Resistance: IP65 certified weatherproof
Size: 121 x 90 x 56 mm
Weight (Battery included): 330g (11.6 oz)

For more specifications, visit <https://reolink.com/>.

Notification of Compliance

FCC Compliance Statement

This device complies with Part 15 of the FCC Rules. Operation is subject to the following two conditions: (1) this device may not cause harmful interference, and (2) this device must accept any interference received, including interference that may cause undesired operation. Changes or modifications not expressly approved by the party responsible for compliance could void the user's authority to operate the equipment.

NOTE: This equipment has been tested and found to comply with the limits for a Class B digital device, pursuant to Part 15 of the FCC Rules. These limits are designed to provide reasonable protection against harmful interference in a residential installation. This equipment generates, uses and can radiate radio frequency energy and, if not installed and used in accordance with the instructions, may cause harmful interference to radio communications. However, there is no guarantee that interference will not occur in a particular installation. If this equipment does cause harmful interference to radio or television reception, which can be determined by turning the equipment off and on, the user is encouraged to try to correct the interference by one or more of the following measures:

- Reorient or relocate the receiving antenna.
- Increase the separation between the equipment and receiver.
- Connect the equipment into an outlet on a circuit different from that to which the receiver is connected.

- Consult the dealer or an experienced radio/TV technician for help.

RF Exposure Warning Statements:
This equipment complies with FCC radiation exposure limits set forth for an uncontrolled environment. This equipment shall be installed and operated with minimum distance 20cm between the radiator & body. Operation of this device is restricted to indoor use only. (W52 band)

Simplified EU Declaration of Conformity

Reolink declares that this device is in compliance with the essential requirements

and other relevant provisions of Directive 2014/53/EU.



Correct Disposal of This Product

This marking indicates that this product should not be disposed with other household wastes throughout the EU. To prevent possible harm to the environment or human health from uncontrolled waste disposal, recycle it responsibly to promote the sustainable reuse of material resources. To return your used device, please use the return and collection systems or contact the retailer where the product was purchased. They can take this product for environment safe recycling.

Limited Warranty

This product comes with a 2-year limited warranty that is valid only if purchased from Reolink official stores or a Reolink authorized reseller. Learn more: <https://reolink.com/warranty-and-return/>.

NOTE: We hope that you enjoy the new purchase. But if you are not satisfied with the product and plan to return, we strongly suggest that you reset the camera to factory default settings and take out the inserted SD card before returning.

Terms and Privacy

Use of the product is subject to your agreement to the Terms of Service and Privacy Policy at reolink.com. Keep out of reach of children.

End User License Agreement

By using the Product Software that is embedded on the Reolink product, you agree to the terms of this End User License Agreement (“EULA”) between you and Reolink. Learn more: <https://reolink.com/eula/>.

Statement for IC 2.4G & 5G WIFI & RF

This device contains licence-exempt transmitter(s)/receiver(s) that comply with Innovation, Science and Economic

Development Canada’s licence-exempt RSS(s). Operation is subject to the following two conditions:

- (1) This device may not cause interference.
- (2) This device must accept any interference, including interference that may cause undesired operation of the device.

L’émetteur/récepteur exempt de licence contenu dans le présent appareil est conforme aux CNR d’Innovation, Sciences et Développement économique Canada applicables aux appareils radio exempts de licence. L’exploitation est autorisée aux deux conditions suivantes:

- (1) L’ appareil ne doit pas produire de brouillage;
- (2) L’ appareil doit accepter tout brouillage radioélectrique subi, même si le brouillage est susceptible d’ en compromettre le fonctionnement.

Radio Frequency Exposure Statement for IC
The device has been evaluated to meet general RF exposure requirements. The device can be used in mobile exposure conditions. The min separation distance is 20cm.

Déclaration d’exposition aux radiofréquences pour IC L’appareil a été évalué pour répondre aux exigences générales en matière d’exposition aux RF. L’appareil peut être utilisé dans des conditions d’exposition mobiles. La distance de séparation minimale est de 20cm.

Operation of this device is restricted to indoor use only. (W52 band)
Le fonctionnement de cet appareil est limité à une utilisation en intérieur uniquement. (W52 band)

Technical Support

If you need any technical help, please contact our support team before returning the products, <https://support.reolink.com>