

Quick Start Guide

Apply to: E1 Outdoor Pro

Content

What's in the Box	2
Camera Introduction	3
Set up the Camera	4
Install the Camera	7
Troubleshooting	10
Specifications	10
Notification of Compliance	10

What's in the Box



Camera

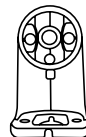

Camera Bracket

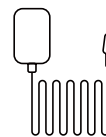

Power Adapter



Reset Needle

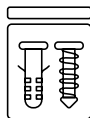

Pack of Screws

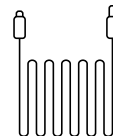

4.5m Power
Extension Cable

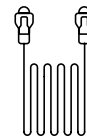

1m
Network Cable

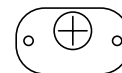

Mounting
Template



Quick
Start Guide



Surveillance
Sign

Camera Introduction

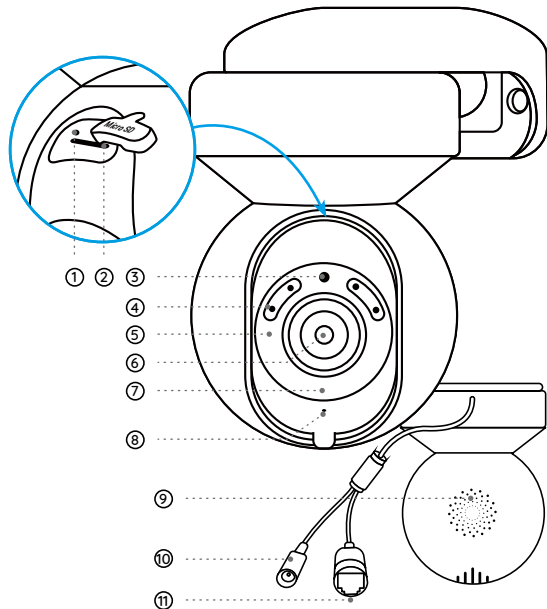

① Reset Button

* Press for more than five seconds to restore the device to default settings.

② Micro SD Card Slot

* Rotate the lens to find the reset button and the SD card slot.

③ Daylight Sensor

④ Spotlight

⑤ Infrared Lights

⑥ Lens

⑦ Status LED

⑧ Built-in Mic

⑨ Speaker

⑩ Power Cable

⑪ Network Cable

Different states of the status LED:

- Red Light: WiFi connection failed
- Blue Light: WiFi connection succeeded

- Blinking: Standby status
- On: Working status

Set up the Camera

Wired Setup

It is recommended that the initial setup be completed with the Ethernet cable. You may follow the steps below to set up your camera.

- Step 1 Connect the camera to a LAN port on your router with an Ethernet cable.
- Step 2 Use the power adapter provided to power on the camera.

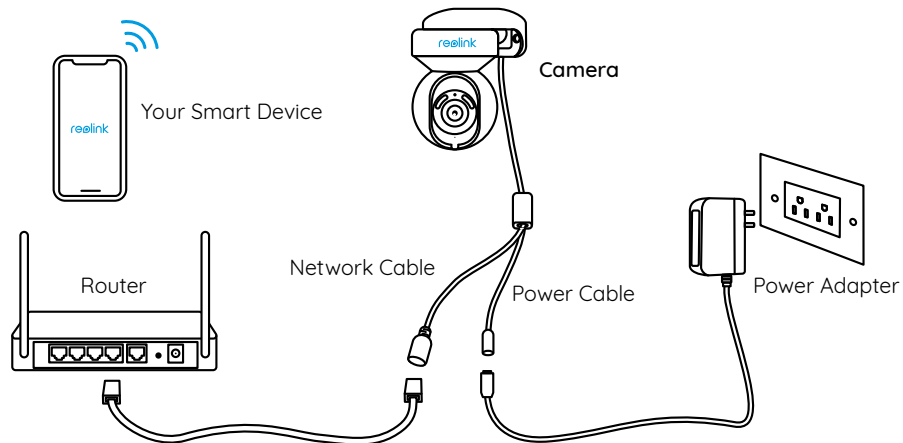

Step 3 Download and Launch the Reolink App or Client software, and follow the onscreen instructions to finish initial setup.

• On Smartphone

Scan to download the Reolink App.



• On PC

Download path of the Reolink Client: Go to <https://reolink.com> > Support > App & Client.

Wireless Setup

If you set up Camera without the Ethernet cable, you may follow the steps below.

NOTE: This device supports 2.4 GHz and 5 GHz Wi-Fi networks. It is recommended to connect the device to 5 GHz Wi-Fi for a better network experience.

Step 1 Use the power adapter provided to power on the camera.

Step 2 Launch the Reolink App, click the “+” button in the top right corner to add the camera. Scan the QR code on the device and follow the onscreen instructions to finish initial setup.

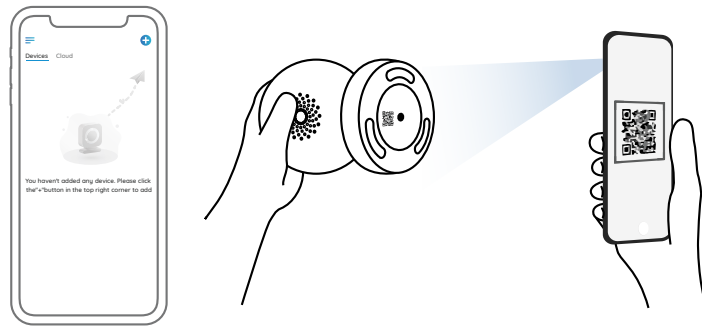

NOTE: If you access the camera via the Reolink Client, you may click the Add Device icon and choose the UID option to enter the UID of your camera. The UID is on the camera body (right below the QR code).

Install the Camera

Mount the Camera to the Wall

For outdoor use, the camera must be installed upside down for better waterproof performance.

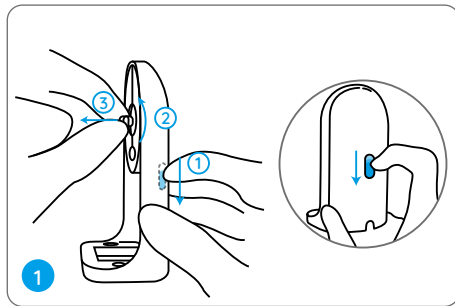

Pull the button of the security mount and unscrew the bracket to separate the two parts.

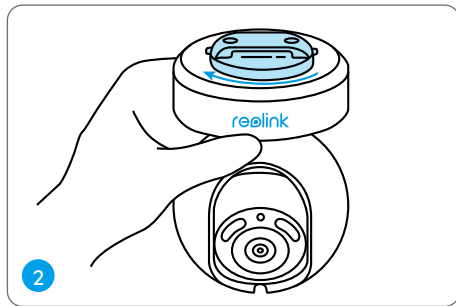

Screw the bracket to the bottom of the camera.

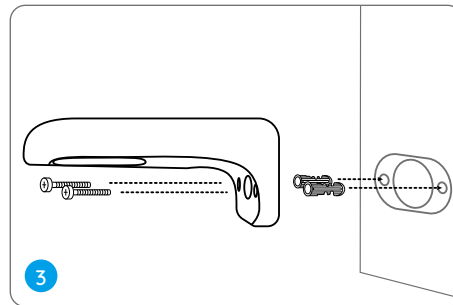

Drill holes in accordance with the mounting template and screw the security mount to the wall.

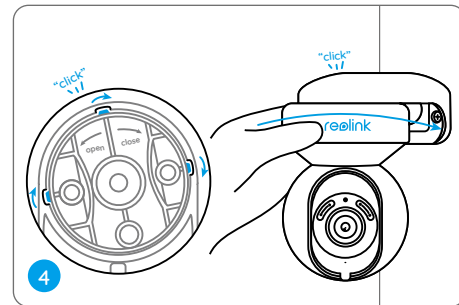

Choose a proper direction of the camera and then align the bracket to the security mount and lock the camera in place by turning anti-clockwise.

NOTE: Use the drywall anchors included in the package if needed.

Mount the Camera to the Ceiling

Pull the button of the security mount and unscrew the ceiling bracket from the mount.

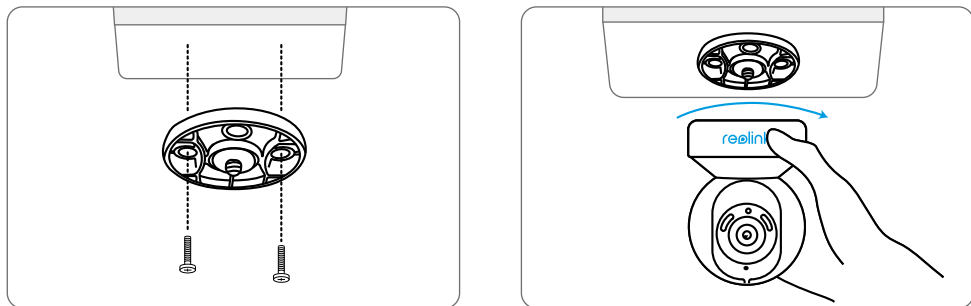

Install the bracket to the ceiling. Align the camera with the bracket and turn the camera unit clockwise to lock it in position.

Troubleshooting

Camera is Not Powering on

If your camera is not powering on, please try the following solutions:

- Plug the camera into another outlet.
- Use another 12V power adapter to power on the camera.

If these won't work, please contact Reolink Support.

WiFi Connection Failed During Initial Setup Process

If the camera failed to connect to WiFi, please try the following solutions:

- Please ensure you have entered the correct WiFi password.
- Put your camera close to your router to ensure a strong WiFi signal.
- Change the encryption method of the WiFi network to WPA-PSK/WPA2-PSK/WPA3-PSK (safer encryption) on your router interface.
- Change your WiFi SSID or password and

make sure that SSID is within 31 characters and password is within 64 characters.

- Set your password using only the characters on the keyboard.

If these won't work, please contact Reolink Support.

Specifications

Operating Frequency: 2.4/5GHz Dual-band

Operating Temperature:
-10°C to 55°C (14°F to 131°F)

Size: 85×118 mm

Weight: 395g

For more specifications, please visit
<https://reolink.com/>

Notification of Compliance

 CE Declaration of Conformity

Reolink declares that this device is in compliance with the essential requirements

and other relevant provisions of Directive 2014/53/EU and Directive 2014/30/EU.

UKCA Declaration of Conformity

Reolink declares that this product is in compliance with Radio Equipment Regulations 2017 and Electromagnetic Compatibility Regulations 2016.

FCC Compliance Statements

This device complies with Part 15 of the FCC Rules. Operation is subject to the following two conditions: (1) this device may not cause harmful interference, and (2) this device must accept any interference received, including interference that may cause undesired operation.

NOTE: This equipment has been tested and found to comply with the limits for a Class B digital device, pursuant to Part 15 of the FCC Rules. These limits are designed to provide reasonable protection against harmful interference in a residential installation. This equipment generates, uses and can radiate radio frequency energy and, if not installed and used in accordance with the instructions,

may cause harmful interference to radio communications. However, there is no guarantee that interference will not occur in a particular installation. If this equipment does cause harmful interference to radio or television reception, which can be determined by turning the equipment off and on, the user is encouraged to try to correct the interference by one or more of the following measures:

- Reorient or relocate the receiving antenna.
- Increase the separation between the equipment and receiver.
- Connect the equipment into an outlet on a circuit different from that to which the receiver is connected.
- Consult the dealer or an experienced radio/TV technician for help.

Caution: Changes or modifications not expressly approved by the party responsible for compliance could void the user's authority to operate the equipment.

FCC Radiation Exposure statement

This equipment complies with FCC radiation exposure limits set forth for an uncontrolled environment. This equipment should be in-

stalled and operated with minimum distance 20cm between the radiator and your body.

ISED Compliance Statements

This device contains licence-exempt transmitter(s)/receiver(s) that comply with Innovation, Science and Economic Development Canada's licence-exempt RSS(s). Operation is subject to the following two conditions:
(1) This device may not cause interference.
(2) This device must accept any interference, including interference that may cause undesired operation of the device.

L' émetteur/récepteur exempt de licence contenu dans le présent appareil est conforme aux CNR d'Innovation, Sciences et Développement économique Canada applicables aux appareils radio exempts de licence. L' exploitation est autorisée aux deux conditions suivantes :
(1) L' appareil ne doit pas produire de brouillage;
(2) L' appareil doit accepter tout brouillage radioélectrique subi, même si le brouillage est susceptible d'en compromettre le fonctionnement.

ISED Radiation Exposure statement

This equipment complies with IC RSS-102 radiation exposure limits set forth for an uncontrolled environment. This equipment should be installed and operated with minimum distance 20 cm between the radiator and your body.

Cet équipement est conforme aux limites d'exposition aux radiations IC CNR-102 établies pour un environnement non contrôlé. Cet équipement doit être installé et utilisé avec une distance minimale de 20 cm entre le radiateur et votre corps. Cet émetteur ne doit pas être colocalisé ou fonctionner en conjonction avec une autre antenne ou un autre émetteur.

NOTE: Operation of 5150-5250 MHz is restricted to indoor use only in Canada.



Correct Disposal of This Product

This marking indicates that this product should not be disposed with other household wastes throughout the EU. To prevent possible harm to the environment or human health from uncontrolled waste disposal, recycle it responsibly to promote the sustainable reuse

of material resources. To return your used device, please use the return and collection systems or contact the retailer where the product was purchased. They can take this product for environmentally safe recycling.

Limited Warranty

This product comes with a 2-year limited warranty that is valid only if purchased from Reolink Official Store or a Reolink authorized reseller. Learn more: <https://reolink.com/warranty-and-return/>.

Terms and Privacy

Use of the product is subject to your agreement to the Terms of Service and Privacy Policy at reolink.com. Keep out of reach of children.

WiFi Operating Frequency

OPERATING FREQUENCY :
(the maximum transmitted power)
2.4GHz: (For 2.4GHz camera only):
2412MHz --- 2472MHz (EIRP < 20 dBm)
5GHz:
5150MHz --- 5250MHz (EIRP < 23 dBm)
5745MHz --- 5825MHz (EIRP < 14 dBm)



The functions of Wireless Access Systems including Radio Local Area Networks(WAS/RLANs) within the band 5150-5350 MHz for this device are restricted to indoor use only within all European Union countries (BE/BG/CZ/DK/DE/EE/IE/EL/ES/FR/HR/ IT/CY/LV/LT/LU/HU/MT/NL/AT/PL/PT/RO/SI/SK/FI/SE/TR/NO/CH/IS/LI/UK(NI))

Technical Support

If you need any technical help, please visit our official support site and contact our support team before returning the products, <https://support.reolink.com>.

For USA: The frequency stability of all transmission frequencies of U-NII-1, U-NII 2A, U-NII 2C and U-NII-3 meets the requirements of 47 CFR FCC Part15.407(g), and the manufacturer declares that their transmission is maintained at Band U-NII-1, U-NII 2A, U-NII 2C and U-NII-3.

For Canada: The frequency stability of all transmission frequencies of U-NII-1, U-NII 2A, U-NII 2C and U-NII-3 meets the 47 CFR FCC Part15.407(g) requirements, and the manufacturer states that their transmissions remain within the U-NII-1, U-NII 2A, U-NII 2C and U-NII-3 bands.

Pour le Canada : La stabilité de fréquence de toutes les fréquences de transmission de U-NII-1, U-NII 2A, U-NII 2C et U-NII-3 est conforme aux exigences 47 CFR FCC Part15.407(g), et le fabricant déclare que leurs transmissions restent dans les bandes U-NII-1, U-NII 2A, U-NII 2C et U-NII-3.

Manufacturer Info

Reolink Innovation Limited

FLAT/RM
7057/F FA YUEN COMMERCIAL BUILDING
75-77 FA YUEN STREET MONG KOK KL
HONG KONG

Factory Name: Shenzhen Reolink
Technology Co., Ltd

Factory Address: 2-4th Floor, Building 2,
Yuanling Industrial Park, ShangWu, Shiyan
Street, Bao'an District, Shenzhen, China