

size:92x276mm

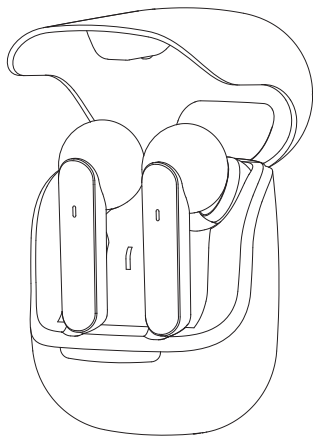

T103

TRUE WIRELESS EARPHONE

USER MANUAL

Wireless Earphones:

True Wireless Earphones to achieve realize wireless stereo, separate left and right channels, HIFI sound effect, both left and right earphones with complete wireless function, it can be used alone or in pairs, and support dual microphone calls.

Specifications:

Wireless Version:	V5.0	Sensitivity:	100 ± 3 dB
Working Distance :	10M	Frequency Range:	20Hz-20KHz
Battery Specifications:	30mAh	Driver:	8 MM
Playing time:	4 Hours	Impedance:	32Ohm S.PL (at 1KHz)
Charging time :	1.5 Hour		

Charging case:

Battery Specification:	400mAh (Earphones can be charged 5 times.)
Charging Voltage:	DC4.5-5.5V
Charging time:	2 Hours

Function

On/Off	Power on: Take out the earphones from the charging case, it will turn on automatically. Power off: Put the earphones into the charging case, it will turn off automatically.
Pairing	When you take out both earphones from the charging case at the same time, they will be paired automatically. The red and blue LED indicator will flash alternatively until both earphones are paired successfully. At this time, the earphones are ready to be paired with your mobile phone. The LED indicator will turn blue after successful connection. (Support single earphone connection)
Play/Pause	Pause: Double-press the touching area on either side to pause. Play: Double-press the touching area again to play.
Phone Calls	Answer the Call: Double-press the touching area on either side to answer the call. Hang up the Call: Double-press again to hang up the call. Reject the Call: Long press 2 seconds to reject the call.

Voice Assistant	Long press the touching area for 3 seconds to start the phone's voice assistant.
Earphone Charging	Put the earphones into the charging case, the earphones will automatically shut down and enter the charging state. The LED indicator will turn red while charging and turn solid blue when fully charged.
Charge the Case	Insert the small connector of the supplied Type-C charging cable into the USB charging port at the bottom of the charging case. Insert the larger connector of the supplied Type-C charging cable into the USB port on a computer, or a charging device containing a USB port, or a 5V USB adapter. The LED indicator light will turn solid blue when fully charged. The LED indicator light will turn solid green while the earphone is charging and will keep on for 10 seconds once fully charged, then it will turn off.

Attention:

- Please do not treat the product with violence, and do not squeeze the product with heavy objects. Keep away from high temperature and humidity
- For the best performance, please avoid close contact with WIFI or router, otherwise it may affect the wireless signal or disconnect.
- Please use this product within the effective distance environment (10 meters), and there should be no physical obstacles between the wireless device and the earphone block (such as a high wall.)

NOTE:

If you have any problem during the use of the product or if you have any suggestion for us, please don't hesitate to contact our after-sale team. We have a professional after-sale customer service team who will reply you in 24 hours. For After-Sale Customer Service or Technical Support, please contact

aftersale.us@gpheadphone.com

Functional operation diagram

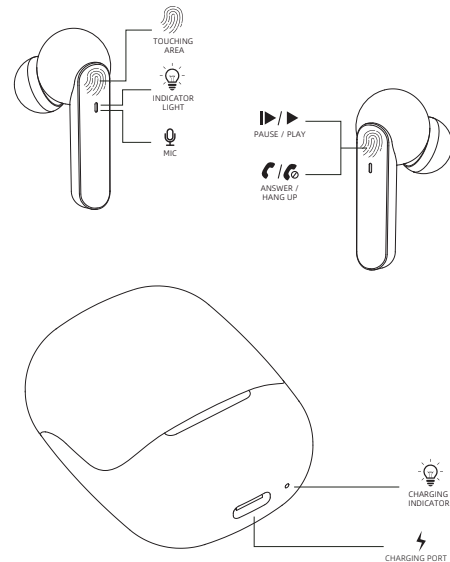

FCC Statement

This equipment has been tested and found to comply with the limits for a Class B digital device, pursuant to part 15 of the FCC Rules. These limits are designed to provide reasonable protection against harmful interference in a residential installation. This equipment generates, uses and can radiate radio frequency energy and, if not installed and used in accordance with the instructions, may cause harmful interference to radio communications. However, there is no guarantee that interference will not occur in a particular installation. If this equipment does cause harmful interference to radio or television reception, which can be determined by turning the equipment off and on, the user is encouraged to try to correct the interference by one or more of the following measures:

- Reorient or relocate the receiving antenna.
- Increase the separation between the equipment and receiver.
- Connect the equipment into an outlet on a circuit different from that to which the receiver is connected.
- Consult the dealer or an experienced radio/TV technician for help.

Caution: Any changes or modifications to this device not explicitly approved by manufacturer could void your authority to operate this equipment.

This device complies with part 15 of the FCC Rules.

Operation is subject to the following two conditions: (1) This device may not cause harmful interference, and (2) this device must accept any interference received, including interference that may cause undesired operation.

RF Exposure Information

The device has been evaluated to meet general RF exposure requirement. The device can be used in portable exposure condition without restriction.