

OKAI SH10

User Manual

Quick Start Guide & Terms of Warranty

Table of Contents

1. Introduction	02
1-1. Product Diagram	03
2. Packing List	04
3. Wearing the Helmet	05
3-1. Putting the Helmet On	05
3-2. Examples of Improper Wear	05
4. Instructions	06
5. Technical Specifications	11
6. Notes	12
7. Bluetooth Notes	13
8. OKAI Warranty Details	14
8-1. Terms of Warranty	14
8-2. Warranty Description	14
9. Wearing the Helmet: Warnings and Instructions	15
10. Electronic Function Troubleshooting	15
10-1. Problems	15

1. Introduction

Thank you for purchasing the OKAI smart helmet.

This guide will provide tips on how to better use the product. This guide may be updated as we continue to refine our products. You can obtain the latest version of this guide and learn more about OKAI from our official website (www.okai.co).

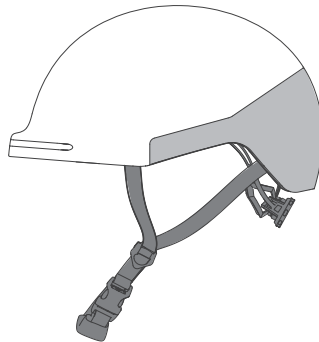

* The picture is for reference only. Please refer to the actual product for more details.

OKAI

1-1. Product Diagram

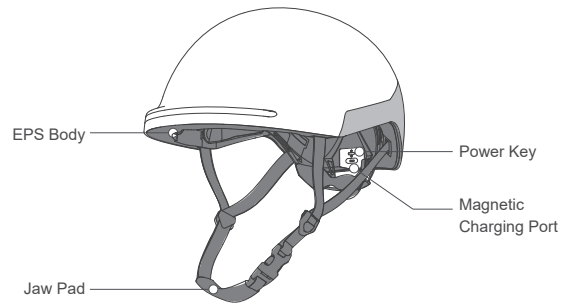
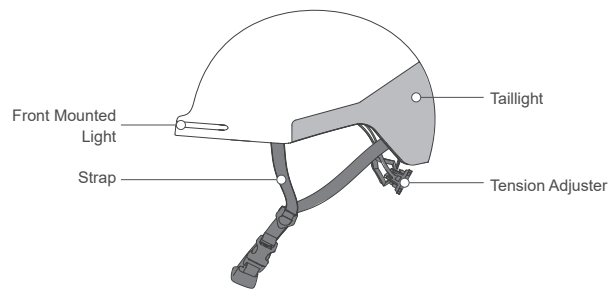

Dimensions (cm): 27.8 × 22 × 16.5 (L × W × H)
10.94 × 8.66 × 6.5 (in)

2. Packing List

- ① Smart Helmet : × 1
- ② Remote controller : × 1
- ③ Quick Start Guide : × 1
- ④ Dust-proof storage bag : × 1
- ⑤ Magnetic USB Charging Cable : × 1

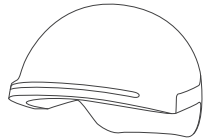

X1



X1

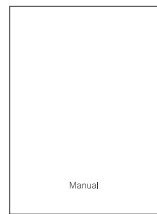

X1



X1

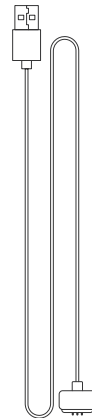

X1

3. Wearing the Helmet

3-1. Putting the Helmet On



1. Adjust the length of the strap.

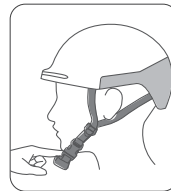

2. Leave a finger-sized gap between the strap and chin.

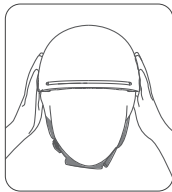

3. Straighten the helmet.

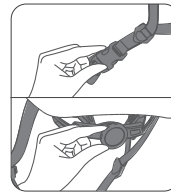

4. Check if the buckle is proper.

3-2. Examples of Improper Wear



The helmet is not level.



The helmet is not fastened.

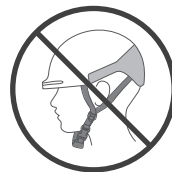

The helmet is tilted forward.

4. Instructions

This section provides information on how to use the product correctly. Following these instructions is critical to ensure user safety.

1. Power On

Press the Power Key to power on the Smart Helmet. The back panel of the helmet will display "OKAI" to indicate that the power on was successful.

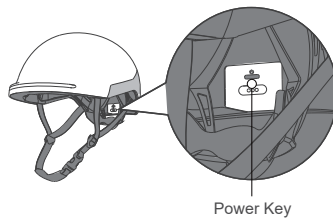

2. Power Off

Press and hold the Power Key for 3 seconds to power off the Smart Helmet. When powering off, the back panel of the helmet will display a countdown as visual confirmation.

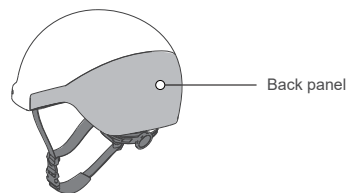

3. Connect APP instructions

*Please scan the QR code on the package or enter the APP store to search for OKAI and download the OKAI APP to connect.



1.Register and log in

2.Click search device

3.Connect the device

4.Get started

*If you owned another vehicle of OKAI brand, then you can pair between the helmet and the vehicle.



Pair the vehicle

4. Light Display Switch

Once the Smart Helmet is connected to the OKAI app, you can configure and adjust the display of its front and rear mounted lights.



Front Light
Configuration



Rear Light
Configuration



Cycling Light
Configuration

5. Brake Lights

Once the smart helmet is connected to the app, you can configure and adjust the display of its brake light.



Brake Light
Configuration

6. Motion control

The smart helmet supports motion control functions, such as making and cancelling a turn. Please learn more in APP.

7. Automatic Shutdown

The helmet will automatically shut down if it remains stationary for over 3 minutes.

8. Smart helmet charging

•Use the magnetic USB charging cable to connect the magnetic charging port with a power source. The rear light of the helmet will display red to indicate charging or green to indicate a full charge.

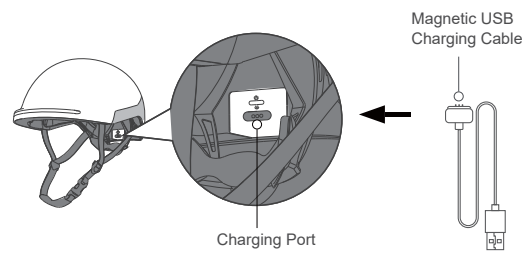

9. Remote controller

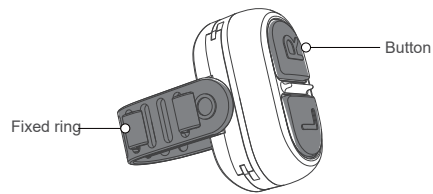

•Remote controller charging

First separate the remote control from the strap, use the magnetic USB charging port to connect the remote charging contact, the L button will illuminate a red light to indicate that charging is being made, and the R button will illuminate a green light to indicate that charging is complete.

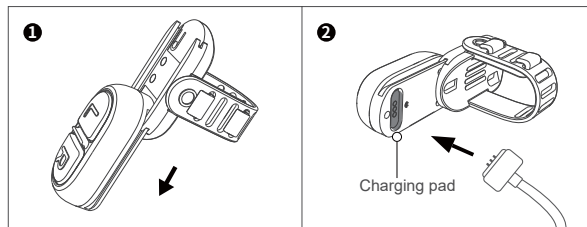
**•Fixed ring**

Bend the strap upwards, snap it into the slot and fix it to the handlebar.

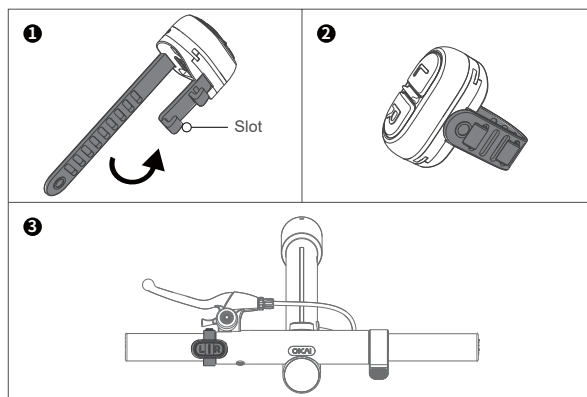

5. Technical Specifications

Item	Contents	SH10
Helmet	External Dimensions (L × W × H)	27.8 × 22 × 16.5 cm 10.94 × 8.66 × 6.5 in
	Size Range	US:58 ~ 61 cm EU:58 ~ 62 cm 22.83 ~ 24.41 in
	Battery Life	4~8h
	Exterior Materials	Modified Explosion-Proof ABS
	Waterproof Rating	IPX4
	Charging Port	Magnetic Charging Port
	Operating Temperature	0 C ~ 40 C
	Storage Temperature	-15 C ~ 45 C
	Charge Temperature	0 C ~ 40 C
Battery	Battery Specifications	3.85V/2400mAh
	Operating Voltage	3.3V — 4.2V
	Amperage	0.8A
	Electrical Parameters	3W/3.85V
	Charge Time	Up to 3 hrs
Bluetooth	Frequency Band (s)	2.4000-2.4835GHz
	Max Frequency Band Power	20mW

* These specifications are subject to change without notice.

* The above data was measured by OKAI Laboratory at a room temperature of 25°C and specific lighting modes. During use, there may be differences due to changes in the actual environment.

6. Notes

- The helmet contains electronic functions. While the helmet is protected against short-term splashes and rain, it should not be exposed to long periods of rain.
- The helmet contains a 3.85V/2400mAh battery, the capacity of which will change with ambient temperature. When used in low temperatures or environments lower than 0°C, the battery life of the product may be reduced.
- Do not clean the golden contacts of the charging port with metallic or other hard tools such as blades and tweezers. If you must clean the contacts, wipe with a cotton swab of water or alcohol. Ensure the charging port remains clean and dry during the charging process.
- If the electronic functions do not work or behave abnormally, charge the helmet for 3 hours before trying again.
- The internal battery of the helmet must not be disassembled, squeezed, heated, or burned under any circumstances. Do not use sharp objects such as screwdrivers to pierce or pry open the battery. Failure to follow these guidelines may result in ignition of the battery and injury.
- To prevent damage, do not store the helmet with sharp objects.
- The helmet can only protect if it fits well and that the buyer should try different sizes and choose the size which feels secure and comfortable on the head.
- The helmet should be adjusted to fit the user, e.g. the straps positioned so that they do not cover the ears, the buckle positioned away from the jawbone and the straps and buckle adjusted to be both comfortable and firm.
- The helmet should be placed so as to protect the forehead and not be pushed too far over the back of the head.
- The helmet cannot always protect against injury.
- If the helmet is subjected to severe impact, it should not be used again and discarded and destroyed as its protective ability will be severely reduced.
- Do not modify or remove any of the original components of the helmet other than recommended by OKAI and the helmet should not be adapted for the purpose of fitting accessories in a way not recommended by OKAI.
- No helmet can protect against all possible impacts. For maximum protection, the helmet must be fitted and attached properly to the wearer's head in accordance with the manufacturer's fitting instructions.
- No longer adequate to protect the head against further impacts, and that this damage may not be visible to the user.
- The helmet that has sustained an impact should be returned to the manufacturer for component inspection or be destroyed and replaced.
- The helmet can be damaged by contact with common substances (for example, certain solvents, cleaners, hair tonics etc.) and that this damage may or may not be visible to the user.

 To maintain battery life, we recommend that you fully charge the helmet before each period of long-term (three months) storage.

7. Bluetooth Notes

Any Changes or modifications not expressly approved by the party responsible for compliance could void the user's authority to operate the equipment.

 **NOTE:** This equipment has been tested and found to comply with the limits for a Class B digital device, pursuant to part 15 of the FCC Rules. These limits are designed to provide reasonable protection against harmful interference in a residential installation. This equipment generates, uses and can radiate radio frequency energy and, if not installed and used in accordance with the instructions, may cause harmful interference to radio communications. However, there is no guarantee that interference will not occur in a particular installation. If this equipment does cause harmful interference to radio or television reception, which can be determined by turning the equipment off and on, the user is encouraged to try to correct the interference by one or more of the following measures:

1. Reorient or relocate the receiving antenna.
2. Increase the separation between the equipment and receiver.
3. Connect the equipment into an outlet on a circuit different from that to which the receiver is connected.
4. Consult the dealer or an experienced technician for help.
5. Hereby, Zhejiang Okai Vehicle Co., Ltd. declares that the radio equipment type Smart Helmet SH10 is in compliance with Directive 2014/53/EU. The full text of the EU declaration of conformity is available at the following internet address:
<https://www.okai.co/>

 **RF exposure warning:** The device has been evaluated to meet general RF exposure requirement. The device can be used in portable exposure condition without restriction.

This device complies with part 15 of the FCC Rules. Operation is subject to the following two conditions: (1) This device may not cause harmful interference, and (2) this device must accept any interference received, including interference that may cause undesired operation.

8. OKAI Warranty Details

8-1. Terms of Warranty

- If there are any inconsistencies with or omissions from national regulations below, the national regulations will prevail.
- This product includes a free product defect warranty period of one year from the date of purchase. A replacement will be issued within 15 days after a quality check.
- OKAI does not assume warranty liability for other attached items of the product (e.g., the quick start guide and packaging).

8-2. Warranty Description

The scope of the warranty service is limited to normal use only. The warranty is not valid for any damages caused by factors other than quality defects in one of the following scenarios. In these circumstances, OKAI provides repairs at a fee.

- The warranty period has expired.
- The user has no proof of warranty or valid invoice, except in cases where the user can otherwise prove the product is within a valid warranty period.
- The contents of the proof of warranty do not correspond with the physical nature of the product or have been altered.
- The product was damaged by the user's failure to store, maintain, or use the product according to instructions.
- The product was damaged by disassembly from a service store not authorized by OKAI.
- The product was damaged by a force majeure event.
- The product has experienced natural wear and tear in areas such as the exterior, keys, paint, and accessories.
- The product has other failures, defects, or blemishes not attributable to OKAI.

9. Wearing the Helmet: Warnings and Instructions

- Users should select a helmet that fits their head size.
- The strap must be fastened during use.
- Stop using the helmet or examine it for significant damage in the event of a major impact.
- Do not apply impact to the helmet or scrub it with corrosive solvents.
- The life cycle of the helmet is 3 years.
- Do not alter the structure of the helmet.
- Proper use of a sports helmet can effectively reduce injuries, but cannot prevent them completely.
- Protect the product from collision, moisture, and organic chemicals during transportation and storage.

10. Electronic Function Troubleshooting

If any of the problems listed below occur during use, charge the helmet in accordance with the charge time of the quick start guide. The helmet can be reset during the charging process. If problems persist, contact an after-sales service center.

After-Sales Hotline (PRC): 4008821787

After-Sales Email (International): support@okai.co

10-1. Problems

1. The helmet does not charge or power on normally.
2. Functions such as the lights or loudspeaker do not work or behave abnormally when the helmet has been powered on.
3. The helmet shuts down automatically soon after being powered on.