

DMX/Bluetooth Constant Voltage LED Controller

- Small size and light weight. The housing is made from V0 flame retardant PC materials from SAMSUNG/COVESTRO.
- Bluetooth 5.0 SIG Mesh with high networking capability is reliable and stable.
- Support DMX512/RDM and realize Bluetooth/DMX intelligent switch control.
- With soft-on and fade-in dimming function, enhancing your visual comfort.
- Compatible with DIM, CT, RGB, RGBW, RGBWY lights to control the output.
- Provide the options to set dimming parameters that can meet high-level dimming requirements in different occasions.
- Work with the Super Panel to achieve remote control.
- Get control on iOS or Android devices through Bluetooth connection.
- Set the soft start time and power-on lighting status



Technical Specs

Model	B5-DMX-4A-S
Wireless Protocol Type	Bluetooth 5.0 SIG Mesh, DMX/RDM
Output Voltage	5-24Vdc
Input Voltage Range	5-24Vdc
Load Current	4A×5CH / 5A×4CH Max. 20A
Load Power	[0~20W...96W]×5CH Max. 480W
Protection	Short circuit, overcurrent, overheat, anti-reverse protection
Working Temperature	-20°C~55°C
Dimensions	175×44×30mm(L×W×H)
Package Size	178×48×33mm(L×W×H)
Weight (G.W)	130g

Product Size

Unit: mm

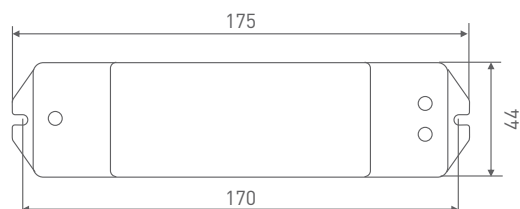

Terminal Description

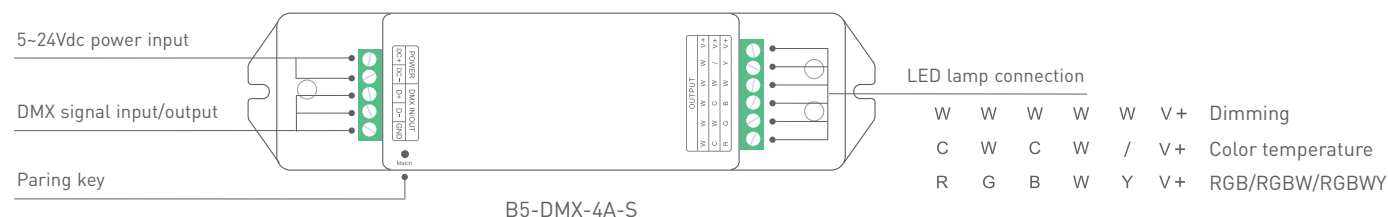

DMX Wiring Diagram

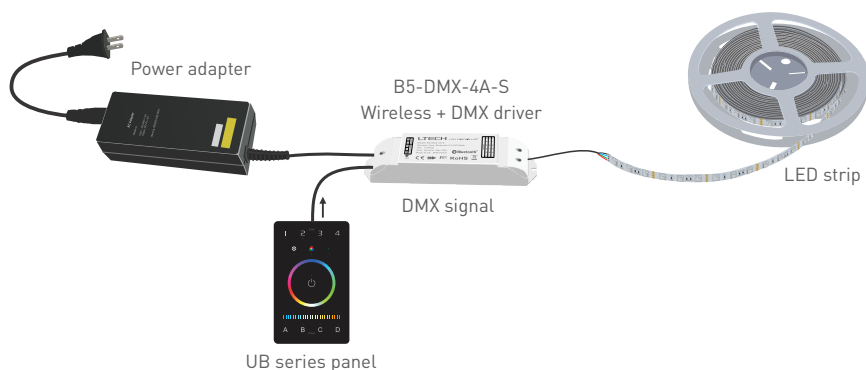

Application Diagram

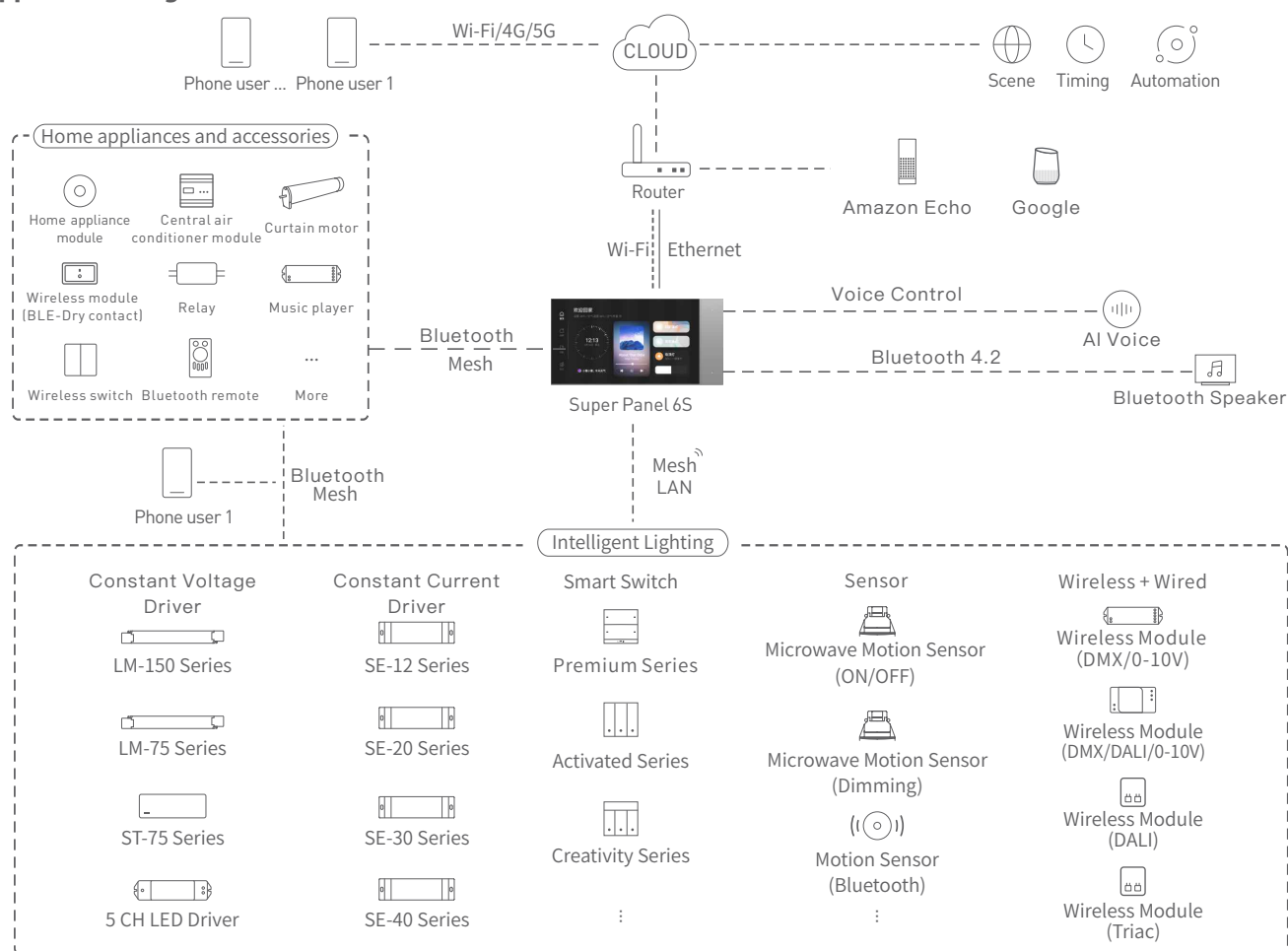

Recommended Applications

- 1、Achieve fast dimming control.

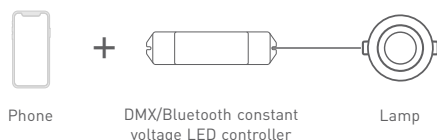

- 2、Both the App and the remote can control the controller after linking up the remote with the controller via the App.

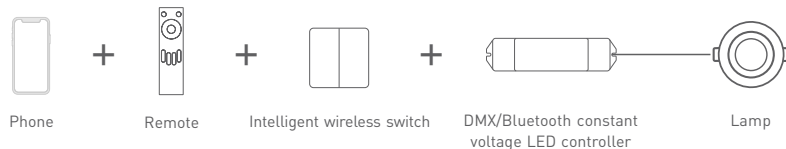

- 3、Both the App and the Super Panel can control the controller after linking up the Super Panel with the controller via the App. By connecting the Super Panel to the network, you are allowed to remotely control the controller, cloud scenes and automation via the App.

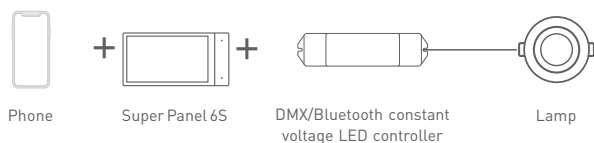

- 4、More applications of intelligent control are waiting for you to set up.

Other Instructions

If the controller works with a remote, gateway ,intelligent wireless switch or other items ,please refer to related manuals.

App Operating Instructions

1. Register an account

1.1 Scan the QR code below with you mobile phone and follow the prompts to complete the app installation.



Scan and download the App

1.2 Open the App and log in or register an account.

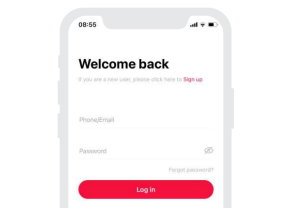

2. Pairing instructions

Create a home if you are a new user. Click "+" icon in the upper right corner and follow the prompts to add the driver first. Then pick "Smart lighting - RGBWY light" from "Add Device" list. Follow the prompts to power on the device first, and make sure the device is not connected to a network yet. Click "Bluetooth Search" to add the device according to the prompts.

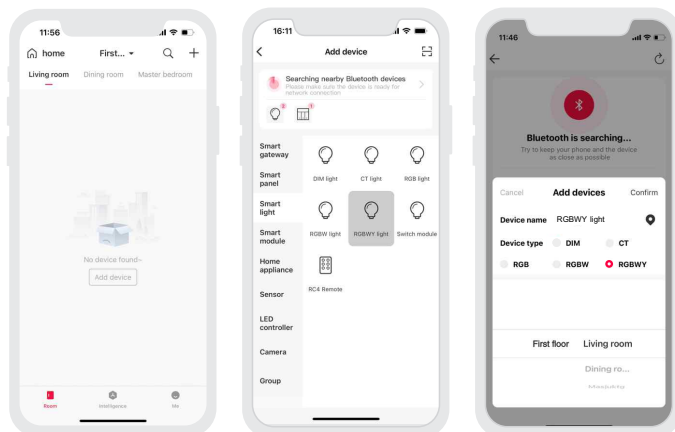

3. Control interface settings

After pairing up your device, go to the control interface. You'll be able to achieve your desired lighting effects by changing brightness, colors and color temperature. Click "Theme" and you'll easily switch to multiple theme lighting effects with one tap. Click "Mode" and the App provides you with editable normal modes and editable advanced modes. Customize dynamic modes to put you into a more colorful life.

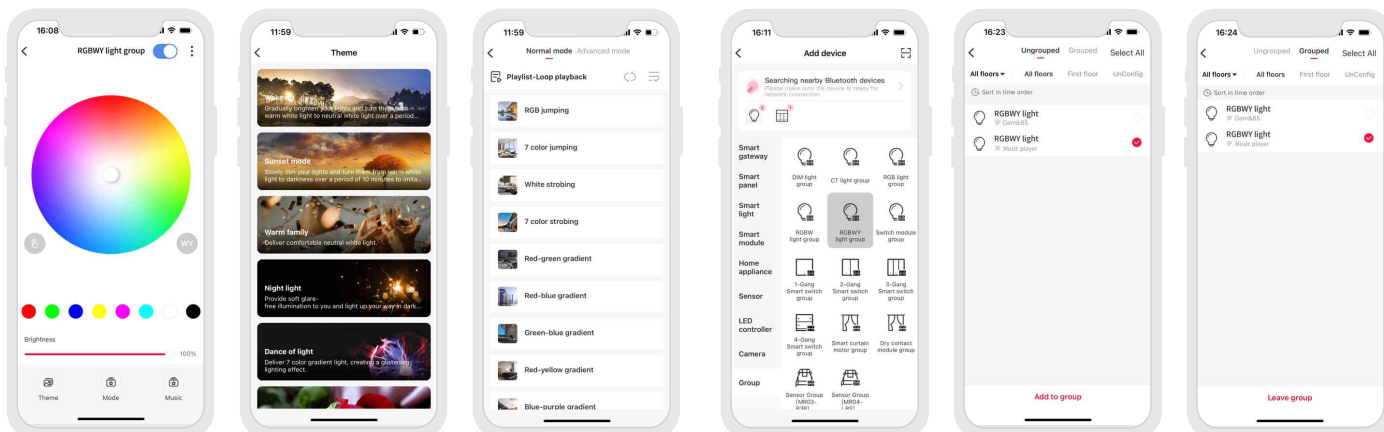

4. Light groups

Users are able to combine the same type of light fixtures into a group to control them simultaneously. Once you create the group, you can set the dim level or change color temperature and colors more easily. Return to the device list and click "Group" - "RGBWY light group". Then follow the prompts to rename the group and pick the lights you are going to group together, and save them.

5. Advanced functions

The controller can be linked up with gateway devices (such as LTECH Super Panel) to achieve the advanced functions, such as cloud scenes and automation.

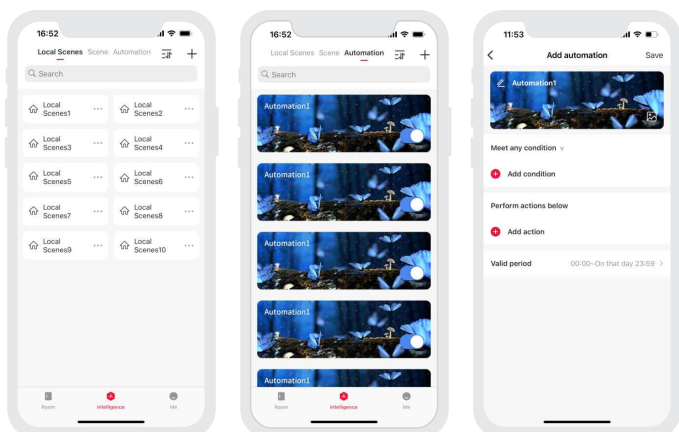

How to reset a device (reset it to factory defaults)

Method 1: After you long press the pairing key for 6s, the lamp will flash 5 times, which means the controller has been set to factory defaults.

Method 2: Make sure the controller is connected to a lamp and keep the lamp on. Turn the controller off with the switch and after 15s turn it on. After 2s, turn it off again. Repeat the same operation 6 times. When the lamp flashes 5 times, the controller has been set to factory defaults.

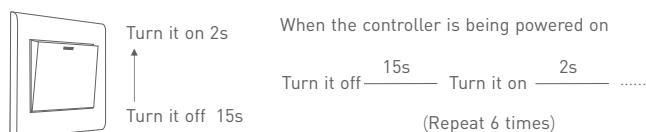

FAQs

1. What should I do if I fail to add the device?
 - 1.1 Please make sure the device is powered on normally.
 - 1.2 Please make sure the device hasn't been added by any other account. If it has, please reset to factory defaults manually.
 - 1.3 The recommended distance between the mobile phone and the device is no more than 20 meters.
 - 1.4 If the device has been forced to delete, please reset to factory defaults manually and then add the device again.
2. What should I do if the device disconnects from the network?
 - 2.1 Please make sure the device is powered on normally.
 - 2.2 Please make sure Bluetooth on your phone is turned on.
 - 2.3 If you control the device remotely, please make sure your phone network runs smoothly.
3. How to control remotely and set cloud scenes?

Remote control and cloud scenes can be achieved only by working with LTECH Super Panel.
4. How to share control of your home devices?

Please go to "Me" - "Home Management" and access the home you want to share. Click "Add Member" and follow the prompts to add members to your home.

Attentions

- Products shall be installed by qualified professionals.
- LTECH products are non-waterproof (special models excepted). Please avoid the sun and rain. When installed outdoors, please ensure it is mounted in a water proof enclosure.
- Good heat dissipation will extend the working life of products. Please ensure good ventilation.
- Please check if the working voltage used complies with the parameter requirements of products.
- The diameter of wire used must be able to load the light fixtures you connect and ensure the firm wiring.
- Before you power on products, please make sure all the wiring is correct in case of incorrect connection that causes damage to light fixtures.
- If a fault occurs, please do not attempt to fix products by yourself. If you have any question, please contact your suppliers.

* This manual is subject to changes without further notice. Product functions depend on the goods. Please feel free to contact our official distributors if you have any question.

Warranty Agreement

- Warranty periods from the date of delivery : 2 years.
- Free repair or replacement services for quality problems are provided within warranty periods.

Warranty exclusions below:

- Beyond warranty periods.
 - Any artificial damage caused by high voltage, overload, or improper operations.
 - Products with severe physical damage.
 - Damage caused by natural disasters and force majeure.
 - Warranty labels and barcodes have been damaged.
 - No any contract signed by LTECH.
1. Repair or replacement provided is the only remedy for customers. LTECH is not liable for any incidental or consequential damage unless it is within the law.
 2. LTECH has the right to amend or adjust the terms of this warranty, and release in written form shall prevail.

Update Log

Version	Updated Time	Update Content	Updated by
A0	20221115	Original version	Yang Weiling

FCC Warning

This device complies with part 15 of the FCC Rules. Operation is subject to the following two conditions: (1) This device may not cause harmful interference, and (2) this device must accept any interference received, including interference that may cause undesired operation.

Any Changes or modifications not expressly approved by the party responsible for compliance could void the user's authority to operate the equipment.

Note: This equipment has been tested and found to comply with the limits for a Class B digital device, pursuant to part 15 of the FCC Rules. These limits are designed to provide reasonable protection against harmful interference in a residential installation. This equipment generates uses and can radiate radio frequency energy and, if not installed and used in accordance with the instructions, may cause harmful interference to radio communications. However, there is no guarantee that interference will not occur in a particular installation. If this equipment does cause harmful interference to radio or television reception, which can be determined by turning the equipment off and on, the user is encouraged to try to correct the interference by one or more of the following measures:

- Reorient or relocate the receiving antenna.
- Increase the separation between the equipment and receiver.
- Connect the equipment into an outlet on a circuit different from that to which the receiver is connected.
- Consult the dealer or an experienced radio/TV technician for help.

This equipment complies with FCC radiation exposure limits set forth for an uncontrolled environment. This equipment should be installed and operated with minimum distance 20cm between the radiator & your body.