

280*100mm

Selfie Stick PTZ Instruction Manual

TM-206

Please read the instruction manual carefully before use

Product introduction

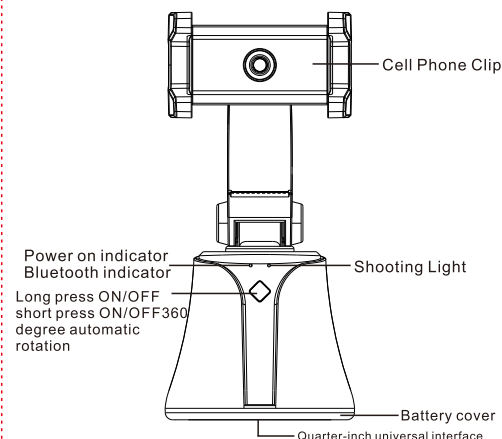

Main function introduction

1. Control smart phone video recording
2. Face tracking

Battery installation

3 AA batteries model

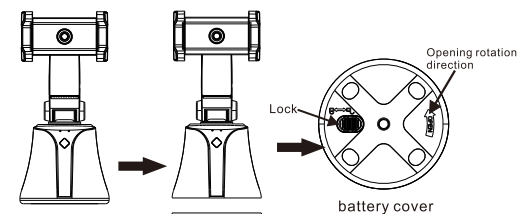

As shown in the figure, when you open the battery cover, turn the lock on the battery cover at the bottom of the product Break to the unlocking direction, and then turn the battery cover in the direction indicated to open it battery cover; then press the positive and negative poles to install 3 AA batteries;

Lithium battery model

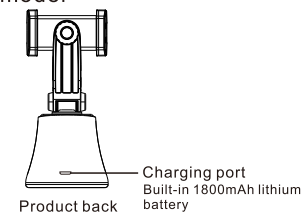

Vertical and horizontal switching

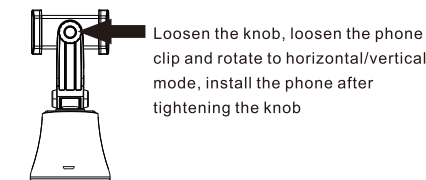

Loosen the knob, loosen the phone clip and rotate to horizontal/vertical mode, install the phone after tightening the knob

APP download

<p>Live 360 APP</p> <p>Live follow</p> <p>iPhone/Android</p> <p>Please search and download in Tencent app treasure</p> <p>ios/Android</p>	<p>Apai Genie</p> <p>Take pictures/ video follow</p> <p>iPhone Android</p> <p>Please search and download in Tencent app treasure</p> <p>ios Android</p>
--	--

User instructions

Install battery

Unscrew the battery cover and insert 3x "AA" batteries according to the direction marked on the battery case. Put back the battery cover.

Install phone

Break apart the phone clip, slide the phone into the direction of the front of the phone lens. Mobile phone clip, just adjust the mobile phone to the right.

Horizontal and vertical screen switching

Loosen the knob, loosen the phone clip and rotate to horizontal/vertical mode, install the phone after tightening the knob.

Power on for use

Long Press Start (start/stop 360 degree automatic rotation function), red light flashing; Long Press Turn Off, red light out.

Connected devices

(1) The AI Live PTZ turns on, the LED light flashes, the AI Live PTZ is waiting for Bluetooth connection State.

(2) Turn on Bluetooth and location information (GPS, location), turn on live 360APP, no manual bluetooth matching, wait 3-6 seconds, AI Live PTZ and APP automatically connected.

(3) When the red light of the AI Live PTZ is on, the Bluetooth icon on the APP interface turns blue, and the AI Live PTZ is automatically connected to the APP Successful connection.

(4) Live 360APP and device connection, Apai Genie APP can be automatically connected.

APP USAGE

(1) The use of live 360APP (live/photo function): Open live 360APP, select live platform (Douyin short video/kuaisou/TikTok/Taobao host) or camera/wechat after such mobile phone custom applications, automatically adjust to the platform, automatically enable face follow mode.

(2) The use of the Apai Genie APP (photo and video function): first connect to the live 360 APP and device, open the live 360 APP, slide down to the custom APP, open the Apai Genie APP in the custom APP, click on the lock symbol on the screen to unlock it, to automatically enable face-following mode.

Special Note

(1) When the AI Live PTZ is connected to the mobile phone, there is no need to manually search for the Bluetooth name, and no need to manually pair Bluetooth.

(2) Some mobile phone models may have Bluetooth connection delay, please wait patiently for Bluetooth Automatic connection is successful, or restart the selfie stick and APP, continue to try to connect automatically.

(3) When using the phone's built-in camera to take pictures, you need to turn on voice control in the camera settings or smile face capture.

Product Parameters

Product Name: Selfie Stick PTZ

Model: TM-206

Support cell phone size: 56-100mm

Power Supply: 3 AA batteries

Working voltage: Lithium battery 3.7V/dry battery 4.5V

Charging voltage: 5V/1A (lithium battery model)

Product Weight: 220g

Product Size: 167*77.6*77.6mm

Mechanical Angle:

360° infinite horizontal rotation

37° vertical flip up

37° Flip down vertically

Quality Inspection: Qualified Products

Support System: ios 10.0 and higher

Android 8.1 and higher

Implementation Standard: GB4943

Warranty Card

Product Model	
Purchase Date	
Customer Name	
Tel	
Address	
Problem Description	

Dealer Information (Signing)

CE RoHS REACH UN38.3 FC Made in China

This device complies with Part 15 of the FCC Rules. Operation is subject to the following two conditions: (1) this device may not cause harmful interference, and (2) this device must accept any interference received, including interference that may cause undesired operation

NOTE: This equipment has been tested and found to comply with the limits for a Class B digital device, pursuant to Part 15 of the FCC Rules. These limits are designed to provide reasonable protection against harmful interference in a residential installation. This equipment generates, uses and can radiate radio frequency energy and, if not installed and used in accordance with the instructions, may cause harmful interference to radio communications. However, there is no guarantee that interference will not occur in a particular installation.

If this equipment does cause harmful interference to radio or television reception, which can be determined by turning the equipment off and on, the user is encouraged to try to correct the interference by one or more of the following measures:

- Reorient or relocate the receiving antenna.
- Increase the separation between the equipment and receiver.
- Connect the equipment into an outlet on a circuit different from that to which the receiver is connected.
- Consult the dealer or an experienced radio/TV technician for help.

Warning: changes or modifications not expressly approved by the party responsible for compliance could void the user's authority to operate the equipment