



**GENEVA**  
**DESKTOP CD SYSTEM**  
**VDTS-5400**



## Instruction Manual

Please read carefully before use and keep for future reference

# WARNING

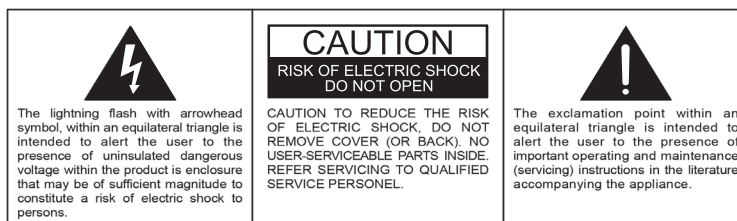

**CAUTION:** To reduce the risk of fire or electric shock, do not expose this appliance to rain or moisture.



**WARNING:** Invisible laser radiation when open and interlock failed or defeated. Avoid direct exposure to laser beam.



This equipment is a Class II or double insulated electrical appliance. It has been designed in such a way that it does not require a safety connection to electrical earth.



Correct Disposal of this product. This marking indicates that this product should not be disposed with other household wastes throughout the EU. To prevent possible harm to the environment or human health from uncontrolled waste disposal, recycle it responsibly to promote the sustainable reuse of material resources. To return your used device, please use the return and collection systems or contact the retailer where the product was purchased. They can take this product for environmentally safe recycling.

## Important Safety Instructions

1. Read these instructions – All the safety and operating instructions should be read before this product is operated.
2. Keep these instructions – The safety and operating instructions should be retained for future reference.
3. Heed all warnings – All warnings on the appliance and in the operating instructions should be adhered to.
4. Follow all instructions – All operating and use instructions should be followed.
5. Do not use this apparatus near water – The appliance should not be used near water or moisture – for example, in a wet basement or near a swimming pool, and the like.
6. Clean only with a dry cloth.
7. Do not block any ventilation openings. Install in accordance with the manufacturer's instructions.
8. Do not install near any heat sources such as radiators, heat registers, stoves, or other apparatus (including amplifiers) that produce heat.
9. Protect the power cord from being walked on or pinched particularly at the plugs, power outlets, and at the point where they exit from the apparatus.
10. Only use attachments/accessories specified by the manufacturer.
11. Use only with the cart, stand, tripod, bracket, or table specified by the manufacturer, or sold with the apparatus. When a cart or rack is used, use caution when moving the cart/apparatus combination to avoid injury from tip-over.
12. Unplug the apparatus during lightning storms or when unused for long periods of time.
13. Refer all servicing to qualified personnel. Servicing is required when the apparatus has been damaged in any way, such as power supply cord or plug is damaged, liquid has been spilled or objects have fallen into the apparatus has been exposed to rain or moisture, does not operate normally, or has been dropped.
14. The mains plug is used as disconnect device, the disconnect device shall remain readily operable.
15. **WARNING:** To reduce the risk of fire or electric shock, do not expose this apparatus to rain or moisture. The apparatus shall not be exposed to dripping or splashing and that no objects filled with liquids, such as vases, shall not be placed on apparatus.
16. The use of the equipment in moderate climate.
17. The ventilation should not be impeded by covering the ventilation openings with items, such as newspapers, tablecloths, curtains, etc.
18. Do not place open flame sources, such as lighted candles, on the apparatus.
19. The symbol with ~ indicates AC voltage.
20. **CAUTION,** These servicing instructions are for use by qualified service personnel only. To reduce the risk of electric shock do not perform any servicing other than that contained in the operating instructions unless you are qualified to do so.



This lightning flash with arrowhead symbol within an equilateral triangle is intended to alert the user to the presence of non-insulated "dangerous voltage" within the product's enclosure that may be of sufficient magnitude to constitute a risk of electric shock. Warning: To reduce the risk of electric shock, do not remove cover (or back) as there are no user-serviceable parts inside. Refer servicing to qualified personnel. The exclamation point within and equilateral triangle is intended to alert the user to the presence of important operating and maintenance instructions in the literature accompanying the appliance.



# TABLE OF CONTENTS

FEATURES-----	3
SPECIFICATIONS-----	3
PRODUCT OVERVIEW-----	4
REMOTE CONTROL-----	5
SETUP & BASIC OPERATION-----	7
LISTENING TO A RECORD-----	8
CONNECTING TO BLUETOOTH®-----	10
USING THE CD PLAYER-----	11
USING THE FM RADIO-----	12
USING THE AUX IN (LINE IN)-----	12
CARE & MAINTENANCE-----	13
TROUBLESHOOTING GUIDE-----	14
FCC NOTICE-----	15
CAUTION ON MODIFICATION-----	16
SUPPORT-----	16

# FEATURES

The Geneva Desktop Stereo System with Turntable delivers powerful music playback with a retro style reminiscent of past Stereo Systems. Packed with features including CD & Bluetooth Playback, 3 Speed Turntable, 25X2 Watts of Power, Fully Functioning VU Meters, and detached Speakers with removable covers, the Geneva delivers!

- Built-in CD Player and full function remote control
- 3 Speed Turntable
- Bluetooth In connectivity allows you to stream music from another source up to 33 feet away
- 25 X 2 Watts of Dynamic Stereo Sound
- Digital FM Radio with a backlit display; FM antenna is included
- Fully functioning VU Meters provide a great retro style
- Includes a 3.5mm Aux input and Headphone Jack for additional playback options
- Detached Speakers with removable grills allow for different

# SPECIFICATIONS

Product Name	GENEVA (Desktop CD Stereo System with Turntable)
FM Frequency Range	87.5 – 108 MHz
FM Station Memory	Up to 20
Bluetooth® Version	V5.3
Bluetooth® Transmission Distance	Up to 33 Feet (10 Meters)*
Rated Frequency	2.4GHz
CD Formats	CD, CD-R, CD-RW
Turntable	33 1/3 / 45 / 78
Input	Aux In
Output	Headphone x 1
Built-in Speaker	(4"+2"+2") x 2
Power Output	25W x 2
Power Source	AC/DC 100-240V 50-60Hz 15V/3A
Accessories Included	UL Approved Adapter, Remote Control (Requires 2x AAA batteries (not included), User Manual, Quick Set Up Guide

*\*Distance may vary depending on any objects or interference between devices.*

SPECIFICATIONS AND ACCESSORIES ARE SUBJECT TO CHANGE WITHOUT NOTICE

# PRODUCT OVERVIEW

1. TURNTABLE
2. DUST COVER
3. TONE ARM WITH STYLUS
4. TONE ARM
5. 45 RPM ADAPTER
6. TONE ARM ON/OFF LEVER
7. AUTO STOP CONTROL SWITCH
8. SPEED SELECTOR (33/45/78 RPM)
9. HOLD DOWN CLIP
10. TONE ARM REST
11. VU METERS
12. ◀◀ / TUN- BUTTON
13. ■ STOP BUTTON
14. SOURCE BUTTON
15. STANDBY BUTTON
16. SENSOR
17. AUX IN JACK
18. PHONES JACK
19. CD DOOR
20. ▲ OPEN BUTTON
21. DISPLAY
22. ▶▶ / PAIR / SCAN BUTTON
23. ▶▶ / TUN+ BUTTON
24. MEM / PROG BUTTON
25. REPEAT / M- BUTTON
26. M+ / CLK SET BUTTON
27. BALANCE KNOB
28. TREBLE KNOB
29. BASS KNOB
30. VOLUME KNOB
31. LINE OUT RCA JACK (TURNTABLE)
32. LINE IN RCA JACK (MAIN UNIT)
33. SPEAKER TERMINAL JACK
34. DC INPUT JACK (TURNTABLE)
35. FM ANTENNA
36. DC IN JACK FOR MAIN UNIT POWER
37. DC OUT JACK (TO CONNECT ITEM 34)

Turntable

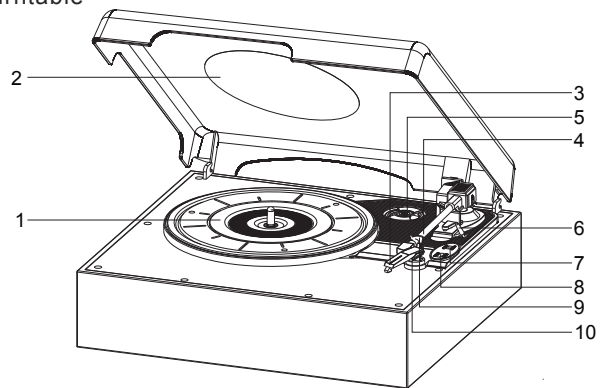

Front View

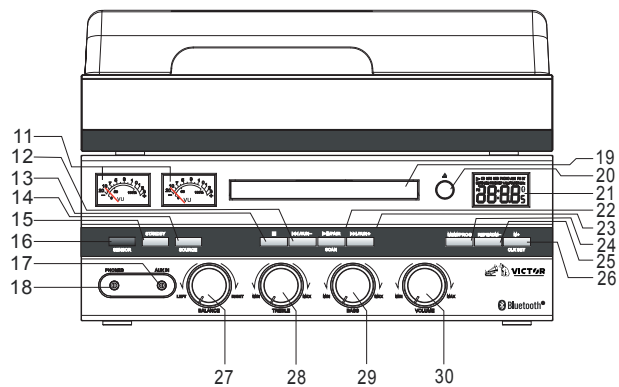

Rear View

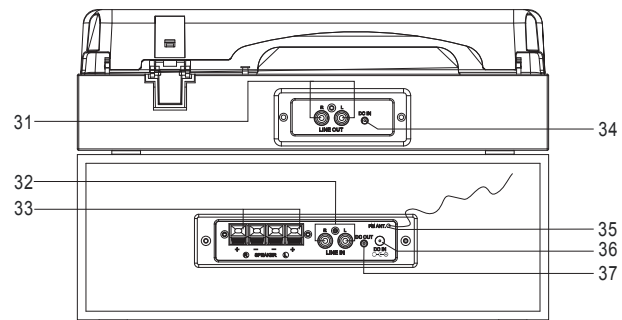

# REMOTE CONTROL

Remote Control - Requires 2x AAA batteries (Not Included)

1. FM BUTTON
2. POWER BUTTON
3. CD BUTTON
4. PHONO BUTTON
5. MEM BUTTON
6. REPEAT BUTTON
7. TUN- / ⏮️ BUTTON
8. VOL- BUTTON
9. CLK SET BUTTON
10. BT BUTTON
11. MUTE BUTTON
12. AUX BUTTON
13. MEM+ BUTTON
14. MEM- BUTTON
15. OPEN / CLOSE BUTTON: In CD mode, open or close CD tray.
16. SCAN / PROG BUTTON:
17. ▶️⏸️ PLAY PAUSE BUTTON
18. TUN+ / ⏭️ BUTTON
19. ■ STOP BUTTON: Stop playback
20. VOL+ BUTTON: Increase volume level
21. NUMERIC KEYS
22. PAIR BUTTON

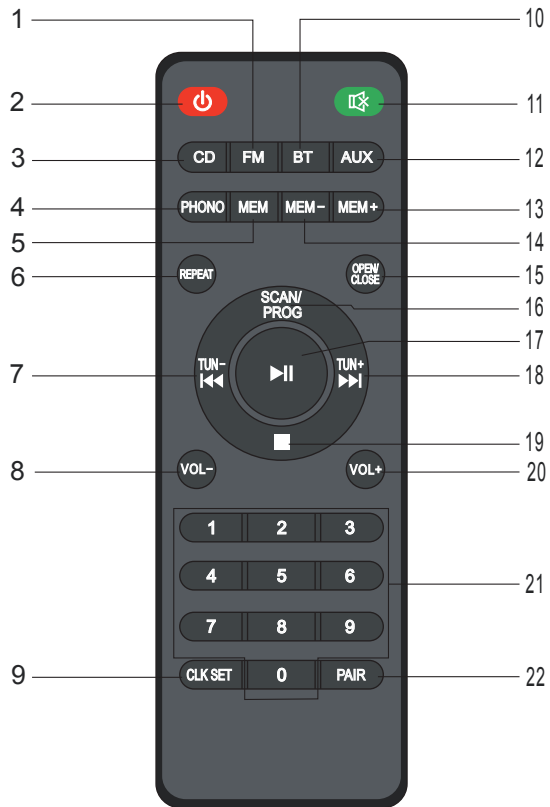

### Using the Remote Control

The Remote-Control Unit can operate the unit from about 24 feet. When operating the remote-control unit, point it (30 degrees horizontal and vertical) towards the front panel of the unit.

- Even if the remote-control unit is operated within the effective range, remote control operation may be impossible if there are any obstacles between the unit and the remote control.
- If the remote-control unit is operated near other appliances which generate infrared rays, or if other remote-control devices using infrared rays are used near the unit, it may operate incorrectly. Conversely, the other appliances may operate incorrectly.

### Battery Replacement

If the distance required between the remote-control unit and main unit decreases, the battery is exhausted. In this case, please replace the batteries.

To Replace With New Batteries (Not Included):

1. Remove the battery compartment cover as per the illustration on the right.
2. Observe the correct polarity and install two AAA size battery.
3. Close the cover.

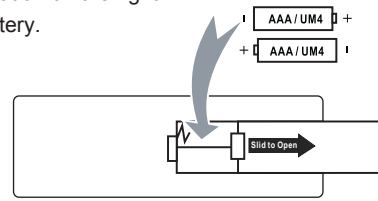

### Battery Precautions

- Be sure to insert the battery with correct positive + and negative - polarities.
- Refer to the precautions on the battery labels.
- When the remote-control unit is not to be used for long periods of time (more than a month), remove the battery from the remote control unit to prevent it from leaking. If it leaks, carefully wipe away the liquid inside the battery compartment and replace the battery with a new one.
- Do not heat or disassemble batteries and never dispose of old batteries by throwing them into a fire.
- Do not mix old and new batteries.
- Use only the same type of batteries.
- Do not dispose of the batteries in fire, battery may explode or leak.
- Do not recharge a non-rechargeable battery.

# SETUP & BASIC OPERATION

## Connecting the external speakers

The speaker input sockets are located at the back of the main unit.

1. Unwrap the speaker wire from the left speaker and plug it into the left (L) speaker socket on the main unit.
2. Unwrap the speaker wire from the right speaker and plug it into the right (R) speaker socket on the main unit.
3. Make sure the speaker cables are not run in areas where they could cause danger.

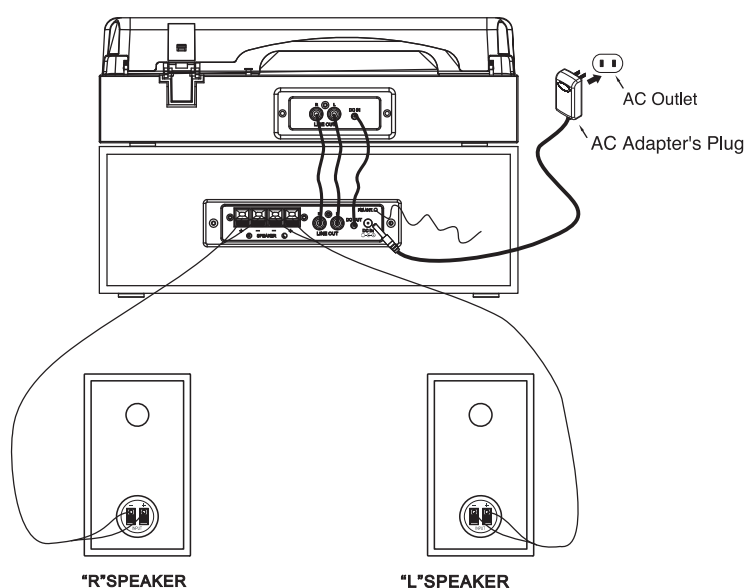

## Connecting Signal and Power between the turntable and main unit.

1. Plug two short RCA cables into line out jack between Turntable and Main unit.
2. Plug the short DC cable into DC In and DC out between Turntable and Main unit.

## Connecting a Power for whole unit

1. Check that the mains voltage in the rating plate on the back of the main unit is the same as the voltage in your area.
2. Insert the DC plug of the AC adapter cord into the DC Input jack at the back of the main unit.

## Powering On the Unit

1. Press the STANDBY button on the unit or remote-control to turn the unit ON.
2. Press the STANDBY button again on the unit or remote-control to turn the unit OFF

## FM Antenna

Unwrap the FM antenna and extend it fully. You may need to adjust the position of the antenna to get optimum reception.



### Volume Adjustment

Twist the **VOLUME KNOB** to adjust the volume. The volume level will be shown in the LCD Display in the top right corner of the unit.

NOTE: Depending on the type of music/audio output from the Bluetooth CD Radio Microsystem, the 2 Volume (VU) Meters might not move at lower volumes. In some cases, the volume must be around “#8 or higher” to see very active movement.

### Balance Adjustment

Twist the **BALANCE KNOB** to adjust the volume between the left speaker and the right speaker. The volume of the left speaker and right speaker is equal when the **BALANCE** knob clip in middle.

### Treble and Bass Adjustment

Twist the **TREBLE KNOB** and **BASS KNOB** to adjust the treble and bass levels

### Clock Setup

1. Connect a power source, press and hold the CLK SET button (Main Unit or Remote Control) more than 2 seconds, the hour digits will blink on the LCD display.
2. Repeatedly press the SKIP- / TUN- button or SKIP+ / TUN+ button to set the hour. Press and hold the buttons for fast advance/reverse setting.  
Note: The PM icon of the LCD DISPLAY will light when the hour is set to PM.
3. Press the CLK SET button to confirm and the minute digits will blink.
4. Repeatedly press the SKIP- / TUN- button or SKIP+ / TUN+ button to set the minute. Press and hold the buttons for fast advance/reverse setting
5. Press the CLK SET button to confirm and complete the setting. The display will stop blinking.

Note: The unit will automatically save the settings and exit the time set mode if you do not press the CLK SET button within 10 seconds.

## LISTENING TO A RECORD

It is recommended that you use extreme care when manipulating the tone arm, stylus, and other components of this turntable. These parts are very sensitive and can easily break or become damaged if they are carelessly handled.

1. Lift the DUST COVER all the way up until it stops. The cover will stay open.
2. Remove the tie-wrap from the TONE ARM (when using for the first time).
3. Remove the white protective needle cover by gently pulling it forward.

4. Release the tone arm HOLD DOWN CLIP by gently pushing to the right.

This will unlock the TONE ARM from its arm rest.

Note: Re-lock the HOLD DOWN CLIP when moving the turntable to another location.

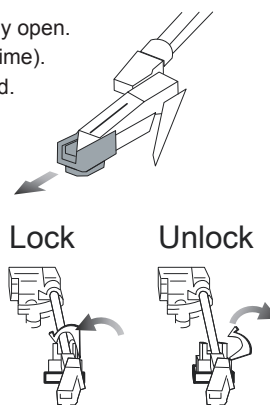

### Turntable operation

1. Press the STANDBY button to turn on the unit.
2. Press SOURCE button until the display is showed in PHONO mode.
3. Set the SPEED selector to the correct position (33, 45, or 78 RPM).
4. Place the record on the turntable
5. Lift the TONE ARM CONTROL lever and move the TONE ARM to the desired starting point over the record.
6. Lower the TONE ARM CONTROL lever and the TONE ARM will move down and music will start playing.
7. Turn the VOLUME CONTROL knob to adjust the volume to the desired level.
8. Slide the AUTO STOP CONTROL switch to choose the auto stop function.
9. At the end of the record, the TONE ARM will stop automatically. You should return the TONE ARM to the TONE ARM REST manually.

### Adapter for 45 RPM (Accessory)

This adapter allows you to play 45 RPM records.

1. Gently place your 45 RPM record on to the turntable
2. Place the 45 RPM ADAPTER over the spindle.
3. Follow normal turntable operation steps to play your record.



### REPLACING THE STYLUS

It's suggested to replace the stylus after 400 hours of use.

Please follow the steps below to change the stylus.

1. Lift the TONE ARM of the TONE ARM LOCK
2. At the front end of the tone arm, place the trip of your fingernail between the red stylus holder and the black cartridge housing as shown. Press down on the red stylus holder until it separates from the cartridge housing.
3. Completely remove the red stylus holder with worn stylus and discard it.
4. Place the new red stylus holder with stylus under the cartridge housing. First, press upward on the back side of the stylus holder, and then press up on the front edge of the stylus holder until it snaps into place on the cartridge housing.

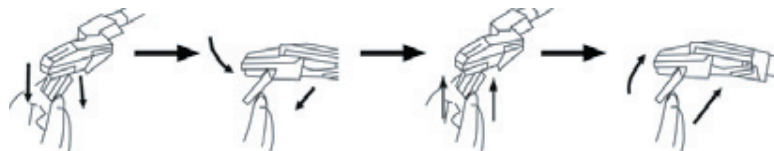



# CONNECTING TO BLUETOOTH

External devices that have a built-in Bluetooth feature can connect wirelessly to the Unit



## Getting Connected

Pairing a Bluetooth device

1. Press the STANDBY button to turn on the unit.
2. Press the SOURCE button until the Bluetooth indicator  shows on LCD Display with blink,
3. Set the Bluetooth function of your external device to ON and begin searching for devices.  
NOTE: The effective distance between your external device and this apparatus is 10 meters (33 feet).
4. Once "VICTOR VDTS-5400" appears on the paired devices list of your external device, select it.
5. If you are asked for a password, enter "0000"
6. An audible chime will sound and Bluetooth indicator  is lighted steadily on the display that indicates a connection has been established.
7. A few seconds later your Bluetooth connection should be ready to use.
8. If you want change to pair with another Bluetooth Enable Device. Press and hold the PAIR button. The Bluetooth indicator  will be flashing on the display and the unit will go into Pairing/Discoverable mode again. Repeat above step 3 to step 7

**Note:** After initial pairing, the unit will stay paired unless unpaired manually by the user or erased due to a reset of the device. If your device should become unpaired or your find it is unable to connect, repeat the above steps or press and hold the PAIR button again

## Playing Music from an External Bluetooth Device

1. After pair your external device and set it to play.
2. Audio played through the connected Bluetooth Device will now be heard through the speakers.
3. Press the play/pause  button on the remote or short press the play/pause  button on unit to pause or resume play.
4. Also can use **SKIP- / SKIP+** button to select previous or next file on external device.
5. Adjust VOLUME knob to obtain the desired volume level.

**Note:** Some function buttons may not work with all devices.

## RE-LINKING TO A SMARTPHONE OR BLUETOOTH ENABLED DEVICE

Even if your smartphone or Bluetooth device is already paired with the unit and with both Bluetooth functions turned on, they can become unlinked at some point due to intentional manual disconnection or undesirable external signal interferences or over-range for more than 10 seconds. If this happens, the unit will emit two short beeps. You can re-link them and resume play by:

1. Select "VICTOR VDTS-5400" from the device list on your smartphone or Bluetooth device. The unit should re-link to your Bluetooth enabled device within 5 seconds.
2. Tap the play button of the music player on your Bluetooth enabled device to resume playback

## USING THE CD PLAYER

1. Press **SOURCE** button until the display reads “**CD**”.
2. Press the **OPEN /CLOSE** button to open the CD door, put a CD onto the CD tray with the printed label facing up (towards you). To close the CD door, press **OPEN /CLOSE** button again.

**Note:** Remember to remove the CD when you are finished listening.

- **To Play a CD When Stopped:** Press the **▶II/PAIR** button. The disc will play from track 1 and play indicator appears on the display.
- **To Pause a CD While Playing:** Press the **▶II/PAIR** button. The disc will pause and play indicator blink on the display. Press the **▶II/PAIR** button again to resume playback.
- **To Stop a CD While Playing:** Press the **■ STOP** button.
- **To Change Tracks:** Press **I◀◀ / TUN-** button or **▶▶ / TUN+** button.
- **To Search During Playback:** Press and hold the **I◀◀ / TUN-** button or **▶▶ / TUN+** button until the desired section is located. While searching, sound will be played at a distorted speed. Playback returns to normal when the button is released

### Repeating Playback of a Track or CD

Press the **REPEAT** button on the main unit or remote control to circle the play mode:

- Repeat 1 ---Press the **REPEAT** button on the main unit or remote control once and the current track will be played continuously
- Repeat All ---Press the **REPEAT** button again and ALL tracks on the current disc will be played continuously.
- Normal playback --- Press **REPEAT** button again to resume normal playback

**Note:** Pressing the **■ STOP** button will stop playback and the play mode will be cleared.

### Program Play

Program play must be set when the CD is stopped. You can program up to 20 tracks in any order.

1. Press **■ STOP** button and then press **MEM / PROG** button on the main unit or remote control.
2. Press **I◀◀ / TUN-** button or **▶▶ / TUN+** button to select a track. The display shows the selected track.
3. Press the **MEM / PROG** button on the main unit or remote control to add the track into the program list.
4. Repeat steps 2 and 3 until you complete the programming. You can program up to 20 tracks.
5. To Start the Program Play: Press **/PAIR** button.
6. **To Pause or Stop a Program Play:** Press **▶II/PAIR** or **■ STOP** button.
7. **To Replay a Program:** Press **▶II/PAIR** button.
8. **To Review the Content of a Program:** Press **■ STOP** button then keep pressing the **MEM / PROG** button to review the programmed tracks.
9. **To Clear the Program:** Press **■ STOP** button twice or open and close the CD door.

## USING THE FM RADIO

1. Press the **SOURCE** button to switch to the **FM RADIO**. The display will show a radio station: "87.5".
2. Tune to a desired radio station. The frequency is indicated on the display.
  - **MANUAL TUNING:** Press the **TUN+** or **TUN-** button briefly and the frequency will tune up or down.
  - **AUTO SEARCHING:** Press the **TUN+** or **TUN-** button for more than 2 seconds, the radio frequency will start to change on the display. Once a station is found, the radio will stop searching and start to broadcast immediately.
  - **AUTO STORE:** Press **SCAN** button for more than 2 seconds, the unit will auto scan available stations in FM band and store it in the memory.
3. Re-position the antenna if necessary.

### Setting FM Radio Presets

The unit can store up to 20 radio station presets.

#### To Manually Set Presets

1. Find the radio station you would like to save.
2. Press the **MEM/PROG** button on the main unit or **PROG** button on the remote control.
3. Press **I◀◀ / TUN-** or **▶▶ / TUN+** buttons to select the preferred Preset Number, The display will show "P01, P02, etc..."
4. Press the **MEM/PROG** button on the main unit or remote control again to save the station.
5. Repeat steps 1-4 until you have finished saving your presets.
6. To navigate through the stored presets, press the **MEM+** or **MEM-** buttons.

## USING THE AUX IN (LINE IN)

External (auxiliary) audio sources such as tablets, smartphones or MP3 players, can connect to the Bluetooth CD Radio Microsystem via aux-in.

1. Press **STANDBY** button to turn the unit ON and then press **SOURCE** button to select "AUX".
2. Set the volume to the minimum level with the **VOLUME KNOB**.
3. Plug in an **AUX-IN** cable (not included) into the **AUX-IN** jack on the front of the unit.
4. Plug the other end of the cable into the headphone or Line-Out jack of the external source.
5. Turn on the external audio device and set it to play. Turn the external audio device's volume up to 2/3. If necessary, adjust the volume on the main unit by turning the **VOLUME KNOB**.

## CARE & MAINTENANCE

Depending on the quality of the disc, and the condition of the recording, some CD-R/CD-RW discs may not be playable.

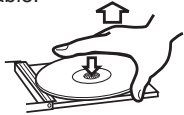

How to remove the disc



How to hold the disc



How to clean the disc

1. Always place the CD in the disc tray with the label facing upward. (CDs can be played only on one side).
2. To move a disc from its storage case, press down on the center of the case and lift the disc out, holding it carefully by the edges.
3. If the disc becomes dirty, wipe the surface from the center hole outward towards the outer edge with a soft, dry cloth.
4. Never use harmful chemicals such as record spray, antistatic sprays or fluid, benzine or thinner to clean the discs. Such chemicals will do irreparable damage to the disc's plastic surface.
5. Discs should be returned to their cases after use to avoid serious scratches that could cause the laser pick up to skip.
6. Do not expose discs to direct sunlight or high humidity and temperature for extended periods. Long exposure to high temperatures will warp the discs.
7. Printable CD-R and CD-RW discs are not recommended, as the label side might be sticky and damage the unit.
8. Use a soft oil-based felt-tipped pen to write the information on the label side. Never use a ball-point or hard-tipped pen, as this may cause damage to the recorded side.
9. Do not use CDs with an irregular shape (octagonal, heart-shaped, business card size, etc). CDs of this sort can damage the unit.

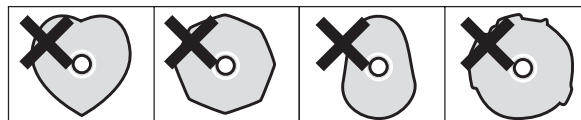

10. If you have any doubts of using CD-R/CD-RW disc, read the precautions supplied with the disc, or contact the disc manufacturer directly.

# TROUBLESHOOTING GUIDE

In case of trouble with the unit, please look through the problems below and see if you can solve them yourself before calling your dealer.

	PROBLEM	CAUSE	SOLUTION
<b>WHOLE UNIT</b>	Unit does not turn ON when STANDBY is pressed.	<ul style="list-style-type: none"> <li>Unit is unplugged</li> </ul>	<ul style="list-style-type: none"> <li>Connect unit to AC power supply</li> </ul>
	No sound comes out of the speakers.	<ul style="list-style-type: none"> <li>The external speakers are disconnected.</li> <li>The volume is turned down (to MIN).</li> <li>The input selector does not match the playback source.</li> </ul>	<ul style="list-style-type: none"> <li>Connect the external speakers.</li> <li>Adjust the volume.</li> <li>Re-select the desired input source.</li> </ul>
	The sound is noisy.	<ul style="list-style-type: none"> <li>The unit is too close to a TV set or another similar appliance.</li> </ul>	<ul style="list-style-type: none"> <li>Turn off the TV or other appliance, and relocate the unit.</li> </ul>
	The unit does not act as expected, or respond.	<ul style="list-style-type: none"> <li>External factors such as ESD (Electro-static discharge) affect the unit.</li> </ul>	<ul style="list-style-type: none"> <li>Remove the power cord and all power supply devices. Then re-plug the unit after one minute.</li> </ul>
<b>RADIO UNIT</b>	Cannot listen to any station, or signal appears weak.	<ul style="list-style-type: none"> <li>The station is not tuned-in properly.</li> <li>A TV set is being used nearby and is interfering with the radio reception.</li> </ul>	<ul style="list-style-type: none"> <li>Properly tune-in the desired station.</li> <li>Turn-off the interfering TV set.</li> </ul>
	The sound is distorted.	<ul style="list-style-type: none"> <li>The antenna is not positioned properly.</li> </ul>	<ul style="list-style-type: none"> <li>Re-position the antenna until reception improves.</li> </ul>
<b>CD PLAYER</b>	CD stops immediately after starting, or unit pauses or stops during play.	<ul style="list-style-type: none"> <li>The CD is inserted upside down.</li> <li>The CD is dusty or dirty or there is condensation on the CD.</li> </ul>	<ul style="list-style-type: none"> <li>Insert the CD with the printed side right-side up.</li> <li>Carefully clean and dry the CD.</li> </ul>
	No sound.	<ul style="list-style-type: none"> <li>The CD player is paused.</li> </ul>	<ul style="list-style-type: none"> <li>Press the PLAY/PAUSE button.</li> </ul>
	Specific CD is noisy, or playback stops or skips.	<ul style="list-style-type: none"> <li>The CD is scratched, damaged or warped.</li> <li>The disc is very dirty.</li> </ul>	<ul style="list-style-type: none"> <li>The CD should be changed.</li> <li>Carefully clean the CD.</li> </ul>
<b>RECORD PLAYER</b>	No sound on phono source	<ul style="list-style-type: none"> <li>The protective needle cover was not removed</li> </ul>	<ul style="list-style-type: none"> <li>Remove the protective needle cover</li> </ul>
		<ul style="list-style-type: none"> <li>The tie-wrap was not removed from underneath the tone arm</li> </ul>	<ul style="list-style-type: none"> <li>Remove it first</li> </ul>
		<ul style="list-style-type: none"> <li>Tone arm HOLD DOWN CLIP was not released</li> </ul>	<ul style="list-style-type: none"> <li>Remove it first</li> </ul>
		<ul style="list-style-type: none"> <li>The stylus is dirty.</li> </ul>	<ul style="list-style-type: none"> <li>Remove dust on the stylus with a stylus-cleaning brush.</li> </ul>
	Poor sound on phono source	<ul style="list-style-type: none"> <li>Dust or dirt has collected on the record.</li> </ul>	<ul style="list-style-type: none"> <li>Clean the record with a high quality recrd cleaner.</li> </ul>
<b>BLUETOOTH</b>	Bluetooth No Sound	<ul style="list-style-type: none"> <li>Unit is not linked with your Bluetooth enabled device.</li> </ul>	<ul style="list-style-type: none"> <li>Go through BT pairing process to the unit.</li> </ul>
		<ul style="list-style-type: none"> <li>Unit placement out of range.</li> </ul>	<ul style="list-style-type: none"> <li>Relocate the unit within Bluetooth operating range (32 feet)</li> </ul>
		<ul style="list-style-type: none"> <li>Your Bluetooth enabled device Volume set too low.</li> </ul>	<ul style="list-style-type: none"> <li>Increase Volume level of your Bluetooth enabled device.</li> </ul>

## FCC NOTICE

This device complies with Part 15 of the FCC Rules. Operation is subject to the following two conditions: (1) this device may not cause harmful interference, and (2) this device must accept any interference received, including that may cause undesired operation.

NOTE: This equipment has been tested and found to comply with the limits for a Class B digital device, pursuant to Part 15 of the FCC Rules. These limits are designed to provide reasonable protection against harmful interference in a residential installation. This equipment generates, uses, and can radiate radio frequency energy and, if not installed and used in accordance with the instructions, may cause harmful interference to radio communications. However, there is no guarantee that interference will not occur in a particular installation. If this equipment does cause harmful interference to radio or television reception, which can be determined by turning the equipment on and off, the user is encouraged to try to correct the interference by one or more of the following measures:

- Reorient or relocate the receiving antenna.
- Increase the separation between the equipment and receiver.
- Connect the equipment into an outlet on a circuit different from that to which the receiver is connected .
- Consult the dealer or an experienced radio/TV technician for help.

WARNING: Any changes or modifications not expressly approved by the party responsible for compliance could void the user's authority to operate this equipment.

The device must not be collocated or operating in conjunction with any other antenna or transmitter.

To maintain compliance with the FCC's RF exposure guidelines, place the product at least 20cm from nearby persons.

## ISED STATEMENT

RSS-Gen Issue 3 December 2010"&"CNR-Gen 3e édition Décembre 2010:

This device complies with Industry Canada licence-exempt RSS standard(s).

Operation is subject to the following two conditions: (1) This device may not cause interference, and (2) This device must accept any interference, including interference that may cause undesired operation of the device.

Le présent appareil est conforme aux CNR d'industrie Canada applicables aux appareils radio exempts de licence. L'exploitation est autorisée aux deux conditions suivantes:

(1) l'appareil ne doit pas produire de brouillage, et

(2) l'utilisateur de l'appareil doit accepter tout brouillage radio électriquesubi, même si le brouillage est susceptible d'encompromettre le fonctionnement.

The device must not be co-located or operating in conjunction with any other antenna or transmitter.

L'appareil ne doit pas être localisé ou fonctionner avec d'autres antennes ou transmetteurs.

This device complies with IC radiation exposure limits set forth for an uncontrolled environment.

Cet appareil est conforme aux limites d'exposition aux rayonnements de la IC établies pour un incontrôlé environnement.

The device should be installed and operated with a minimum distance of 20cm between the radiator and your body.

L'appareil doit être installé et utilisé avec une distance minimale de 20 cm entre le radiate et votre corps.



## CAUTION ON MODIFICATIONS

Any changes or modifications not expressly approved by the grantee of this device may void the authority granted by the FCC to operate this equipment. Electric and electronic equipment contains materials, components and substances that can be hazardous to your health and the environment, if the waste material (discarded electric and electronic equipment) is not handled correctly. Electric and electronic equipment is marked with the crossed-out trash can symbol, seen below. This symbol signifies that electric and electronic equipment should not be disposed of with other household waste but should be disposed of separately. All cities have established collection points, where electric and electronic equipment can either be submitted free of charge at recycling stations and other collection sites or be collected from the households. Additional information is available at the technical department of your city.



### CALIFORNIA PROP 65 WARNING

"WARNING" This product contains chemicals known to the State of California to cause birth defects or other reproductive harm. For more information on these regulations and a list of chemicals, visit the following website address: <http://www.oehha.ca.gov/prop65.html>

## SUPPORT

We do our best to offer high quality products to our customers. If you experience any issues or problems with your product, please contact customer support as many issues can be quickly resolved.

If you have problems with your device, please consult the instructions in this manual. Please also visit us on the web at [www.naxa.com](http://www.naxa.com) to get up to the minute news, alerts, and documentation for your device. For additional assistance, please contact Naxa Technical Support.

### Naxa Technical Support

2320 East 49<sup>th</sup> St.

Vernon, CA 90058

(866) 411-6292

<http://www.naxa.com/supportcenter>

*\*This product has been manufactured and sold under the responsibility of NAXA ELECTRONICS INC.*

*VICTOR and the DOG & GRAMOPHONE logo are trademarks used under license by NAXA ELECTRONICS INC.*

*Further information at [www.victor-brand.com](http://www.victor-brand.com).*

*All other products, services, companies, trademarks, trade or product names and logos referenced herein are the property of their respective owners.*