

2 in 1 Dog Training Collar & Bark Control Collar

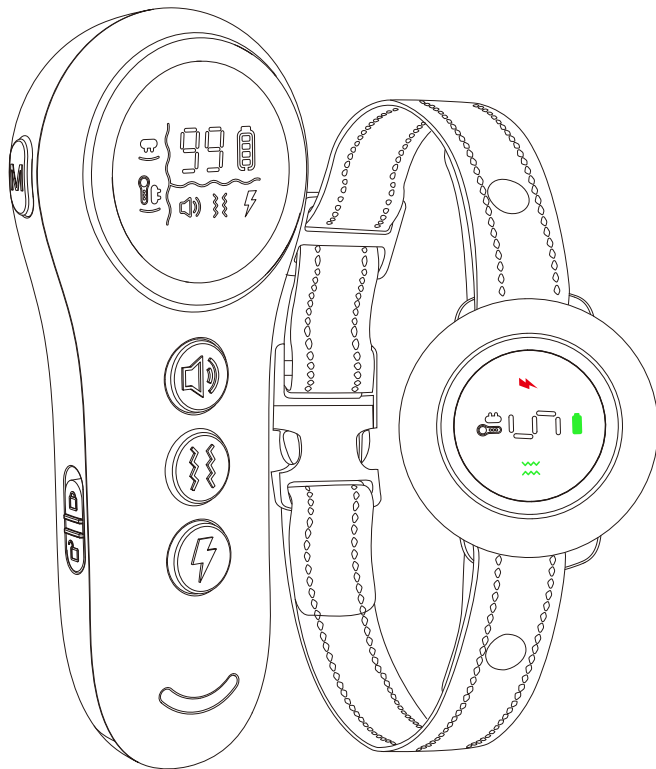

Model: RS8

I. Important Safety Information:

WARNING

Not for use with aggressive dogs. Do not use this product if your dog is aggressive, or if your dog is prone to aggressive behavior. Aggressive dogs can cause severe injury to their owner and others. If you are unsure whether this product is appropriate for your dog, please consult your veterinarian or a certified trainer.

- For use with dogs over 6 months of age and over 5 lbs.
- DO NOT press and hold the Warning Tone Button, Vibration Button and Shock Button for more than 10 seconds constantly to avoid physical or psychological hurt to your dog
- Your dog **SHOULD NOT VOCALIZE OR PANIC** when receiving stimulation. If this happens, the stimulation level is too high and you need to go back to the previous level and repeat the process.
- **DO NOT** charge the device near any flammable substances.
- For dog use **ONLY**. Not for use on children.
- This is not a toy, and should only be operated by a responsible adult.

CAUTION

Before your first training, please read and follow the instructions in this manual carefully. The cautions below will help keep your dog safe and comfortable. Millions of dogs are comfortable when they wear stainless steel contacts, while some dogs are sensitive to contact pressure.

- **It is vitally important that you and your dog remain safe while learning during on-leash training.** Your dog should be on a strong leash (do not attach the leash to the 2 in 1 Dog Training Collar & Bark Control Collar), long enough for him to attempt to chase an object, but short enough for him not to reach a road or other hazard. You must also be physically strong enough to restrain your dog when he tries to chase.
- **Risk of skin damage.** Proper Receiver/Bark Control Collar fitment is important. A Receiver/Bark Control Collar worn for too long or made too tight on the dog's neck may cause skin damage. Ranging from redness to pressure ulcers; this condition is commonly known as bed sores.
- **DO NOT leave the Receiver/Bark Control Collar on the dog for more than 12 hours per day.**
- When possible re-position the Receiver/Bark Control Collar on the dog's neck every 1 to 2 hours.
- **Check the fit to prevent excessive pressure;** follow the instructions in this manual.
- **Never connect an extra leash to the Receiver/Bark Control Collar;** it will cause excessive pressure on the contacts.
- **Clean the dog's neck area and the Metal Prongs of the Receiver/Bark Control Collar weekly** with a damp cloth.
- **Examine the contact area daily** for signs of a rash or a sore.
- **If a rash or sore is found, discontinue the use of the Receiver/Bark Control Collar** until the skin has healed. If the condition persists beyond 48 hours, see your veterinarian.
- **Receiver/Bark Control Collar meets IP67 waterproof rating,** it can be submerged in water up to 1 meter for up to 30 minutes.

II. Quick Start Guide

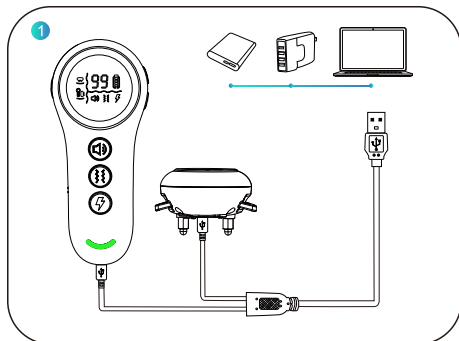

Charge the Receiver/Bark Control Collar and the Remote Transmitter for 2-3 hours with the double-headed Micro-USB cable from the package box.

Note: The charger, power bank and other charging devices shown in the above picture are not included in the box.

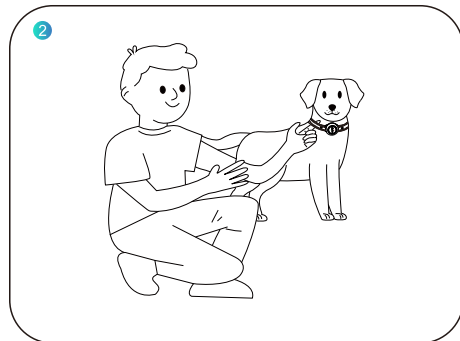

Let your dog stand on four feet or lay down fully. Fill the Receiver/Bark Control Collar to your dog by leaving one finger space between the Collar and your dog's neck. Center the Metal Prongs underneath your dog's neck, touching the skin.

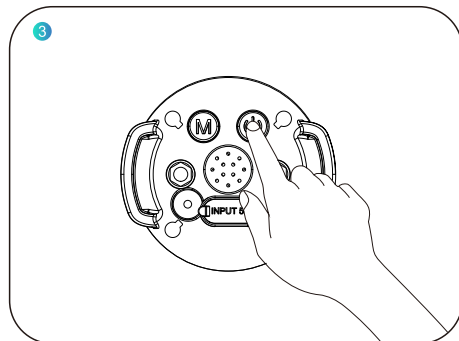

Turn on the Receiver/Bark Control Collar by pressing and holding the Power Button for 2 seconds with a Beep and Vibration to indicate that the Receiver/Bark Control Collar turns on, and then the white Indicator continues to blink regularly.

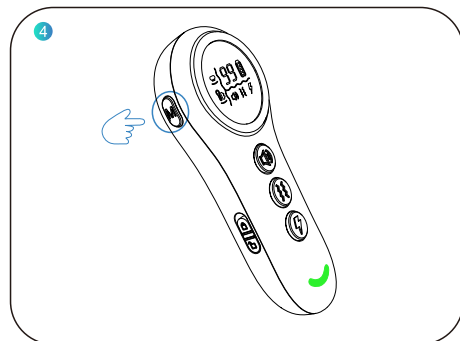

Turn on the Remote Transmitter by pressing and holding the Mode (On/Off) Button for 2 seconds.

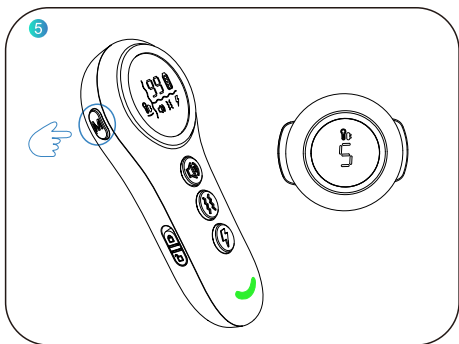

Press the Mode Button on the Remote Transmitter, the green indicator light on the Remote Transmitter will light up (both the Dog Training Mode icons on the Displays of the Remote Transmitter and the Receiver light up simultaneously). The 2 in 1 Dog Training Collar & Bark Control Collar will enter the Dog Training Mode.

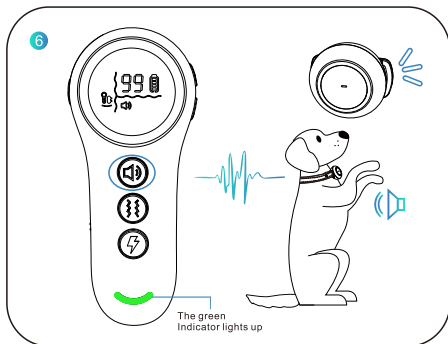

Warning Tone Command: Press the Warning Tone Button, and the Receiver will deliver a warning tone (the green Indicator on the Remote Transmitter and the white Indicator on the Receiver will light up). The Beep level is 1-8 adjustable. Adjust the Warning Tone Level by pressing the Level Up/Down Button.



Vibration Command: Press the Vibration Button, and the Receiver will deliver vibration (the green Indicator on the Remote Transmitter and the white indicator on the Receiver will light up). The Vibration level is 1-16 adjustable. Adjust the Vibration Level by pressing the Level Up/Down Button.

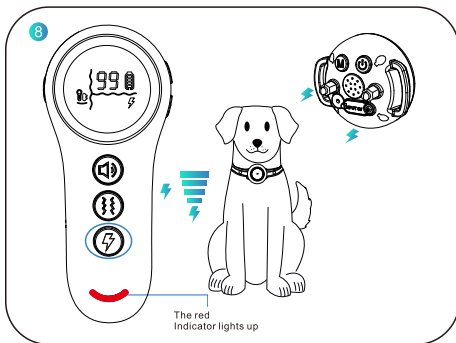

Shock Command: Press the Shock Button, and the Receiver will deliver Shock (the red Indicator on the Remote Transmitter and the white indicator on the Receiver will light up). The Vibration level is 1-99 adjustable. Adjust the Shock Level by pressing the Level Up/Down Button.

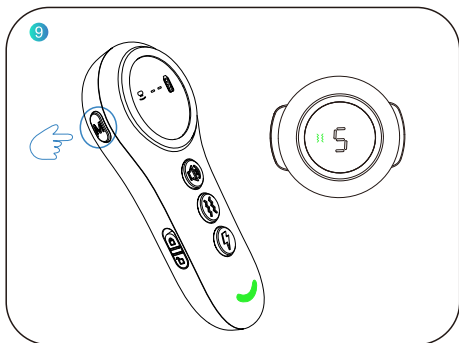

Press the Mode Button on the Remote Transmitter, the green indicator light and the Bark Control Collar Mode icon on the Display of the Remote Transmitter will light up. The 2 in 1 Dog Training Collar & Bark Control Collar will enter the Bark Control Collar Mode.

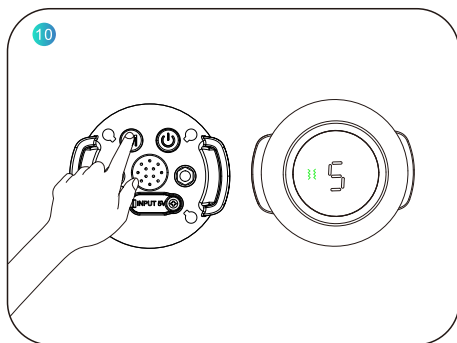

Press the Mode Button to enter the Warning Tone + Vibration Mode, the Working Mode is 6 Variable Warning Tone + 3 Levels of Vibration working collaboratively in 6 steps. Adjust the sensitivity level from 1-5 by pressing the Power/Set Button. Level 5 is the most sensitive and level 1 is the least sensitive.

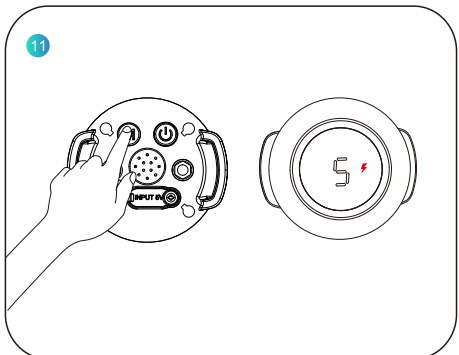

Press the Mode Button to enter the Warning Tone + Vibration + Shock Mode, the Working Mode is 6 Variable Warning Tone + 3 Levels of Vibration + 6 Levels of Shock working collaboratively in 6 steps. Adjust the sensitivity level from 1-5 by pressing the Power/Set Button. Level 5 is the most sensitive and level 1 is the least sensitive.

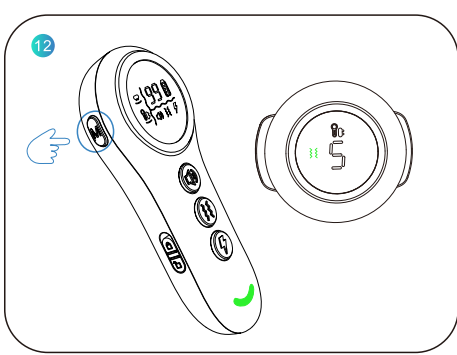

Press the Mode Button on the Remote Transmitter, the green indicator light on the Remote Transmitter will light up (the Dog Training Mode icon and Bark Control Mode icon on the Display of the Remote Transmitter and the Dog Training Mode icon on the Receiver/Bark Control Collar will light up simultaneously). The 2 in 1 Dog Training Collar & Bark Control Collar will enter the Dog Training & Bark Control Mode.

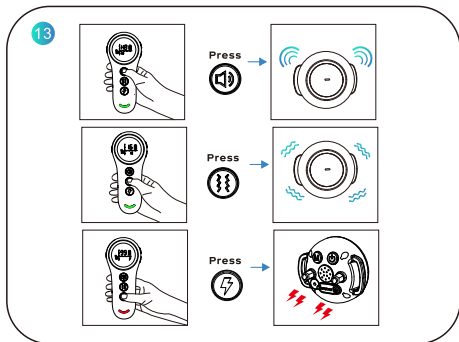

Press the Warning Tone Button, Vibration Button, or Shock Button on the Remote Transmitter, and Receiver/Bark Control Collar will respond correspondingly. Please refer to "VI. Training Mode" on page 11 and 12 for more details.

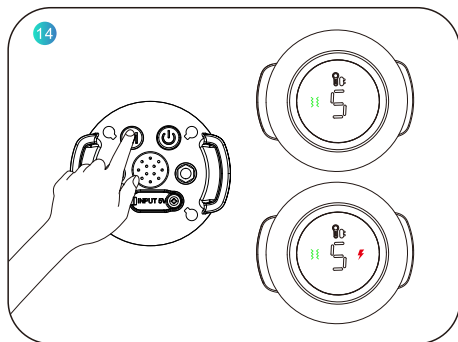

Press the Mode to switch modes, the mode icons will be changed. Adjust the sensitivity level from 1-5 by pressing the Power/Set Button. Please refer to "VI. Training Mode" on page 12 and 13 for more details.

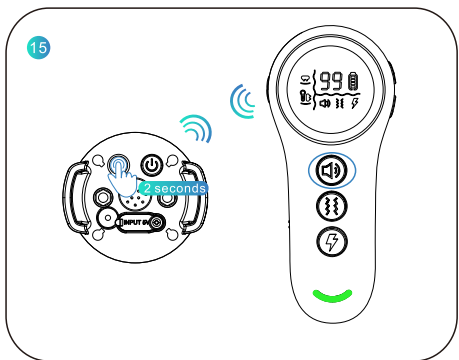

In case of the Receiver/Bark Control Collar is not responding to the Remote Transmitter, follow these steps to pair them up:

1. Press the Power Button on the Receiver/Bark Control Collar for 2 seconds to enter the Pairing Mode. You will hear a beeping tone and the Dog Training icon will Blinking Fast. You will now have 10 seconds to finish the pairing;
2. Press the Beep Button, Vibration Button, or Shock Button on the Remote Transmitter, and Receiver will respond correspondingly indicating that the pairing process is completed. Please refer to "VI. Pairing Up" on page 15 and 16 for more details.

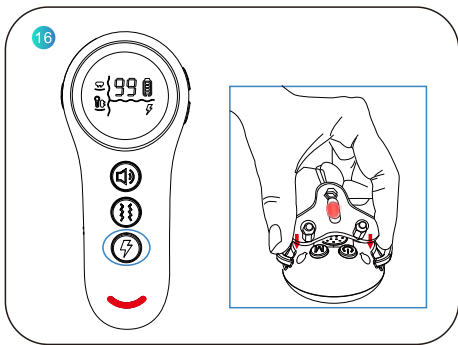

Test the Receiver/Bark Control Collar with the Test Bulb:

1. Hold the Test Bulb to the Metal Prongs on the Receiver/Bark Control Collar. Make sure the metal wire in the Test Bulb has direct contact with both of the top of the Metal Prongs.
2. Press the Shock Button on the Remote Transmitter.
3. The yellow Test Light will flash if the Receiver/Bark Control Collar works normally. At higher shock levels, the Test Bulb will flash brighter.

Note: Please always start from the lowest Shock level to avoid accident hurt.

III. Package Content

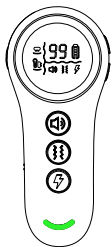

Remote Transmitter

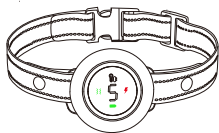

Receiver



User Manual



Metal Prongs



Silicone Caps



Test Bulb

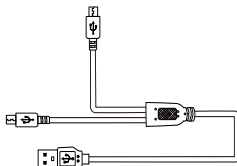

Charging Cable



Wrist Strap

IV. Product Overview

Remote Transmitter

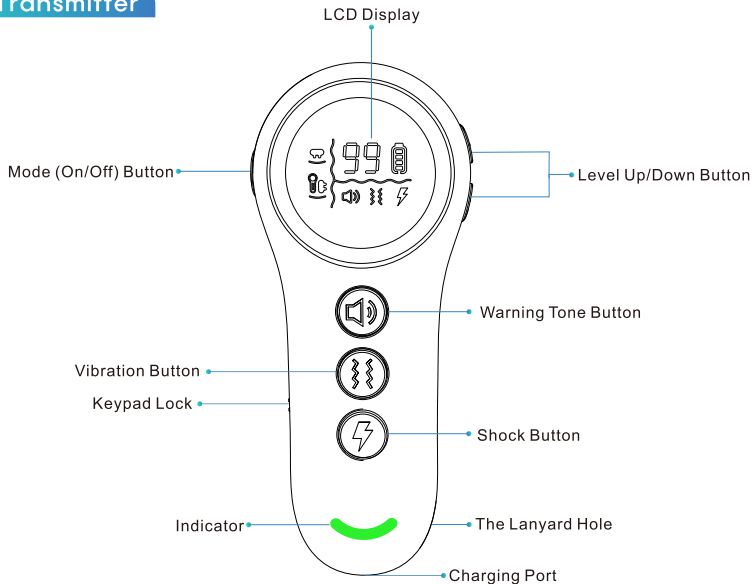

- (1)The icons "88" and "🔒" will be displayed when the Remote Transmitter is set to the locked state.
- (2)The Remote Transmitter will go into sleep mode if there is no operation in 30 seconds.

Display Screen

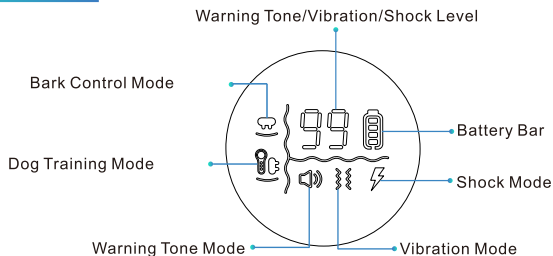

Receiver/Bark Control Collar

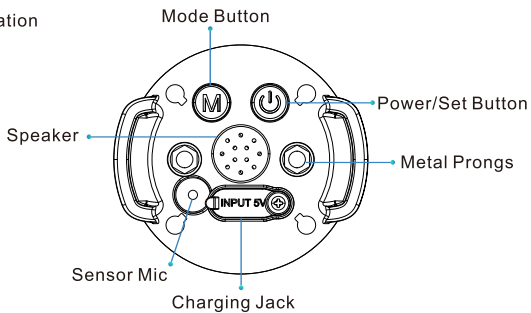
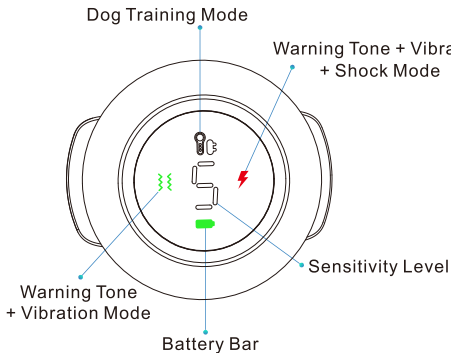

Mode Icons



Warning Tone +Vibration



Warning Tone +Vibration+Shock

Sensitivity Level

1-5

Adjust the sensitivity level from 1-5 by pressing the Power/Set Button. Level 5 is the most sensitive and level 1 is the least sensitive

Protection Mode

8

Product is in a 30-second Protection Period

Test Mode

0

When the product is set on Test Mode, the digit shows 0 and then will show 5 after the test is completed, or if the test is not operated within 5 seconds

Indicators



Blinking in medium speed: the product is on charge



Blinking in low speed: the product is on standby



Blinking in high speed: the battery is low

How the System Works

The 2 in 1 Dog Training Collar & Bark Control Collar is easy to use with an advanced digital display that tells you the exact stimulation level you are using.

The Dog Training Mode assists you in controlling your dog without a leash. At the push of a button, your Remote Transmitter sends a signal activating your dog's Receiver. He receives a safe but annoying stimulation. He'll quickly learn the association between his behavior and your correction, and soon you'll have a better-behaved dog. The Bark Control Mode detects the dog bark and automatically deliver Warning Tone, Vibration and Shock, the dogs will learn quickly from the stimulation and stop barking.

The 2 in 1 Dog Training Collar & Bark Control Collar has been proven safe, comfortable, and effective for both small and large dog breeds. If using the 2 in 1 Dog Training Collar & Bark Control Collar consistently and correctly, any basic obedience commands can be taught and will help correct any misbehavior that your dog exhibit.

V. Setting Up

1. Charge the Product

Charge both the Receiver/Bark Control Collar and the Remote Transmitter with the charging cable in the package box until their indicator becomes solid green which will take around 2-3 hours.

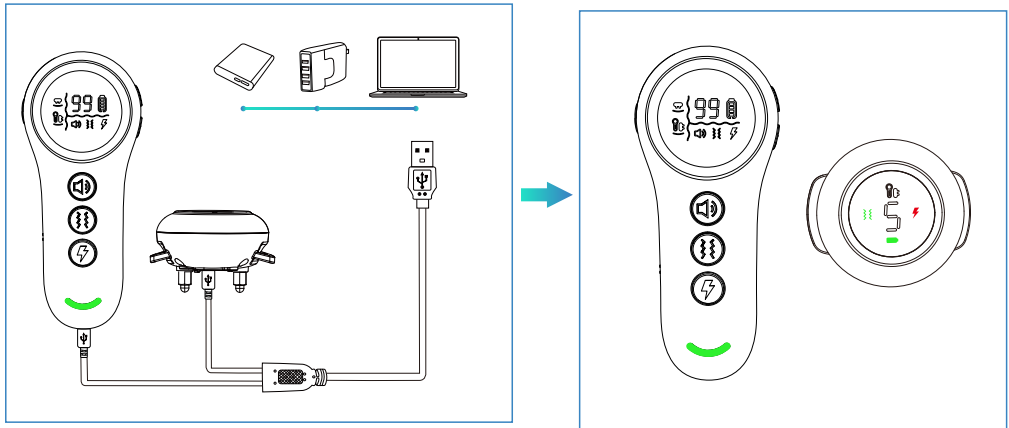

Note:

- (1) The charger, power bank and other charging devices shown in the above picture are not included in the box.
- (2) Use the charging cable in the package when charging. Other charging cables may not be suitable for this 2 in 1 Dog Training Collar & Bark Control Collar, which may cause electric damage.
- (3) The 2 in 1 Dog Training Collar & Bark Control Collar ONLY supports a 5V-rated power source.

If charged with an improper charger:

Receiver/Bark Control Collar—deliver a rapid warning tone and stop charging automatically.

Remote Transmitter—stop charging automatically with the Indicator rapidly blinking in red.