

ADVANCED SHOCK REMOTE

DOG TRAINING COLLAR

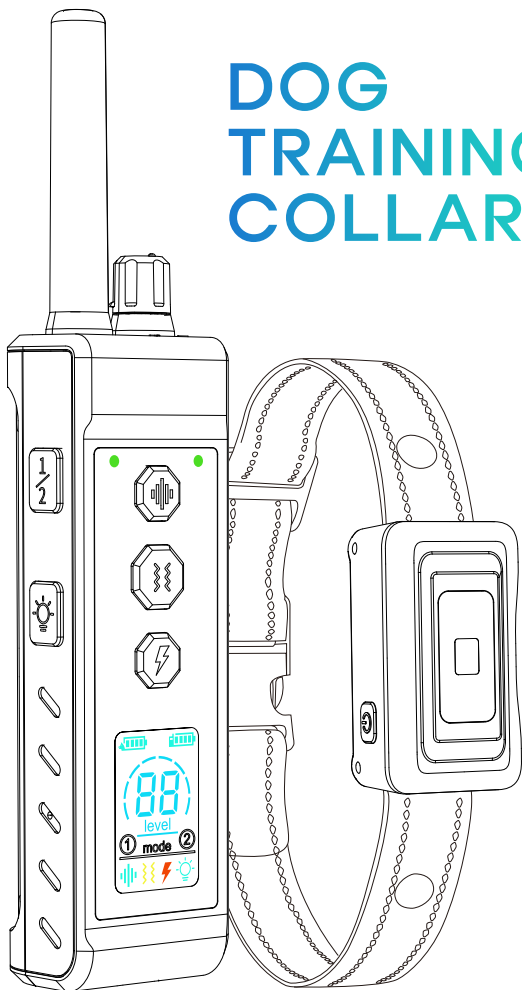

Model:RS5

I. Important Safety Information:

WARNING

Not for use with aggressive dogs. Do not use this product if your dog is aggressive, or if your dog is prone to aggressive behavior. Aggressive dogs can cause severe injury to their owner and others. If you are unsure whether this product is appropriate for your dog, please consult your veterinarian or a certified trainer.

- ◆ For use with dogs over 6 months of age and over 8 lbs.
- ◆ **DO NOT** press and hold the Warning Tone Button, Vibration Button and Shock Button for more than 10 seconds constantly to avoid physical or psychological hurt to your dog.
- ◆ Your dog **SHOULD NOT WHINE OR PANIC** when receiving stimulation. If this happens, the stimulation level is too high and you need to go back to the previous level and repeat the process.
- ◆ **DO NOT** charge the device near any flammable substances.
- ◆ For dog use **ONLY**. Not for use on children.
- ◆ This is not a toy, and should only be operated by a responsible adult.

CAUTION

Before your first training, please read and follow the instructions in this manual carefully. The cautions below will help keep your dog safe and comfortable. Millions of dogs are comfortable wearing collars, while some are sensitive to the pressure from the contacts.

- ◆ It is vitally important that you and your dog remain safe while learning during on-leash training. Your dog should be on a strong leash (do not attach the leash to the receiver), long enough for him to attempt to chase an object, but short enough for him not to reach a road or other hazard. You must also be physically strong enough to restrain your dog when he tries to chase.
- ◆ Risk of skin damage. Proper Receiver fitment is important. A Receiver worn for too long or made too tight on the dog's neck may cause skin damage. Ranging from redness to pressure ulcers; this condition is commonly known as bed sores.
- ◆ **DO NOT** leave the Receiver on the dog for more than 12 hours per day.
- ◆ When possible re-position the Receiver on the dog's neck every 1 to 2 hours.
- ◆ Check the fit to prevent excessive pressure; follow the instructions in this manual.
- ◆ Never connect an extra leash to the Receiver; it will cause excessive pressure on the contacts.
- ◆ Clean the dog's neck area and the Metal Prongs of the Receiver weekly with a damp cloth.
- ◆ Examine the contact area daily for signs of a rash or a sore.
- ◆ If a rash or sore is found, discontinue the use of the Receiver until the skin has healed. If the condition persists beyond 48 hours, see your veterinarian.
- ◆ Receiver Collar meets IP67 waterproof rating, it can be submerged in water up to 1 meter for up to 30 minutes. If submerged and wet, please do not use it.

II. Quick Start Guide

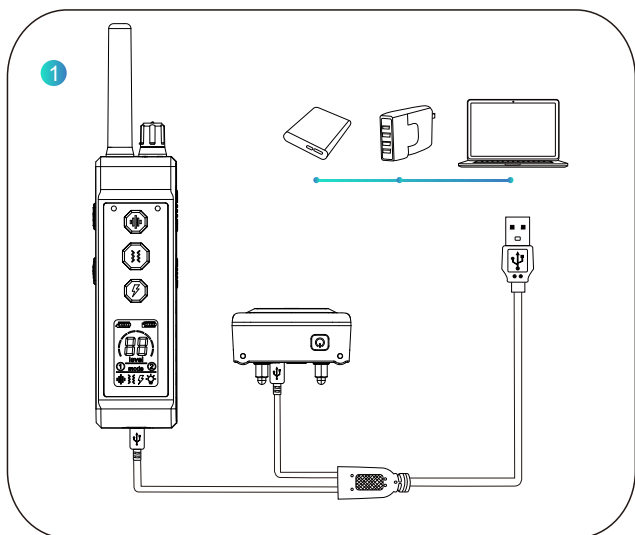

Charge the Receiver and the Remote Transmitter for 2-3 hours with the double-headed Type-C cable from the package box.

Note: The charger, power bank and other charging devices shown in the above picture are not included in the box.

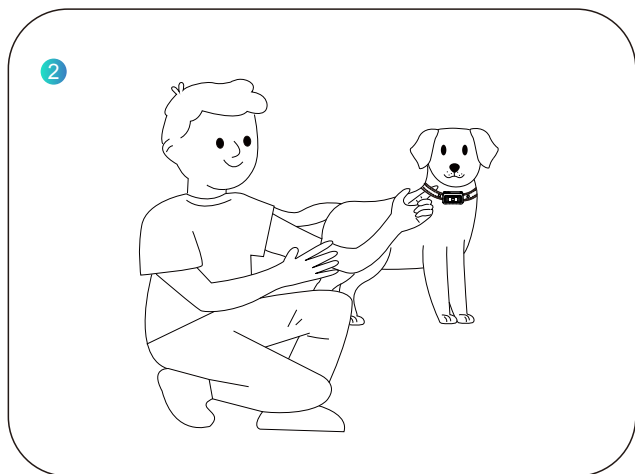

Let your dog stand on all fours or lay down fully. Fit the Receiver to your dog by leaving one finger space between the Receiver Collar and your dog's neck. Center the Metal Prongs underneath your dog's neck, touching the skin.

3

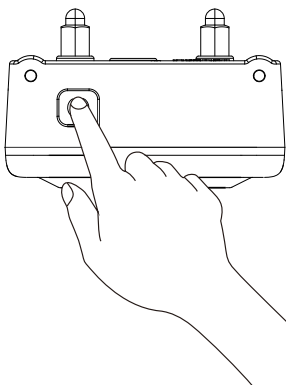

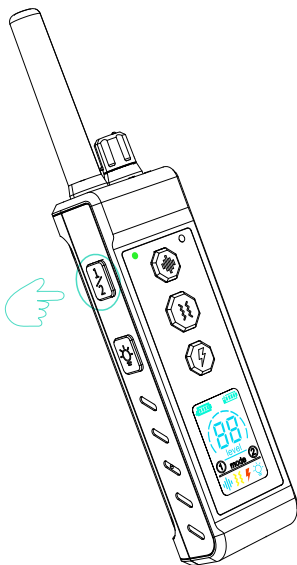

Turn on the Receiver by pressing and holding the Power Button for 2 seconds with a vibration to indicate that the Receiver is turned on, and then the green Indicator continues to blink regularly.

4

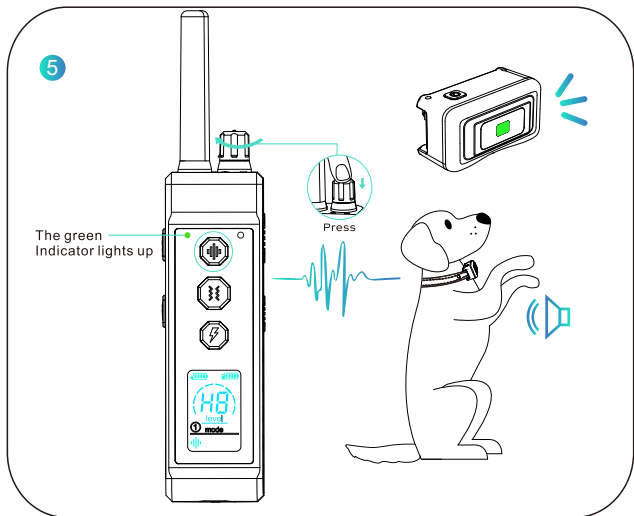

Turn on the Remote Transmitter by pressing and holding the On/Off (Channel) Button for 2 seconds.



Warning Tone Command: Press the Warning Tone Button, and the green Indicator Light on the Remote Transmitter rapidly lights up. The Receiver will deliver a warning tone, and the green LED Indicator light on the Receiver comes up simultaneously. To adjust the warning tone level, press the Adjustment Knob to select the Warning Tone Mode first, then turn the Adjustment Knob left and right to raise/lower to the desired level, and finally press  button to confirm the modification.

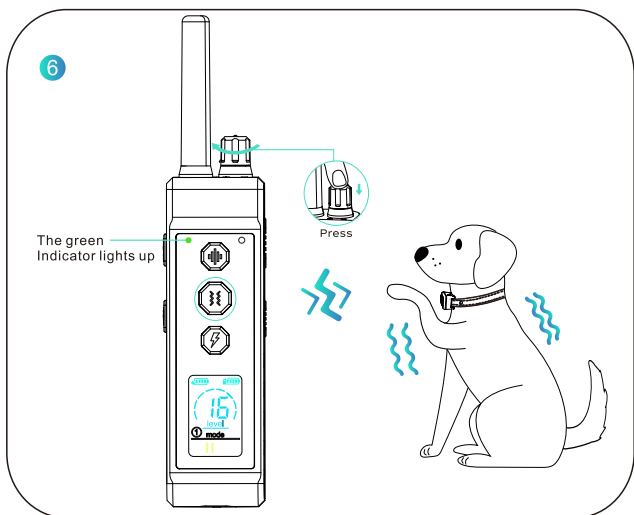

Vibration Command: Press the Vibration Button, and the green Indicator Light on the Remote Transmitter rapidly lights up. The Receiver will deliver vibration, and the green LED Indicator light on the Receiver comes up simultaneously. To adjust the Vibration level, press the Adjustment Knob to select the Vibration Mode first, then turn the Adjustment Knob left and right to raise/lower to the desired level, and finally press  button to confirm the modification.

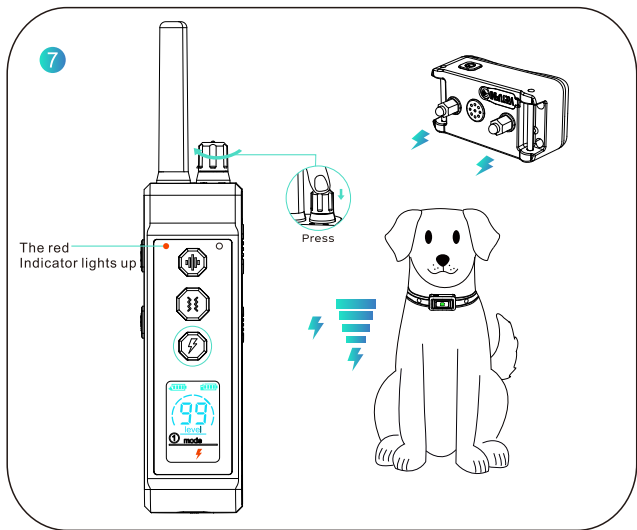

Shock Command: Press the Shock Button, and the red indicator Light on the Remote Transmitter rapidly lights up. The Receiver will deliver a shock and the green LED Indicator light on the Receiver comes up simultaneously.

To adjust the shock level, press the Adjustment Knob to select the Shock Mode first, then turn the Adjustment Knob left and right to raise/lower to the desired level, and finally press  button to confirm the modification.



Switch the channel by pressing the On/Off (Channel) Button. This product can train up to 2 dogs.

9

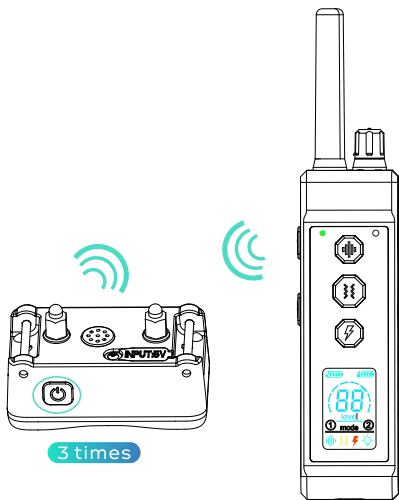

Pair the Remote Transmitter to an extra Receiver: first, change the channel of the Remote Transmitter to Channel 2 by pressing the On/Off (Channel) Button; press the Power Button on the extra Receiver 3 times until you hear a beeping tone, while the green LED Indicator light on the extra Receiver keeps on.

Then press any one of the Warning Tone, Vibration, or Shock Button, and the Receiver will beep 3 times as the green LED Indicator light goes off. Last press any one of the Warning Tone, Vibration, or Shock Button, and the Receiver will respond accordingly.

10

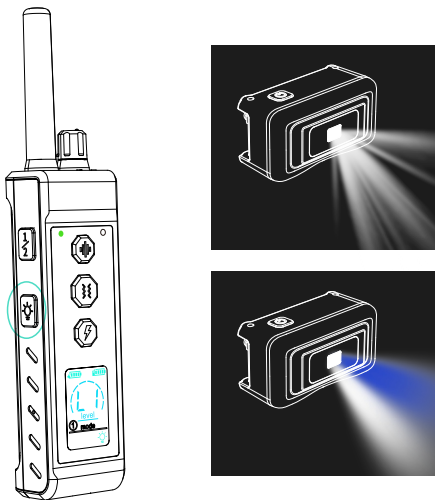

Light Mode: Press the lighting button once, the white light is always on; when the white light is on, press and hold the lighting button to switch the blue light and white light to flash alternately.

11

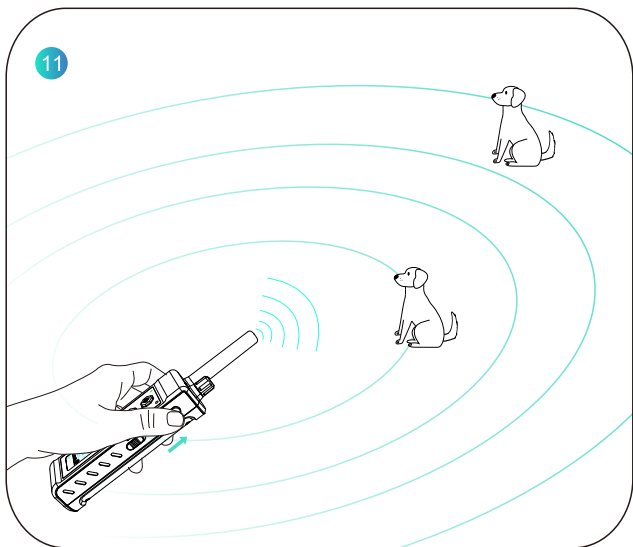

Turbo Mode: Slide the Turbo Button to increase the remote control distance. The max remote range will be triple after the Turbo mode is on.

III. Package Content



Remote Transmitter

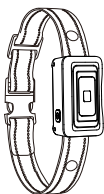

Receiver Collar



Test Bulb



Metal Prongs



Conductive Silicone Caps

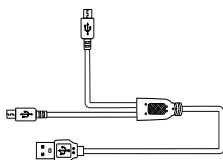

Type-C Cable



User Manual

IV. Product Overview

Receiver

LED Indicator

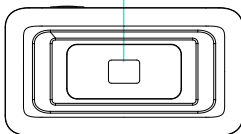

Speaker

Contact Points

Charging Jack

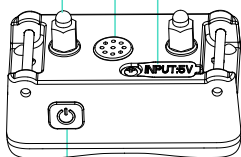

Power Button

Remote Transmitter

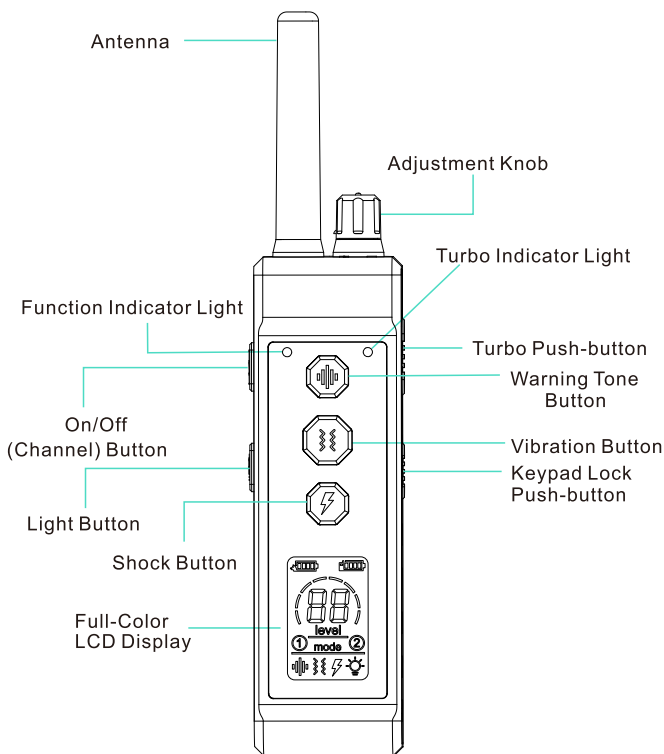

Note:

(1)The icon "88" will be displayed when the Remote Transmitter switches to the lock state.

(2)The Remote Transmitter will go into sleep mode if no operation in one minute.

LCD Display

