

*Receiver Collar Indicator Light Definitions

Receiver Collar Function	Receiver Collar Indicator Light Response
System Running	Slow Blinking, 1 blink every 4 seconds
Low Battery	Fast Blinking, 2 blinks every 1 second
Fully charged/Pairing Mode/ Executing the Shock, Vibration or Warning Tone Command	Indicator light become Solid
On charge	Slow Blinking, 1 blink every 1 second

Step 7 Charging the Device

The Remote Training Collar use Lithium-Polymer batteries, DO NOT charge the device near any flammable substances. Fully charge the Remote Transmitter and Receiver Collar before use.

Charge the Remote Training Collar if:

- The indicator light on the Receiver Collar is blinking rapidly.
- There is only 1 battery level bar left on the Remote Transmitter LCD display.
- The indicator light on the Remote Transmitter and Receiver collar will not come on.

Charging Steps:

- 1.Plug the adaptor into a standard wall outlet.
- 2.Lift the rubber cover on the Receiver Collar charging jack.
- 3.Connect the USB cable connectors to the charging jack on Receiver Collar and Remote Transmitter.

4. Connect the USB cable port to the power adapter, power bank or your PC.

Notes:

Remote Transmitter: Fully charged, the Green LED indicator will become solid.

Receiver Collar: Fully charged, the Green LED indicator will become solid.

The charging time takes 2~3 hours, Green indicator light on Remote Transmitter and Blue indicator light on Receiver Collar will blink slowly when charging.

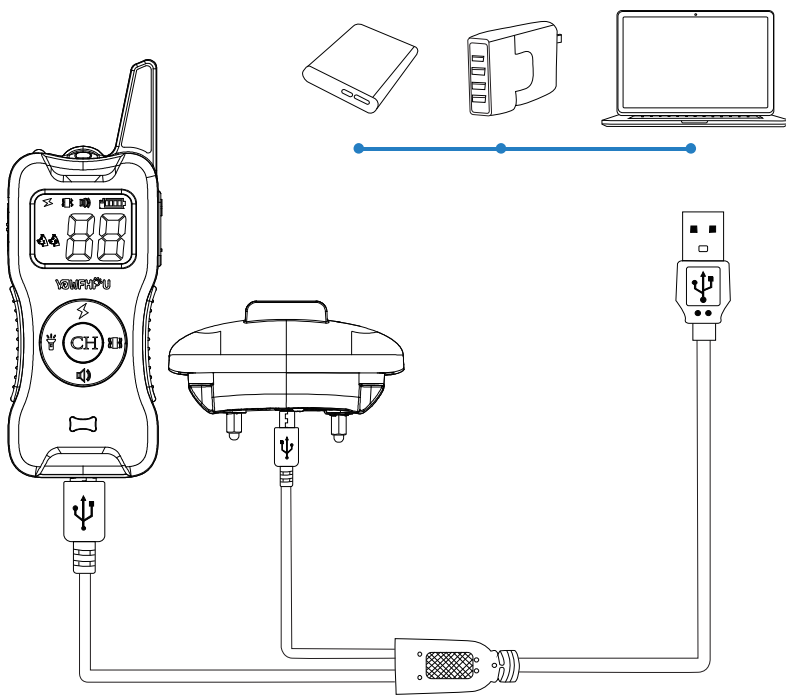

Warning:

In case you have to use chargers for charging, please use those with 5V output voltage. Improper chargers will cause charging damage to the device.

If it's on charge with improper chargers, receiver Collar will deliver Warning Tone continuously and red indicator will blink fast on Remote Transmitter.

Notes:



- 1. Improper chargers mean those with output voltage over 5V.
- 2. Output Voltage usually can be seen

Step 8 How to Pair the Remote Transmitter & Receiver Collar

If your Receiver Collars does not beep when you press the Beep Button on the Remote Transmitter, or you feel the Receiver Collar is not responding to the Remote Transmitter, follow these steps to pair.

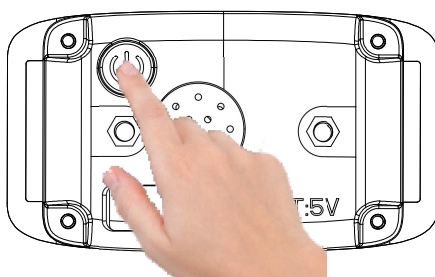
Press and hold the power button on the Receiver Collar for 2 seconds to turn on the Receiver Collar.



Press the  or  or  on the Remote Transmitter to complete the pairing. Then Receiver Collar will respond to your operations on the Remote.

Tips: You can choose channel 1 or channel 2 to pair the Remote Transmitter & Receiver Collar. The system can pair 2 Receiver Collars at the same time. If you can not pair the device successfully, it maybe caused by the signal interference. Please change to another place to try or contact with our service center.

Notes: The Remote Transmitter and Receiver Collar will only work on the channel you have paired. For example, if you have paired Remote Transmitter to Receiver Collar on Channel 1, Remote Transmitter can control Receiver Collar only on Channel 1, and it will not work on Channel 2.

The system can pair 2 Receiver Collars to 2 different channel at the same time. If you bought the dual Receiver Collars version, follow “Step 8” above to pair the other receiver (Choose the other channel by pressing the Channel Button  on the Remote Transmitter).

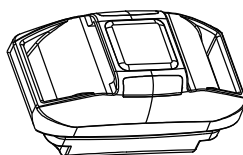
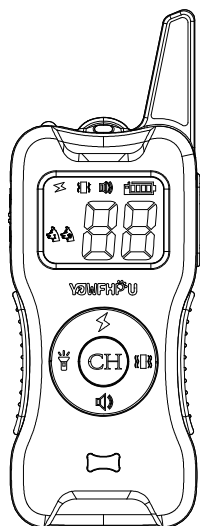

1 Receiver Collar paired to Channel 1

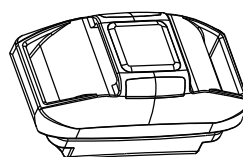

1 Receiver Collar paired to Channel 2

Step 9 How to Test the Functions

Beeping Test

- Press the  Button to test the Warning Tone function.
- The Receiver Collar will beep along with solid green indicator on the Receiver Collar indicating that the Warning Tone function works.

Vibration Test

- Press the  Button to test the Vibration function.
- The Receiver Collar will vibrate along with solid green indicator on the Receiver Collar indicating that the Vibration function works.

Shock Test

- Secure the Test Bulb on the Receiver Collars' Contact Points.
- Press the  Button to test the shock function.
- The Test Bulb will light up along with solid green indicator on the Receiver Collar indicating the static shock stimulation works, Test Bulb become brighter at higher shock levels.

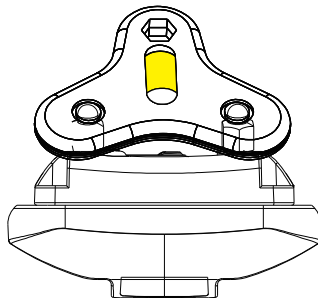

Notes:

For your dog's comfort and safety, please ensure the conductive silicone covers are worn on the contact points before putting the Receiver Collar on your dog. The conductive silicone covers can deliver the static shock.

Notes: The hexagon hole on the Test Bulb can be used to fasten or unfasten the Probes to the Contact Points.

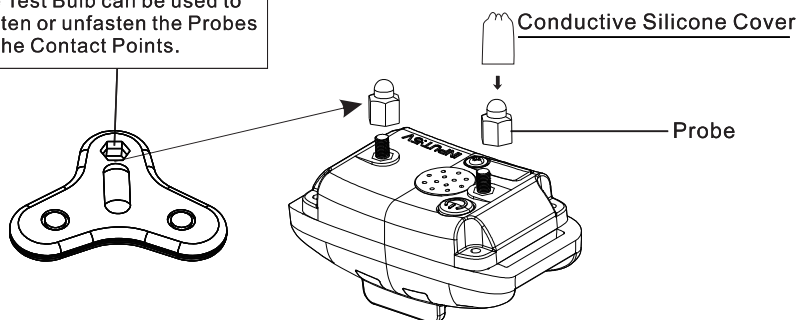

General Training Guide

General Tips

- Eliminate one misbehavior or teach one obedience command at a time. If you move too fast with training, your pet may become confused.
- Be consistent. Correct your pet every time he misbehaves.
- Unless you can supervise him, it is recommended that you restrict your pet from situations in which he has a history of misbehaving. However, setting up a situation as a training session can dramatically improve your chances of success.
- If your pet reacts to the beeps by hiding or acting fearful, redirect his attention to a simple and appropriate behavior, such as the "sit" command.
- Pets should be at least 6 months old before using the Trainer.
- Only let responsible family members use the Trainer. It is not a toy!
- Other pets in hearing range will be affected by the training beeps. Therefore, training sessions should be conducted out of hearing range of other pets.

CAUTION: Never use the Remote Trainer to correct or eliminate any form of aggressive behavior. We recommend you contact your local veterinarian or professional trainer to determine if your pet might be aggressive. See page 1 for more information.

Teaching Basic Obedience

The "Sit" Command

1. Put a separate, non-metallic collar on your pet's neck ABOVE the Receiver Collar, and attach a 10-foot leash. Note: Be sure the extra collar does not put pressure on the Contact Points.
2. Hold the leash and the Remote Transmitter in one hand. Keep your other hand free to guide your pet into a "Sit" position.
3. Press and hold the Stimulation Button, starting at your pet's Recognition Level.

4. Immediately give the “Sit” command while continuing to hold the Stimulation Button.
5. Release the Stimulation Button as soon as your pet is in position, and praise him.
6. Release your pet from the “Sit” command and play.
7. Repeat Steps 2 through 6.

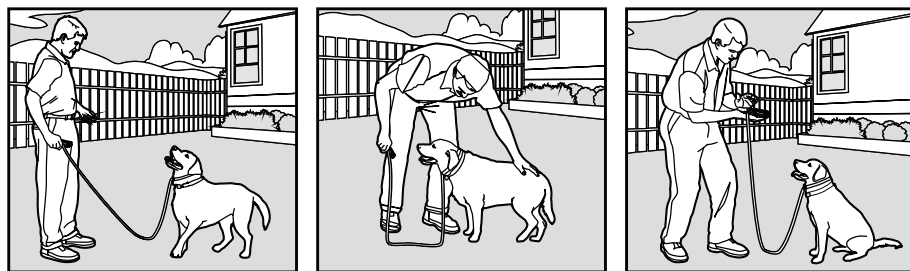

Note: If your pet breaks the “Sit” command, repeat steps 3 through 6. Keep your pet close to you while teaching the “Sit” command.

The “Come” Command

1. Put a separate, non-metallic collar on your pet’s neck ABOVE the Receiver Collar, and attach a 10-foot leash. Note: Be sure the extra collar does not put pressure on the Contact Points.
2. Hold your leash in one hand and the Remote Transmitter in the other.
3. Wait for your pet to walk away from you. Using the Recognition Level for your pet, press and hold the Stimulation Button on your Remote Transmitter.
4. Immediately give the command “Come” while continuing to hold the Stimulation Button.
5. Using the leash, gently guide your pet toward you until he begins to come in your direction.
6. Immediately release the Stimulation Button as soon as your pet steps towards you, and praise him enthusiastically.
7. Quickly move backwards as your pet begins to come back to you, praising him the entire time.
8. Praise your pet when he returns to you.
9. Repeat Steps 3 through 8.
10. Once your pet responds readily to the “Come” command several times, back away from him without giving a command.

When your pet turns toward you, give the command “Come” (WITHOUT STIMULATION) and praise him while you continue to back up. Praise your pet when he returns to you.

11. Use your leash to prevent your pet from running past you. If your pet manages to run past you, repeat Steps 3 through 8.

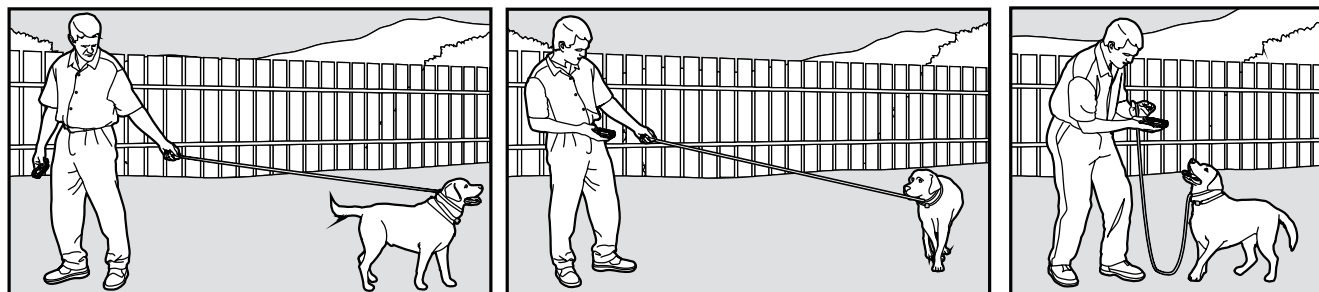

The “Stay” Command

1. Put a separate, non-metallic collar on your pet’s neck ABOVE the Receiver Collar, and attach a 10-foot leash. Note: Be sure the extra collar does not put pressure on the Contact Points.

2. Put your pet on his bed. Hold your leash in one hand and the Remote Transmitter in the other.

3. Staying within 3 feet, walk the perimeter of the bed. Do not say anything to your pet.

4. If your pet tries to leave the bed, press and hold the Stimulation Button and give the “Stay” command. Continue to hold the button until your pet is back on his bed. If necessary, use the leash to guide your pet onto his place.

5. Praise your pet when he is back on his bed.

6. Once your pet has settled for a few seconds, release him and play calmly.

7. Repeat steps 1 through 5.

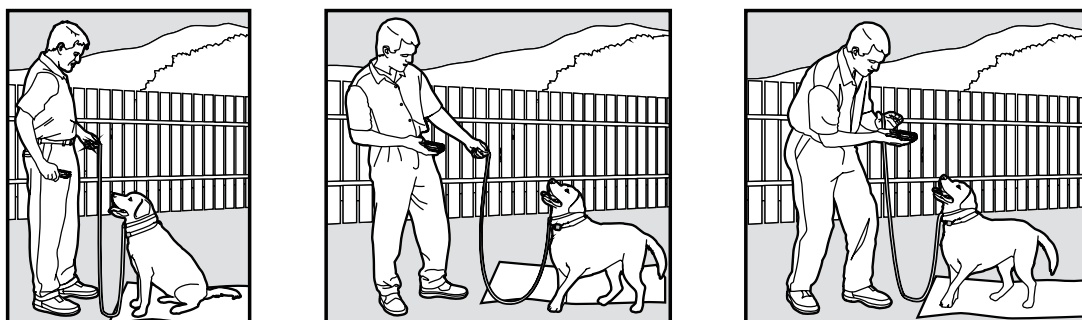

Eliminating Unwanted Behavior

Jumping Up

Pets typically jump up to get attention. If you do not want your pet to jump on you, then friends or members of the family should not encourage this behavior. That means every time your pet jumps on someone, he should be reprimanded or redirected to an alternate and acceptable behavior, for which he can receive praise.

Note: It is best if your pet first understands the “Sit” command.

1. Choose your pet’s Recognition Level.
2. As soon as your pet lifts his paws off the ground to jump on you, press the Stimulation Button and give the command “Sit.”
3. Release the Stimulation Button immediately once your pet is sitting, and verbally praise him.
4. If your pet ignores the stimulation, increase the Intensity Level by 1.
5. Practice this exercise in several different areas and use different people for distractions.

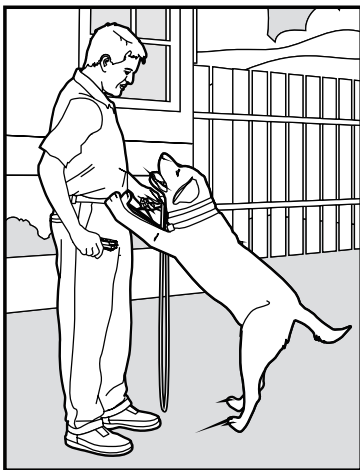

Digging

It is important to first understand why your pet is digging. Many dogs, such as terriers, were bred to flush out prey, and digging is very innate to them. Other dogs may be digging to find a cool spot to lie down, or simply out of boredom. Your pet may no longer have the desire to dig if he is provided with the following:

- A cool, shaded area in which to lie down, and plenty of water.
- An alternate activity, such as a favorite toy.
- Plenty of play, exercise, and attention.
- A yard free from rodents or prey that he may be trying to flush out.

1. Choose the Intensity Level 1 higher than your pet's Recognition Level.
2. Place the Receiver Collar on your pet and wait at least 10 minutes before placing him in the yard. No other people or pets should be in the yard, as you do not want your pet to associate the stimulation with anything other than his digging. Your pet must be securely fenced in or contained during training.
3. From a window or area where your pet cannot see you, wait until your pet begins to dig.
4. While your pet digs, press the Stimulation Button and release it when he stops digging. Only press the button while your pet is in the act of digging, and do not say anything to him.
5. If your pet ignores the stimulation, increase the Intensity Level by 1.
6. Continue to watch your pet, as he may choose another area to dig.
7. Do not allow your pet in the yard unsupervised until he has completely stopped digging.

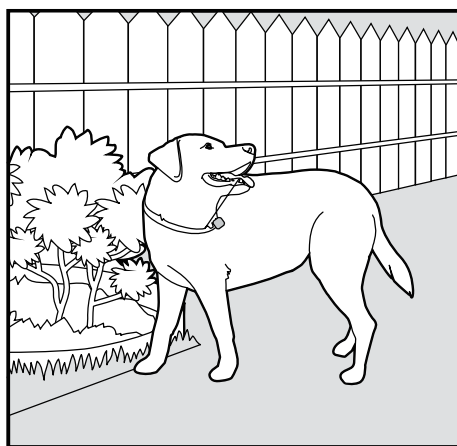
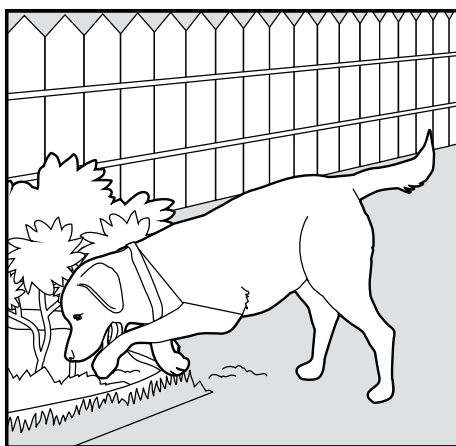
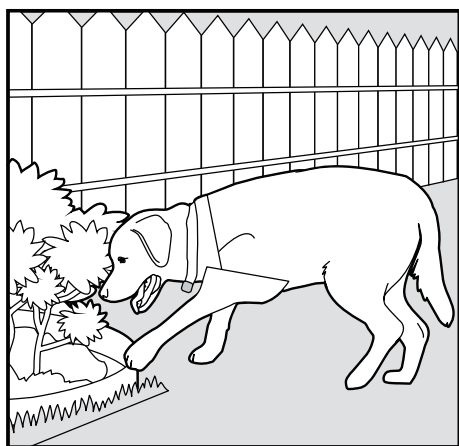

Chasing

Chasing is an instinctive behavior stimulated by moving objects. Some dogs have a particularly strong desire to chase that can put them in harm's way and leave you helpless. Never allow your dog off the leash or out of a contained area until he has learned the "Come" command, regardless of the distraction. Be consistent and correct your dog every time he chases something.

CAUTION: It is vitally important that you and your dog remain safe while learning during on-leash training. Your dog should be on a strong leash, long enough for him to attempt to chase an object, but short enough for him not to reach a road or other unsafe area. You must also be physically strong enough to restrain your dog when he tries to chase.

1. If your dog has not learned the "Come" command, keep a leash on him so you can physically stop him before he reaches the object he is chasing.
2. Choose the Intensity Level 1 higher than your dog's Recognition Level.
3. Set up a scenario where your dog is enticed to chase an object. Common items could be cars, motorcycles, bicycles, etc. (do not use toys).
4. When the object passes in front of your dog, make sure to hold the leash with a firm grip. As soon as your dog begins to chase the object, press and hold the Stimulation Button until he stops.
5. When your dog stops chasing the object, immediately release the button, walk backwards and give the command "Come." Praise your dog as he comes to you.
6. Repeat the process until your dog stops chasing the object.

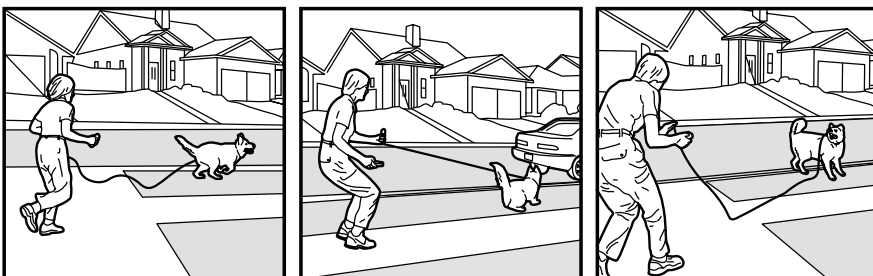

Trash Raiding

The easiest way to prevent trash raiding is to remove garbage and tempting food from your pet's environment. You can use the Training Collar to teach your pet to stay away from these items; however, you must be prepared to correct your pet every time he approaches them.

1. Choose the Intensity Level 1 higher than your pet's Recognition Level.
2. Pick a temptation for your pet and position yourself where he cannot see you.
3. While your pet's mouth is touching the temptation, press and hold the Stimulation Button. Immediately release the button when your pet leaves the temptation.
4. Do not say anything, as you want your pet to associate the stimulation with his behavior, not you.
5. If your pet does not respond to the stimulation, increase the Intensity Level by 1 and repeat the process.
6. Repeat this process in several different locations with different temptations.

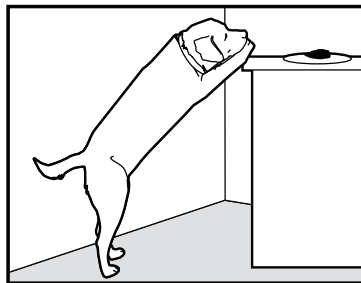
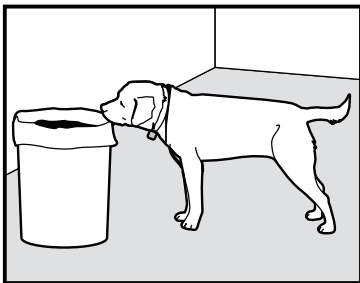

Frequently Asked Questions

<p>Is the Stimulation safe for my pet?</p>	<ul style="list-style-type: none"> •While the Stimulation is unpleasant, it is harmless to your pet. Electronic training devices require interaction and training from the owner to achieve desired results.
<p>How old does my pet have to be before using the Remote Training Collar?</p>	<ul style="list-style-type: none"> •Your pet should be able to recognize basic obedience commands such as "Sit" or "Stay". Pets should be at least 6 months old before using the Trainer.
<p>Once my pet is trained and has been obeying my commands, will he have to continue to wear the Receiver Collar?</p>	<ul style="list-style-type: none"> •Probably not. You may need to reinforce training with the Receiver Collar from time to time.
<p>Is the Receiver Collar waterproof?</p>	<ul style="list-style-type: none"> •Yes. Receiver Collar meets lab test waterproof standard, but make sure to keep the area dry when charging. Notes: Remote Transmitter is not waterproof.
<p>How can I get the largest remote range with the Remote Training Collar?</p>	<ul style="list-style-type: none"> •The range of the Remote Training Collar will vary according to terrain, weather, vegetation, as well as transmission from other radio devices. See "How the System Works" for tips on maximizing your range.
<p>How long can I continuously deliver stimulation to my pet?</p>	<ul style="list-style-type: none"> •The maximum amount of time you can press the Stimulation Button and deliver stimulation to your pet continuously is 10 seconds. After this, the Remote Transmitter will time-out, and the Stimulation Button must be released and pressed again.

Trouble Shooting

<p>My pet does not respond when I press a button.</p>	<ul style="list-style-type: none">•Make sure the Receiver Collar has been turned on.•If your range has reduced from the first time you used the Remote Training Collar, the battery(s) may be low in either the Remote Transmitter or Receiver Collar.•Many factors can impact the amount of range you have with the Remote Trainer. For a list of these factors, see "How the System Works".•Test the Receiver Collar. See "How to test the functions" for details.•Increase the Stimulation Level. Refer to "How to find the best Vibration/ Shock Level for your pet" for more information.•Make sure the Receiver Collar's Contact Points are placed snugly against your pet's skin. Refer to "How to Fit the Receiver Collar" for more information.
<p>The Receiver Collar will not turn on.</p>	<ul style="list-style-type: none">•Make sure the Receiver Collar has been charged. For the initial charge, be sure to charge it for 4 hours. Subsequent charges only take 2~3 hours.
<p>The Receiver Collar is not responding to the Remote Transmitter.</p>	<ul style="list-style-type: none">•Verify the Receiver Collar is on.•If the indicator light is blinking rapidly, fully charged the Receiver Collar.•If the first two solutions did not resolve your problem, see "How to pair the Remote Transmitter & Receiver Collar."

FCC

USA

This device complies with part 15 of the FCC Rules. Operation is subject to the following two conditions: (1) This device may not cause harmful interference, and (2) this device must accept any interference received, including interference that may cause undesired operation.

NOTE: This equipment has been tested and found to comply with the limits for a Class B digital device, pursuant to part 15 of the FCC Rules. These limits are designed to provide reasonable protection against harmful interference in a residential installation. This equipment generates, uses, and can radiate radio frequency energy and, if not installed and used in accordance with the instructions, may cause harmful interference to radio communications. However, there is no guarantee that interference will not occur in a specific installation. If interference does occur to radio or television reception, which can be determined by turning the equipment off and on, the user is encouraged to try to correct the interference by one or more of the following measures:

- Reorient or relocate the receiving antenna.
- Increase the separation between the equipment and the receiver.
- Connect the equipment to an outlet on a circuit different from that to which the receiver is connected.
- Consult customer care, the dealer, or an experienced radio/TV technician for help.

Changes or modifications not expressly approved by the party responsible for compliance could void the user's authority to operate the equipment.

The device has been evaluated to meet general RF exposure requirement.

Reference size for different dogs

Size	Neck Girth (IN)	Chest Girth (IN)	Back Length (IN)	Weight (LBS)	Breed
X-Small	7.8-8.6	9.8-11.8	7.4	1-10	Chihuahua, Yorkshire, Terrier
Small	7.8-9.4	11.4-14.1	9.0	11-25	Poodle, Pomeranian
Medium	9.0-11.0	13.7-16.5	11.0	26-40	Shih Tzu, Maltese Dog
Large	10.6-12.2	16.1-18.5	12.2	41-70	Miniature Schnauzer, Pekingese
Large	11.8-13.3	18.1-20.8	13.7	71-90	English Cocker Spaniel
Large	12.9-14.5	20.4-23.2	15.7	91-110	Beagle
X-Large	16.9-18.9	29.9-33.0	23.6	N/A	Husky
X-Large	18.5-20.4	34.6-38.1	23.6	N/A	Labrador Retriever
X-Large	20.4-24.4	36.2-39.3	27.5	N/A	Golden Retriever, Old English Sheepdog

Version: E300 V1
Made in China