

Premium Dog Training Collar

User Manual

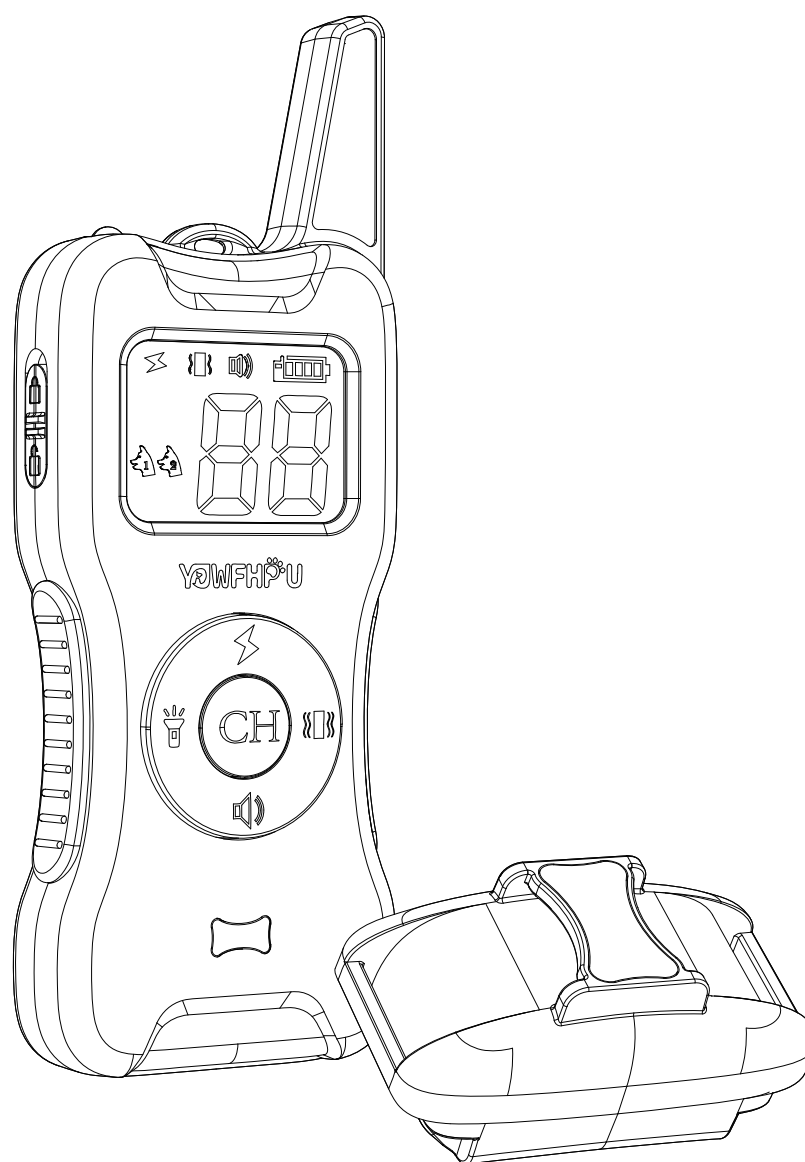

READ FULL USER MANUAL BEFORE USE

Important Safety Information

WARNING:

Not for use with aggressive dogs. Do not use this Product if your dog is aggressive, or if your dog is prone to aggressive behavior. Aggressive dogs can cause severe injury and even death to their owner and others. If you are unsure whether this product is appropriate for your dog, please consult your veterinarian or certified trainer.

CAUTION:

Safety during on-leash training. It is vitally important that you and your dog remain safe while learning during on-leash training. Your dog should be on a strong leash, long enough for him to attempt to chase an object, but short enough for him not to reach a road or other unsafe area. You must also be physically strong enough to restrain your dog when he tries to chase.

Risk of skin damage. Please read and follow the instructions in this manual. Proper fit of the collar is important. A collar worn for too long or made too tight on the pet's neck may cause skin damage. Ranging from redness to pressure ulcers; this condition is commonly known as bed sores.

- **Avoid leaving the collar on the dog for more than 12 hours per day.**
- When possible re-position the collar on the pet's neck every 1 to 2 hours.
- Check the fit to prevent excessive pressure; follow the instructions in this manual.
- Never connect a leash to the electronic collar; it will cause excessive pressure on the contacts.
- When using a separate collar for a leash, don't put pressure on the electronic collar.
- Wash the dog's neck area and the contacts of the collar weekly with a damp cloth.

- Examine the contact area daily for signs of a rash or a sore.
- If a rash or sore is found, discontinue use of the collar until the skin has healed.
- If the condition persists beyond 48 hours, see your veterinarian.

These steps will help keep your pet safe and comfortable. Millions of pets are comfortable while they wear stainless steel contacts. Some pets are sensitive to contact pressure. You may find after some time that your pet is very tolerant of the collar. If so, you may relax some of these precautions. It is important to continue daily checks of the contact area. If redness or sores are found, discontinue use until the skin has fully healed.

Table of Contents

Components	4
Other Items You May Need	4
How the System Works.....	5
Definition of the Product	6
Operating Guide	7
How to Turn the Remote Training Collar On/Off	7
How the Transmitter Buttons Work	8
How to Fit the Receiver Collar.....	8
How to Find the Best Stimulation Level for Your Pet.....	10
How to Maximize the Distance.....	11
The LCD Display & LED Indicator.....	12
Charging the Device	13
How to Pair the Remote Transmitter & Receiver Collar	14
How to Test the Functions.....	16
General Training Guide	17
General Tips	17
Teaching Basic Obedience	17
Eliminating Unwanted Behavior	20
Frequently Asked Questions	24
Trouble Shooting	25
FCC	26
Reference Size for Different Dogs	27

Components

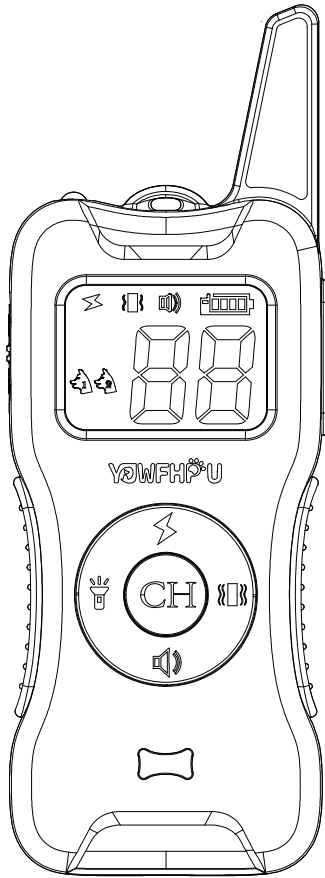

Remote Transmitter

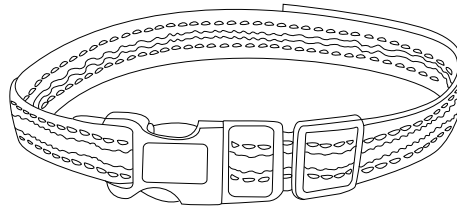

Strap

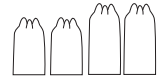

Conductive Silicone Covers

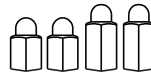

Contact Points

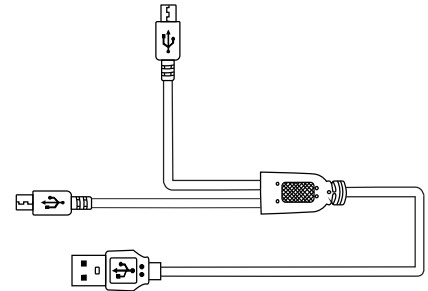

USB Cable

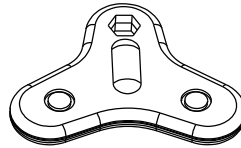

Test Bulb

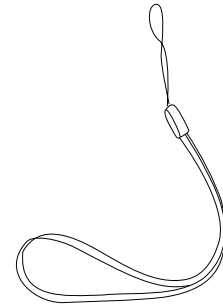

Wrist Strap

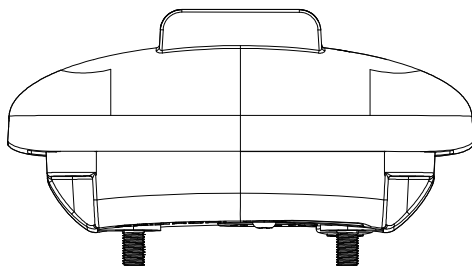

Receiver Collar

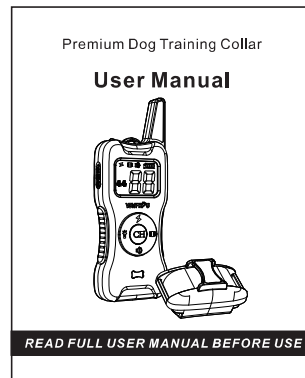

User Manual

Other Items You May Need

- Scissors
- Lighter

How the System Works

The Remote Training Collar is easy to use with an advanced digital display that tells you exactly what level of stimulation you are using.

The Remote Training Collar assist you in controlling your pet without a leash.

Your remote sends a signal activating your dog's Receiver Collar. He receives a safe but annoying stimulation. He'll quickly learn the association between his behavior and your correction; in no time, you'll have a better-behaved pet. The Remote Training Collar has been proven safe, comfortable, and effective for both small and large dog breeds.

Using the Remote Trainer consistently and correctly, any basic obedience commands can be taught and many misbehaviors that your pet exhibits can be corrected.

Definition of the Product

Remote Transmitter

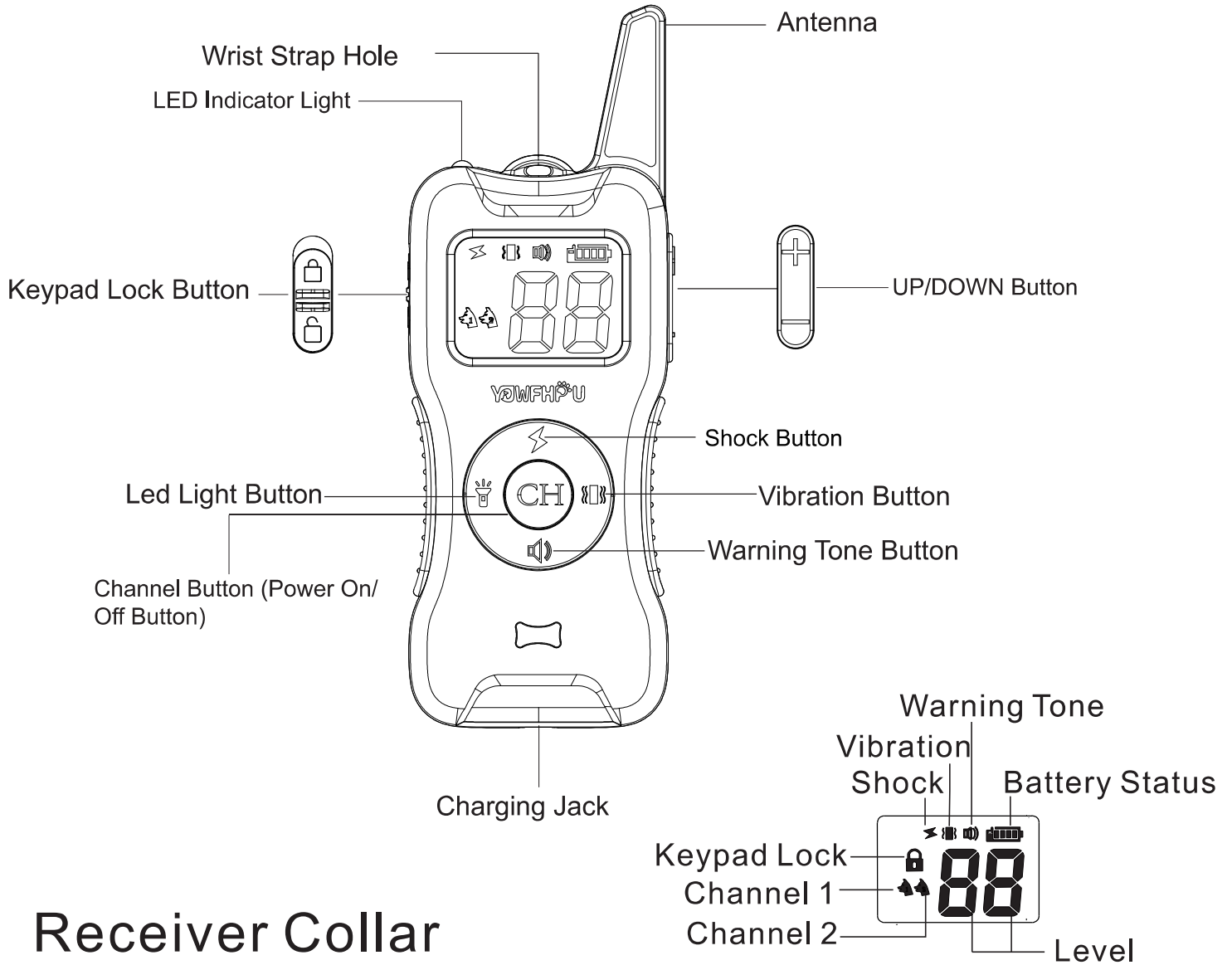

Receiver Collar

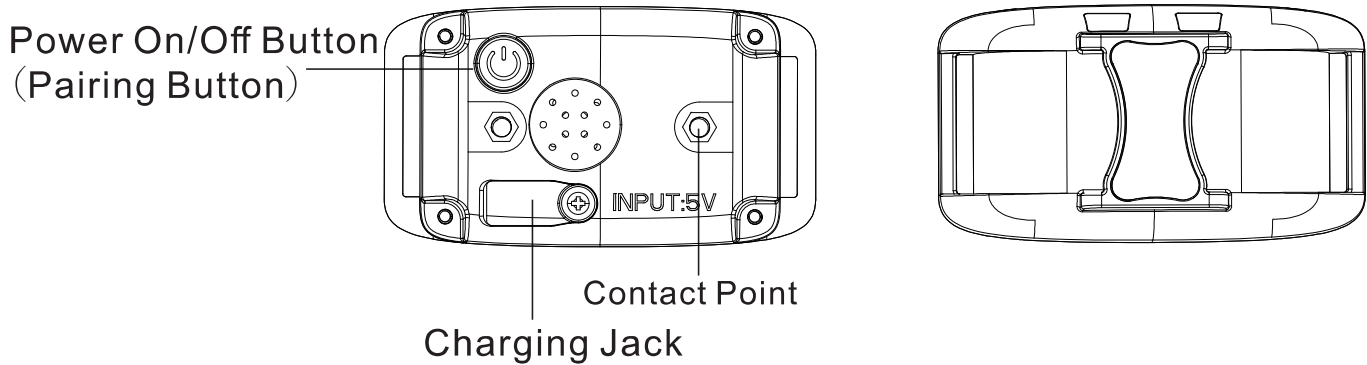

Operating Guide

Step 1 How to Turn the Remote Training Collar On/Off

To turn the Remote Transmitter on

1. Press and Hold the channel button (CH) for 2 seconds to power on the Remote Transmitter. The backlight will be on.
2. Backlight will be off at 15 seconds if there is no operation.
3. LCD display will be turned off at 2 minutes if there is no operation. Any press on the button of the Remote Transmitter will activate the Remote Transmitter.

To turn the Remote Transmitter off

Press and Hold the channel button (CH) for 2 seconds to power off the Remote Transmitter.

To turn the Receiver Collar on



Press and Hold the power button (⏻) for 2 seconds, the Receiver Collar will vibrate and indicator will start to blink in green.

To turn the Receiver Collar off

Press and Hold the power button (⏻) for 2 seconds, the Receiver Collar will beep and GREEN LED indicator turns off.

Notes: To extend the life of the batteries, turn off the Remote Transmitter and Receiver Collar when they are not in use.

Step 2 How the Transmitter Buttons Work

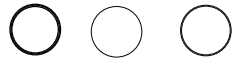

1. Press  /  /  once to send a vibration, shock and beep command to Receiver Collar.



Press the Shock Button, then adjust Shock level by pressing the Up & Down Button.

Press the Vibration Button, then adjust Vibration level by pressing the Up & Down Button.

Press the Warning Tone Button, then adjust Tone level by pressing the Up & Down Button.

Notes: You can also press  button select the stimulation you want, then adjust the levels by pressing the Up & Down Button. You can also press  button for 3 seconds to turn on/off the LED light.

How to Fit the Receiver Collar

Important: The proper fit and placement of your Receiver Collar is important for effective training. The Contact Points must have direct contact with your pet's skin on the underside of his neck. To assure a proper fit, please follow these steps:

Step 3

1. Make sure that the Receiver Collar is turned off.
2. Have your pet standing comfortably.
3. Place the Receiver Collar on your dog's neck close to the ears. Center the Contact Points underneath your dog's neck, touching the skin.

Note: It is sometimes necessary to trim the hair around the Contact Points to make sure that contact is consistent.

CAUTION: Do not shave the pet's neck as this may increase the risk of skin irritation.

4. The Receiver Collar should fit snugly, yet loose enough to allow one finger to fit between the strap and your pet's neck.

5. Allow your pet to wear the collar for several minutes then recheck the fit. Check the fit again as your pet becomes more comfortable with the Receiver Collar.

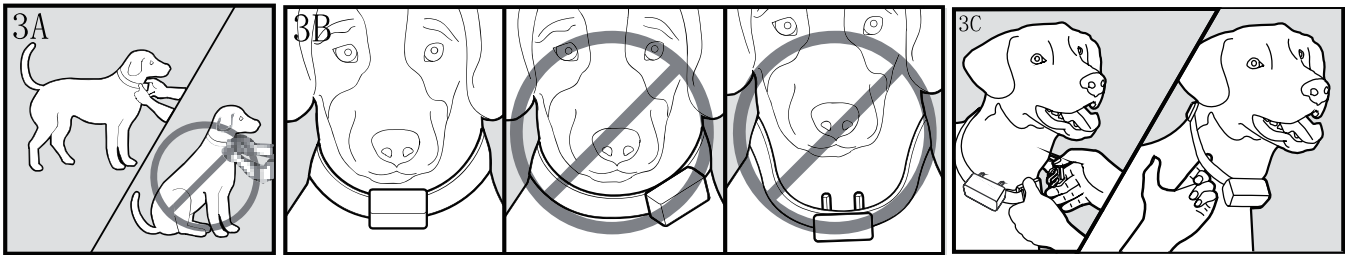

6. How to attach the strap to the Receiver Collar?

Follow the 1-2-3-4 steps instructed to thread the strap.



Notes: In case you have the Nylon collar in package, mark the desired length of the collar, leaving some extra inches (if your dog is still growing more or for the thicker winter coat), and cut off the excess. Seal the edge of the cut strap by holding it above the fire for a few seconds.

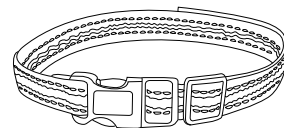

Nylon Collar

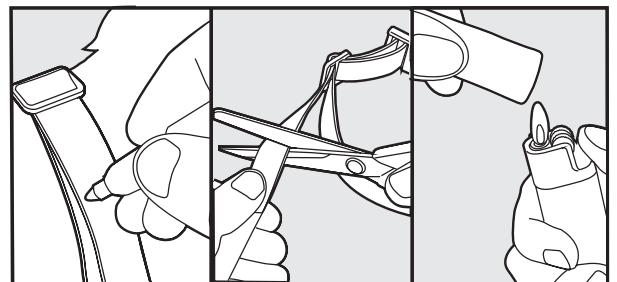

Step 4 **How to Find the Best Vibration/Shock/Warning Tone Level for Your Pet**

The Remote Training Collar has 99 stimulation levels for Static Shock and 16 for Vibration. Always start at the lowest level and work your way up. This allows you to choose the Stimulation level that is best for your pet. Once you have placed the Receiver Collar on your pet, it is time to find the Stimulation Level that is best for him. This is called the Recognition Level. A slight change in your pet's behavior, such as looking around in curiosity, scratching at his collar, or flicking his ears, indicates the Recognition Level that is best for him.

Follow the steps below to find your pet's Recognition Level:

1. Starting at Level 1 on the Digital Display, press the Vibration/Shock Button continuously for 1 to 2 seconds. Note: When the Vibration/Shock Button is held down for 10 consecutive seconds, the Transmitter will "time-out", and you must release and press the button again before additional stimulation can be delivered.
2. If your pet shows no reaction, repeat the Stimulation Level several times before moving up to the next level.
3. **YOUR PET SHOULD NOT VOCALIZE OR PANIC WHEN RECEIVING STIMULATION. IF THIS HAPPENS, THE STIMULATION LEVEL IS TOO HIGH AND YOU NEED TO GO BACK TO THE PREVIOUS LEVEL AND REPEAT THE PROCESS.**
4. Move up through the Stimulation Levels until your pet reliably responds to the stimulation.
5. If your pet continues to show no response at highest level, check the fit of the Receiver Collar. If your pet has long or thick hair, please use the the longer set of Contact Points in package. Then go back to #1 and repeat the process.

Notes:

For Warning Tone, there is 8 types of tone without loudness difference. Please try each Warning Tone and find the one that attract your pet's attention best.

If this still does not yield any results, your pet's hair will need to be trimmed around the Contact completing all of these steps, your dog still does not indicate he is feeling the stimulation, please contact our customer service.

Step How to Maximize the Distance

5

Terrain, weather, vegetation, transmission from other radio devices, and other factors will affect the maximum range.

Hold the Remote Transmitter in a horizontal position away from your body to achieve optimum range. For Maximum signal strength, keep the device properly charged.



Maximum range



Typical range









Minmum range

*Avoid touching the antenna or the range may decrease substantially.



Step The LCD Display & LED Indicator

6

*LCD Display on Remote Transmitter

	Indicates keypad is locked.
	Indicates Shock Mode is on
	Indicates Beep Mode is on
	Indicates Vibration Mode is on
	Indicates battery level
	Indicates stimulation levels of Shock/Vibration and types of Warning Tone

*Remote Transmitter Indicator Light Definitions

Remote Transmitter Function	Remote Transmitter Indicator Light Response
Press  , deliver warning tone command to Receiver Collar	Green LED on when pressing the button
Press  ,deliver vibration to Receiver Collar base on current level showed on LCD display(vibration will stop after 10 consecutive seconds and will reset after release the Vibration Button)	Green LED on when pressing the button
Press  ,deliver shock to Receiver Collar base on current level showed on LCD display(shock will stop after 10 consecutive seconds and will reset after release the Shock Button)	Red LED on when pressing the button
Charging the Remote Transmitter	Green LED blinks
Remote Transmitter is fully charged	Green LED is on