

MANUAL

Magnetic Wireless Charging Phone Mount

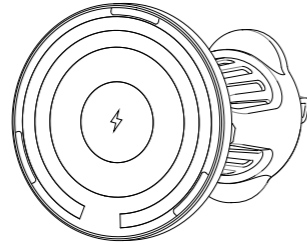

HC-WC02

Parts

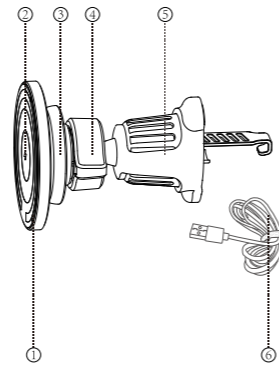

- ① Anti-slip Silicon Pad
- ② Coil Induction Area
- ③ Ball Socket
- ④ Ball-Nut
- ⑤ Airvent Hook
- ⑥ Cable

Installation

- ① Insert the ball-nut through the ball socket of the airvent hook component part
 - ② Attach the ball and socket joint together
 - ③ Turn locking knob anti-clockwise to tighten and attach the joint components
 - ④ Gently place the desktop ring phone holder over the assembled component parts and it will magnetically attach to each other
 - ⑤ Insert the hook into the vehicle airvent and hook it onto the grille
 - ⑥ Turn knob clockwise to tighten hook and lock onto the grille, fix support
- Turn knob counterclockwise to extend hook

Instructions

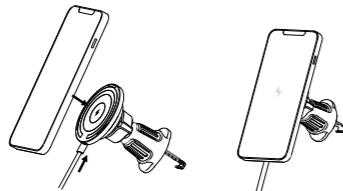

Plug-in the cable, then place the center of the mobile phone in alignment with the center of the magnetic phone mount to start automatic wireless charging immediately.

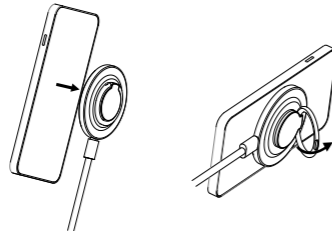

The magnetic phone mount can be detached from the installation part attached to the vehicle. When the phone mount is removed it could be used as a desktop ring phone holder. Keep the magnetic phone mount connected to the cable for wireless charging feature

Parameters

Model:HC-WC02
 Input:5V/2A 9V/2A
 Output:15W(Max)

FCC Statement

This equipment has been tested and found to comply with the limits for a Class B digital device, pursuant to part 15 of the FCC Rules. These limits are designed to provide reasonable protection against harmful interference in a residential installation. This equipment generates, uses and can radiate radio frequency energy and, if not installed and used in accordance with the instructions, may cause harmful interference to radio communications. However, there is no guarantee that interference will not occur in a particular installation. If this equipment does cause harmful interference to radio or television reception, which can be determined by turning the equipment off and on, the user is encouraged to try to correct the interference by one or more of the following measures:

- Reorient or relocate the receiving antenna.
- Increase the separation between the equipment and receiver.
- Connect the equipment into an outlet on a circuit different from that to which the receiver is connected.
- Consult the dealer or an experienced radio/TV technician for help.

Caution: Any changes or modifications to this device not explicitly approved by manufacturer could void your authority to operate this equipment.

This device complies with part 15 of the FCC Rules. Operation is subject to the following two conditions: (1) This device may not cause harmful interference, and (2) this device must accept any interference received, including interference that may cause undesired operation.

Radiation Exposure Statement

This device complies with FCC RF radiation exposure limits set forth for an uncontrolled environment. The FCC certification of this device refers to RF exposure testing performed in typical operating conditions, where a person is no closer than 20 centimeters from the device surface at all times, except for non-repetitive patterns with transient time intervals in the order of a second. Only in the stated conditions, the device is shown to fully comply with the FCC RF Exposure requirements of KDB 447498.

CE FC RoHS Recycle Made in China