

Wireless Charger Manual

Product List

1. Wireless charging
2. Instructions
3. Charging cable

PRODUCT OVERVIEW:

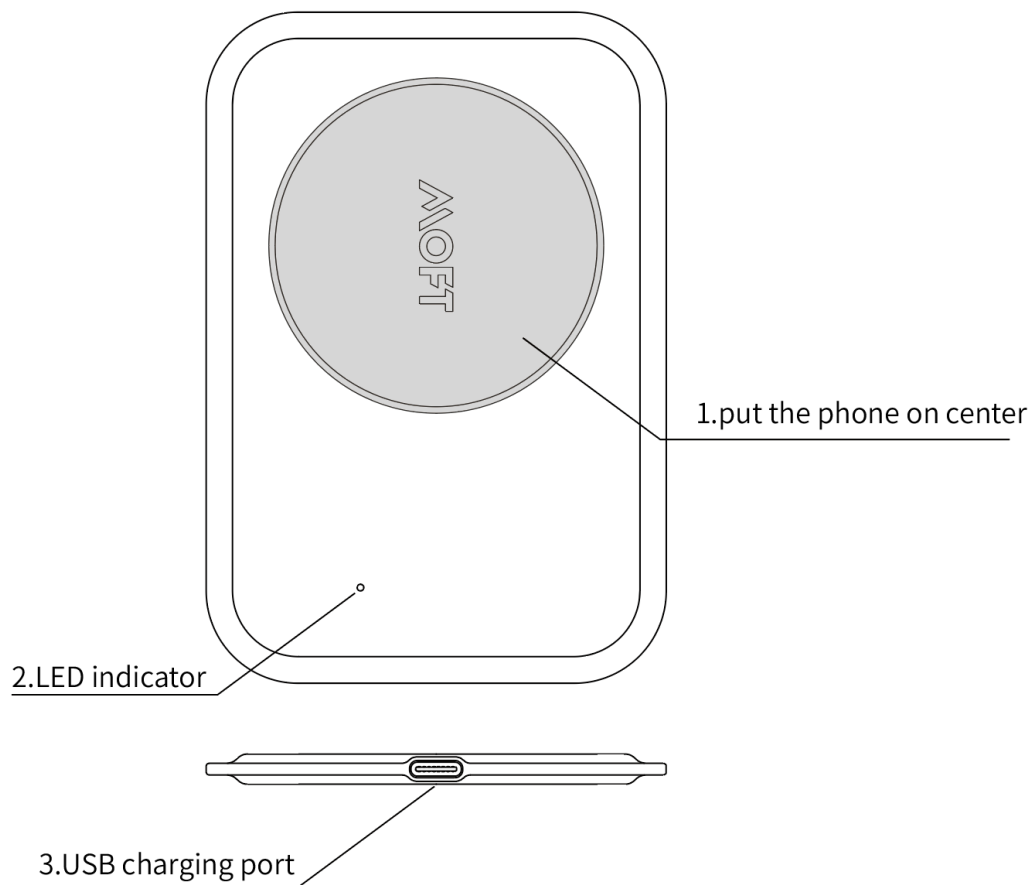

SPECIFICATION:

Input: DC 5V /2A , 9V1.67A

PD/QC: 9V/1.12A

OUT:5V/2A 9V/1.12A

Charging distance: <3mm

Operation Temperature: 0°C ~ 40°C.

Storage Temperature: -20°C ~70°C

How to use:

1.Inserting the USB input interface into the charger or other charger interface to apply power.

2.Attaching the wireless charger to the back of the phone (charging area), it can sense and start wireless charging.

LED intruduction

LED Display	LED1
Clour	Green
Electrify	RED and Green alternates flashing
Standby	Green light
charge	Green light flashing
Full Charge	Green light
FOD	Red light
Alarm	Red light

Note:

1.Please avoid using thick phone case

2.Please avoid any metal objects btween the phone and wireless charger.

3.Make sure your phone is compatible for wireless charging

4.For Magsafe, make sure your phone is compatible for Magsafe charging, Android users or non-magsafe Apple users

are used with magnetic stickers.

IMPORTANT:

1. Only use included accessories or certified and tested accessories to charge this device. Using third party accessories can influence the item safety.
2. Some phone cases may block the wireless charging
3. Do not place other materials, like metal objects, magnets, and magnetic stripe cards, between the mobile device and the wireless charger pad.
4. Check your mobile device's battery percentage using the charging icon displayed on the screen of your phone.
5. When the mobile device is not placed on the charging surface accurately, your mobile device may not charge properly.

FCC Statement

This device complies with part 15 and part 18 of the FCC Rules. Operation is Subject To the following two conditions: (1) This device may not cause harmful interference, and (2) this device must accept any interference received, including interference that may cause undesired operation. Changes or modifications not explicitly approved by the party responsible for compliance could void the user's authority to operate this equipment.

Note: this equipment has been tested and found to comply with the limits for a Class B digital device, pursuant to part 15 and part 18 of the FCC Rules. These limits are designed to provide reasonable protection against harmful interference in a residential installation. This equipment generates, uses and candidate radio frequency energy and, if not installed and used in accordance with the instructions, may cause harmful interference to radio communications. However, there is no guarantee that interference will not occur in a particular installation. If this equipment does cause harmful interference to radio or television reception, which can be determined by turning the equipment off and on, the user is encouraged to try to correct the interference

by one or more of the following measures:

- Reorient or relocate the receiving antenna.
- Increase the separation between the equipment and receiver.
 - Connect the equipment into an outlet on a circuit different from that to which the receiver is connected.
- Consult the dealer or an experienced radio/TV technician for help.

The equipment complies with FCC radiation exposure limits set forth for an uncontrolled environment. During the operation of device a distance of 15 cm surrounding the device and 20 cm above the top surface of the device must be respected.

This device complies with Part 18 of the FCC Rules. This equipment generates uses and can radiate radio frequency energy and, if not installed and used in accordance with the instructions, may cause harmful interference to radio communications. If this equipment does cause harmful interference to radio or television reception, which can be determined by turning the equipment off and on, the user is encouraged to try to correct the interference by one or more of the following measures:

- Increase the separation between the equipment and any other radio device.
- Connect the equipment into an outlet on a circuit different from that to which the receiver is connected.