

Baseus	产品名称: 倍思 原石 无线充 15W	版本: P0A0
	包装编码: PB2256Z	设计日期: 2019-10-19
	包装尺寸: 80*115mm	审核: 由成铭
	包装材料: 悦声臻品上质100g 高白	
	后道工艺: 双面单色印刷、风琴褶	备注: 文字、线条需要印刷清晰
	设计师: 邓刚华	

Baseus倍思

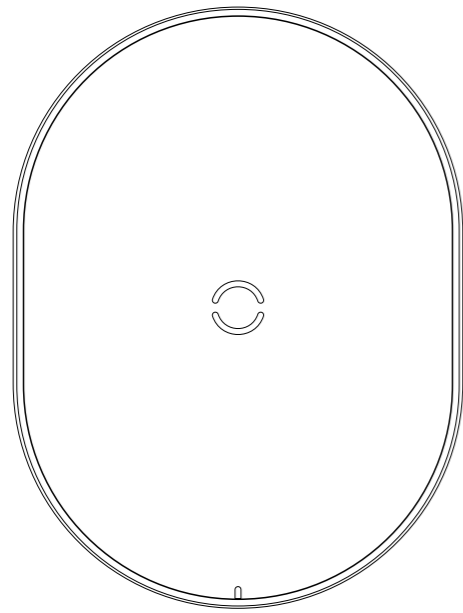

原石 无线充电器
产品使用说明书

使用产品前请仔细阅读本产品使用说明书, 并妥善保管

产品介绍

感谢您选择购买我公司的无线充电产品, 这是一款支持快速充电的无线充电器, 使用本产品前, 请认真阅读本说明书, 并妥善保管, 以备查阅。

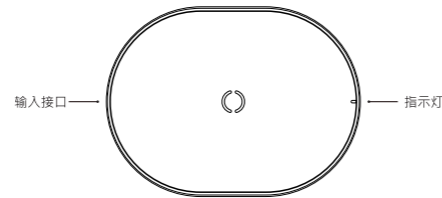

规格参数

品牌: Baseus (倍思)
型号: BS-W501
名称: 倍思 原石无线充电器
材质: PC+硅胶
颜色: 黑色/白色
接口: Type-C输入
输入电流: DC 5V~2A 9V~2A 12V~2A (Max)
(建议搭配功率18W及以上的QC3.0适配器)
兼容性: 支持符合Qi标准的无线充电设备
产品尺寸: 100.8mm*75.5mm*12.5mm
产品重量: 130.3g (不含包装)

注: 以上参数均来源于产品实测, 实际参数会因产品或其他因素而有差异

包装清单

无线充电器 *1
数据线 *1
说明书 *1
保修卡 *1

-1-

使用说明

1.接通电源后, 指示灯点亮;

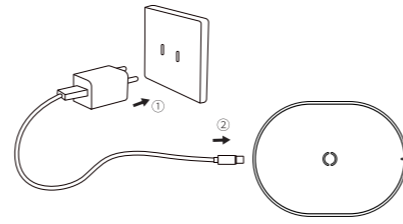

2.放上手机或其他支持Qi标准的无线接收设备, 对正产品后, 橙色指示灯呼吸闪烁进入充电状态;

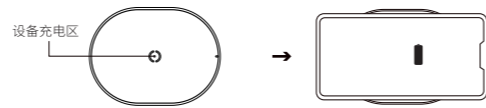

3.充电时, 需保持手机的中心位置对准无线充电器的中心位置, 即可进行无线充电, 若不能正常工作充电, 请调整手机放置的位置, 直至手机显示正常充电;

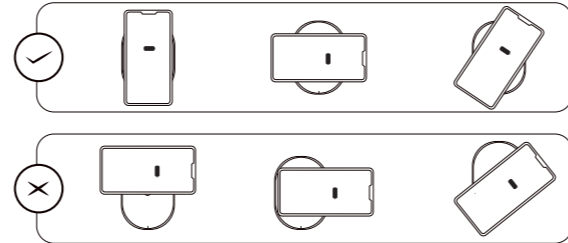

-2-

4.当LED灯闪烁时, 无线充电器处于错误或者保护阶段, 此时应当注意是否有金属物体置于无线充电器的充电位置, 将其拿掉即可正常充电;

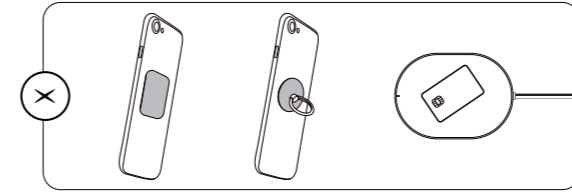

电子信息产品有毒有害物质申明

部件名称	有毒有害物质或元素					
	铅 (pb)	汞 (Hg)	镉 (Cd)	六价铬 (Cr VI)	多溴联苯 (PBB)	多溴二苯醚 (PBDE)
PCB	X	0	0	0	0	0
外壳	0	0	0	0	0	0
附件	0	0	0	0	0	0

本表格依据SJ/T 11364的规定编制。
O: 表示该有毒有害物质在该部件所有均质材料中的含量超出GB/T 26572标准规定的限量要求以下。
X: 表示该有毒有害物质至少在该部件某一均质材料中的含量超出GB/T 26572标准规定的限量要求。
该产品符合欧盟RoHS 2.0指令(2011/65/EU)

注意事项

- 1.使用本产品时, 请使用输出电压为9V~2A, 12V~2A或其他带快速充电功能的适配器。
- 2.充电时接触面不能放置金属物, 如铁片, 指甲, 金属保护壳等;
- 3.手机充电时, 如有发现断续充电或发热严重的情况, 很可能是手机接收线圈与无线充电线圈没有完全对准, 请尝试冷却手机, 再进行正确位置对位。
- 4.本产品有输入过流/过压保护功能, 如使用不当会导致本产品寿命降低或损坏, 因此带来的责任, 不属于保修责任或厂家责任, 敬请谅解。
- 5.请使用干燥软布清洁表面, 不要用化学品、肥皂或者洗涤剂清洗。
- 6.用户不正确使用或不正确放置本产品可能会导致本产品寿命降低或损坏, 因此带来的责任, 不属于保修责任或厂家责任, 敬请谅解。

-3-

品牌名: Baseus倍思
公司: 深圳市时高创新科技有限公司
地址: 深圳市龙岗区坂田街道南岭社区雪岗路2008号倍思智能园B栋五层
执行标准: Q/SSCZ 021-2020
热线: 4000-112-111 网址: www.baseus.com
Copyright©2019-2021 Shenzhen Times Innovation Technology Co., Ltd.
All Rights Reserved

The "Qi" symbol is a trademark of the Wireless Power Consortium



PB2256Z
倍思设计
中国制造



-4-

Baseus

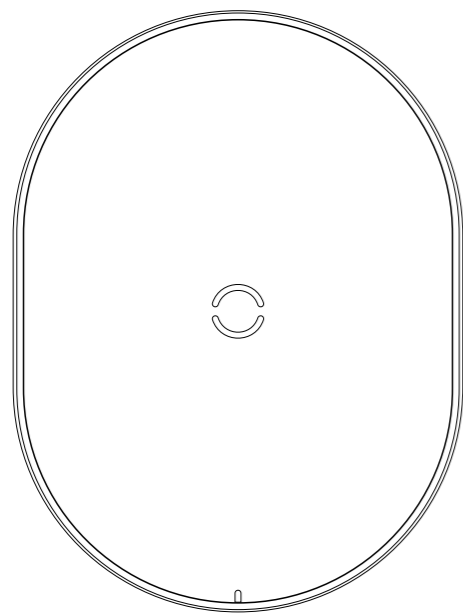

Cobble Wireless Charger
User Manual

Please read this instructions completely and keep it properly

Product Introduction

Thanks for your choosing our wireless charger, this wireless charger support quick charging. Before you use this product, Please read this manual carefully and save it.

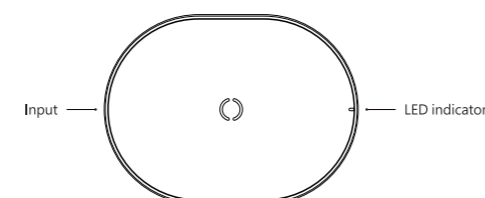

Specification

Brand: Baseus
Model: BS-W501
Name: Baseus Cobble Wireless Charger
Material: PC+Silicone
Color: Black / White
Interface: Type-C Input
Input Current: DC 5V~2A 9V~2A 12V~2A (Max)
(It is recommended to use the QC3.0 adapter with power of 18W or above.)
Compatibility: Supports Qi-compliant wireless charging devices
Product Size: 100.0mm*80.0mm*7.3mm
Product Weight: 130.3g (without packaging)

Package List

Wireless Charger *1
User Manual *1
Warranty card *1
Charging Cable *1

-5-

Instruction

1.After the product is inserted into the adapter, the indicator lights will be on.

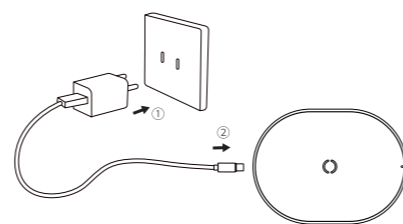

2.Charging mode: Orange light breath.

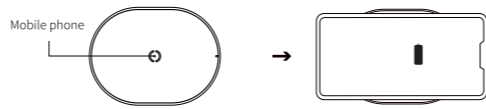

3. Point your phone at the center of the wireless charger, and the wireless charger starts working. If it cannot work properly, please adjust the position of the mobile phone until the mobile phone displays normal charging. (please refer to the following figure for placement)

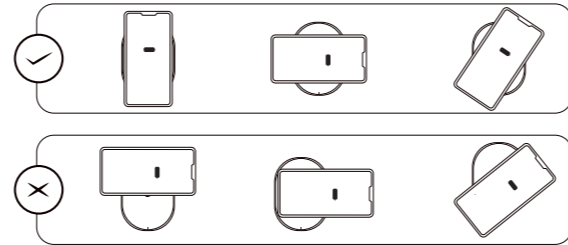

-6-

4. FOD: light flicker.

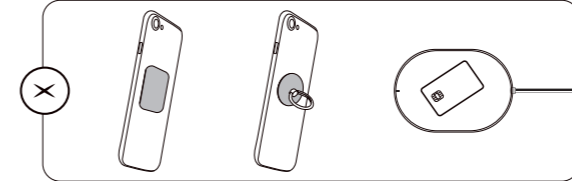

Statement on Toxic and Hazardous Substances in Electronic Information Products

Part Description	Toxic or hazardous substances and elements					
	Lead (Pb)	Mercury (Hg)	Cadmium (Cd)	Hexavalent chromium (Cr VI)	Polybrominated biphenyls (PBB)	Polybrominated diphenyl ethers (PBDE)
PCB	X	0	0	0	0	0
Casing	0	0	0	0	0	0
Accessory	0	0	0	0	0	0

This form is compiled in accordance with SJ/T 11364.
O: It indicates that the content of the toxic and harmful substance in all homogeneous materials of the component is below the limit specified in GB/T 26572 standard.
X: The content of toxic and harmful substances in at least one homogeneous material of this part exceeds the limit stipulated in GB/T 26572 standard.
This product complies with EU RoHS 2.0 Directive (2011/65/EU)

Caution

1. To achieve best performance of this wireless charger, or 9V~2A, 12V~2A adapter is suggested to be adapted.
2. In the process of charging, do not put any metal materials like key, ring, metallic phone case etc. on the back of phone device or wireless charger directly.
3. It may occur occasional intermittent charging or serious heating due to the unjustified position of phone receiver coil and wireless charging, please try to cool your phone, then move your phone to carry out the alignment.
4. This product has over current / voltage protection, it will be shut off or reduce output if used in incorrect way. Please check whether your device is abnormal or not.
5. Please use this product under temperature of 0-25°C. DO NOT Expose the product to water, fire, or in overheated and lower temperature environment, the product will be unavailable, Do not let children to touch accessories.
6. Please use dry, clean soft cloth to clear product surface, DO NOT use chemistry material and soap to clean.
7. Manufacturer will not be responsible for those defects which caused by users, Please kindly understand.

-7-

This device complies with part 15 of the FCC Rules. Operation is subject to the following two conditions: (1) this device may not cause harmful interference, and (2) this device must accept any interference received, including interference that may cause undesired operation.

Any changes or modifications not expressly approved by the party responsible for compliance could void the user's authority to operate the equipment.

NOTE: This equipment has been tested and found to comply with the limits for a Class B digital device, pursuant to Part 15 of the FCC Rules. These limits are designed to provide reasonable protection against harmful interference in a residential installation. This equipment generates, uses and can radiate radio frequency energy and, if not installed and used in accordance with the instructions, may cause harmful interference to radio communications. However, there is no guarantee that interference will not occur in a particular installation.

If this equipment does cause harmful interference to radio or television reception, which can be determined by turning the equipment off and on, the user is encouraged to try to correct the interference by one or more of the following measures:

- Reorient or relocate the receiving antenna.
- Increase the separation between the equipment and receiver.
- Connect the equipment into an outlet on a circuit different from that to which the receiver is connected.
- Consult the dealer or an experienced radio/TV technician for help.

Shenzhen Times Innovation Technology Co., Ltd.
Add: 5th Floor, Building B, Baseus Intelligence Park, No.2008, Xuegang Rd,
Gangzou Community, Banlian Street, Longgang District, Shenzhen
Executive Standard: Q/SSCZ 021-2020
Hotline: +86-4000-112-111 Website: www.baseus.com
Copyright©2019-2021 Shenzhen Times Innovation Technology Co., Ltd.
All Rights Reserved

The "Qi" symbol is a trademark of the Wireless Power Consortium



PB2256Z
Designed by Baseus
Made in China



-8-